

The Secretary
NSW Department of Planning, Industry and Environment

30 June 2021

ATTENTION: Jason Maslen

Dear Sir or Madam

I refer to the Department's below email of 28 June 2021 regarding the notice of exhibition of the Environmental Impact Statement (EIS) for State Significant Development SSD-10879802 Carlingford West Public School Upgrades for 'Construction and refurbishment of permanent learning spaces, new library, reconfigured open space, access and play areas. Also includes construction of additional parking spaces on site, new driveway and turning circle to Felton Road west' at 59 - 73 Felton Road, Carlingford (Lots 1 & 2 DP 235625) in the City of Parramatta Council Local Government Area (LGA). Submissions need to be made to the Department by 27 July 2021.

Please refer to Endeavour Energy's submission made to the Department via email on 20 November 2020 regarding the request for Secretary's Environmental Assessment Requirements (SEARs) for State Significant Development SSD-10879802 Carlingford West Public School Upgrades. The recommendations and comments provided therein generally remain valid.

Subject to the foregoing and the following further recommendations and comments Endeavour Energy has no objection to the Development Application.

- Network Capacity / Connection

Endeavour Energy has noted the following in the Infrastructure Management Plan addressing the suitability of the site for the development in regard to whether electricity services are available and adequate for the development.

4 Electrical Services

4.1 Supply

It is understood that the current loads at the site will not be sufficient to facilitate the realisation of the full design as it currently stands and load assessment utilising AS 3000 estimates reveal a new 1000kVA capacity substation will be required. A new main switchboard will also be required that will supply the existing main switchboard.

Though in the earliest stages of planning two options are currently being assessed for the new substation. Each are being assessed in preliminary planning before being handed to an ASP Level 3 Designer to further coordinate and assess capabilities of each areas for the development. The two defined entry points of Felton Road East & Felton Road West are the two locations under current consideration. Each have benefit for the site and regardless of perceived benefit the decision to accept remains with the Authority, being Endeavour Energy.

For the two options for the proposed new padmount substation, the Architectural Plans only appear to show a new substation to the Felton Road East entry point. As there is no existing 11,000 volt / 11 kilovolt (kV) high voltage conductors to Felton Road West, a feeder would need to be extended to supply a padmount substation in that location.

The Infrastructure Management Plan includes Section 16 Electrical Supply Offer (ULL3312) for Standard Connection Service dated 21 May 2021.

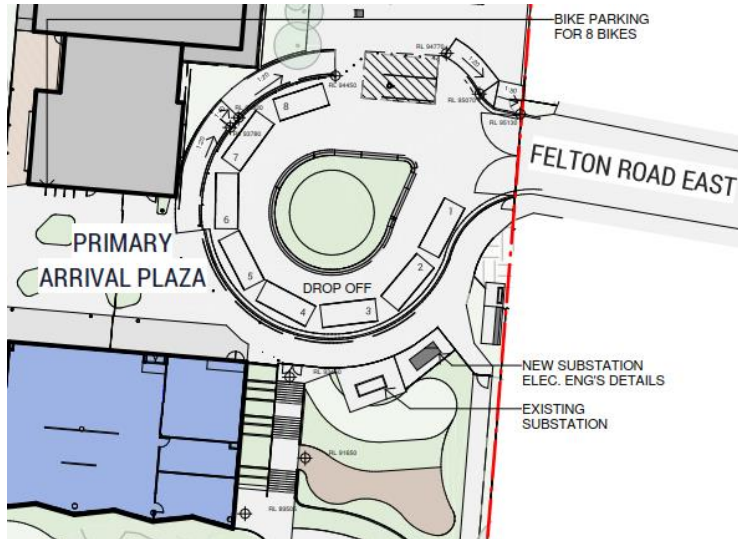

The applicant will need to complete the connection of load process as detailed in the Connection Offer. Endeavour Energy's Network Connections Branch are responsible for managing the conditions of supply with the proponent and their Accredited Service Provider (ASP) and can be contacted via Head Office enquiries on business days from 9am - 4:30pm on telephone: 133 718 or (02) 9853 6666.

Generally it is the Level 3 ASP's responsibility (engaged by the developer) to make sure that the substation location and design complies with Endeavour Energy's standards the suitability of access, safety clearances, fire ratings, flooding etc. As a condition of the Development Application consent the Department should request the submission of documentary evidence from Endeavour Energy confirming that satisfactory arrangements have been made for the connection of electricity and the design requirements for the substation, prior to the release of the Construction Certificate / commencement of works.

Subject to the foregoing Endeavour Energy has no objection to the Development Application.

Should you wish to discuss this matter, or have any questions, please do not hesitate to contact me or the contacts identified above or in Endeavour Energy's previous submission in relation to the various matters. Due to the high number of development application / planning proposal notifications submitted to Endeavour Energy, to ensure a response contact by email to property.development@endeavourenergy.com.au is preferred.

With the COVID-19 health risk a significant number of Endeavour Energy staff are working from home. Access to emails and other internal stakeholders can accordingly be somewhat limited. As a result it may sometimes take longer than usual to respond to enquiries. Thank you for your ongoing understanding during this time.

Yours faithfully
 Cornelis Duba
 Development Application Specialist
 Network Environment & Assessment
 M: 0455 250 981
 E: cornelis.duba@endeavourenergy.com.au
 51 Huntingwood Drive, Huntingwood NSW 2148
www.endeavourenergy.com.au



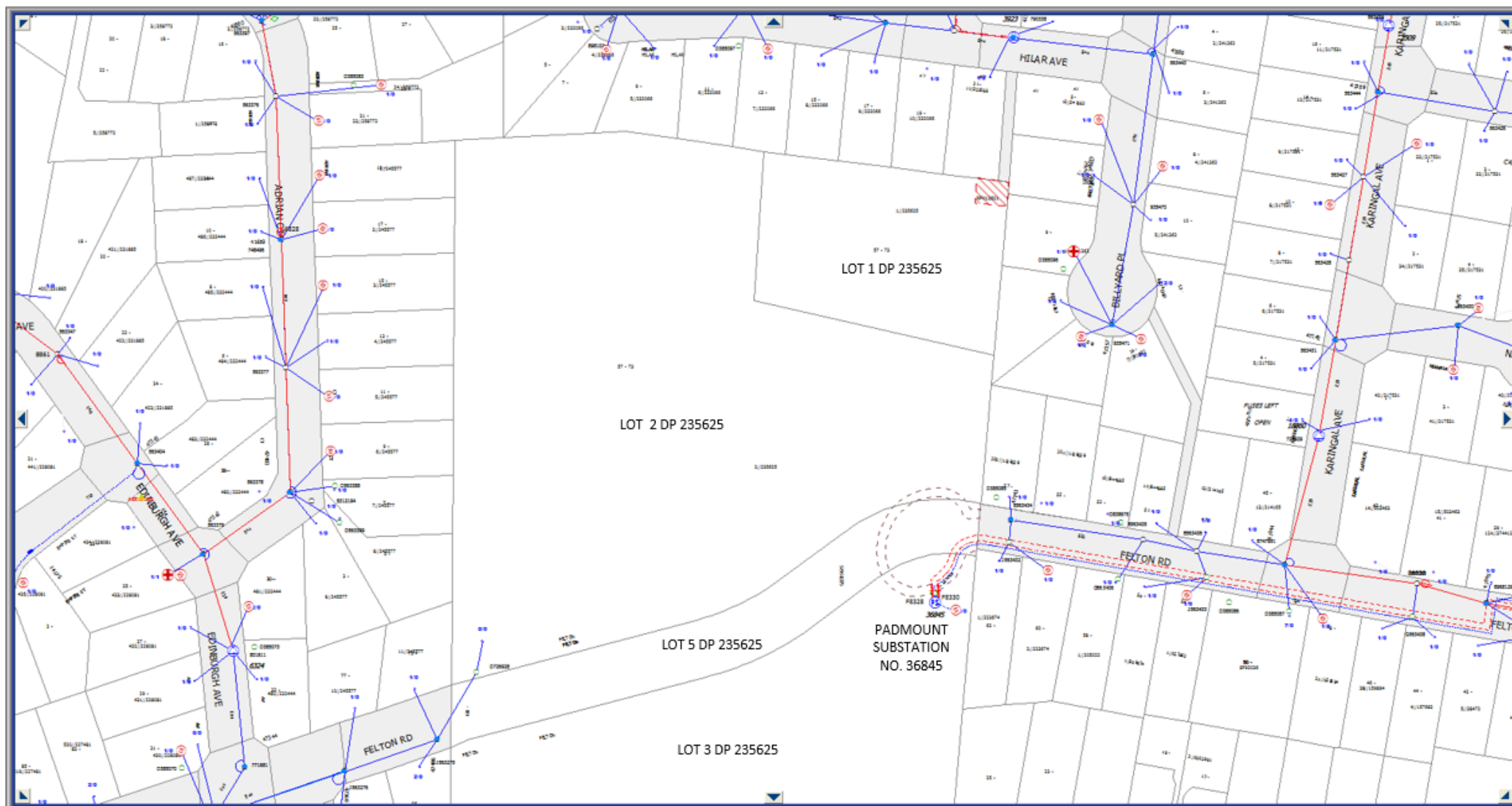

Please note the location, extent and type of any electricity infrastructure, boundaries etc. shown on the plan is indicative only. In addition it must be recognised that the electricity network is constantly extended, augmented and modified and there is a delay from the completion and commissioning of these works until their capture in the model. Generally (depending on the scale and/or features selected), low voltage (normally not exceeding 1,000 volts) is indicated by blue lines and high voltage (normally exceeding 1,000 volts but for Endeavour Energy's network not exceeding 132,000 volts / 132 kV) by red lines (these lines can appear as solid or dashed and where there are multiple lines / cables only the higher voltage may be shown). This plan only shows the Endeavour Energy network and does not show electricity infrastructure belonging to other authorities or customers owned electrical equipment beyond the customer connection point / point of supply to the property. This plan is not a 'Dial Before You Dig' plan under the provisions of Part 5E 'Protection of underground electricity power lines' of the Electricity Supply Act 1995 (NSW).

From: Erin White <Erin.White@planning.nsw.gov.au> **On Behalf Of** DPE PSVC Social and Other Infrastructure Mailbox

Sent: Monday, 28 June 2021 11:36 AM

To: Property Development <Property.Development@endeavourenergy.com.au>

Cc: Jason Maslen <Jason.Maslen@planning.nsw.gov.au>

Subject: Notice of Exhibition - Carlingford West Public School Upgrades (SSD-10879802) - Endeavour Energy



Planning,
Industry &
Environment

Attention: Mr Cornelis Duba
Development Application Specialist
Endeavour Energy

-via email-

property.development@endeavourenergy.com.au

Dear Mr Duba

The Department of Planning, Industry and Environment has received an Environmental Impact Statement (EIS) for the Carlingford West Public School Upgrades (SSD-10879802).

The EIS will be publicly exhibited from **Wednesday 30 June 2021** to **Tuesday 27 July 2021**. All relevant documents may be viewed on the Department's website at:

<https://www.planningportal.nsw.gov.au/major-projects/projects/on-exhibition>.

The Department invites you to advise on the proposal, including advice on recommended conditions by **Tuesday 27 July 2021**.

If you have any enquiries, please contact Jason Maslen on (02) 8275 1317 or via email at

jason.maslen@planning.nsw.gov.au.

Kind regards

Erin White

DA Coordinator, Social & Infrastructure Assessments

Infrastructure Assessments | Department of Planning, Industry and Environment

T 02 8275 1183 |

4 Parramatta Square, 12 Darcy Street, Parramatta

www.dpie.nsw.gov.au



Planning,
Industry &
Environment

The Department of Planning, Industry and Environment acknowledges that it stands on Aboriginal land. We acknowledge the traditional custodians of the land and we show our respect for elders past, present and emerging through thoughtful and collaborative approaches to our work, seeking to demonstrate our ongoing commitment to providing places in which Aboriginal people are included socially, culturally and economically.