

The Secretary
NSW Department of Planning, Industry and Environment

12 May 2021

ATTENTION: Nathan Stringer

Dear Sir or Madam

I refer to the Department's below email of 6 May 2021 regarding the request for State Significant Development SSD-8865-Mod-1 St Anthony of Padua Catholic School Redevelopment for proposed amendments to project staging, site layout, the composition of outdoor and indoor recreational facilities, building bulk and scale including a reduction in total gross floor area, and minor changes to drop-off / pick-up area at 125-165 Tenth Avenue and 140-170 Eleventh Avenue, Austral (Lots 810, 811, 812, 840, 841, 842 DP 2475; Lots 1 & 2 DP 1232692). Submissions need to be made to the Department by 24 May 2021.

Please refer to Endeavour Energy's submission made to the Department via email on 10 February 2020 in relation to State Significant Development Application (SSD 8865) - Redevelopment of St Anthony of Padua School at 125-165 Tenth Avenue and 140-170 Eleventh Avenue, Austral (Lots 810, 811, 812, 840, 841, 842 DP 2475; Lots 1 & 2 DP 1232692). Endeavour Energy has noted from the Section 4.55(2) Modification Report the proposed amendments do not appear to have a direct or significant impact on the existing or required electricity infrastructure. Notwithstanding the proposed amendments the recommendations and comments provided therein essentially remain valid.

Subject to the foregoing and the following further recommendations and comments Endeavour Energy has no objection to the Development Application.

- Network Capacity / Connection

The applicant will need to contact Endeavour Energy's Network Connections Branch (via Head Office enquiries on business days from 9am - 4:30pm on telephone: 133 718 or (02) 9853 6666) who is responsible for managing the conditions of supply with the proponent and their Accredited Service Provider (ASP). However the applicant will need to contact Endeavour Energy's Network Connections if this Development Application:

- Includes any contestable works projects that are outside of any existing approved / certified works.
- Results in an electricity load that is outside of any existing Supply / Connection Offer requiring the incorporation of the additional load for consideration. This is due to load being based on a desktop assessment. Depending on the actual development proposed for the site, the load provided may not be sufficient.

Should you wish to discuss this matter, or have any questions, please do not hesitate to contact me or the contacts identified above or in Endeavour Energy's previous submission in relation to the various matters. Due to the high number of development application / planning proposal notifications submitted to Endeavour Energy, to ensure a response contact by email to property.development@endeavourenergy.com.au is preferred.

With the easing of the current COVID-19 health risk, whilst a significant number of Endeavour Energy staff are returning to the office they are at times still working from home. Although working from home, access to emails and other internal stakeholders can still be somewhat limited and as a result it may take longer than usual to respond to enquiries. Thank you for your ongoing understanding during this time.

Yours faithfully

Cornelis Duba

Development Application Specialist

Network Environment & Assessment

M: 0455 250 981

E: cornelis.duba@endeavourenergy.com.au

51 Huntingwood Drive, Huntingwood NSW 2148

www.endeavourenergy.com.au



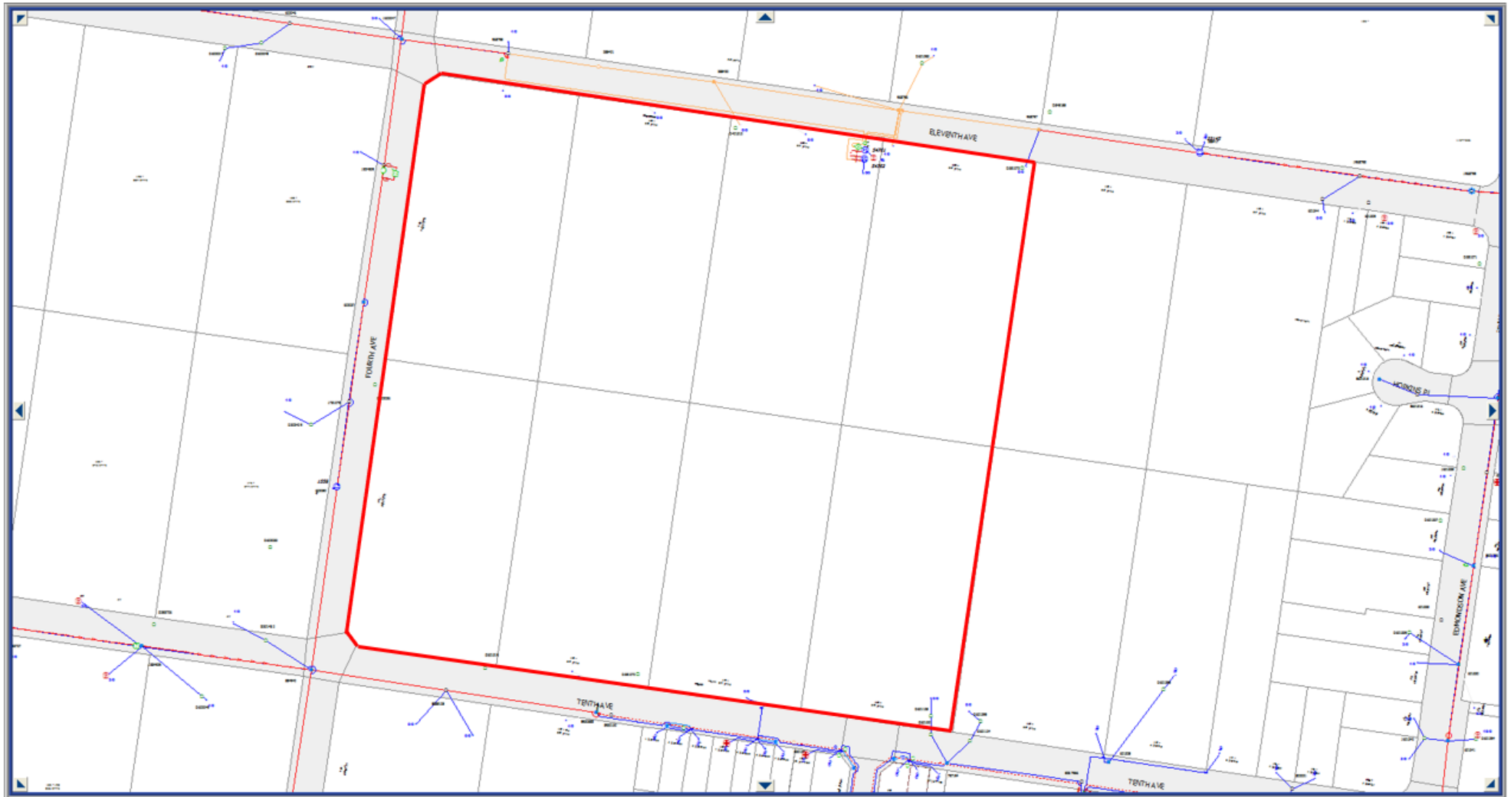

Please note the location, extent and type of any electricity infrastructure, boundaries etc. shown on the plan is indicative only. In addition it must be recognised that the electricity network is constantly extended, augmented and modified and there is a delay from the completion and commissioning of these works until their capture in the model. Generally (depending on the scale and/or features selected), low voltage (normally not exceeding 1,000 volts) is indicated by blue lines and high voltage (normally exceeding 1,000 volts but for Endeavour Energy's network not exceeding 132,000 volts / 132 kV) by red lines (these lines can appear as solid or dashed and where there are multiple lines / cables only the higher voltage may be shown). This plan only shows the Endeavour Energy network and does not show electricity infrastructure belonging to other authorities or customers owned electrical equipment beyond the customer connection point / point of supply to the property. This plan is not a 'Dial Before You Dig' plan under the provisions of Part 5E 'Protection of underground electricity power lines' of the Electricity Supply Act 1995 (NSW).

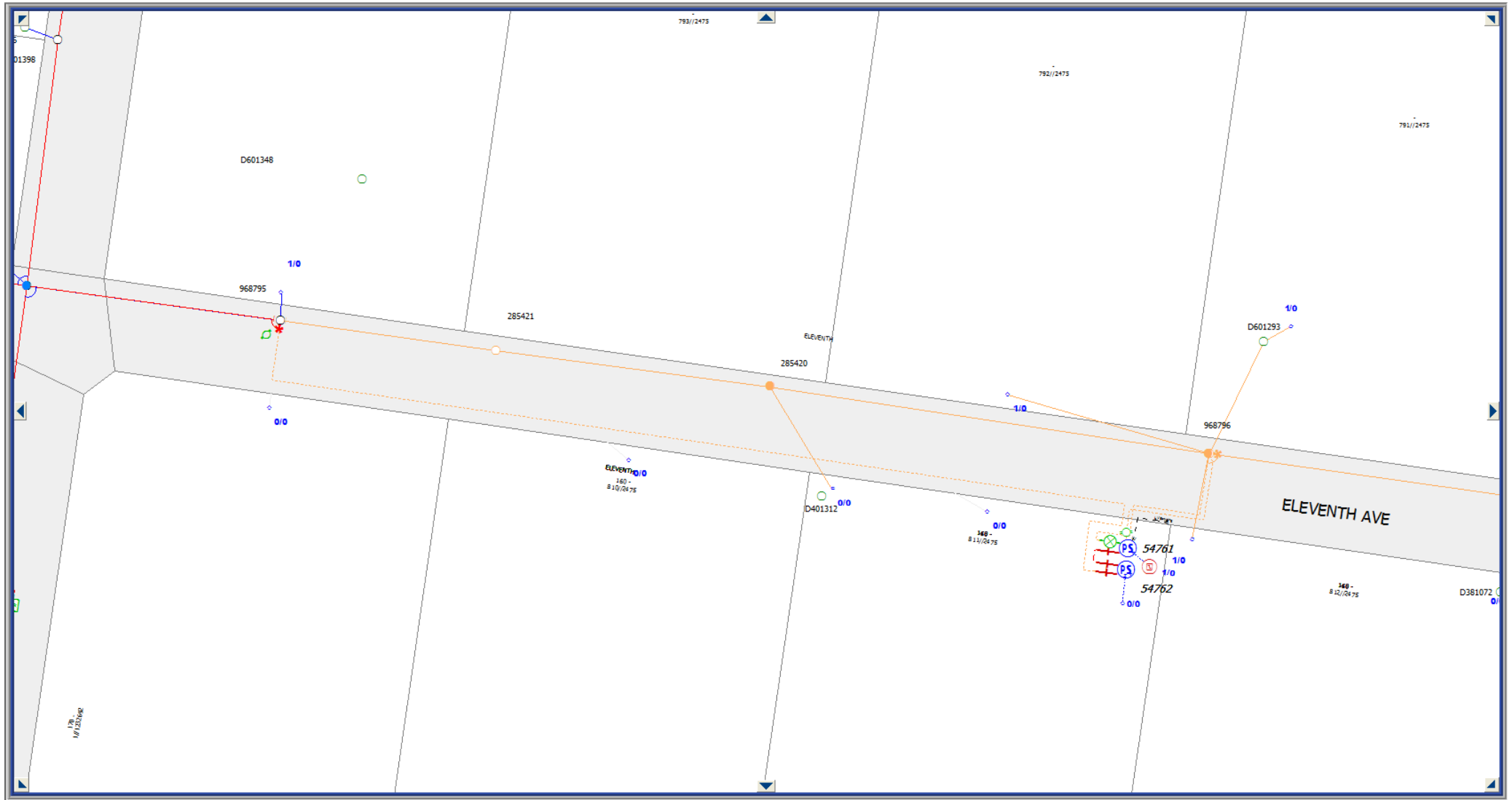

Supply for the St Anthony of Padua Catholic School Redevelopment is provided by the two new padmount substations no.s 54761 and 57762 (indicated by the symbol ) to the Eleventh Avenue road frontage.

From: Erin White <Erin.White@planning.nsw.gov.au> **On Behalf Of** DPE PSVC Social and Other Infrastructure Mailbox
Sent: Thursday, 6 May 2021 3:18 PM
To: Property Development <Property.Development@endeavourenergy.com.au>
Cc: Nathan Stringer <Nathan.Stringer@planning.nsw.gov.au>
Subject: Notice of Exhibition - St Anthony of Padua Catholic School Redevelopment Modification (SSD-8865-Mod-1) - Endeavour Energy



Planning,
Industry &
Environment

Attention: Mr Cornelis Duba
Development Application Specialist
Endeavour Energy

-via email-

property.development@endeavourenergy.com.au

Dear Mr Duba

The Department of Planning, Industry and Environment has received a request to modify the St Anthony of Padua Catholic School Redevelopment – MOD 1 – Amendments to staging, site layout and built form (SSD-8865-Mod-1).

The modification request will be publicly exhibited from **Monday 10 May 2021** to **Monday 24 May 2021**. All relevant documents may be viewed on the Department's website at:
<https://www.planningportal.nsw.gov.au/major-projects/projects/on-exhibition>.

The Department invites you to advise on the request, including advice on recommended conditions by **Monday 24 May 2021**.

If you have any enquiries, please contact Nathan Stringer on (02) 9995 5531 or via email at Nathan.Stringer@planning.nsw.gov.au.

Kind regards

Erin White
DA Coordinator, Social & Infrastructure Assessments

Infrastructure Assessments | Department of Planning, Industry and Environment
4 Parramatta Square, 12 Darcy Street, Parramatta
www.dpie.nsw.gov.au



Planning,
Industry &
Environment



Please consider the environment before printing this e-mail.