

# EIS proposal

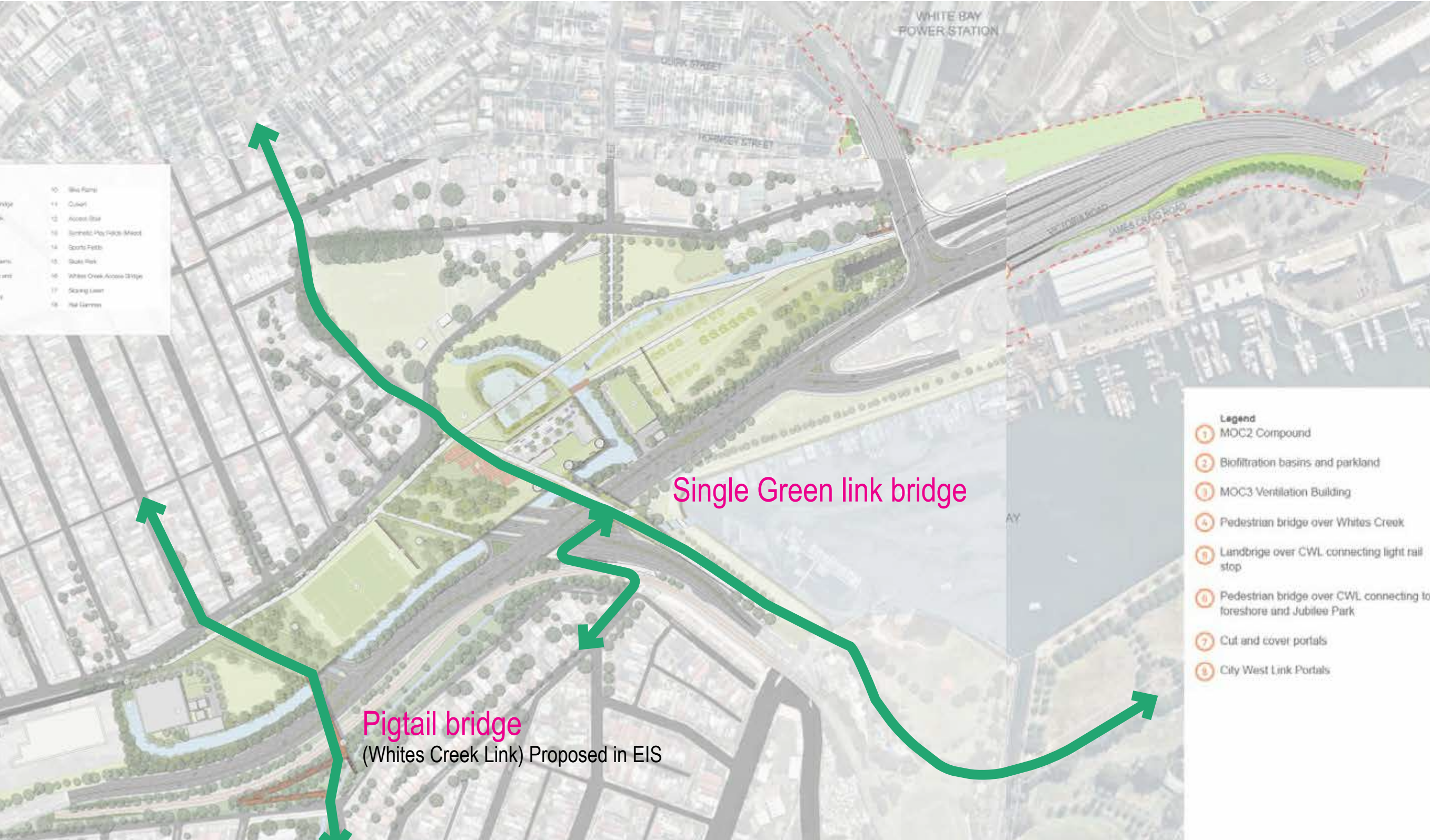

Rozelle Interchange

EIS - north south integration - grade separated pedestrian access



# MOD 2 proposal



Rozelle Interchange

Parkland to parkland – continuous grade separated path



# MOD 2 April 2020 amendment

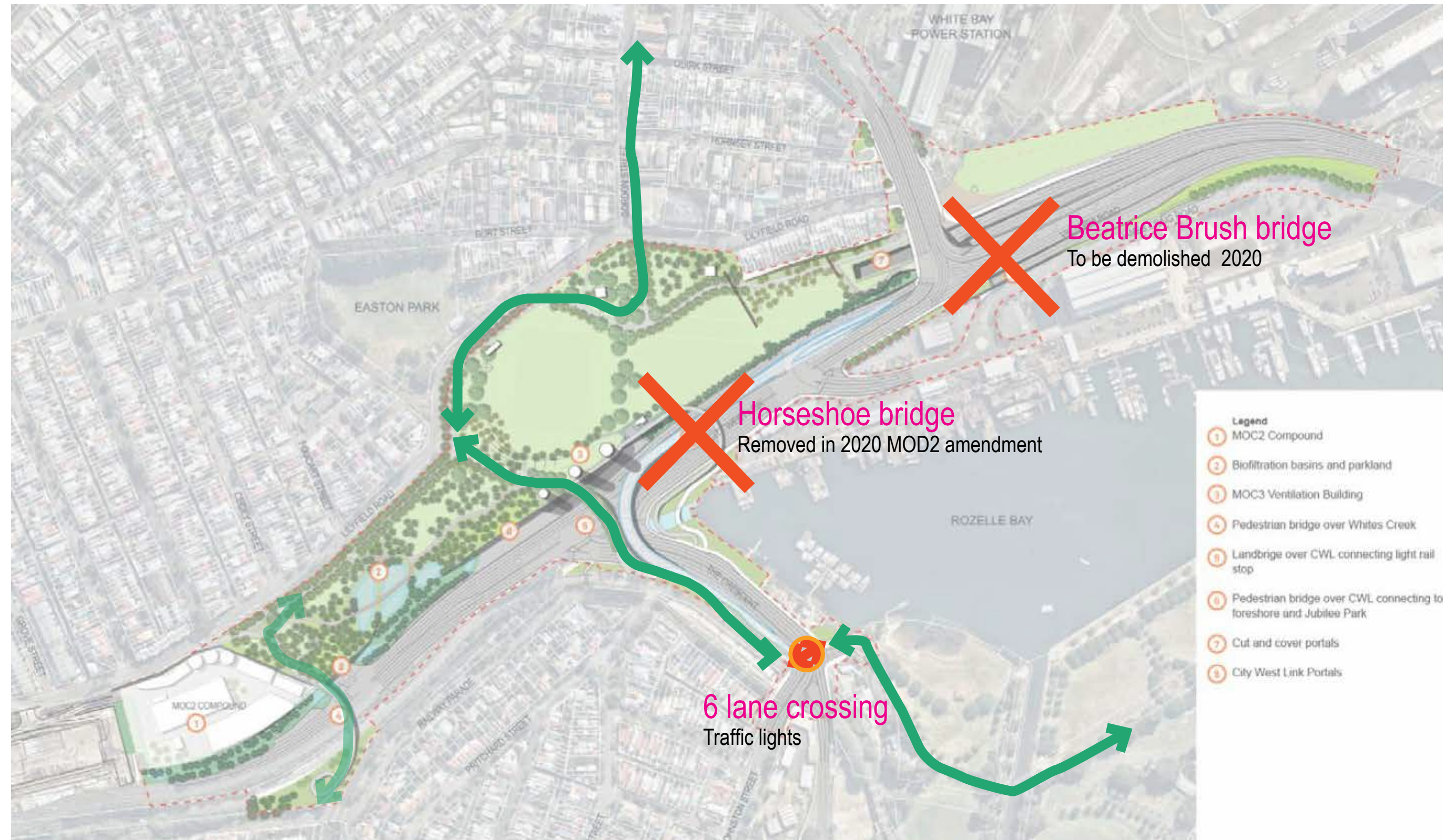

Rozelle Interchange

## Removal of horseshoe bridge removes seamless connection



# Issue

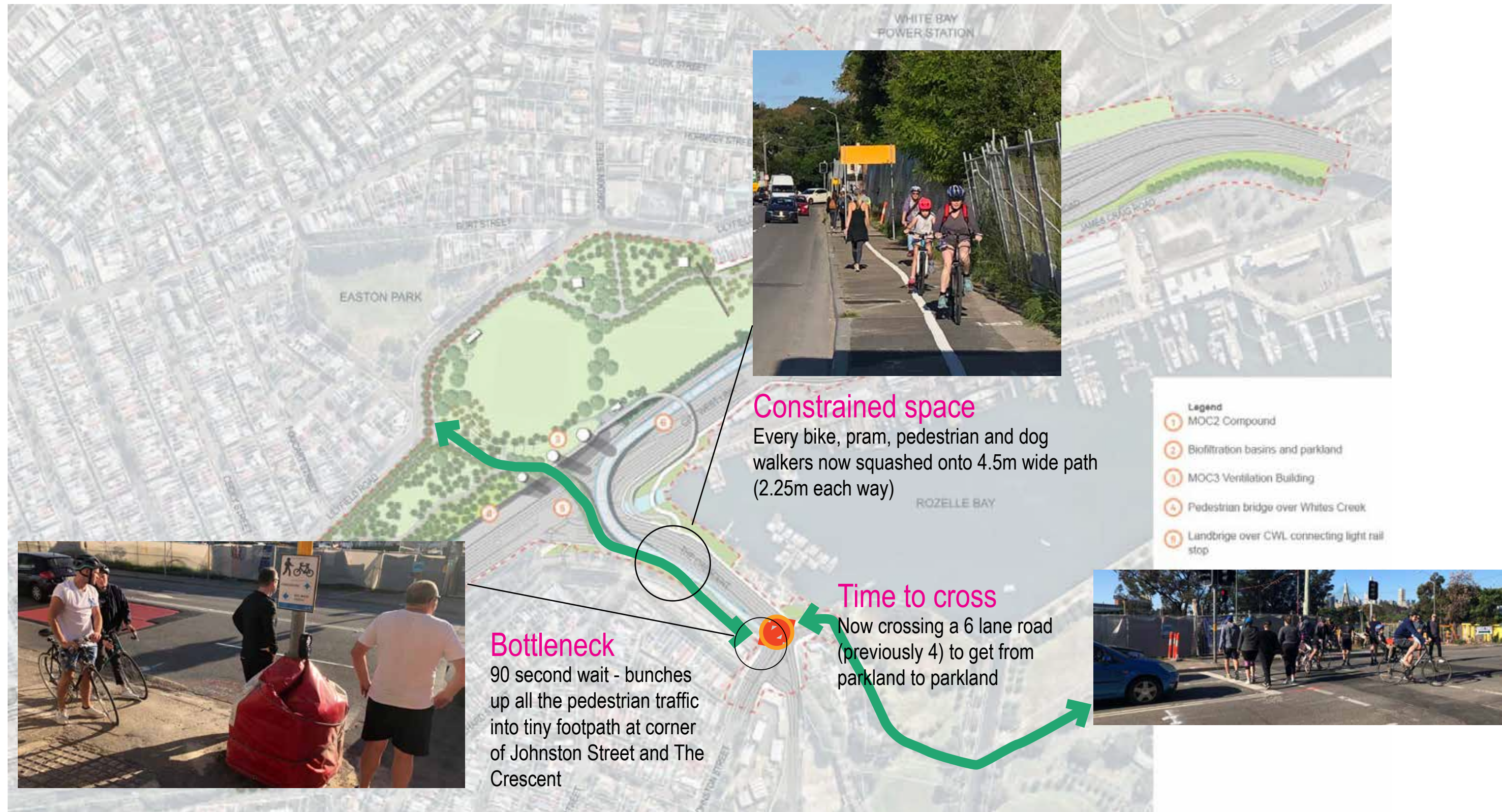

## Rozelle Interchange

# Removal of horseshoe bridge removes seamless connection



# Issue

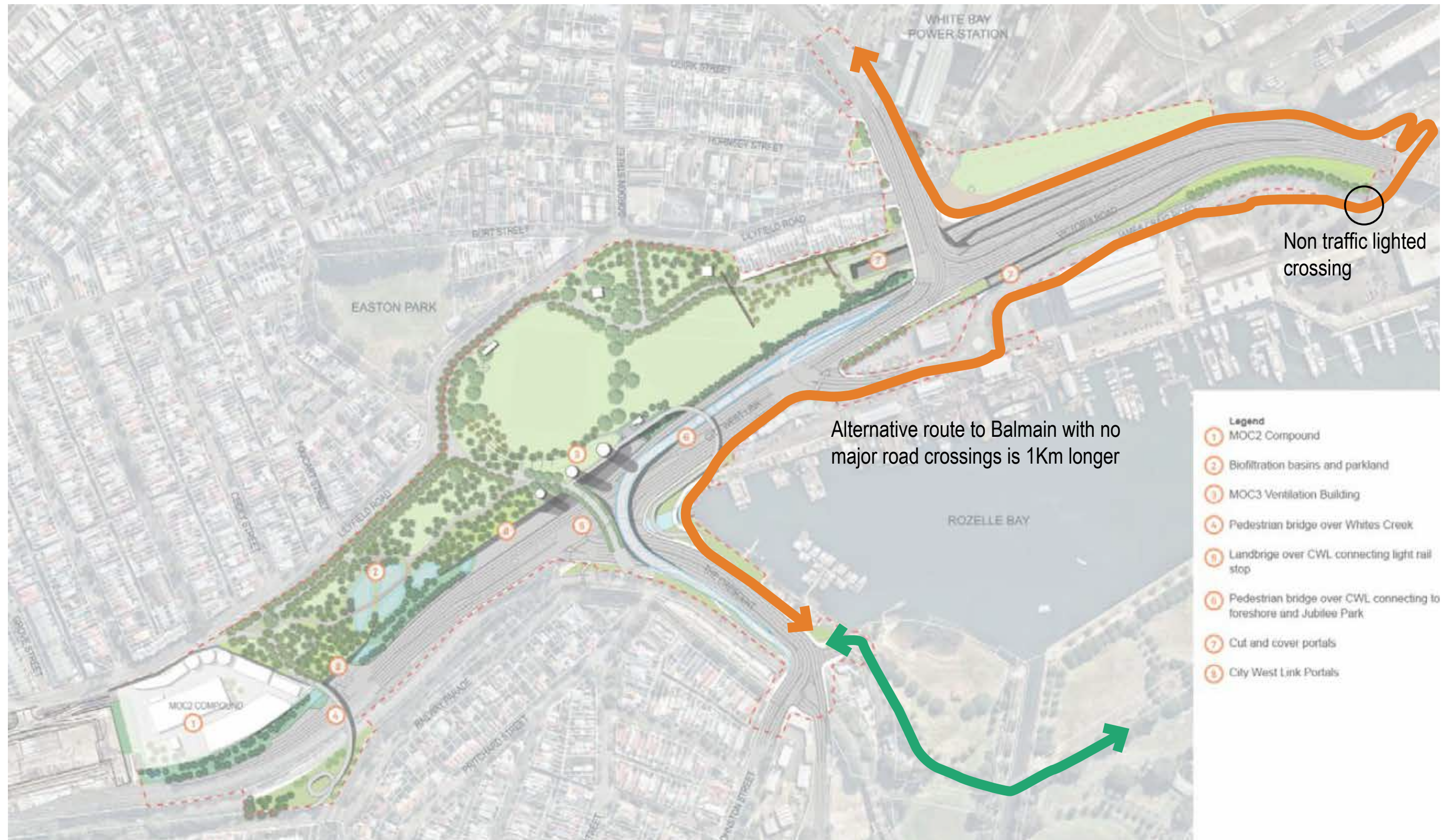

## Rozelle Interchange

# Removal of horseshoe bridge removes seamless connection



# Issue

## Lilyfield residents have cross 3 lights not 1 to Rozelle Bay



### Rozelle Interchange

## Flat creek level pedestrian connectivity still via freeway environment



# Issue

## Lilyfield residents have cross 3 lights not 1 to Rozelle Bay

Slab bridge construction - will there actually be green / vegetation here?

Lilyfield connection

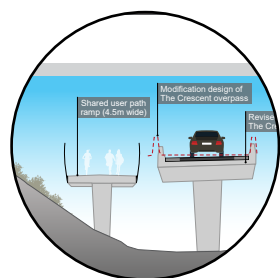
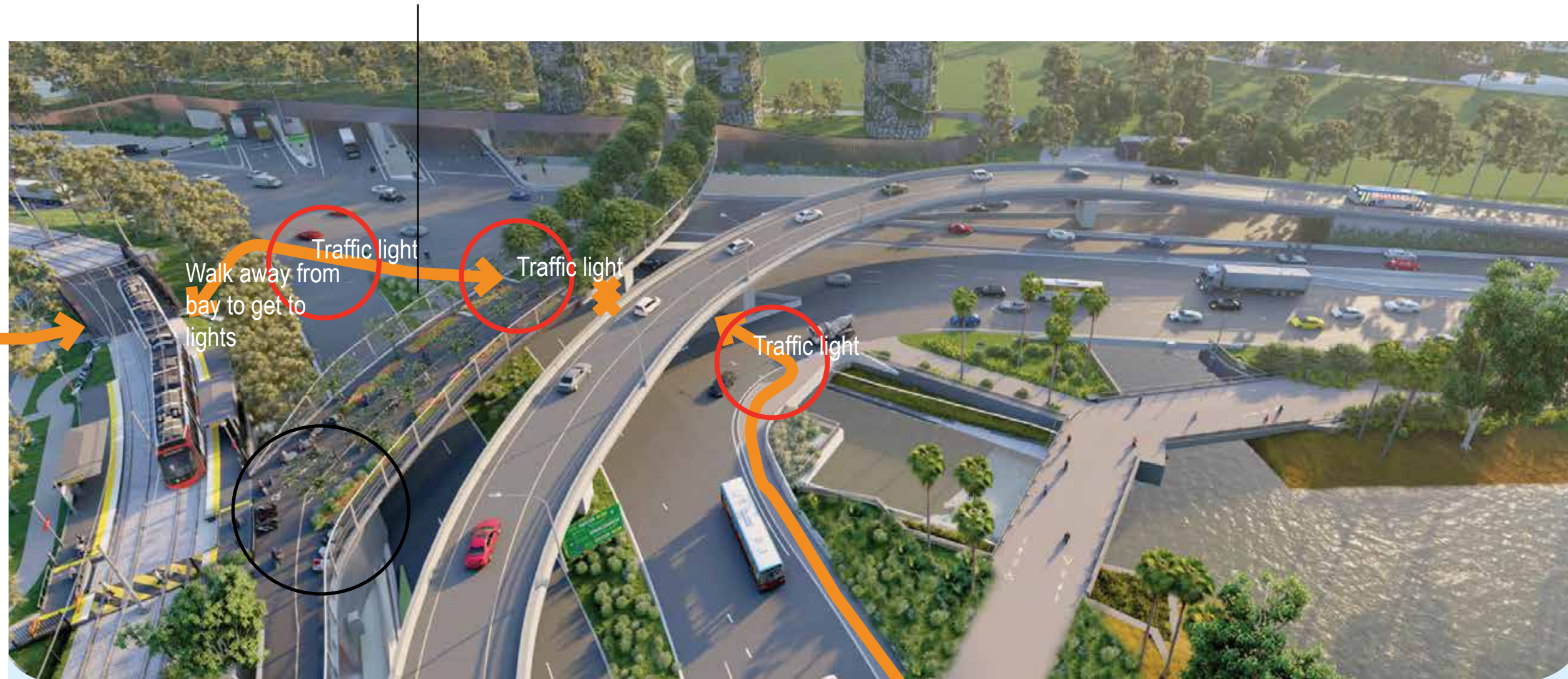

Retaining wall blocks pedestrian path.  
Section 2 and 3 show it as pier and  
headstock construction

Glebe foreshore connection

### Rozelle Interchange

## At grade pedestrian connectivity still via a freeway environment



# SOLUTION

Maintain “Green bridge” as the upper level walkway



Rozelle Interchange

Rozelle to Annandale – light rail connection via green bridge



# SOLUTION

Remove down ramp to retain at grade path to Rozelle Bay



Rozelle Interchange

lilyfield to Glebe – at grade connection with one traffic light



# SOLUTION

## Reinstate Horseshoe bridge as seamless park - park connection

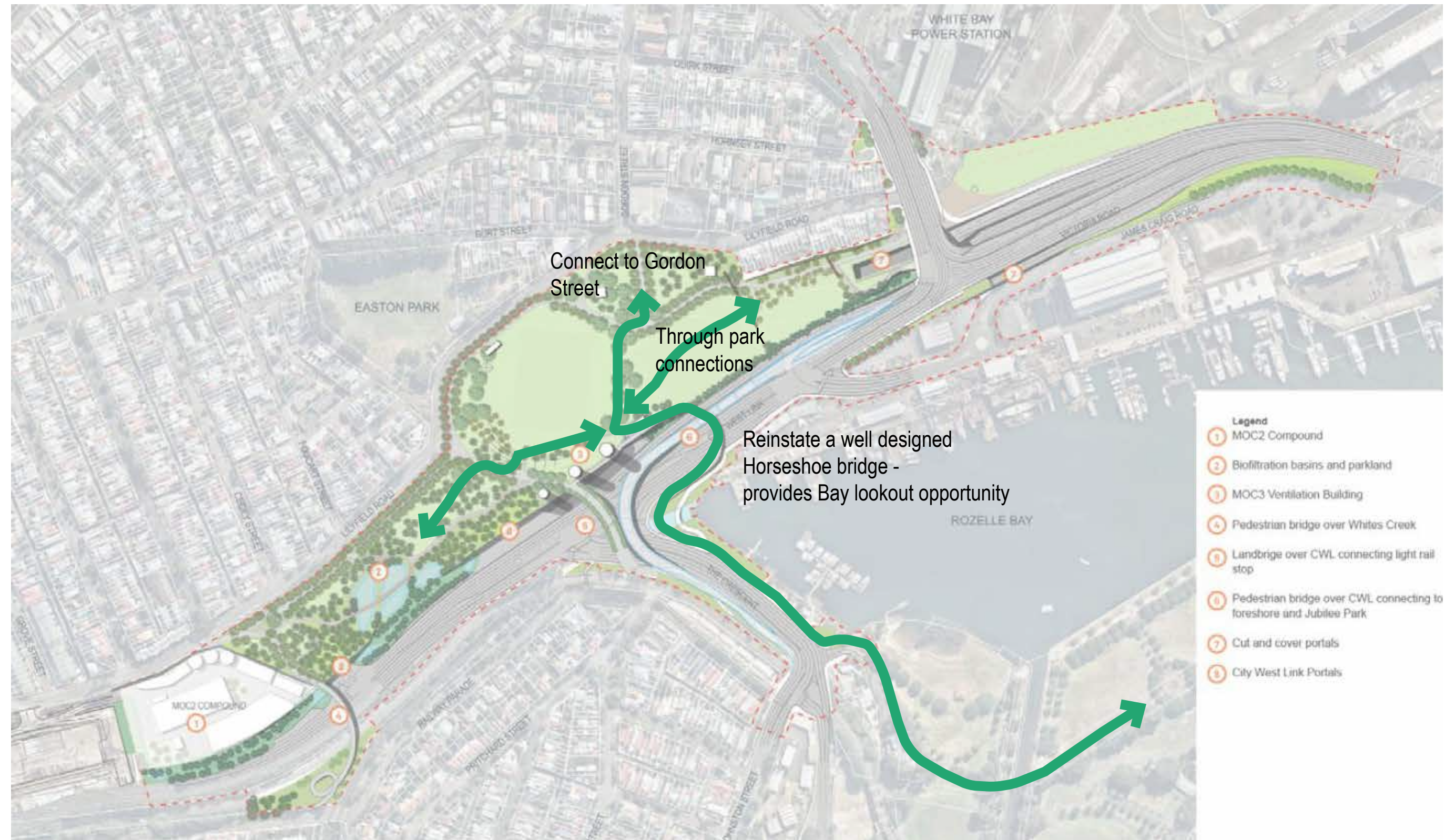

Rozelle Interchange

Parkland to parkland - continuous grade separated path



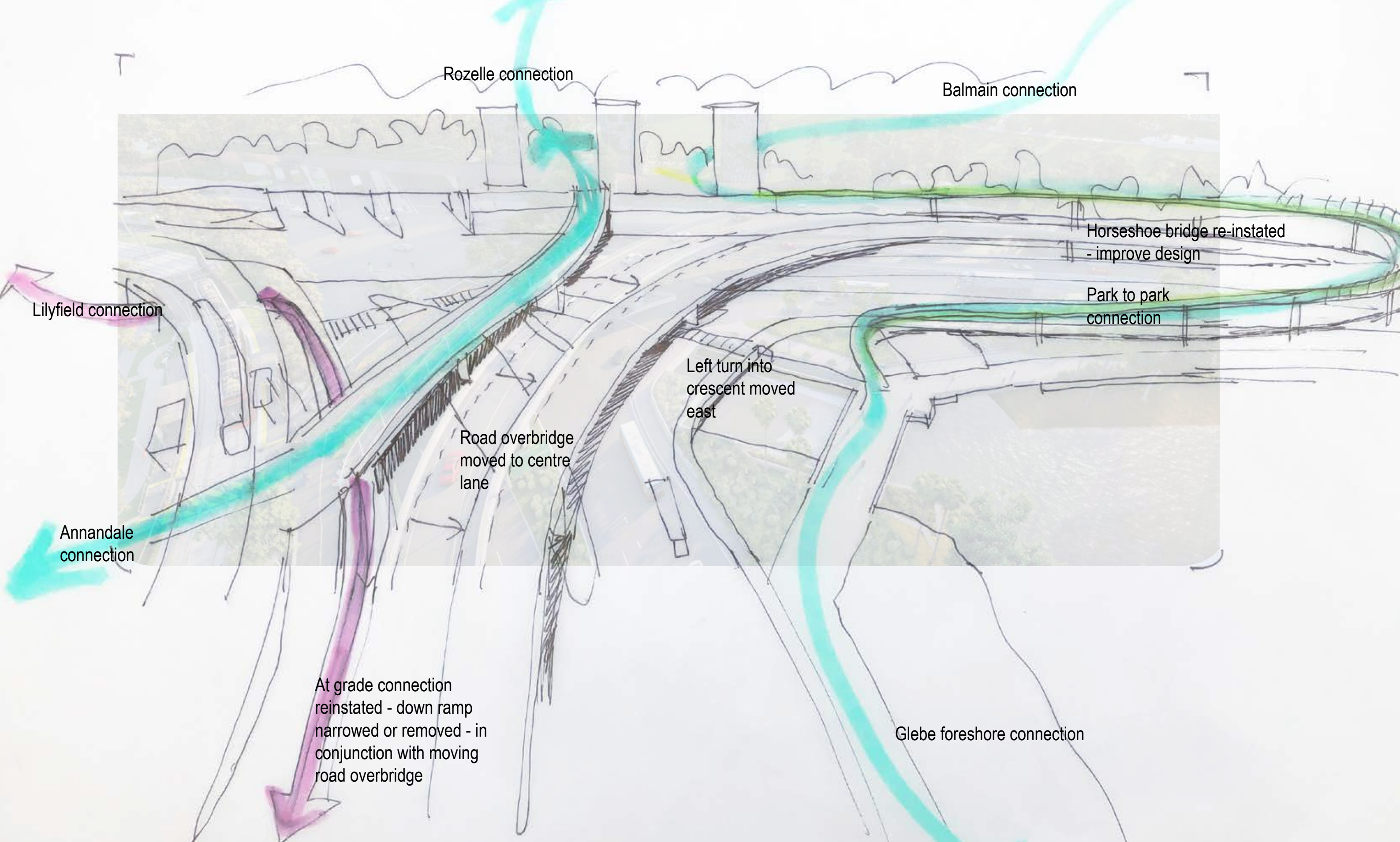

## Rozelle Interchange

# Proposed changes



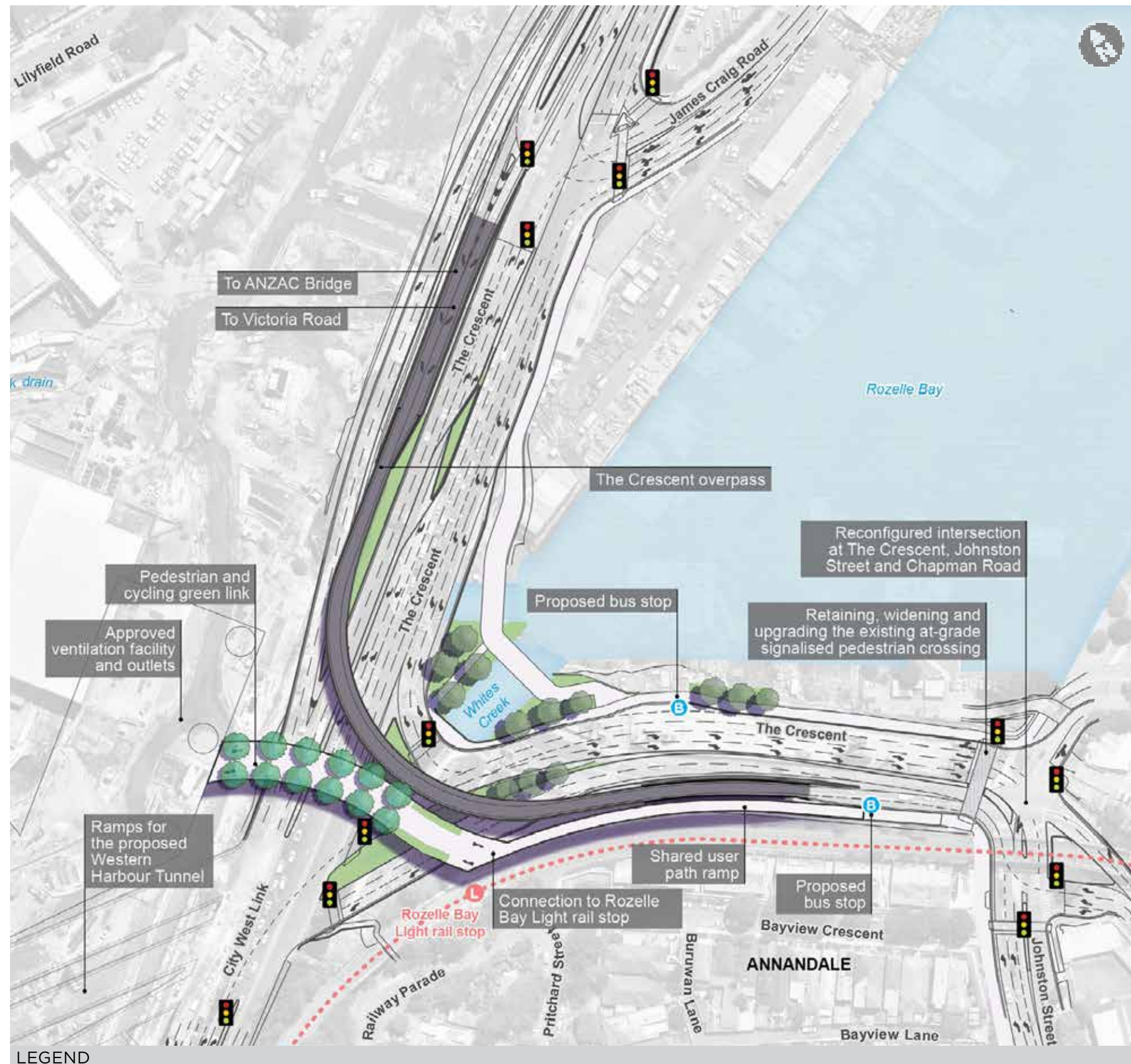

## Rozelle Interchange Amended MOD 2



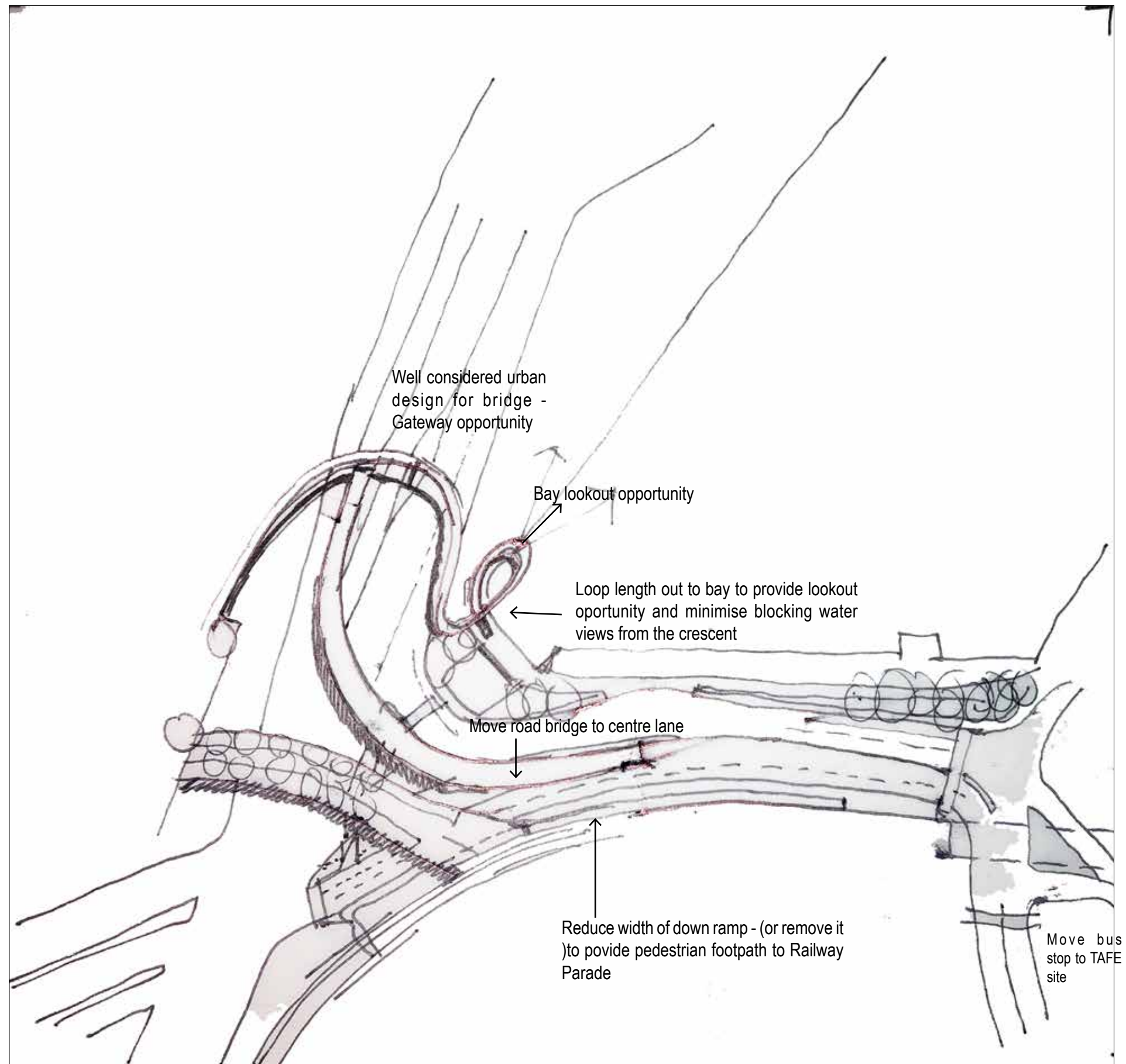

## Rozelle Interchange

# Suggested changes



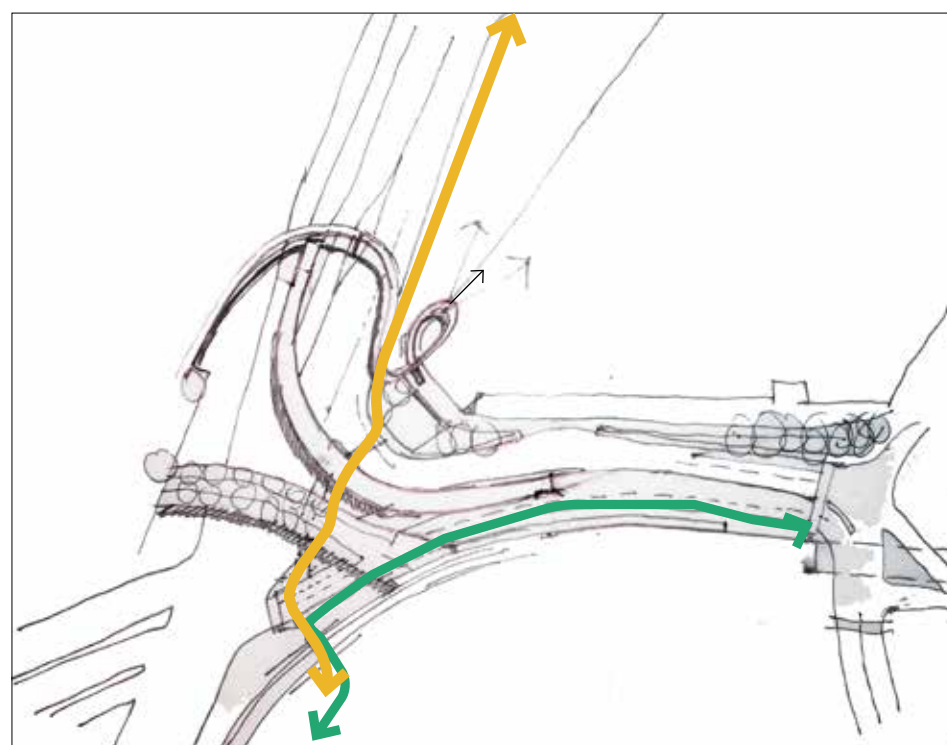

- ↔ Railway parade to Rozelle Bay link
- ↔ Railway parade to Anzac Bridge

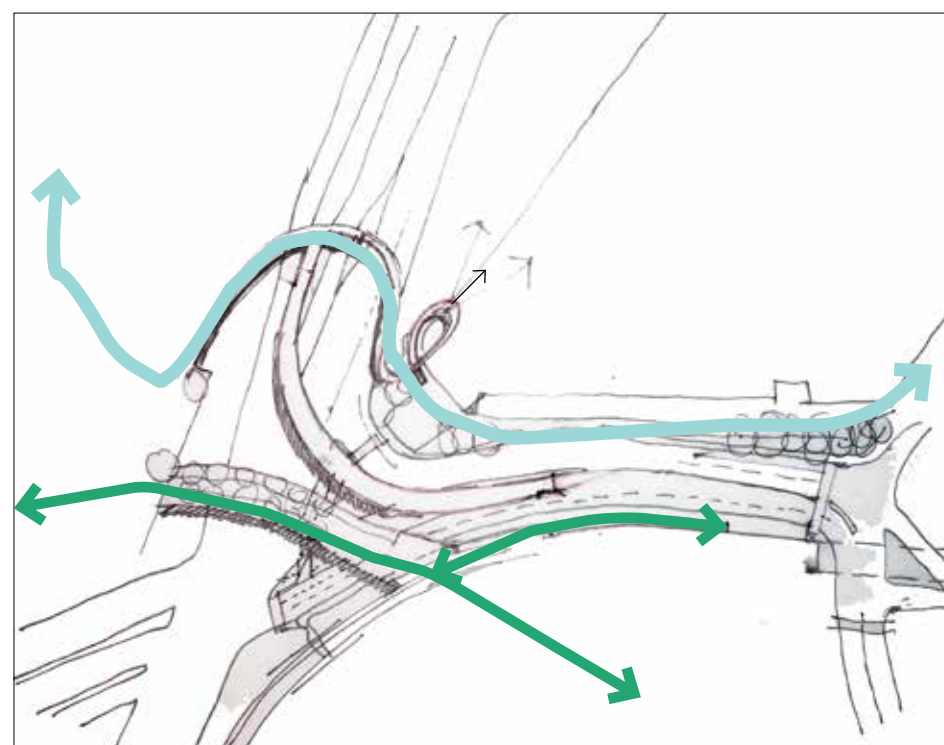

- ↔ Rozelle to Annandale
- ↔ Park to Park  
Balmain / Rozelle to Glebe

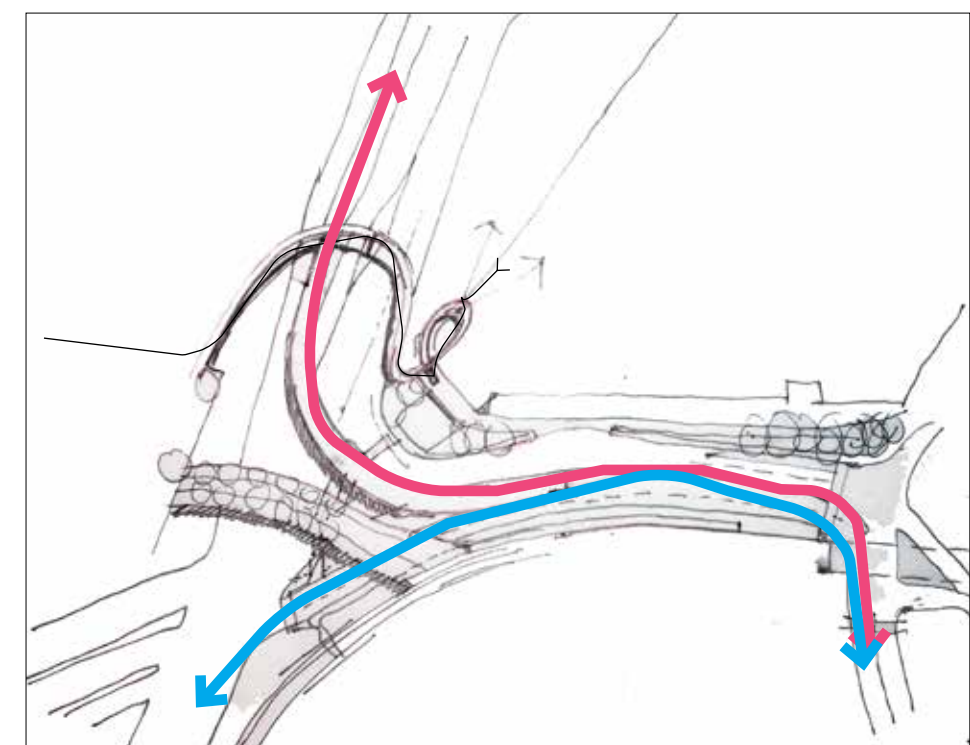

- ↔ Car - Annandale to City / Gladesville
- ↔ Car - Annandale to Haberfield / WHT and WestConnex

## Rozelle Interchange

# Suggested changes



# SOLUTION



**Rozelle Interchange**

**Spot the pedestrian bridge**



# SOLUTION



Rozelle Interchange

**Tiny visual impact**



# SOLUTION

Beatrice Brush Bridge - Rozelle (To be demolished)  
Horseshoe bridge likely to be very similar



Rozelle Interchange

Pedestrian bridges can be well designed



# SOLUTION



**Rozelle Interchange**

**Pedestrian bridges can be well designed**