

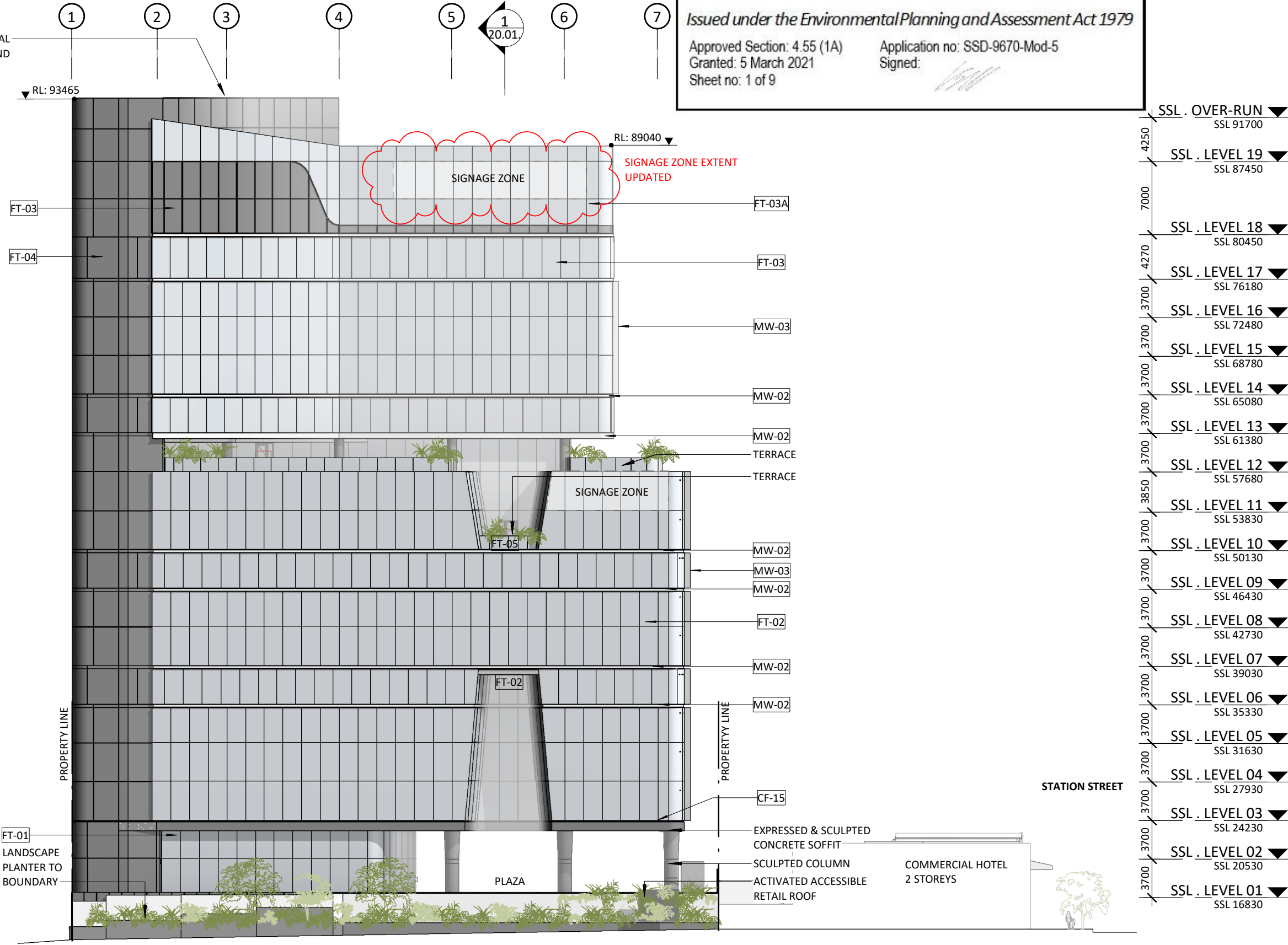

LEGEND			
FT-01	PODIUM GLAZING	CUSTOM VERTICAL ALUMINIUM MULLIONS FROM GROUND TO LEVEL 03. FULL HEIGHT LAMINATED GLASS WITH BLACK HORIZONTAL SILICONE BUTT JOINTS. COLOURLESS LOW IRON GLASS. XIR FILM FOR GLAZING PERFORMANCE TO NORTH FACADE.	
FT-02	TOWER CURTAIN WALL	FULL HEIGHT ALUMINIUM FRAMED UNITIZED CURTAIN WALL GLAZING, STRUCTURAL GLAZED IGU WITH BLACK SPACERS AND BLACK SILICONE BUTT JOINT. VLT: 45-50% REFLECTIVITY: 20% MAX SHGC: 0.20 MIN BACKPAN: CERAMIC FRIT BACK PAN (FT03A TO SPANDREL ONLY) MULLION COLOUR: ANODISED ALUMINIUM - CHARCOAL	
FT-03	PLANT ROOMS CURTAIN WALL	FULL HEIGHT ALUMINIUM FRAMED UNITIZED CURTAIN WALL WITH RIGID MESH PANELS FIXED TO BACK OF MULLIONS. MULLIONS TO BE EXPOSED. MESH PERFORATION SIZE TBC, SUBJECT TO FINAL ENGINEERING DESIGN DEVELOPMENT MULLION COLOUR: ANODISED ALUMINIUM - CHARCOAL	
FT-03A	SPANDREL PANEL CURTAIN WALL	FULL HEIGHT ALUMINIUM FRAMED UNITIZED CURTAIN WALL GLAZING, STRUCTURAL GLAZED IGU WITH BLACK SPACERS AND BLACK SILICONE BUTT JOINT. VLT: 45-50% REFLECTIVITY: 20% MAX SHGC: 0.20 MIN BACKPAN: FULL HEIGHT CERAMIC FRIT BACK PAN MULLION COLOUR: ANODISED ALUMINIUM - CHARCOAL	
FT-04	CONCRETE WALL SYSTEM	PRECAST CONCRETE PANELS AND/OR OFF FORM CONCRETE COLOUR: NEUTRAL GREY AGGREGATE: 'HOLCIM GEOSTONE' REBATES SHOWN ARE INDICATIVE ONLY	
FT-05	FRAMELESS GLASS BALUSTRADE	LOW IRON CLEAR MONOLITHIC FRAMELESS GLASS BALUSTRADE. GENERALLY 1200MM WIDE WITH 20MM CLEAR VERTICLE GAP BETWEEN GLASS PANELS WITH CONTINUOUS STAINLESS STEEL TOP CHANNEL.	
MW-01	CURTAIN WALL HORIZONTAL SUNSHADE (NORTH FACADE)	ALUMINIUM SLEEVE FINS AT STACK JOINTS. FINS TO BE SOLID EXTRUSION TO CUSTOM SHAPE. RECESSED ALUMINIUM CHANNEL INTEGRATED WITHIN CURTAIN WALL.	
MW-02	CURTAIN WALL RECESS (TOWER)	CURTAIN WALL HORIZONTAL RECESS AT SLAB EDGE. RECESSED ALUMINIUM CHANNEL INTEGRATED WITHIN CURTAIN WALL.	
MW-03	CURTAIN WALL VERTICAL SUNSHADE (WEST FACADE)	ALUMINIUM SLEEVE FINS AT STACK JOINTS. FINS TO BE SOLID EXTRUSION TO CUSTOM SHAPE. RECESSED ALUMINIUM CHANNEL INTEGRATED WITHIN CURTAIN WALL.	



1 NORTH ELEVATION
10.01. 1 : 400

LEGEND

- FT-01

PODIUM GLAZING
CUSTOM VERTICAL ALUMINIUM MULLIONS FROM GROUND TO LEVEL 03. FULL HEIGHT LAMINATED GLASS WITH BLACK HORIZONTAL SILICONE BUTT JOINTS. COLOURLESS LOW IRON GLASS. XIR FILM FOR GLAZING PERFORMANCE TO NORTH FACADE.
- FT-02

TOWER CURTAIN WALL
FULL HEIGHT ALUMINIUM FRAMED UNITIZED CURTAIN WALL GLAZING, STRUCTURAL GLAZED IGU WITH BLACK SPACERS AND BLACK SILICON BUTT JOINT.
VLT: 45-50%
REFLECTIVITY: 20% MAX
SHGC: 0.20 MIN
BACKPAN: CERAMIC FRIT BACK PAN (FT03A TO SPANDREL ONLY)
MULLION COLOUR: ANODISED ALUMINIUM - CHARCOAL
- FT-03

PLANT ROOMS CURTAIN WALL
FULL HEIGHT ALUMINIUM FRAMED UNITIZED CURTAIN WALL WITH RIGID MESH PANELS FIXED TO BACK OF MULLIONS. MULLIONS TO BE EXPOSED. MESH PERFORATION SIZE TBC, SUBJECT TO FINAL ENGINEERING DESIGN DEVELOPMENT
MULLION COLOUR: ANODISED ALUMINIUM - CHARCOAL
- FT-03A

SPANDREL PANEL CURTAIN WALL
FULL HEIGHT ALUMINIUM FRAMED UNITIZED CURTAIN WALL GLAZING, STRUCTURAL GLAZED IGU WITH BLACK SPACERS AND BLACK SILICON BUTT JOINT.
VLT: 45-50%
REFLECTIVITY: 20% MAX
SHGC: 0.20 MIN
BACKPAN: FULL HEIGHT CERAMIC FRIT BACK PAN
MULLION COLOUR: ANODISED ALUMINIUM - CHARCOAL
- FT-04

CONCRETE WALL SYSTEM
PRECAST CONCRETE PANELS AND/OR OFF FORM CONCRETE
COLOUR: NEUTRAL GREY
AGGREGATE: 'HOLCIM GEOSTONE'
REBATES SHOWN ARE INDICATIVE ONLY
- FT-05

FRAMELESS GLASS BALUSTRADE
LOW IRON CLEAR MONOLITHIC FRAMELESS GLASS BALUSTRADE. GENERALLY 1200MM WIDE WITH 20MM CLEAR VERTICLE GAP BETWEEN GLASS PANELS WITH CONTINUOUS STAINLESS STEEL TOP CHANNEL.
- MW-01

CURTAIN WALL HORIZONTAL SUNSHADE (NORTH FACADE)
ALUMINIUM SLEEVE FINS AT STACK JOINTS. FINS TO BE SOLID EXTRUSION TO CUSTOM SHAPE.
RECESSED ALUMINIUM CHANNEL INTEGRATED WITHIN CURTAIN WALL.
- MW-02

CURTAIN WALL RECESS (TOWER)
CURTAIN WALL HORIZONTAL RECESS AT SLAB EDGE.
RECESSED ALUMINIUM CHANNEL INTEGRATED WITHIN CURTAIN WALL.
- MW-03

CURTAIN WALL VERTICAL SUNSHADE (WEST FACADE)
ALUMINIUM SLEEVE FINS AT STACK JOINTS. FINS TO BE SOLID EXTRUSION TO CUSTOM SHAPE.
RECESSED ALUMINIUM CHANNEL INTEGRATED WITHIN CURTAIN WALL.

CONCRETE ENCLOSURE
TO CONCEAL COOLING
TOWERS BEHIND

VERTICAL SUNSHADING

TERRACE

VERTICAL SUNSHADING
(MW03)

BRACING BEHIND GLAZING
SHOWN DASHED

EXISTING COMMERCIAL
HOTEL

SIGNAGE ZONE

RL: 93650

FT-04

FT-03A

SIGNAGE ZONE
LOCATION UPDATED

FT-03

MW-02

MW-02

MW-03

MW-02

MW-02

FT-05

SIGNAGE ZONE

HORIZONTAL
MECHANICAL LOUVRES

MW-02

MW-03

FT-02

MW-02

MW-02

EXPRESSED & SCULPTED
CONCRETE SOFFIT

MW-02

SCULPTED COLUMN

FT-01

HASSALL STREET

ECLIPSE TOWER
22 STOREYS

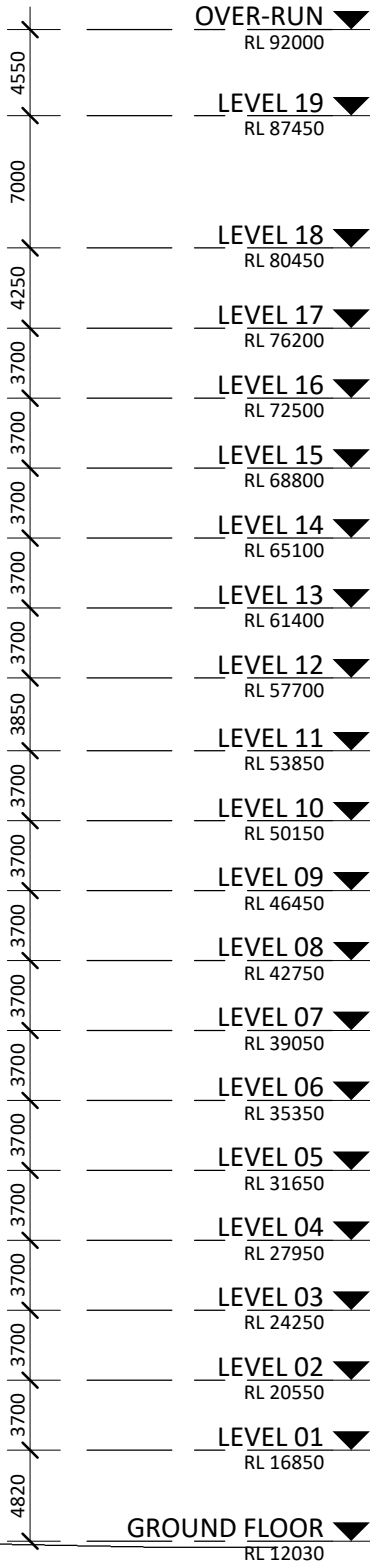

Rev	Description	Consultant	Date	Issued by
L	RtS Submission	BRT	09.08.19	MD
M	Mod2 Submission	BRT	24.03.19	JM
N	Mod3 Submission	BRT	24.06.20	MD
O	Mod5 Submission	BRT	10.12.20	MD

LEGEND

NOTE: REFER TO 6HS-BRT-A10.01 & 6HS-BRT-A10.02 FOR ALL HARDWORKS



GENERAL

- EXTENT OF WORK BOUNDARY | GROUND FLOOR LEVEL
- EXTENT OF WORK BOUNDARY | LEVEL 1
- EXTENT OF WORK BOUNDARY | LEVEL 10
- EXTENT OF WORK BOUNDARY | LEVEL 12
- PROPERTY BOUNDARY (BY ARCHITECT)

MATERIALS & FINISHES - PAVEMENTS

REFER TO CIVIL ENGINEER'S DOCUMENTATION FOR ALL SUB BASE DETAILS

- PV1 PAVING TYPE 1 | CoP PAVER ON SLAB
REFER TO LANDSCAPE SELECTIONS SCHEDULE
REFER TO CIVIL ENGINEER'S DOCUMENTATION FOR ALL SUB BASE DETAILS
- PV2 PAVING TYPE 2 | CoP PAVER ON SLAB
REFER TO LANDSCAPE SELECTIONS SCHEDULE
REFER TO CIVIL ENGINEER'S DOCUMENTATION FOR ALL SUB BASE DETAILS
- PV3 PAVING TYPE 3 | GRANITE STONE ON SLAB
REFER TO ARCHITECT'S DOCUMENTATION
REFER TO CIVIL ENGINEER'S DOCUMENTATION FOR ALL SUB BASE DETAILS
- PV4 PAVING TYPE 4 | COBBLESTONE ON SLAB
REFER TO ARCHITECT'S DOCUMENTATION

MATERIALS & FINISHES - SOFTWARES

- EXISTING TREE TO BE REMOVED
- PROPOSED STREET TREE PLANTING
- SS STRUCTURAL SOIL TO STREET TREE PLANTING
REFER TO LANDSCAPE SPECIFICATION

FURNITURE & FIXTURES

REFER TO CIVIL ENGINEER'S DOCUMENTATION FOR ALL SUB BASE DETAILS

- EX.LP EXISTING LIGHT POLE RETAINED
REFER TO ELECTRICAL ENGINEER
- TI TACTILE INDICATORS
REFER TO LANDSCAPE SELECTIONS SCHEDULE
- TG1 TREE GRATE TYPE 1 | CoP TREE GRATE
REFER TO LANDSCAPE SELECTIONS SCHEDULE
- BR CoP BIKE RACKS
REFER TO LANDSCAPE SELECTIONS SCHEDULE
- BO2 CoP BOLLARDS | REMOVABLE
REFER TO LANDSCAPE SELECTIONS SCHEDULE
- BE CoP SEAT
REFER TO LANDSCAPE SELECTIONS SCHEDULE

LEVELS & GRADING

REFER TO CIVIL ENGINEER'S DOCUMENTATION FOR DETAILS

- PROPOSED LANDSCAPE LEVEL
- EXISTING LEVEL
REFER TO ENGINEER'S DRAWINGS - TO BE CONFIRMED ON SITE
- FINISHED FLOOR LEVEL
REFER TO ARCHITECTS DRAWINGS
- PROPOSED GRADE
REFER TO ENGINEER'S DRAWINGS - TO BE CONFIRMED ON SITE

CIVIL & EXISTING SERVICES

REFER TO CIVIL ENGINEER'S DOCUMENTATION FOR DETAILS

- PIT EXISTING PIT COVER
REFER TO ENGINEER'S DOCUMENTATION FOR DETAILS
- POST EXISTING SIGN POST
REFER TO ENGINEER'S DOCUMENTATION FOR DETAILS
- EJ EXPANSION JOINT
REFER TO ENGINEER'S DOCUMENTATION FOR DETAILS



Planning,
Industry &
Environment

Issued under the Environmental Planning and Assessment Act 1979

Approved Section: 4.55(1A) Application No: SSD-9670-Mod-5
Granted: 5 March 2021 Signed:
Sheet no: 3 of 9

WARNING



Services shown on this drawing are approximate only.
The exact location is to be confirmed on site by
contractor prior to commencement of work.

These coloured drawings shall be read in digital format or colour hardcopy.
These drawings shall be read in conjunction with all relevant information (not limited to
legends, schedules, specifications).

These drawings shall be read in conjunction with any Engineers, Architects or other
consultant information (not limited to drawings, legends, schedules, specifications).
Check all dimensions and site conditions prior to commencement of any work or
procurement or fabrication of any services, materials, fittings or equipment.
Not be reproduced or distributed without prior permission of the Landscape Architect.

NOTES / KEY PLAN

DATE REV AMENDMENTS

5/17/19	A	ISSUED FOR CONSULTANTS REVIEW - DRAFT TENDER
5/27/19	B	ISSUED FOR 100% TENDER
6/6/19	C	ISSUED FOR 100% TENDER - UPDATED
30/7/19	D	ISSUED FOR 100% TENDER
8/28/20	E	ISSUED FOR SSDA MOD 4

CONSULTANTS

ARCHITECTS 2 Foveaux St Sunny Hills, NSW 2010 T 02 9319 3744	ENGINEERS L11/151 Castlereagh St Sydney, NSW 2000 T 02 846 3000
ARCHITECTS L2081 Creek St Brisbane, QLD 4000 T 07 3855 6500	ENGINEERS 485 Victoria Ave Cherrywood, NSW 2087 T 02 9415 4100
PROJECT MANAGER L1443 Martin Place Sydney, NSW 2000 T 0412 925 650	CERTIFIER L17/456 Kent St Sydney, NSW 2000 T 02 9283 6555

ASPECT Studios

ASPECT Studios Pty Ltd
Level 1, 78-80 George Street
Redfern NSW 2016
Australia
T 02 9699 7182
www.aspect-studios.com
sydney@aspect-studios.com
ABN 11 120 219 551

PROJECT
HASSALL STREET PARRAMATTA
2B - 6 Hassall Street Parramatta, NSW 2150

CLIENT



NORTH
SCALE A1 | SCALE A3
VARIES AS SHOWN



Do not scale - use dimensions & callouts on drawings & schedules.
Refer discrepancies to Landscape Architect for clarification.

STATUS
Project Phase
SSDA

NOT FOR CONSTRUCTION

DRAWING
LEGEND

DRAWING NO.

6HS-ASP-L01.02 E

REVISION

EW LEVEL 1

EW GROUND LEVEL

REFER TO ARCHITECTURAL
DOCUMENTATION FOR
INTERIOR LAYOUT

Plant List					
ID	QTY	BOTANICAL NAME	COMMON NAME	EXOTIC/NATIVE	POT SIZE (MM)
TREES					
Fa	5	Flindersea australis	Australian Teak	Native	400L
GROUND FLOOR PLANTING					
Ao	9	Alcantarea odorata	Fragrant Alcantarea	Exotic	300
Ac	53	Alpinia caerulea	Native Ginger	Native	200
Cg	42	Carpobrotus glaucescens	Pig's Face	Native	200
Cr	37	Cordyline 'Rubra'	Palm Lily	Native	200
Ds	59	Dichondra 'Silver Falls'	Silver Falls	Native	300
Hv	57	Hardenbergia violacea	Purple Coral Pea	Native	200
Sa	17	Scaevola aemula	Fairy Fan-flower	Native	200
Se	21	Sedum 'Autumn Joy'	Autumn Stonecrop	Exotic	200
Tj	79	Trachelium jasmynoides	Star Jasmine	Exotic	200
LEVEL 1 PLANTING					
Aw	62	Acacia cognata 'Waterfall'	River Wattle	Native	500
Co	64	Cordyline australis	Cabbage Palm	Exotic	300
Cr	76	Cordyline 'Rubra'	Palm Lily	Native	300
Dc	29	Dianella 'Cassa Blue'	Flax Lily	Native	200
De	31	Dianella 'Emerald Arch'	Flax Lily	Native	200
Do	74	Dorotheanthus bellidiformis 'Mezoo Trailing Red'	Mezoo Trailing Red	Exotic	200
Hs	39	Hardenbergia 'Snow White'	White Happy Wanderer	Native	200
Hg	38	Helmholtzia glaberrima	Stream Lily	Native	200
Hy	21	Hymenocallis 'Gold Nugget'	Dwarf Native Frigipani	Native	200
Mp	20	Myoporum parvifolium 'Yareena'	Yareenda	Native	200
Px	62	Philodendron 'Xanadu'	Xanadu	Exotic	200
Sj	53	Sedum 'Autumn Joy'	Autumn Stonecrop	Exotic	200
Sm	49	Sedum morganianum	Donkey's Tail	Exotic	200
Tj	56	Trachelium jasmynoides	Star Jasmine	Exotic	200
Ws	30	Westringia 'Smokey'	Coastal Rosemary	Native	300
Wm	17	Westringia 'Mundi'	Mundi	Native	200
Zf	36	Zamia furfuracea	Cardboard Plant	Exotic	200

PROPERTY BOUNDARY



Planning, Industry & Environment
Issued under the Environmental Planning and Assessment Act 1979
Approved Section: 4.55(1A) Application No: SSD-9670-Mod-5
Granted: 5 March 2021 Signed:
Sheet no: 5 of 9

5 x FLINDERSEA AUSTRALIS

HASSALL STREET

WARNING
Services shown on this drawing are approximate only. The exact location is to be confirmed on site by contractor prior to commencement of work.
These coloured drawings shall be read in digital format or colour hardcopy. These drawings shall be read in conjunction with all relevant information (not limited to legends, schedules, specifications).
These drawings shall be read in conjunction with any Engineers, Architects or other consultant information (not limited to drawings, legends, schedules, specifications).
Check all dimensions and site conditions prior to commencement of any work or procurement or fabrication of any services, materials, fittings or equipment.
Not be reproduced or distributed without prior permission of the Landscape Architect.

NOTES / KEY PLAN

DATE	REV	AMENDMENTS
8/28/20	A	ISSUED FOR SSDA MOD 4

CONSULTANTS

Tzannes
ARCHITECTS
2 Foveaux St
Sunny Hill, NSW 2010
T 02 9319 3744

BlightRayner
ARCHITECTS
114/5 Martin Place
Brisbane, QLD 4000
T 07 3855 6500

SOLUTIONS CONSULTING
PROJECT MANAGER
114/5 Martin Place
Sydney, NSW 2000
T 0412 925 650

Robur Bird Group

floth

STEVE WATSON PARTNERS

ENGINEERS
L117151 Castlereagh St
Sydney, NSW 2000
T 02 8446 3000

ENGINEERS
485 Victoria Ave
Cherrywood, NSW 2087
T 02 9415 4100

CERTIFIER
L17456 Kent St
Sydney, NSW 2000
T 02 9283 6555

ASPECT Studios

ASPECT Studios Pty Ltd
Level 1, 78-80 George Street
Redfern NSW 2016
Australia
T 02 9699 7182
www.aspect-studios.com
sydney@aspect-studios.com
ABN 11 120 219 551

PROJECT
HASSELL STREET PARRAMATTA
2B - 6 Hassell Street Parramatta, NSW 2150

CLIENT

Charter Hall

WESTERN SYDNEY UNIVERSITY

S19003

NORTH

SCALE A1 | SCALE A3

1:100 1:200

0 2.5 5 7.5M

Do not scale - use dimensions & callouts on drawings & schedules. Refer discrepancies to Landscape Architect for clarification.

STATUS
Project Phase
SSDA

NOT FOR CONSTRUCTION

DRAWN

GH

CHECKED

NB

7.5M

DRAWING NO.

PLANTING PLANS
Ground Level & Level 1

DRAWING NO.

6HS-ASP-L01.05AA

REVISION



Approved Section: 4.55(1A) Application No: SSD-9670-Mod-5
 Granted: 5 March 2021 Signed: 
 Sheet no: 6 of 9

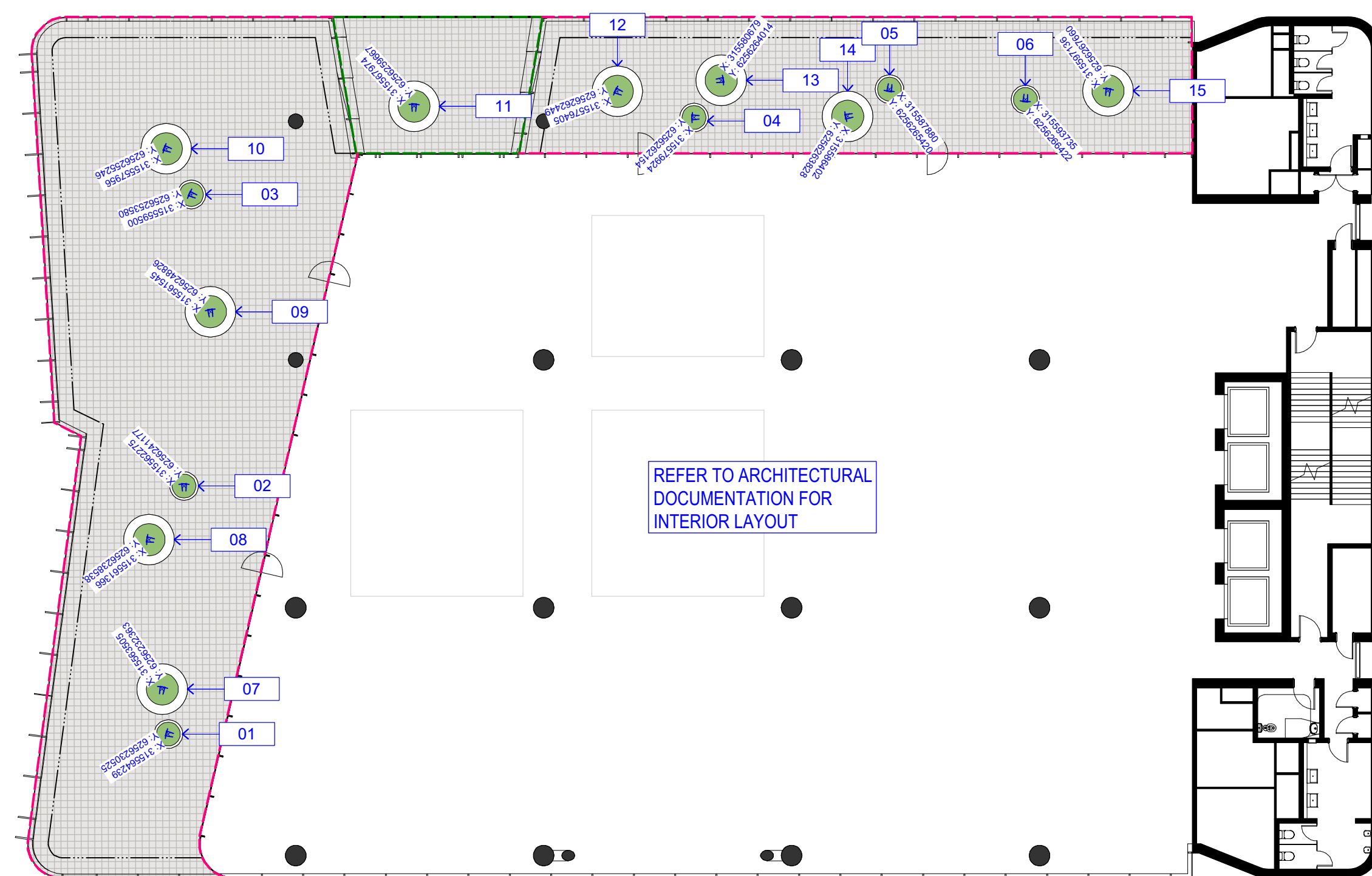

Plant List						
ID	QTY	BOTANICAL NAME	COMMON NAME	EXOTIC/NATIVE	POT SIZE (MM)	SPACING (MM)
LEVEL 10 & LEVEL 12						
Ar	46	Anigozanthos 'Regal Velvet'	Kanagaroo Paw	Native	300	40
Ca	34	Chryscephalum apiculatum	Yellow Buttons	Native	300	40
Hv	20	Hardenbergia violacea	Native Sarsparella	Native	300	50
Re	38	Russella equisetiformis	Coral Plant	Exotic	300	50
Sg	16	Salvia guarantica 'Black and Blue'	Anise Scented Sage	Exotic	300	60
Sa	17	Scaevolea aemula	Fan Flower	Exotic	300	40

A diagram of a 2D hexagonal lattice. The lattice is composed of 10 nodes arranged in a hexagonal pattern. The nodes are colored either red or blue. There are 5 red nodes and 5 blue nodes. The red nodes are located at the top-left, top-right, middle-left, middle-right, and bottom-left positions. The blue nodes are located at the top-middle, middle-middle, bottom-middle, bottom-left-middle, and bottom-right-middle positions. The nodes are connected by lines forming a hexagonal grid.

A circular arrangement of 10 nodes. Three nodes are labeled 'Re' (purple) and seven nodes are labeled 'Sa' (red). The nodes are arranged in a ring, with 'Re' nodes at positions 1, 4, and 7, and 'Sa' nodes at positions 2, 3, 5, 6, 8, 9, and 10.

A diagram of a 12-atom cluster, consisting of 3 Re atoms (purple) and 9 Ca atoms (yellow). The atoms are arranged in a cluster within a circular boundary.

A diagram of a 12-atom cluster, consisting of 3 Re atoms (purple) and 9 Ca atoms (yellow). The atoms are arranged in a cluster within a circular boundary, with tick marks around the perimeter.

A diagram showing a cluster of particles within a circular container. The container is a large circle with tick marks around its perimeter. Inside, there are 10 green circles, each labeled 'Hv', and 5 purple circles, each labeled 'Re'. The green circles are clustered together in the upper half of the container, while the purple circles are clustered together in the lower half. The green circles are arranged in a roughly circular pattern, with some overlapping. The purple circles are also clustered together, with some overlapping. The green circles are positioned closer to the top of the container, while the purple circles are positioned closer to the bottom. The green circles are arranged in a way that they appear to be pushing against the purple circles, which are also pushing against the bottom of the container. The green circles are arranged in a way that they appear to be pushing against the purple circles, which are also pushing against the bottom of the container.

A diagram showing a cluster of 13 atoms (10 Calcium (Ca) and 3 Strontium (Sg)) enclosed within a larger sphere. The cluster is composed of 10 yellow circles labeled 'Ca' and 3 blue circles labeled 'Sg'. The entire cluster is contained within a larger white circle with a black outline, which represents the 14 Å sphere mentioned in the text.

A diagram showing a cluster of 10 atoms within a circular boundary. The atoms are represented by circles, some red and some blue. The red circles are labeled 'Ar' and the blue circles are labeled 'Sg'. There are 7 red 'Ar' atoms and 3 blue 'Sg' atoms. The cluster is surrounded by a circular boundary with tick marks, and red arrows point outwards from the boundary.

NOTES / KEY PLAN

DATE	REV	AMENDMENTS
5/17/19	A	ISSUED FOR CONSULTANTS REVIEW - DRAFT TENDER
5/27/19	B	ISSUED FOR 100% TENDER
6/6/19	C	ISSUED FOR 100% TENDER - UPDATED
30/7/19	D	ISSUED FOR 100% TENDER
8/28/20	E	ISSUED FOR SSDA MOD 4

CONSULTANTS

Izannes ARCHITECTS
2 Foveaux St
Surry Hills, NSW 2011

ARCHITECTS
1288 Creek St

Brisbane, QLD 4000
T 07 3905 6500

SOLUTIONS CONSULTING AUSTRALIA



ENGINEERS
L11/151 Castlereagh Road
Sydney, NSW 2000

ENGINEERS
495 Victoria Ave

100 Victoria Ave
Chatswood, NSW 206
T 02 9419 4100

**STEVE WATSON
& PARTNERS**

ASPECT Studios

ASPECT Studios Pty Ltd
Level 1, 78-80 George Street
Redfern NSW 2016
Australia
T 02 9699 7182
www.aspect-studios.com
sydney@aspect-studios.com
ABN 11 120 219 561

PROJECT
HASSELL STREET PARRAMATTA
2B - 6 Hassell Street Parramatta, NSW 2150

CLIENT

Charter Hall 

WESTERN SYDNEY
UNIVERSITY

S1900

	NORTH	SCALE A1	SCALE
		1:200	1:400

0 5
Do not scale - use direct

STATUS
Project Phase

SSDA

NOT FOR CONSTRUCTION

DRAWING

SETOUT AND PLANTING

Level 10 & 12

DRAWING NO. 6HS-ASP-L01.06 E REVISION

X00000005 PRODUCTION\01 Phase\01 CAD\Package Files\19003 6HS-ASP-I 01 01[SSDA MODIFICATION] yw

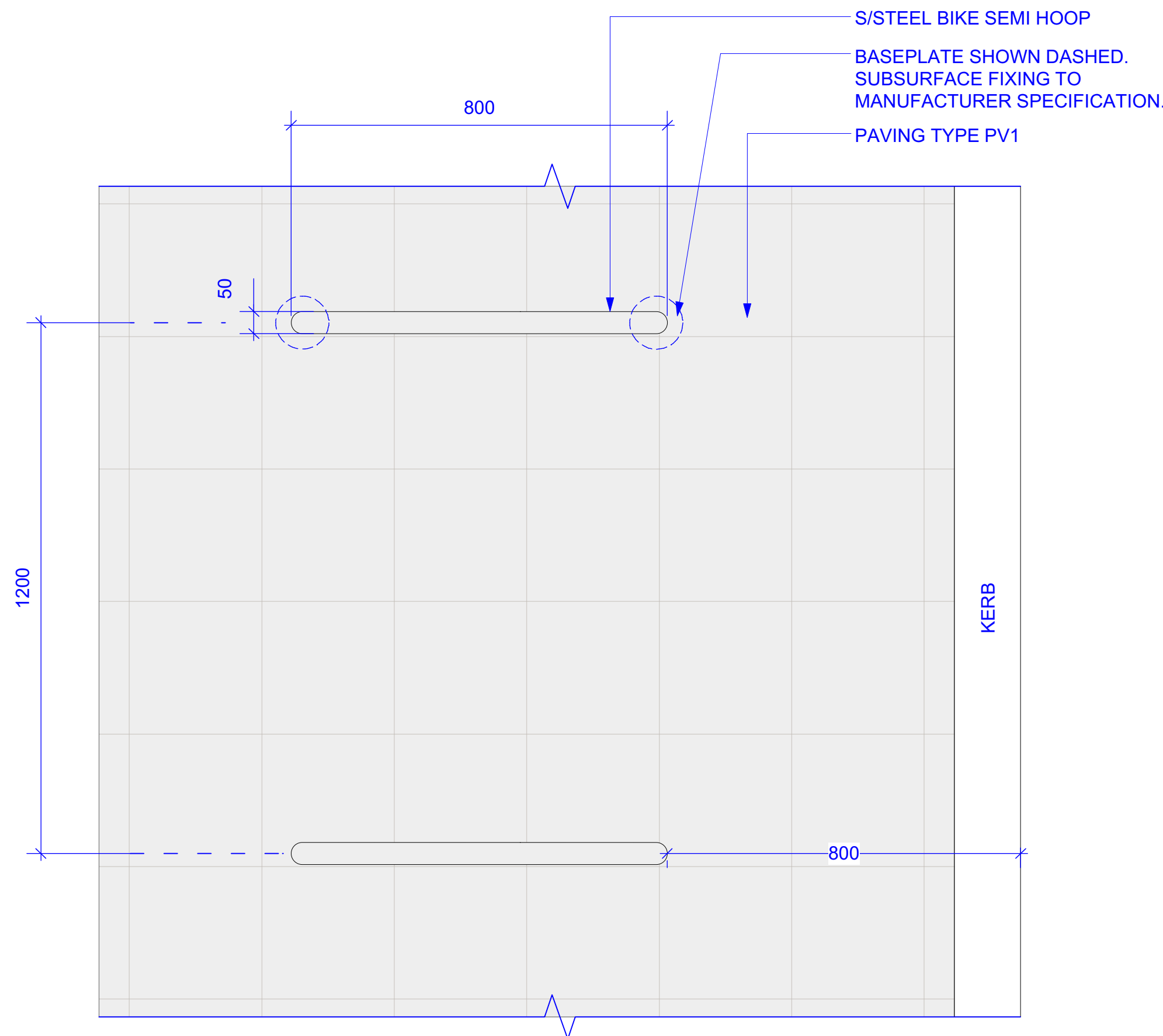

1 BR I CoP BIKE HOOP
1:10 PLAN

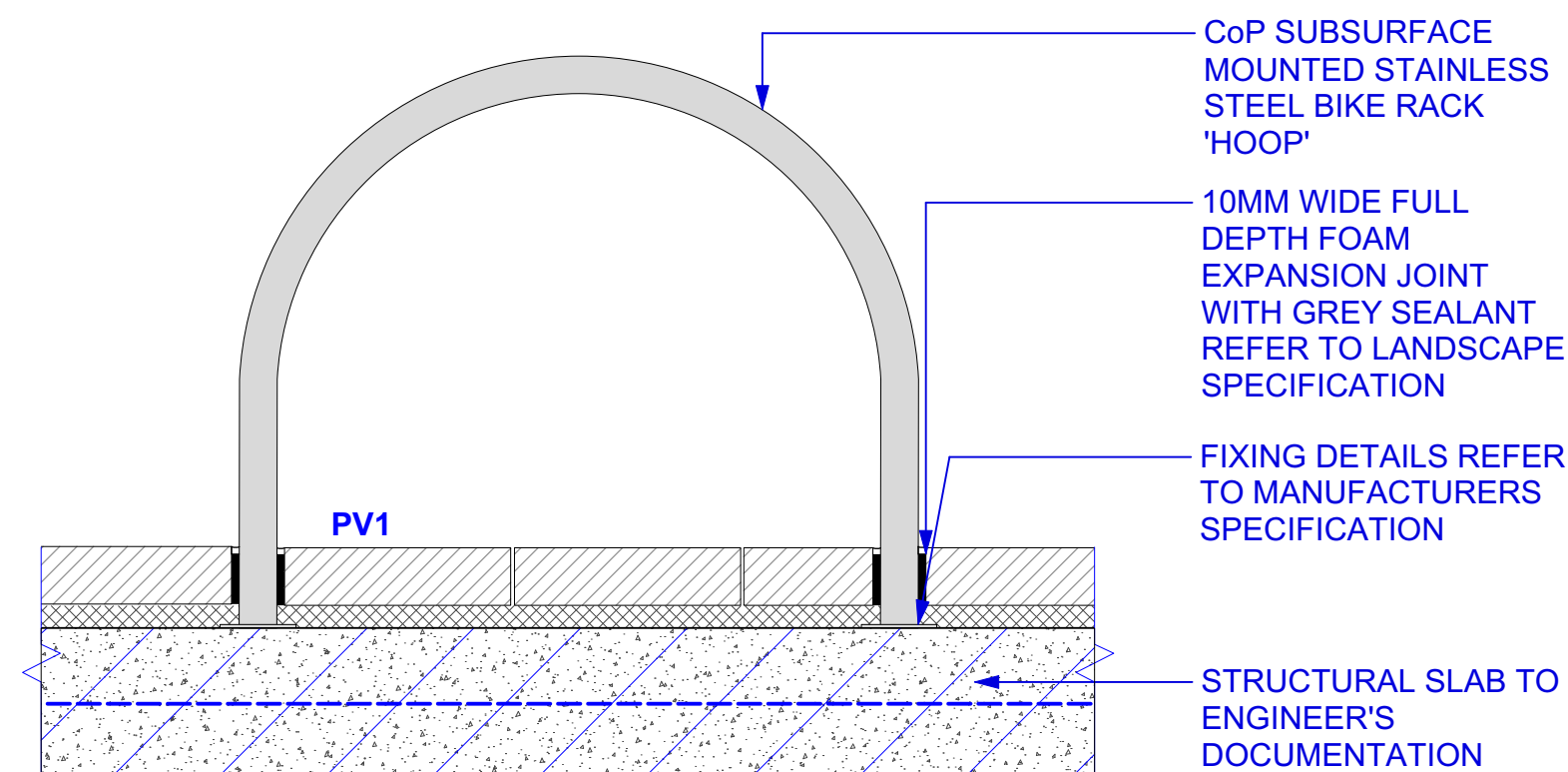

2 BR I CoP BIKE HOOP
1:10 SECTION

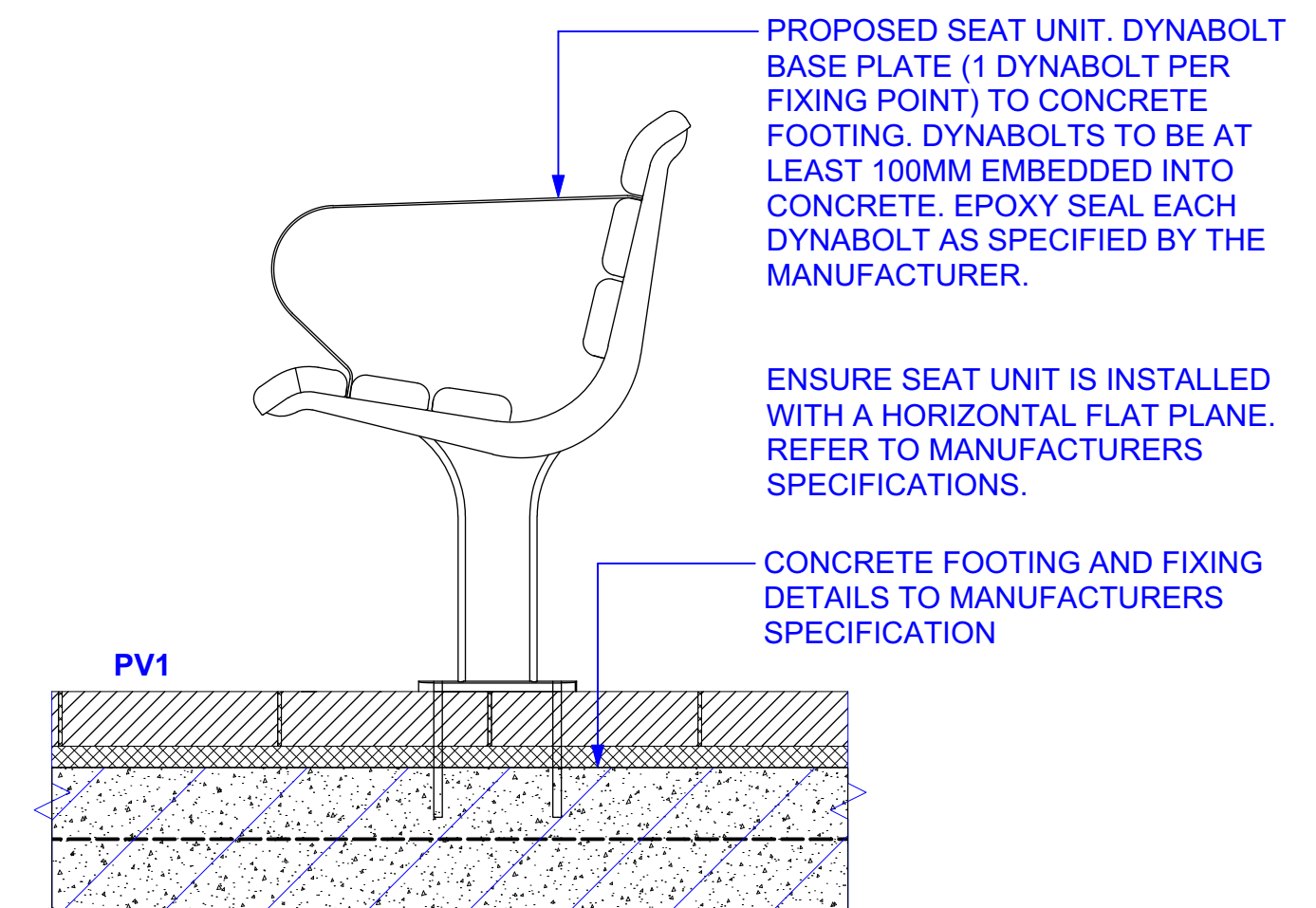

3 BE I CoP SEAT
1:10 SECTION

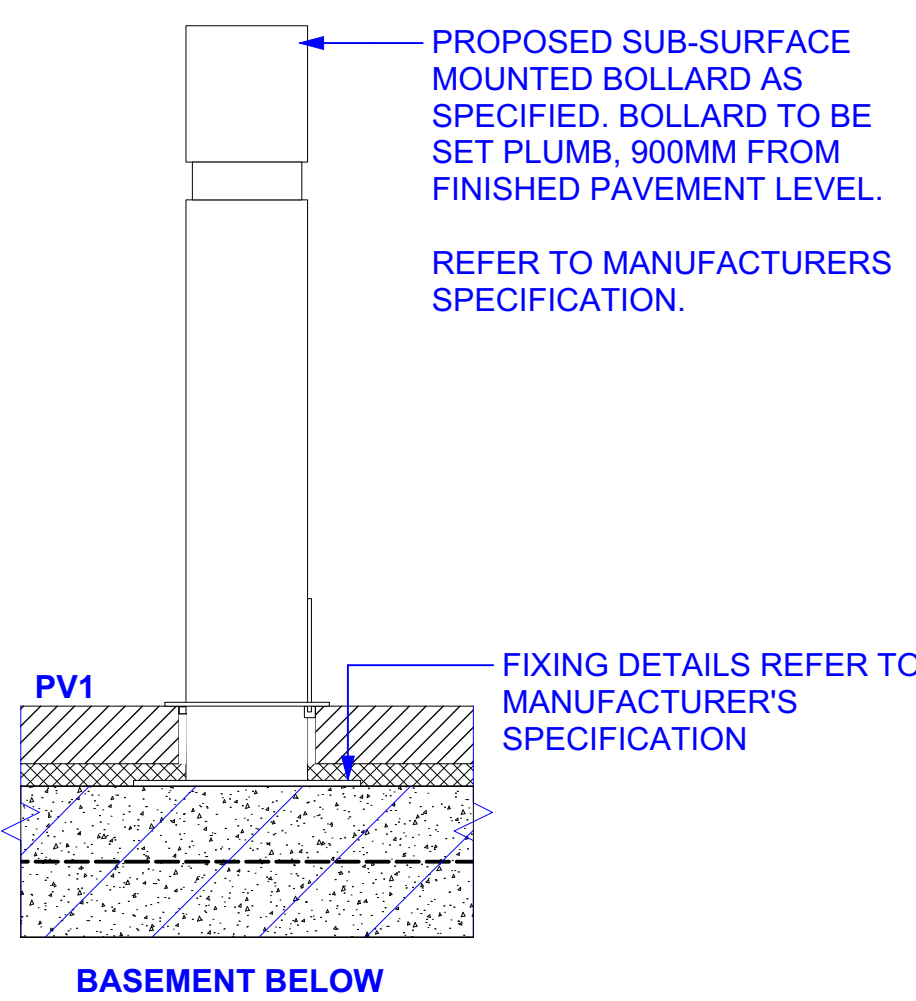

4 BO2 I REMOVABLE CoP BOLLARD
1:10 SECTION

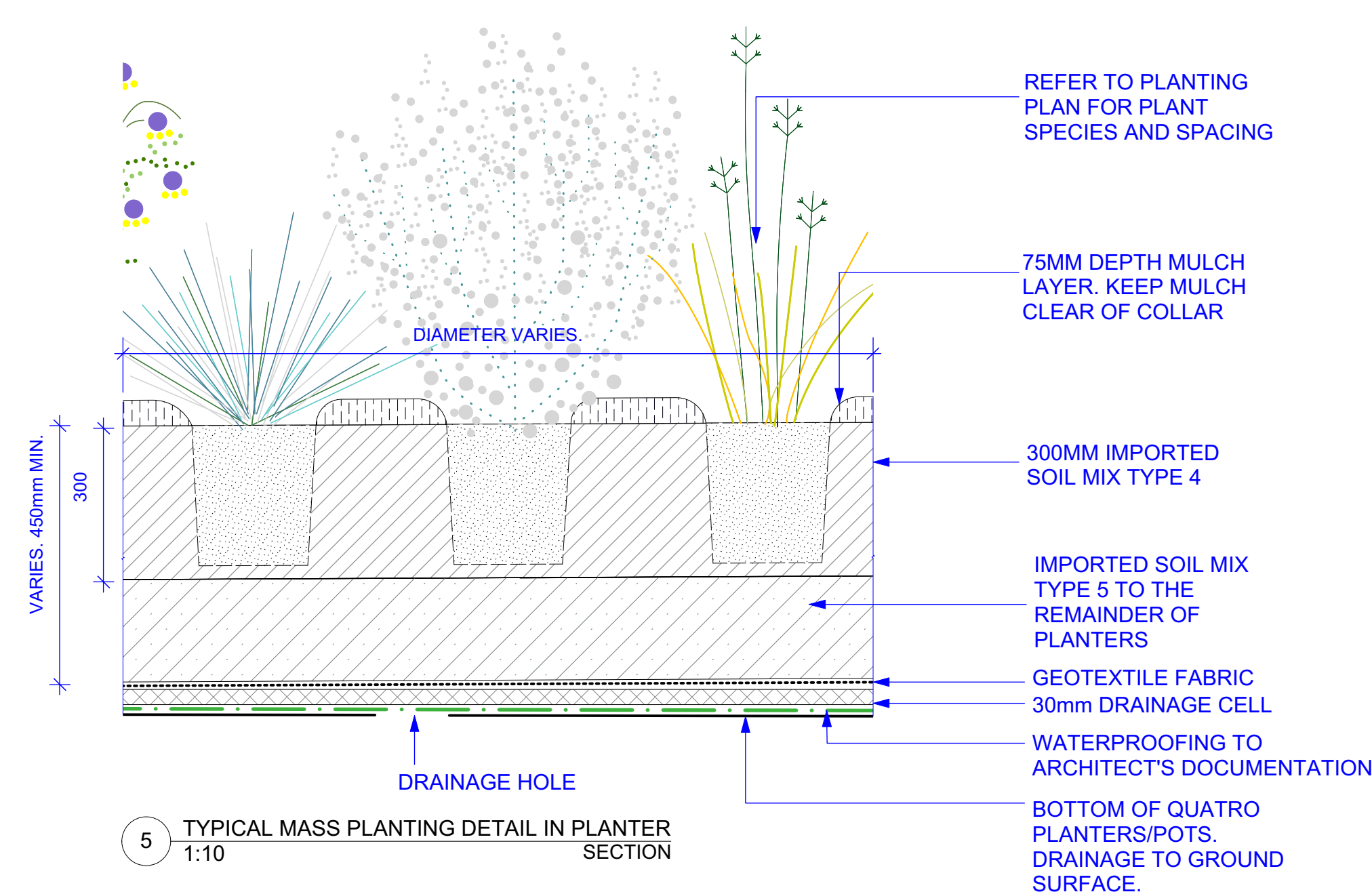

5 TYPICAL MASS PLANTING DETAIL IN PLANTER
1:10 SECTION

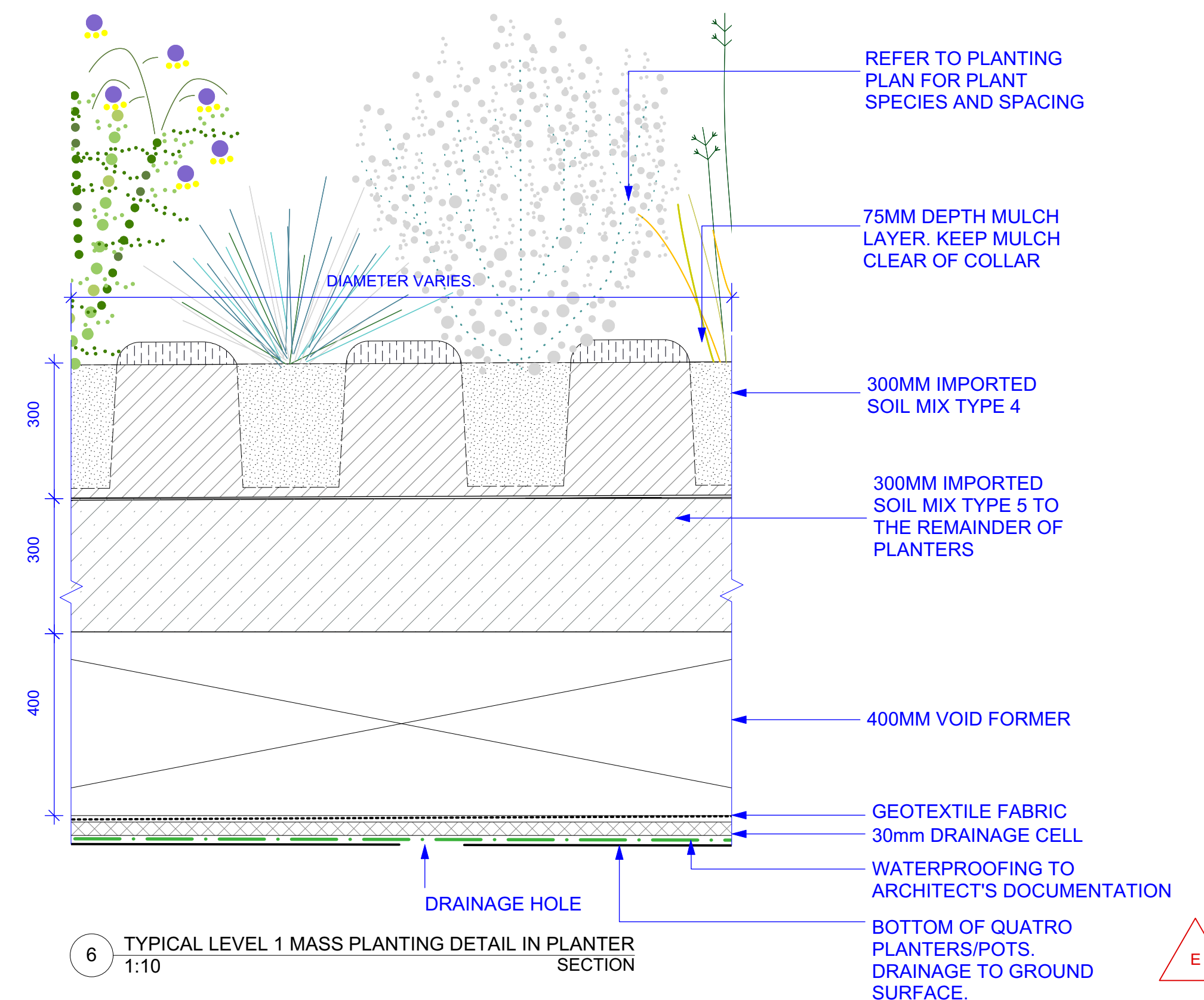

6 TYPICAL LEVEL 1 MASS PLANTING DETAIL IN PLANTER
1:10 SECTION

WARNING
DIAL BEFORE YOU DIG
www.1100.com.au
Services shown on this drawing are approximate only. The exact location is to be confirmed on site by contractor prior to commencement of work.
These coloured drawings shall be read in digital format or colour hardcopy. These drawings shall be read in conjunction with all relevant information (not limited to legends, schedules, specifications).
These drawings shall be read in conjunction with any Engineers, Architects or other consultant information (not limited to drawings, legends, schedules, specifications).
Check all dimensions and site conditions prior to commencement of any work or procurement or fabrication of any services, materials, fittings or equipment.
Not be reproduced or distributed without prior permission of the Landscape Architect.

NOTES / KEY PLAN
 REQUIRES FUTURE STRUCTURAL AND CIVIL REVIEW AND DOCUMENTATION
NEW PAVING TO FINISH FLUSH WHERE INTERFACE TO EXISTING
LOCATION OF ALL UNDERGROUND SERVICES TO BE CONFIRMED ON SITE

DATE	REV	AMENDMENTS
5/17/19	A	ISSUED FOR CONSULTANTS REVIEW - DRAFT TENDER
5/27/19	B	ISSUED FOR 100% TENDER
6/6/19	C	ISSUED FOR 100% TENDER - UPDATED
30/7/19	D	ISSUED FOR 100% TENDER
8/28/20	E	ISSUED FOR SSDA MOD 4

CONSULTANTS
Architects
1zannes
2 Foveaux St
Sunny Hill, NSW 2010
T 02 9319 3744
Engineers
Robert Bird Group
L11/151 Castlereagh St
Sydney, NSW 2000
T 02 8446 3000
Architects
BlightRayner
L2/85 Creek St
Brisbane, QLD 4000
T 07 3855 6500
Engineers
floth
485 Victoria Ave
Cherrywood, NSW 2087
T 02 9415 4100
Project Manager
SOLUTIONS CONSULTING
L1/4/3 Martin Place
Sydney, NSW 2000
T 0412 925 650
CERTIFIER
STEVE WATSON PARTNERS
L1/7/4/6 Kent St
Sydney, NSW 2000
T 02 9283 6555

ASPECT Studios
ASPECT Studios Pty Ltd
Level 1, 78-80 George Street
Redfern NSW 2016
Australia
T 02 9699 7182
www.aspect-studios.com
sydney@aspect-studios.com
ABN 11 120 219 561

PROJECT
HASSALL STREET PARRAMATTA
2B - 6 Hassall Street Parramatta, NSW 2150

CLIENT



SCALE A1 | SCALE A3
VARIES AS SHOWN

NORTH



Do not scale - use dimensions & callouts on drawings & schedules. Refer discrepancies to Landscape Architect for clarification.

STATUS
Project Phase
SSDA

NOT FOR CONSTRUCTION

DRAWN
GH

CHECKED
NB

DRAWING
DETAILS
Hassall Street Public Domain

DRAWING NO.
6HS-ASP-L01.07

REVISION

E

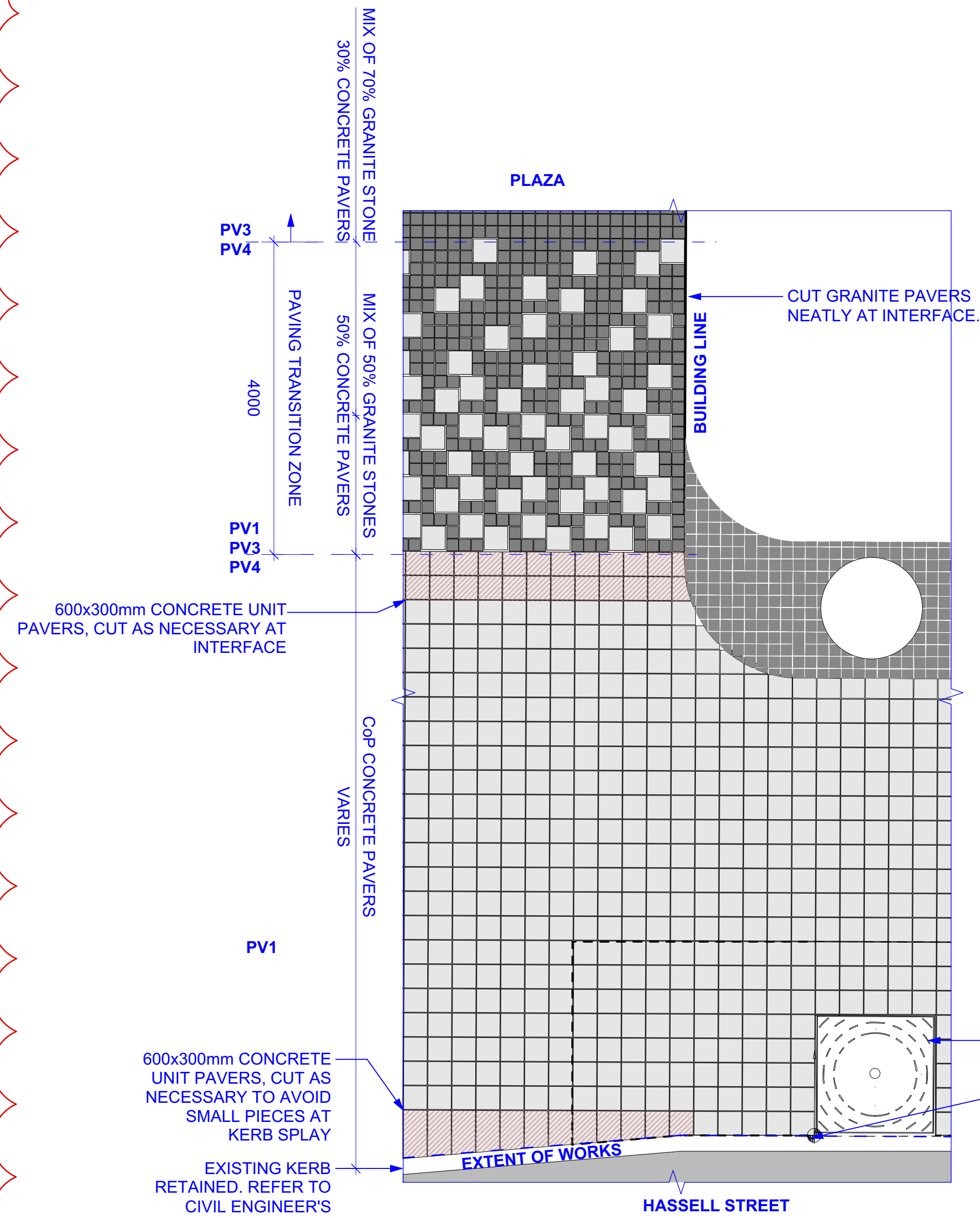

1 TYPICAL PAVING LAYOUT AND INTERFACE AT PROPERTY BOUNDARY PLAN
1:50

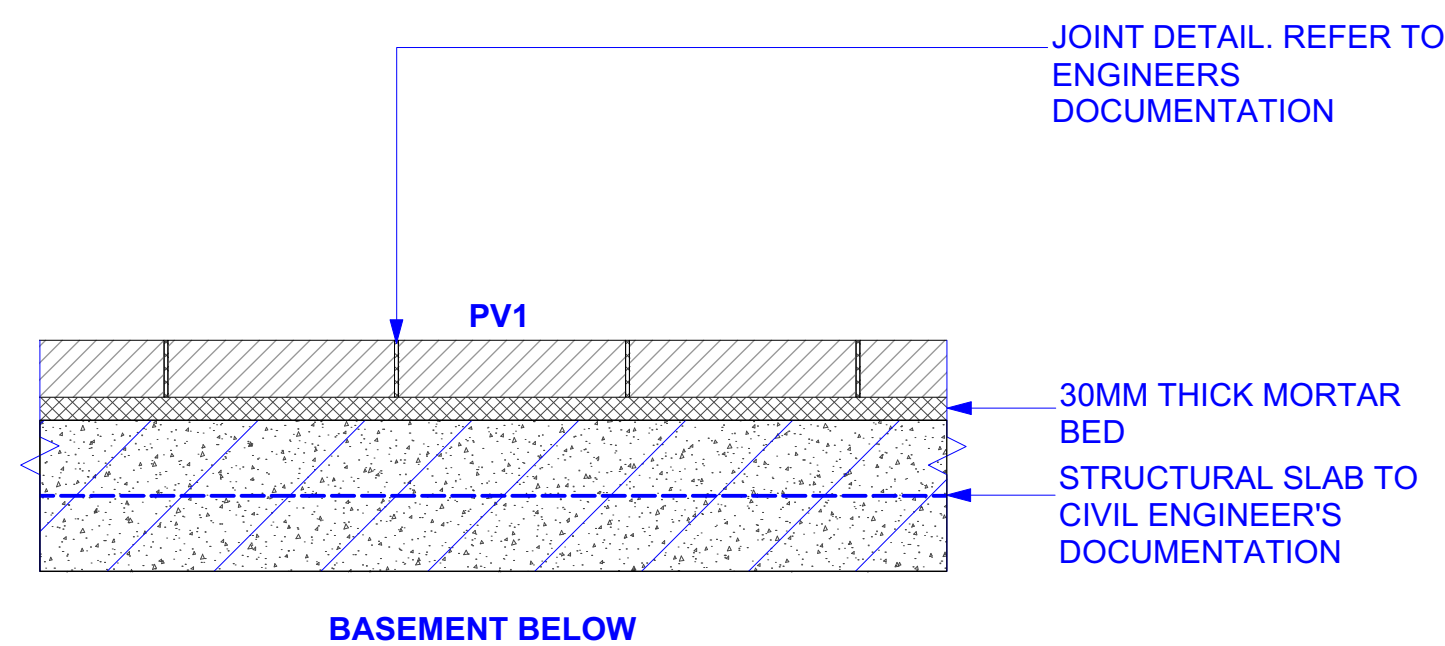

3 PAVING TYPE 1 | CoP PD CONCRETE UNIT PAVER - ON SLAB SECTION
1:10

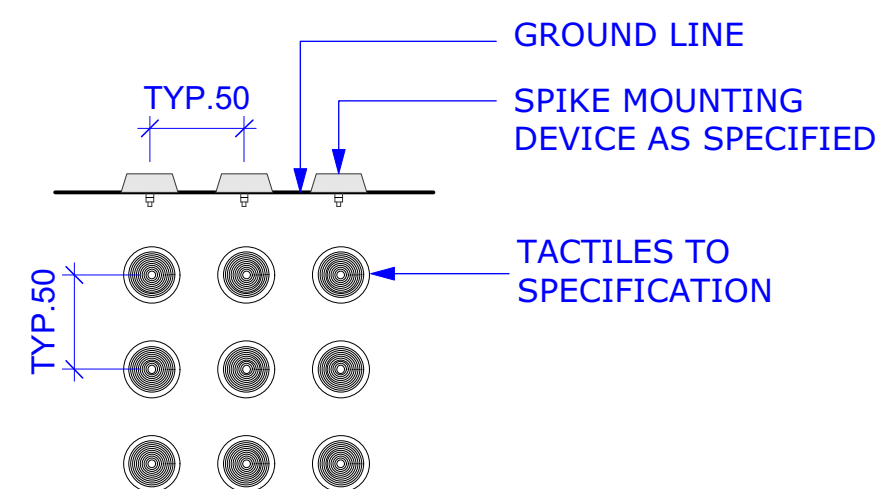

4 GROUND SURFACE TACTILE INDICATORS PLAN/SECTION
1:4

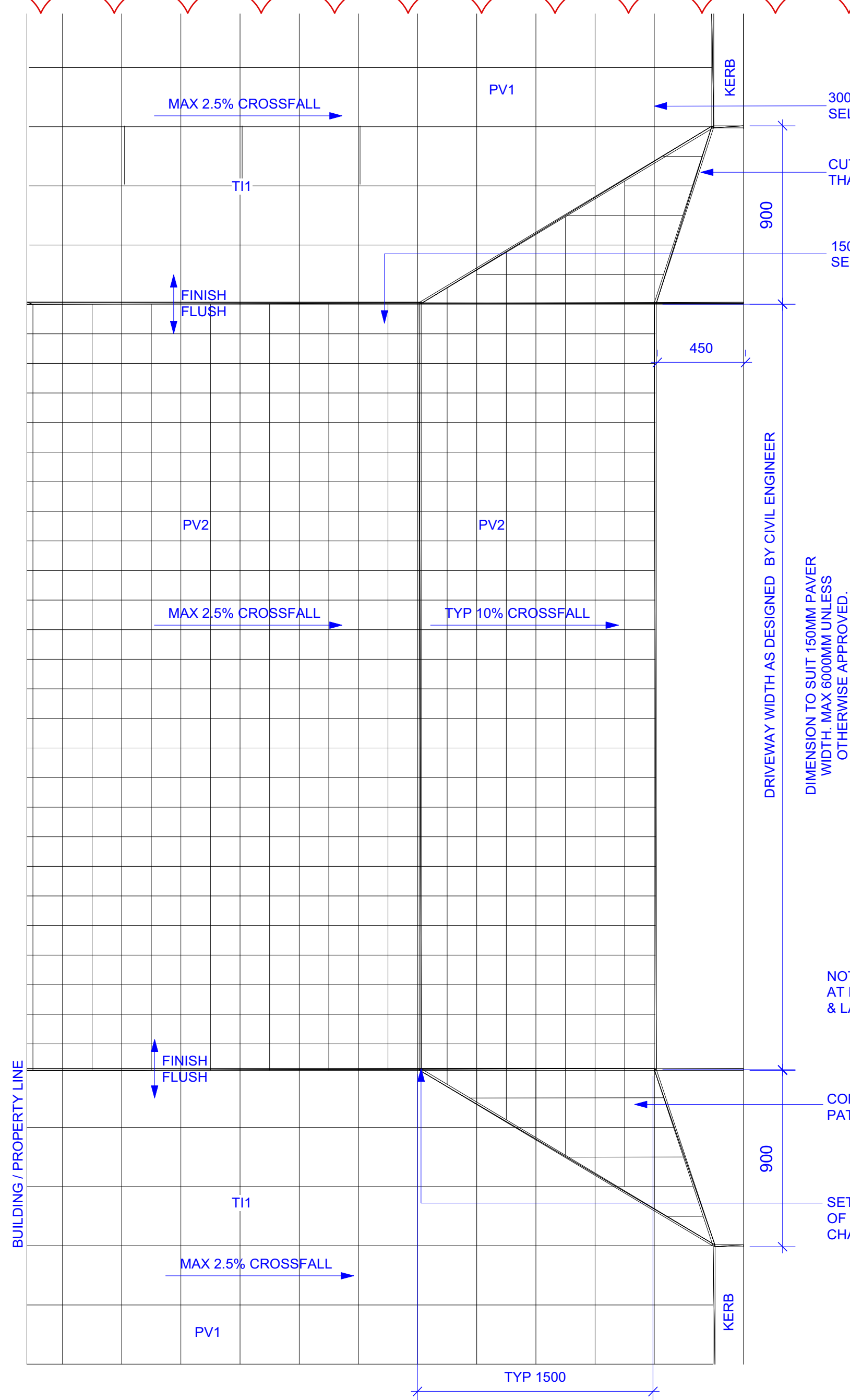

2 TYPICAL VEHICLE CROSSOVER DETAIL PLAN
1:20

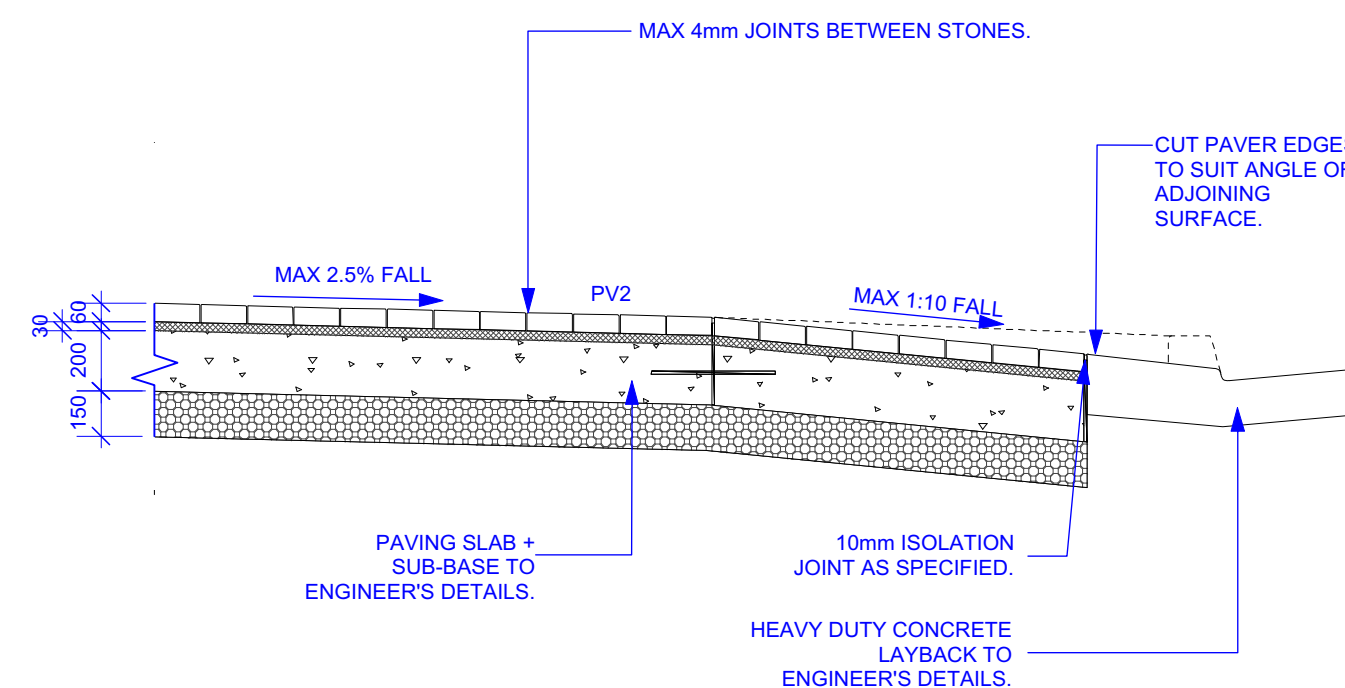

5 TYPICAL VEHICLE RAMP SECTION
1:25

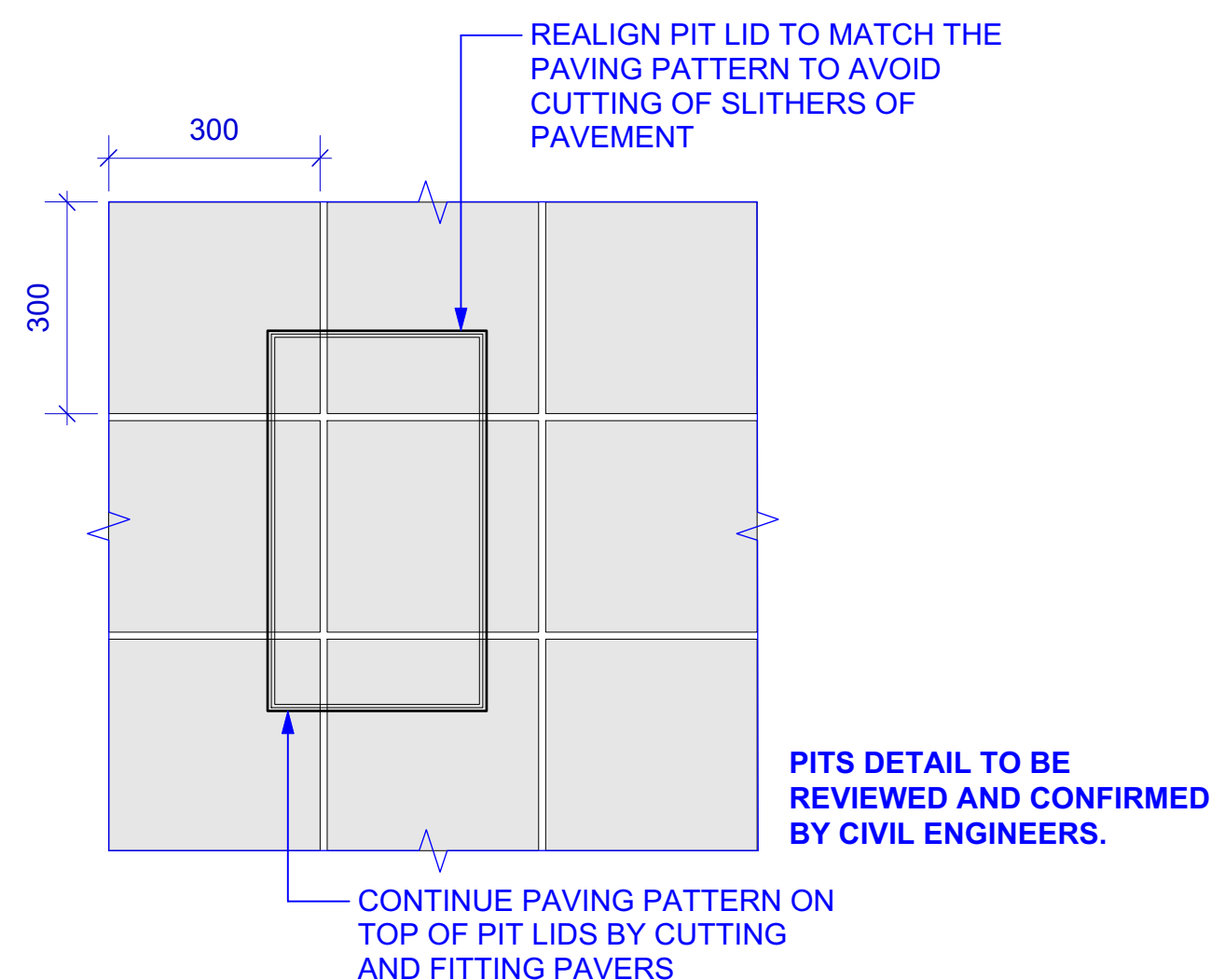
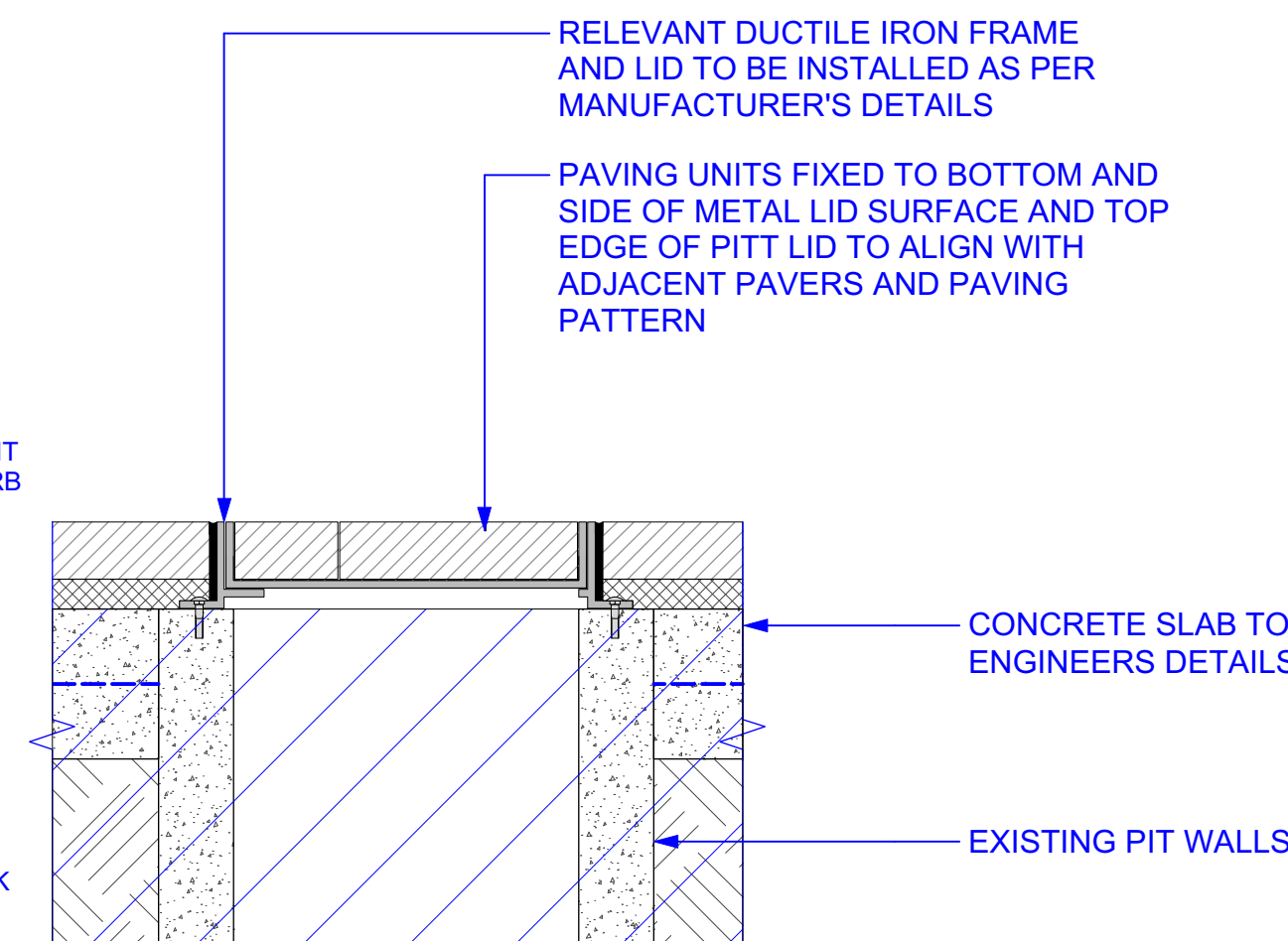

6 TYPICAL PIT COVER WITH PAVER DETAIL PLAN & SECTION
1:10

WARNING
DIAL BEFORE YOU DIG
Services shown on this drawing are approximate only. The exact location is to be confirmed on site by contractor prior to commencement of work.
These coloured drawings shall be read in digital format or colour hardcopy. These drawings shall be read in conjunction with all relevant information (not limited to legends, schedules, specifications).
These drawings shall be read in conjunction with any Engineers, Architects or other consultant information (not limited to drawings, legends, schedules, specifications).
Check all dimensions and site conditions prior to commencement of any work or procurement or fabrication of any services, materials, fittings or equipment.
Not be reproduced or distributed without prior permission of the Landscape Architect.

NOTES / KEY PLAN
REQUIRES FUTURE STRUCTURAL AND CIVIL REVIEW AND DOCUMENTATION
NEW PAVING TO FINISH FLUSH WHERE INTERFACE TO EXISTING
LOCATION OF ALL UNDERGROUND SERVICES TO BE CONFIRMED ON SITE

DATE	REV	AMENDMENTS
30/7/19	A	ISSUED FOR 100% TENDER
8/28/20	B	ISSUED FOR SSDA MOD 4

CONSULTANTS	ARCHITECTS	ENGINEERS
1zannes	2 Foveaux St Sunny Hill, NSW 2010 T 02 9319 3744	L11151 Castlereagh St Sydney, NSW 2000 T 02 846 3000
BlightRayner	ARCHITECTS L2081 Creek St Brisbane, QLD 4000 T 07 3855 6500	ENGINEERS 485 Victoria Ave Cherrywood, NSW 2087 T 02 9415 4100
SOLUTIONS CONSULTING	PROJECT MANAGER L1443 Martin Place Sydney, NSW 2000 T 0412 925 650	CERTIFIER L17456 Kent St Sydney, NSW 2000 T 02 9283 6555

ASPECT Studios

PROJECT
HASSALL STREET PARRAMATTA
2B - 6 Hassall Street Parramatta, NSW 2150

CLIENT

Charter Hall

WESTERN SYDNEY UNIVERSITY

S19003

NORTH

SCALE A1 | SCALE A3
VARIES AS SHOWN

STATUS
Project Phase
SSDA
Do not scale - use dimensions & callouts on drawings & schedules. Refer discrepancies to Landscape Architect for clarification.

NOT FOR CONSTRUCTION

DRAWING
DETAILS
Ground Level

DRAWING NO.

6HS-ASP-L01.09 B

REVISION

EXTENDED TREE PIT USING STRUCTURAL CELL SYSTEM OR SUSPENDED PAVING DESIGN*. FULL DEPTH DOWELLED EXPANSION JOINT EXPRESSED THROUGH PAVEMENT TO THE EDGE OF EXPANDED TREE PIT.

TYPICAL TREE PIT SIZE OF 1500x1500mm DEFINED BY GRATE..

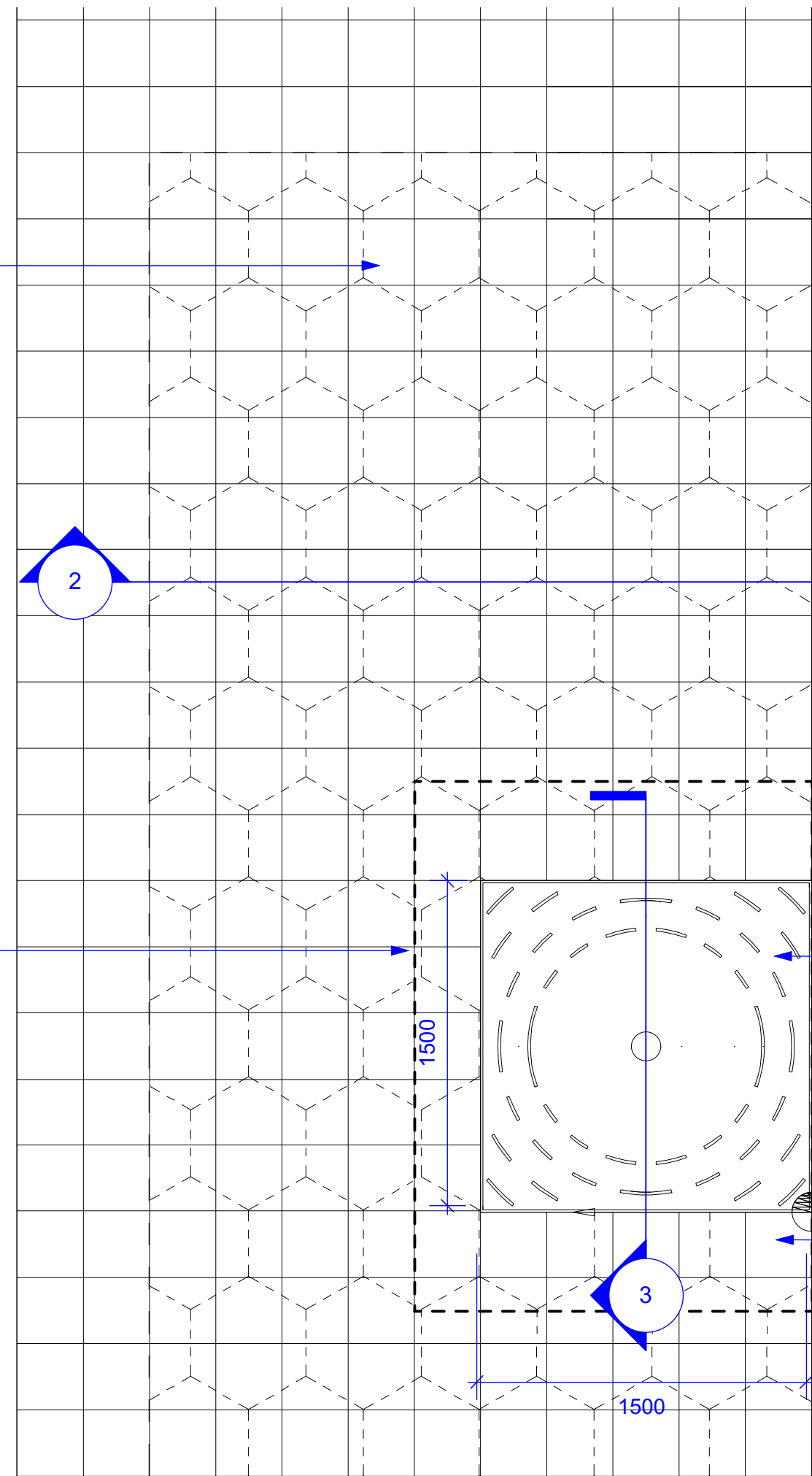

DESIGN NOTES

- EXPANDED TREE PIT USING STRUCTURAL CELLS UNDER THE FOOTPATH IS REQUIRED TO PROVIDE SATISFACTORY UNCOMPACTED SOIL VOLUME TO STREET TREES IN A FULLY PAVED FOOTPATH.

1

TYPICAL PAVING LAYOUT DETAIL | NEW TREE PIT | PAVING TYPE 1
1:25 PLAN

SETOUT PAVING FROM BACK OF KERB

TREE GRATE SPECIFIED BY COUNCIL. (FURPHY FOUNDRY 1500 x 1500mm CAST ALUMINIUM GRATE POWDERCOATED BLACK UNLESS OTHERWISE SPECIFIED).

NEW TREE AS SPECIFIED.

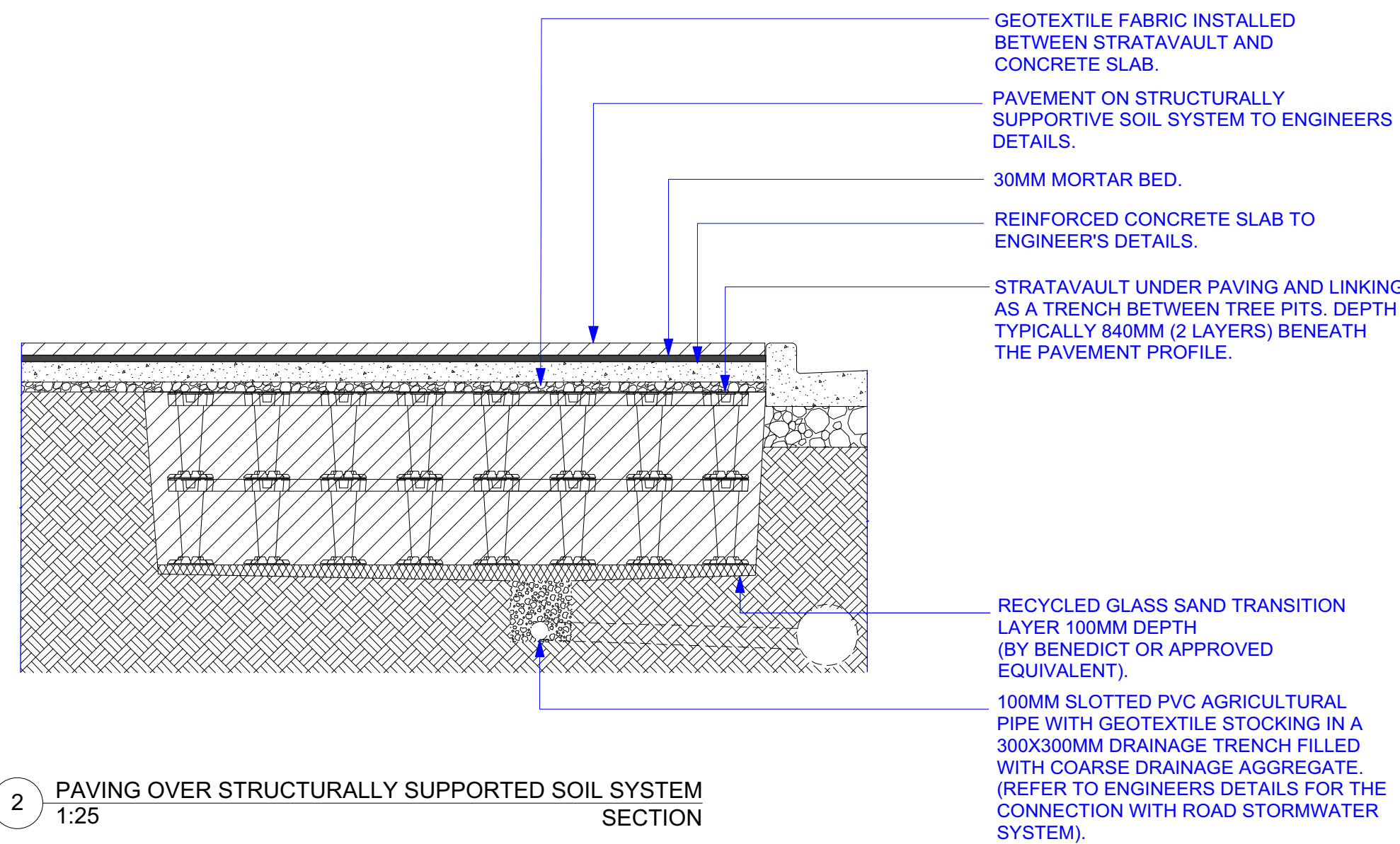

2 PAVING OVER STRUCTURALLY SUPPORTED SOIL SYSTEM
1:25 SECTION

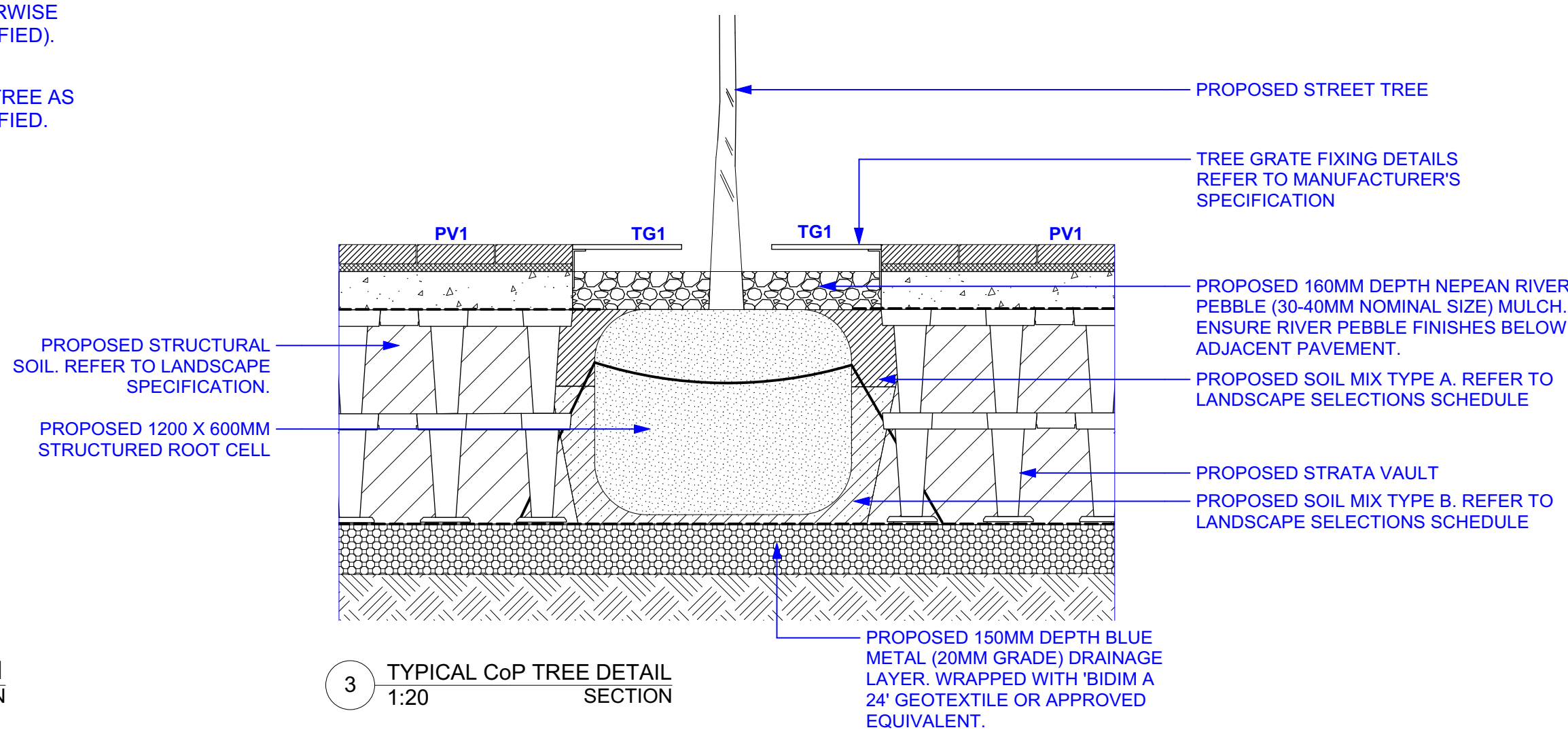

3 TYPICAL CoP TREE DETAIL
1:20 SECTION



Planning,
Industry &
Environment

Issued under the Environmental Planning and Assessment Act 1979

Approved Section: 4.55(1A)
Granted: 5 March 2021
Sheet no: 9 of 9

Application No: SSD-9670-Mod-5
Signed:

WARNING

Services shown on this drawing are approximate only. The exact location is to be confirmed on site by contractor prior to commencement of work.

These coloured drawings shall be read in digital format or colour hardcopy. These drawings shall be read in conjunction with all relevant information (not limited to legends, schedules, specifications).

These drawings shall be read in conjunction with any Engineers, Architects or other consultant information (not limited to drawings, legends, schedules, specifications). Check all dimensions and site conditions prior to commencement of any work or procurement or fabrication of any services, materials, fittings or equipment.

Not be reproduced or distributed without prior permission of the Landscape Architect.

NOTES / KEY PLAN

REQUIRES FUTURE STRUCTURAL AND CIVIL REVIEW AND DOCUMENTATION

NEW PAVING TO FINISH FLUSH WHERE INTERFACE TO EXISTING

LOCATION OF ALL UNDERGROUND SERVICES TO BE CONFIRMED ON SITE

DATE REV AMENDMENTS

8/28/20 A ISSUED FOR SSDA MOD 4

CONSULTANTS

ARCHITECTS
Tzannes
2 Foveaux St
Sunny Hill, NSW 2010
T 02 9319 3744

ARCHITECTS
BlightRayner
114/5 Martin Place
Sydney, NSW 2000
T 02 9255 6500

PROJECT MANAGER
SOLUTIONS CONSULTING
114/5 Martin Place
Sydney, NSW 2000
T 0412 925 650

ENGINEERS
Rajput Bird Group
L11/151 Castlereagh St
Sydney, NSW 2000
T 02 8446 3000

ENGINEERS
floth
485 Victoria Ave
Cherrywood, NSW 2087
T 02 9415 4100

CERTIFIER
STEVE WATSON
117/156 Kent St
Sydney, NSW 2000
T 02 9283 6555

ASPECT Studios

ASPECT Studios Pty Ltd
Level 1, 78-80 George Street
Redfern NSW 2016
Australia
T 02 9699 7182
www.aspect-studios.com
sydney@aspect-studios.com
ABN 11 120 219 551

PROJECT
HASSALL STREET PARRAMATTA
2B - 6 Hassall Street Parramatta, NSW 2150

CLIENT

Charter Hall

WESTERN SYDNEY UNIVERSITY

S19003

NORTH

SCALE A1 | SCALE A3
VARIES AS SHOWN

DRAWN
GH

CHECKED
NB

DRAWING
DETAILS
Ground Level

DRAWING NO.

REVISION

STATUS
Project Phase
SSDA

NOT FOR CONSTRUCTION

DRAWING NO.

REVISION

6HS-ASP-L01.10

A

X0000005_PRODUCTION01_Phase01_CAD/Package Files/S19003_6HS-ASP-L01.01[SSDA MODIFICATION].vwx