



Morris Goding
Access Consulting

Mitch Ryan
Project Manager
Next
Level 18, 227 Elizabeth Street
Sydney NSW 2000

16 December 2020

Dear Mitch

RE: Access Design Statement – accessible parking unmarked shared area

I hereby state that the proposed relocation of the unmarked shared area (diagram 1); that is adjacent to the accessible dedicated space is in accordance with AS/NZS 2890.6:2009 – Parking facilities – Part 6: Off street parking for people with disabilities (diagram 2):

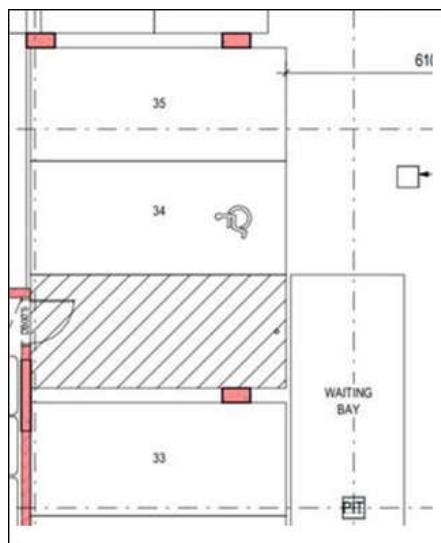

Diagram 1

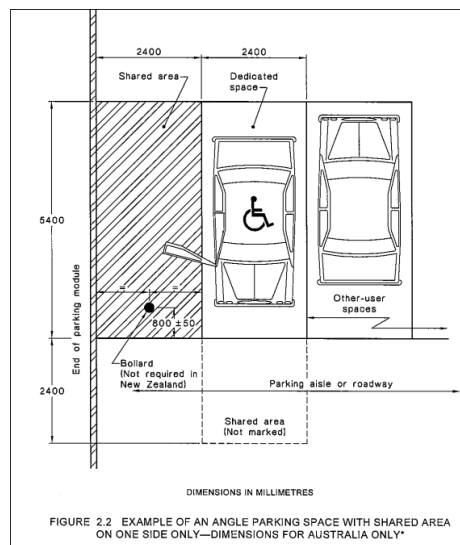

Diagram 2

All other aspects of the accessible car parking bays will be designed to comply with AS/NZS 2890.6:2009.

Yours faithfully

Lee-May Whong
Senior Access Consultant
Morris Goding Access Consulting

Morris Goding
Access Consulting
ABN 70 414 330 060

Studio 6, Level 1
56 Bowman Street
Pymont NSW 20 09

T 02 9692 9322
F 02 9692 8433
W mgac.com.au

NSW
QLD
VIC