

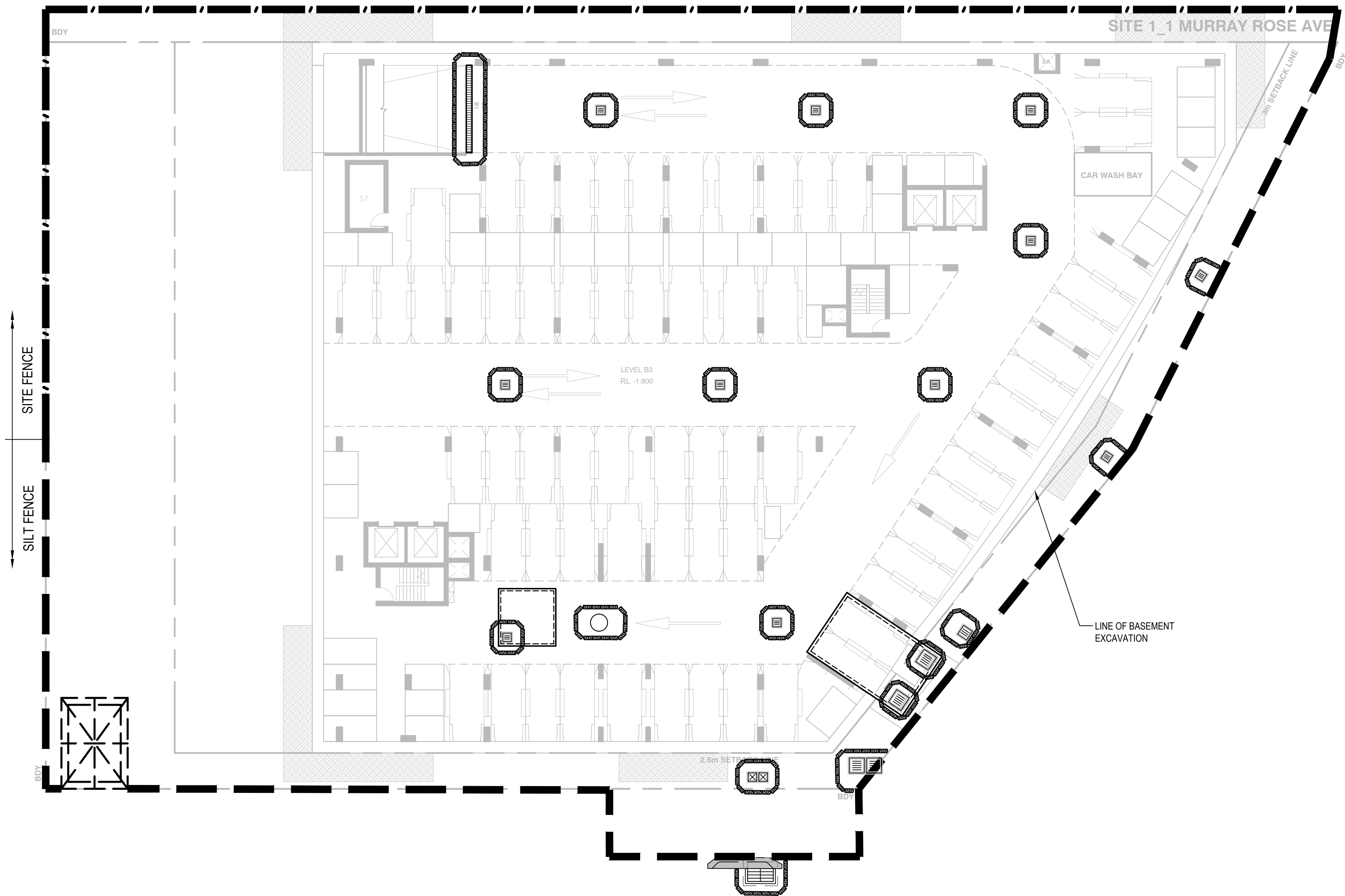



DATE PLOTTED: 2 November 2018 3:31 PM BY: GORAN MILENKOVIC

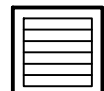
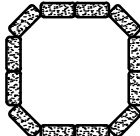

BUILDING 1 SEDIMENTATION AND EROSION CONTROL PLAN
SCALE 1:200

LEGEND

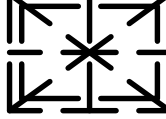
-  SITE FENCE
-  SILT FENCE
-  STORMWATER PIT
-  SILT TRAP/SAND BAGS
-  TEMPORARY SURFACE INLET SEDIMENT TRAP OR GROSS POLLUTANT TRAP
-  TEMPORARY CONSTRUCTION VEHICLE EXIT

NOTE

SITE ACCESS AND STOCKPILE LOCATION MAY CHANGE DEPENDING ON CONSTRUCTION PREFERENCE

FOR SEDIMENTATION AND EROSION CONTROL DETAILS REFER TO DRAWING 80818416-CI-3002.

THE CONTRACTOR MUST INSPECT AND MAINTAIN THE SEDIMENT CONTROLS MEASURES DAILY AND PROVIDE A WEEKLY PHOTOGRAPHIC REPORT TO SOPA

PROVIDE SAND BAGS OR SEDIMENT FENCE AROUND ALL EXISTING STORMWATER PITS THAT HAVE BEEN CONSTRUCTED DOWNSTREAM OF NON SURFACED EXCAVATION

THIS LAYOUT PRESENTS ONE OF A NUMBER OF POSSIBLE SOLUTIONS FOR THE EROSION AND SEDIMENTATION CONTROL ON THE SITE DURING THE CONSTRUCTION PERIOD. FINAL LAYOUT MAY BE ALTERED BY THE CONTRACTOR TO SUIT THEIR SITE LAYOUT, OPERATIONS SEQUENCE, STAGING ETC. ANY SUCH CHANGES MUST BE IN ACCORDANCE WITH THE GUIDELINES OF LANDCOM MANAGING URBAN STORMWATER MANUAL. 2004 ("BLUE BOOK") SHOULD THE STRIPPED AREA AT ANY STAGE EXCEED 2500 m², SEDIMENTATION POND INCL. ASSOCIATED BERMS, CUT OFF TRENCHES ETC. IS TO BE PROVIDED IN ACCORDANCE WITH THE GUIDELINES OF LANDCOM MANAGING URBAN STORMWATER MANUAL.

XREFs: XR-AR-PLAN-B3
CAD File: N:\Projects\80818416_182_MurrayRoseAve_Olympic\K012_Civil\Drawings\Build\80818416-CI-1020.dwg

Rev.	Date	Description	Des.	Verif.	Appd.
A	23/10/2018	DEVELOPMENT APPROVAL REVISED ISSUE	GM	VJ	TY
2	22/10/2018	DEVELOPMENT APPROVAL ISSUE	GM	VJ	TY
1	14/09/2018	PRE-DA COORDINATION ISSUE	GM	VJ	TY

© Cardno Limited All Rights Reserved.
This document is produced by Cardno Limited solely for the benefit of and use by the client in accordance with the terms of the retainer. Cardno Limited does not and shall not assume any responsibility or liability whatsoever to any third party arising out of any use or reliance by third party on the content of this document.



Drawn GM	Date JUL. 2018	Client AUSTINO SYDNEY OLYMPIC PARK PTY LTD
Checked VJ	Date JUL. 2018	Project PROPOSED DEVELOPMENT 1 & 2 MURRAY ROSE AVENUE SYDNEY OLYMPIC PARK
Designed VJ	Date JUL. 2018	Title BULK EXCAVATION & SEDIMENTATION AND EROSION CONTROL PLAN BUILDING 1
Verified TY	Date	Status FOR APPROVAL NOT TO BE USED FOR CONSTRUCTION PURPOSES
Approved		Datum AHD
		Scale 1:200
		Size A1
		Drawing Number 80818416-CI-1020
		Revision A

DATE PLOTTED: 2 November 2018 3:37 PM BY : GORAN MILENKOVIC

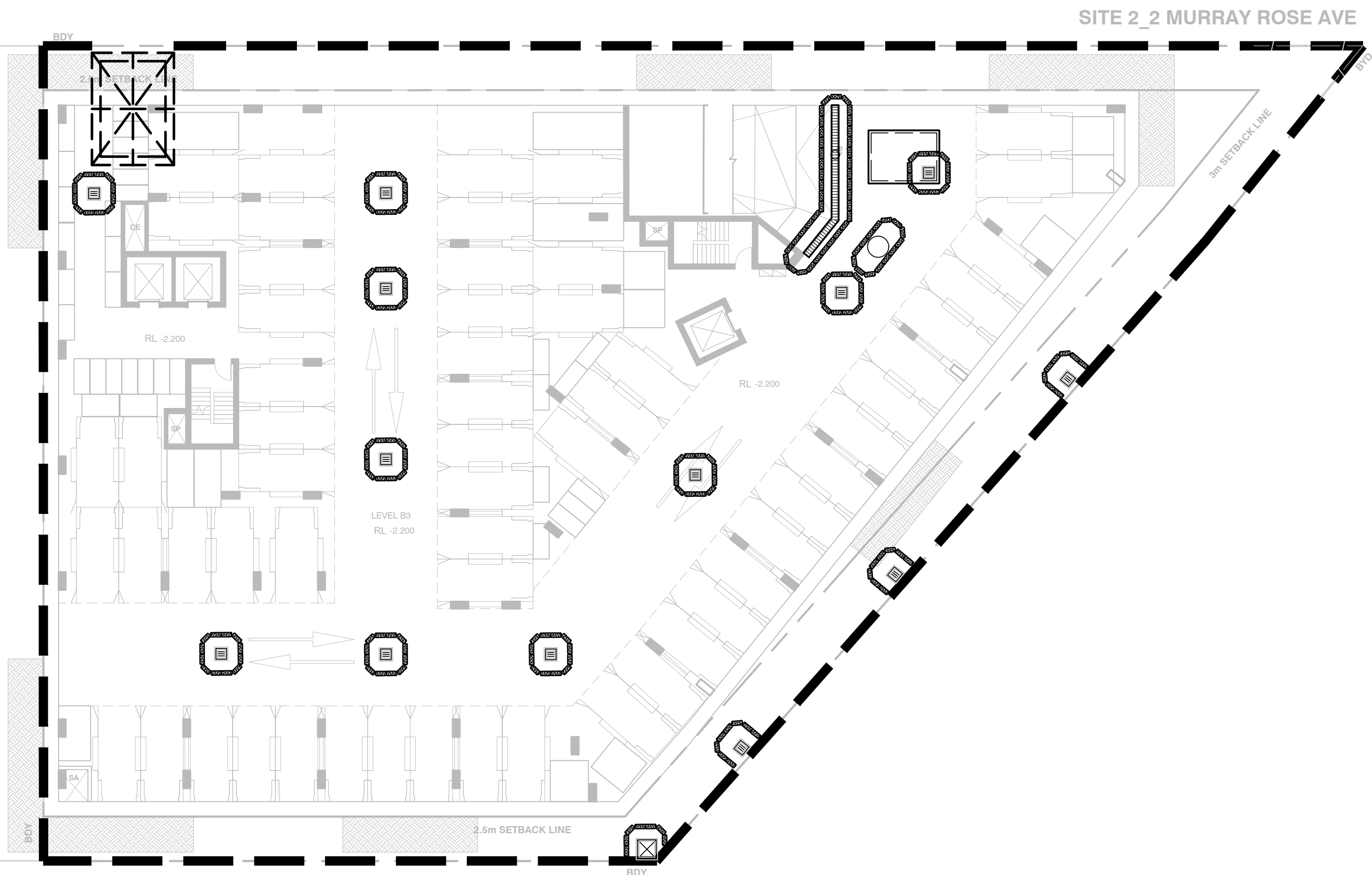

BUILDING 2 SEDIMENTATIONAND EROSION CONTROL PLAN
SCALE 1:200

LEGEND

- SILT FENCE
- STORMWATER PIT
- SILT TRAP/SAND BAGS
- TEMPORARY SURFACE INLET SEDIMENT TRAP OR GROSS POLLUTANT TRAP
- TEMPORARY CONSTRUCTION VEHICLE EXIT

NOTE
SITE ACCESS AND STOCKPILE LOCATION MAY CHANGE
DEPENDING ON CONSTRUCTION PREFERENCE

FOR SEDIMENTATION AND EROSION CONTROL
DETAILS REFER TO DRAWING 80818416-CI-3002.

THE CONTRACTOR MUST INSPECT AND
MAINTAIN THE SEDIMENT CONTROLS
MEASURES DAILY AND PROVIDE A WEEKLY
PHOTOGRAPHIC REPORT TO SOPA

PROVIDE SAND BAGS OR SEDIMENT FENCE
AROUND ALL EXISTING STORMWATER PITS
THAT HAVE BEEN CONSTRUCTED
DOWNSTREAM OF NON SURFACED
EXCAVATION

THIS LAYOUT PRESENTS ONE OF A NUMBER OF POSSIBLE
SOLUTIONS FOR THE EROSION AND SEDIMENTATION
CONTROL ON THE SITE DURING THE CONSTRUCTION PERIOD.
FINAL LAYOUT MAY BE ALTERED BY THE CONTRACTOR TO
SUIT THEIR SITE LAYOUT, OPERATIONS SEQUENCE, STAGING
ETC. ANY SUCH CHANGES MUST BE IN ACCORDANCE WITH
THE GUIDELINES OF LANDCOM MANAGING URBAN
STORMWATER MANUAL. 2004 ("BLUE BOOK")
SHOULD THE STRIPPED AREA AT ANY STAGE EXCEED 2500 m²,
SEDIMENTATION POND INCL. ASSOCIATED BERMS, CUT OFF
TRENCHES ETC. IS TO BE PROVIDED IN ACCORDANCE WITH
THE GUIDELINES OF LANDCOM MANAGING URBAN
STORMWATER MANUAL.

XREFs: XR-AR-PLAN-B3
CAD File: N:\Projects\80818416_182 MurrayRoseAve OlympicPark\012_CIVIL\Drawings\Buid\80818416-CI-2020.dwg

Rev.	Date	Description	Des.	Verif.	Appd.
A	23/10/2018	DEVELOPMENT APPROVAL REVISED ISSUE	GM	VJ	TY
2	22/10/2018	DEVELOPMENT APPROVAL ISSUE	GM	VJ	TY
1	14/09/2018	PRE-DA COORDINATION ISSUE	GM	VJ	TY

© Cardno Limited All Rights Reserved.
This document is produced by Cardno Limited solely for the
benefit of and use by the client in accordance with the
terms of the retainer. Cardno Limited does not and shall not
assume any responsibility or liability whatsoever to any third
party arising out of any use or reliance by third party on the
content of this document.



Cardno (NSW/ACT) Pty Ltd | ABN 95 001 145 035
Level 9, The Forum, 203 Pacific Highway
St Leonards, NSW 2065
Tel: 02 9496 7700 Fax: 02 9439 5170
Web: www.cardno.com.au

Drawn GM	Date JUL. 2018	Client AUSTINO SYDNEY OLYMPIC PARK PTY LTD
Checked VJ	Date JUL. 2018	Project PROPOSED DEVELOPMENT 1 & 2 MURRAY ROSE AVENUE SYDNEY OLYMPIC PARK
Designed VJ	Date JUL. 2018	Title BULK EXCAVATION & SEDIMENTATION AND EROSION CONTROL PLAN BUILDING 2
Verified TY	Date	Status FOR APPROVAL NOT TO BE USED FOR CONSTRUCTION PURPOSES
Approved		Datum AHD
		Scale 1:200
		Size A1
		Drawing Number 80818416-CI-2020
		Revision A