

31—10—18

Stage I Amending DA  
Response to Submissions  
City of Sydney — South Tower

— Sydney Metro Martin Place  
integrated station development

18167-SK-0514\_2

GRIMSHAW

# Level 9 — Office / terrace

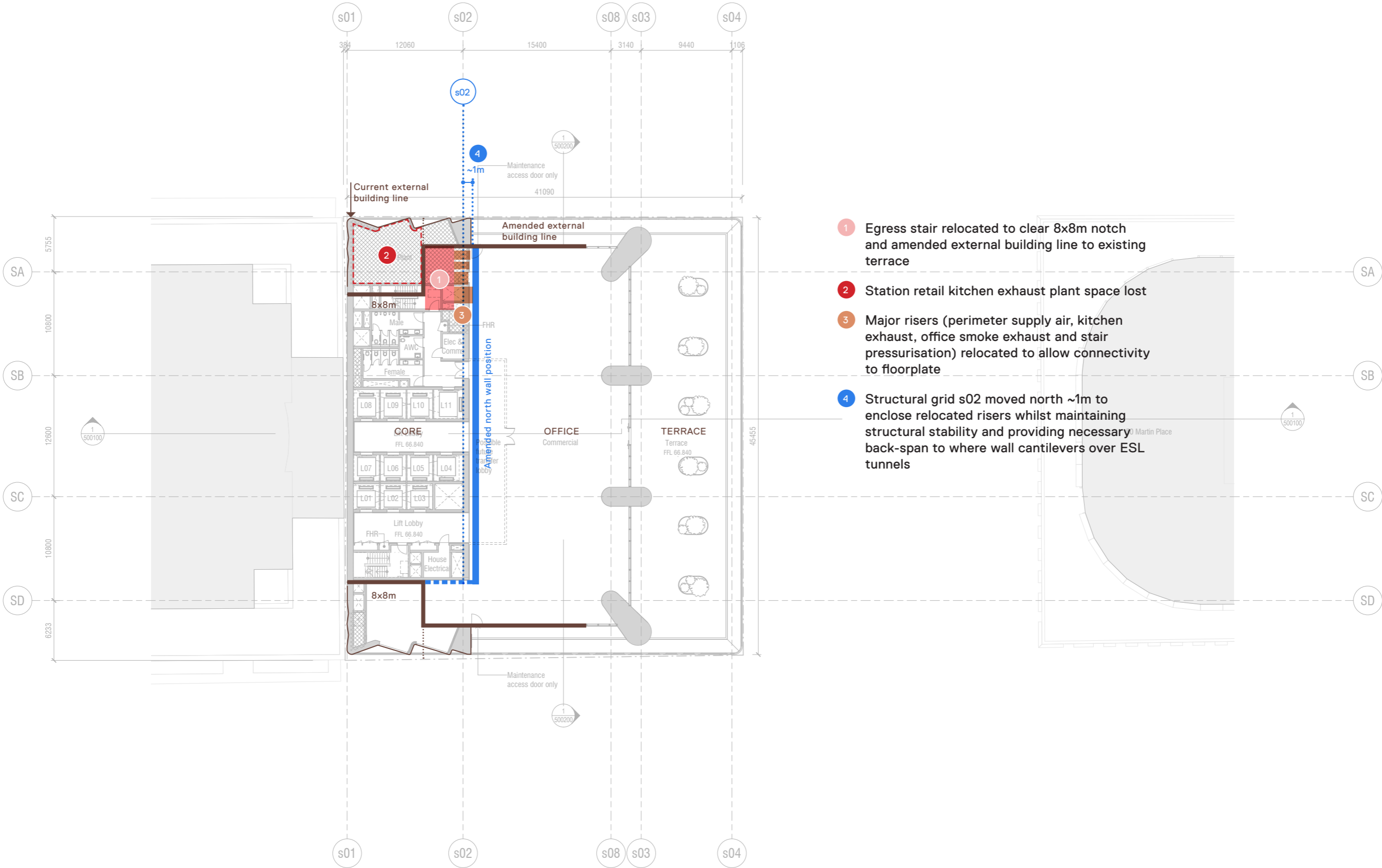

## Level 8 — Office

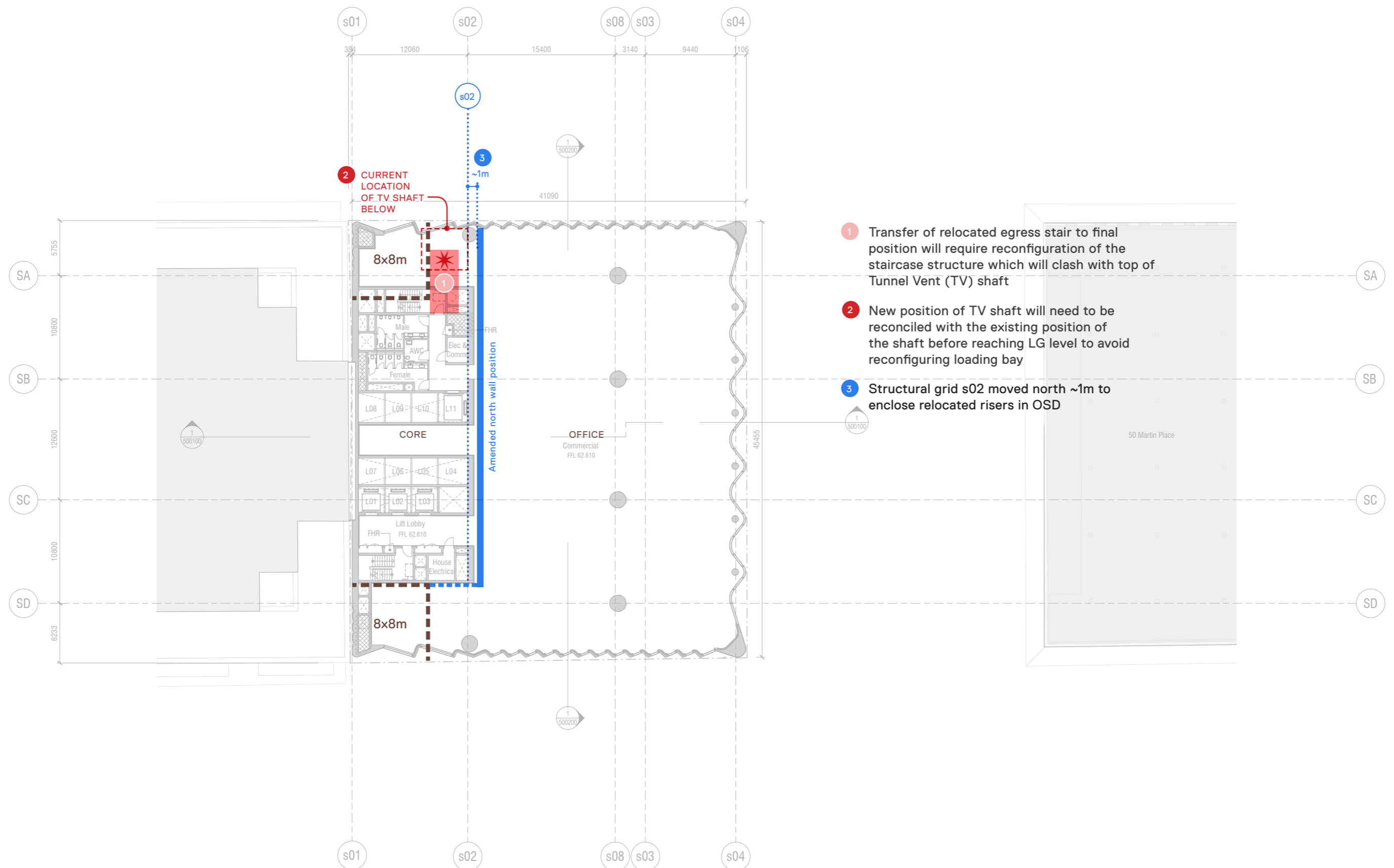

## Ground Floor (Elizabeth Street level)

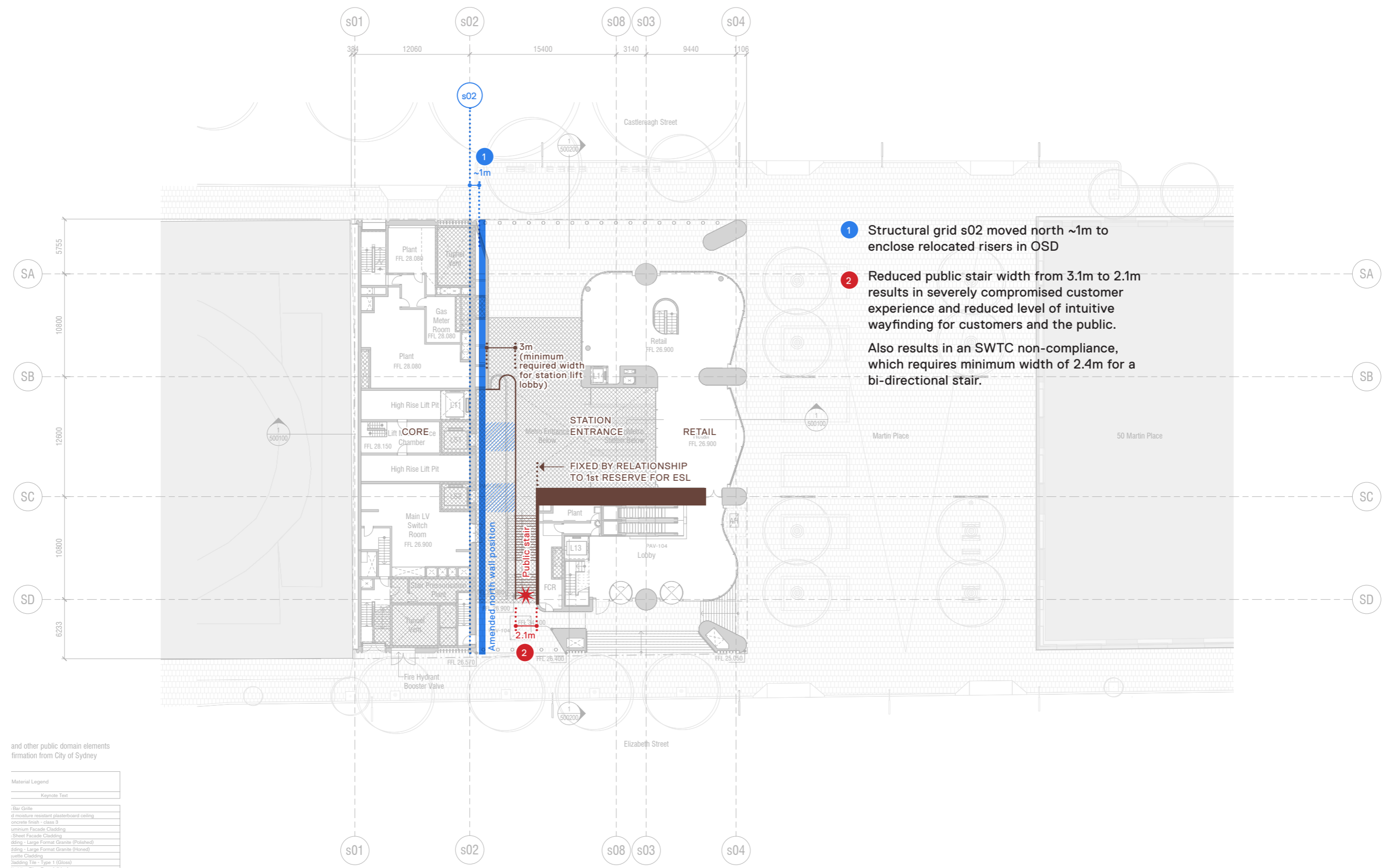

# Lower Ground (Castlereagh Street level)

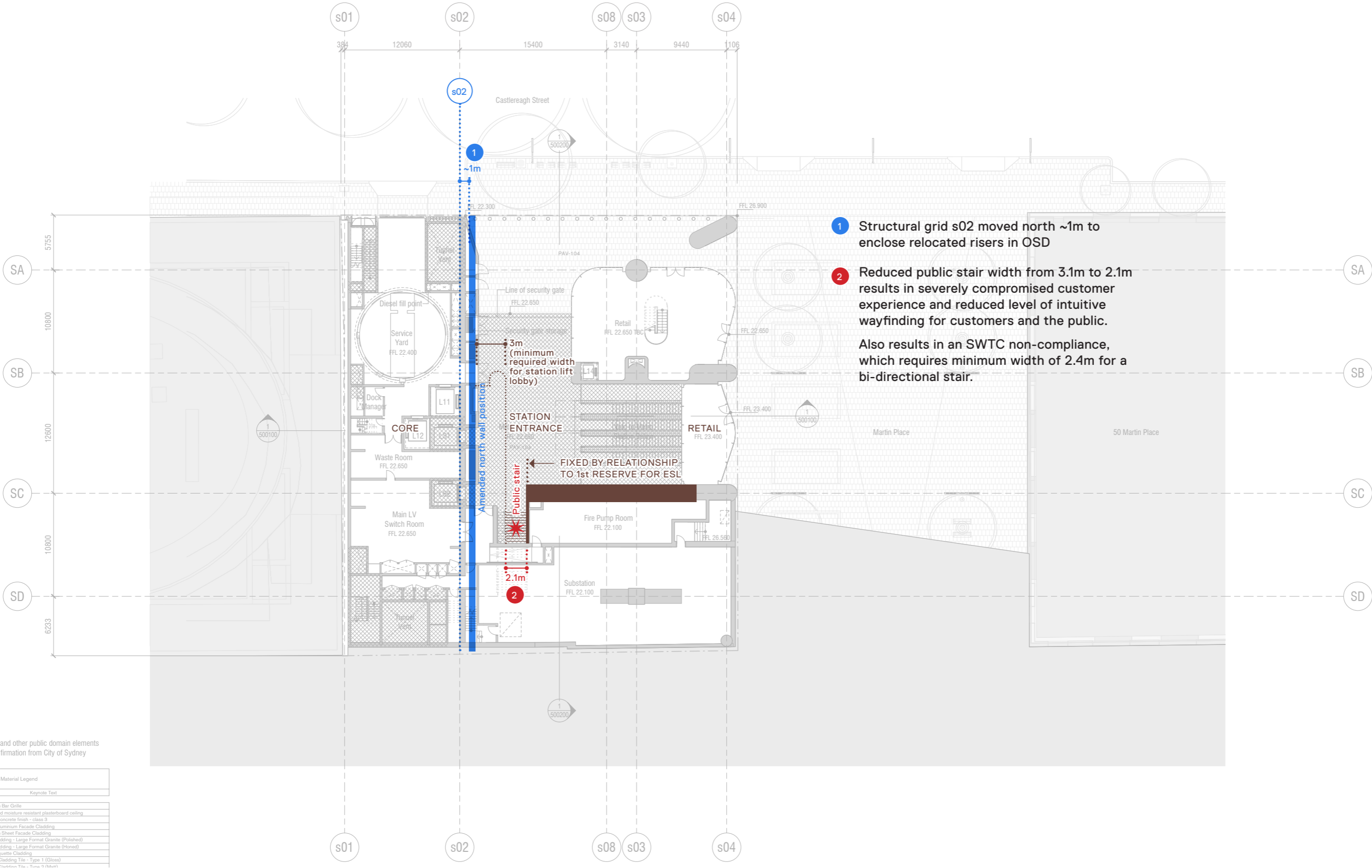

# Level B1 — Upper concourse

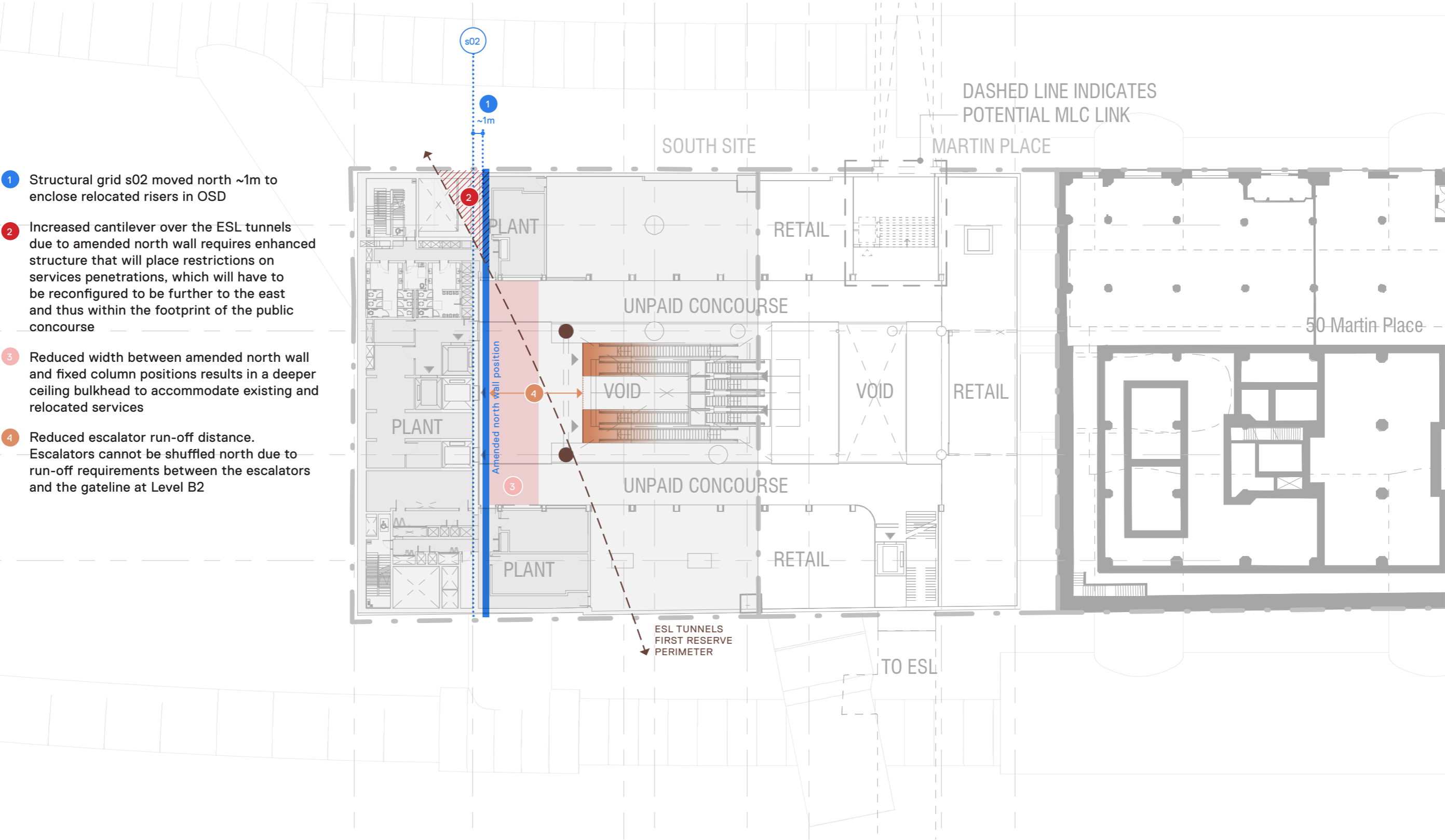

# Level B2 — Lower concourse

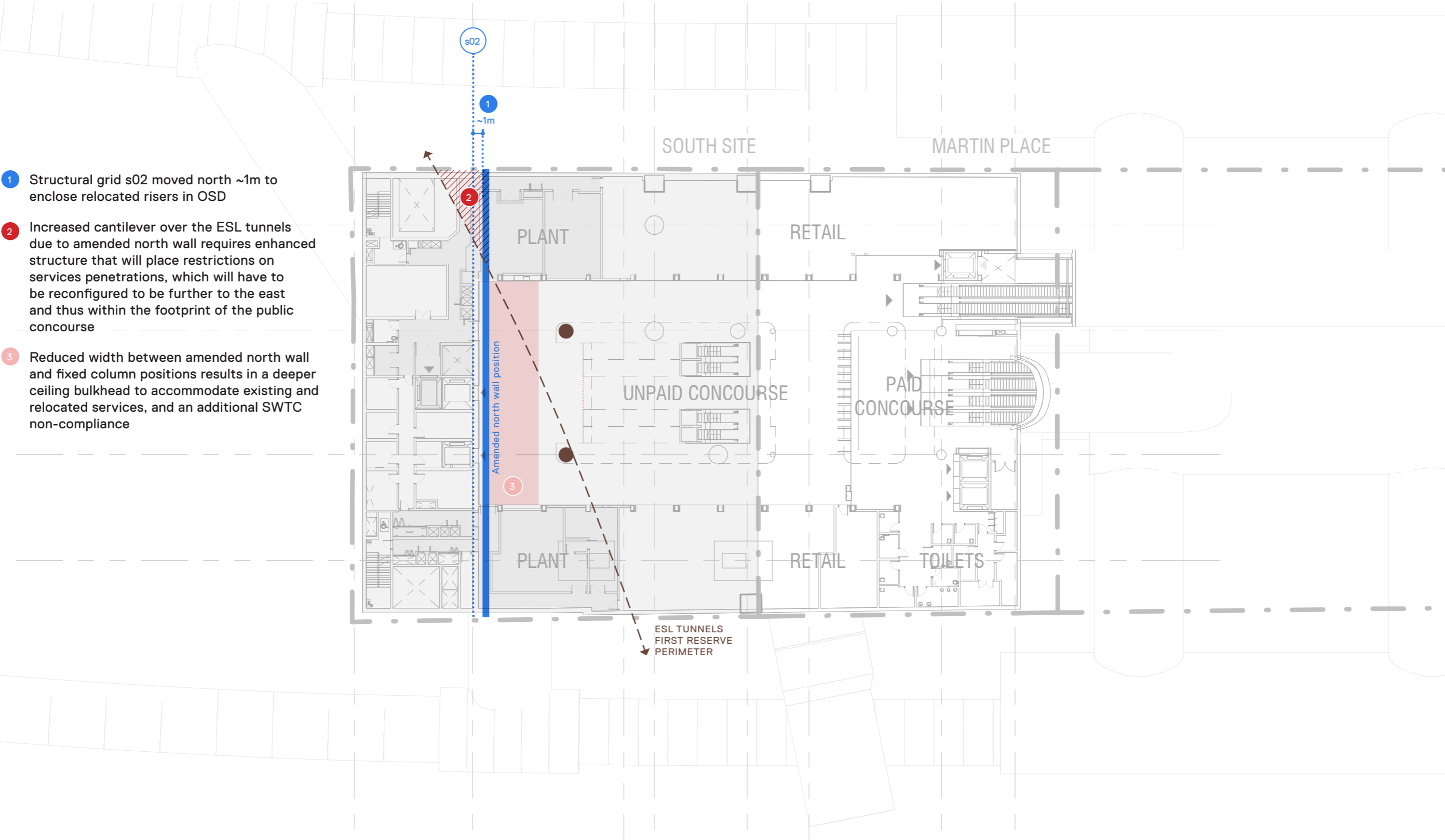

# Level B3 — Plant

- 1

Structural grid s02 moved north ~1m to enclose relocated risers in OSD, severely constraining services reticulation to the point where it may not be achievable.

This is due to the wall thickness increasing due to the extended cantilever limiting opportunities for services penetrations, creating a north-south barrier across floorplate.

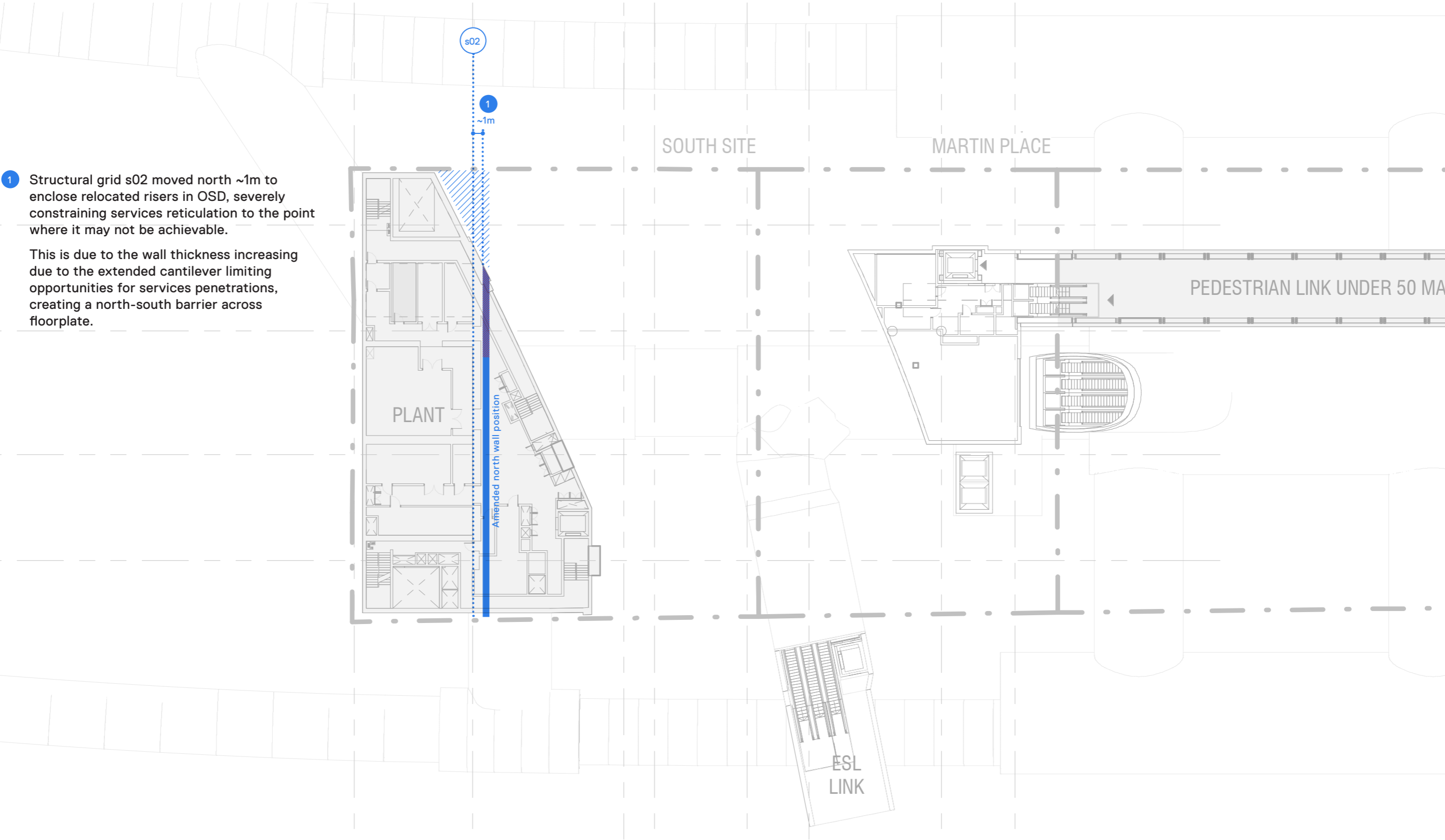

# Level B4 — Plant

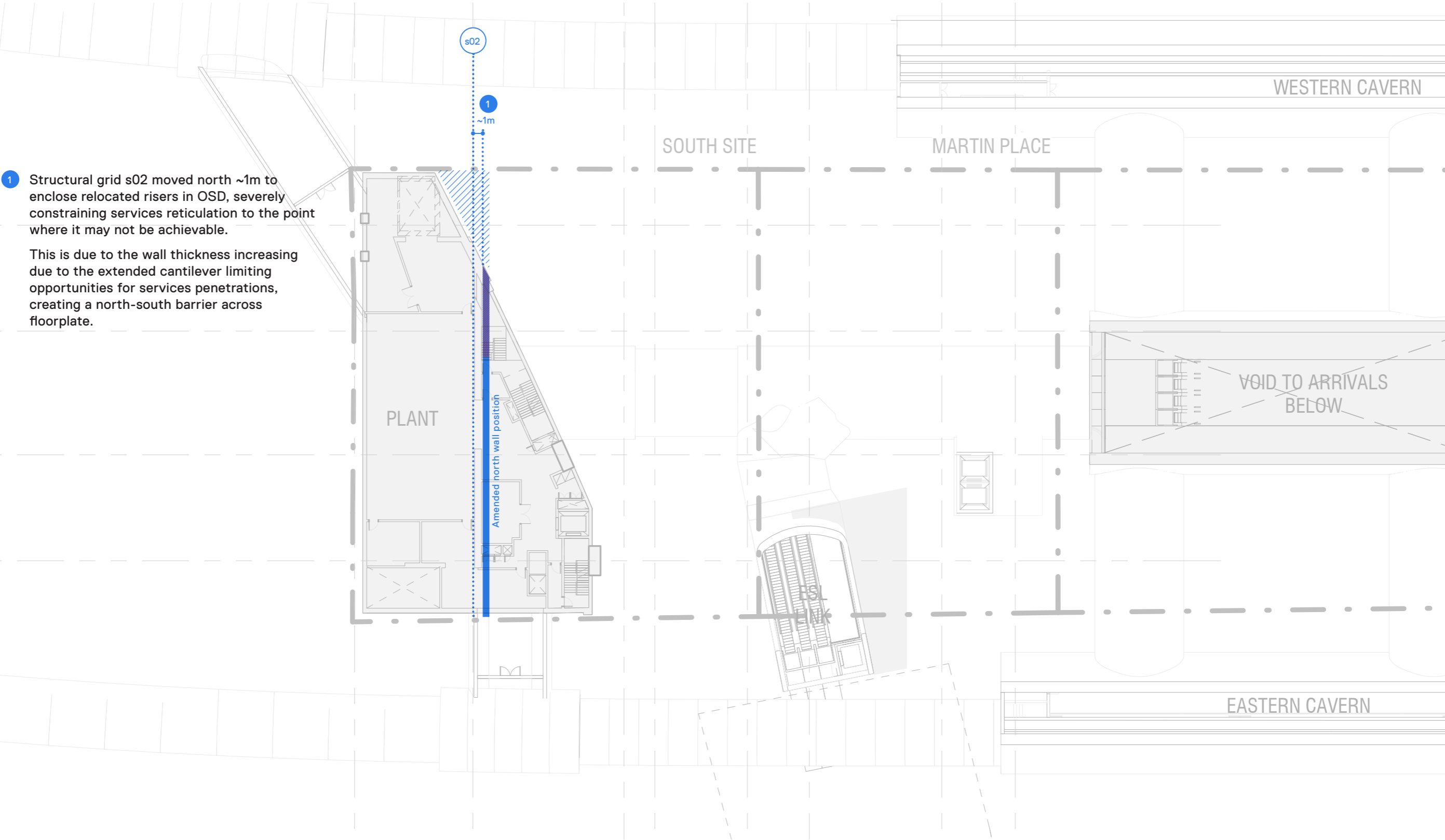

# Level B5 — Platform / plant

