



14 April, 9:00 AM AEST



Shadow cast by existing buildings



Stage 2 South Tower footprint



Stage 1 amending DA envelope with City
of Sydney suggested 8x8m notches



Additional shadow cast by proposed
stage 1 amending DA envelope



14 April, 10:00 AM AEST



Shadow cast by existing buildings



Stage 2 South Tower footprint



Stage 1 amending DA envelope with City of Sydney suggested 8x8m notches



Additional shadow cast by proposed stage 1 amending DA envelope



14 April, 11:00 AM AEST



Shadow cast by existing buildings



Stage 2 South Tower footprint



Stage 1 amending DA envelope with City of Sydney suggested 8x8m notches



Additional shadow cast by proposed stage 1 amending DA envelope

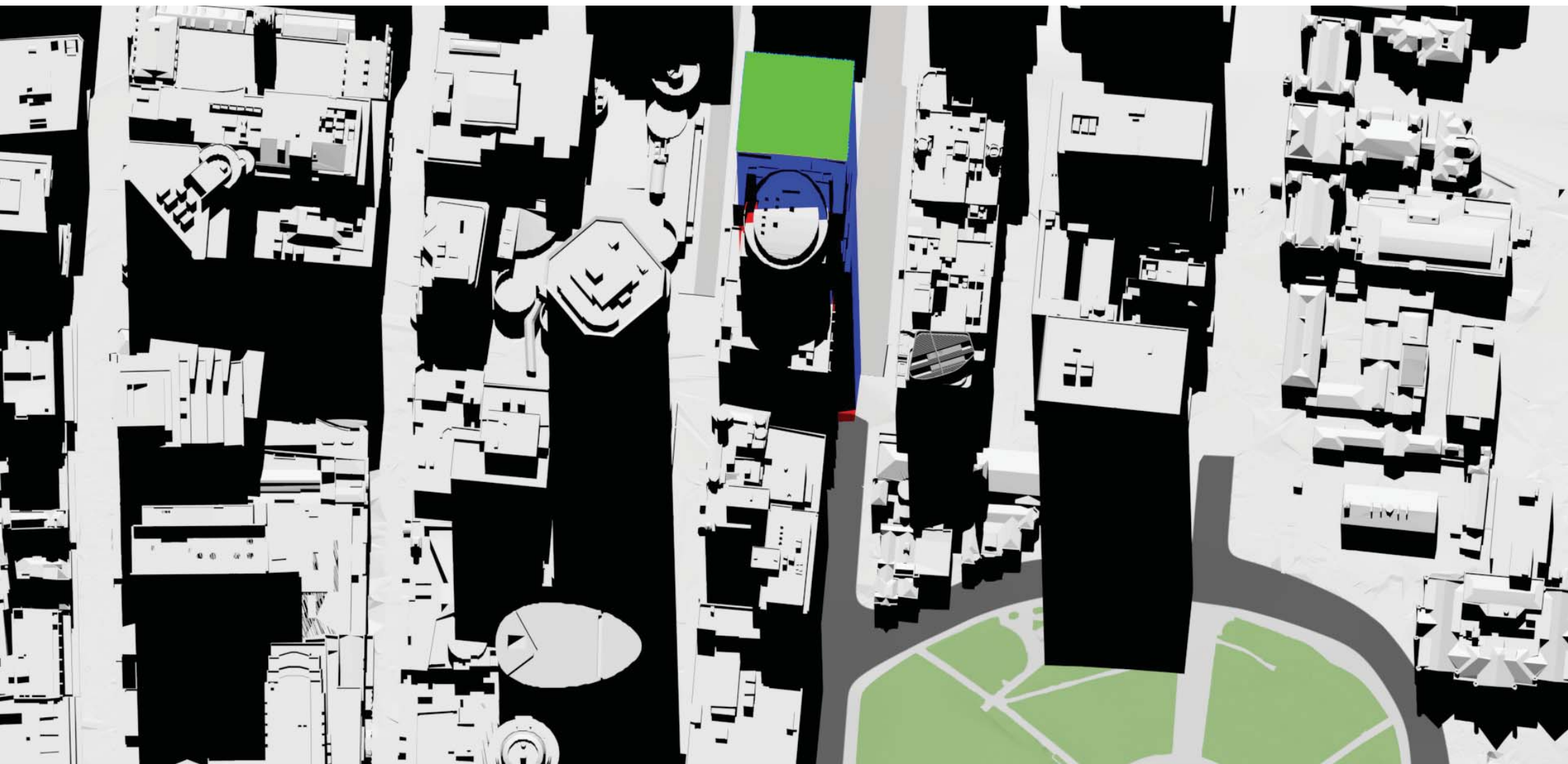

14 April, 12:00 PM AEST



Shadow cast by existing buildings



Stage 2 South Tower footprint



Stage 1 amending DA envelope with City of Sydney suggested 8x8m notches



Additional shadow cast by proposed stage 1 amending DA envelope



14 April, 1:00 PM AEST



Shadow cast by existing buildings



Stage 2 South Tower footprint



Stage 1 amending DA envelope with City
of Sydney suggested 8x8m notches



Additional shadow cast by proposed
stage 1 amending DA envelope

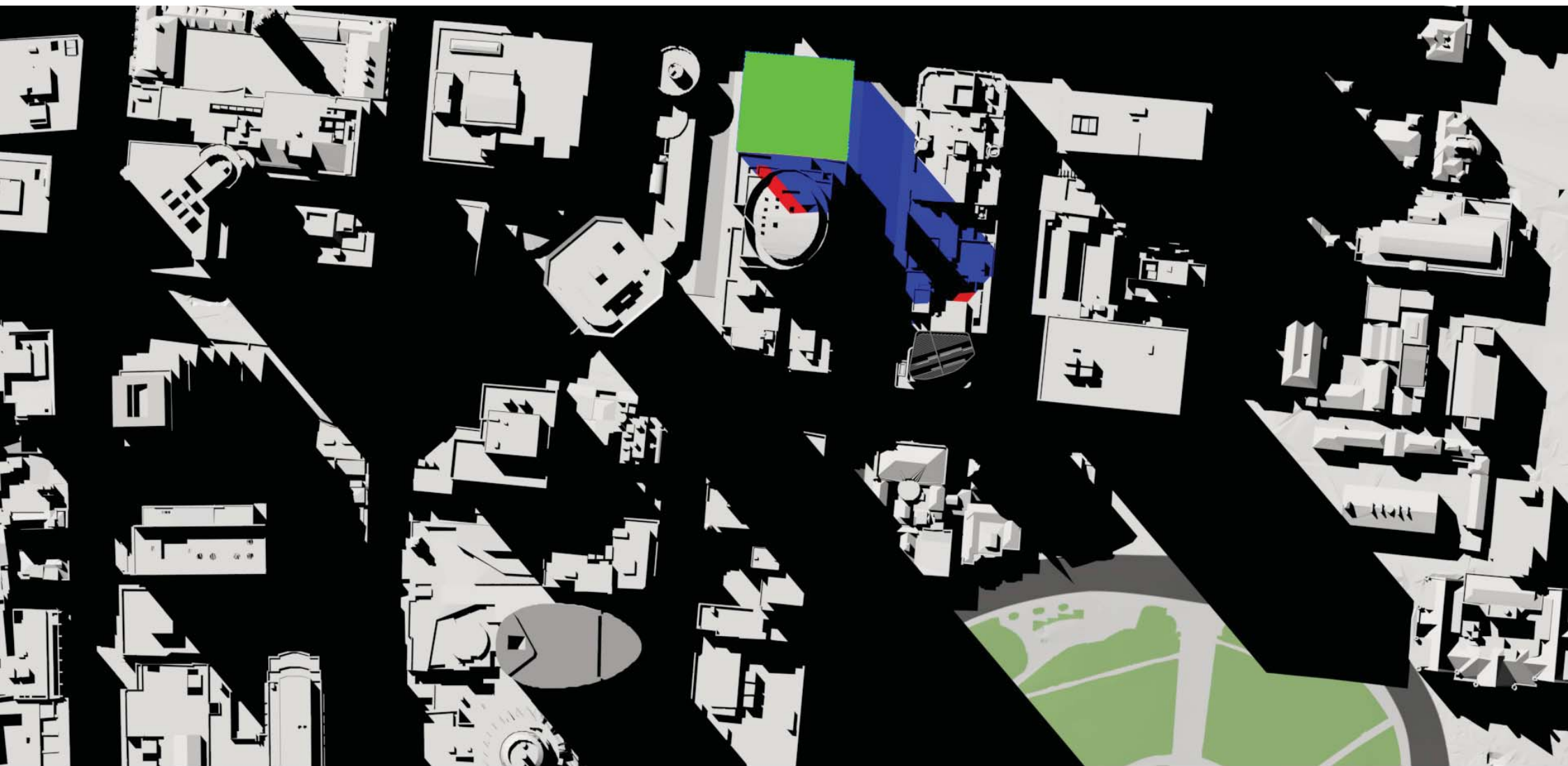

14 April, 2:00 PM AEST



Shadow cast by existing buildings



Stage 2 South Tower footprint



Stage 1 amending DA envelope with City
of Sydney suggested 8x8m notches



Additional shadow cast by proposed
stage 1 amending DA envelope

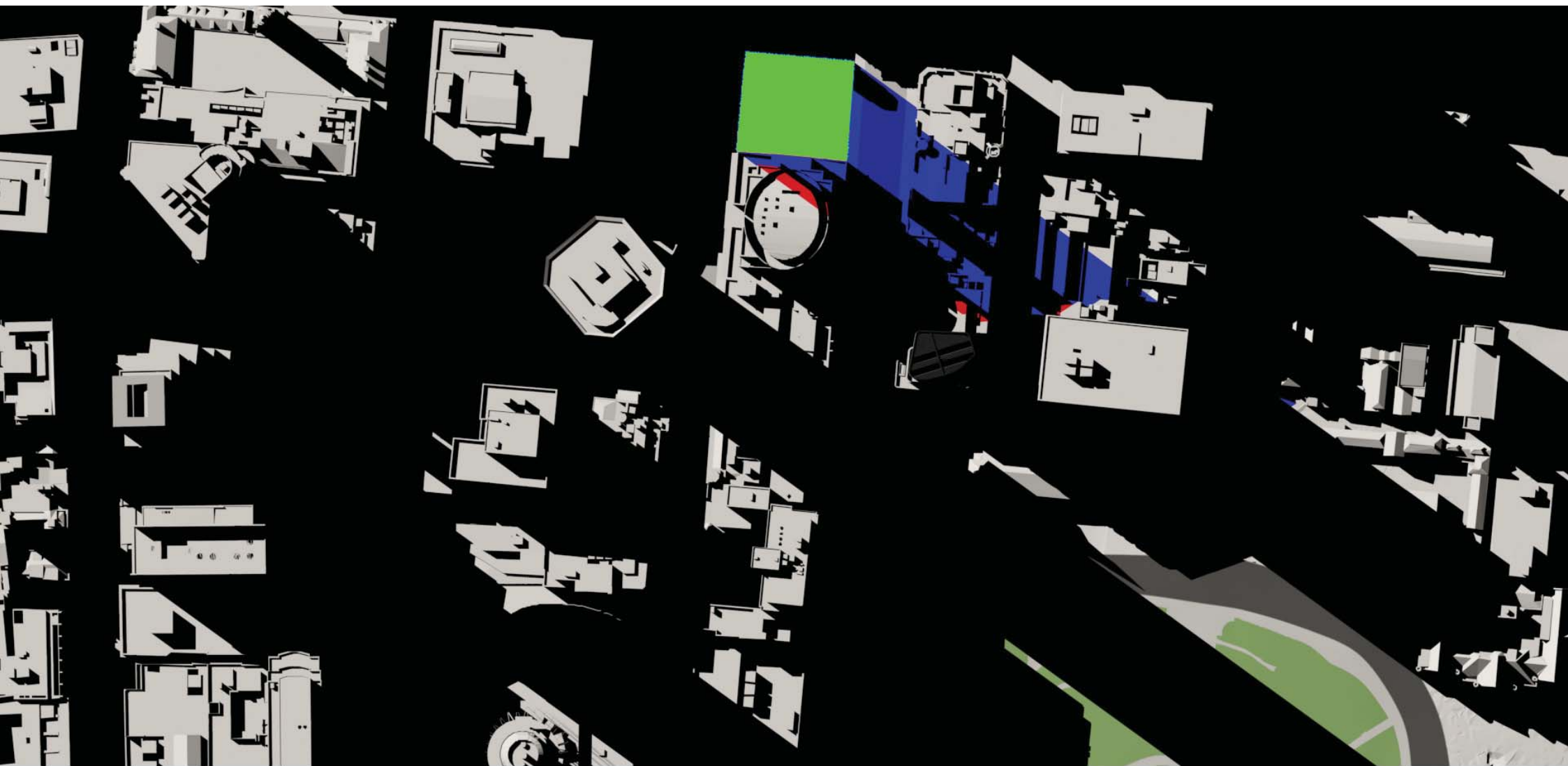

14 April, 3:00 PM AEST



Shadow cast by existing buildings



Stage 2 South Tower footprint



Stage 1 amending DA envelope with City of Sydney suggested 8x8m notches



Additional shadow cast by proposed stage 1 amending DA envelope



31 August, 9:00 AM AEST



Shadow cast by existing buildings



Stage 2 South Tower footprint



Stage 1 amending DA envelope with City
of Sydney suggested 8x8m notches



Additional shadow cast by proposed
stage 1 amending DA envelope



31 August, 10:00 AM AEST



Shadow cast by existing buildings



Stage 2 South Tower footprint



Stage 1 amending DA envelope with City of Sydney suggested 8x8m notches



Additional shadow cast by proposed stage 1 amending DA envelope



31 August, 11:00 AM AEST



Shadow cast by existing buildings



Stage 2 South Tower footprint



Stage 1 amending DA envelope with City of Sydney suggested 8x8m notches



Additional shadow cast by proposed stage 1 amending DA envelope

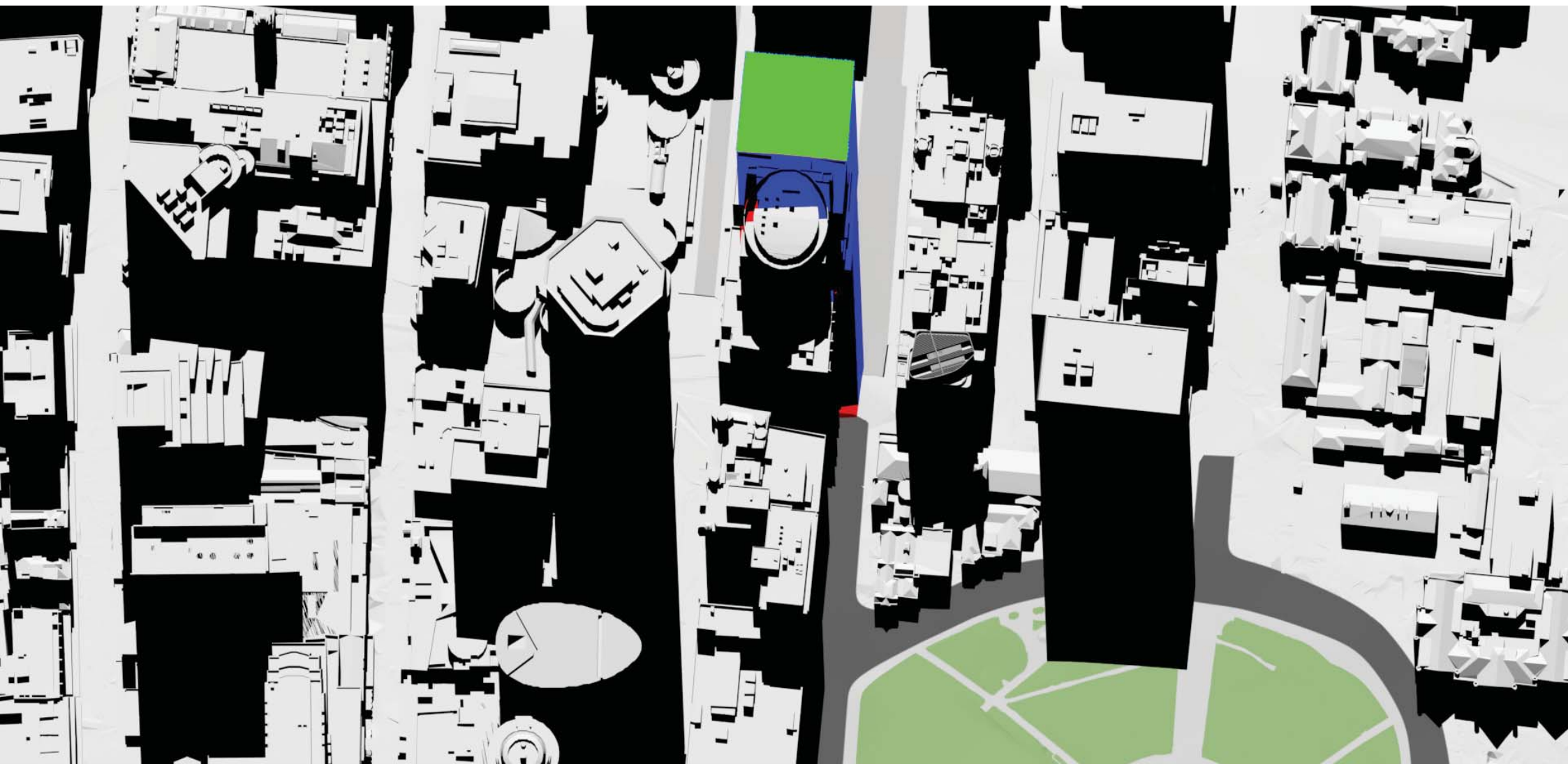

31 August, 12:00 PM AEST



Shadow cast by existing buildings



Stage 2 South Tower footprint



Stage 1 amending DA envelope with City
of Sydney suggested 8x8m notches



Additional shadow cast by proposed
stage 1 amending DA envelope



31 August, 1:00 PM AEST



Shadow cast by existing buildings



Stage 2 South Tower footprint



Stage 1 amending DA envelope with City of Sydney suggested 8x8m notches



Additional shadow cast by proposed stage 1 amending DA envelope

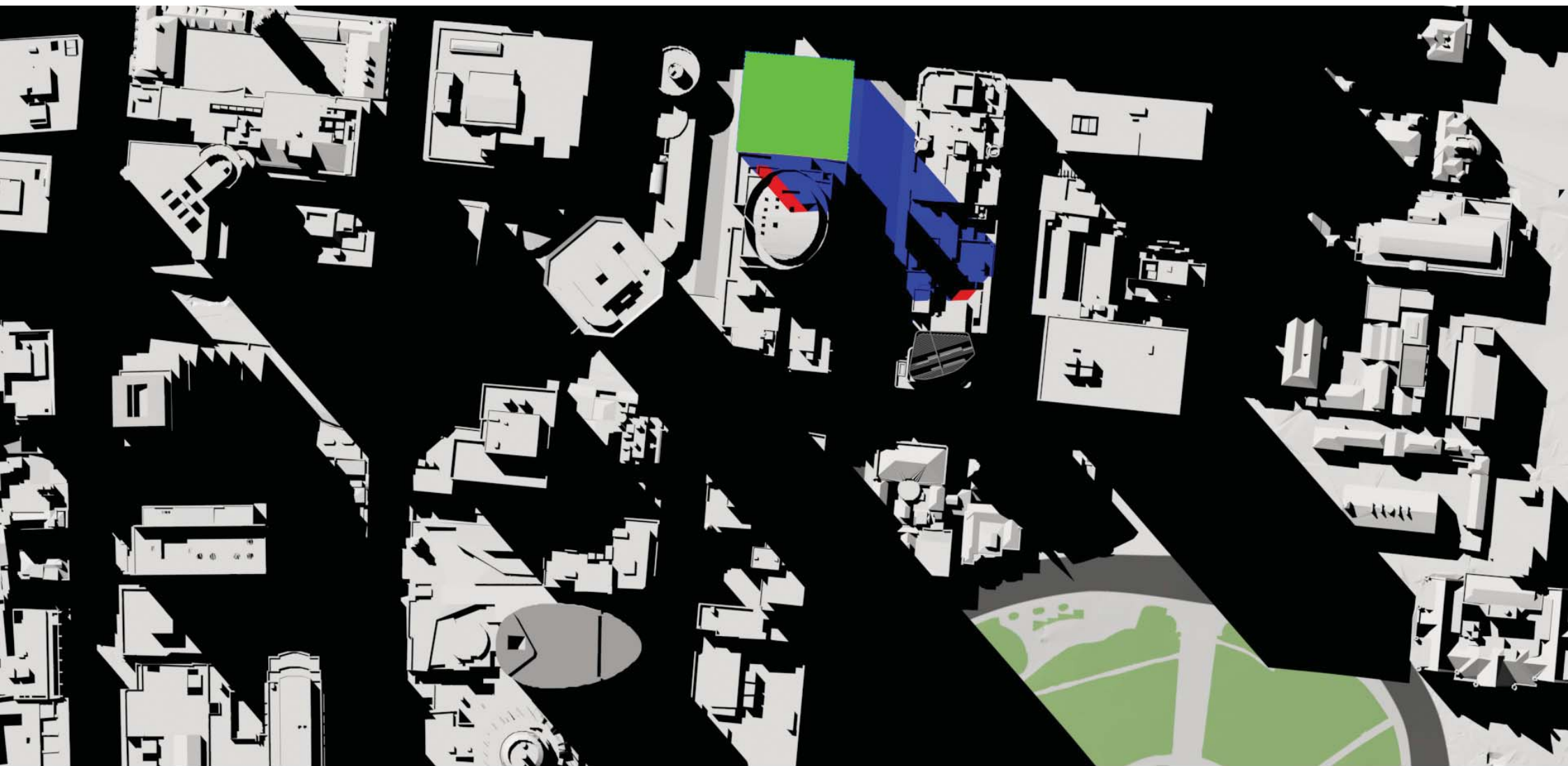

31 August, 2:00 PM AEST



Shadow cast by existing buildings



Stage 2 South Tower footprint



Stage 1 amending DA envelope with City
of Sydney suggested 8x8m notches



Additional shadow cast by proposed
stage 1 amending DA envelope

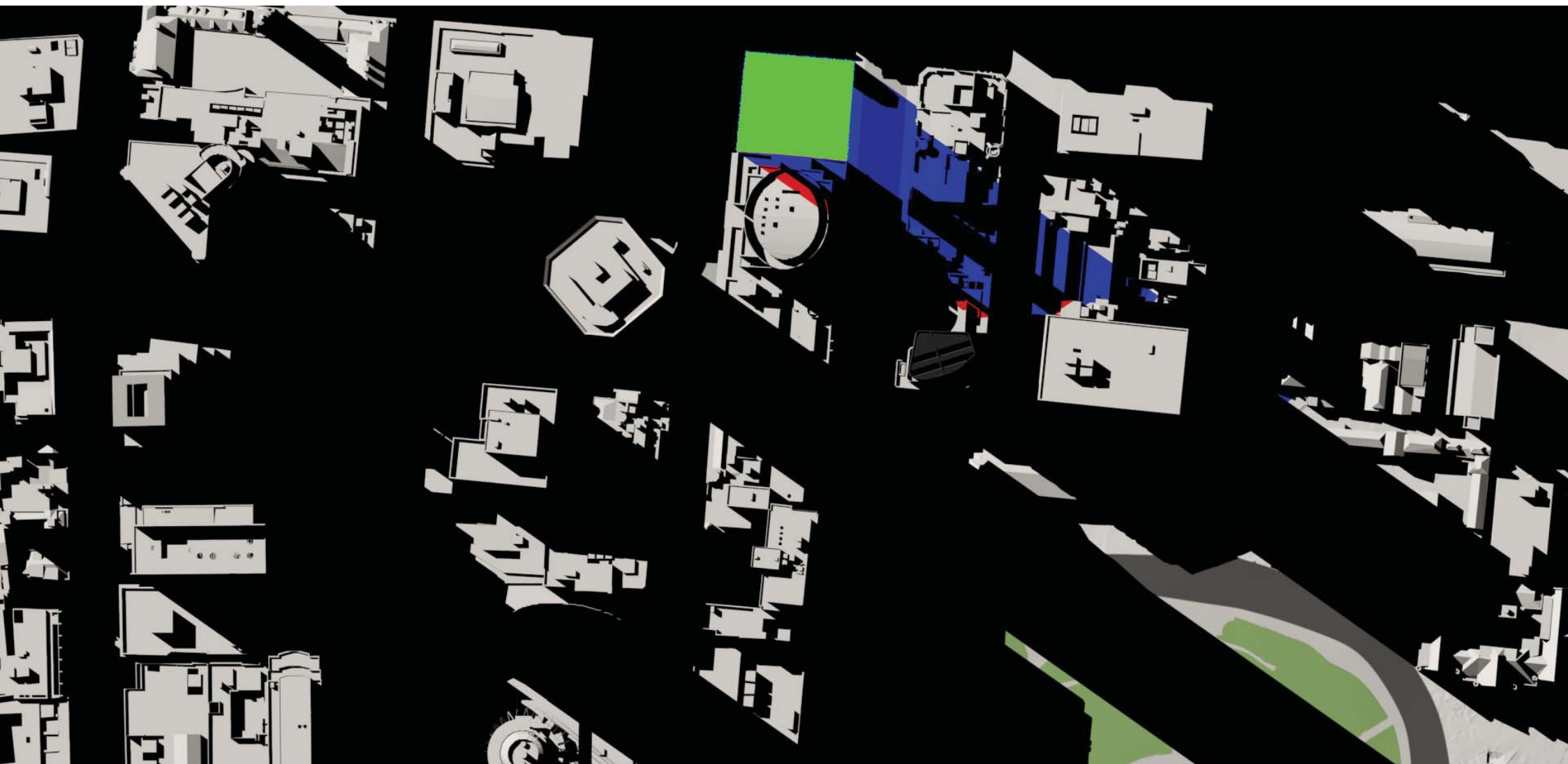

31 August, 3:00 PM AEST



Shadow cast by existing buildings



Stage 2 South Tower footprint



Stage 1 amending DA envelope with City of Sydney suggested 8x8m notches



Additional shadow cast by proposed stage 1 amending DA envelope

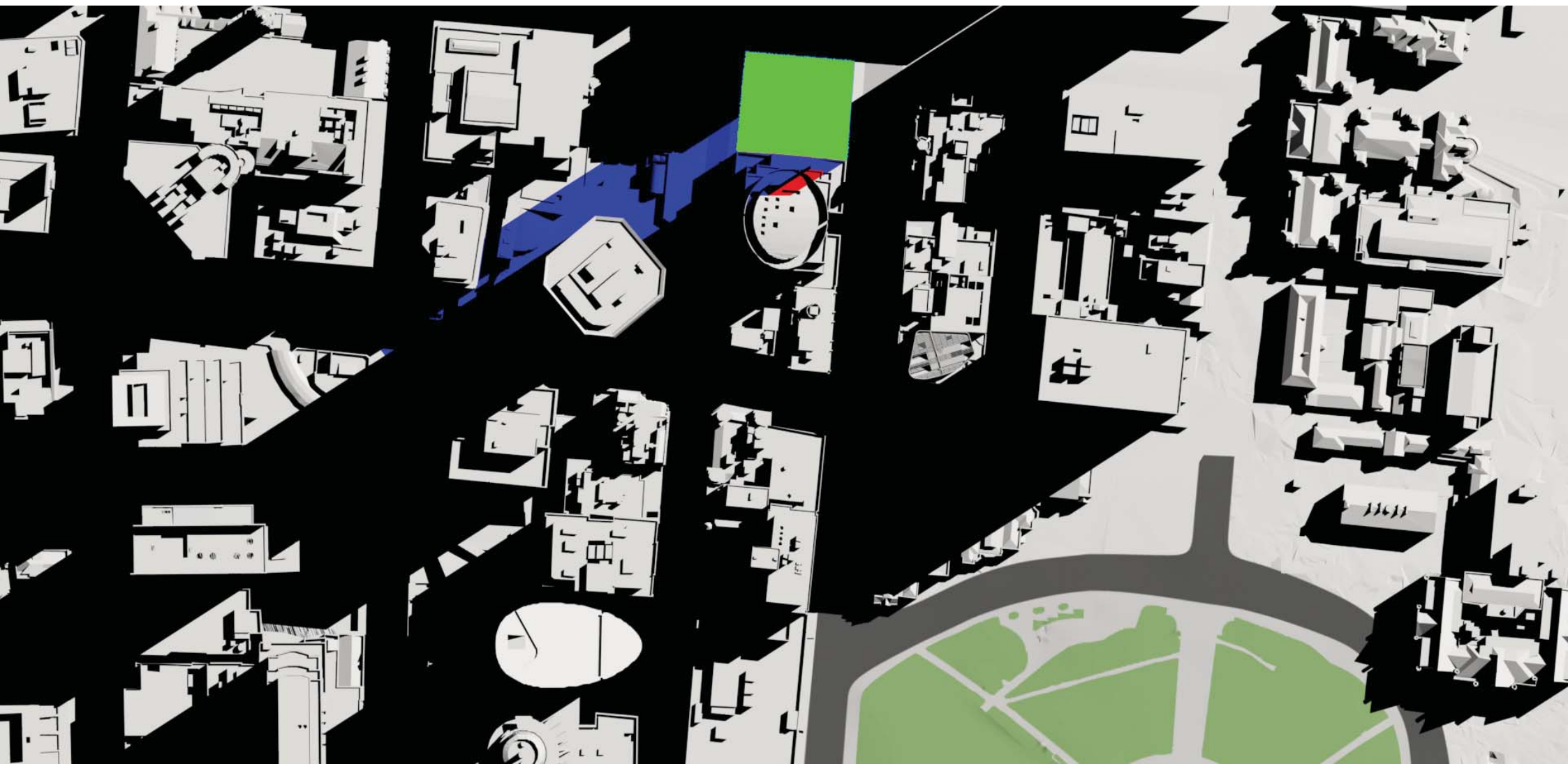

21 September, 9:00 AM AEST



Shadow cast by existing buildings



Stage 2 South Tower footprint



Stage 1 amending DA envelope with City of Sydney suggested 8x8m notches



Additional shadow cast by proposed stage 1 amending DA envelope

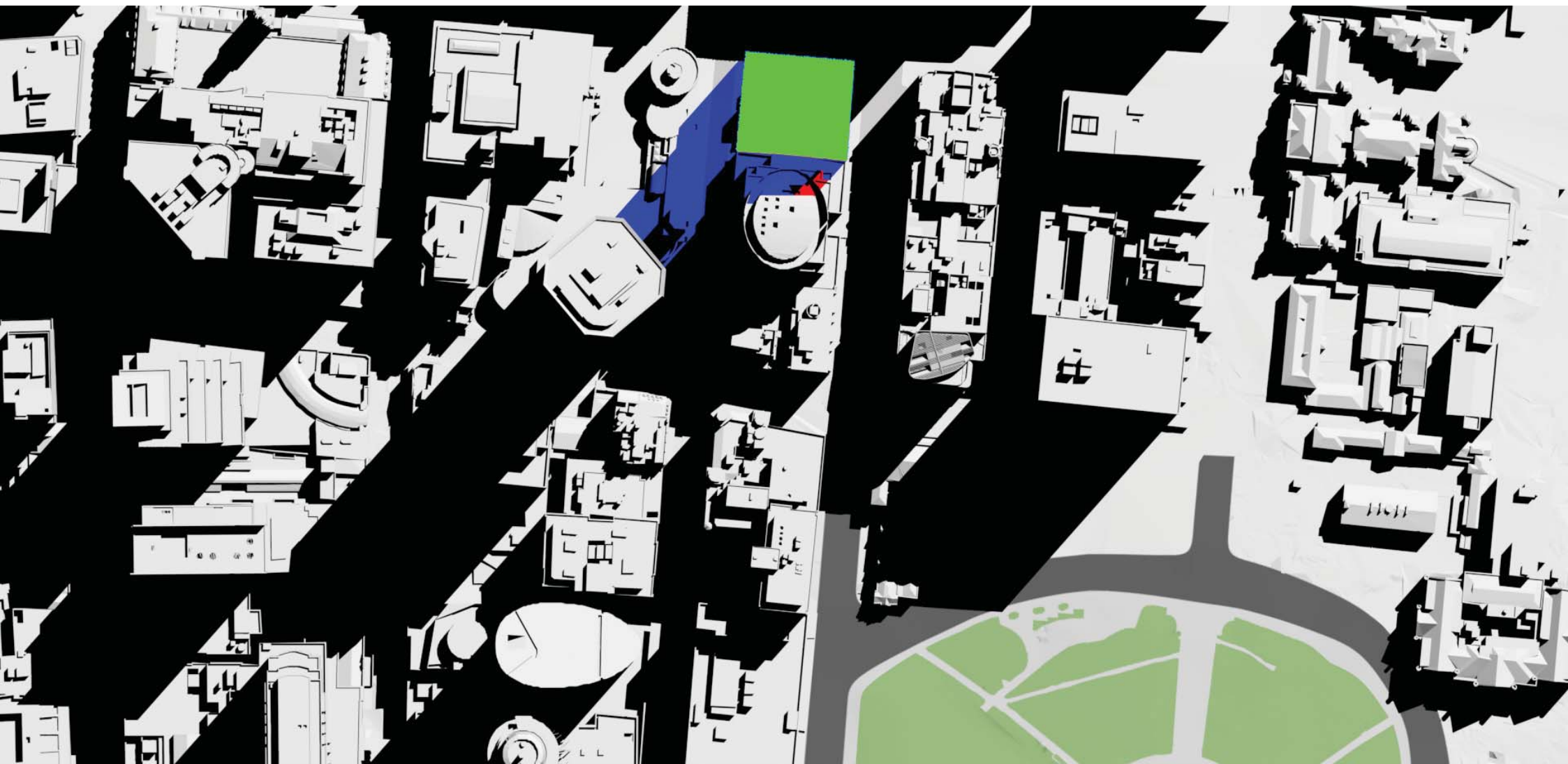

21 September, 10:00 AM AEST



Shadow cast by existing buildings



Stage 2 South Tower footprint



Stage 1 amending DA envelope with City of Sydney suggested 8x8m notches



Additional shadow cast by proposed stage 1 amending DA envelope

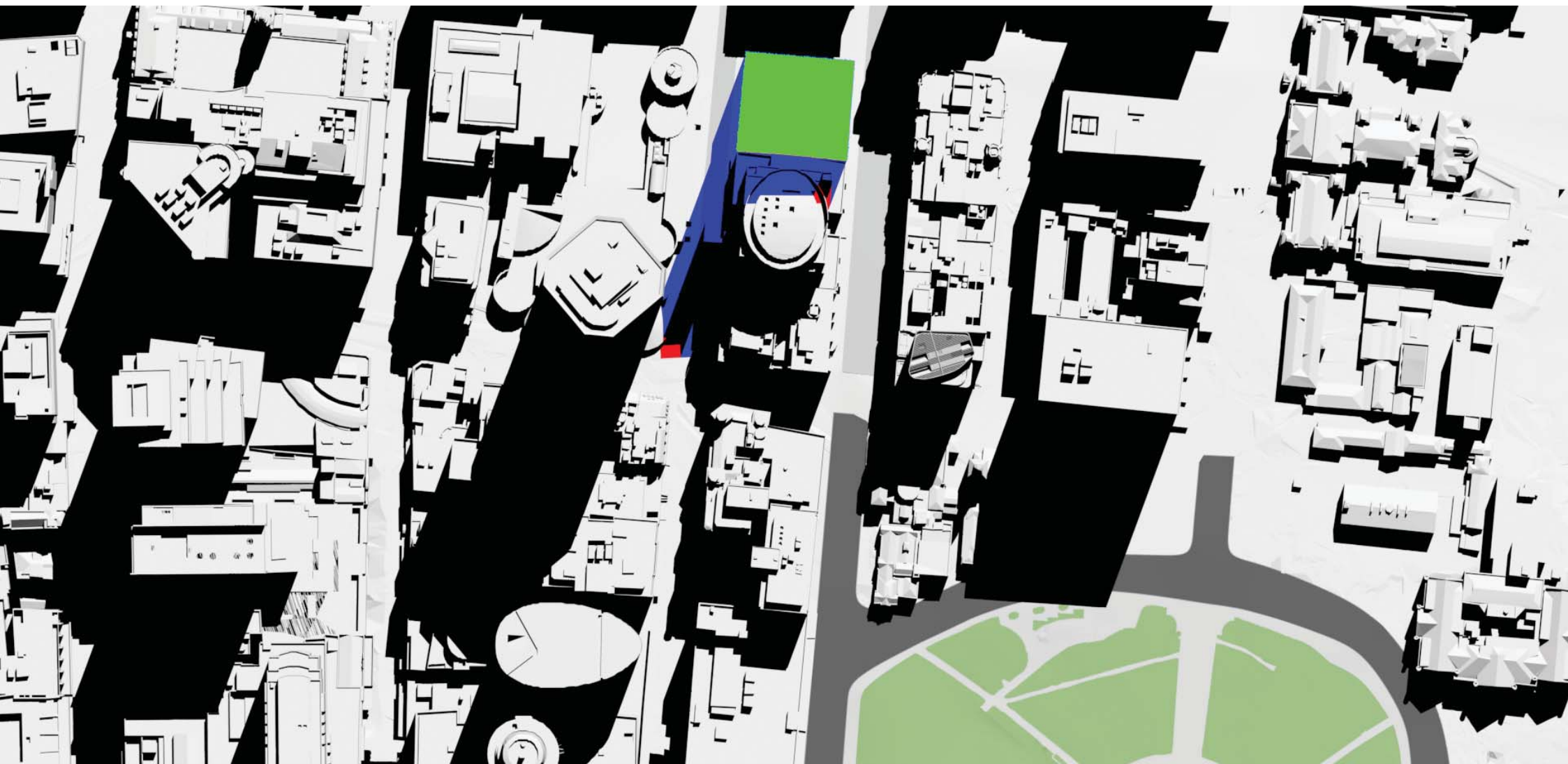

21 September, 11:00 AM AEST



Shadow cast by existing buildings



Stage 2 South Tower footprint



Stage 1 amending DA envelope with City of Sydney suggested 8x8m notches



Additional shadow cast by proposed stage 1 amending DA envelope



21 September, 12:00 PM AEST



Shadow cast by existing buildings



Stage 2 South Tower footprint



Stage 1 amending DA envelope with City of Sydney suggested 8x8m notches



Additional shadow cast by proposed stage 1 amending DA envelope

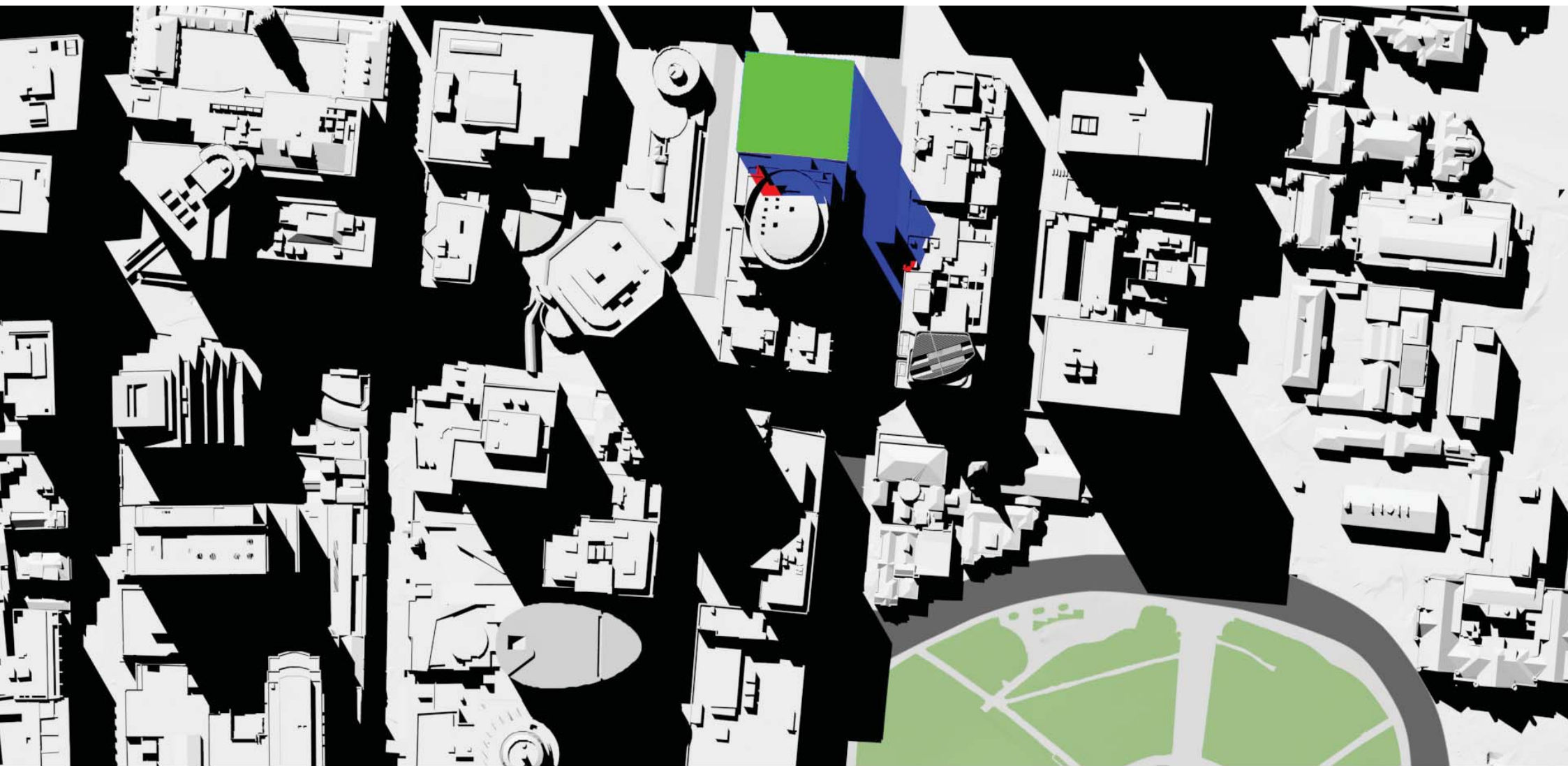

21 September, 1:00 PM AEST



Shadow cast by existing buildings



Stage 2 South Tower footprint



Stage 1 amending DA envelope with City of Sydney suggested 8x8m notches



Additional shadow cast by proposed stage 1 amending DA envelope



21 September, 2:00 PM AEST



Shadow cast by existing buildings



Stage 2 South Tower footprint



Stage 1 amending DA envelope with City
of Sydney suggested 8x8m notches



Additional shadow cast by proposed
stage 1 amending DA envelope

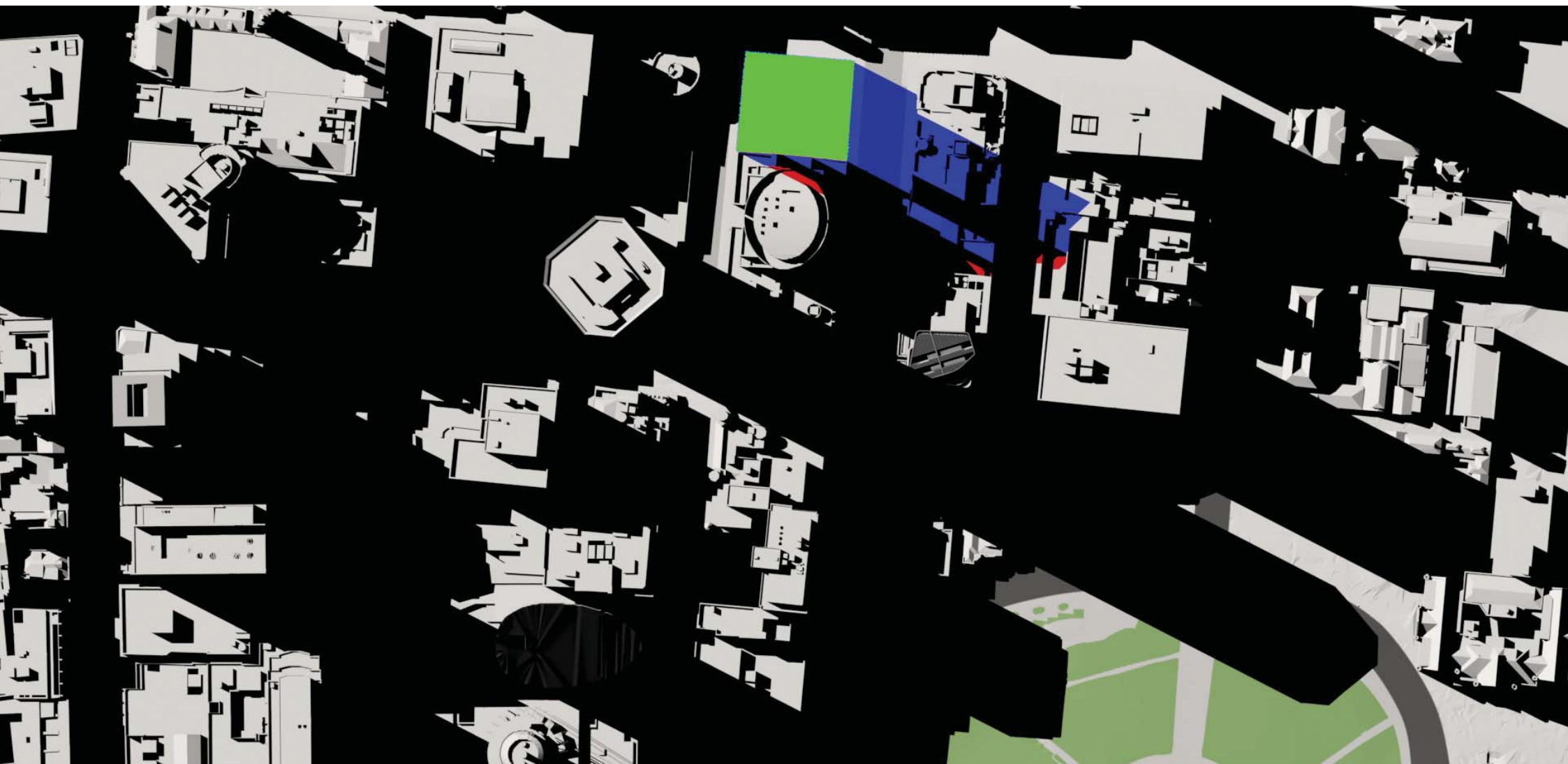

21 September, 3:00 PM AEST



Shadow cast by existing buildings



Stage 2 South Tower footprint



Stage 1 amending DA envelope with City of Sydney suggested 8x8m notches



Additional shadow cast by proposed stage 1 amending DA envelope



21 December, 9:00 AM AEDT



Shadow cast by existing buildings



Stage 2 South Tower footprint



Stage 1 amending DA envelope with City of Sydney suggested 8x8m notches



Additional shadow cast by proposed stage 1 amending DA envelope



21 December, 10:00 AM AEDT



Shadow cast by existing buildings



Stage 2 South Tower footprint



Stage 1 amending DA envelope with City
of Sydney suggested 8x8m notches



Additional shadow cast by proposed
stage 1 amending DA envelope



21 December, 11:00 AM AEDT



Shadow cast by existing buildings



Stage 2 South Tower footprint



Stage 1 amending DA envelope with City of Sydney suggested 8x8m notches



Additional shadow cast by proposed stage 1 amending DA envelope

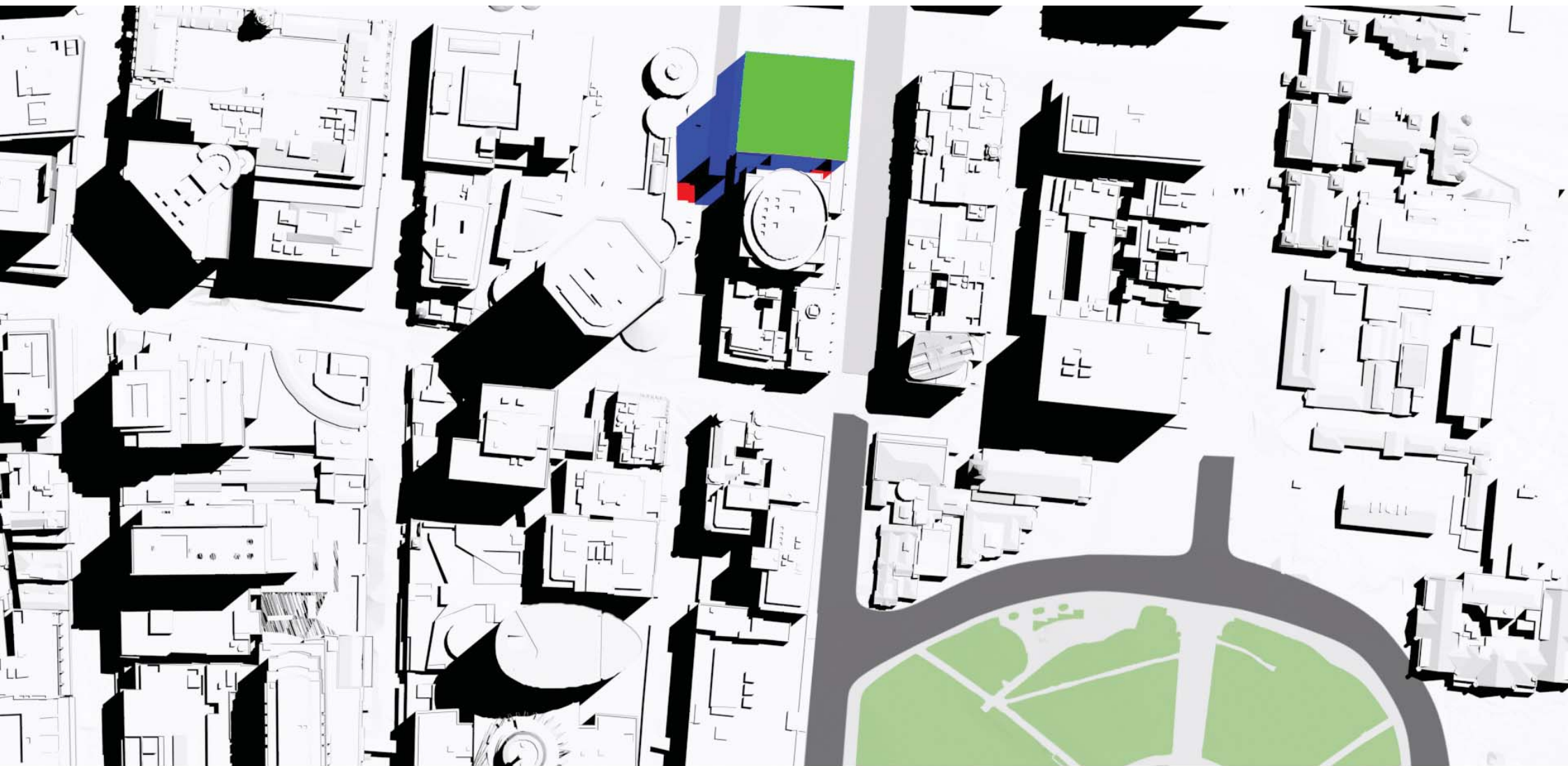

21 December, 12:00 PM AEDT



Shadow cast by existing buildings



Stage 2 South Tower footprint



Stage 1 amending DA envelope with City
of Sydney suggested 8x8m notches



Additional shadow cast by proposed
stage 1 amending DA envelope

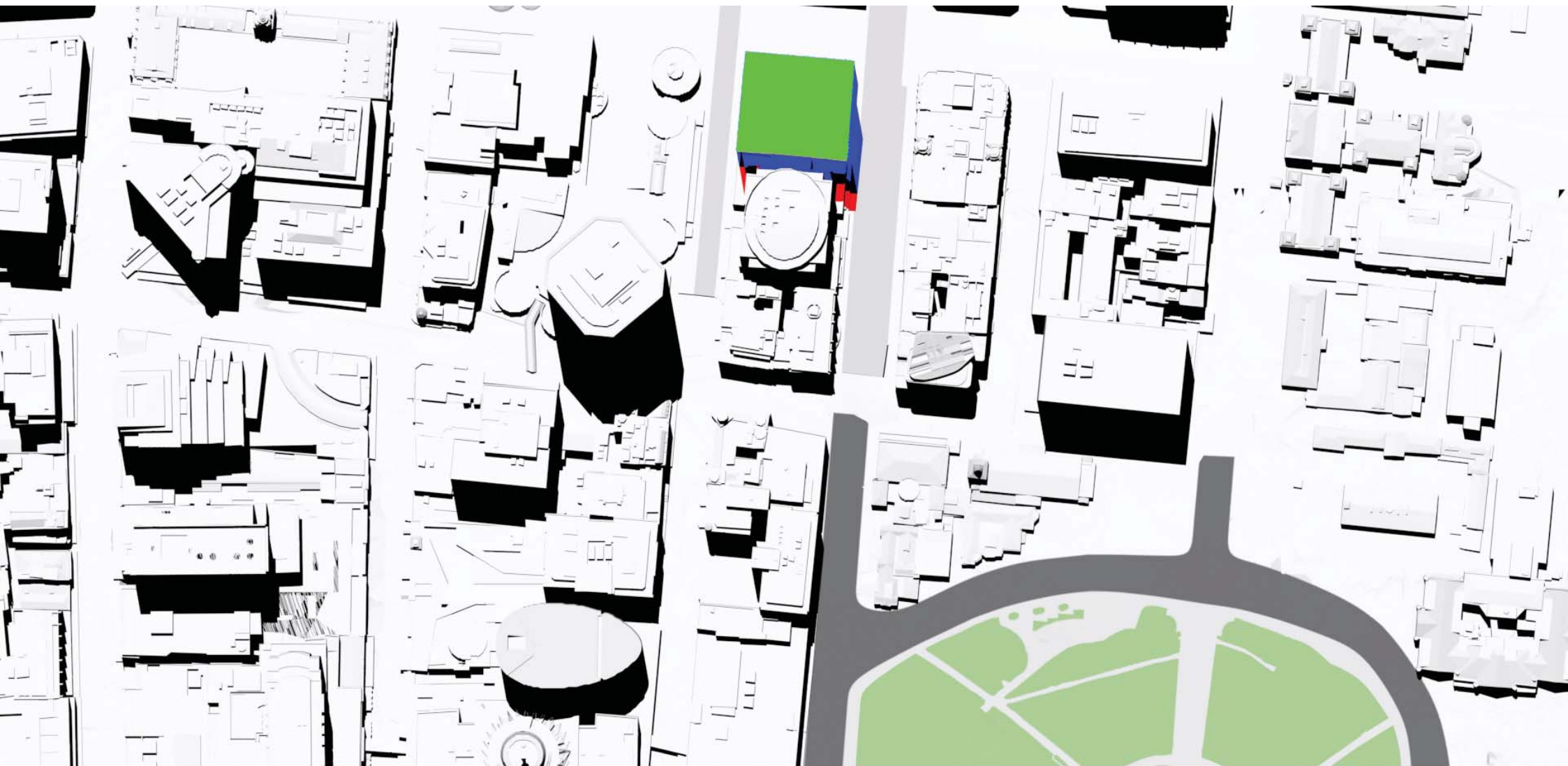

21 December, 1:00 PM AEDT



Shadow cast by existing buildings



Stage 2 South Tower footprint



Stage 1 amending DA envelope with City
of Sydney suggested 8x8m notches



Additional shadow cast by proposed
stage 1 amending DA envelope



21 December, 2:00 PM AEDT



Shadow cast by existing buildings



Stage 2 South Tower footprint



Stage 1 amending DA envelope with City of Sydney suggested 8x8m notches



Additional shadow cast by proposed stage 1 amending DA envelope



21 December, 3:00 PM AEDT



Shadow cast by existing buildings



Stage 2 South Tower footprint



Stage 1 amending DA envelope with City of Sydney suggested 8x8m notches



Additional shadow cast by proposed stage 1 amending DA envelope

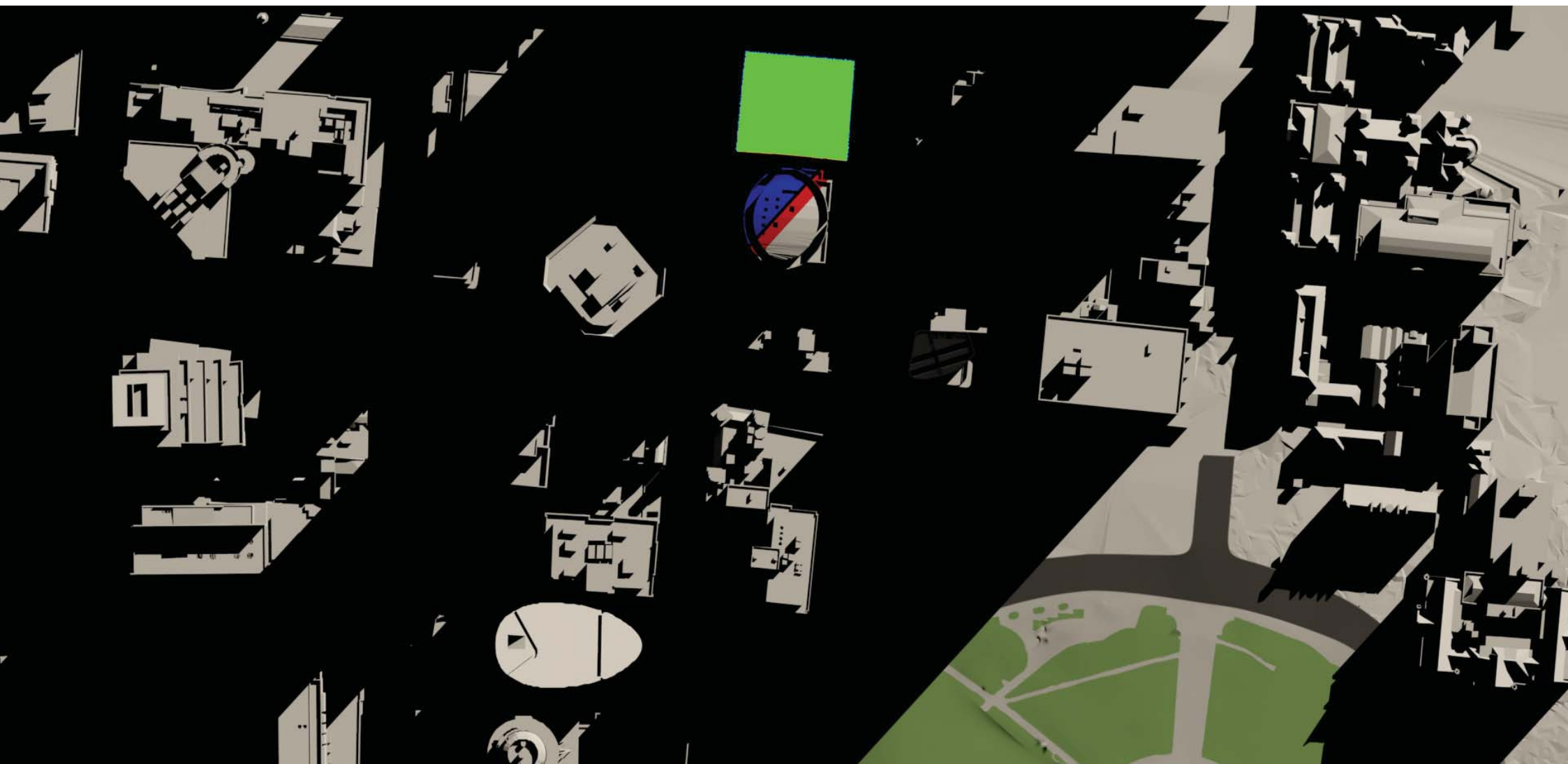

21 June, 9:00 AM AEST



Shadow cast by existing buildings



Stage 2 South Tower footprint



Stage 1 amending DA envelope with City of Sydney suggested 8x8m notches



Additional shadow cast by proposed stage 1 amending DA envelope

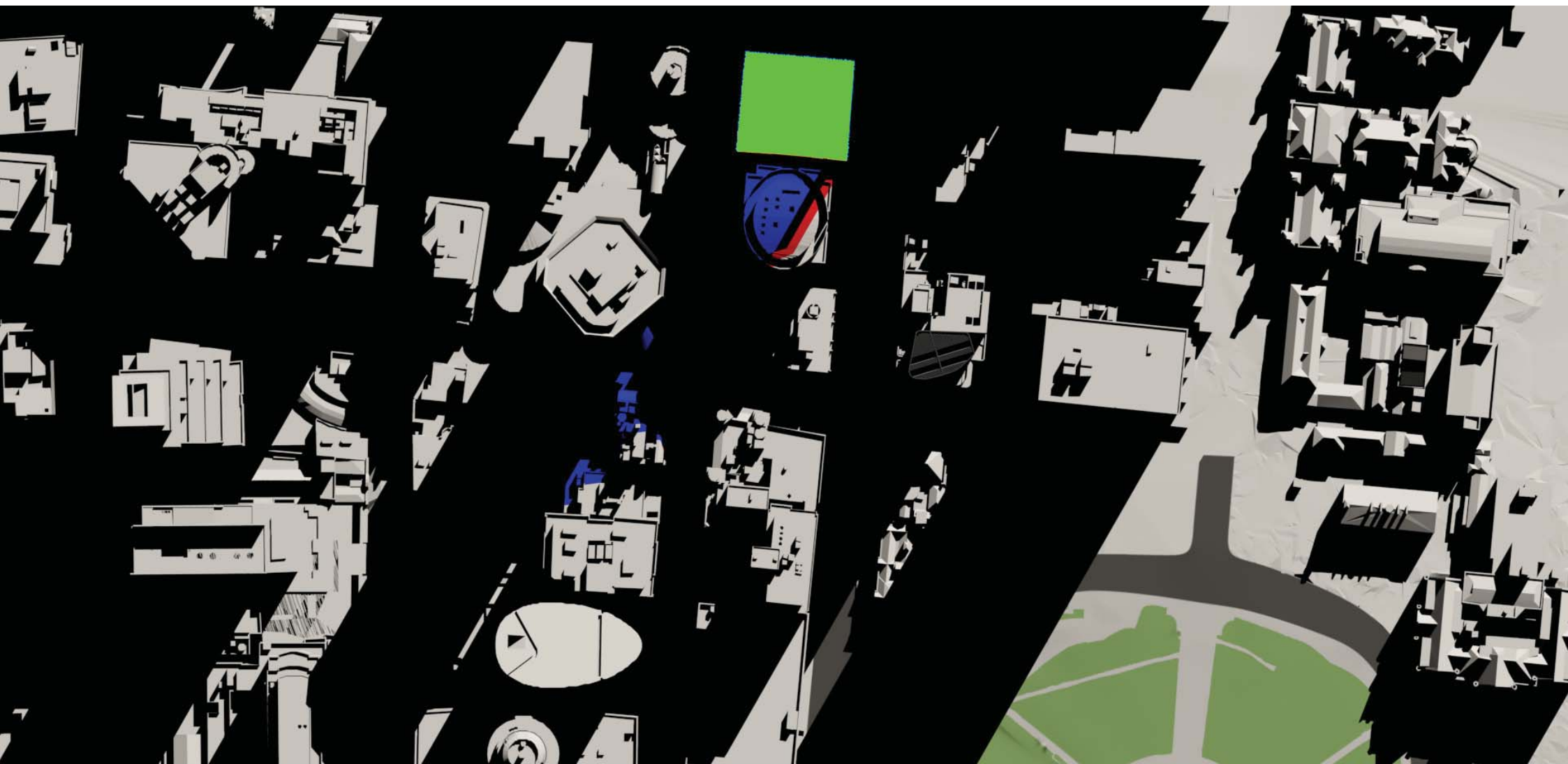

21 June, 10:00 AM AEST



Shadow cast by existing buildings



Stage 2 South Tower footprint



Stage 1 amending DA envelope with City of Sydney suggested 8x8m notches



Additional shadow cast by proposed stage 1 amending DA envelope



21 June, 11:00 AM AEST



Shadow cast by existing buildings



Stage 2 South Tower footprint



Stage 1 amending DA envelope with City of Sydney suggested 8x8m notches



Additional shadow cast by proposed stage 1 amending DA envelope

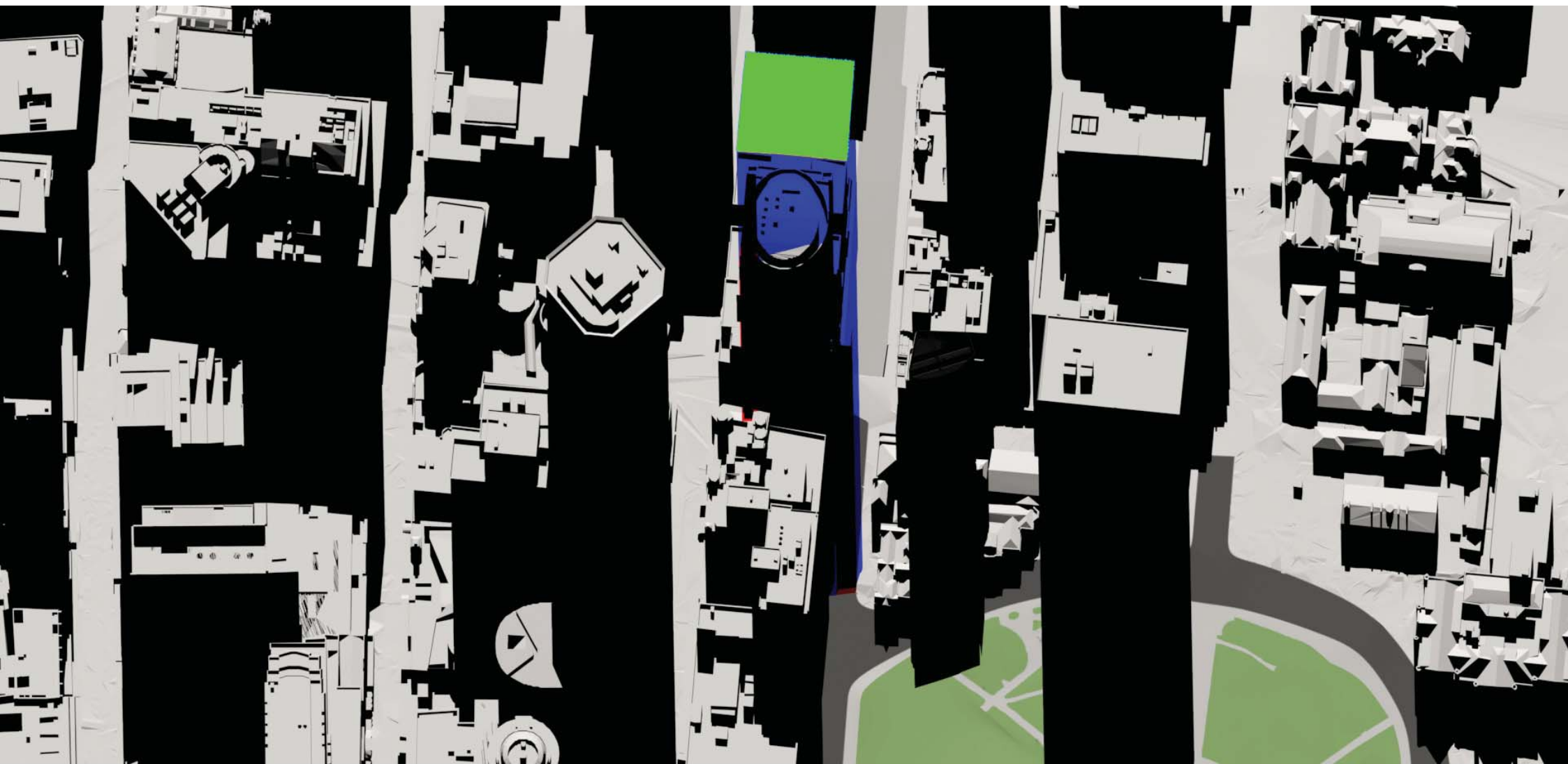

21 June, 12:00 PM AEST



Shadow cast by existing buildings



Stage 2 South Tower footprint



Stage 1 amending DA envelope with City of Sydney suggested 8x8m notches



Additional shadow cast by proposed stage 1 amending DA envelope

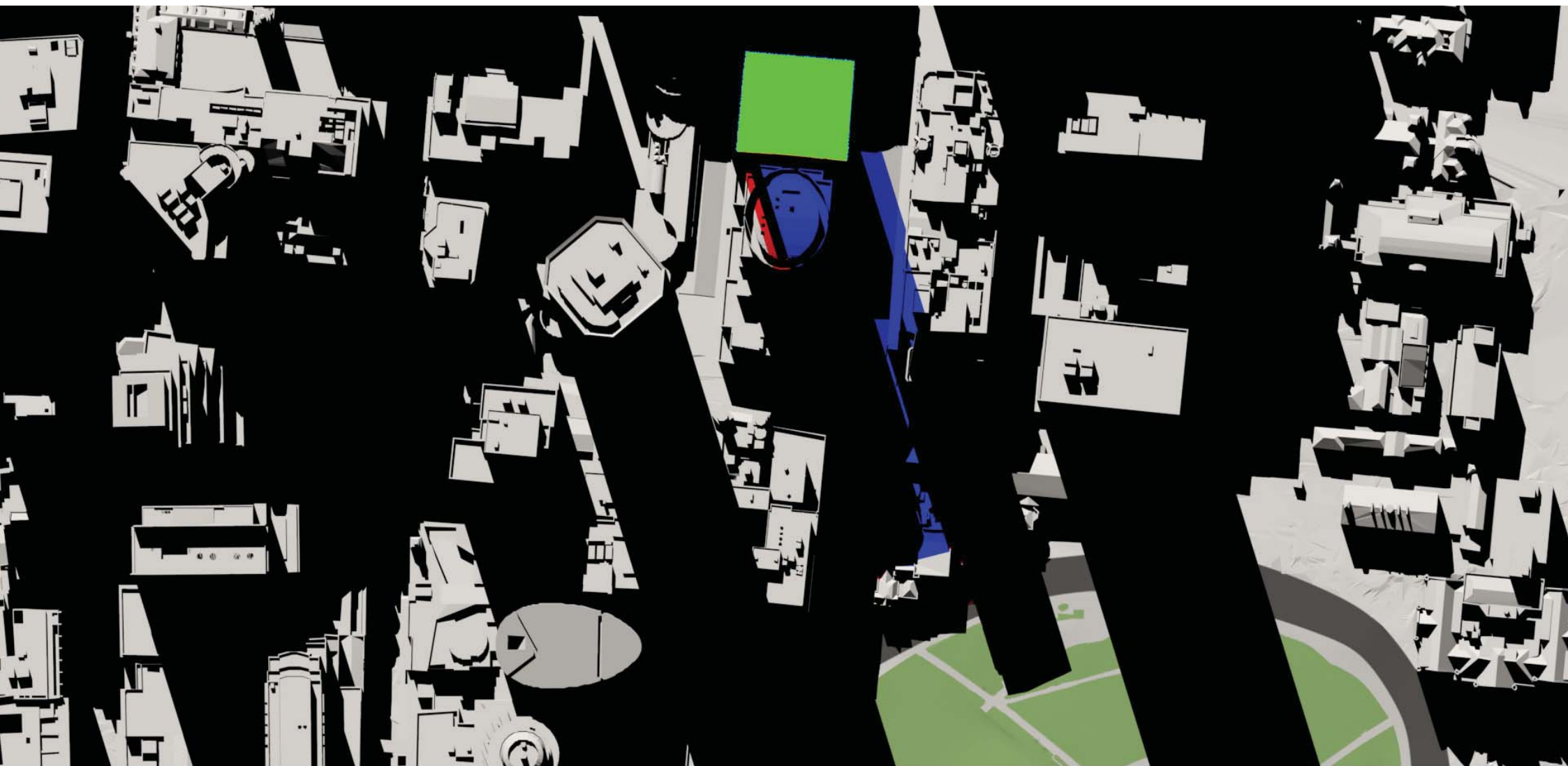

21 June, 1:00 PM AEST



Shadow cast by existing buildings



Stage 2 South Tower footprint



Stage 1 amending DA envelope with City of Sydney suggested 8x8m notches



Additional shadow cast by proposed stage 1 amending DA envelope

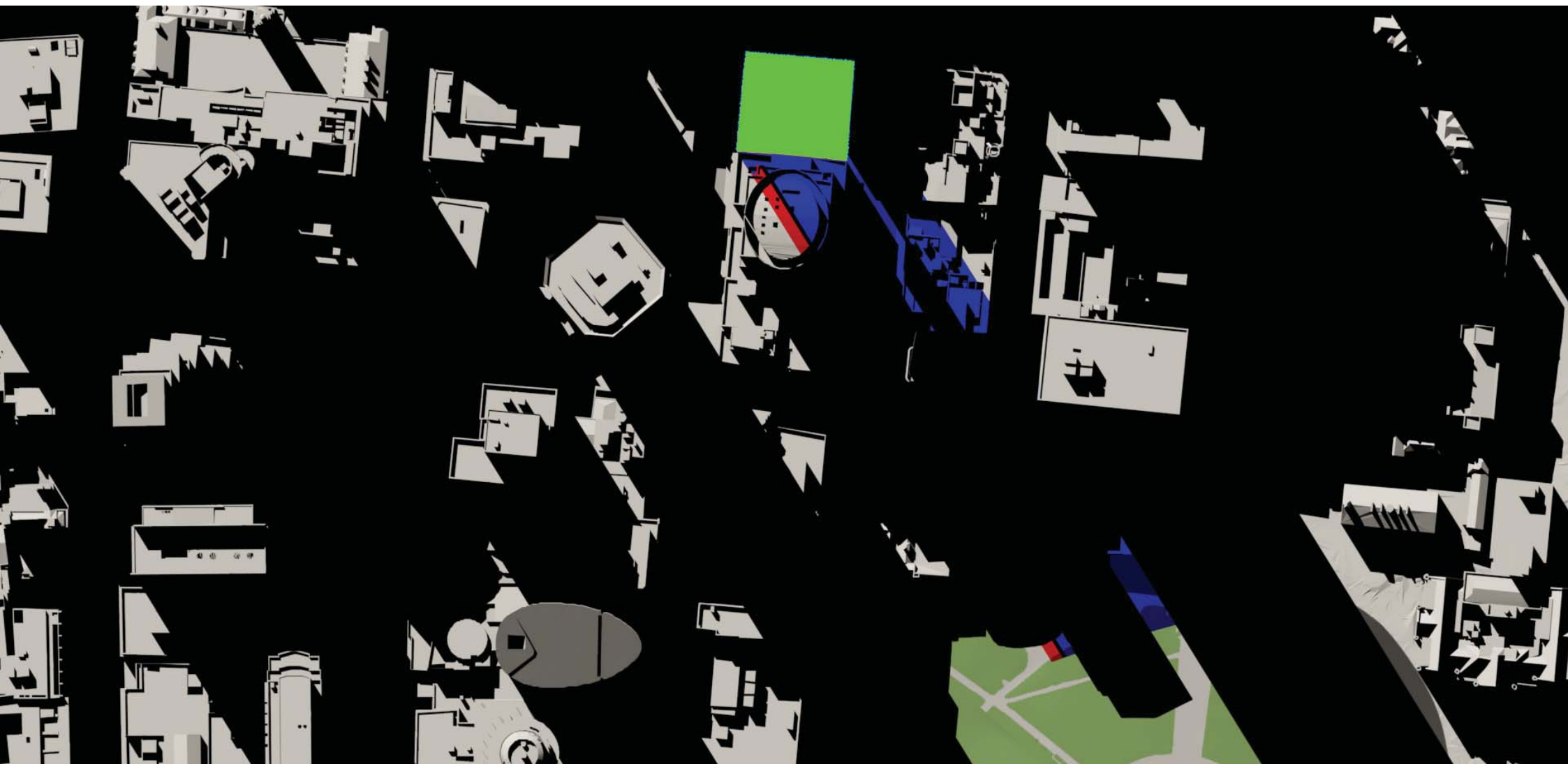

21 June, 2:00 PM AEST



Shadow cast by existing buildings



Stage 2 South Tower footprint



Stage 1 amending DA envelope with City of Sydney suggested 8x8m notches



Additional shadow cast by proposed stage 1 amending DA envelope

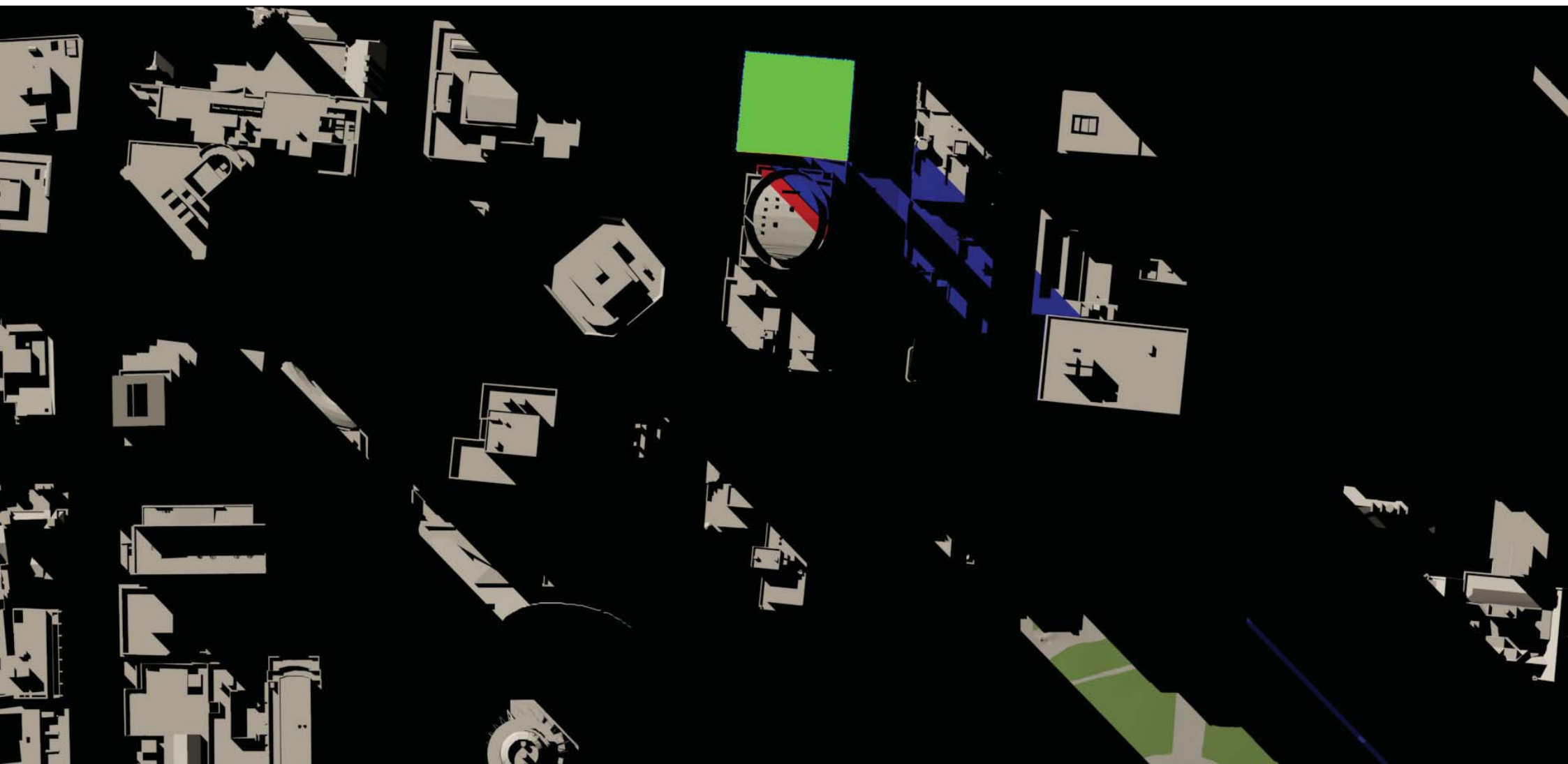

21 June, 3:00 PM AEST



Shadow cast by existing buildings



Stage 2 South Tower footprint



Stage 1 amending DA envelope with City of Sydney suggested 8x8m notches



Additional shadow cast by proposed stage 1 amending DA envelope