

| Rev | App | Ckd | Revision or reason for issue | Date     | Legend |
|-----|-----|-----|------------------------------|----------|--------|
| A   | PB  | PVR | Stage 2 DA Draft             | 29-06-18 |        |
| B   | PB  | PVR | Stage 2 DA Draft             | 06-07-18 |        |
| C   | PB  | PVR | Stage 2 DA Draft             | 18-07-18 |        |
| D   | PB  | PVR | Stage 2 DA                   | 03-08-18 |        |
| E   | PB  | PVR | Stage 2 DA                   | 07-08-18 |        |
| F   | PB  | PVR | Stage 2 DA                   | 22-08-18 |        |

CSST Areas (not for approval)

CSST detail is indicative and subject to separate approval.

Final OSD detail on station levels is subject to issue of the relevant construction certificate and approved Station Design and Precinct Plan.

Scale / North Point

1:200 @ A1, 1:400 @ A3

General Notes

Do not scale from drawing. Use marked dimensions. To be read in conjunction with all other Consultant's drawings. The Architect to be immediately notified of any discrepancies. Copyright on this drawing retained by the Architect.

Notes

This architectural package describes the North Tower. Refer to Grimshaw for Metro and Tzannes for South Tower

Disclaimer

Street trees, furniture and other public domain elements within the precinct are indicative only and are subject to relevant approvals and detailed coordination with new and existing underground utilities and infrastructure.

Authoring Organisation

**GRIMSHAW**

Grimshaw  
Level 2, 333 George Street, Sydney  
New South Wales 2000 Australia

Telephone ++ +61 2 9253 0200  
Email info@grimshaw-architects.com

Architect

**JPW  
JOHNSON PILTON WALKER**

Johnson Pilton Walker Pty Ltd ACN 095 778 886  
Level 10 Plaza Building Australia Square 95 Pitt Street Sydney  
New South Wales 2000 Australia

Telephone ++ +61 2 9259 5900  
Email jpw@jpw.com.au

Project Title

**SYDNEY METRO MARTIN PLACE -  
integrated station development**

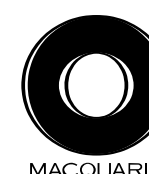

Client  
Macquarie Group Ltd  
50 Martin Place, Sydney  
New South Wales 2000 Australia

Telephone ++ +61 2 8232 3333  
Email: www.macquarie.com

Drawing Title

**SYDNEY METRO - MARTIN PLACE  
LEVEL 10 PLAN  
GENERAL ARRANGEMENT**

Status

**STAGE II SSDA**

Drawing Number

**CSWSMP-MAC-SMN-AT-DRG-DA-301000**

Revision

**F**

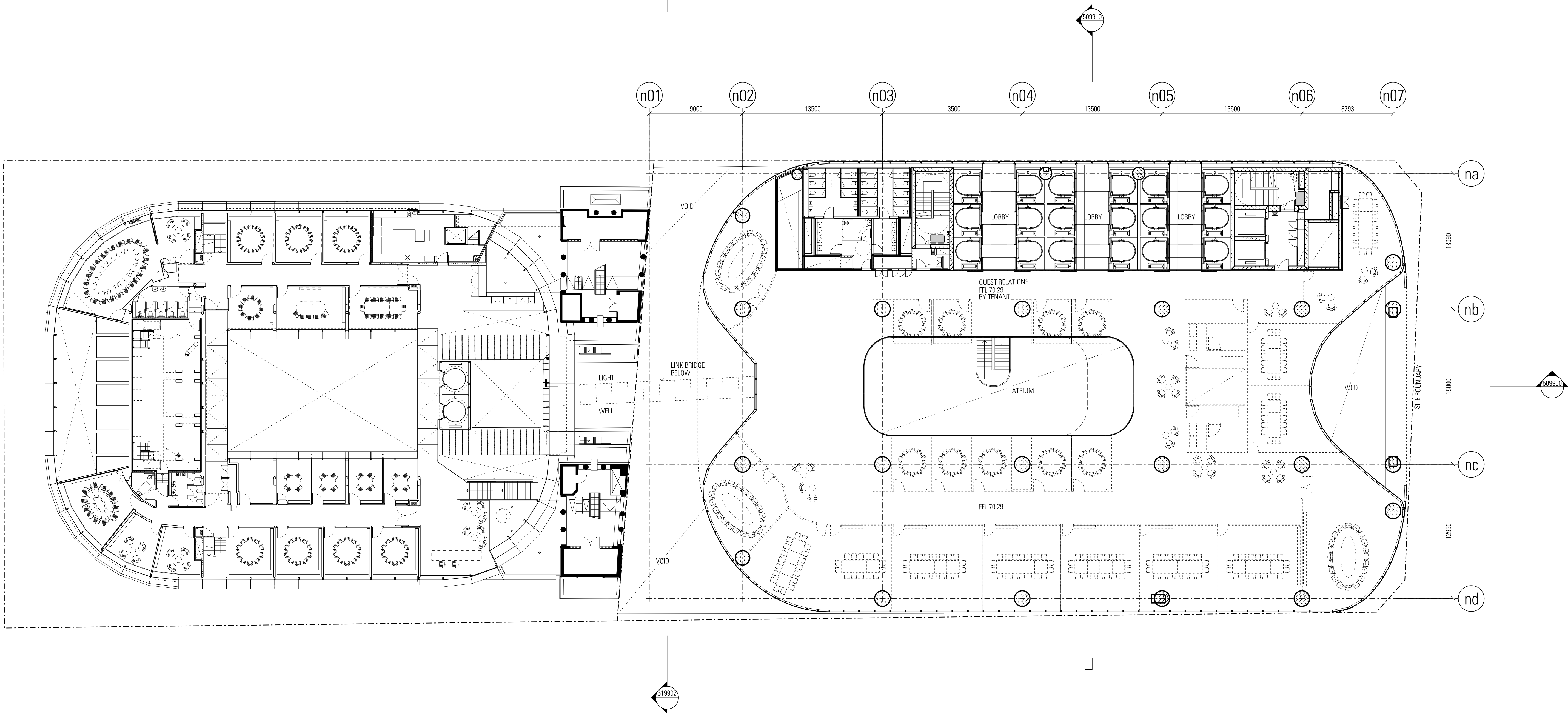

| Rev | App | Ckd | Revision or reason for issue | Date     | Legend |
|-----|-----|-----|------------------------------|----------|--------|
| A   | PB  | PVR | Stage 2 DA Draft             | 29-06-18 |        |
| B   | PB  | PVR | Stage 2 DA Draft             | 06-07-18 |        |
| C   | PB  | PVR | Stage 2 DA Draft             | 16-07-18 |        |
| D   | PB  | PVR | Stage 2 DA                   | 03-08-18 |        |
| E   | PB  | PVR | Stage 2 DA                   | 07-08-18 |        |
| F   | PB  | PVR | Stage 2 DA                   | 22-08-18 |        |

CSST Areas (not for approval)

CSST detail is indicative and subject to separate approval.

Final OSD detail on station levels is subject to issue of the relevant construction certificate and approved Station Design and Precinct Plan.

Scale / North Point

1:200 @ A1, 1:400 @ A3

General Notes

Do not scale from drawing. Use marked dimensions. To be read in conjunction with all other Consultant's drawings. The Architect to be immediately notified of any discrepancies. Copyright on this drawing retained by the Architect.

Notes

This architectural package describes the North Tower. Refer to Grimshaw for Metro and Tzannes for South Tower

Disclaimer

Street trees, furniture and other public domain elements within the precinct are indicative only and are subject to relevant approvals and detailed coordination with new and existing underground utilities and infrastructure.

Authoring Organisation

**GRIMSHAW**

Grimshaw  
Level 2, 333 George Street, Sydney  
New South Wales 2000 Australia

Telephone ++ 61 2 9253 0200  
Email info@grimshaw-architects.com

Architect

**JPW  
JOHNSON PILTON WALKER**

Johnson Pilton Walker Pty Ltd ACN 095 778 886  
Level 10 Plaza Building Australia Square 95 Pitt Street Sydney  
New South Wales 2000 Australia

Telephone +61 2 9259 5900  
Email jpw@jpw.com.au

Project Title

**SYDNEY METRO MARTIN PLACE -  
integrated station development**



Client  
Macquarie Group Ltd  
50 Martin Place, Sydney  
New South Wales 2000 Australia

Telephone +61 2 8232 3333  
Email: www.macquarie.com

Drawing Title

**SYDNEY METRO - MARTIN PLACE  
LEVEL 11 PLAN  
GENERAL ARRANGEMENT**

Status Revision

**STAGE II SSDA** F

Drawing Number

**CSWSMP-MAC-SMN-AT-DRG-DA-301100**

| Rev | App | Ckd | Revision or reason for issue | Date     | Legend |
|-----|-----|-----|------------------------------|----------|--------|
| A   | PB  | PVR | Stage 2 DA Draft             | 29-06-18 |        |
| B   | PB  | PVR | Stage 2 DA Draft             | 08-07-18 |        |
| C   | PB  | PVR | Stage 2 DA Draft             | 18-07-18 |        |
| D   | PB  | PVR | Stage 2 DA                   | 03-08-18 |        |
| E   | PB  | PVR | Stage 2 DA                   | 07-08-18 |        |
| F   | PB  | PVR | Stage 2 DA                   | 22-08-18 |        |

CSST Areas (not for approval)

CSST detail is indicative and subject to separate approval.

Final OSD detail on station levels is subject to issue of the relevant construction certificate and approved Station Design and Precinct Plan.

Scale / North Point

1:200 @ A1, 1:400 @ A3

General Notes

Do not scale from drawing. Use marked dimensions. To be read in conjunction with all other Consultant's drawings. The Architect to be immediately notified of any discrepancies. Copyright on this drawing retained by the Architect.

Notes

This architectural package describes the North Tower. Refer to Grimshaw for Metro and Trains for South Tower

Disclaimer

Street trees, furniture and other public domain elements within the precinct are indicative only and are subject to relevant approvals and detailed coordination with new and existing underground utilities and infrastructure.

Authoring Organisation

**GRIMSHAW**

Grimshaw  
Level 2, 333 George Street, Sydney  
New South Wales 2000 Australia

Telephone ++ +61 2 9253 0200  
Email info@grimshaw-architects.com

Architect

**JPW  
JOHNSON PILTON WALKER**

Johnson Pilton Walker Pty Ltd ACN 095 778 886  
Level 10 Plaza Building Australia Square 95 Pitt Street Sydney  
New South Wales 2000 Australia

Telephone +61 2 9259 5900  
Email jpw@jpw.com.au

Project Title

**SYDNEY METRO MARTIN PLACE -  
integrated station development**



Client  
Macquarie Group Ltd  
50 Martin Place, Sydney  
New South Wales 2000 Australia

Telephone +61 2 8232 3333  
Email: www.macquarie.com

Drawing Title

**SYDNEY METRO - MARTIN PLACE  
LEVEL 12 PLAN  
GENERAL ARRANGEMENT**

Status

**STAGE II SSDA**

Drawing Number

**CSWSMP-MAC-SMN-AT-DRG-DA-301200**

Revision

**F**

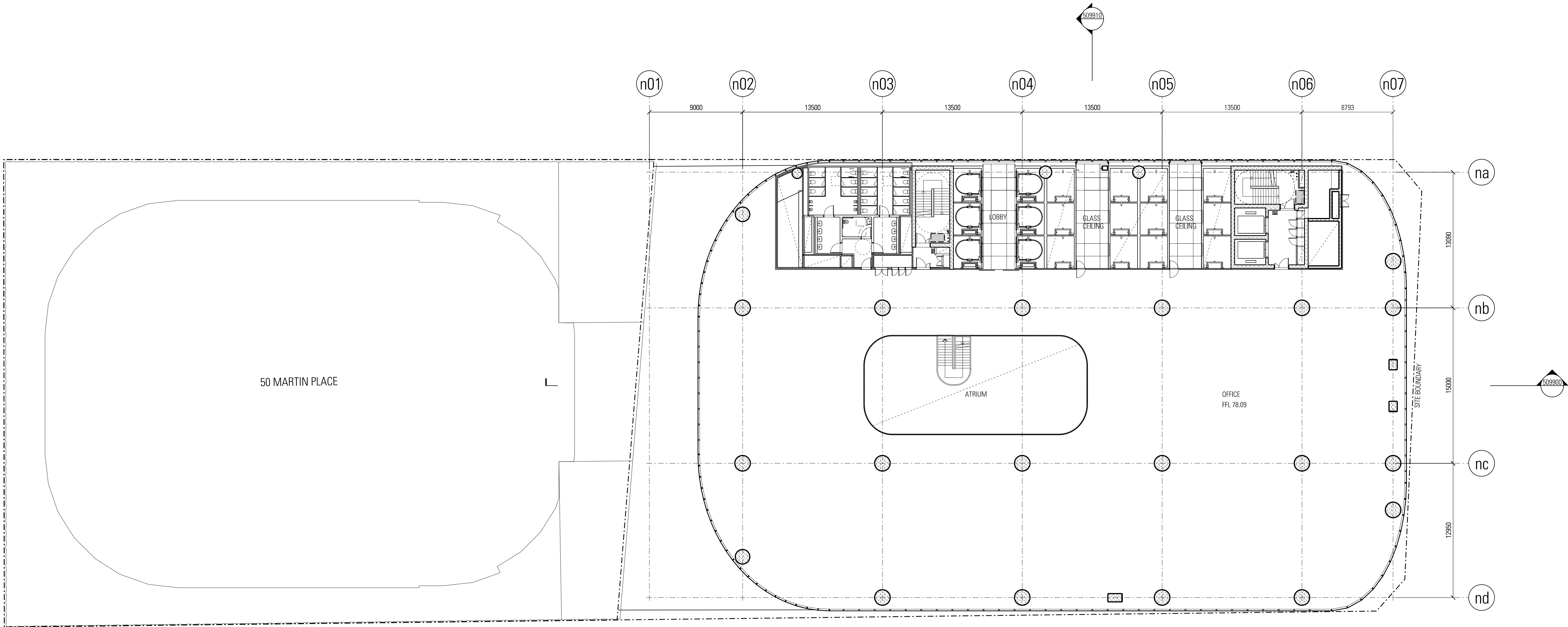

| Rev | App | Ckd | Revision or reason for issue | Date     | Legend |
|-----|-----|-----|------------------------------|----------|--------|
| A   | PB  | PVR | Stage 2 DA Draft             | 29-06-18 |        |
| B   | PB  | PVR | Stage 2 DA Draft             | 06-07-18 |        |
| C   | PB  | PVR | Stage 2 DA Draft             | 18-07-18 |        |
| D   | PB  | PVR | Stage 2 DA                   | 03-08-18 |        |
| E   | PB  | PVR | Stage 2 DA                   | 07-08-18 |        |
| F   | PB  | PVR | Stage 2 DA                   | 22-08-18 |        |

| Legend   |
|--|
|  CSSI Areas (not for approval)                              |
| CSSI detail is indicative and subject to separate approval.  |
| Final OSD detail on station levels is subject to issue of the relevant construction certificate and approved Station Design and Precinct Plan. |

| Scale / North Point   |
|---|
| 1:200 @ A1, 1:400 @ A3  |
| 0 2 4 6 10  |
| General Notes   |
| Do not scale from drawing. Use marked dimensions. To be read in conjunction with all other Consultant's drawings. The Architect to be immediately notified of any discrepancies. Copyright on this drawing retained by the Architect. |

| Notes  |
|--|
| This architectural package describes the North Tower. Refer to Grimshaw for Metro and Tzannes for South Tower  |
| Disclaimer   |
| Street trees, furniture and other public domain elements within the precinct are indicative only and are subject to relevant approvals and detailed coordination with new and existing underground utilities and infrastructure. |

| Authoring Organisation   |
|--|
| <b>GRIMSHAW</b>  |
| Grimshaw<br>Level 2, 333 George Street, Sydney<br>New South Wales 2000 Australia |
| Telephone + +61 2 9253 0200<br>Email info@grimshaw-architects.com                |

| Architect   |
|---|
| <b>JPW<br/>JOHNSON PILTON WALKER</b>  |
| Johnson Pilton Walker Pty Ltd ACN 095 778 886<br>Level 10 Plaza Building Australia Square 95 Pitt Street Sydney<br>New South Wales 2000 Australia |
| Telephone +61 2 9259 5900<br>Email jpw@jpw.com.au   |

| Project Title  |
|--|
| <b>SYDNEY METRO MARTIN PLACE -<br/>integrated station development</b>                      |
|       |
| Client<br>Macquarie Group Ltd<br>50 Martin Place, Sydney<br>New South Wales 2000 Australia |
| Telephone +61 2 8232 3333<br>Email: www.macquarie.com                                      |

| Drawing Title  |
|--|
| <b>SYDNEY METRO - MARTIN PLACE<br/>LEVEL 13 PLAN<br/>GENERAL ARRANGEMENT</b> |
| Status<br><b>STAGE II SSDA</b>   |
| Drawing Number<br>CSWSMP-MAC-SMN-AT-DRG-DA-301300                            |
| Revision<br>F  |



| Rev | App | Ckd | Revision or reason for issue | Date     |
|-----|-----|-----|------------------------------|----------|
| A   | PB  | PVR | Stage 2 DA Draft             | 29-06-18 |
| B   | PB  | PVR | Stage 2 DA Draft             | 06-07-18 |
| C   | PB  | PVR | Stage 2 DA Draft             | 18-07-18 |
| D   | PB  | PVR | Stage 2 DA                   | 03-08-18 |
| E   | PB  | PVR | Stage 2 DA                   | 07-08-18 |
| F   | PB  | PVR | Stage 2 DA                   | 22-08-18 |

| Legend |
|--------|
|--------|

CSST Areas (not for approval)

CSST detail is indicative and subject to separate approval.

Final OSD detail on station levels is subject to issue of the relevant construction certificate and approved Station Design and Precinct Plan.

Scale / North Point

1:200 @ A1, 1:400 @ A3

General Notes

Do not scale from drawing. Use marked dimensions. To be read in conjunction with all other Consultant's drawings. The Architect to be immediately notified of any discrepancies. Copyright on this drawing retained by the Architect.

Notes

This architectural package describes the North Tower. Refer to Grimshaw for Metro and Tzannes for South Tower

Disclaimer

Street trees, furniture and other public domain elements within the precinct are indicative only and are subject to relevant approvals and detailed coordination with new and existing underground utilities and infrastructure.

Authoring Organisation

**GRIMSHAW**

Grimshaw  
Level 2, 333 George Street, Sydney  
New South Wales 2000 Australia

Telephone ++ 61 2 9253 0200  
Email info@grimshaw-architects.com

Architect

**JPW  
JOHNSON PILTON WALKER**

Johnson Pilton Walker Pty Ltd ACN 095 778 886  
Level 10 Plaza Building Australia Square 95 Pitt Street Sydney  
New South Wales 2000 Australia

Telephone +61 2 9259 5900  
Email jpw@jpw.com.au

Project Title

**SYDNEY METRO MARTIN PLACE -  
integrated station development**



Client  
Macquarie Group Ltd  
50 Martin Place, Sydney  
New South Wales 2000 Australia

Telephone +61 2 8232 3333  
Email: www.macquarie.com

Drawing Title

**SYDNEY METRO - MARTIN PLACE  
LEVEL 14 PLAN  
GENERAL ARRANGEMENT**

Status Revision

**STAGE II SSDA** F

Drawing Number

CSWSMP-MAC-SMN-AT-DRG-DA-301400

| Rev | App | Ckd | Revision or reason for issue | Date     |
|-----|-----|-----|------------------------------|----------|
| A   | PB  | PVR | Stage 2 DA Draft             | 29-06-18 |
| B   | PB  | PVR | Stage 2 DA Draft             | 06-07-18 |
| C   | PB  | PVR | Stage 2 DA Draft             | 18-07-18 |
| D   | PB  | PVR | Stage 2 DA                   | 03-08-18 |
| E   | PB  | PVR | Stage 2 DA                   | 07-08-18 |
| F   | PB  | PVR | Stage 2 DA                   | 22-08-18 |

| Legend |
|--------|
|--------|

CSST Areas (not for approval)

CSST detail is indicative and subject to separate approval.

Final OSD detail on station levels is subject to issue of the relevant construction certificate and approved Station Design and Precinct Plan.

Scale / North Point

1:200 @ A1, 1:400 @ A3

General Notes

Do not scale from drawing. Use marked dimensions. To be read in conjunction with all other Consultant's drawings. The Architect to be immediately notified of any discrepancies. Copyright on this drawing retained by the Architect.

Notes

This architectural package describes the North Tower. Refer to Grimshaw for Metro and Tzannes for South Tower

Disclaimer

Street trees, furniture and other public domain elements within the precinct are indicative only and are subject to relevant approvals and detailed coordination with new and existing underground utilities and infrastructure.

Authoring Organisation

**GRIMSHAW**

Grimshaw  
Level 2, 333 George Street, Sydney  
New South Wales 2000 Australia

Telephone + +61 2 9253 0200  
Email info@grimshaw-architects.com

Architect

**JPW  
JOHNSON PILTON WALKER**

Johnson Pilton Walker Pty Ltd ACN 095 778 886  
Level 10 Plaza Building Australia Square 95 Pitt Street Sydney  
New South Wales 2000 Australia

Telephone +61 2 8259 5900  
Email jpw@jpw.com.au

Project Title

**SYDNEY METRO MARTIN PLACE -  
integrated station development**



Client  
Macquarie Group Ltd  
50 Martin Place, Sydney  
New South Wales 2000 Australia

Telephone +61 2 8232 3333  
Email: www.macquarie.com

Drawing Title

**SYDNEY METRO - MARTIN PLACE  
LEVEL 15 PLAN  
GENERAL ARRANGEMENT**

Status Revision

**STAGE II SSDA** F

Drawing Number

CSWSMP-MAC-SMN-AT-DRG-DA-301500

| Rev | App | Ckd | Revision or reason for issue | Date     | Legend |
|-----|-----|-----|------------------------------|----------|--------|
| A   | PB  | PVR | Stage 2 DA Draft             | 29-06-18 |        |
| B   | PB  | PVR | Stage 2 DA Draft             | 06-07-18 |        |
| C   | PB  | PVR | Stage 2 DA Draft             | 18-07-18 |        |
| D   | PB  | PVR | Stage 2 DA                   | 03-08-18 |        |
| E   | PB  | PVR | Stage 2 DA                   | 07-08-18 |        |
| F   | PB  | PVR | Stage 2 DA                   | 22-08-18 |        |

CSST Areas (not for approval)

CSST detail is indicative and subject to separate approval.

Final OSD detail on station levels is subject to issue of the relevant construction certificate and approved Station Design and Precinct Plan.

Scale / North Point

1:200 @ A1, 1:400 @ A3

General Notes

Do not scale from drawing. Use marked dimensions. To be read in conjunction with all other Consultant's drawings. The Architect to be immediately notified of any discrepancies. Copyright on this drawing retained by the Architect.

Notes

This architectural package describes the North Tower. Refer to Grimshaw for Metro and Tzannes for South Tower

Disclaimer

Street trees, furniture and other public domain elements within the precinct are indicative only and are subject to relevant approvals and detailed coordination with new and existing underground utilities and infrastructure.

Authoring Organisation

**GRIMSHAW**

Grimshaw  
Level 2, 333 George Street, Sydney  
New South Wales 2000 Australia

Telephone ++61 2 9253 0200  
Email info@grimshaw-architects.com

Architect

**JPW  
JOHNSON PILTON WALKER**

Johnson Pilton Walker Pty Ltd ACN 095 778 886  
Level 10 Plaza Building Australia Square 95 Pitt Street Sydney  
New South Wales 2000 Australia

Telephone ++61 2 9259 5900  
Email jpw@jpw.com.au

Project Title

**SYDNEY METRO MARTIN PLACE -  
integrated station development**



Client  
Macquarie Group Ltd  
50 Martin Place, Sydney  
New South Wales 2000 Australia

Telephone ++61 2 8232 3333  
Email: www.macquarie.com

Drawing Title

**SYDNEY METRO - MARTIN PLACE  
LEVEL 16 PLAN  
GENERAL ARRANGEMENT**

Status Revision

**STAGE II SSDA** F

Drawing Number

**CSWSMP-MAC-SMN-AT-DRG-DA-301600**

| Rev | App | Ckd | Revision or reason for issue | Date     | Legend |
|-----|-----|-----|------------------------------|----------|--------|
| A   | PB  | PVR | Stage 2 DA Draft             | 29-06-18 |        |
| B   | PB  | PVR | Stage 2 DA Draft             | 06-07-18 |        |
| C   | PB  | PVR | Stage 2 DA Draft             | 18-07-18 |        |
| D   | PB  | PVR | Stage 2 DA                   | 03-08-18 |        |
| E   | PB  | PVR | Stage 2 DA                   | 07-08-18 |        |
| F   | PB  | PVR | Stage 2 DA                   | 22-08-18 |        |

CSST Areas (not for approval)

CSST detail is indicative and subject to separate approval.

Final OSD detail on station levels is subject to issue of the relevant construction certificate and approved Station Design and Precinct Plan.

Scale / North Point

1:200 @ A1, 1:400 @ A3

General Notes

Do not scale from drawing. Use marked dimensions. To be read in conjunction with all other Consultant's drawings. The Architect to be immediately notified of any discrepancies. Copyright on this drawing retained by the Architect.

Notes

This architectural package describes the North Tower. Refer to Grimshaw for Metro and Trains for South Tower

Disclaimer

Street trees, furniture and other public domain elements within the precinct are indicative only and are subject to relevant approvals and detailed coordination with new and existing underground utilities and infrastructure.

Authoring Organisation

**GRIMSHAW**

Grimshaw  
Level 2, 333 George Street, Sydney  
New South Wales 2000 Australia

Telephone ++ 61 2 9253 0200  
Email info@grimshaw-architects.com

Architect

**JPW  
JOHNSON PILTON WALKER**

Johnson Pilton Walker Pty Ltd ACN 095 778 886  
Level 10 Plaza Building Australia Square 95 Pitt Street Sydney  
New South Wales 2000 Australia

Telephone +61 2 9259 5900  
Email jpw@jpw.com.au

Project Title

**SYDNEY METRO MARTIN PLACE -  
integrated station development**



Client  
Macquarie Group Ltd  
50 Martin Place, Sydney  
New South Wales 2000 Australia

Telephone +61 2 8232 3333  
Email: www.macquarie.com

Drawing Title

**SYDNEY METRO - MARTIN PLACE  
LEVEL 17 PLAN  
GENERAL ARRANGEMENT**

Status Revision

**STAGE II SSDA** F

Drawing Number

CSWSMP-MAC-SMN-AT-DRG-DA-301700



CSWSMP-MAC-SMN-AT-DRG-DA-301800.dwg  
23/08/2018  
2:33:39 PM

| Rev | App | Ckd | Revision or reason for issue | Date     |
|-----|-----|-----|------------------------------|----------|
| A   | PB  | PVR | Stage 2 DA Draft             | 29-06-18 |
| B   | PB  | PVR | Stage 2 DA Draft             | 06-07-18 |
| C   | PB  | PVR | Stage 2 DA Draft             | 18-07-18 |
| D   | PB  | PVR | Stage 2 DA                   | 03-08-18 |
| E   | PB  | PVR | Stage 2 DA                   | 07-08-18 |
| F   | PB  | PVR | Stage 2 DA                   | 22-08-18 |

| Legend | Date     |
|--------|----------|
|        | 29-06-18 |
|        | 06-07-18 |
|        | 18-07-18 |
|        | 03-08-18 |
|        | 07-08-18 |
|        | 22-08-18 |

CSA Areas (not for approval)

CSA detail is indicative and subject to separate approval.

Final OSD detail on station levels is subject to issue of the relevant construction certificate and approved Station Design and Precinct Plan.

Scale / North Point

1:200 @ A1, 1:400 @ A3

General Notes

Do not scale from drawing. Use marked dimensions. To be read in conjunction with all other Consultant's drawings. The Architect to be immediately notified of any discrepancies. Copyright on this drawing retained by the Architect.

Notes

This architectural package describes the North Tower. Refer to Grimshaw for Metro and Trains for South Tower

Disclaimer

Street trees, furniture and other public domain elements within the precinct are indicative only and are subject to relevant approvals and detailed coordination with new and existing underground utilities and infrastructure.

Authoring Organisation

**GRIMSHAW**

Grimshaw  
Level 2, 333 George Street, Sydney  
New South Wales 2000 Australia

Telephone + +61 2 9253 0200  
Email info@grimshaw-architects.com

Architect

**JPW  
JOHNSON PILTON WALKER**

Johnson Pilton Walker Pty Ltd ACN 095 778 886  
Level 10 Plaza Building Australia Square 95 Pitt Street Sydney  
New South Wales 2000 Australia

Telephone +61 2 9259 5900  
Email jpw@jpw.com.au

Project Title

**SYDNEY METRO MARTIN PLACE -  
integrated station development**



Client  
Macquarie Group Ltd  
50 Martin Place, Sydney  
New South Wales 2000 Australia

Telephone +61 2 8232 3333  
Email: www.macquarie.com

Drawing Title

**SYDNEY METRO - MARTIN PLACE  
LEVEL 18 PLAN  
GENERAL ARRANGEMENT**

Status Revision

**STAGE II SSDA** F

Drawing Number

CSWSMP-MAC-SMN-AT-DRG-DA-301800

| Rev | App | Ckd | Revision or reason for issue | Date     | Legend |
|-----|-----|-----|------------------------------|----------|--------|
| A   | PB  | PVR | Stage 2 DA Draft             | 29-06-18 |        |
| B   | PB  | PVR | Stage 2 DA Draft             | 06-07-18 |        |
| C   | PB  | PVR | Stage 2 DA Draft             | 18-07-18 |        |
| D   | PB  | PVR | Stage 2 DA                   | 03-08-18 |        |
| E   | PB  | PVR | Stage 2 DA                   | 07-08-18 |        |
| F   | PB  | PVR | Stage 2 DA                   | 22-08-18 |        |

CSST Areas (not for approval)

CSST detail is indicative and subject to separate approval.

Final OSD detail on station levels is subject to issue of the relevant construction certificate and approved Station Design and Precinct Plan.

Scale / North Point

1:200 @ A1, 1:400 @ A3

General Notes

Do not scale from drawing. Use marked dimensions. To be read in conjunction with all other Consultant's drawings. The Architect to be immediately notified of any discrepancies. Copyright on this drawing retained by the Architect.

Notes

This architectural package describes the North Tower. Refer to Grimshaw for Metro and Trains for South Tower

Disclaimer

Street trees, furniture and other public domain elements within the precinct are indicative only and are subject to relevant approvals and detailed coordination with new and existing underground utilities and infrastructure.

Authoring Organisation

**GRIMSHAW**

Grimshaw  
Level 2, 333 George Street, Sydney  
New South Wales 2000 Australia

Telephone + +61 2 9253 0200  
Email info@grimshaw-architects.com

Architect

**JPW  
JOHNSON PILTON WALKER**

Johnson Pilton Walker Pty Ltd ACN 095 778 886  
Level 10 Plaza Building Australia Square 95 Pitt Street Sydney  
New South Wales 2000 Australia

Telephone +61 2 9259 5900  
Email jpw@jpw.com.au

Project Title

**SYDNEY METRO - MARTIN PLACE -  
integrated station development**



Client  
Macquarie Group Ltd  
50 Martin Place, Sydney  
New South Wales 2000 Australia

Telephone +61 2 8232 3333  
Email: www.macquarie.com

Drawing Title

**SYDNEY METRO - MARTIN PLACE  
LEVEL 19 PLAN  
GENERAL ARRANGEMENT**

Status Revision

**STAGE II SSDA** **F**

Drawing Number

**CSWSMP-MAC-SMN-AT-DRG-DA-301900**

| Rev | App | Ckd | Revision or reason for issue | Date     |
|-----|-----|-----|------------------------------|----------|
| A   | PB  | PVR | Stage 2 DA Draft             | 29-06-18 |
| B   | PB  | PVR | Stage 2 DA Draft             | 06-07-18 |
| C   | PB  | PVR | Stage 2 DA Draft             | 18-07-18 |
| D   | PB  | PVR | Stage 2 DA                   | 03-08-18 |
| E   | PB  | PVR | Stage 2 DA                   | 07-08-18 |
| F   | PB  | PVR | Stage 2 DA                   | 22-08-18 |

| Legend | Date     |
|--------|----------|
|        | 29-06-18 |
|        | 06-07-18 |
|        | 18-07-18 |
|        | 03-08-18 |
|        | 07-08-18 |
|        | 22-08-18 |

CSWI Areas (not for approval)

CSWI detail is indicative and subject to separate approval.

Final OSD detail on station levels is subject to issue of the relevant construction certificate and approved Station Design and Precinct Plan.

Scale / North Point

1:200 @ A1, 1:400 @ A3

General Notes

Do not scale from drawing. Use marked dimensions. To be read in conjunction with all other Consultant's drawings. The Architect to be immediately notified of any discrepancies. Copyright on this drawing retained by the Architect.

Notes

This architectural package describes the North Tower. Refer to Grimshaw for Metro and Trains for South Tower

Disclaimer

Street trees, furniture and other public domain elements within the precinct are indicative only and are subject to relevant approvals and detailed coordination with new and existing underground utilities and infrastructure.

Authoring Organisation

**GRIMSHAW**

Grimshaw  
Level 2, 333 George Street, Sydney  
New South Wales 2000 Australia

Telephone ++ 61 2 9253 0200  
Email info@grimshaw-architects.com

Architect

**JPW  
JOHNSON PILTON WALKER**

Johnson Pilton Walker Pty Ltd ACN 095 778 886  
Level 10 Plaza Building Australia Square 95 Pitt Street Sydney  
New South Wales 2000 Australia

Telephone +61 2 9259 5900  
Email jpw@jpw.com.au

Project Title

**SYDNEY METRO MARTIN PLACE -  
integrated station development**



Client  
Macquarie Group Ltd  
50 Martin Place, Sydney  
New South Wales 2000 Australia

Telephone +61 2 8232 3333  
Email: www.macquarie.com

Drawing Title

**SYDNEY METRO - MARTIN PLACE  
LEVEL 20 PLAN  
GENERAL ARRANGEMENT**

Status Revision

**STAGE II SSDA** F

Drawing Number

CSWSMP-MAC-SMN-AT-DRG-DA-302000

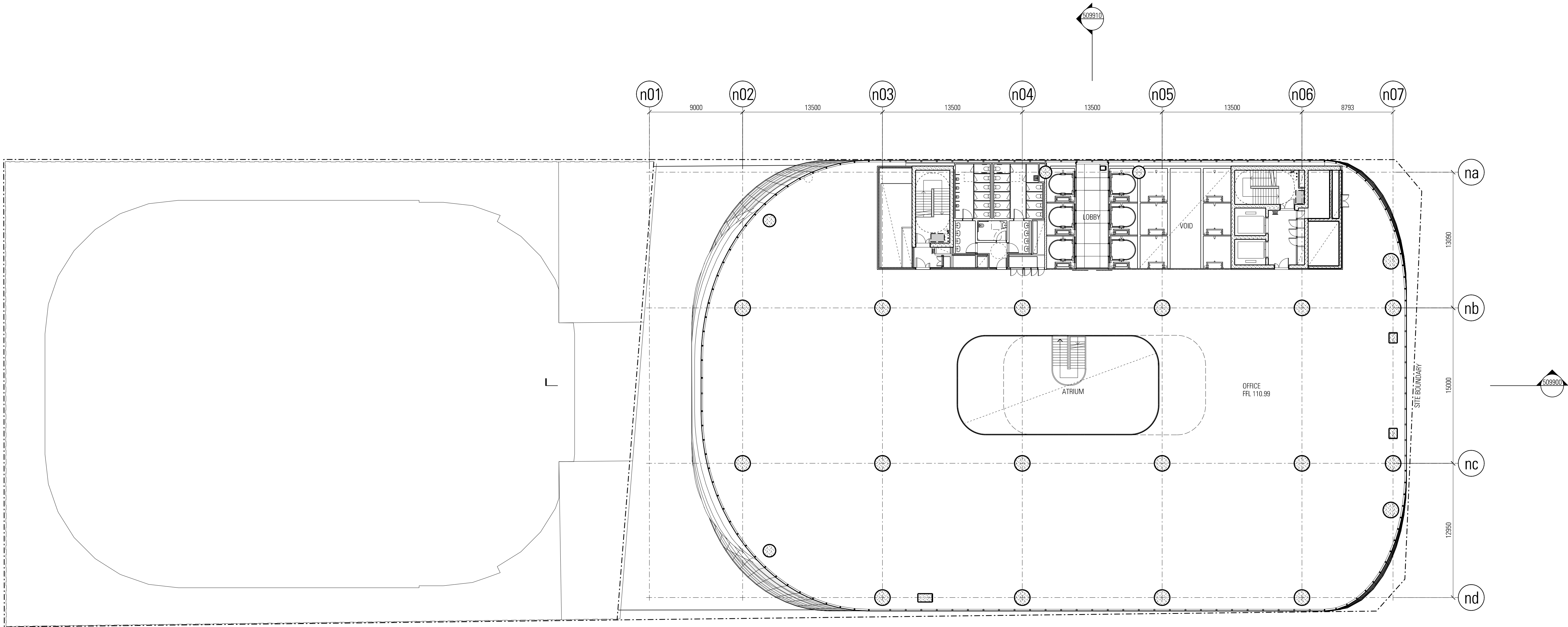

| Rev | App | Ckd | Revision or reason for issue | Date     | Legend |
|-----|-----|-----|------------------------------|----------|--------|
| A   | PB  | PVR | Stage 2 DA Draft             | 29-06-18 |        |
| B   | PB  | PVR | Stage 2 DA Draft             | 06-07-18 |        |
| C   | PB  | PVR | Stage 2 DA Draft             | 18-07-18 |        |
| D   | PB  | PVR | Stage 2 DA                   | 03-08-18 |        |
| E   | PB  | PVR | Stage 2 DA                   | 07-08-18 |        |
| F   | PB  | PVR | Stage 2 DA                   | 22-08-18 |        |

CSST Areas (not for approval)

CSST detail is indicative and subject to separate approval.

Final OSD detail on station levels is subject to issue of the relevant construction certificate and approved Station Design and Precinct Plan.

Scale / North Point

1:200 @ A1, 1:400 @ A3

General Notes

Do not scale from drawing. Use marked dimensions. To be read in conjunction with all other Consultant's drawings. The Architect to be immediately notified of any discrepancies. Copyright on this drawing retained by the Architect.

Notes

This architectural package describes the North Tower. Refer to Grimshaw for Metro and Tzannes for South Tower

Disclaimer

Street trees, furniture and other public domain elements within the precinct are indicative only and are subject to relevant approvals and detailed coordination with new and existing underground utilities and infrastructure.

Authoring Organisation

**GRIMSHAW**

Grimshaw  
Level 2, 333 George Street, Sydney  
New South Wales 2000 Australia

Telephone + +61 2 9253 0200  
Email info@grimshaw-architects.com

Architect

**JPW  
JOHNSON PILTON WALKER**

Johnson Pilton Walker Pty Ltd ACN 095 778 886  
Level 10 Plaza Building Australia Square 95 Pitt Street Sydney  
New South Wales 2000 Australia

Telephone +61 2 9259 5900  
Email jpw@jpw.com.au

Project Title

**SYDNEY METRO MARTIN PLACE -  
integrated station development**



Client  
Macquarie Group Ltd  
50 Martin Place, Sydney  
New South Wales 2000 Australia

Telephone +61 2 8232 3333  
Email: www.macquarie.com

Drawing Title

**SYDNEY METRO - MARTIN PLACE  
LEVEL 21 PLAN  
GENERAL ARRANGEMENT**

Status Revision

**STAGE II SSDA** F

Drawing Number

**CSWSMP-MAC-SMN-AT-DRG-DA-302100**



| Rev | App | Ckd | Revision or reason for issue | Date     | Legend |
|-----|-----|-----|------------------------------|----------|--------|
| A   | PB  | PVR | Stage 2 DA Draft             | 29-06-18 |        |
| B   | PB  | PVR | Stage 2 DA Draft             | 06-07-18 |        |
| C   | PB  | PVR | Stage 2 DA Draft             | 18-07-18 |        |
| D   | PB  | PVR | Stage 2 DA                   | 03-08-18 |        |
| E   | PB  | PVR | Stage 2 DA                   | 07-08-18 |        |
| F   | PB  | PVR | Stage 2 DA                   | 22-08-18 |        |

| Rev | App | Ckd | Revision or reason for issue | Date     | Legend |
|-----|-----|-----|------------------------------|----------|--------|
| A   | PB  | PVR | Stage 2 DA Draft             | 29-06-18 |        |
| B   | PB  | PVR | Stage 2 DA Draft             | 06-07-18 |        |
| C   | PB  | PVR | Stage 2 DA Draft             | 18-07-18 |        |
| D   | PB  | PVR | Stage 2 DA                   | 03-08-18 |        |
| E   | PB  | PVR | Stage 2 DA                   | 07-08-18 |        |
| F   | PB  | PVR | Stage 2 DA                   | 22-08-18 |        |

CSST Areas (not for approval)

CSST detail is indicative and subject to separate approval.

Final OSD detail on station levels is subject to issue of the relevant construction certificate and approved Station Design and Precinct Plan.

Scale / North Point

1:200 @ A1, 1:400 @ A3

General Notes

Do not scale from drawing. Use marked dimensions. To be read in conjunction with all other Consultant's drawings. The Architect to be immediately notified of any discrepancies. Copyright on this drawing retained by the Architect.

Notes

This architectural package describes the North Tower. Refer to Grimshaw for Metro and Tzannes for South Tower

Disclaimer

Street trees, furniture and other public domain elements within the precinct are indicative only and are subject to relevant approvals and detailed coordination with new and existing underground utilities and infrastructure.

Authoring Organisation

**GRIMSHAW**

Grimshaw  
Level 2, 333 George Street, Sydney  
New South Wales 2000 Australia

Telephone ++ 61 2 9253 0200  
Email info@grimshaw-architects.com

Architect

**JPW  
JOHNSON PILTON WALKER**

Johnson Pilton Walker Pty Ltd ACN 095 778 886  
Level 10 Plaza Building Australia Square 95 Pitt Street Sydney  
New South Wales 2000 Australia

Telephone +61 2 9259 5900  
Email jpw@jpw.com.au

Project Title

**SYDNEY METRO MARTIN PLACE -  
integrated station development**



Client  
Macquarie Group Ltd  
50 Martin Place, Sydney  
New South Wales 2000 Australia

Telephone +61 2 8232 3333  
Email: www.macquarie.com

Drawing Title

**SYDNEY METRO - MARTIN PLACE  
LEVEL 22 PLAN  
GENERAL ARRANGEMENT**

Status Revision

**STAGE II SSDA** F

Drawing Number

**CSWSMP-MAC-SMN-AT-DRG-DA-302200**

| Rev | App | Ckd | Revision or reason for issue | Date     | Legend |
|-----|-----|-----|------------------------------|----------|--------|
| A   | PB  | PVR | Stage 2 DA Draft             | 29-06-18 |        |
| B   | PB  | PVR | Stage 2 DA Draft             | 06-07-18 |        |
| C   | PB  | PVR | Stage 2 DA Draft             | 18-07-18 |        |
| D   | PB  | PVR | Stage 2 DA                   | 03-08-18 |        |
| E   | PB  | PVR | Stage 2 DA                   | 07-08-18 |        |
| F   | PB  | PVR | Stage 2 DA                   | 22-08-18 |        |

CSST Areas (not for approval)

CSST detail is indicative and subject to separate approval.

Final OSD detail on station levels is subject to issue of the relevant construction certificate and approved Station Design and Precinct Plan.

Scale / North Point

1:200 @ A1, 1:400 @ A3

General Notes

Do not scale from drawing. Use marked dimensions. To be read in conjunction with all other Consultant's drawings. The Architect to be immediately notified of any discrepancies. Copyright on this drawing retained by the Architect.

Notes

This architectural package describes the North Tower. Refer to Grimshaw for Metro and Trains for South Tower

Disclaimer

Street trees, furniture and other public domain elements within the precinct are indicative only and are subject to relevant approvals and detailed coordination with new and existing underground utilities and infrastructure.

Authoring Organisation

**GRIMSHAW**

Grimshaw  
Level 2, 333 George Street, Sydney  
New South Wales 2000 Australia

Telephone ++61 2 9253 0200  
Email info@grimshaw-architects.com

Architect

**JPW  
JOHNSON PILTON WALKER**

Johnson Pilton Walker Pty Ltd ACN 095 778 886  
Level 10 Plaza Building Australia Square 95 Pitt Street Sydney  
New South Wales 2000 Australia

Telephone +61 2 9259 5900  
Email jpw@jpw.com.au

Project Title

**SYDNEY METRO MARTIN PLACE -  
integrated station development**



Client  
Macquarie Group Ltd  
50 Martin Place, Sydney  
New South Wales 2000 Australia

Telephone +61 2 8232 3333  
Email: www.macquarie.com

Drawing Title

**SYDNEY METRO - MARTIN PLACE  
LEVEL 23 PLAN  
GENERAL ARRANGEMENT**

Status Revision

**STAGE II SSDA** F

Drawing Number

**CSWSMP-MAC-SMN-AT-DRG-DA-302300**

| Rev | App | Ckd | Revision or reason for issue | Date     | Legend |
|-----|-----|-----|------------------------------|----------|--------|
| A   | PB  | PVR | Stage 2 DA Draft             | 29-06-18 |        |
| B   | PB  | PVR | Stage 2 DA Draft             | 06-07-18 |        |
| C   | PB  | PVR | Stage 2 DA Draft             | 18-07-18 |        |
| D   | PB  | PVR | Stage 2 DA                   | 03-08-18 |        |
| E   | PB  | PVR | Stage 2 DA                   | 07-08-18 |        |
| F   | PB  | PVR | Stage 2 DA                   | 22-08-18 |        |

CSST Areas (not for approval)

CSST detail is indicative and subject to separate approval.

Final OSD detail on station levels is subject to issue of the relevant construction certificate and approved Station Design and Precinct Plan.

Scale / North Point

1:200 @ A1, 1:400 @ A3

General Notes

Do not scale from drawing. Use marked dimensions. To be read in conjunction with all other Consultant's drawings. The Architect to be immediately notified of any discrepancies. Copyright on this drawing retained by the Architect.

Notes

This architectural package describes the North Tower. Refer to Grimshaw for Metro and Trains for South Tower

Disclaimer

Street trees, furniture and other public domain elements within the precinct are indicative only and are subject to relevant approvals and detailed coordination with new and existing underground utilities and infrastructure.

Authoring Organisation

**GRIMSHAW**

Grimshaw  
Level 2, 333 George Street, Sydney  
New South Wales 2000 Australia

Telephone ++ +61 2 9253 0200  
Email info@grimshaw-architects.com

Architect

**JPW  
JOHNSON PILTON WALKER**

Johnson Pilton Walker Pty Ltd ACN 095 778 886  
Level 10 Plaza Building Australia Square 95 Pitt Street Sydney  
New South Wales 2000 Australia

Telephone +61 2 9259 5900  
Email jpw@jpw.com.au

Project Title

**SYDNEY METRO MARTIN PLACE -  
integrated station development**



Client  
Macquarie Group Ltd  
50 Martin Place, Sydney  
New South Wales 2000 Australia

Telephone +61 2 8232 3333  
Email: www.macquarie.com

Drawing Title

**SYDNEY METRO - MARTIN PLACE  
LEVEL 24 PLAN  
GENERAL ARRANGEMENT**

Status

**STAGE II SSDA**

Drawing Number

**CSWSMP-MAC-SMN-AT-DRG-DA-302400**

Revision

**F**

| Rev | App | Ckd | Revision or reason for issue | Date     | Legend |
|-----|-----|-----|------------------------------|----------|--------|
| A   | PB  | PVR | Stage 2 DA Draft             | 29-06-18 |        |
| B   | PB  | PVR | Stage 2 DA Draft             | 06-07-18 |        |
| C   | PB  | PVR | Stage 2 DA Draft             | 18-07-18 |        |
| D   | PB  | PVR | Stage 2 DA                   | 03-08-18 |        |
| E   | PB  | PVR | Stage 2 DA                   | 07-08-18 |        |
| F   | PB  | PVR | Stage 2 DA                   | 22-08-18 |        |

CSST Areas (not for approval)

CSST detail is indicative and subject to separate approval.

Final OSD detail on station levels is subject to issue of the relevant construction certificate and approved Station Design and Precinct Plan.

Scale / North Point

1:200 @ A1, 1:400 @ A3

General Notes

Do not scale from drawing. Use marked dimensions. To be read in conjunction with all other Consultant's drawings. The Architect to be immediately notified of any discrepancies. Copyright on this drawing retained by the Architect.

Notes

This architectural package describes the North Tower. Refer to Grimshaw for Metro and Trains for South Tower

Disclaimer

Street trees, furniture and other public domain elements within the precinct are indicative only and are subject to relevant approvals and detailed coordination with new and existing underground utilities and infrastructure.

Authoring Organisation

**GRIMSHAW**

Grimshaw  
Level 2, 333 George Street, Sydney  
New South Wales 2000 Australia

Telephone ++ 61 2 9253 0200  
Email info@grimshaw-architects.com

Architect

**JPW  
JOHNSON PILTON WALKER**

Johnson Pilton Walker Pty Ltd ACN 095 778 886  
Level 10 Plaza Building Australia Square 95 Pitt Street Sydney  
New South Wales 2000 Australia

Telephone +61 2 9259 5900  
Email jpw@jpw.com.au

Project Title

**SYDNEY METRO MARTIN PLACE -  
integrated station development**



Client  
Macquarie Group Ltd  
50 Martin Place, Sydney  
New South Wales 2000 Australia

Telephone +61 2 8232 3333  
Email: www.macquarie.com

Drawing Title

**SYDNEY METRO - MARTIN PLACE  
LEVEL 25 PLAN  
GENERAL ARRANGEMENT**

Status

**STAGE II SSDA**

Drawing Number

**CSWSMP-MAC-SMN-AT-DRG-DA-302500**

Revision

**F**



| Rev | App | Ckd | Revision or reason for issue | Date     | Legend |
|-----|-----|-----|------------------------------|----------|--------|
| A   | PB  | PVR | Stage 2 DA Draft             | 29-06-18 |        |
| B   | PB  | PVR | Stage 2 DA Draft             | 06-07-18 |        |
| C   | PB  | PVR | Stage 2 DA Draft             | 18-07-18 |        |
| D   | PB  | PVR | Stage 2 DA                   | 03-08-18 |        |
| E   | PB  | PVR | Stage 2 DA                   | 07-08-18 |        |
| F   | PB  | PVR | Stage 2 DA                   | 22-08-18 |        |

| Date     | Legend |
|----------|--------|
| 29-06-18 |        |
| 06-07-18 |        |
| 18-07-18 |        |
| 03-08-18 |        |
| 07-08-18 |        |
| 22-08-18 |        |

CSST Areas (not for approval)

CSST detail is indicative and subject to separate approval.

Final OSD detail on station levels is subject to issue of the relevant construction certificate and approved Station Design and Precinct Plan.

Scale / North Point

1:200 @ A1, 1:400 @ A3

General Notes

Do not scale from drawing. Use marked dimensions. To be read in conjunction with all other Consultant's drawings. The Architect to be immediately notified of any discrepancies. Copyright on this drawing retained by the Architect.

Notes

This architectural package describes the North Tower. Refer to Grimshaw for Metro and Trains for South Tower

Disclaimer

Street trees, furniture and other public domain elements within the precinct are indicative only and are subject to relevant approvals and detailed coordination with new and existing underground utilities and infrastructure.

Authoring Organisation

**GRIMSHAW**

Grimshaw  
Level 2, 333 George Street, Sydney  
New South Wales 2000 Australia

Telephone ++ 61 2 9253 0200  
Email info@grimshaw-architects.com

Architect

**JPW  
JOHNSON PILTON WALKER**

Johnson Pilton Walker Pty Ltd ACN 095 778 886  
Level 10 Plaza Building Australia Square 95 Pitt Street Sydney  
New South Wales 2000 Australia

Telephone +61 2 9259 5900  
Email jpw@jpw.com.au

Project Title

**SYDNEY METRO MARTIN PLACE -  
integrated station development**



Client  
Macquarie Group Ltd  
50 Martin Place, Sydney  
New South Wales 2000 Australia

Telephone +61 2 8232 3333  
Email: www.macquarie.com

Drawing Title

**SYDNEY METRO - MARTIN PLACE  
LEVEL 26 PLAN  
GENERAL ARRANGEMENT**

Status  
**STAGE II SSDA**

Drawing Number  
**CSWSMP-MAC-SMN-AT-DRG-DA-302600**

Revision  
**F**

| Rev | App | Ckd | Revision or reason for issue | Date     | Legend |
|-----|-----|-----|------------------------------|----------|--------|
| A   | PB  | PVR | Stage 2 DA Draft             | 29-06-18 |        |
| B   | PB  | PVR | Stage 2 DA Draft             | 06-07-18 |        |
| C   | PB  | PVR | Stage 2 DA Draft             | 18-07-18 |        |
| D   | PB  | PVR | Stage 2 DA                   | 03-08-18 |        |
| E   | PB  | PVR | Stage 2 DA                   | 07-08-18 |        |
| F   | PB  | PVR | Stage 2 DA                   | 22-08-18 |        |

CSST Areas (not for approval)

CSST detail is indicative and subject to separate approval.

Final OSD detail on station levels is subject to issue of the relevant construction certificate and approved Station Design and Precinct Plan.

Scale / North Point

1:200 @ A1, 1:400 @ A3

General Notes

Do not scale from drawing. Use marked dimensions. To be read in conjunction with all other Consultant's drawings. The Architect to be immediately notified of any discrepancies. Copyright on this drawing retained by the Architect.

Notes

This architectural package describes the North Tower. Refer to Grimshaw for Metro and Trains for South Tower

Disclaimer

Street trees, furniture and other public domain elements within the precinct are indicative only and are subject to relevant approvals and detailed coordination with new and existing underground utilities and infrastructure.

Authoring Organisation

**GRIMSHAW**

Grimshaw  
Level 2, 333 George Street, Sydney  
New South Wales 2000 Australia

Telephone ++ 61 2 9253 0200  
Email info@grimshaw-architects.com

Architect

**JPW  
JOHNSON PILTON WALKER**

Johnson Pilton Walker Pty Ltd ACN 095 778 886  
Level 10 Plaza Building Australia Square 95 Pitt Street Sydney  
New South Wales 2000 Australia

Telephone +61 2 9259 5900  
Email jpw@jpw.com.au

Project Title

**SYDNEY METRO MARTIN PLACE -  
integrated station development**



Client  
Macquarie Group Ltd  
50 Martin Place, Sydney  
New South Wales 2000 Australia

Telephone +61 2 8232 3333  
Email: www.macquarie.com

Drawing Title

**SYDNEY METRO - MARTIN PLACE  
LEVEL 27 PLAN  
GENERAL ARRANGEMENT**

Status

**STAGE II SSDA**

Drawing Number

**CSWSMP-MAC-SMN-AT-DRG-DA-302700**

Revision

**F**

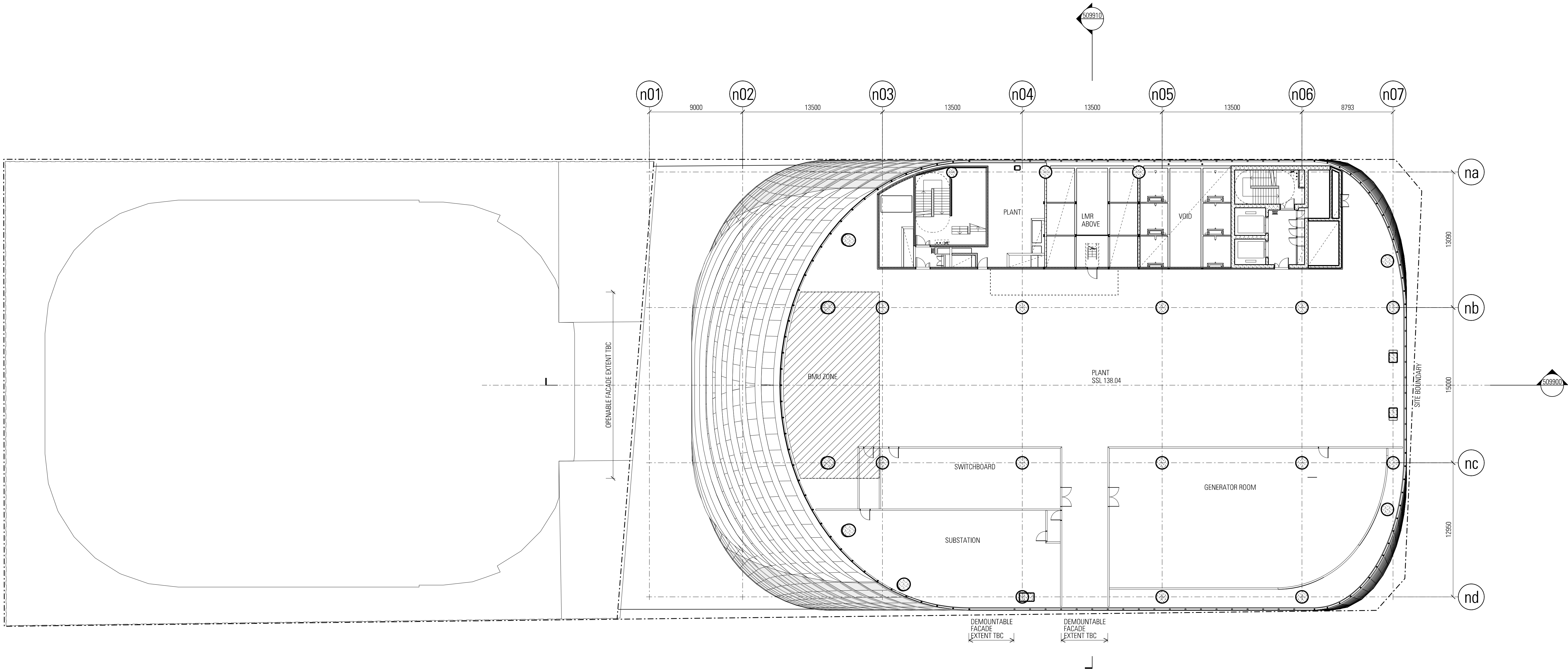

| Rev | App | Ckd | Revision or reason for issue | Date     | Legend |
|-----|-----|-----|------------------------------|----------|--------|
| A   | PB  | PVR | Stage 2 DA Draft             | 29-06-18 |        |
| B   | PB  | PVR | Stage 2 DA Draft             | 06-07-18 |        |
| C   | PB  | PVR | Stage 2 DA Draft             | 16-07-18 |        |
| D   | PB  | PVR | Stage 2 DA                   | 03-08-18 |        |
| E   | PB  | PVR | Stage 2 DA                   | 07-08-18 |        |
| F   | PB  | PVR | Stage 2 DA                   | 22-08-18 |        |

CSST Areas (not for approval)

CSST detail is indicative and subject to separate approval.

Final OSD detail on station levels is subject to issue of the relevant construction certificate and approved Station Design and Precinct Plan.

Scale / North Point

1:200 @ A1, 1:400 @ A3

General Notes

Do not scale from drawing. Use marked dimensions. To be read in conjunction with all other Consultant's drawings. The Architect to be immediately notified of any discrepancies. Copyright on this drawing retained by the Architect.

Notes

This architectural package describes the North Tower. Refer to Grimshaw for Metro and Tzannes for South Tower

Disclaimer

Street trees, furniture and other public domain elements within the precinct are indicative only and are subject to relevant approvals and detailed coordination with new and existing underground utilities and infrastructure.

Authoring Organisation

GRIMSHAW

Grimshaw  
Level 2, 333 George Street, Sydney  
New South Wales 2000 Australia

Telephone ++ +61 2 9253 0200  
Email info@grimshaw-architects.com

Architect

JPW  
JOHNSON PILTON WALKER

Johnson Pilton Walker Pty Ltd ACN 095 778 886  
Level 10 Plaza Building Australia Square 95 Pitt Street Sydney  
New South Wales 2000 Australia

Telephone +61 2 9259 5900  
Email jpw@jpw.com.au

Project Title

SYDNEY METRO MARTIN PLACE -  
integrated station development



Client  
Macquarie Group Ltd  
50 Martin Place, Sydney  
New South Wales 2000 Australia

Telephone +61 2 8232 3333  
Email: www.macquarie.com

Drawing Title

SYDNEY METRO - MARTIN PLACE  
LEVEL 28 PLAN  
GENERAL ARRANGEMENT

Status  
STAGE II SSDA

Drawing Number  
CSWSMP-MAC-SMN-AT-DRG-DA-302800

Revision

F

| Rev | App | Ckd | Revision or reason for issue | Date     | Legend |
|-----|-----|-----|------------------------------|----------|--------|
| A   | PB  | PVR | Stage 2 DA Draft             | 29-06-18 |        |
| B   | PB  | PVR | Stage 2 DA Draft             | 06-07-18 |        |
| C   | PB  | PVR | Stage 2 DA Draft             | 18-07-18 |        |
| D   | PB  | PVR | Stage 2 DA                   | 03-08-18 |        |
| E   | PB  | PVR | Stage 2 DA                   | 07-08-18 |        |
| F   | PB  | PVR | Stage 2 DA                   | 22-08-18 |        |

CSST Areas (not for approval)

CSST detail is indicative and subject to separate approval.

Final OSD detail on station levels is subject to issue of the relevant construction certificate and approved Station Design and Precinct Plan.

Scale / North Point

1:200 @ A1, 1:400 @ A3

General Notes

Do not scale from drawing. Use marked dimensions. To be read in conjunction with all other Consultant's drawings. The Architect to be immediately notified of any discrepancies. Copyright on this drawing retained by the Architect.

Notes

This architectural package describes the North Tower. Refer to Grimshaw for Metro and Trains for South Tower

Disclaimer

Street trees, furniture and other public domain elements within the precinct are indicative only and are subject to relevant approvals and detailed coordination with new and existing underground utilities and infrastructure.

Authoring Organisation

**GRIMSHAW**

Grimshaw  
Level 2, 333 George Street, Sydney  
New South Wales 2000 Australia

Telephone ++ 61 2 9253 0200  
Email info@grimshaw-architects.com

Architect

**JPW  
JOHNSON PILTON WALKER**

Johnson Pilton Walker Pty Ltd ACN 095 778 886  
Level 10 Plaza Building Australia Square 95 Pitt Street Sydney  
New South Wales 2000 Australia

Telephone +61 2 9259 5900  
Email jpw@jpw.com.au

Project Title

**SYDNEY METRO MARTIN PLACE -  
integrated station development**



Client  
Macquarie Group Ltd  
50 Martin Place, Sydney  
New South Wales 2000 Australia

Telephone +61 2 8232 3333  
Email: www.macquarie.com

Drawing Title

**SYDNEY METRO - MARTIN PLACE  
LEVEL 29 PLAN  
GENERAL ARRANGEMENT**

Status

**STAGE II SSDA**

Drawing Number

**CSWSMP-MAC-SMN-AT-DRG-DA-302900**

Revision

**F**



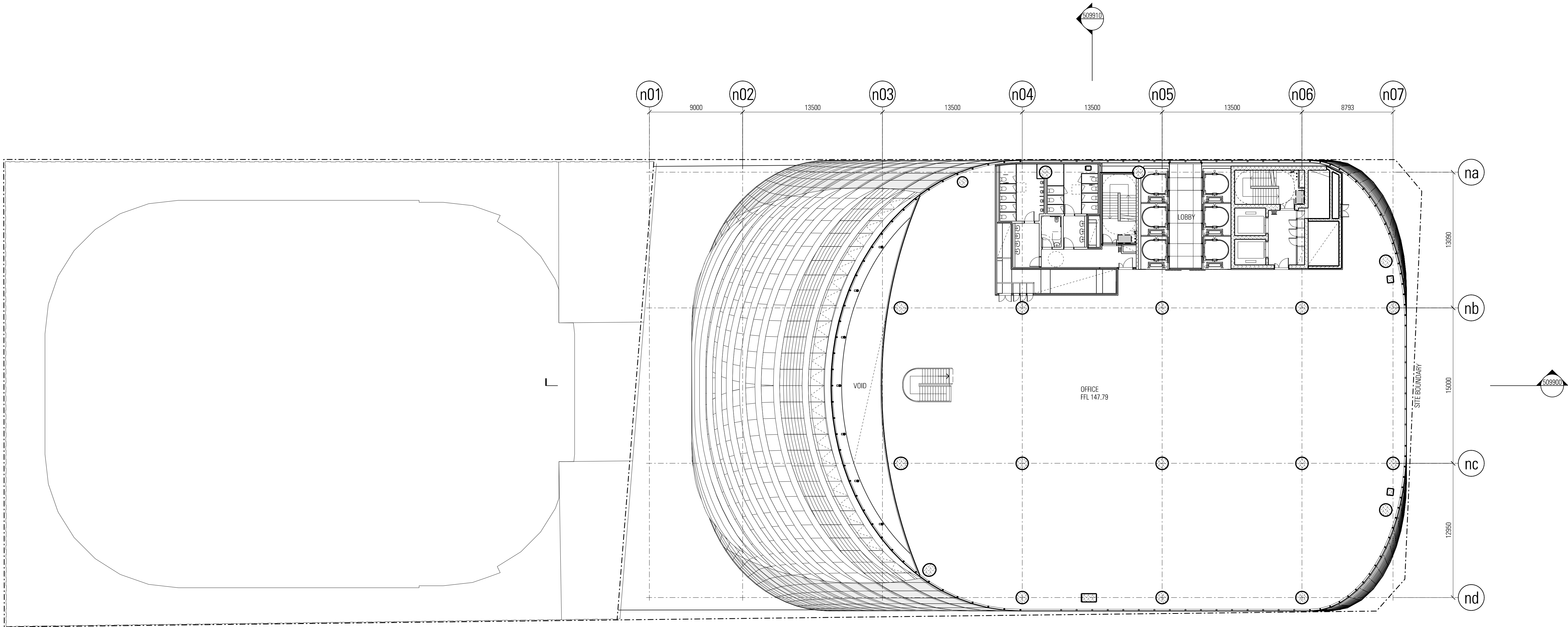

| Rev | App | Ckd | Revision or reason for issue | Date     | Legend |
|-----|-----|-----|------------------------------|----------|--------|
| A   | PB  | PVR | Stage 2 DA Draft             | 29-06-18 |        |
| B   | PB  | PVR | Stage 2 DA Draft             | 06-07-18 |        |
| C   | PB  | PVR | Stage 2 DA Draft             | 18-07-18 |        |
| D   | PB  | PVR | Stage 2 DA                   | 03-08-18 |        |
| E   | PB  | PVR | Stage 2 DA                   | 07-08-18 |        |
| F   | PB  | PVR | Stage 2 DA                   | 22-08-18 |        |

CSST Areas (not for approval)

CSST detail is indicative and subject to separate approval.

Final OSD detail on station levels is subject to issue of the relevant construction certificate and approved Station Design and Precinct Plan.

Scale / North Point

1:200 @ A1, 1:400 @ A3

General Notes

Do not scale from drawing. Use marked dimensions. To be read in conjunction with all other Consultant's drawings. The Architect to be immediately notified of any discrepancies. Copyright on this drawing retained by the Architect.

Notes

This architectural package describes the North Tower. Refer to Grimshaw for Metro and Tzannes for South Tower

Disclaimer

Street trees, furniture and other public domain elements within the precinct are indicative only and are subject to relevant approvals and detailed coordination with new and existing underground utilities and infrastructure.

Authoring Organisation

GRIMSHAW

Grimshaw  
Level 2, 333 George Street, Sydney  
New South Wales 2000 Australia

Telephone ++ 61 2 9253 0200  
Email info@grimshaw-architects.com

Architect

JPW  
JOHNSON PILTON WALKER

Johnson Pilton Walker Pty Ltd ACN 095 778 886  
Level 10 Plaza Building Australia Square 95 Pitt Street Sydney  
New South Wales 2000 Australia

Telephone +61 2 9259 5900  
Email jpw@jpw.com.au

Project Title

SYDNEY METRO MARTIN PLACE -  
integrated station development



Client  
Macquarie Group Ltd  
50 Martin Place, Sydney  
New South Wales 2000 Australia

Telephone +61 2 8232 3333  
Email: www.macquarie.com

Drawing Title

SYDNEY METRO - MARTIN PLACE  
LEVEL 30 PLAN  
GENERAL ARRANGEMENT

Status Revision

STAGE II SSDA F

Drawing Number

CSWSMP-MAC-SMN-AT-DRG-DA-303000

| Rev | App | Ckd | Revision or reason for issue | Date     | Legend |
|-----|-----|-----|------------------------------|----------|--------|
| A   | PB  | PVR | Stage 2 DA Draft             | 29-06-18 |        |
| B   | PB  | PVR | Stage 2 DA Draft             | 06-07-18 |        |
| C   | PB  | PVR | Stage 2 DA Draft             | 18-07-18 |        |
| D   | PB  | PVR | Stage 2 DA                   | 03-08-18 |        |
| E   | PB  | PVR | Stage 2 DA                   | 07-08-18 |        |
| F   | PB  | PVR | Stage 2 DA                   | 22-08-18 |        |

CSST Areas (not for approval)

CSST detail is indicative and subject to separate approval.

Final OSD detail on station levels is subject to issue of the relevant construction certificate and approved Station Design and Precinct Plan.

Scale / North Point

1:200 @ A1, 1:400 @ A3

General Notes

Do not scale from drawing. Use marked dimensions. To be read in conjunction with all other Consultant's drawings. The Architect to be immediately notified of any discrepancies. Copyright on this drawing retained by the Architect.

Notes

This architectural package describes the North Tower. Refer to Grimshaw for Metro and Trains for South Tower

Disclaimer

Street trees, furniture and other public domain elements within the precinct are indicative only and are subject to relevant approvals and detailed coordination with new and existing underground utilities and infrastructure.

Authoring Organisation

**GRIMSHAW**

Grimshaw  
Level 2, 333 George Street, Sydney  
New South Wales 2000 Australia

Telephone ++ 61 2 9253 0200  
Email info@grimshaw-architects.com

Architect

**JPW  
JOHNSON PILTON WALKER**

Johnson Pilton Walker Pty Ltd ACN 095 778 886  
Level 10 Plaza Building Australia Square 95 Pitt Street Sydney  
New South Wales 2000 Australia

Telephone +61 2 9259 5900  
Email jpw@jpw.com.au

Project Title

**SYDNEY METRO MARTIN PLACE -  
Integrated station development**



Client  
Macquarie Group Ltd  
50 Martin Place, Sydney  
New South Wales 2000 Australia

Telephone +61 2 8232 3333  
Email: www.macquarie.com

Drawing Title

**SYDNEY METRO - MARTIN PLACE  
LEVEL 31 PLAN  
GENERAL ARRANGEMENT**

Status

**STAGE II SSDA**

Drawing Number

**CSWSMP-MAC-SMN-AT-DRG-DA-303100**

Revision

**F**

| Rev | App | Ckd | Revision or reason for issue | Date     | Legend |
|-----|-----|-----|------------------------------|----------|--------|
| A   | PB  | PVR | Stage 2 DA Draft             | 29-06-18 |        |
| B   | PB  | PVR | Stage 2 DA Draft             | 06-07-18 |        |
| C   | PB  | PVR | Stage 2 DA Draft             | 18-07-18 |        |
| D   | PB  | PVR | Stage 2 DA                   | 03-08-18 |        |
| E   | PB  | PVR | Stage 2 DA                   | 07-08-18 |        |
| F   | PB  | PVR | Stage 2 DA                   | 22-08-18 |        |

CSST Areas (not for approval)

CSST detail is indicative and subject to separate approval.

Final OSD detail on station levels is subject to issue of the relevant construction certificate and approved Station Design and Precinct Plan.

Scale / North Point

1:200 @ A1, 1:400 @ A3

General Notes

Do not scale from drawing. Use marked dimensions. To be read in conjunction with all other Consultant's drawings. The Architect to be immediately notified of any discrepancies. Copyright on this drawing retained by the Architect.

Notes

This architectural package describes the North Tower. Refer to Grimshaw for Metro and Trains for South Tower

Disclaimer

Street trees, furniture and other public domain elements within the precinct are indicative only and are subject to relevant approvals and detailed coordination with new and existing underground utilities and infrastructure.

Authoring Organisation

**GRIMSHAW**

Grimshaw  
Level 2, 333 George Street, Sydney  
New South Wales 2000 Australia

Telephone ++ 61 2 9253 0200  
Email info@grimshaw-architects.com

Architect

**JPW  
JOHNSON PILTON WALKER**

Johnson Pilton Walker Pty Ltd ACN 095 778 886  
Level 10 Plaza Building Australia Square 95 Pitt Street Sydney  
New South Wales 2000 Australia

Telephone +61 2 9259 5900  
Email jpw@jpw.com.au

Project Title

**SYDNEY METRO MARTIN PLACE -  
Integrated station development**



Client  
Macquarie Group Ltd  
50 Martin Place, Sydney  
New South Wales 2000 Australia

Telephone +61 2 8232 3333  
Email: www.macquarie.com

Drawing Title

**SYDNEY METRO - MARTIN PLACE  
LEVEL 32 PLAN  
GENERAL ARRANGEMENT**

Status

**STAGE II SSDA**

Drawing Number

**CSWSMP-MAC-SMN-AT-DRG-DA-303200**

Revision

**F**

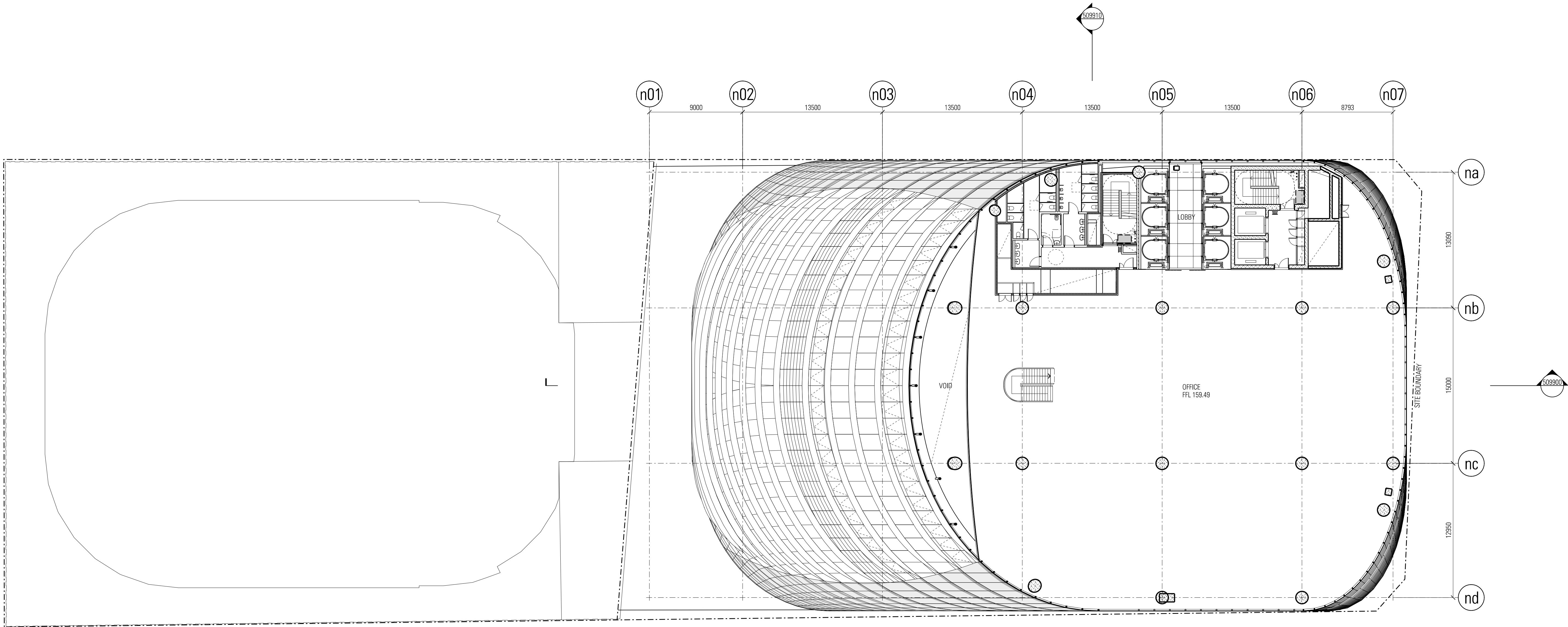

| Rev | App | Ckd | Revision or reason for issue | Date     | Legend |
|-----|-----|-----|------------------------------|----------|--------|
| A   | PB  | PVR | Stage 2 DA Draft             | 29-06-18 |        |
| B   | PB  | PVR | Stage 2 DA Draft             | 06-07-18 |        |
| C   | PB  | PVR | Stage 2 DA Draft             | 18-07-18 |        |
| D   | PB  | PVR | Stage 2 DA                   | 03-08-18 |        |
| E   | PB  | PVR | Stage 2 DA                   | 07-08-18 |        |
| F   | PB  | PVR | Stage 2 DA                   | 22-08-18 |        |

CSST Areas (not for approval)

CSST detail is indicative and subject to separate approval.

Final OSD detail on station levels is subject to issue of the relevant construction certificate and approved Station Design and Precinct Plan.

Scale / North Point

1:200 @ A1, 1:400 @ A3

General Notes

Do not scale from drawing. Use marked dimensions. To be read in conjunction with all other Consultant's drawings. The Architect to be immediately notified of any discrepancies. Copyright on this drawing retained by the Architect.

Notes

This architectural package describes the North Tower. Refer to Grimshaw for Metro and Tzannes for South Tower

Disclaimer

Street trees, furniture and other public domain elements within the precinct are indicative only and are subject to relevant approvals and detailed coordination with new and existing underground utilities and infrastructure.

Authoring Organisation

**GRIMSHAW**

Grimshaw  
Level 2, 333 George Street, Sydney  
New South Wales 2000 Australia

Telephone ++ 61 2 9253 0200  
Email info@grimshaw-architects.com

Architect

**JPW  
JOHNSON PILTON WALKER**

Johnson Pilton Walker Pty Ltd ACN 095 778 886  
Level 10 Plaza Building Australia Square 95 Pitt Street Sydney  
New South Wales 2000 Australia

Telephone +61 2 9259 5900  
Email jpw@jpw.com.au

Project Title

**SYDNEY METRO MARTIN PLACE -  
integrated station development**

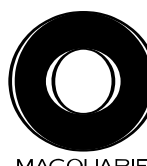

Client  
Macquarie Group Ltd  
50 Martin Place, Sydney  
New South Wales 2000 Australia

Telephone +61 2 8232 3333  
Email: www.macquarie.com

Drawing Title

**SYDNEY METRO - MARTIN PLACE  
LEVEL 33 PLAN  
GENERAL ARRANGEMENT**

Status Revision

**STAGE II SSDA** F

Drawing Number

**CSWSMP-MAC-SMN-AT-DRG-DA-303300**



| Rev | App | Ckd | Revision or reason for issue | Date     | Legend |
|-----|-----|-----|------------------------------|----------|--------|
| A   | PB  | PVR | Stage 2 DA Draft             | 29-06-18 |        |
| B   | PB  | PVR | Stage 2 DA Draft             | 06-07-18 |        |
| C   | PB  | PVR | Stage 2 DA Draft             | 18-07-18 |        |
| D   | PB  | PVR | Stage 2 DA                   | 03-08-18 |        |
| E   | PB  | PVR | Stage 2 DA                   | 07-08-18 |        |
| F   | PB  | PVR | Stage 2 DA                   | 22-08-18 |        |

CSST Areas (not for approval)

CSST detail is indicative and subject to separate approval.

Final OSD detail on station levels is subject to issue of the relevant construction certificate and approved Station Design and Precinct Plan.

Scale / North Point

1:200 @ A1, 1:400 @ A3

General Notes

Do not scale from drawing. Use marked dimensions. To be read in conjunction with all other Consultant's drawings. The Architect to be immediately notified of any discrepancies. Copyright on this drawing retained by the Architect.

Notes

This architectural package describes the North Tower. Refer to Grimshaw for Metro and Trains for South Tower

Disclaimer

Street trees, furniture and other public domain elements within the precinct are indicative only and are subject to relevant approvals and detailed coordination with new and existing underground utilities and infrastructure.

Authoring Organisation

**GRIMSHAW**

Grimshaw  
Level 2, 333 George Street, Sydney  
New South Wales 2000 Australia

Telephone ++ +61 2 9253 0200  
Email info@grimshaw-architects.com

Architect

**JPW  
JOHNSON PILTON WALKER**

Johnson Pilton Walker Pty Ltd ACN 095 778 886  
Level 10 Plaza Building Australia Square 95 Pitt Street Sydney  
New South Wales 2000 Australia

Telephone +61 2 9259 5900  
Email jpw@jpw.com.au

Project Title

**SYDNEY METRO - MARTIN PLACE -  
integrated station development**



Client  
Macquarie Group Ltd  
50 Martin Place, Sydney  
New South Wales 2000 Australia

Telephone +61 2 8232 3333  
Email: www.macquarie.com

Drawing Title

**SYDNEY METRO - MARTIN PLACE  
LEVEL 34 PLAN  
GENERAL ARRANGEMENT**

Status

**STAGE II SSDA**

Drawing Number

**CSWSMP-MAC-SMN-AT-DRG-DA-303400**

Revision

**F**

| Rev | App | Ckd | Revision or reason for issue | Date     | Legend |
|-----|-----|-----|------------------------------|----------|--------|
| A   | PB  | PVR | Stage 2 DA Draft             | 29-06-18 |        |
| B   | PB  | PVR | Stage 2 DA Draft             | 06-07-18 |        |
| C   | PB  | PVR | Stage 2 DA Draft             | 18-07-18 |        |
| D   | PB  | PVR | Stage 2 DA                   | 03-08-18 |        |
| E   | PB  | PVR | Stage 2 DA                   | 07-08-18 |        |
| F   | PB  | PVR | Stage 2 DA                   | 22-08-18 |        |

CSST Areas (not for approval)

CSST detail is indicative and subject to separate approval.

Final OSD detail on station levels is subject to issue of the relevant construction certificate and approved Station Design and Precinct Plan.

Scale / North Point

1:200 @ A1, 1:400 @ A3

General Notes

Do not scale from drawing. Use marked dimensions. To be read in conjunction with all other Consultant's drawings. The Architect to be immediately notified of any discrepancies. Copyright on this drawing retained by the Architect.

Notes

This architectural package describes the North Tower. Refer to Grimshaw for Metro and Tzannes for South Tower

Disclaimer

Street trees, furniture and other public domain elements within the precinct are indicative only and are subject to relevant approvals and detailed coordination with new and existing underground utilities and infrastructure.

Authoring Organisation

**GRIMSHAW**

Grimshaw  
Level 2, 333 George Street, Sydney  
New South Wales 2000 Australia

Telephone ++ +61 2 9253 0200  
Email info@grimshaw-architects.com

Architect

**JPW  
JOHNSON PILTON WALKER**

Johnson Pilton Walker Pty Ltd ACN 095 778 886  
Level 10 Plaza Building Australia Square 95 Pitt Street Sydney  
New South Wales 2000 Australia

Telephone +61 2 9259 5900  
Email jpw@jpw.com.au

Project Title

**SYDNEY METRO - MARTIN PLACE -  
integrated station development**



Client  
Macquarie Group Ltd  
50 Martin Place, Sydney  
New South Wales 2000 Australia

Telephone +61 2 8232 3333  
Email: www.macquarie.com

Drawing Title

**SYDNEY METRO - MARTIN PLACE  
LEVEL 35 PLAN  
GENERAL ARRANGEMENT**

Status

**STAGE II SSDA**

Drawing Number

**CSWSMP-MAC-SMN-AT-DRG-DA-303500**

Revision

**F**



| Rev | App | Ckd | Revision or reason for issue | Date     |
|-----|-----|-----|------------------------------|----------|
| A   | PB  | PVR | Stage 2 DA Draft             | 29-06-18 |
| B   | PB  | PVR | Stage 2 DA Draft             | 06-07-18 |
| C   | PB  | PVR | Stage 2 DA Draft             | 18-07-18 |
| D   | PB  | PVR | Stage 2 DA                   | 03-08-18 |
| E   | PB  | PVR | Stage 2 DA                   | 07-08-18 |
| F   | PB  | PVR | Stage 2 DA                   | 22-08-18 |

| Legend | Date     |
|--------|----------|
|        | 29-06-18 |
|        | 06-07-18 |
|        | 18-07-18 |
|        | 03-08-18 |
|        | 07-08-18 |
|        | 22-08-18 |

CSWI Areas (not for approval)

CSWI detail is indicative and subject to separate approval.

Final OSD detail on station levels is subject to issue of the relevant construction certificate and approved Station Design and Precinct Plan.

Scale / North Point

1:200 @ A1, 1:400 @ A3

General Notes

Do not scale from drawing. Use marked dimensions. To be read in conjunction with all other Consultant's drawings. The Architect to be immediately notified of any discrepancies. Copyright on this drawing retained by the Architect.

Notes

This architectural package describes the North Tower. Refer to Grimshaw for Metro and Trains for South Tower

Disclaimer

Street trees, furniture and other public domain elements within the precinct are indicative only and are subject to relevant approvals and detailed coordination with new and existing underground utilities and infrastructure.

Authoring Organisation

**GRIMSHAW**

Grimshaw  
Level 2, 333 George Street, Sydney  
New South Wales 2000 Australia

Telephone ++ +61 2 9253 0200  
Email info@grimshaw-architects.com

Architect

**JPW  
JOHNSON PILTON WALKER**

Johnson Pilton Walker Pty Ltd ACN 095 778 886  
Level 10 Plaza Building Australia Square 95 Pitt Street Sydney  
New South Wales 2000 Australia

Telephone +61 2 8259 5900  
Email jpw@jpw.com.au

Project Title

**SYDNEY METRO - MARTIN PLACE -  
integrated station development**



Client  
Macquarie Group Ltd  
50 Martin Place, Sydney  
New South Wales 2000 Australia

Telephone +61 2 8232 3333  
Email: www.macquarie.com

Drawing Title

**SYDNEY METRO - MARTIN PLACE  
LEVEL 36 PLAN  
GENERAL ARRANGEMENT**

Status Revision

**STAGE II SSDA** F

Drawing Number

CSWSMP-MAC-SMN-AT-DRG-DA-303600

| Rev | App | Ckd | Revision or reason for issue | Date     | Legend |
|-----|-----|-----|------------------------------|----------|--------|
| A   | PB  | PVR | Stage 2 DA Draft             | 29-06-18 |        |
| B   | PB  | PVR | Stage 2 DA Draft             | 06-07-18 |        |
| C   | PB  | PVR | Stage 2 DA Draft             | 18-07-18 |        |
| D   | PB  | PVR | Stage 2 DA                   | 03-08-18 |        |
| E   | PB  | PVR | Stage 2 DA                   | 07-08-18 |        |
| F   | PB  | PVR | Stage 2 DA                   | 22-08-18 |        |

CSST Areas (not for approval)

CSST detail is indicative and subject to separate approval.

Final OSD detail on station levels is subject to issue of the relevant construction certificate and approved Station Design and Precinct Plan.

Scale / North Point

1:200 @ A1, 1:400 @ A3

General Notes

Do not scale from drawing. Use marked dimensions. To be read in conjunction with all other Consultant's drawings. The Architect to be immediately notified of any discrepancies. Copyright on this drawing retained by the Architect.

Notes

This architectural package describes the North Tower. Refer to Grimshaw for Metro and Trains for South Tower

Disclaimer

Street trees, furniture and other public domain elements within the precinct are indicative only and are subject to relevant approvals and detailed coordination with new and existing underground utilities and infrastructure.

Authoring Organisation

**GRIMSHAW**

Grimshaw  
Level 2, 333 George Street, Sydney  
New South Wales 2000 Australia

Telephone ++ +61 2 9253 0200  
Email info@grimshaw-architects.com

Architect

**JPW  
JOHNSON PILTON WALKER**

Johnson Pilton Walker Pty Ltd ACN 095 778 886  
Level 10 Plaza Building Australia Square 95 Pitt Street Sydney  
New South Wales 2000 Australia

Telephone +61 2 9259 5900  
Email jpw@jpw.com.au

Project Title

**SYDNEY METRO - MARTIN PLACE -  
integrated station development**



Client  
Macquarie Group Ltd  
50 Martin Place, Sydney  
New South Wales 2000 Australia

Telephone +61 2 8232 3333  
Email: www.macquarie.com

Drawing Title

**SYDNEY METRO - MARTIN PLACE  
LEVEL 37 PLAN  
GENERAL ARRANGEMENT**

Status

**STAGE II SSDA**

Drawing Number

**CSWSMP-MAC-SMN-AT-DRG-DA-303700**

Revision

**F**

| Rev | App | Ckd | Revision or reason for issue | Date     | Legend |
|-----|-----|-----|------------------------------|----------|--------|
| A   | PB  | PVR | Stage 2 DA Draft             | 29-06-18 |        |
| B   | PB  | PVR | Stage 2 DA Draft             | 06-07-18 |        |
| C   | PB  | PVR | Stage 2 DA Draft             | 18-07-18 |        |
| D   | PB  | PVR | Stage 2 DA                   | 03-08-18 |        |
| E   | PB  | PVR | Stage 2 DA                   | 07-08-18 |        |
| F   | PB  | PVR | Stage 2 DA                   | 22-08-18 |        |

CSST Areas (not for approval)

CSST detail is indicative and subject to separate approval.

Final OSD detail on station levels is subject to issue of the relevant construction certificate and approved Station Design and Precinct Plan.

Scale / North Point

1:200 @ A1, 1:400 @ A3

General Notes

Do not scale from drawing. Use marked dimensions. To be read in conjunction with all other Consultant's drawings. The Architect to be immediately notified of any discrepancies. Copyright on this drawing retained by the Architect.

Notes

This architectural package describes the North Tower. Refer to Grimshaw for Metro and Tzannes for South Tower

Disclaimer

Street trees, furniture and other public domain elements within the precinct are indicative only and are subject to relevant approvals and detailed coordination with new and existing underground utilities and infrastructure.

Authoring Organisation

**GRIMSHAW**

Grimshaw  
Level 2, 333 George Street, Sydney  
New South Wales 2000 Australia

Telephone ++ +61 2 9253 0200  
Email info@grimshaw-architects.com

Architect

**JPW  
JOHNSON PILTON WALKER**

Johnson Pilton Walker Pty Ltd ACN 095 778 886  
Level 10 Plaza Building Australia Square 95 Pitt Street Sydney  
New South Wales 2000 Australia

Telephone +61 2 9259 5900  
Email jpw@jpw.com.au

Project Title

**SYDNEY METRO MARTIN PLACE -  
integrated station development**



Client  
Macquarie Group Ltd  
50 Martin Place, Sydney  
New South Wales 2000 Australia

Telephone +61 2 8232 3333  
Email: www.macquarie.com

Drawing Title

**SYDNEY METRO - MARTIN PLACE  
LEVEL 38 PLAN  
GENERAL ARRANGEMENT**

Status

**STAGE II SSDA**

Drawing Number

**CSWSMP-MAC-SMN-AT-DRG-DA-303800**

Revision

**F**