

Guidelines

Public Realm and Open Space

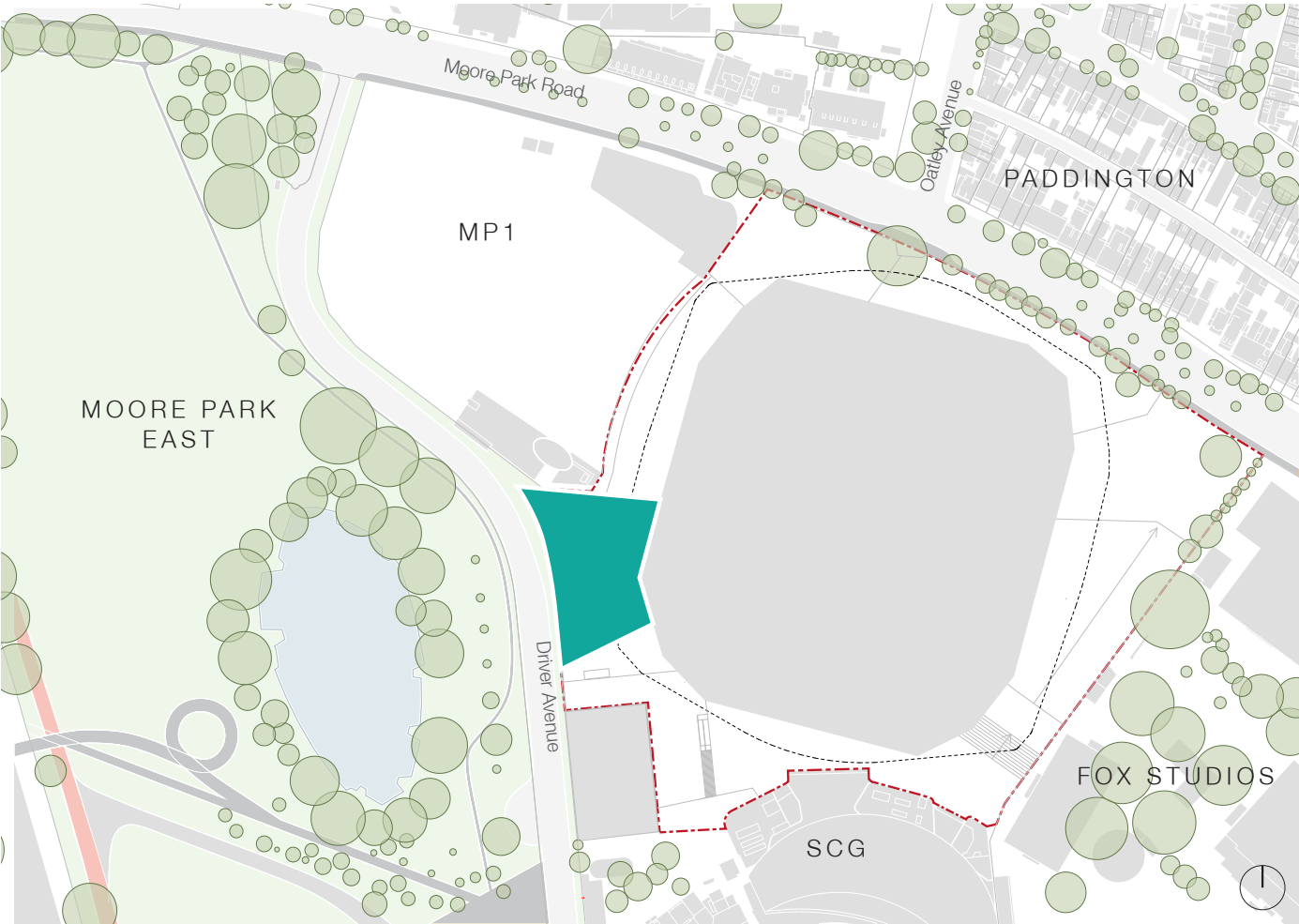

Driver Avenue Terraces Door

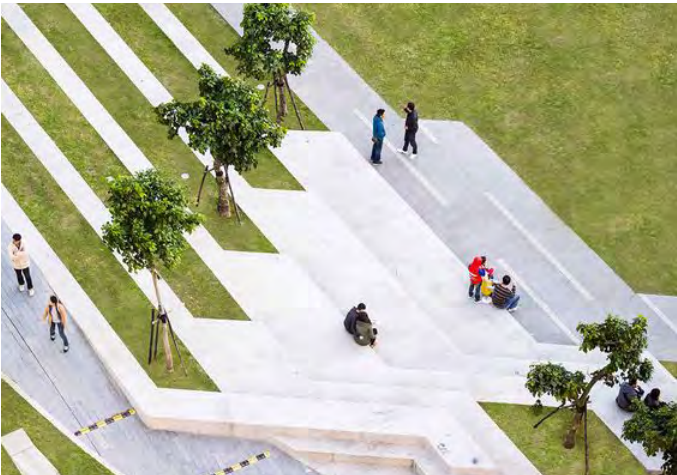

Precedent - Calligraphy Greenway, Taichung, Taiwan



Precedent - Central Park, Sydney

Driver Avenue Terraces

Event

Principles

Create an active and dynamic stadium “front door” along Driver Avenue to enhance the event day experience, transition Moore Park to the stadium and provide connection to public and active transport uses.

Guidelines

- Frame views to and from the stadium from key access routes and Moore Park
- Integrate the “front door” with temporary uses located around Kippax Lake, the proposed Sydney Common and other public domain upgrades proposed by the Moore Park Master Plan 2040
- Provide activity zones around and integrated with the terraces for gatherings, activation and food/beverage uses
- Allow the Moore Park landscape aesthetic and character to influence the design of the Driver Ave Terraces and Stadium public domain design in this area
- Promote use of soft landscape within the stadium site to reduce the heat island effect and create comfortable spaces for the public
- Address the configuration of Driver Avenue to reduce its intrusion on Moore Park and to create a less distinct buffer between the park and Stadium
- Define the stadium security line and locate publicly accessible amenity in response to event requirements

Key

- Site Boundary
- Key Public Spaces
- External Concourse
- Open Space
- Kippax Lake

Day-to-Day

Principles

Create a multipurpose space that provides the public with new passive and active recreation opportunities to take advantage of the parkland setting and the range of day-to-day sporting uses on-site.

Guidelines

- Embed passive surveillance and spatial legibility by reducing visual obstructions
- Promote recreational use of the SFS through the provision of multi purposes spaces and infrastructure including public domain furniture, planting and sporting facilities
- Leverage the parkland setting to enhance day-to-day uses of the site through an extension of character and provision of additional amenity such as bike parking and exercise facilities

Guidelines

Public Realm and Open Space

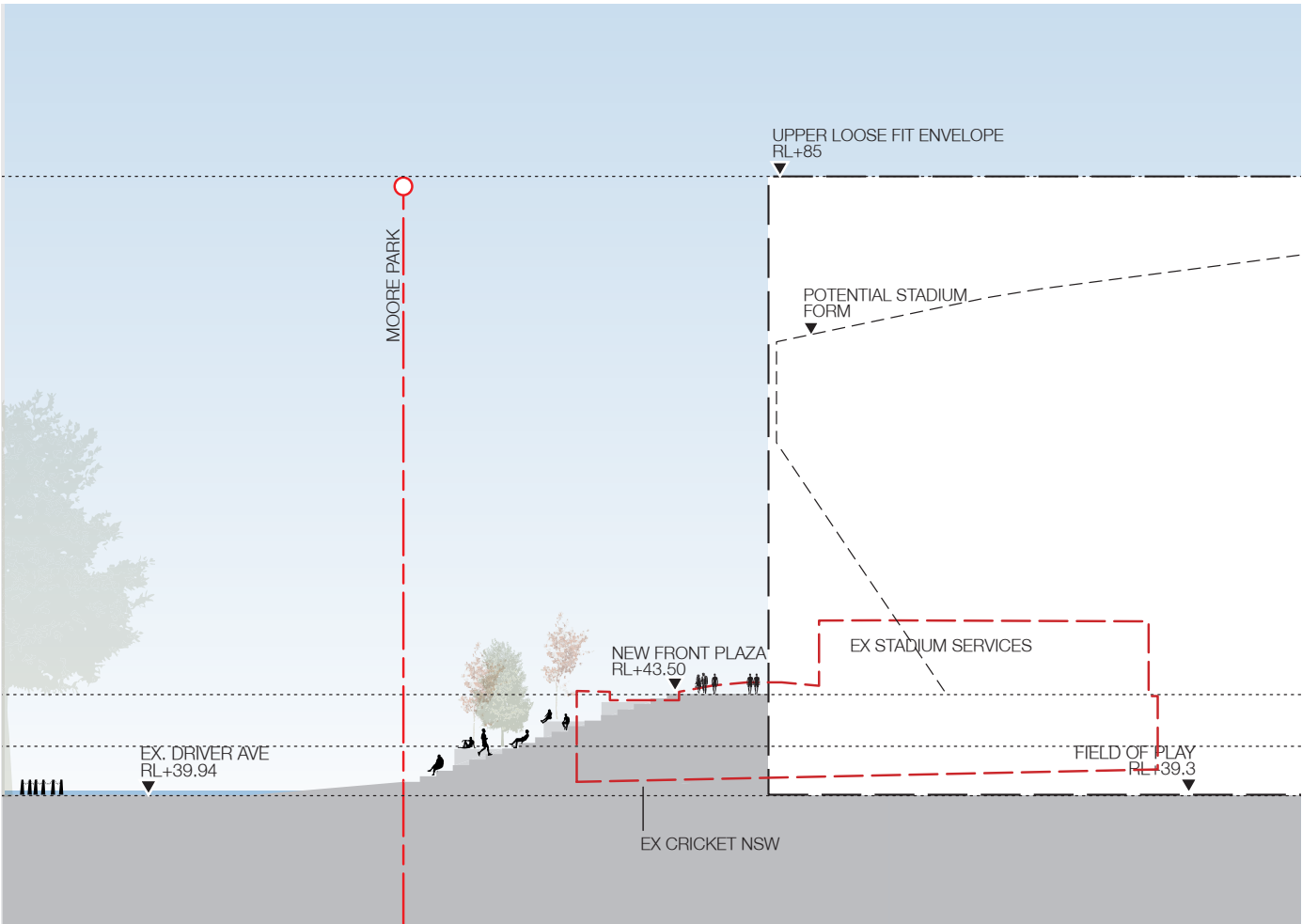

Driver Avenue Terraces Section

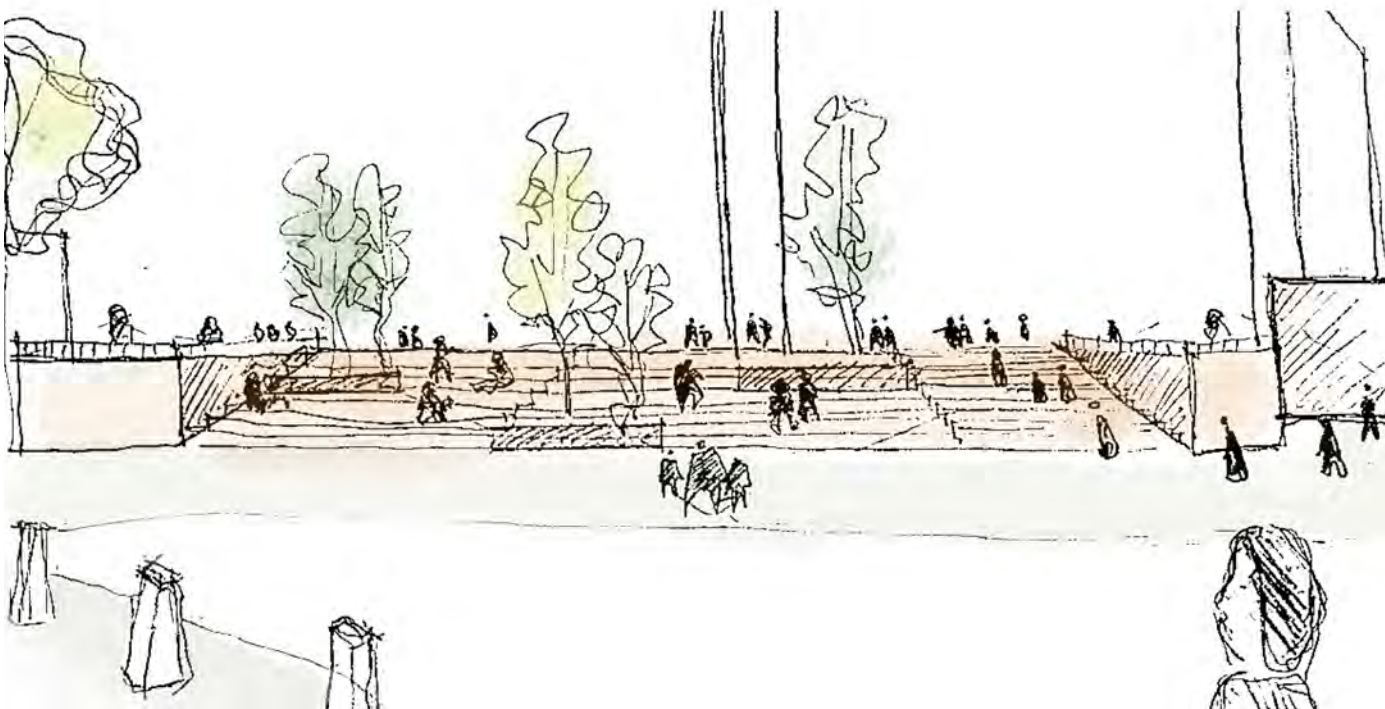

Driver Avenue Terraces Section

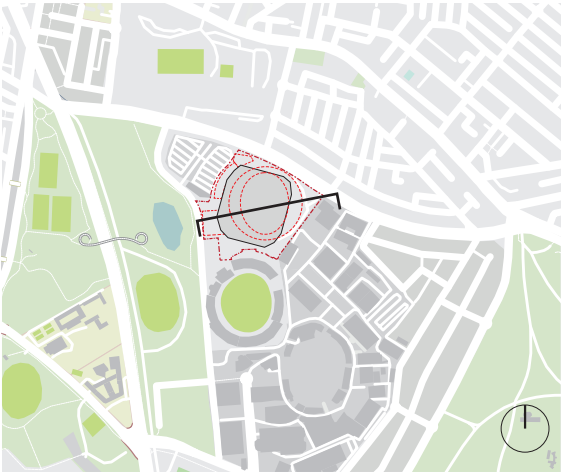

Section Plan

Guidelines

Public Realm and Open Space

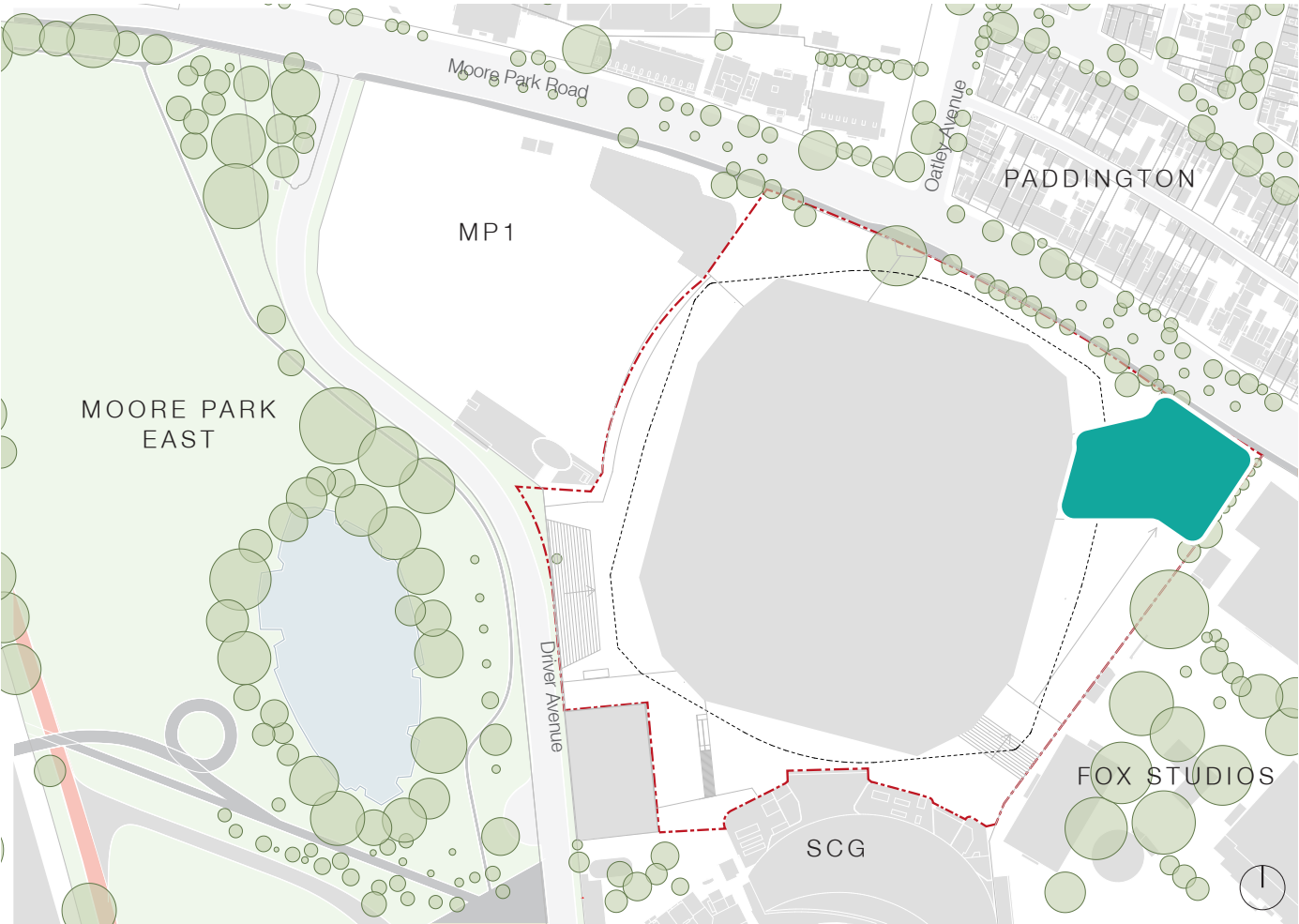

Moore Park Road Front Door



Precedent - Neue Meile Böblingen, Oslo, Norway



Precedent - Bonn Square, Oxford, UK

Moore Park Road Plaza

Event

Principles
Create an active and inviting stadium entry along Moore Park Road to enhance the event day experience, support opportunities for gathering, accommodate activation and facilitate breakout spaces for merchandise, food and beverage outlets.

- Guidelines*
- Provide activation and food/beverage opportunities at external concourse level
 - Frame views towards the stadium and along the Moore Park Road frontage
 - Prioritise pedestrian movement from Paddington and surrounds over vehicular access to Paddington Lane
 - Utilise tree planting to create a pleasant and welcoming pedestrian environment
 - Integrate existing site features such as sculptures in a meaningful way to create a feature and destination of this part of the site
 - Integrate with surrounding wayfinding and ensure clear signage for connections to the stadium, entry points and other local destinations
 - Integrate Moore Park Road public domain, footpath and cycleway with the external concourse to the north of the Stadium

- Retain, protect and enhance the existing tree planting along Moore Park Road. Utilise planting to provide separation between vehicular movement on Moore Park Road and public concourse / footpath
- Integrate hostile vehicle barriers along Moore Park Road, integrated with other public domain elements to minimise clutter

Day to Day

Principles
Create an inviting local entry that builds upon existing pedestrian / cycle connections and encourages the public to utilise space around the stadium as access through to Moore Park.

- Guidelines*
- Integrate wayfinding for Moore Park and Moore Park Light Rail Stop
 - Embed passive surveillance within the stadium form
 - Consider implementing an operable line of security to manage use of concourse outside of operational hours in areas that have low levels of accessibility, passive surveillance and may pose a threat to safety and security within the site
 - Promote spatial legibility by reducing visual obstructions, providing appropriate lighting and continuous, accessible concourse paving to guide pedestrians through the space
 - Select hardscape materials to visually stitch public domain spaces and paths outside the site with those within

Key

- Site Boundary
- Key Public Spaces
- External Concourse
- Open Space
- Kippax Lake

Guidelines

Public Realm and Open Space

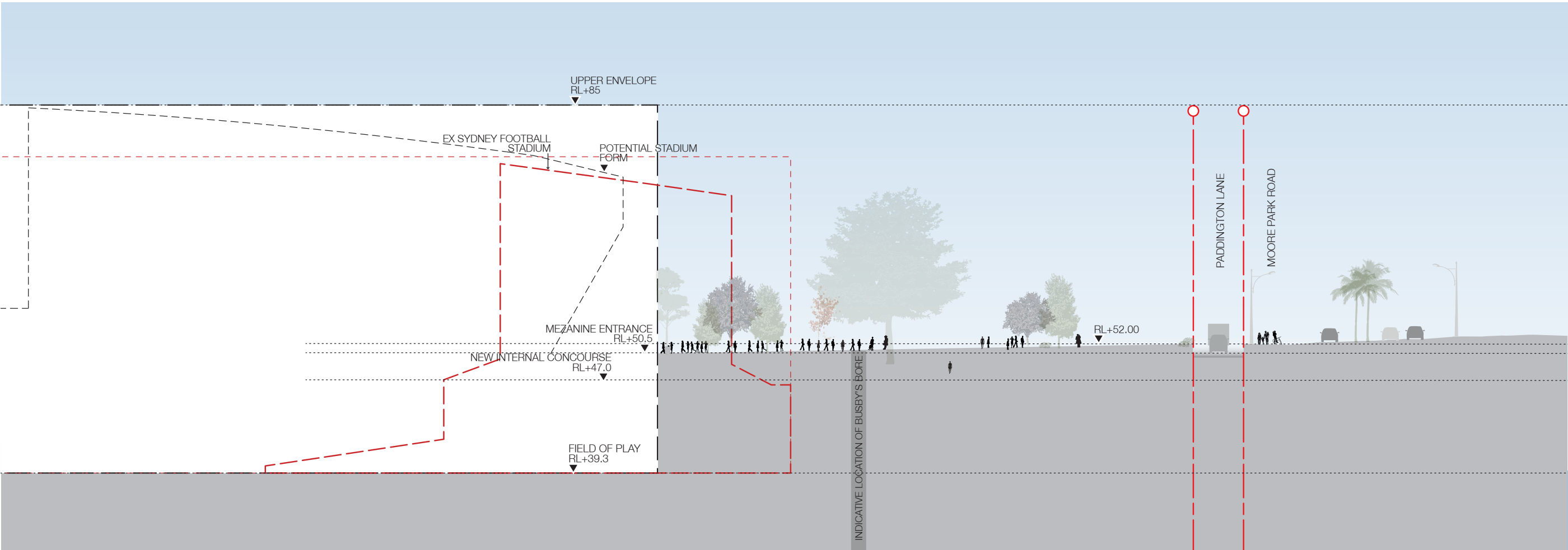

Moore Park Road Plaza Section

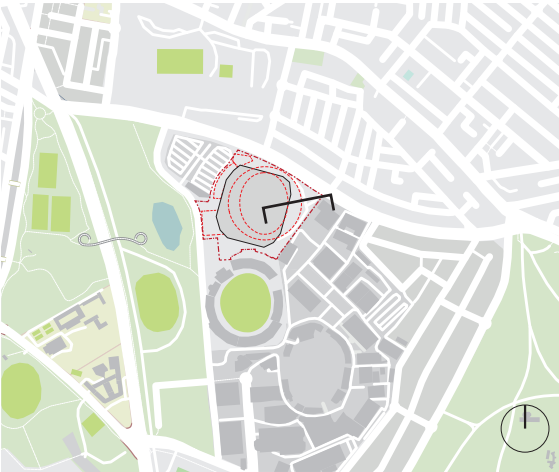

Section Plan

Guidelines

Public Realm and Open Space



Bradman Noble Terrace



Precedent - Mariahilferstrasse, Vienna, Austria



Precedent - Beekman Street Plazas, New York, USA

Sydney live Plaza

The Sydney Live Plaza will be used by both SCG and SFS patrons during events. It presents an opportunity to provide specific, curated activates and functions at defined times due to the contained nature of the area. The practice wicket in this area will provide a draw card and point of interest whilst in use.

The terrace is constrained by the need to maintain existing levels around the SCG stand, limited visibility from the key pedestrian access points, the clearance between the two stadiums and the need to maintain emergency egress routes. Through provision of operable barriers, access to the terrace can be restricted to ensure safety and security is maintained. The current levels of this terraced area will need to be retained to facilitate entry into the SCG Bradman Noble Stand and the food and beverage uses within. There will likely be a grade change between the external concourse and this terrace.

Principles

Create an active and easily accessible event space from both the SCG and SFS pedestrian access points that can be well utilised for temporary events

Guidelines

- Utilise clear wayfinding to guide patrons to the Bradman Noble Terrace
- Utilise landscape features, materials and finishes that guide people to the southern side of the stadium
- Consider the access experience from the SCG and SFS
- Ensure adequate capacity for event based activation, spill out and temporary activation installations
- Integrate hostile vehicle barriers along Moore Park Road, integrated with other public domain elements to minimise clutter

Key

- Site Boundary
- Key Public Spaces
- External Concourse
- Open Space
- Kippax Lake

Guidelines

Public Realm and Open Space

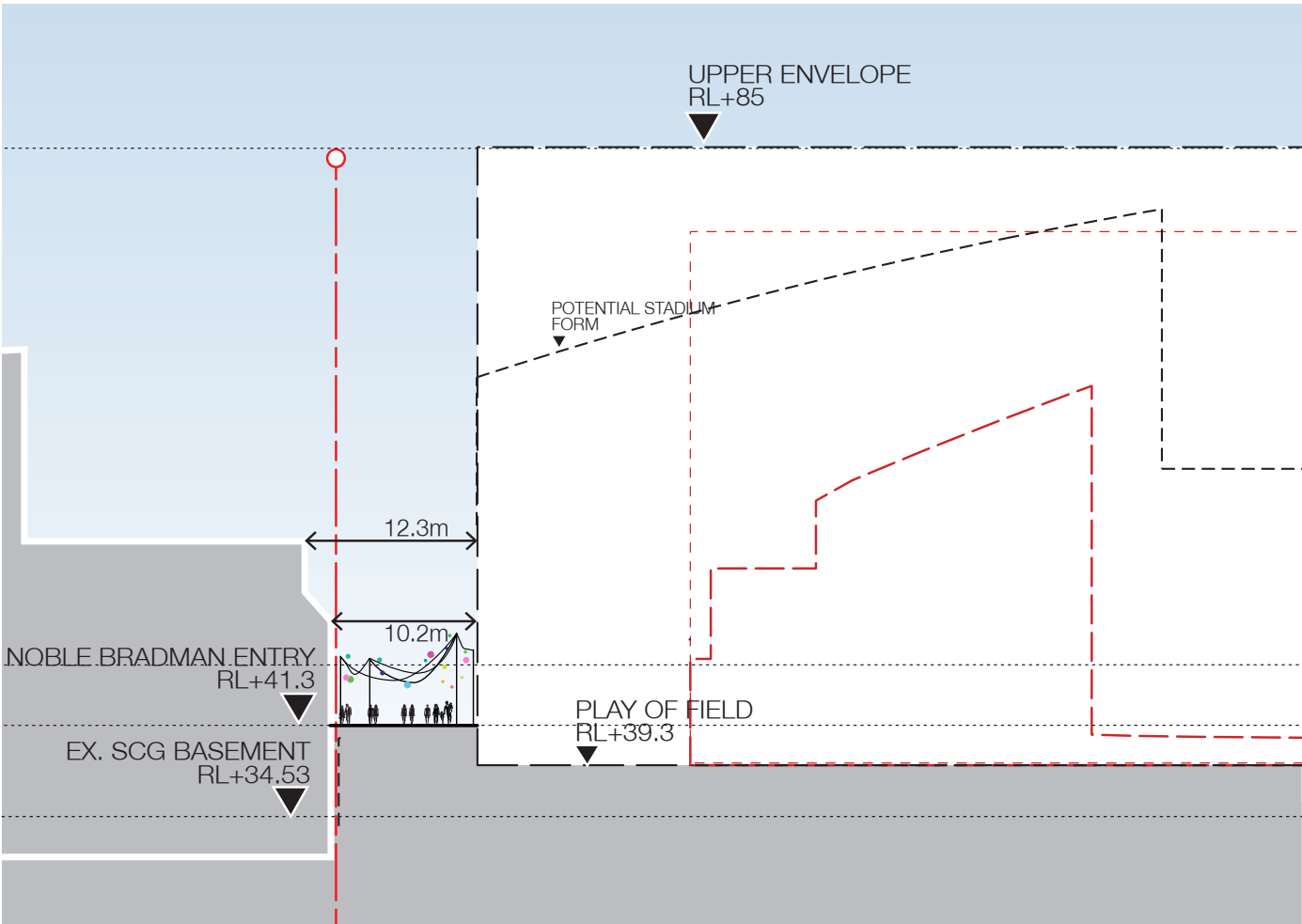

Bradman Noble Terrace Section

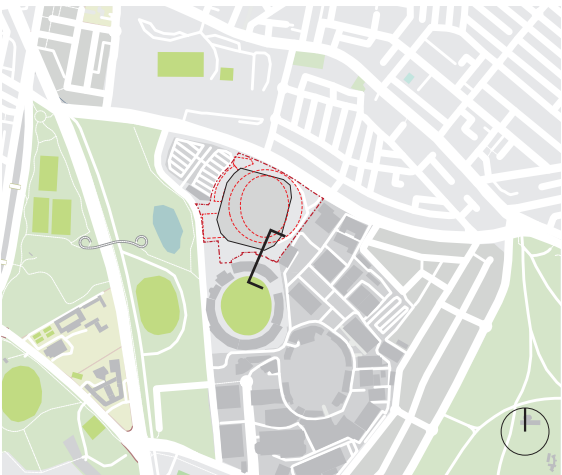

Section Plan



Bradman Noble Terrace Sketch

Guidelines

Public Realm and Open Space

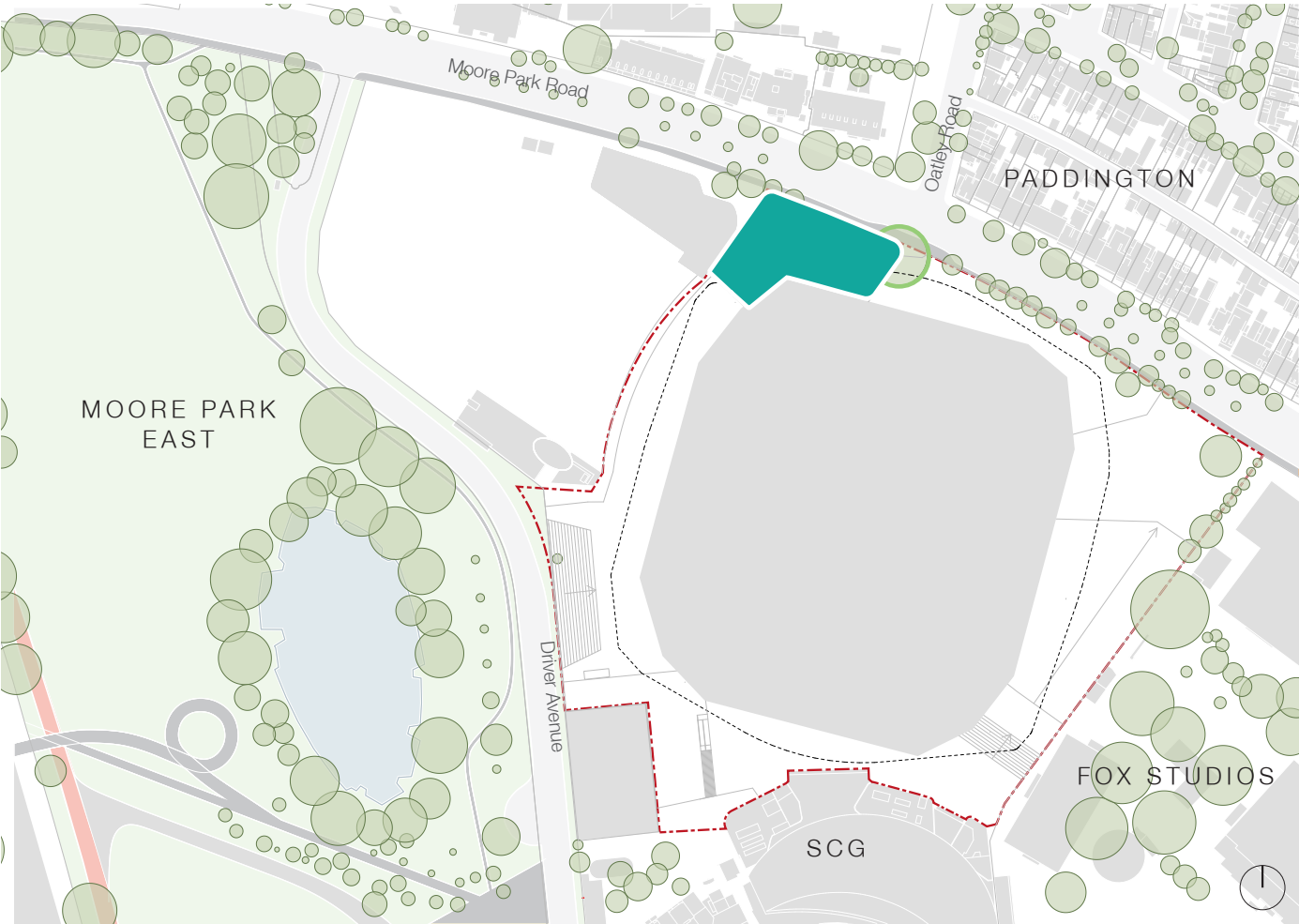

Oatley Road Entry



Precedent - West End Longfellow Place, Boston, USA

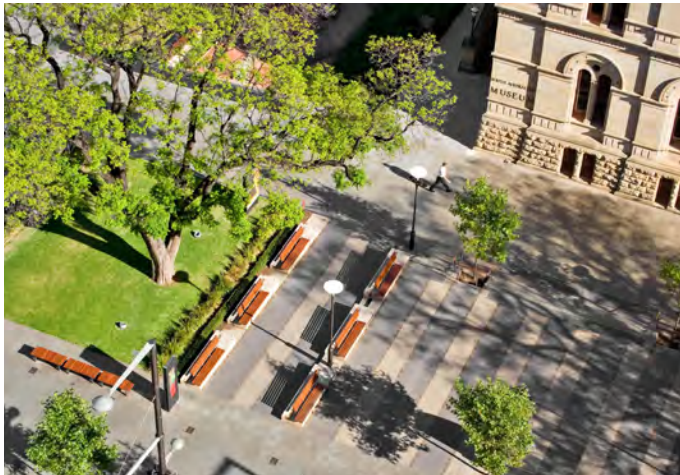

Precedent - North Terrace, Adelaide

Oatley Road Entry

The Oatley Road Entry will be characterised by a public plaza extending directly from the Moore Park Road pedestrian seamlessly stitching the SFS into its context. This entry will provide a continuation of the pedestrian route along Oatley Road from Paddington through to the SFS.

Oatley Road Place is defined and framed by the significant fig tree (No. 125) and the existing Rugby Australia Building. The amenity created by this large tree, its high visibility and location adjacent to the new walking and cycle upgrades along Moore Park Road, leaves it well positioned to hold both day-to-day and event day activation.

Tree planting, low level planting and pedestrian amenity such as bench seats should be allowed for in this area to create a comfortable and inviting public space for people. The Oatley Road Entry must also allow for existing vehicle access into the Rugby Australia Building basement and emergency vehicle access to the SFS external concourse.

Principles
Create a comfortable and inviting space that stitches the SFS into its surrounds and utilises the amenity of existing planting to facilitate activation.

- Guidelines*
- Retain and enhance the setting of Tree 125, integrate amenity such as seating around the tree in a way that will not compromise the health of the tree
 - Utilise movable furniture to allow outward facing activation embedded in the ground floor of the SFS to utilise spaces shaded by Tree 125
 - Reduce conflict between pedestrians and vehicles accessing the Rugby Australia Building basement through landscaped elements, grade separation, material changes and planting
 - Provide a clear zone to allow emergency vehicles to access the external concourse where required

Key

- Site Boundary
- Key Public Spaces
- External Concourse
- Open Space
- Kippax Lake
- Tree 125