

CAMPBELLTOWN HOSPITAL REDEVELOPMENT

SHEET NO.	SHEET NAME	REV	SCALE
SSD-01-000	COVER SHEET/ DRAWING REGISTER	L	NTS
SSD-01-001	PLAN - SITE SURVEY PLAN - EXISTING	D	1:2500
SSD-01-002	PLAN - SITE PLAN - DEMOLITION	E	1:2500
SSD-01-003	PLAN - SITE PLAN PROPOSED WORKS	K	1:2500
SSD-02-001	PLAN - SITE CONTEXT	D	1:5000
SSD-02-002	PLAN - SITE ACCESS EXISTING	E	1:2500
SSD-02-003	PLAN - SITE ACCESS PROPOSED	F	1:2500
SSD-02-004	PLAN - SITE ANALYSIS - EXISTING	C	1:2500
SSD-03-000	PLAN - PROPOSED - L00	G	1:1000
SSD-03-001	PLAN - PROPOSED - L01	G	1:1000
SSD-03-002	PLAN - PROPOSED - L02	H	1:1000
SSD-03-003	PLAN - PROPOSED - L03	G	1:1000
SSD-03-004	PLAN - PROPOSED - L04	G	1:1000
SSD-03-005	PLAN - PROPOSED - L05	G	1:1000
SSD-03-006	PLAN - PROPOSED - L06	G	1:1000
SSD-03-007	PLAN - PROPOSED - L07	G	1:1000
SSD-03-008	PLAN - PROPOSED - L08	G	1:1000
SSD-03-009	PLAN - PROPOSED - L09	G	1:1000
SSD-03-010	PLAN - PROPOSED - L10	G	1:1000
SSD-03-011	PLAN - PROPOSED - L11	H	1:1000
SSD-03-012	PLAN - PROPOSED - L12 (ROOF)	H	1:1000
SSD-03-020	PLAN - PROPOSED - L03 - ROADWORKS - SHEET 1	F	1:1000
SSD-03-021	PLAN - PROPOSED - L03 - ROADWORKS - SHEET 2	D	1:1000
SSD-04-001	SECTIONS - SHEET 1	G	1:1000
SSD-04-002	SECTIONS - SHEET 2	G	1:1000
SSD-04-003	SECTIONS - SHEET 3	F	1:1000
SSD-04-006	ELEVATIONS - NORTH & WEST	G	1:1000
SSD-04-007	ELEVATIONS - SOUTH & EAST	G	1:1000
SSD-04-009	3D VIEWS 01 + 02	G	NTS
SSD-04-010	3D VIEWS 03 + 04	E	NTS
SSD-04-013	MATERIAL SCHEDULE	B	NTS
SSD-04-014	PLAN - SITE CONTEXT - SHADOW DIAGRAMS	B	NTS
SSD-05-000	GROSS FLOOR AREAS - SHEET 01	C	NTS
SSD-05-001	GROSS FLOOR AREAS - SHEET 02	C	NTS



L	ISSUE FOR SSD	06/08/2018	DR
K	ISSUED FOR SSD	30/07/2018	DR
J	ISSUE FOR SSD	17/07/2018	DR
H	ISSUE FOR SSD	25/06/2018	RB
G	ISSUE FOR SSD	22/06/2018	RB
Revision	Description	Date	Initial





NB: DRAWING BASED ON SURVEY CONDUCTED NOVEMBER 2017

Revision	Description	Date	Initial
D	ISSUE FOR SSD	06/08/2018	DR
C	ISSUE FOR SSD	17/07/2018	DR
B	ISSUE FOR SSD	29/05/2018	RB
A	DRAFT ISSUE FOR SSD	25/05/2018	RB



Health
Infrastructure

P: 02 9978 5402
F: 02 8904 1377
W: www.hinfra.health.nsw.gov.au



Billard Leece Partnership Pty Ltd
Architects & Urban Planners
Studio 201, 50 Holt St
Surry Hills 2010
NSW Australia
T +61 2 8096 4066
F +61 3 9656 5050
E info@blp.com.au
www.blp.com.au

Client
Health Infrastructure NSW

Project Name
CAMPBELLTOWN HOSPITAL
REDEVELOPMENT STAGE 2

Drawing Name
PLAN - SITE SURVEY PLAN -
EXISTING

Scale	Project No	Date Created
1:2500 @ A3	17075	09/05/18
Drawing No	Revision	
SSD-01-001	D	

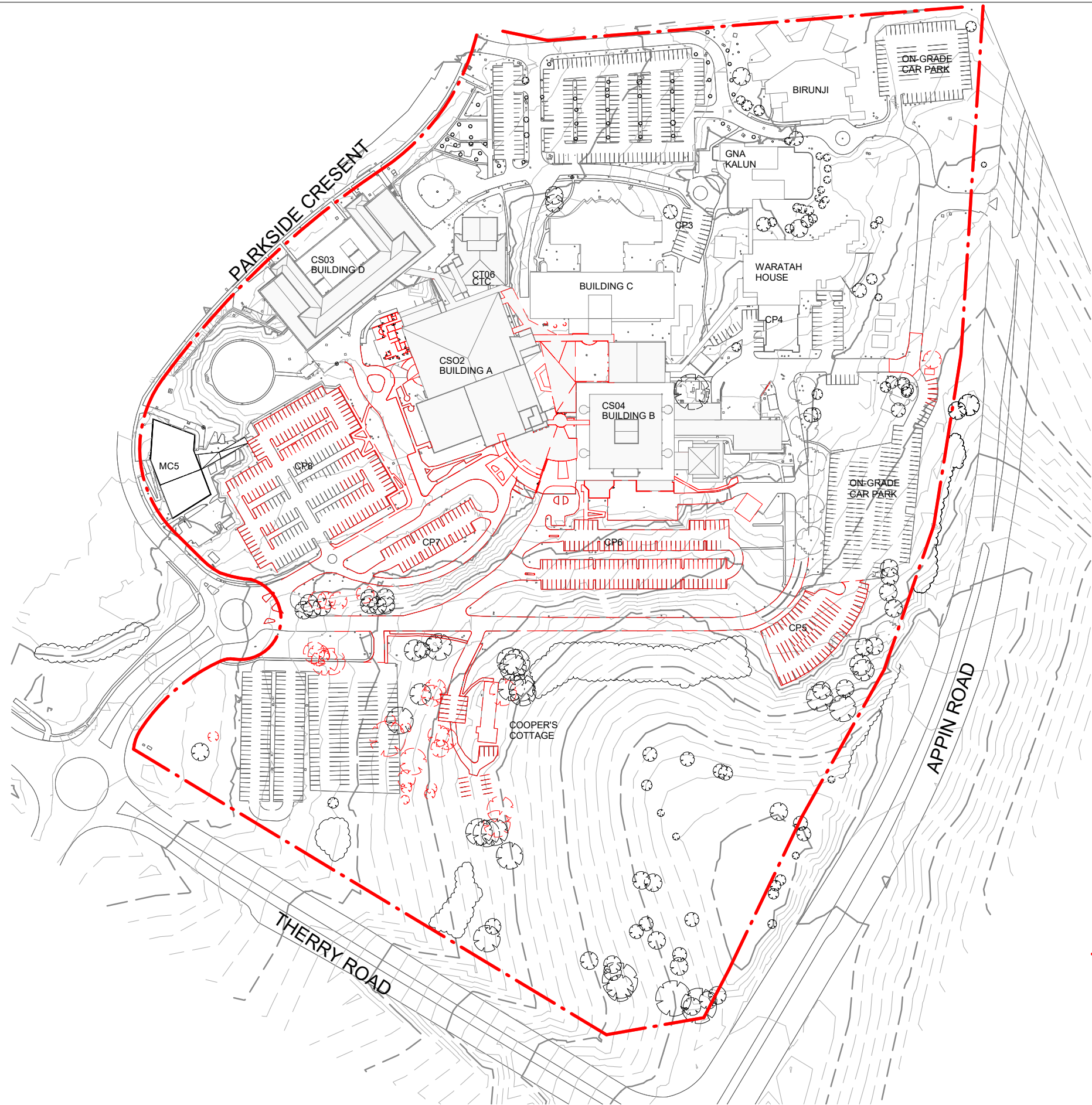

- LEGEND**
- BUILDINGS/ROADS TO BE DEMOLISHED
 - PARKING TO BE DEMOLISHED
 - SITE BOUNDARY
 - TREES TO BE REMOVED/TRANSPLANTED

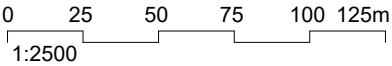

E	ISSUE FOR SSD	06/08/2018	DR
D	ISSUE FOR SSD	17/07/2018	DR
C	ISSUE FOR SSD	22/06/2018	RB
B	ISSUE FOR SSD	19/06/2018	RB
A	DRAFT ISSUE FOR SSD	25/05/2018	RB
Revision	Description	Date	Initial

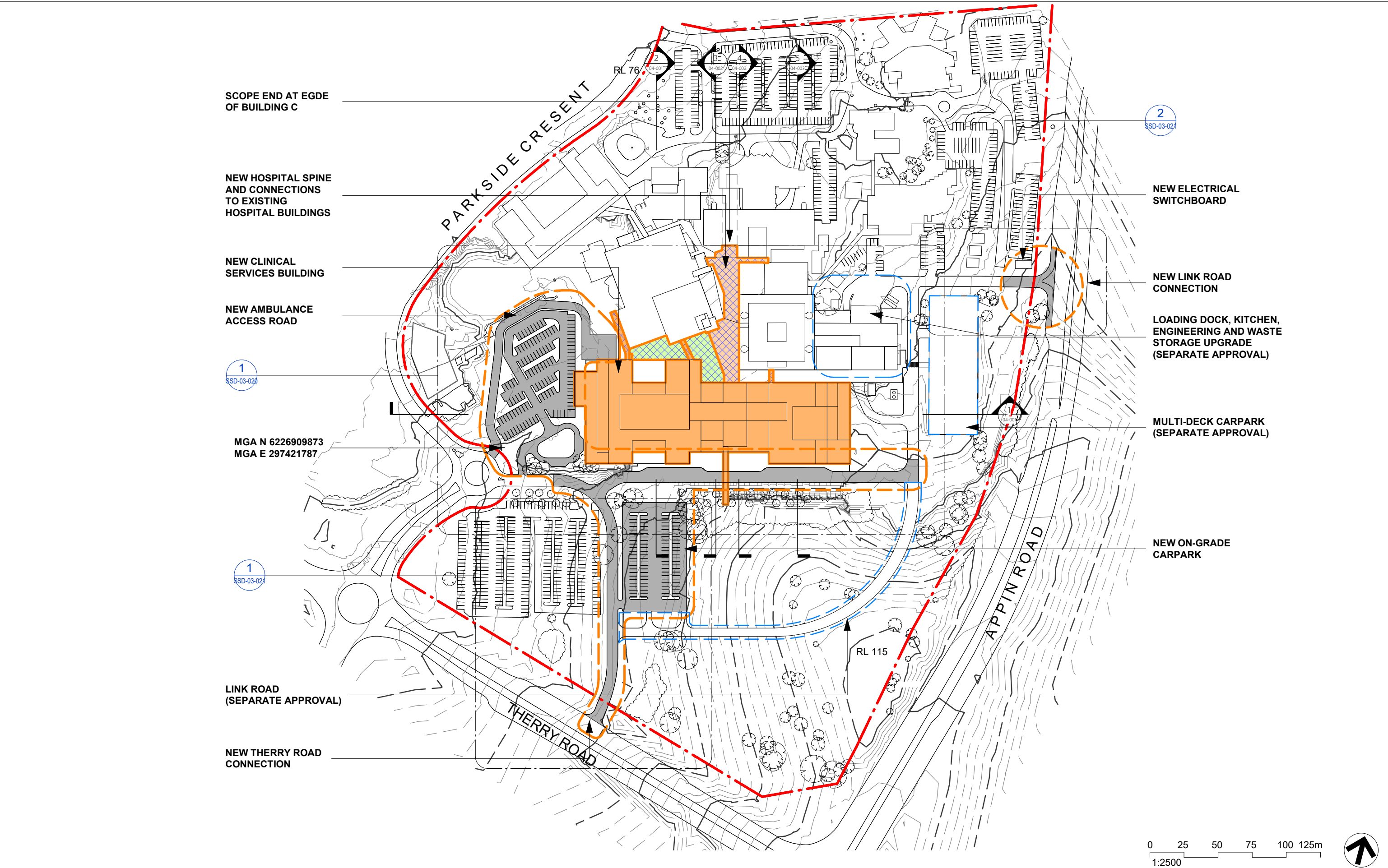

K	ISSUE FOR SSD	06/08/2018	DR
J	ISSUE FOR SSD	17/07/2018	DR
H	ISSUE FOR SSD	25/06/2018	RB
G	ISSUE FOR SSD	22/06/2018	RB
F	ISSUE FOR SSD	19/06/2018	DR
Revision	Description	Date	Initial

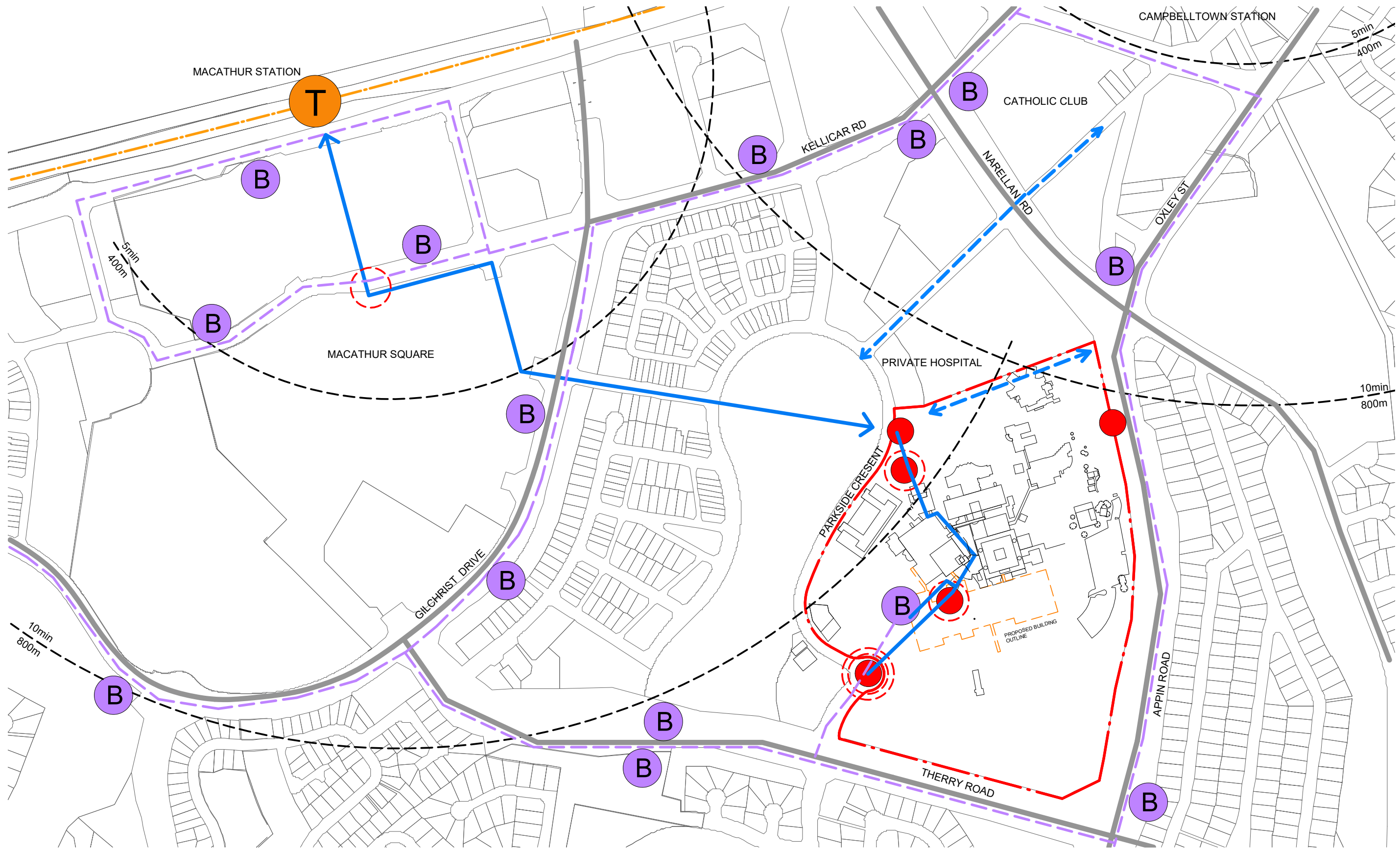

- TRAIN STATION
- BUS STOP
- TRAIN LINE
- BUS LINE
- PROPOSED PEDESTRIAN NETWORK
- MAJOR ROAD
- SITE BOUNDARY
- EXISTING PEDESTRIAN NETWORK
- SITE ENTRY POINT
- HOSPITAL GATEWAY
- MAIN HOSPITAL ENTRY POINT

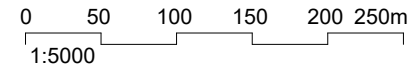

Revision	Description	Date	Initial
D	ISSUE FOR SSD	06/08/2018	DR
C	ISSUE FOR SSD	17/07/2018	DR
B	ISSUE FOR SSD	25/06/2018	RB
A	ISSUE FOR SSD	29/05/2018	RB

P: 02 9978 5402
F: 02 8904 1377
W: www.hinfra.health.nsw.gov.au

Billard Leece Partnership Pty Ltd
Architects & Urban Planners
Studio 201, 50 Holt St
Surry Hills 2010
NSW Australia
T +61 2 8096 4066
F +61 3 9656 5050
E info@blp.com.au
www.blp.com.au

Client
Health Infrastructure NSW

Project Name
CAMPBELLTOWN HOSPITAL
REDEVELOPMENT STAGE 2

Drawing Name PLAN - SITE CONTEXT		
Scale 1 : 5000 @ A3	Project No 17075	Date Created 09/05/18
Drawing No SSD-02-001	Revision D	

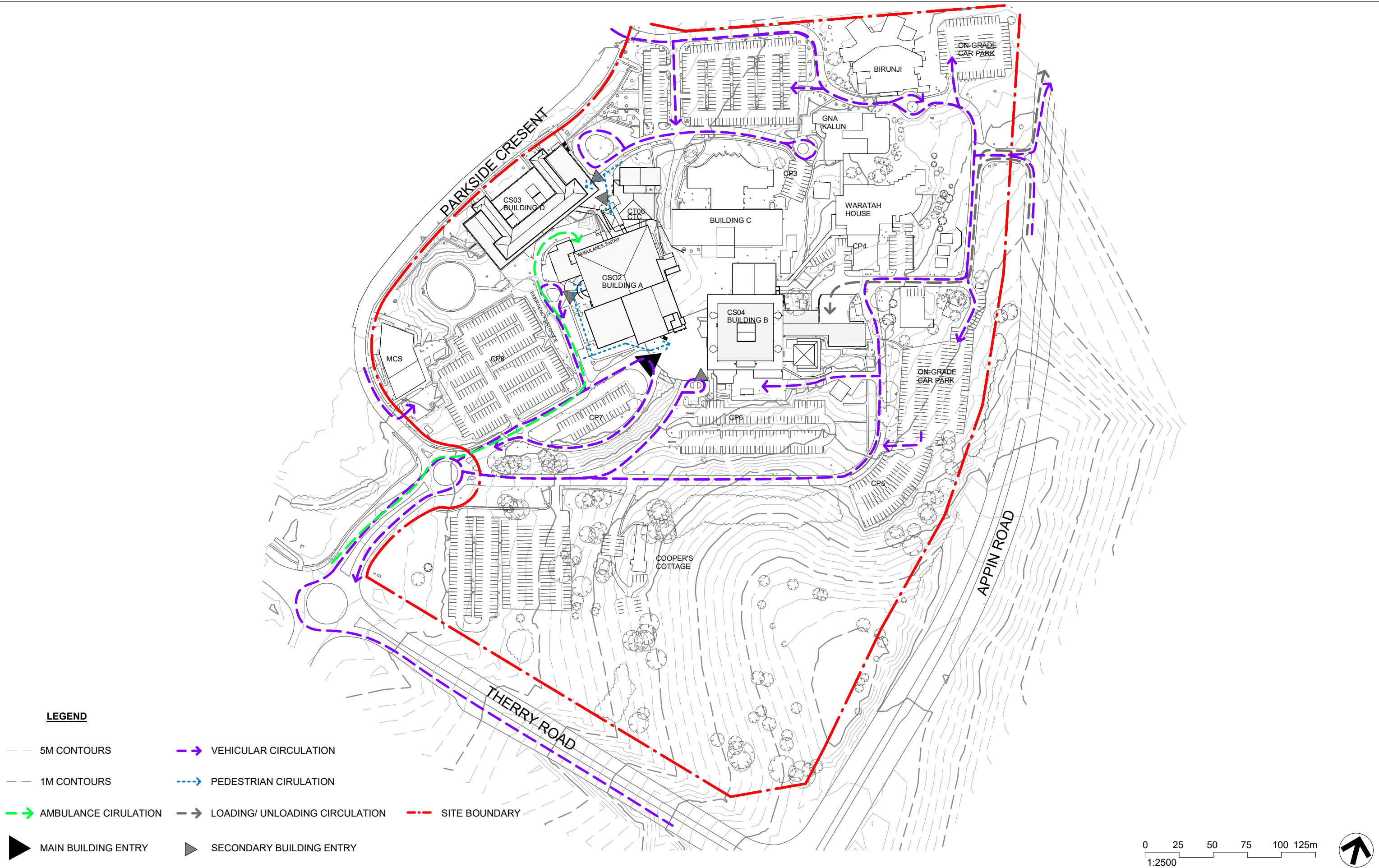

LEGEND

- 5M CONTOURS
- 1M CONTOURS
- AMBULANCE CIRULATION
- VEHICULAR CIRCULATION
- PEDESTRIAN CIRULATION
- LOADING/ UNLOADING CIRCULATION
- SITE BOUNDARY
- MAIN BUILDING ENTRY
- SECONDARY BUILDING ENTRY

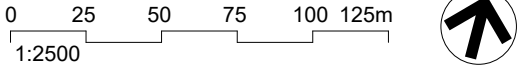

E	ISSUE FOR SSD	06/08/2018	DR
D	ISSUE FOR SSD	17/07/2018	DR
C	ISSUE FOR SSD	22/06/2018	RB
B	ISSUE FOR SSD	29/05/2018	RB
A	DRAFT ISSUE FOR COORDINATION	18/05/2018	RB
Revision	Description	Date	Initial



Health
Infrastructure

P: 02 9978 5402
F: 02 8904 1377
W: www.hinfra.health.nsw.gov.au



Billard Leece Partnership Pty Ltd
Architects & Urban Planners
Studio 201, 50 Holt St
Surry Hills 2010
NSW Australia
T +61 2 8096 4066
F +61 3 9656 5050
E info@blp.com.au
www.blp.com.au

Client
Health Infrastructure NSW

Project Name
CAMPBELLTOWN HOSPITAL
REDEVELOPMENT STAGE 2

Drawing Name
PLAN - SITE ACCESS
EXISTING

Scale
1:2500 @ A3

Project No
17075

Date Created
09/05/18

Drawing No
SSD-02-002

Revision
E



F	ISSUE FOR SSD	06/08/2018	DR
E	ISSUE FOR SSD	17/07/2018	DR
D	ISSUE FOR SSD	22/06/2018	RB
C	ISSUE FOR SSD	19/06/2018	DR
B	ISSUE FOR SSD	04/06/2018	RB
Revision	Description	Date	Initial

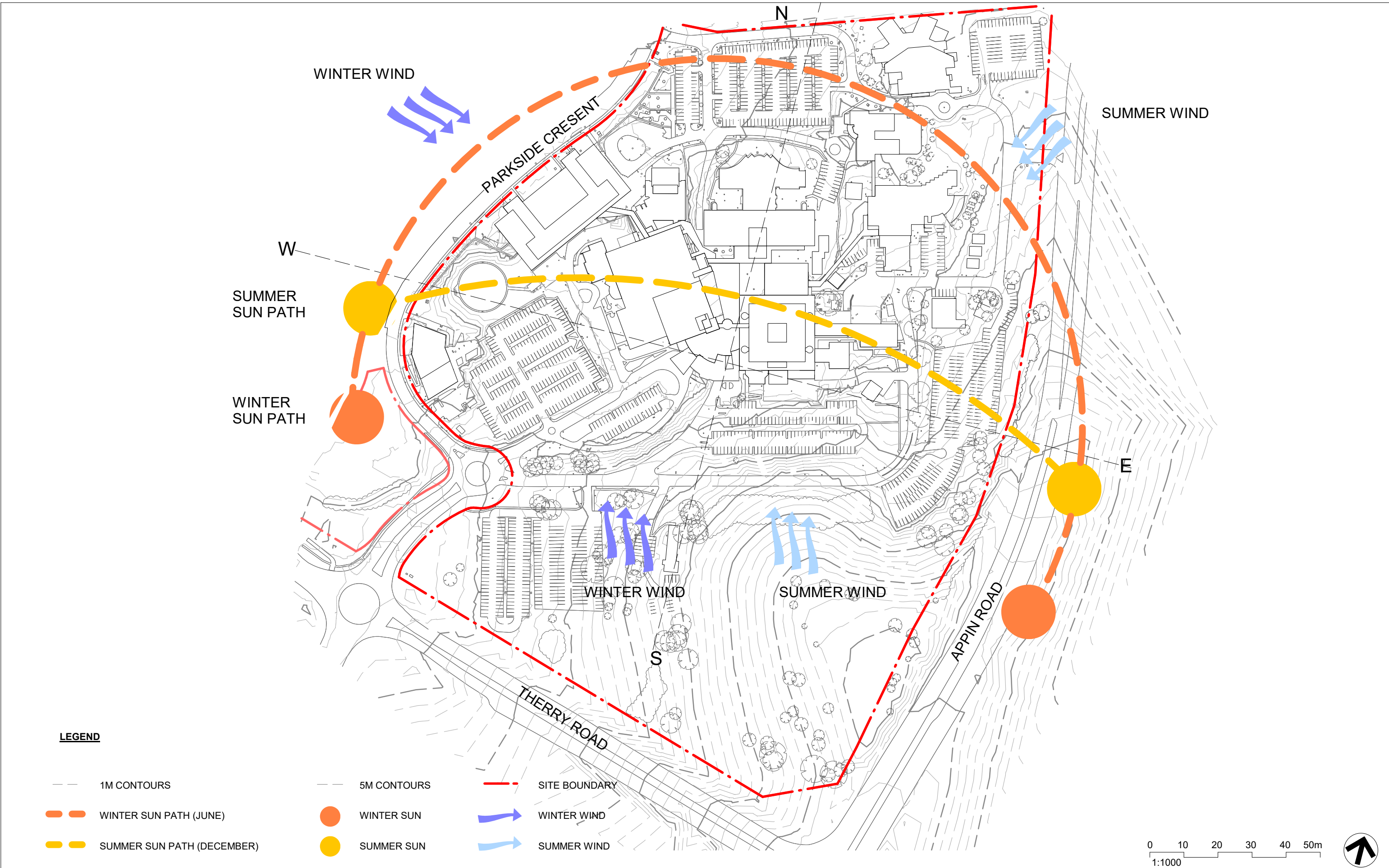

C	ISSUE FOR SSD	06/08/2018	DR
B	ISSUE FOR SSD	17/07/2018	DR
A	ISSUE FOR SSD	29/05/2018	RB
Revision	Description	Date	Initial

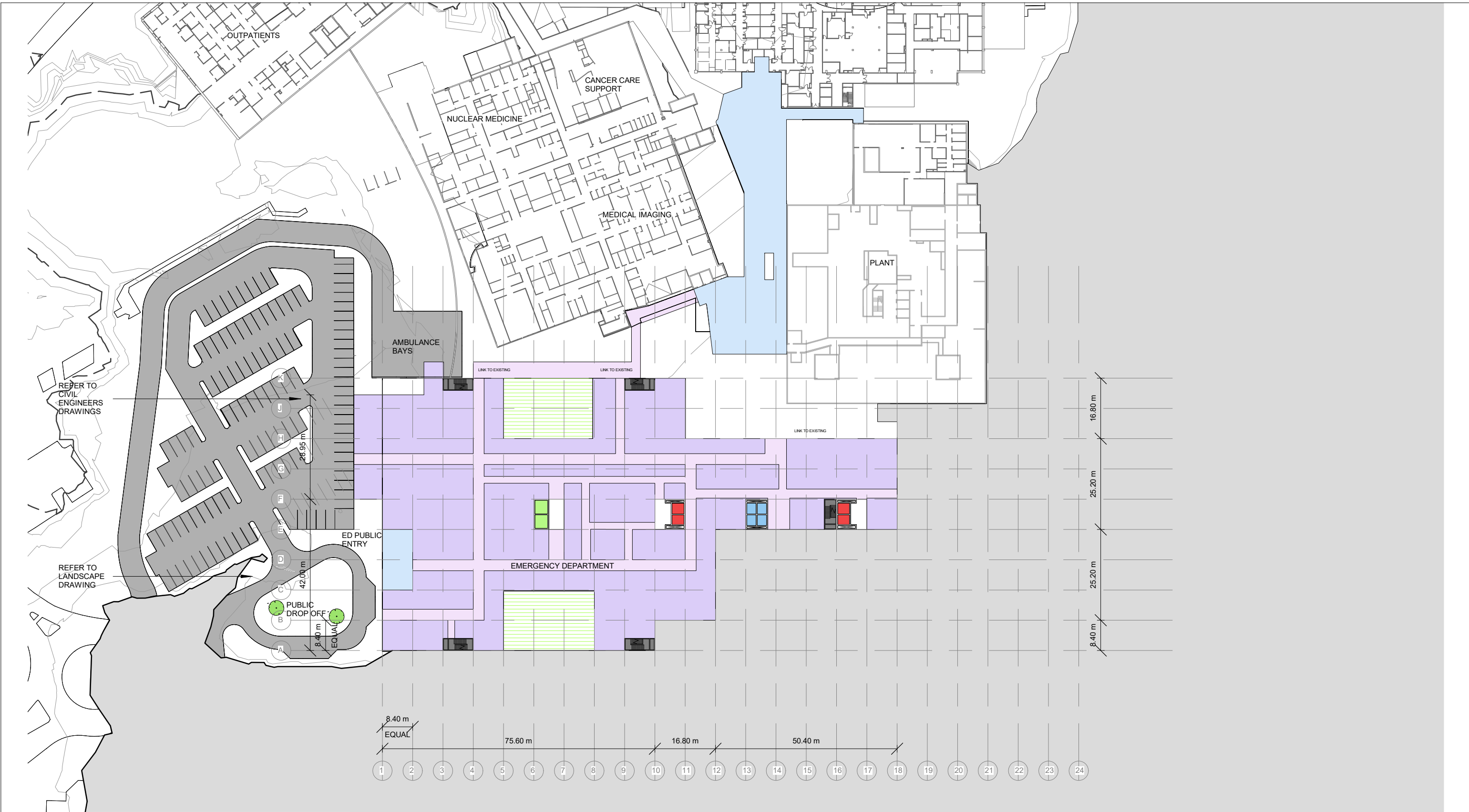

- DEPARTMENTAL AREA
- LIFT - PUBLIC
- LIFT - PATIENT/STAFF/SERVICES
- LIFT - TRAUMA
- CIRCULATION - PUBLIC
- CIRCULATION - STAFF/INTER-DEPARTMENTAL
- STAIRS - FIRE EGRESS
- PLANT
- OUT OF SCOPE
- COURTYARD
- ADMIN

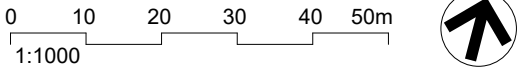

G	ISSUE FOR SSD	06/08/2018	DR
F	ISSUE FOR SSD	25/06/2018	RB
E	ISSUE FOR SSD	19/06/2018	DR
D	ISSUE FOR SSD	04/06/2018	RB
C	ISSUE FOR SSD	29/05/2018	RB
Revision	Description	Date	Initial



Health
Infrastructure

P: 02 9978 5402
F: 02 8904 1377
W: www.hinfra.health.nsw.gov.au



Billard Leece Partnership Pty Ltd
Architects & Urban Planners
Studio 201, 50 Holt St
Surry Hills 2010
NSW Australia
T +61 2 8096 4066
F +61 3 9656 5050
E info@blp.com.au
www.blp.com.au

Client
Health Infrastructure NSW

Project Name
CAMPBELLTOWN HOSPITAL
REDEVELOPMENT STAGE 2

Drawing Name PLAN - PROPOSED - L00		
Scale 1:1000 @ A3	Project No 17075	Date Created 09/05/18
Drawing No SSD-03-000	Revision G	



- DEPARTMENTAL AREA
- LIFT - PUBLIC
- LIFT - PATIENT/STAFF/SERVICES
- LIFT - TRAUMA
- CIRCULATION - PUBLIC
- CIRCULATION - STAFF/INTER-DEPARTMENTAL
- STAIRS - FIRE EGRESS
- PLANT
- OUT OF SCOPE
- COURTYARD
- ADMIN

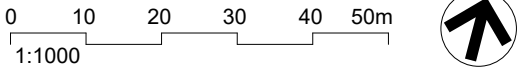

G	ISSUE FOR SSD	06/08/2018	DR
F	ISSUE FOR SSD	25/06/2018	RB
E	ISSUE FOR SSD	19/06/2018	DR
D	ISSUE FOR SSD	04/06/2018	RB
C	ISSUE FOR SSD	29/05/2018	RB
Revision	Description	Date	Initial



P: 02 9978 5402
F: 02 8904 1377
W: www.hinfra.health.nsw.gov.au



Billard Leece Partnership Pty Ltd
Architects & Urban Planners
Studio 201, 50 Holt St
Surry Hills 2010
NSW Australia
T +61 2 8096 4066
F +61 3 9656 5050
E info@blp.com.au
www.blp.com.au

Client
Health Infrastructure NSW

Project Name
CAMPBELLTOWN HOSPITAL
REDEVELOPMENT STAGE 2

Drawing Name PLAN - PROPOSED - L01		
Scale 1:1000 @ A3	Project No 17075	Date Created 09/05/18
Drawing No SSD-03-001	Revision G	



DEPARTMENTAL AREA
LIFT - PUBLIC
LIFT - PATIENT/STAFF/SERVICES
LIFT - TRAUMA

CIRCULATION - PUBLIC
CIRCULATION - STAFF/INTER-DEPARTMENTAL
STAIRS - FIRE EGRESS
PLANT

OUT OF SCOPE
COURTYARD
ADMIN

0 10 20 30 40 50m
1:1000



H	ISSUE FOR SSD	06/08/2018	DR
G	ISSUE FOR SSD	17/07/2018	DR
F	ISSUE FOR SSD	25/06/2018	RB
E	ISSUE FOR SSD	19/06/2018	DR
D	ISSUE FOR SSD	04/06/2018	RB
Revision	Description	Date	Initial

P: 02 9978 5402
F: 02 8904 1377
W: www.hinfra.health.nsw.gov.au



Billard Leece Partnership Pty Ltd
Architects & Urban Planners
Studio 201, 50 Holt St
Surry Hills 2010
NSW Australia
T +61 2 8096 4066
F +61 3 9656 5050
E info@blp.com.au
www.blp.com.au

Client
Health Infrastructure NSW

Project Name
CAMPBELLTOWN HOSPITAL
REDEVELOPMENT STAGE 2

Drawing Name
PLAN - PROPOSED - L02

Scale 1:1000 @ A3	Project No 17075	Date Created 09/05/18
Drawing No SSD-03-002	Revision H	

6/08/2018 2:16:05 PM

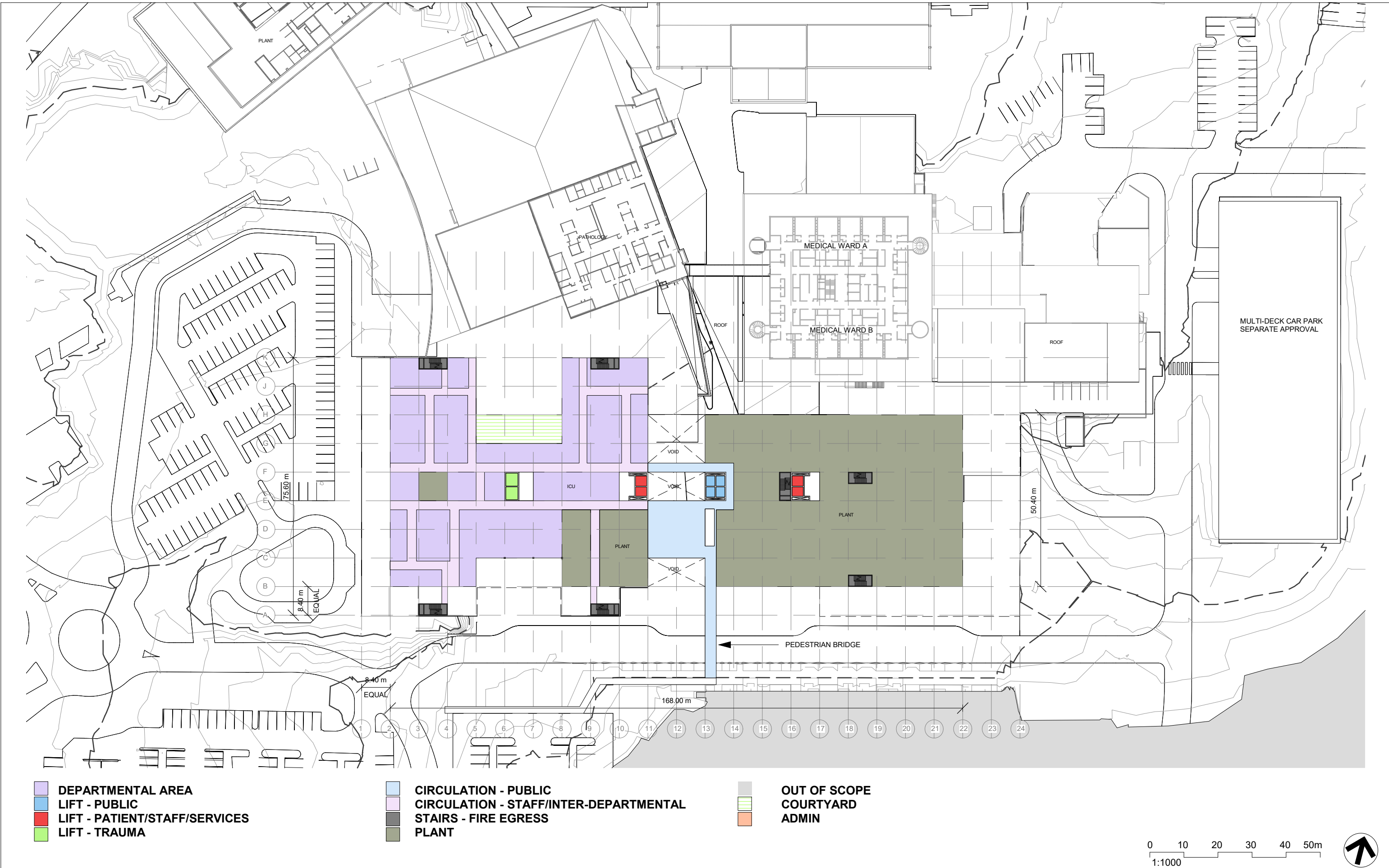

G	ISSUE FOR SSD	06/08/2018	DR
F	ISSUE FOR SSD	25/06/2018	RB
E	ISSUE FOR SSD	19/06/2018	DR
D	ISSUE FOR SSD	04/06/2018	RB
C	ISSUE FOR SSD	29/05/2018	RB
Revision	Description	Date	Initial



G	ISSUE FOR SSD	06/08/2018	DR
F	ISSUE FOR SSD	25/06/2018	RB
E	ISSUE FOR SSD	19/06/2018	DR
D	ISSUE FOR SSD	04/06/2018	RB
C	ISSUE FOR SSD	29/05/2018	RB
Revision	Description	Date	Initial

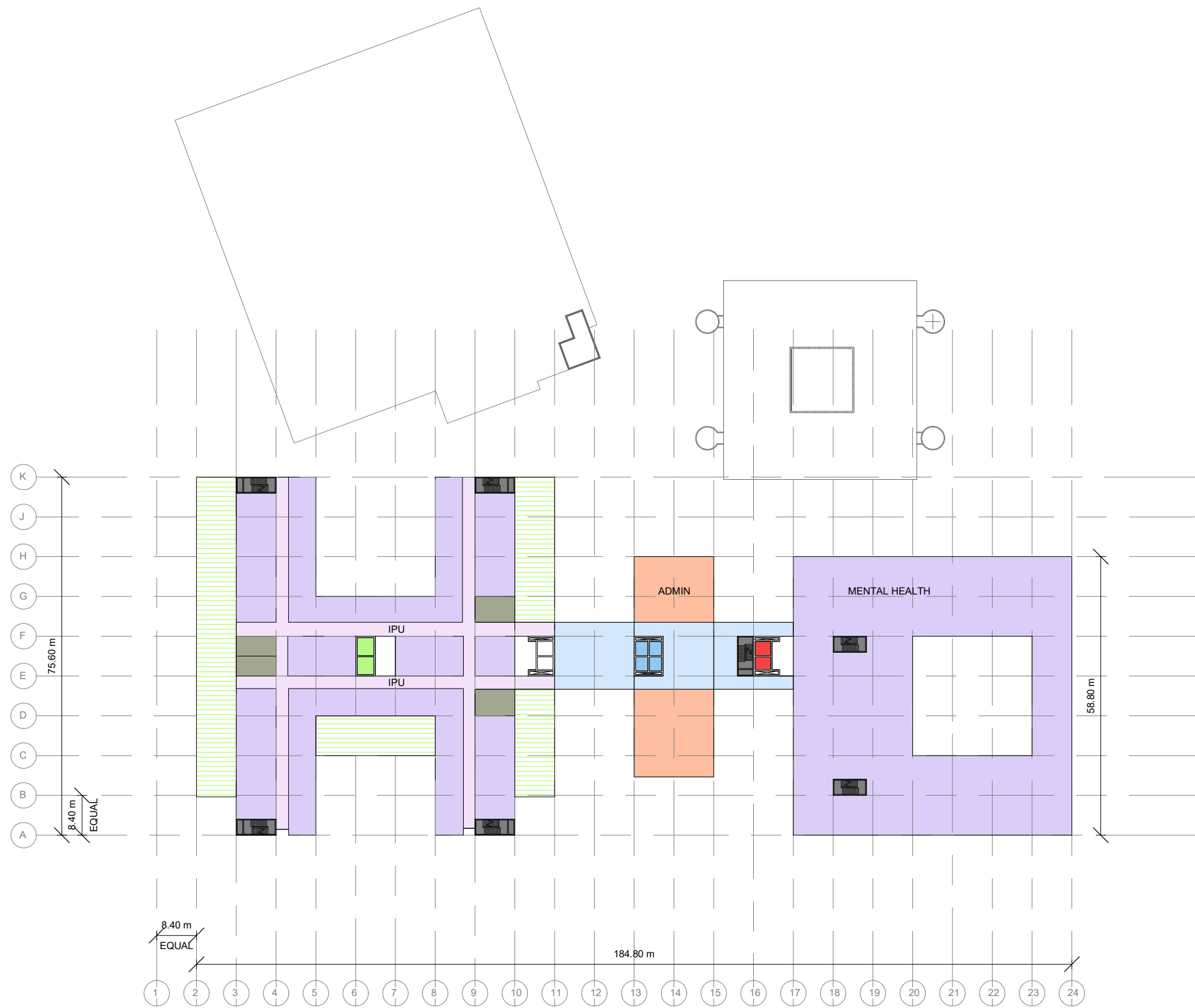

DEPARTMENTAL AREA
LIFT - PUBLIC
LIFT - PATIENT/STAFF/SERVICES
LIFT - TRAUMA

CIRCULATION - PUBLIC
CIRCULATION - STAFF/INTER-DEPARTMENTAL
STAIRS - FIRE EGRESS
PLANT

OUT OF SCOPE
COURTYARD
ADMIN

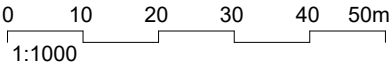

G	ISSUE FOR SSD	06/08/2018	DR
F	ISSUE FOR SSD	25/06/2018	RB
E	ISSUE FOR SSD	19/06/2018	DR
D	ISSUE FOR SSD	04/06/2018	RB
C	ISSUE FOR SSD	29/05/2018	RB
Revision	Description	Date	Initial

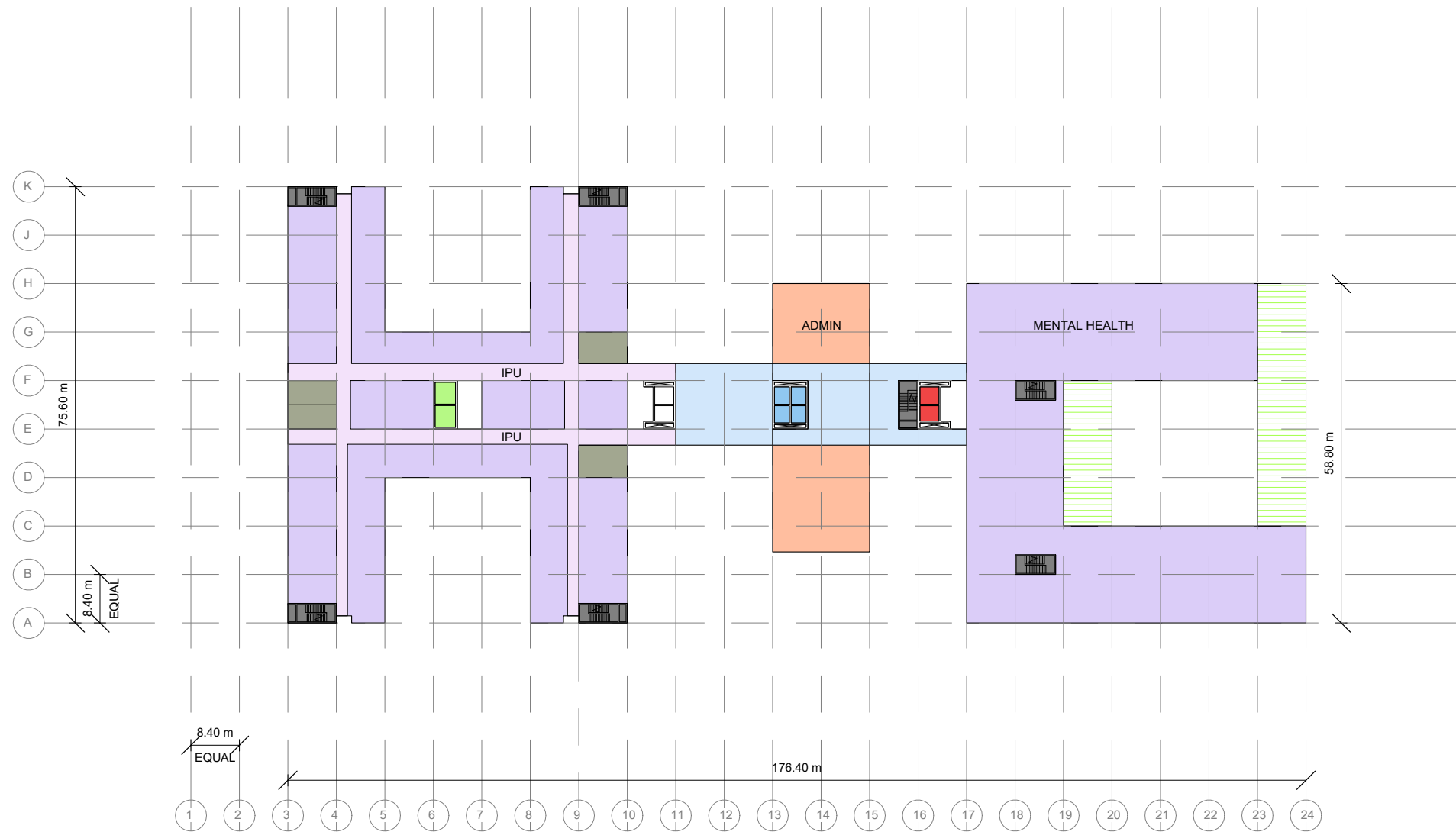

DEPARTMENTAL AREA
LIFT - PUBLIC
LIFT - PATIENT/STAFF/SERVICES
LIFT - TRAUMA

CIRCULATION - PUBLIC
CIRCULATION - STAFF/INTER-DEPARTMENTAL
STAIRS - FIRE EGRESS
PLANT

OUT OF SCOPE
COURTYARD
ADMIN

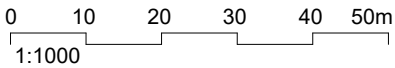

G	ISSUE FOR SSD	06/08/2018	DR
F	ISSUE FOR SSD	25/06/2018	RB
E	ISSUE FOR SSD	19/06/2018	DR
D	ISSUE FOR SSD	04/06/2018	RB
C	ISSUE FOR SSD	29/05/2018	RB
Revision	Description	Date	Initial

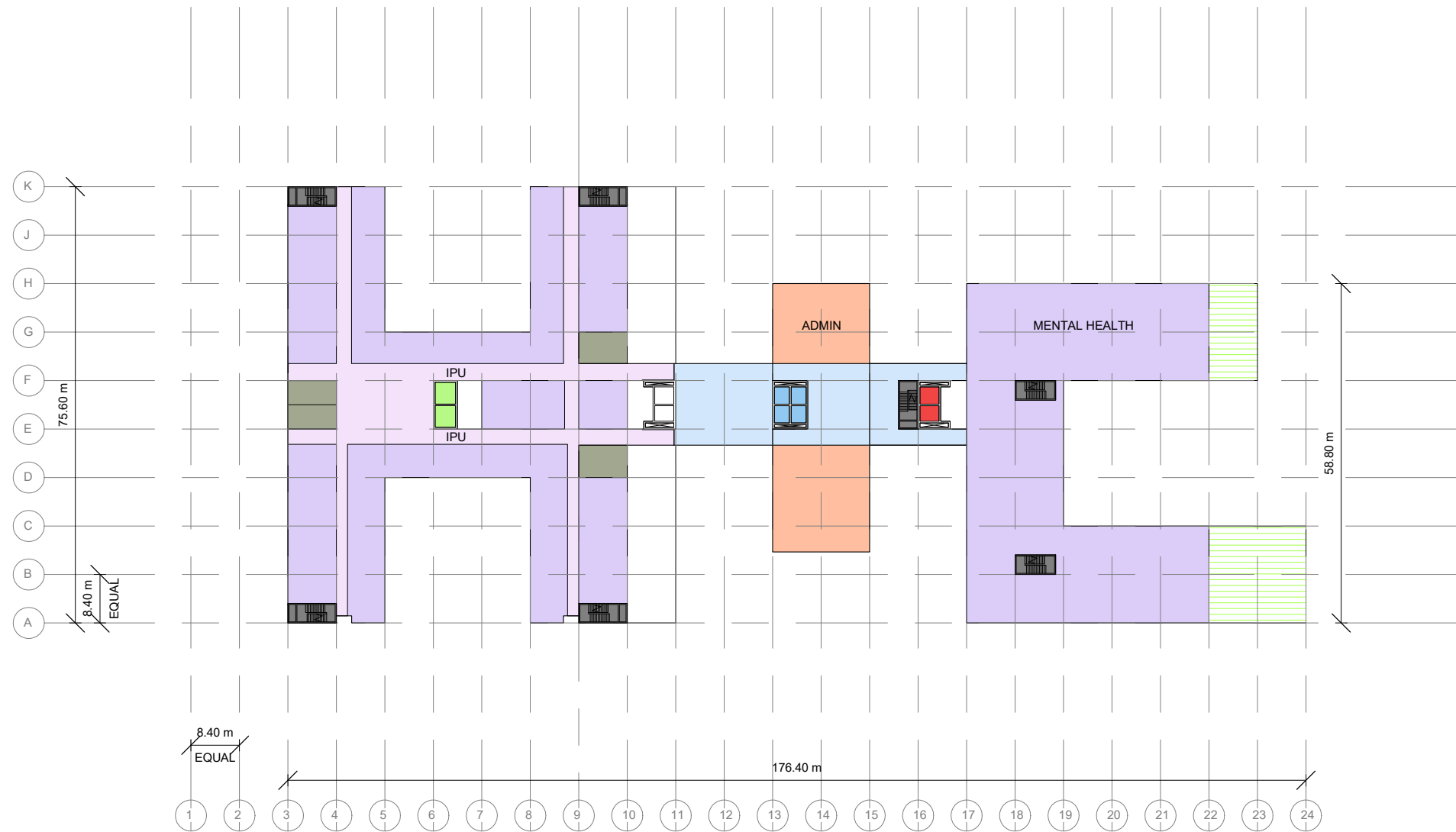

DEPARTMENTAL AREA
LIFT - PUBLIC
LIFT - PATIENT/STAFF/SERVICES
LIFT - TRAUMA

CIRCULATION - PUBLIC
CIRCULATION - STAFF/INTER-DEPARTMENTAL
STAIRS - FIRE EGRESS
PLANT

OUT OF SCOPE
COURTYARD
ADMIN

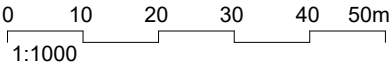

G	ISSUE FOR SSD	06/08/2018	DR
F	ISSUE FOR SSD	25/06/2018	RB
E	ISSUE FOR SSD	19/06/2018	DR
D	ISSUE FOR SSD	04/06/2018	RB
C	ISSUE FOR SSD	29/05/2018	RB
Revision	Description	Date	Initial

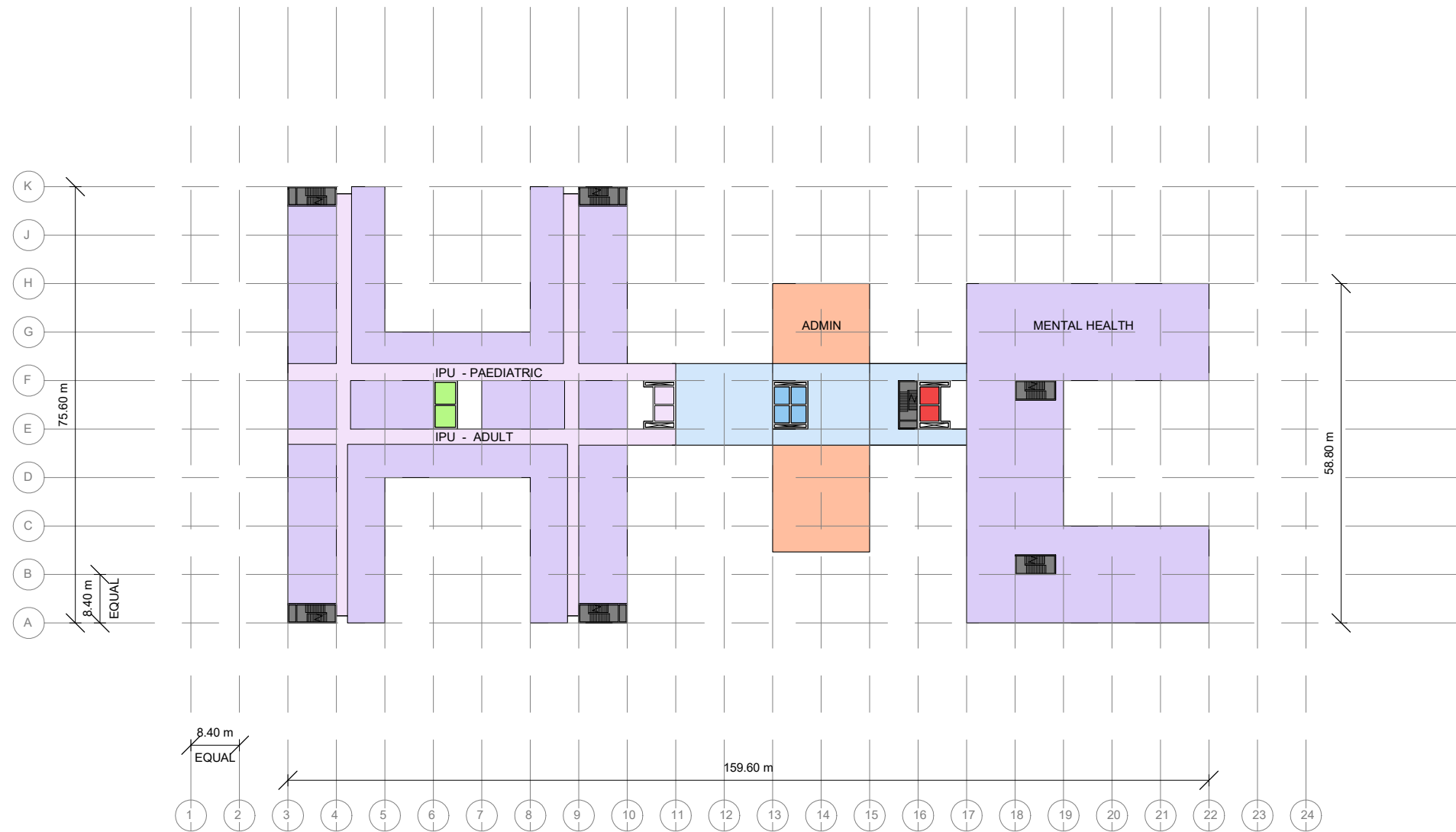

DEPARTMENTAL AREA
LIFT - PUBLIC
LIFT - PATIENT/STAFF/SERVICES
LIFT - TRAUMA

CIRCULATION - PUBLIC
CIRCULATION - STAFF/INTER-DEPARTMENTAL
STAIRS - FIRE EGRESS
PLANT

OUT OF SCOPE
COURTYARD
ADMIN

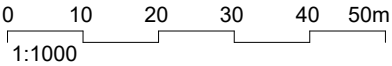

G	ISSUE FOR SSD	06/08/2018	DR
F	ISSUE FOR SSD	25/06/2018	RB
E	ISSUE FOR SSD	19/06/2018	DR
D	ISSUE FOR SSD	04/06/2018	RB
C	ISSUE FOR SSD	29/05/2018	RB
Revision	Description	Date	Initial

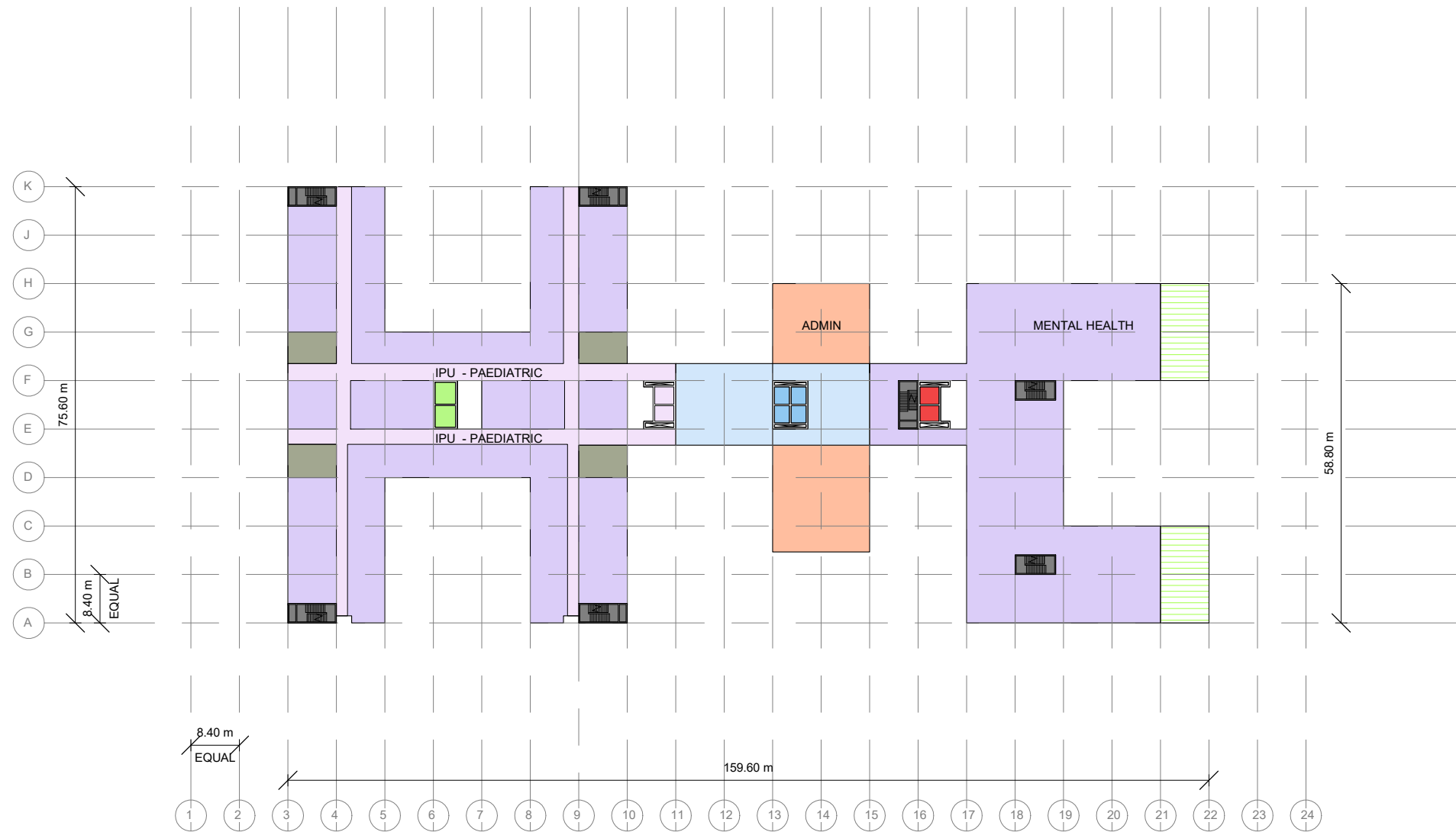

DEPARTMENTAL AREA
LIFT - PUBLIC
LIFT - PATIENT/STAFF/SERVICES
LIFT - TRAUMA

CIRCULATION - PUBLIC
CIRCULATION - STAFF/INTER-DEPARTMENTAL
STAIRS - FIRE EGRESS
PLANT

OUT OF SCOPE
COURTYARD
ADMIN

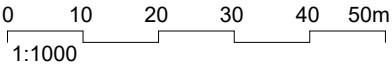

G	ISSUE FOR SSD	06/08/2018	DR
F	ISSUE FOR SSD	25/06/2018	RB
E	ISSUE FOR SSD	19/06/2018	DR
D	ISSUE FOR SSD	04/06/2018	RB
C	ISSUE FOR SSD	29/05/2018	RB
Revision	Description	Date	Initial

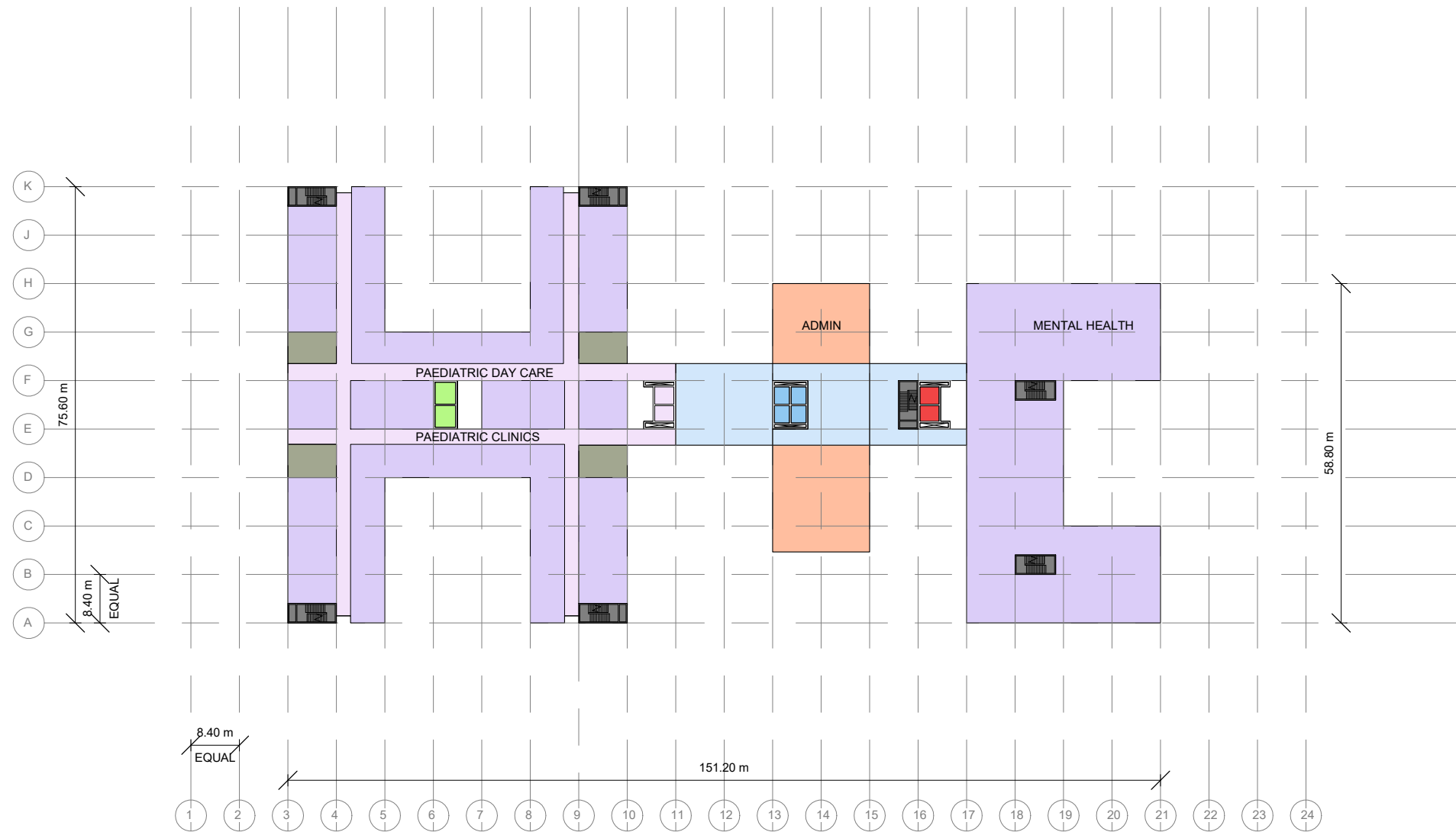

DEPARTMENTAL AREA
LIFT - PUBLIC
LIFT - PATIENT/STAFF/SERVICES
LIFT - TRAUMA

CIRCULATION - PUBLIC
CIRCULATION - STAFF/INTER-DEPARTMENTAL
STAIRS - FIRE EGRESS
PLANT

OUT OF SCOPE
COURTYARD
ADMIN

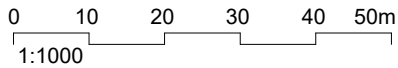

G	ISSUE FOR SSD	06/08/2018	DR
F	ISSUE FOR SSD	25/06/2018	RB
E	ISSUE FOR SSD	19/06/2018	DR
D	ISSUE FOR SSD	04/06/2018	RB
C	ISSUE FOR SSD	29/05/2018	RB
Revision	Description	Date	Initial

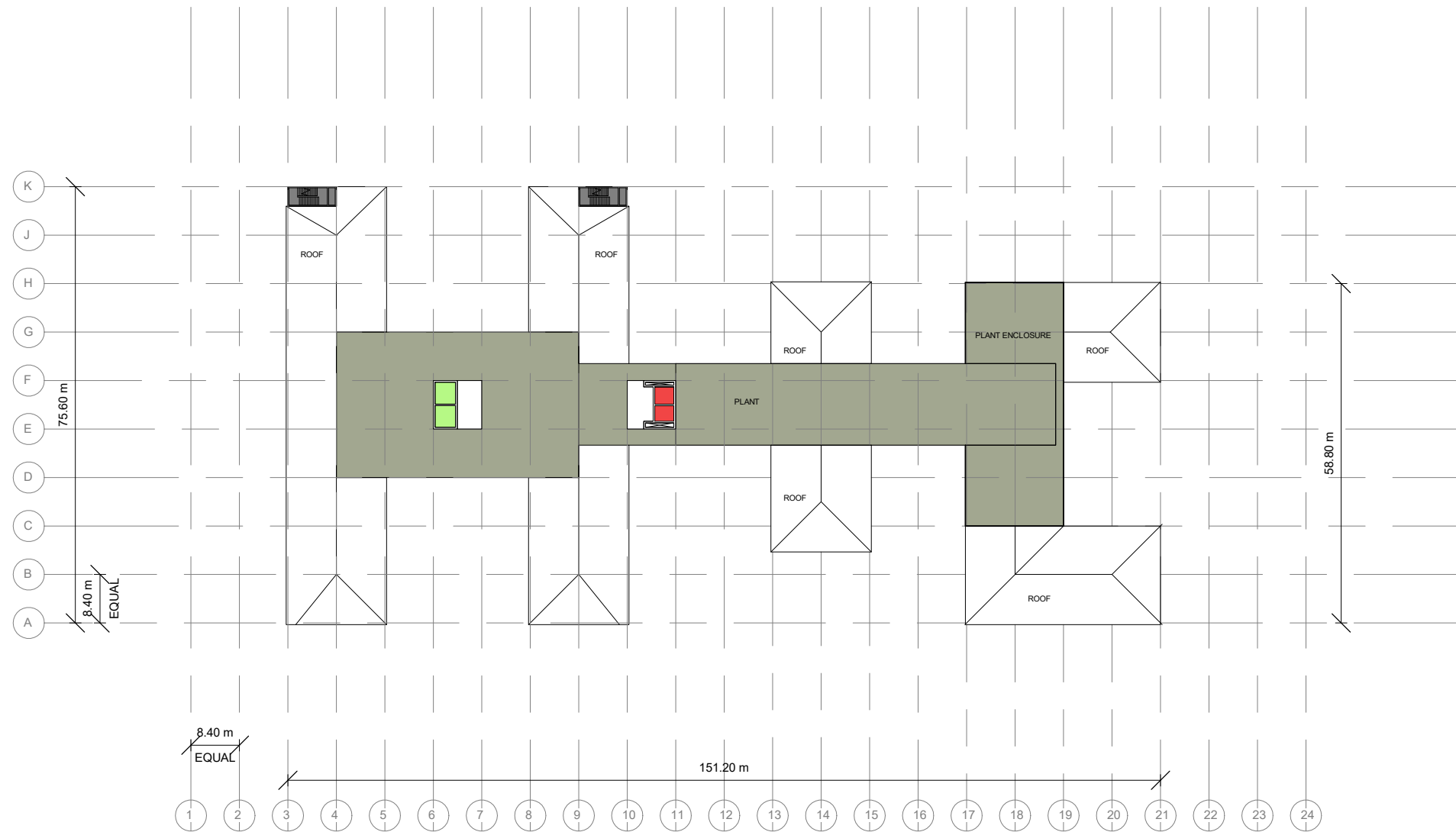

DEPARTMENTAL AREA
LIFT - PUBLIC
LIFT - PATIENT/STAFF/SERVICES
LIFT - TRAUMA

CIRCULATION - PUBLIC
CIRCULATION - STAFF/INTER-DEPARTMENTAL
STAIRS - FIRE EGRESS
PLANT

OUT OF SCOPE
COURTYARD
ADMIN

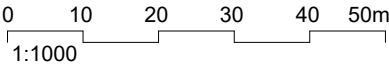

H	ISSUE FOR SSD	06/08/2018	DR
G	ISSUED FOR SSD	30/07/2018	DR
F	ISSUE FOR SSD	25/06/2018	RB
E	ISSUE FOR SSD	19/06/2018	DR
D	ISSUE FOR SSD	04/06/2018	RB
Revision	Description	Date	Initial

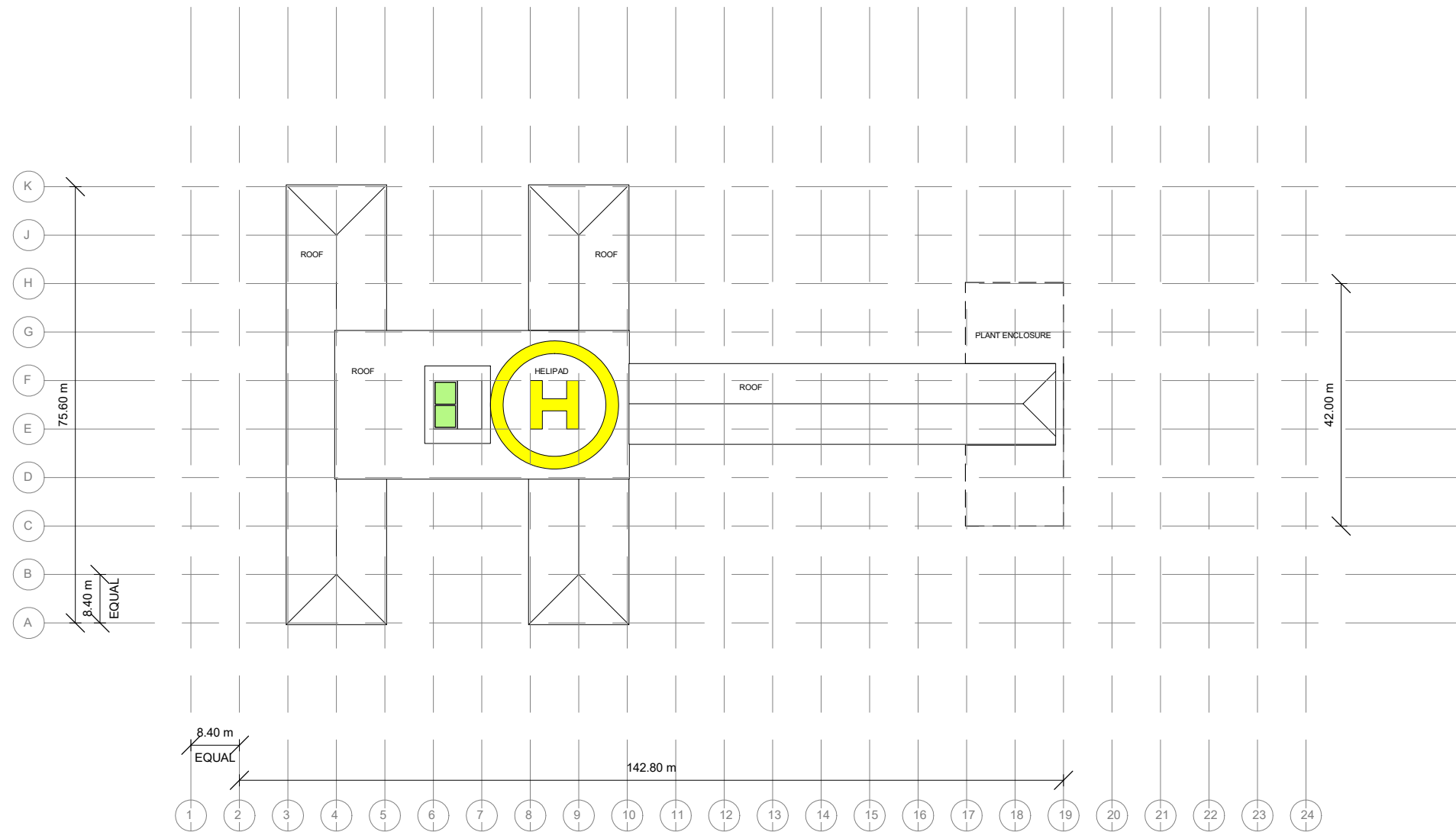

- DEPARTMENTAL AREA
- LIFT - PUBLIC
- LIFT - PATIENT/STAFF/SERVICES
- LIFT - TRAUMA

- CIRCULATION - PUBLIC
- CIRCULATION - STAFF/INTER-DEPARTMENTAL
- STAIRS - FIRE EGRESS
- PLANT

- OUT OF SCOPE
- COURTYARD
- ADMIN

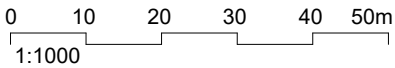

H	ISSUE FOR SSD	06/08/2018	DR
G	ISSUED FOR SSD	30/07/2018	DR
F	ISSUE FOR SSD	17/07/2018	DR
E	ISSUE FOR SSD	09/07/2018	DR
D	ISSUE FOR SSD	25/06/2018	RB
Revision	Description	Date	Initial



P: 02 9978 5402

F: 02 8904 1377

W:www.hinfra.health.nsw.gov.au



Billard Leece Partnership Pty Ltd
Architects & Urban Planners
Studio 201, 50 Holt St
Surry Hills 2010
NSW Australia
T +61 2 8096 4066
F +61 3 9656 5050
E info@blp.com.au
www.blp.com.au

Client
Health Infrastructure NSW

Project Name
CAMPBELLTOWN HOSPITAL
REDEVELOPMENT STAGE 2

Drawing Name
PLAN - PROPOSED - L12
(ROOF)

Scale	Project No	Date Created
1:1000 @ A3	17075	09/05/18
Drawing No	Revision	
SSD-03-012	H	

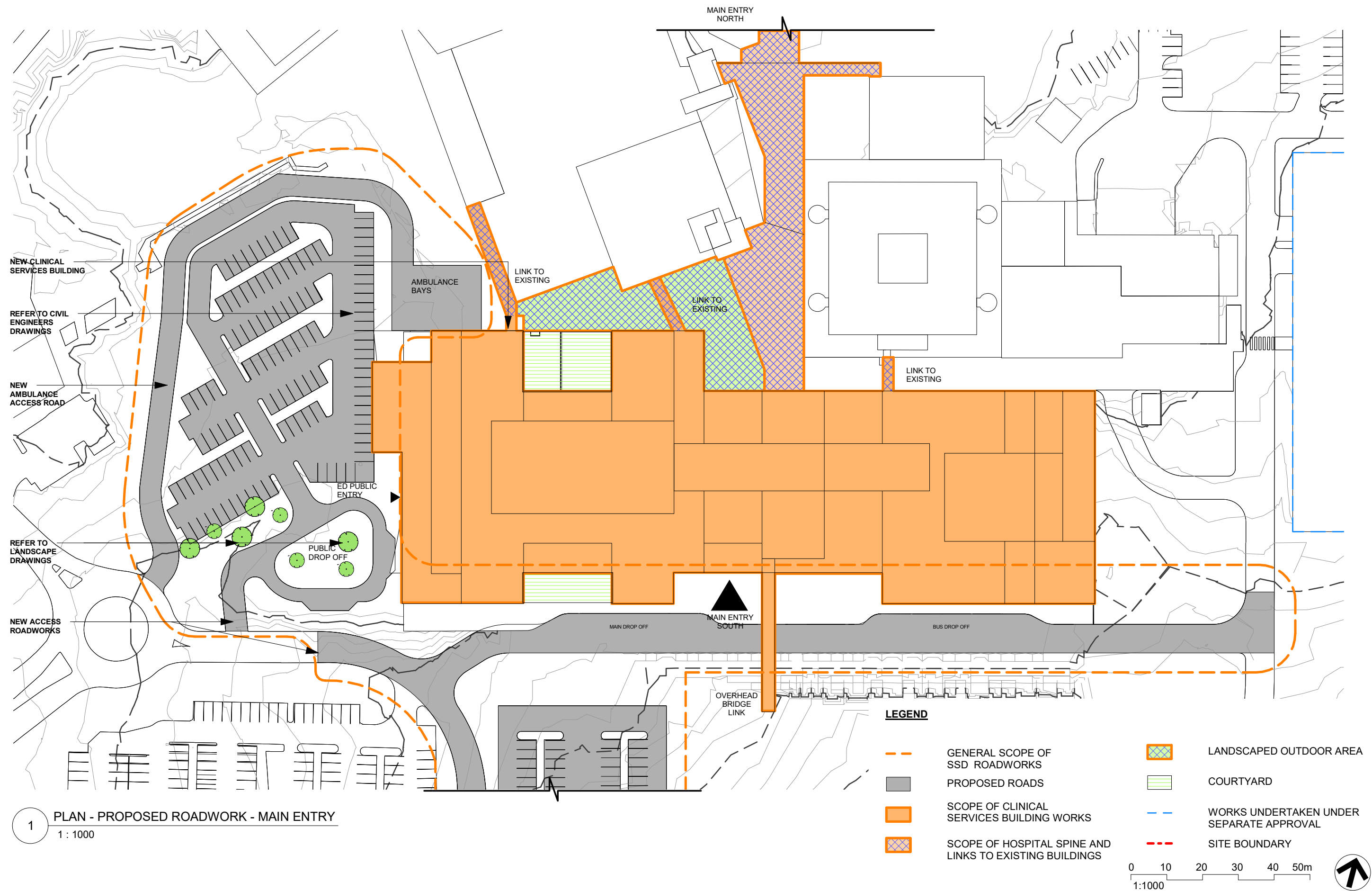

1 PLAN - PROPOSED ROADWORK - MAIN ENTRY
1 : 1000

F	ISSUE FOR SSD	17/07/2018	DR
E	ISSUE FOR SSD	22/06/2018	RB
D	ISSUE FOR SSD	19/06/2018	DR
C	ISSUE FOR SSD	04/06/2018	RB
B	ISSUE FOR SSD	29/05/2018	RB
Revision	Description	Date	Initial

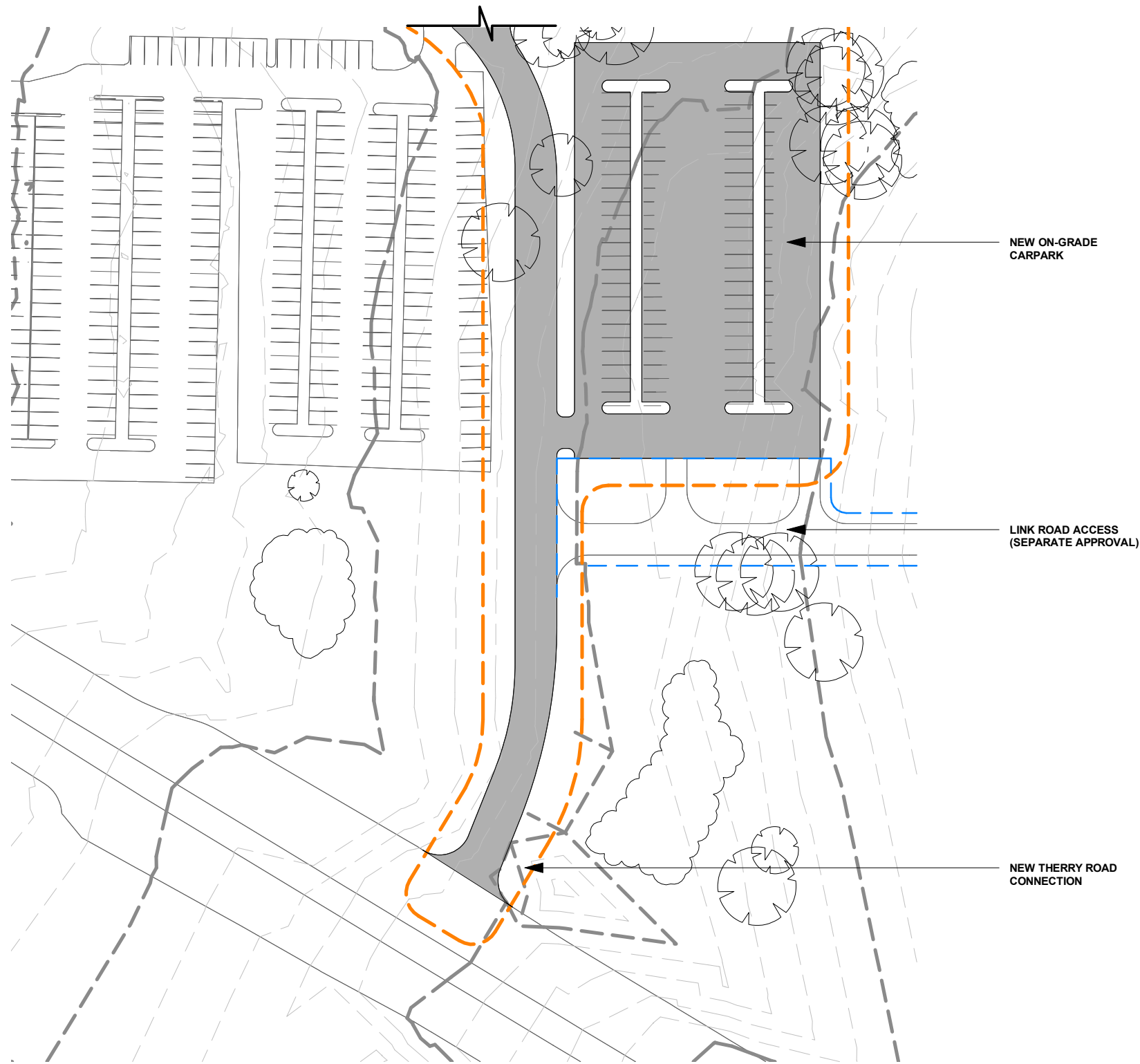

LEGEND

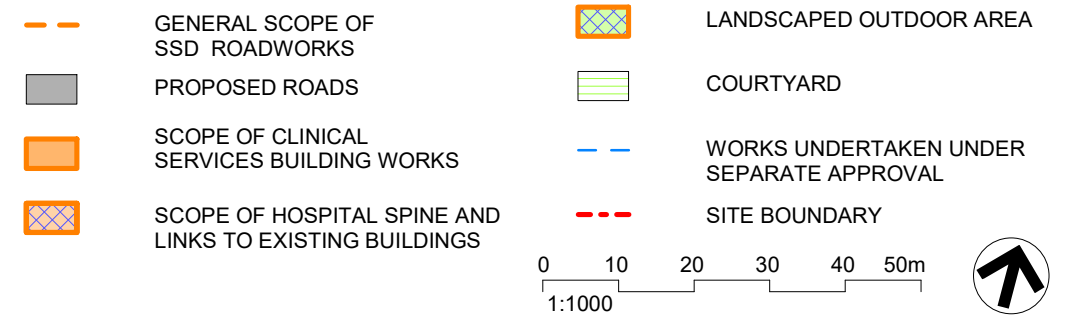

Revision	Description	Date	Initial
D	ISSUE FOR SSD	17/07/2018	DR
C	ISSUE FOR SSD	22/06/2018	RB
B	ISSUE FOR SSD	19/06/2018	DR
A	ISSUE FOR SSD	04/06/2018	RB