

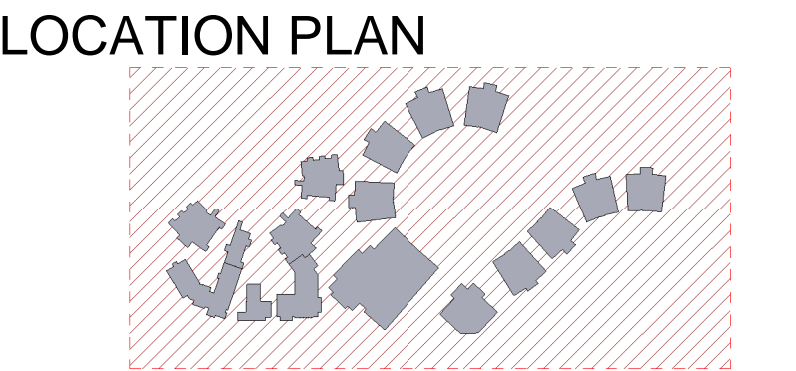

1 SITE ANALYSIS PLAN
04_0001 SCALE 1:1000

NOTE:
ALL TREES INSIDE THE BOUNDARY LINE HAVE BEEN SURVEYED.
REFER TO SURVEY B1662DET - 1 - B
ALL THE TREES OUTSIDE THE BOUNDARY LINE HAVE BEEN TAKEN FROM A
GOOGLE EARTH PHOTO.

- SITE LEGEND**
- | | | | |
|--|------------------------------|--|---------------------------|
| | POOL, WETLAND, POND | | 1:100 YEAR FLOOD LINE |
| | EXISTING ROAD | | SEPP 14 WETLANDS |
| | EXISTING STRUCTURE | | CREEK FLOOD LINE |
| | POWER POLE | | CREEK TOP OF BANK |
| | POWER LINES | | VEGETATION TRUNK LINE |
| | EXISTING TREE | | VEGETATION CANOPY LINE |
| | DEMOLISH TREE | | 50M ASSET PROTECTION ZONE |
| | DEMOLISH HOLLOW BEARING TREE | | EXISTING BUS STOP |
| | HOLLOW BEARING TREE | | MASS PLANTING |
| | NEW TREE | | BREEZES |



REV	DATE	DESCRIPTION	BY	CHK
H	05.12.2017	FOR PIC MEETING	PS	
I	16.01.2018	FOR STAKEHOLDER MEETING	CH	
J	16.02.2018	DEVELOPED DESIGN - 90%	DF	
K	09.03.2018	FOR QA	LK	
L	29.03.2018	FOR CLIENT APPROVAL	LK	TH
M	04.04.2018	FOR CLIENT APPROVAL	LK	
N	04.05.2018	FOR REVIEW	ME	
O	15.05.2018	FOR DEVELOPMENT APPROVAL	LK	
P	08.06.2018	FOR DEVELOPMENT APPROVAL - VIEW ARROWS ADDED	CH	

BUILDER TO CONFIRM ALL DETAILS, SETOUTS (TILE, ETC.), FALLS & CONNECTIONS ON SITE BEFORE CONSTRUCTION

PRINT DATE: 8/06/2018 10:20:06 AM

FILE PATH: C:\Users\chris.H\Documents\2544 Medowie Catholic School_chris.H\3B\VQ.rvt



webberarchitects
commercial and residential

Suite 3, Level 1 496 Hunter St Newcastle • PO Box 807 The Junction 2291
t +61 2 492 4 824 f 0 7 8 jackson@webberarchitects.com • www.webberarchitects.com

Directors: Jon Webber (Principal Architect) AIA, NSW AHS NO. 6520
Sandra Hinchey, Karen Brooks
Associates: Tim Hayes, Luke Keating

SITE ANALYSIS PLAN

CATHERINE MCAULEY CATHOLIC COLLEGE
507 MEDOWIE ROAD, MEDOWIE

ISSUED:

FOR DA APPROVAL

NOT FOR CONSTRUCTION

PROJECT COMMENCEMENT DATE: 01.05.2017

SCALE:

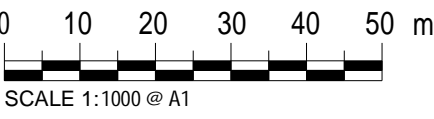

SHEET NUMBER: **2544_01_0004_P**

NORTH:



This drawing and the design expressed are copyright and remain the property of Webber Architects. In accordance with the commonwealth copyright act 1968 this drawing and design in whole or part may not be used unless licensed by Webber Architects. Verify all dimensions and falls on site before construction and do not scale from drawing.