

ABBREVIATIONS	
AW2	AWNING - TYPE 2
AW4	AWNING - TYPE 4
COL	COLUMN
CPP1	CONCRETE PRECAST PANEL - TYPE 1
DP1	DOWNSPIPE - TYPE 1
EG	EAVES GUTTER
LWC1	LIGHT WEIGHT CLADDING - TYPE 1
LWC2	LIGHT WEIGHT CLADDING - TYPE 2
MRS1	METAL ROOF SHEETING - TYPE 1
MRS2	METAL ROOF SHEETING - TYPE 2
PPB1	PAINTED PLASTERBOARD - TYPE 1
RWT1	RAIN WATER TANK - TYPE 1
SB1	STEEL BEAM - TYPE 1

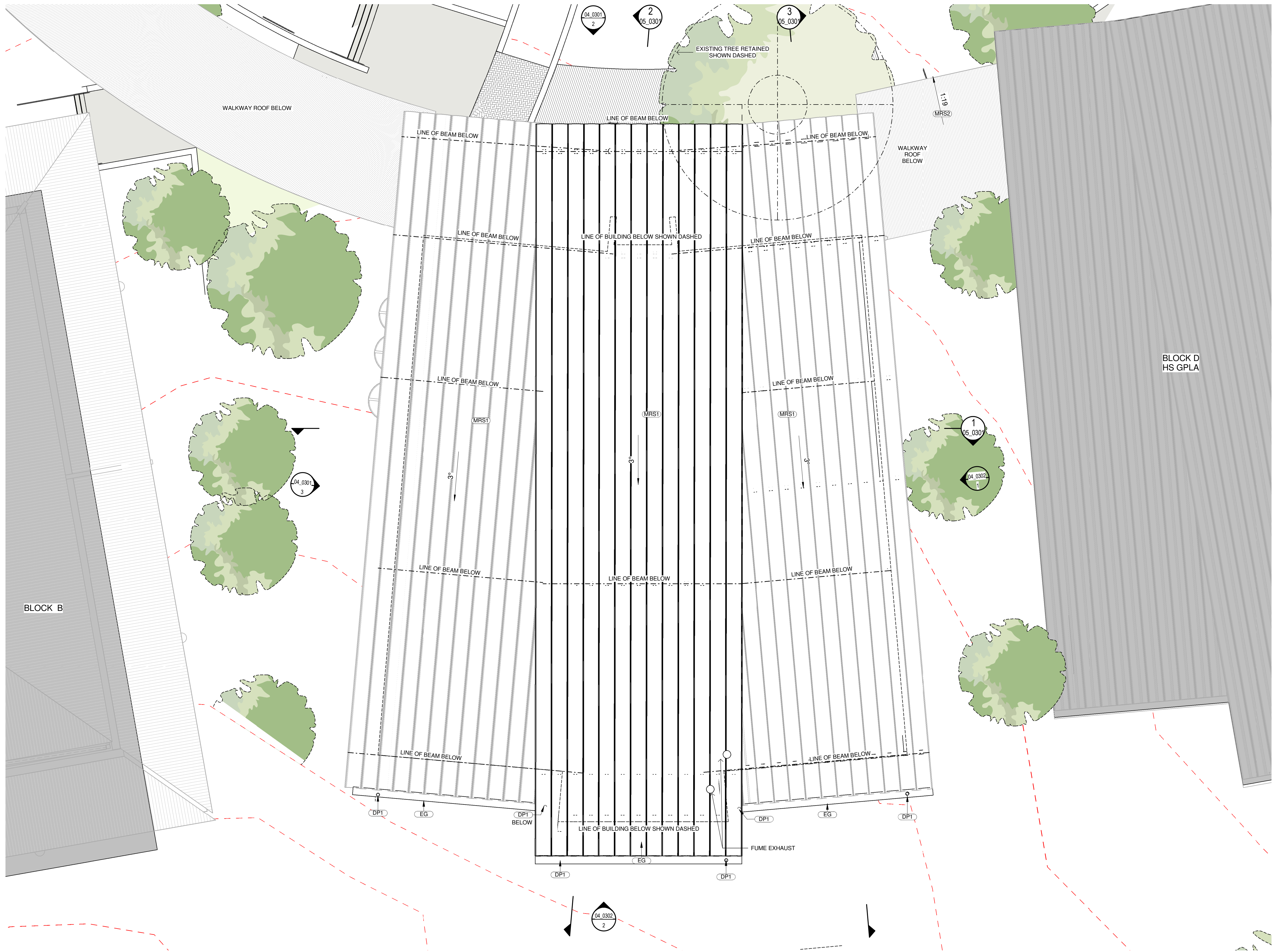

LOCATION PLAN  
SCALE 1 : 5000

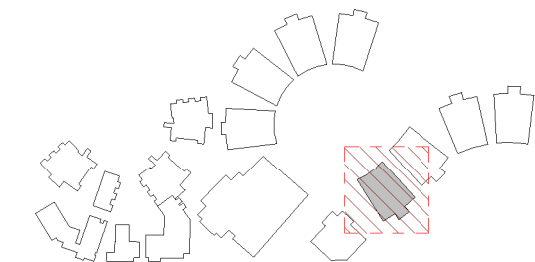

1 ROOF PLAN - BLOCK C  
SCALE 1 : 100

REV	DATE	DESCRIPTION	BY	CHK
A	25.01.2018	FOR DESIGN REVIEW	RH	
B	16.02.2018	DEVELOPED DESIGN - 90% ISSUE	RH	
C	09.03.2018	FOR DA	RH	TH
D	29.03.2018	FOR CLIENT APPROVAL	RH	TH
E	15.05.2018	FOR DEVELOPMENT APPROVAL	CH	

BUILDER TO CONFIRM ALL DETAILS, SETOUTS (TILE, ETC.), FALLS & CONNECTIONS ON SITE BEFORE CONSTRUCTION

PRINT DATE: 16-May-18 4:55:22 PM

FILE PATH: C:\Users\Daniel\Documents\2544 Medowie High School Block C - Science.daniel-foreman.rvt



webberarchitects  
commercial and residential

Suite 3, Level 1 496 Hunter St Newcastle  
1 x 1 = 612 4 226 1 078  
newcastle@webberarchitects.com

Directors: Jon Webber (Principal Architect) AIA, NSW AIB NO. 6830  
Associate Directors: Sarah Hickey, Karen Brooks  
Associates: Tim Hayes, Luke Keating

ROOF PLAN - BLOCK C  
HIGH SCHOOL - SCIENCE  
CATHERINE MCAULEY CATHOLIC COLLEGE  
507 MEDOWIE ROAD, MEDOWIE, NSW

ISSUED:  
**FOR DA APPROVAL**  
**NOT FOR CONSTRUCTION**

PROJECT COMMENCEMENT DATE: 01.05.2017

SCALE:  
0 1000 2000 3000 4000 5000 mm  
SCALE 1:100 @ A1

SHEET NUMBER: **2544\_03\_0303\_E**

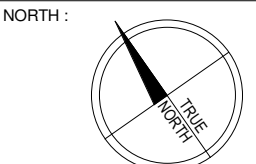

This drawing and the design expressed are copyright and remain the property of Webber Architects. In accordance with the commonwealth copyright act 1968 this drawing and design in whole or part may not be used unless licensed by Webber Architects. Verify all dimensions and falls on site before construction and do not scale from drawing.