



The following information is provided in response to the public and agency queries raised during the course of the SSDA Exhibition.

McConnel Smith & Johnson

Architecture Urban Design
Planning Interiors Graphics

1. TFNSW

The implementation of wayfinding strategies including safe marked walkways in the proposed carpark improvements is being developed and will continue to be refined through the documentation process.

Suite 110 Jones Bay Wharf
26-32 Pirrama Rd

The Green Travel Plan/Travel Access Guide has been used to assist with increasing the mode share of walking and cycling for staff, out-patients and visitors with the;

Nominated Registered Architects
and Directors

MS WILLETT (Reg. No 5327)
BArch (Hons) RAlA

IE MOON (Reg. No 5137)
BArch (Hons)

J ZADRO (Reg. No 9484)
BArch

- inclusion of public and staff bicycle parking on the site

- additional end of trip facilities for staff

The local bus stop has been relocated next to the main front pedestrian entry.

Senior Associates

K LAKIS
BArch MDIA

I EMPSON
BArch (Hons)

A OATES
BArch

Wayfinding strategies have been developed to provide safer marked walkways and shared areas within the proposed car park improvements. An outline of these proposals can be seen Appendix 1: Site Plan DD Concept with additional details contained in the Landscape and Wayfinding Reports Appendices.

2. SITE STRATEGY & MASTER PLANNING

The detailed masterplan was prepared for Bowral & District Hospital to illustrate how the proposed building has been designed and located to integrate with existing buildings and support future hospital development.

A copy of the Bowral & District Hospital Master Plan document? is contained in Appendix 2.

3. ENTRY, SITE CONNECTIONS & LANDSCAPING

The site works and landscape have been developed to address public access and amenity with the following elements:

- a shared pedestrian zone/wombat crossing to improve public access to the existing culturally significant area of landscaping.

- the development of a timber deck seating area in the landscape opposite the main entry accessed via the shared crossing area.

- public seating is located along the colonnade area along the main drop off area and main entry

- both the main entry reception/lift lobby and waiting area along with emergency waiting are located to view the landscape beyond.

Details of these areas can be seen in the Appendix 3 Landscape DD Report

External roadway and site directional signage has been developed to ensure that the Main Entry is not confused with the Ambulance entry. In addition to the directional signs, the Ambulance Entry will be further defined by road markings.

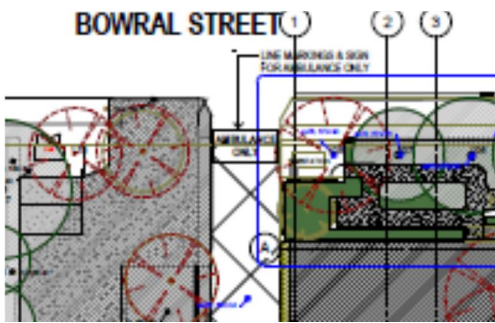

Building signage includes an illuminated Emergency signs on the façade and which can clearly be seen from a distance and defines the entry to the Emergency Department.

Initial details of all the signage can be seen in the Appendix 4 Wayfinding DD Report.

The Site Plan and Landscape proposals have been developed to better connect the New Building with the Administration building and other parts of the hospital via the Milton Park building. A Campus Directory Information Sign is also provided at key locations

Whilst the generator and medical gas storage units are required to be centrally located due to site and service restrictions, they are used to provide a screen between the public domain and the staff garden which is being developed on the western part of the site. These services structures will be further screened by landscape.

4. INTERNAL AMENITY

The interior design has been developed in a manner that decreases the clinical nature of the spaces and provides domestic styled spaces with a variety of public and semi-public seating spaces.

Whilst the area of the spaces is determined by Health Infrastructure, the brief and the Australasian Health Guidelines, all the main public lobby and waiting areas overlook the open stair and void to the landscape beyond and in line with the concept images and palette below.



McConnel Smith & Johnson

Architecture Urban Design
Planning Interiors Graphics

Suite 110 Jones Bay Wharf
26-32 Pirrama Rd

Nominated Registered Architects
and Directors

MS WILLETT (Reg. No 5327)
BArch (Hons) RAIA

IE MOON (Reg. No 5137)
BArch (Hons)

J ZADRO (Reg. No 9484)
BArch

Senior Associates

K LAKIS
BArch MDIA

I EMPSON
BArch (Hons)

A OATES
BArch

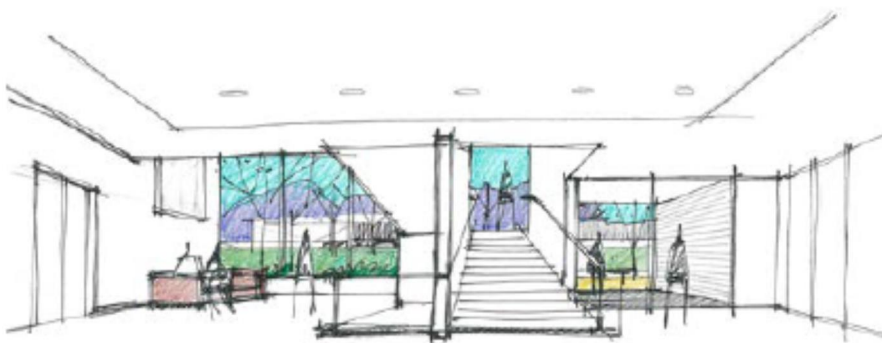

A further development of these spaces with a 3D exploration will be undertaken in consultation with the local LHD, Users and the community.

Funds for a café within the hospital were not allocated but there are 2 cafes within an easy walk of 200 metres from the main entry.

5. BUILT FORM & ARTICULATION

The proposed built form and materials palette is being developed with window modulation and articulation of the brick façade. Consultation with users and the Community has led to a combination of the modulated brick and lightweight cladding façade. Consideration is also being given to the painted blue board façade to ensure it is robust, durable and easily serviced with the location of planters and screens providing protection and service access.

6. ESD STRATEGY

An ESD Strategy has been developed outlining the broad initiatives to be used in the design and assessing those through the development of the design, documentation, construction and operation, using the Green Star Health Care rating system. The report is contained Appendix



McConnel Smith & Johnson

Architecture Urban Design
Planning Interiors Graphics

Suite 110 Jones Bay Wharf
26-32 Pirrama Rd

Nominated Registered Architects
and Directors

MS WILLETT (Reg. No 5327)
BArch (Hons) RAlA

IE MOON (Reg. No 5137)
BArch (Hons)

J ZADRO (Reg. No 9484)
BArch

Senior Associates

K LAKIS
BArch MDIA

I EMPSON
BArch (Hons)

A OATES
BArch

5 along with the Appendix 5A: GS Compliance Checklist for MSJ to progress during the course of the project.

7. PUBLIC ART, CULTURAL HERITAGE & COMMUNITY CONSULTATION

The User Group Meeting process has included a number of groups including members of the local community to ensure local needs are supported.

The following items have been identified to date

A. Aboriginal Healing Space

An outdoor area has been identified to be developed in consultation with the local Aboriginal community. The area identified can be seen on the DD Concept Site Plan & Landscape Report.

B. Existing Administration Building Gardens

The existing Administration building was the former main hospital entry with its circular driveway, and has significant cultural heritage importance to the Bowral community and consultation has identified the following;

- enhancing the circular driveway as a pedestrian only zone allowing the community to contemplate in the existing memorial garden with the intrusion of cars.
- developing the space to allow the hospital to join in Bowral's yearly Tulip Festival.

C. Public Art Strategy

The development of this has been discussed and some of the initial ideas to be expanded upon in consultation with the community include;

- Large format photographic images forming a key image and associated colour theme on each level.
- Use of indigenous flora as a motif or digital image which for a part of and extend from the main department wayfinding signs to small meeting/interview rooms.
- Identification of spaces in each department for potential artwork locations.

An initial overview of these elements can be seen in Appendix 6 Public Art Tracking Plans along with the Landscape and Wayfinding DD Reports.

These are to be developed further in consultation with the users and the community to ensure the proposals are culturally specific, welcoming and supportive.

8. PLANNING CONSIDERATIONS (P Edwards, 100 Mittagong Road, Bowral)

The planning items raised by P Edwards, 100 Mittagong Road, Bowral items have been considered in the design as follows;

a. New CSB and Services

Vehicular service access is still via the three existing back-of-house service points as the existing Linen Services, Medical Gas Services and Mortuary are still located there.

There is a new enclosed link proposed between the existing ED building to the new CSB which will serve as access for all back of house functions to the new building with no extension of the existing travel distance. This proposal also takes into account future expansions and links which may be made as part of the B&DH Masterplan.



McConnel Smith & Johnson

Architecture Urban Design
Planning Interiors Graphics

Suite 110 Jones Bay Wharf
26-32 Pirrama Rd

Nominated Registered Architects
and Directors

MS WILLETT (Reg. No 5327)
BArch (Hons) RAlA

IE MOON (Reg. No 5137)
BArch (Hons)

J ZADRO (Reg. No 9484)
BArch

Senior Associates

K LAKIS
BArch MDIA

I EMPSON
BArch (Hons)

A OATES
BArch

MSJ

A batch/trolley washer has been included on LI Operating Theatres for the first stage instrument sterilising.

McConnel Smith & Johnson

Architecture Urban Design
Planning Interiors Graphics

Nominated Registered Architects
and Directors

IE MOON (Reg. No 5137)
BArch (Hons)

J ZADRO (Reg. No 9484)
BArch

Senior Associates

K LAKIS
BArch MDIA

I EMPSON
BArch (Hons)

A OATES
BArch

Figure 45: Proposed pedestrian and bicycle facilities (Source: MSJ & GTA)

We trust the above with additional information provided in the Appendices clarifies the queries raised.

Yours sincerely

Paul

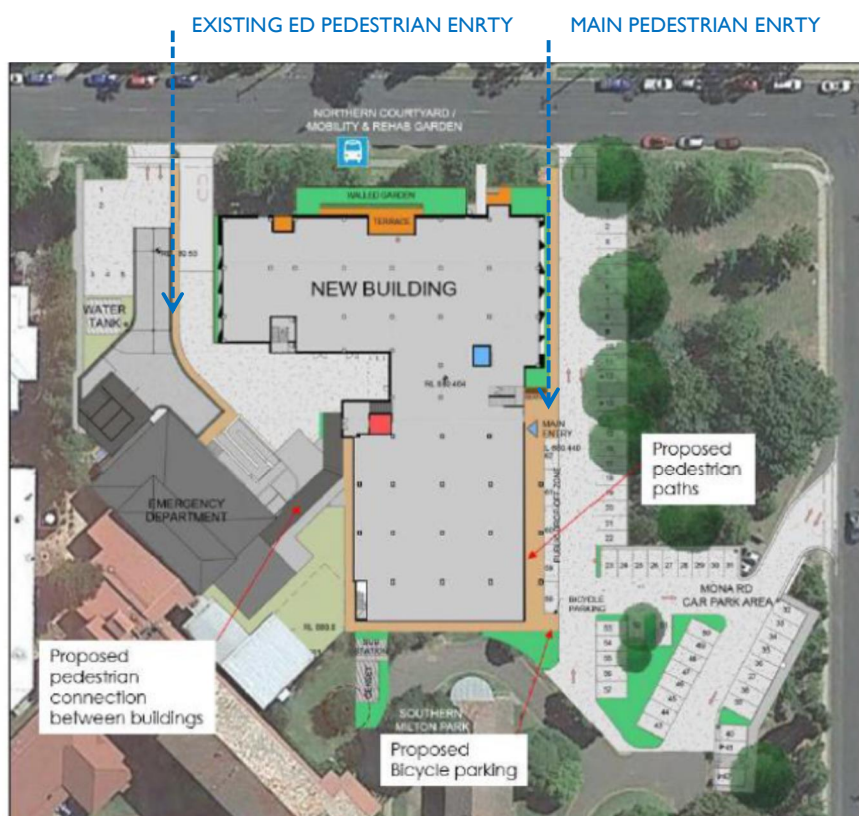
Ian Moon

Director