

## FOR INFORMATION

TFNSW  
Victoria Cross OSD

## Building Envelope Indicative Ground Floor Plan



Scale	Not to scale	@ A0	
Drawn	Author	Checked	Checker
Project no.	12188		
Status	S4.55 Modification		
Plot Date	5/07/2019 12:42:59 PM		
Plot File			

**Melbourne** 1 Nicholson Street  
Melbourne VIC 3000 Australia  
T 03 8664 6200 F 03 8664 6300  
email [mel@batessmart.com.au](mailto:mel@batessmart.com.au)  
<http://www.batessmart.com.au>

**Sydney** 43 Brisbane Street  
Surry Hills NSW 2010 Austral  
T 02 8354 5100 F 02 8354 51  
email [syd@batessmart.com.au](mailto:syd@batessmart.com.au)  
<http://www.batessmart.com.au>

**Bates Smart** Pty Ltd ABN 70 004 999 400

**BATES**SMART

Check all dimensions and site conditions prior to commencement of any work, the purchase or ordering of any materials, fittings, plant, services or equipment and the preparation of shop drawings and or the fabrication of any components.

Do not scale drawings - refer to figured dimensions only. Any discrepancies shall immediately be referred to the architect for clarification.

All drawings may not be reproduced or distributed without prior permission from the architect.

7	05.07.19	ISSUE FOR \$4.55 MODIFICATION	JWC	MLS
6	2.05.19	ISSUE FOR \$4.55 MODIFICATION	JWC	MLS
5	12.04.19	ISSUE FOR \$4.55 MODIFICATION	JWC	MLS
4	01.03.19	ISSUE FOR \$4.55 MODIFICATION	JWC	MLS
3	08.08.18	ISSUE FOR SSDA	TG	TG
2	16.04.18	ISSUE FOR SSDA	TG	FJM
1	22.02.18	ISSUE FOR SSDA	GH	GH
Revision	Date	Description	Initial	Checked



KEY:

--- MAXIMUM BUILDING HEIGHT  
(NORTH SYDNEY LOCAL  
ENVIRONMENT PLAN 2013)

VICTORIA CROSS STATION  
CSSI APPROVAL - INCLUDES  
STRUCTURE AND BUILDING  
INFRASTRUCTURE AND  
SPACE FOR LIFT CORES,  
ACCESS, PARKING, RETAIL  
AND BUILDING SERVICES  
FOR THE FUTURE OSD.

OSD CONCEPT SSD  
BUILDING ENVELOPE  
INCLUDES OSD USES.

ARTICULATION ZONE -  
0-4.5M WIDE.

Note: A 500mm flexible zone is presumed on the Northern elevation of the building envelope, and a 250mm flexible zone is presumed on the Southern elevation of the building envelope, to allow for non-habitable architectural detailing and expression such as sunshades.

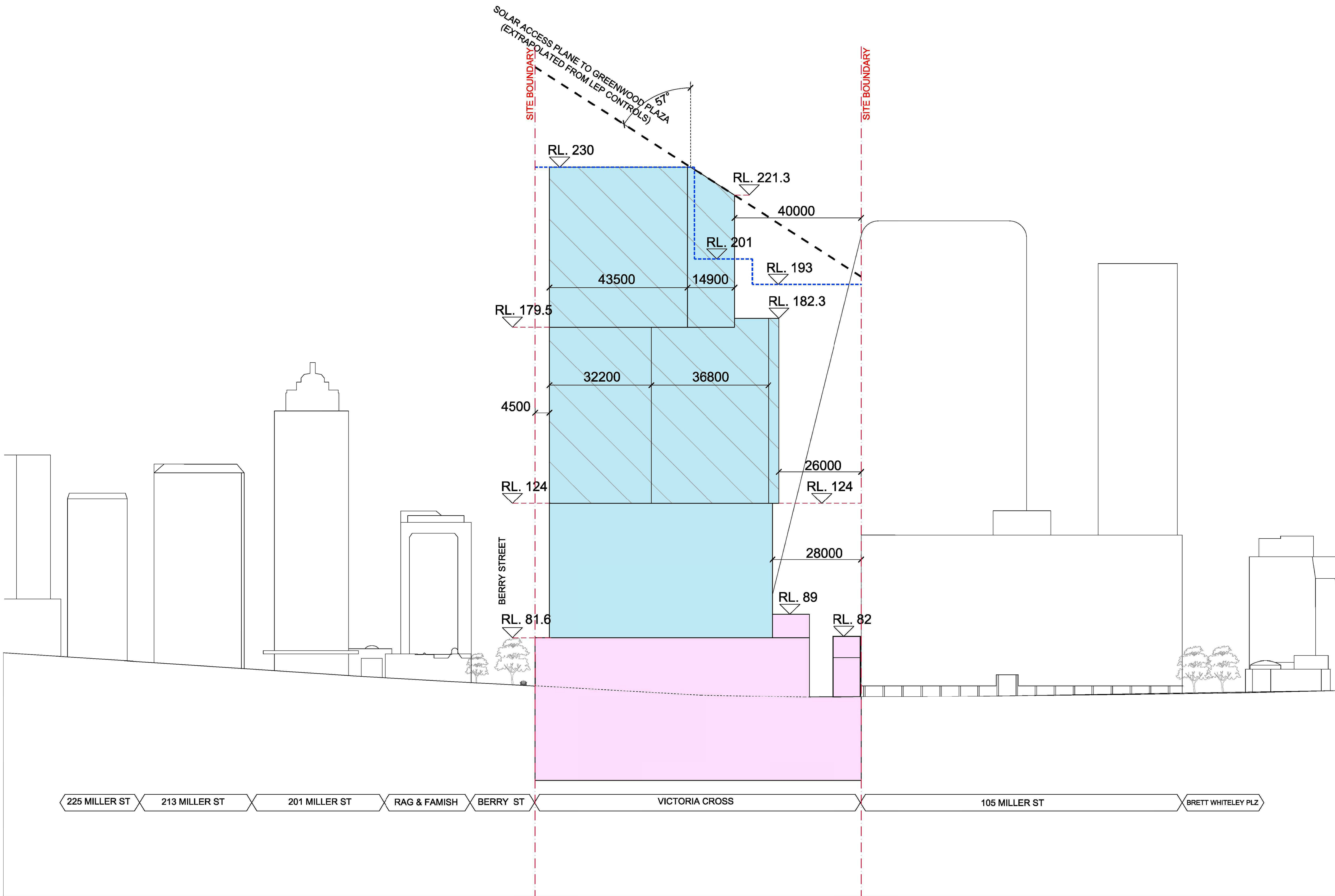

Check all dimensions and site conditions prior to commencement of any work, the purchase or ordering of any materials, fittings, plant, services or equipment and the preparation of shop drawings and or the fabrication of any components.

Do not scale drawings - refer to figured dimensions only. Any discrepancies shall immediately be referred to the architect for clarification.

All drawings may not be reproduced or distributed without prior permission from the architect.

7	05.07.19	ISSUE FOR S4.55 MODIFICATION	JWC	MLS
6	2.05.19	ISSUE FOR S4.55 MODIFICATION	JWC	MLS
5	12.04.19	ISSUE FOR S4.55 MODIFICATION	JWC	MLS
4	01.03.19	ISSUE FOR S4.55 MODIFICATION	JWC	MLS
3	08.08.18	ISSUE FOR SSDA	TG	TG
2	16.04.18	ISSUE FOR SSDA	TG	FJM
1	22.02.18	ISSUE FOR SSDA	GH	GH
Revision Date		Description	Initial	Checked

TFNSW  
Victoria Cross OSD

Building Envelope  
Miller Street Elevation

Scale	Not to scale	@ A0
Drawn	Author	Checked
Project no.	12188	
Status	S4.55 Modification	
Plot Date	5/07/2019 12:46:11 PM	
Plot File		
Drawing no.	A01.002	Revision
		7

FOR INFORMATION

**Melbourne** 1 Nicholson Street  
Melbourne VIC 3000 Australia  
T 03 8664 6200 F 03 8664 6300  
email mel@batesmart.com.au  
http://www.batesmart.com.au

**Bates Smart** Pty Ltd ABN 70 004 999 400

**Sydney** 43 Brisbane Street  
Surry Hills NSW 2010 Australia  
T 02 8354 5100 F 02 8354 5199  
email syd@batesmart.com.au  
http://www.batesmart.com.au

BATESSMART



KEY:

--- MAXIMUM BUILDING HEIGHT  
(NORTH SYDNEY LOCAL  
ENVIRONMENT PLAN 2013)

VICTORIA CROSS STATION  
CSSI APPROVAL - INCLUDES  
STRUCTURE AND BUILDING  
INFRASTRUCTURE AND  
SPACE FOR LIFT CORES,  
ACCESS, PARKING, RETAIL  
AND BUILDING SERVICES  
FOR THE FUTURE OSD.

OSD CONCEPT SSD  
BUILDING ENVELOPE  
INCLUDES OSD USES.

ARTICULATION ZONE -  
0-4.5M WIDE.

Note: A 500mm flexible zone is presumed on the Northern elevation of the building envelope, and a 250mm flexible zone is presumed on the Southern elevation of the building envelope, to allow for non-habitable architectural detailing and expression such as sunshades.

Check all dimensions and site conditions prior to commencement of any work, the purchase or ordering of any materials, fittings, plant, services or equipment and the preparation of shop drawings and or the fabrication of any components.

Do not scale drawings - refer to figured dimensions only. Any discrepancies shall immediately be referred to the architect for clarification.

All drawings may not be reproduced or distributed without prior permission from the architect.

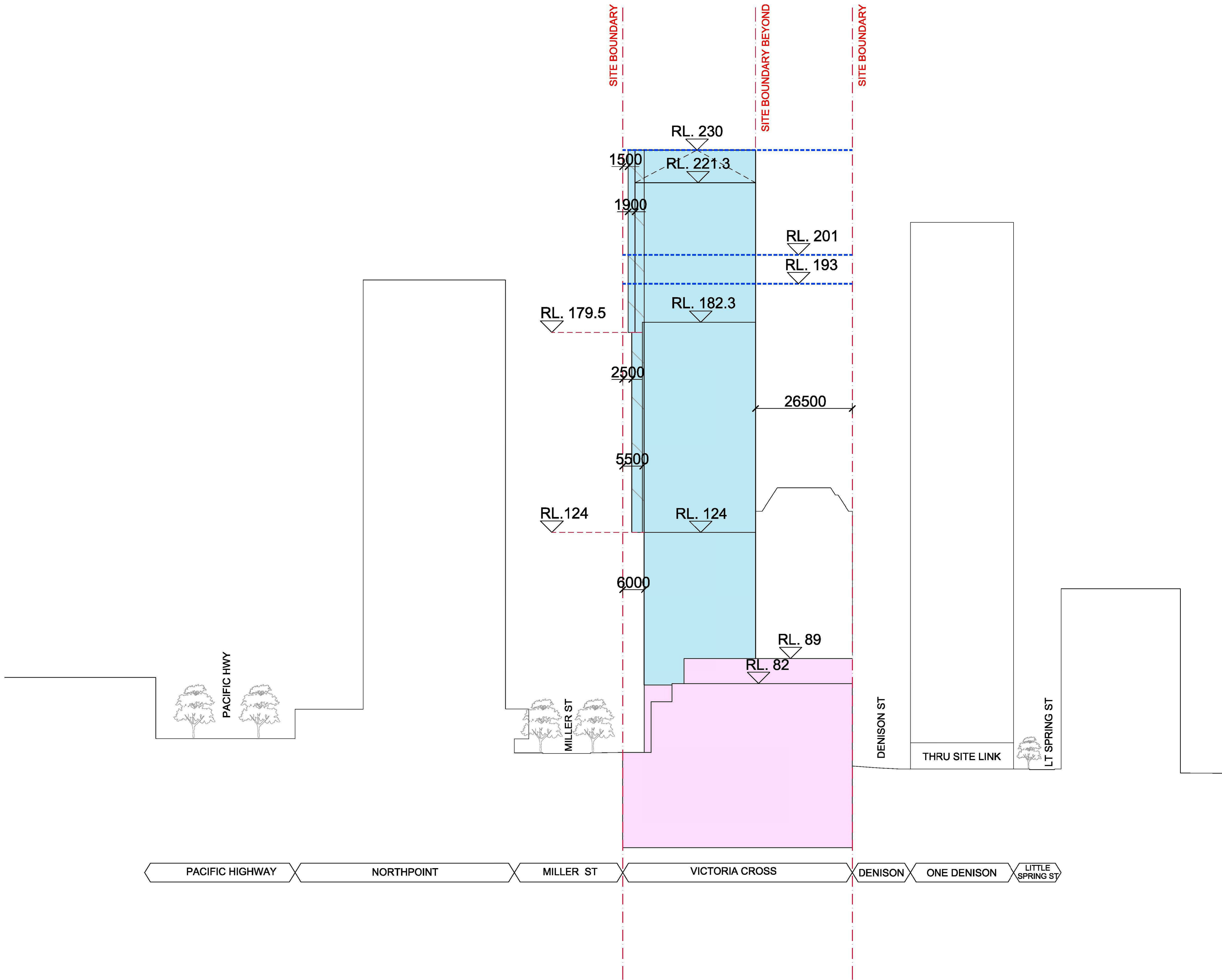

## FOR INFORMATION

TFNSW  
Victoria Cross OSD  
Building Envelope  
East West Section

Scale	Not to scale	@ A0
Drawn	Author	Checked
Project no.	12188	
Status	S4.55 Modification	
Plot Date	5/07/2019 12:46:57 PM	
Plot File		
Drawing no.	A01.003	Revision
		7

**Melbourne** 1 Nicholson Street  
Melbourne VIC 3000 Australia  
T 03 8664 6200 F 03 8664 6300  
email mel@batesmart.com.au  
http://www.batesmart.com.au

**Sydney** 43 Brisbane Street  
Sunny Hills NSW 2010 Australia  
T 02 8354 5100 F 02 8354 5199  
email syd@batesmart.com.au  
http://www.batesmart.com.au

**Bates Smart** Pty Ltd ABN 70 004 999 400

BATESSMART



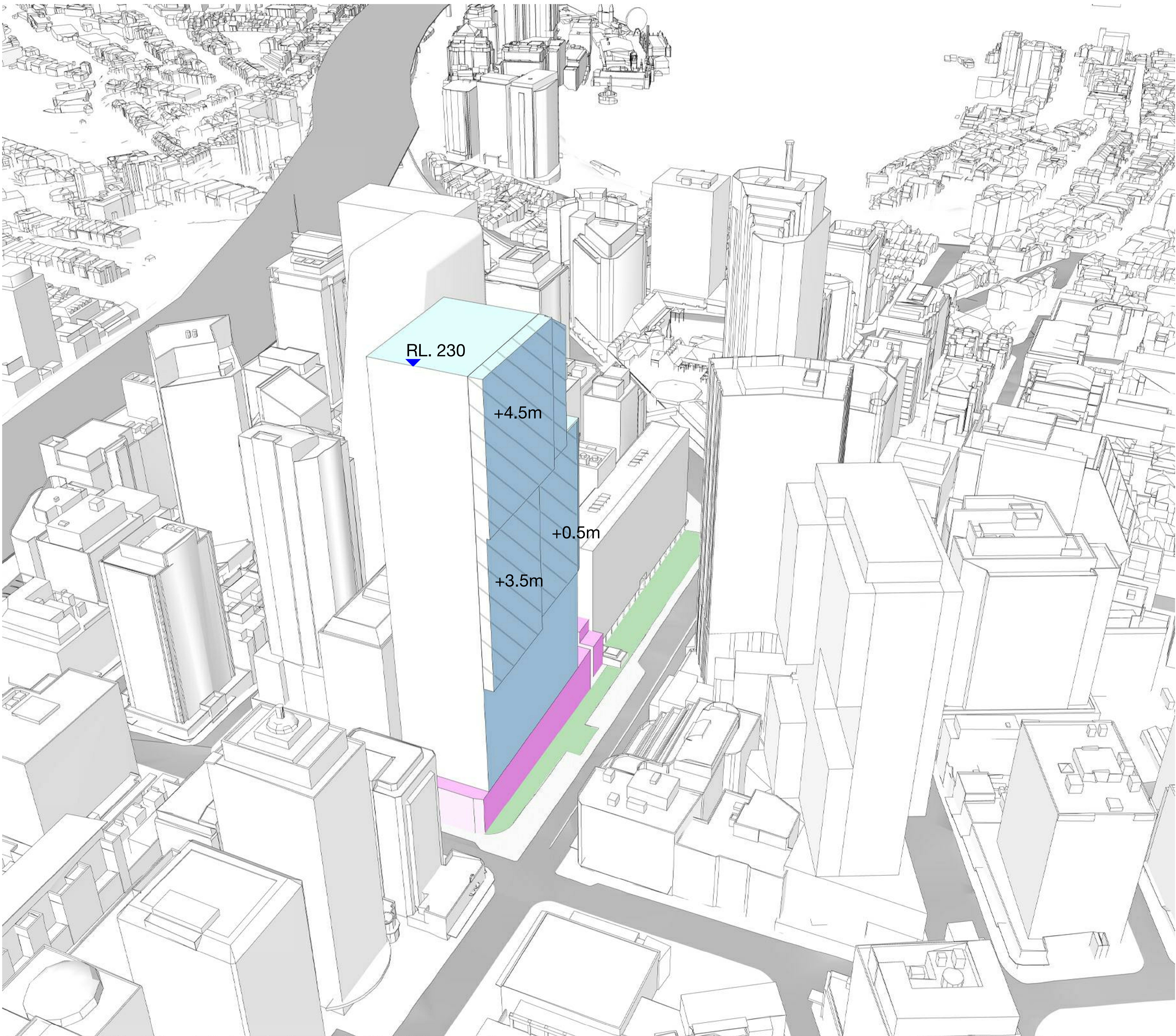

KEY:

VICTORIA CROSS STATION  
CSSI APPROVAL - INCLUDES  
STRUCTURE AND BUILDING  
INFRASTRUCTURE AND  
SPACE FOR LIFT CORES,  
ACCESS, PARKING, RETAIL  
AND BUILDING SERVICES  
FOR THE FUTURE OSD

OSD CONCEPT SSD  
BUILDING ENVELOPE  
INCLUDES OSD USES.

ARTICULATION ZONE -  
0-4.5M WIDE

Note: A 500mm flexible zone is presumed on the Northern elevation of the building envelope, and a 250mm flexible zone is presumed on the Southern elevation of the building envelope, to allow for non-habitable architectural detailing and expression such as sunshades.

## FOR INFORMATION

TFNSW  
Victoria Cross OSD  
Building Envelope  
North West Axonometric

Scale Not to scale @ A0  
Drawn Author Checked Checker  
Project no. 12188  
Status S4.55 Modification  
Plot Date 5/07/2019 12:49:20 PM  
Plot File  
Drawing no. Revision  
A01.004 7

Melbourne 1 Nicholson Street  
Melbourne VIC 3000 Australia  
T 03 8664 6200 F 03 8664 6300  
email mel@batesmart.com.au  
http://www.batesmart.com.au  
Sydney 43 Brisbane Street  
Surry Hills NSW 2010 Australia  
T 02 8354 5100 F 02 8354 5199  
email syd@batesmart.com.au  
http://www.batesmart.com.au

Bates Smart Pty Ltd ABN 70 004 999 400

BATESSMART

Check all dimensions and site conditions prior to commencement of any work, the purchase or ordering of any materials, fittings, plant, services or equipment and the preparation of shop drawings and or the fabrication of any components.

Do not scale drawings - refer to figured dimensions only. Any discrepancies shall immediately be referred to the architect for clarification.

All drawings may not be reproduced or distributed without prior permission from the architect.

7	05.07.19	ISSUE FOR S4.55 MODIFICATION	JWC	MLS
6	2.05.19	ISSUE FOR S4.55 MODIFICATION	JWC	MLS
5	12.04.19	ISSUE FOR S4.55 MODIFICATION	JWC	MLS
4	01.03.19	ISSUE FOR S4.55 MODIFICATION	JWC	MLS
3	08.08.18	ISSUE FOR SSDA	TG	TG
2	16.04.18	ISSUE FOR SSDA	TG	FJM
1	22.02.18	ISSUE FOR SSDA	GH	GH
Revision	Date	Description	Initial	Checked



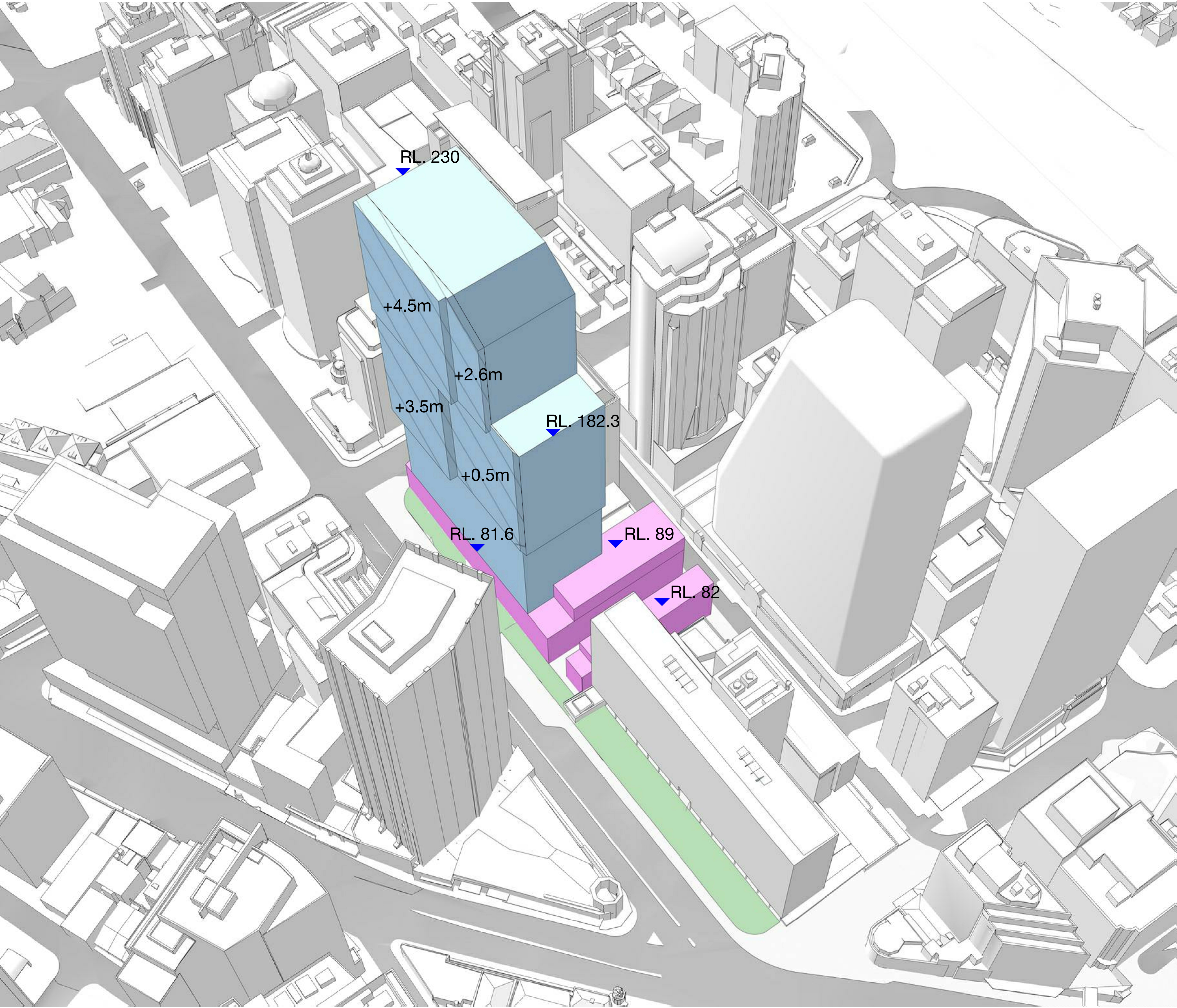

KEY:

VICTORIA CROSS STATION  
CSSI APPROVAL - INCLUDES  
STRUCTURE AND BUILDING  
INFRASTRUCTURE AND  
SPACE FOR LIFT CORES,  
ACCESS, PARKING, RETAIL  
AND BUILDING SERVICES  
FOR THE FUTURE OSD

OSD CONCEPT SSD  
BUILDING ENVELOPE  
INCLUDES OSD USES.

ARTICULATION ZONE -  
0-4.5M WIDE

Note: A 500mm flexible zone is presumed on the Northern elevation of the building envelope, and a 250mm flexible zone is presumed on the Southern elevation of the building envelope, to allow for non-habitable architectural detailing and expression such as sunshades.

Check all dimensions and site conditions prior to commencement of any work, the purchase or ordering of any materials, fittings, plant, services or equipment and the preparation of shop drawings and or the fabrication of any components.

Do not scale drawings - refer to figured dimensions only. Any discrepancies shall immediately be referred to the architect for clarification.

All drawings may not be reproduced or distributed without prior permission from the architect.

7	05.07.19	ISSUE FOR S4.55 MODIFICATION	JWC	MLS
6	2.05.19	ISSUE FOR S4.55 MODIFICATION	JWC	MLS
5	12.04.19	ISSUE FOR S4.55 MODIFICATION	JWC	MLS
4	01.03.19	ISSUE FOR S4.55 MODIFICATION	JWC	MLS
3	08.08.18	ISSUE FOR SSDA	TG	TG
2	16.04.18	ISSUE FOR SSDA	TG	FJM
1	22.02.18	ISSUE FOR SSDA	GH	GH
Revision Date		Description	Initial	Checked

TFNSW  
Victoria Cross OSD

Building Envelope  
South West  
Axonometric

Scale	Not to scale	@ A0
Drawn	Author	Checked
Project no.	12188	
Status	S4.55 Modification	
Plot Date	5/07/2019 12:38:11 PM	
Plot File		

Drawing no.  
A01.005

Revision  
7

FOR INFORMATION

Melbourne 1 Nicholson Street  
Melbourne VIC 3000 Australia  
T 03 8664 6200 F 03 8664 6300  
email mel@batesmart.com.au  
http://www.batesmart.com.au

Sydney 43 Brisbane Street  
Surry Hills NSW 2010 Australia  
T 02 8354 5100 F 02 8354 5199  
email syd@batesmart.com.au  
http://www.batesmart.com.au

Bates Smart Pty Ltd ABN 70 004 999 400

BATESSMART