

# **Community Information Session — information boards**

APPENDIX L



# Welcome to this information session

Our staff will be happy  
to assist you





# Australia's biggest public transport project





# Revolutionising how we travel



The customer is at the centre of the Sydney Metro rail product.

## Key benefits

Metro delivers improved connectivity across multiple levels:

- moving more people faster than ever before
- fast and easy to change to trains, buses, ferries and light rail
- making it fast and easy to move around a growing city
- making a big city better connected
- aligning and integrating with other city-building transport projects
- opening up options for work, education, health care and much more
- taking the guesswork out of travel – no need to plan, just turn up and go.



# Shaping tomorrow's Sydney

Sydney Metro will revitalise communities, transform places and make the nation's only global city more liveable and connected.

Australia's largest city will be more productive and more attractive globally.

Not only will this new mass transit system move more people safely and reliably than ever before, it will unlock the potential of Sydney as a growing global city – creating new and diverse opportunities to support changing communities.

Joining other great global mass transit development initiatives, the NSW Government has identified stations on the Sydney Metro system which can be better integrated with the areas around them, creating world-class places that will shape our city's future.

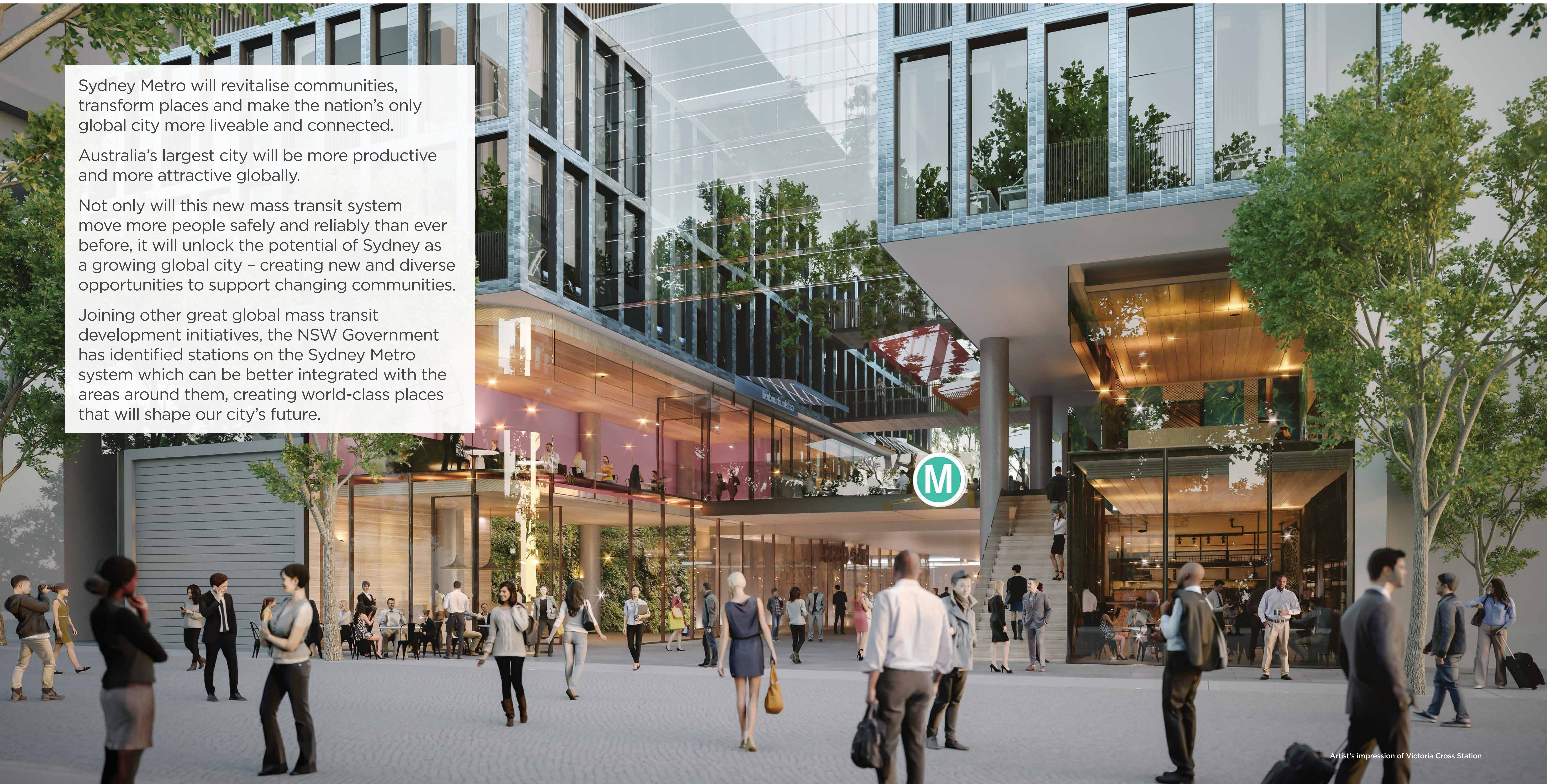

Artist's impression of Victoria Cross Station



[sydneymetro.info](http://sydneymetro.info)  
1800 171 386



# Integrated station developments

As the new metro stations are built underground, buildings will be able to be built above them at the same time.

This helps reduce community impacts and the length of time required to deliver the outcomes of integrated station developments.

The metro stations have been designed so that work on the integrated developments can start while the station construction is underway. This integrated approach means buildings can be completed close to when Sydney Metro services start in 2024.

Option one is preferred because it delivers the integrated development at the earliest date and minimises construction impacts.

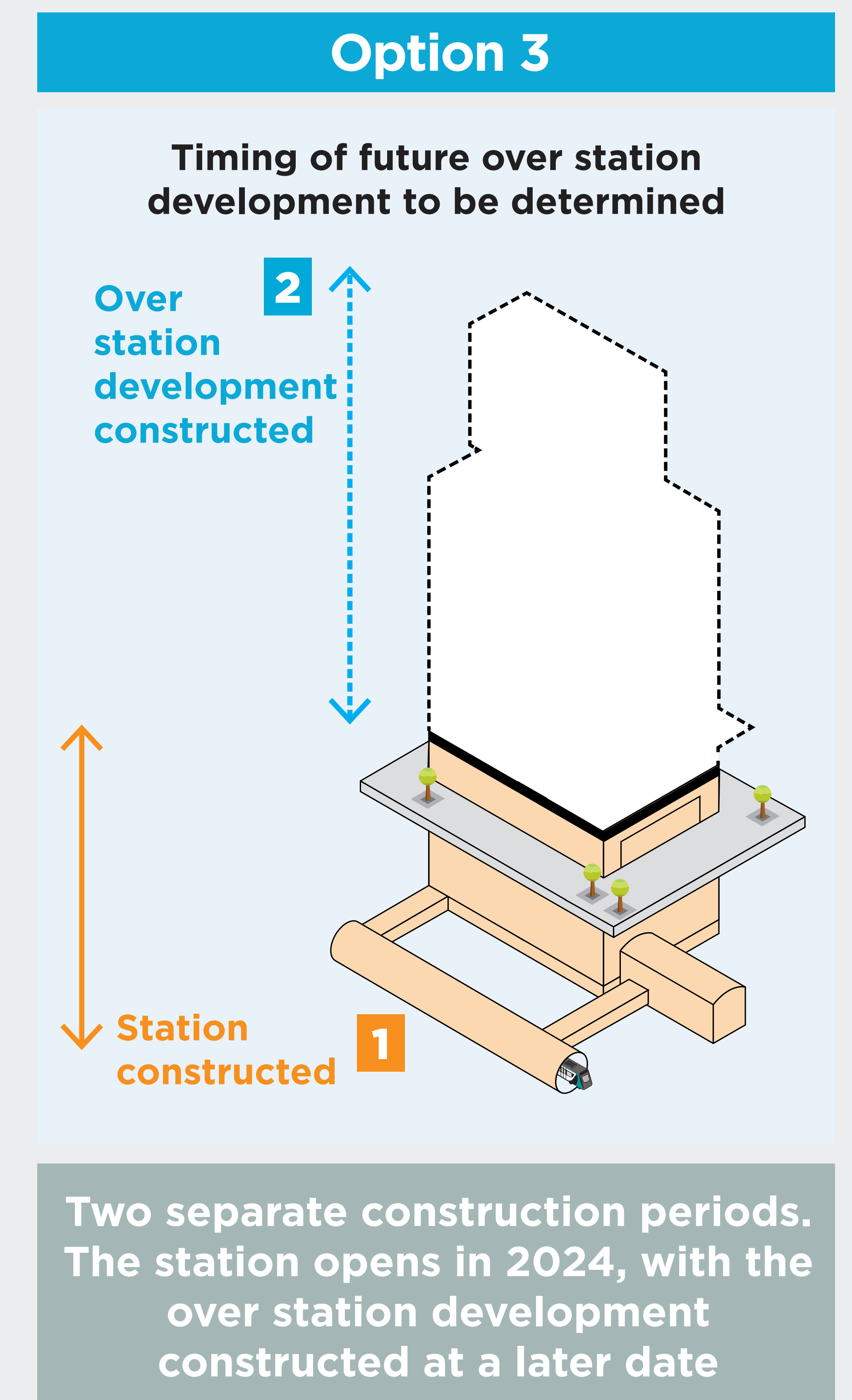
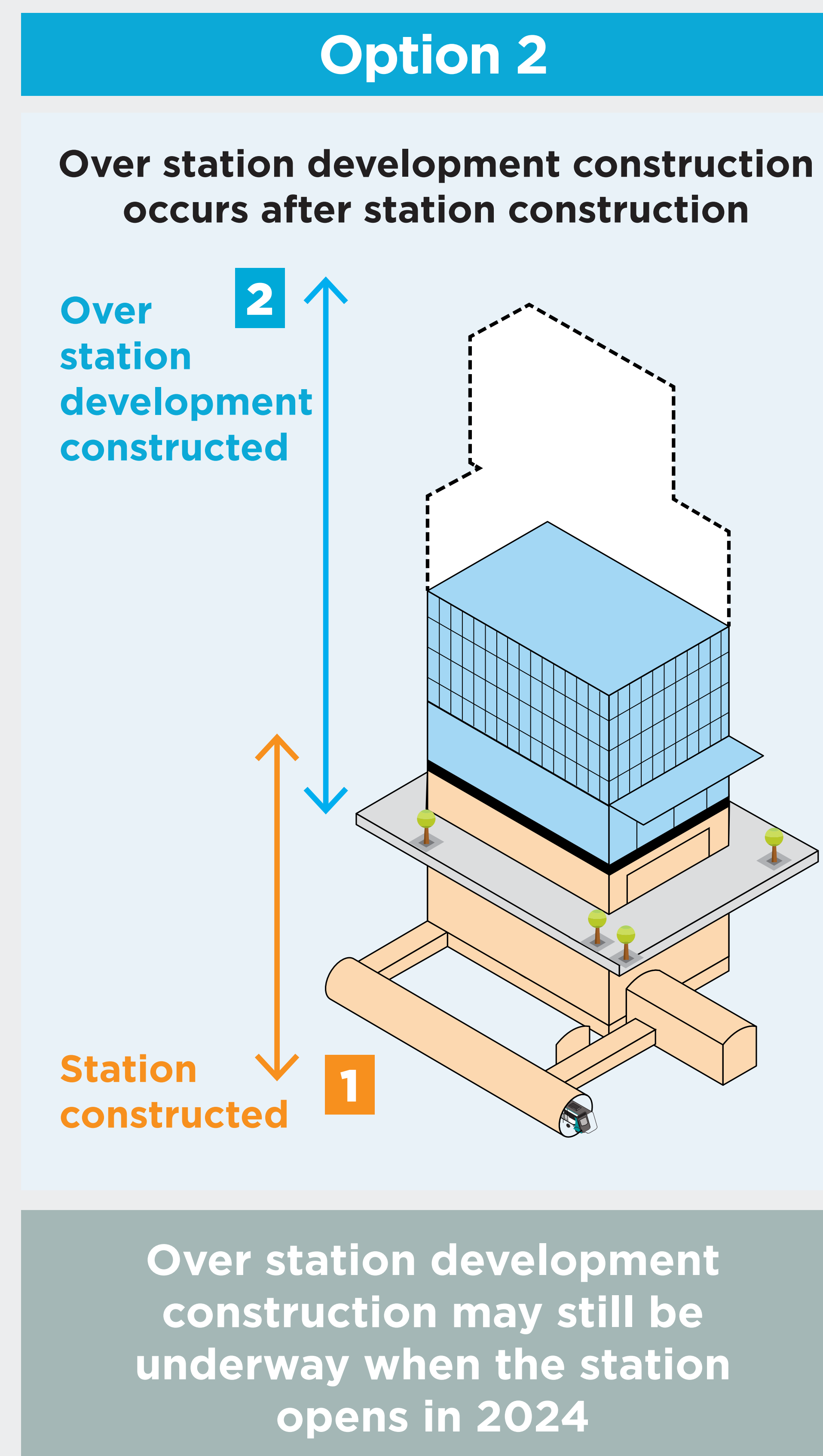
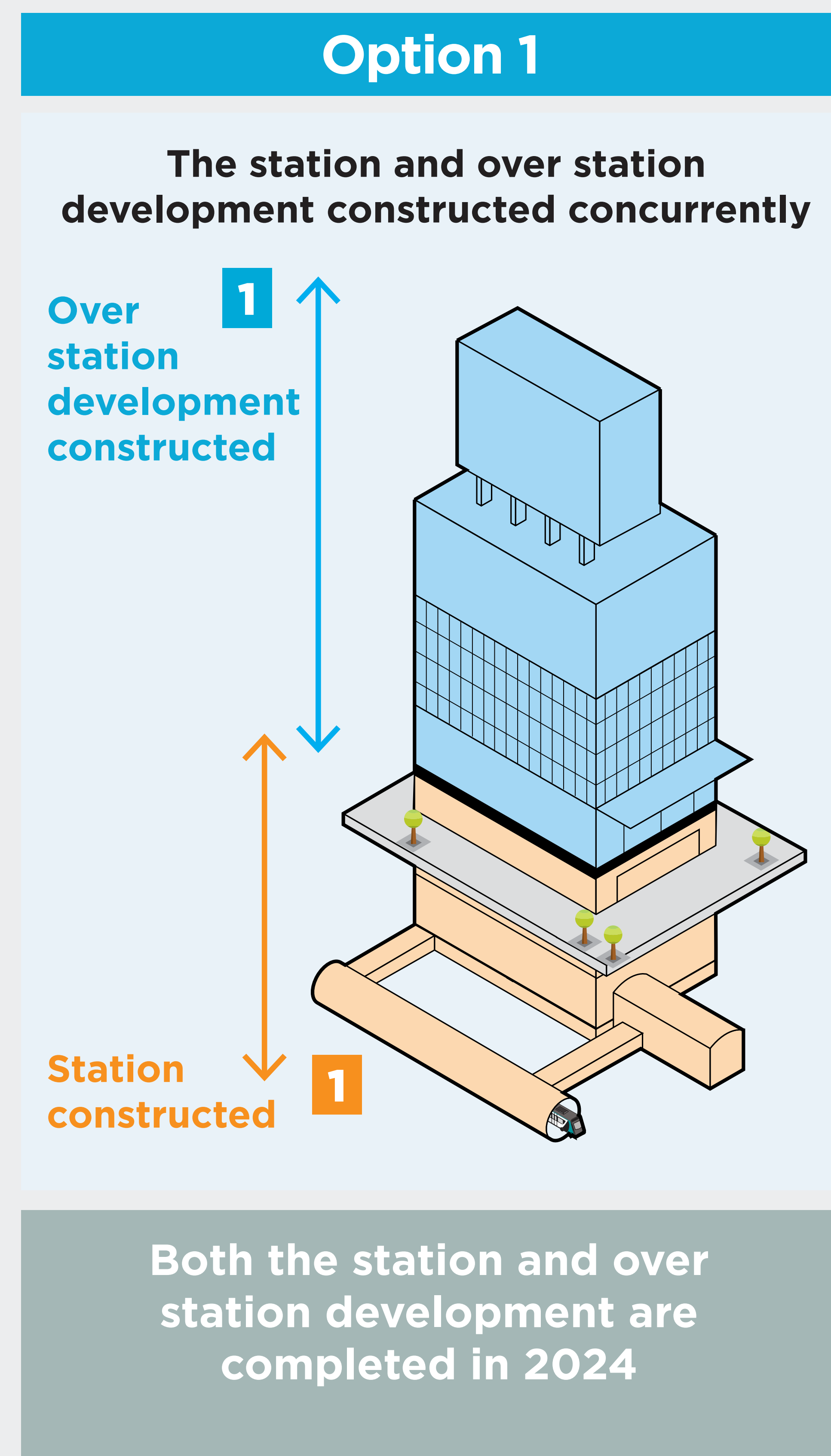



# Excellence in design



## New city icons

- Development that shapes Sydney's growth and identity
- Contributing to Sydney's reputation for design excellence
- Leaving a lasting legacy



## Vibrant public places

- Welcoming and inclusive places for social and cultural interaction
- Opportunities to create places and buildings that celebrate Sydney's culture and values
- Contributing to the vibrant and accessible streets and open space around stations



## Integrated and inclusive

- Maximising opportunities for land use and transport integration
- Meeting the increasing demand for well-located residential, commercial, retail and community precincts
- Contributing to economic growth through appropriate land use outcomes
- Supporting opportunities for the expansion, improvement and activation of public open spaces



## Designed for the future

- Buildings and surrounding spaces will be of the highest quality, exceeding community expectations now and into the future
- New infrastructure and public spaces will be durable, hard wearing and easy to maintain
- Sustainability will be embedded into initiatives



## Safety and accessibility

- Day and night time activation will make precincts vibrant, including safe access
- A sense of security will ensure people can see and be seen

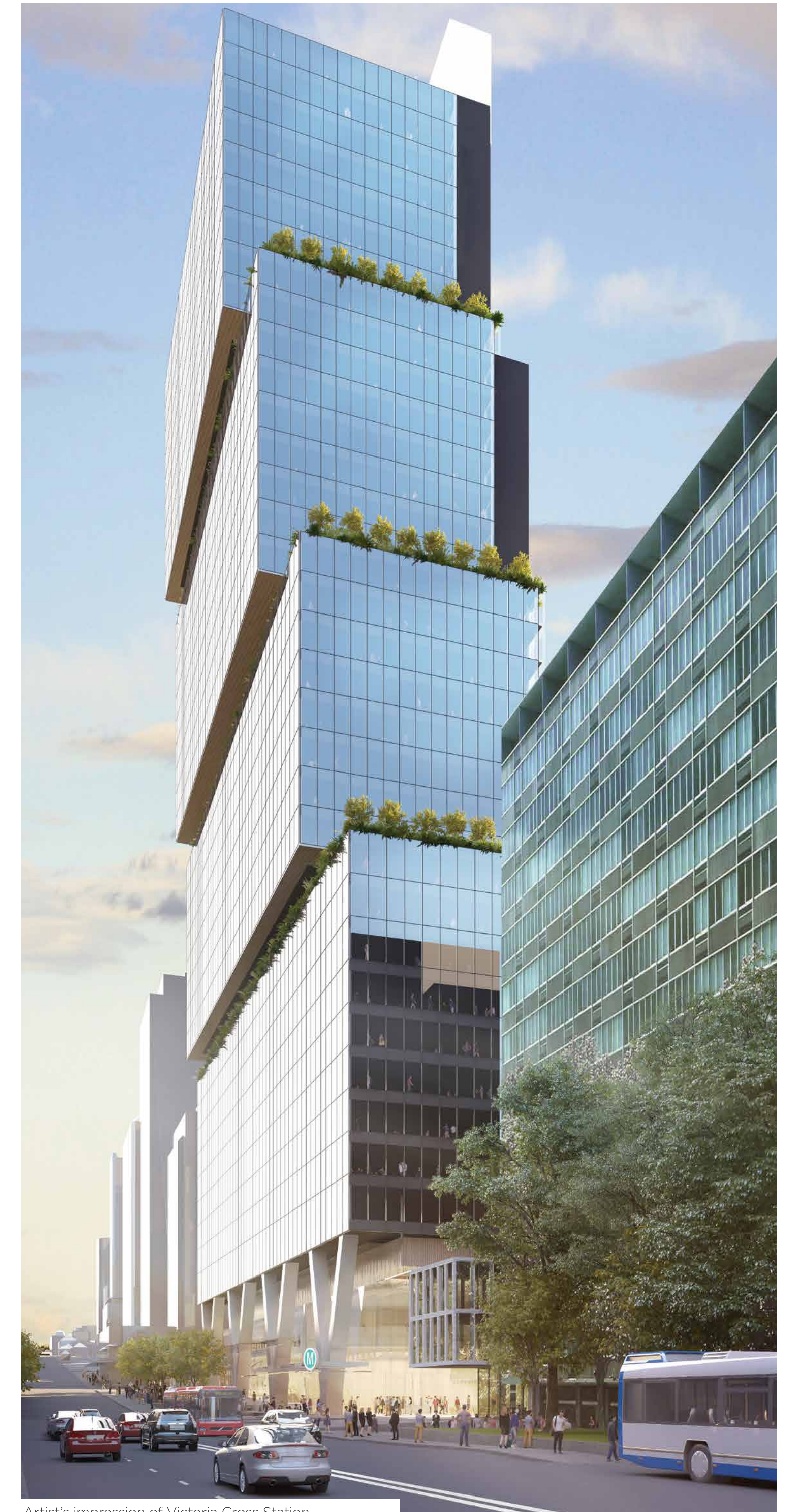



Artist's impression of Victoria Cross Station

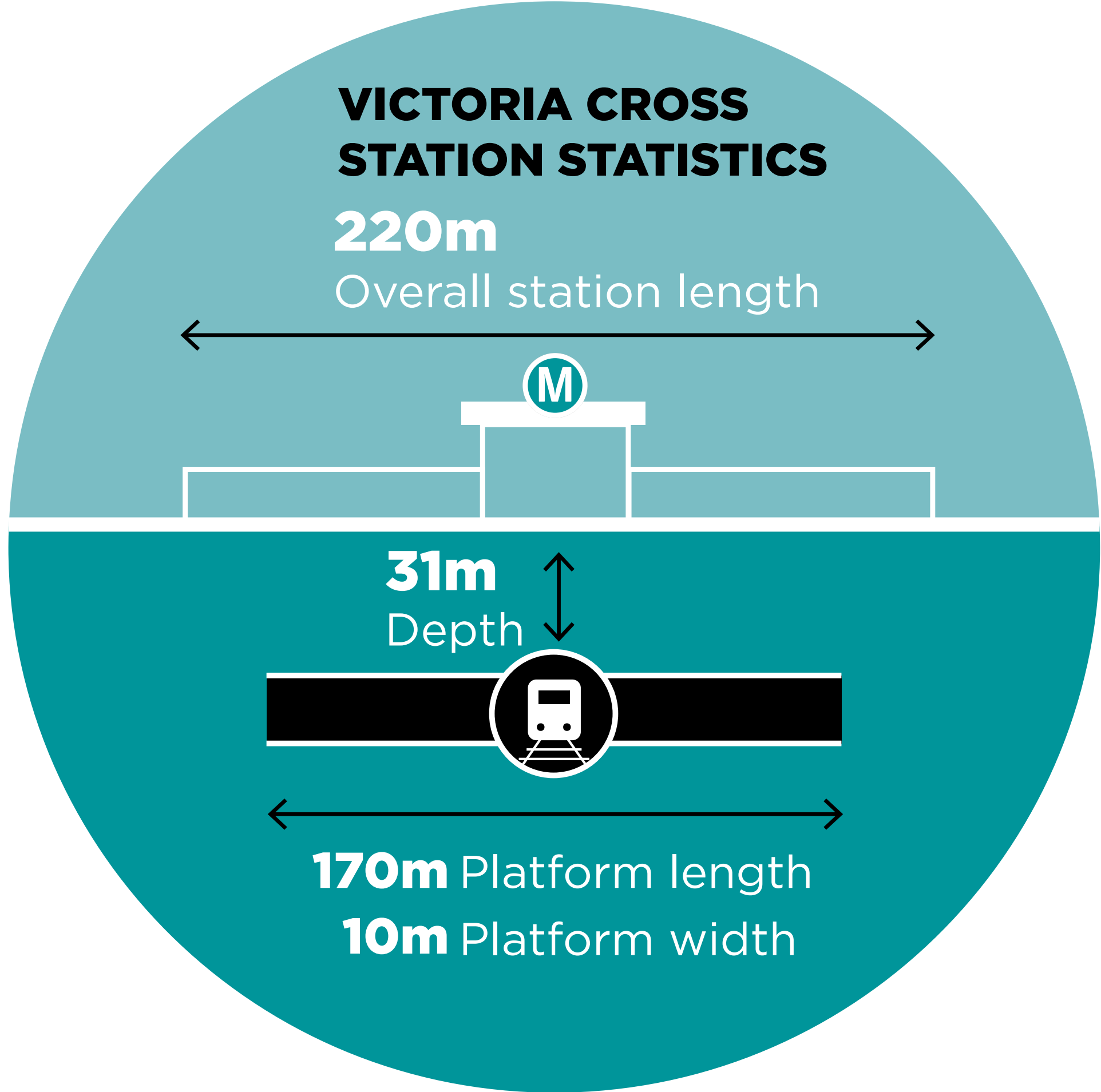

# Victoria Cross Station



**ACCESSING THE STATION**

-  Pedestrian access
-  Bike parking
-  Bus stops
-  Kiss-and-ride
-  Taxi bays



**3** Minutes to  
**BARANGAROO**

**5** Minutes to  
**MARTIN PLACE**

**9** Minutes to  
**CENTRAL**



# Victoria Cross integrated station development



Artists impression of the Victoria Cross integrated station development



[sydneymetro.info](http://sydneymetro.info)  
1800 171 386



# Victoria Cross integrated station development

A new commercial and retail hub that will become a landmark location, and reawaken Sydney's second-largest office market for thousands of new jobs

- 40-storey commercial building plus two storeys of building plant above Victoria Cross Station
- Enabling the integration of retail opportunities to enhance North Sydney as a thriving mixed-use hub
- Complementing neighbouring development including existing heritage buildings and nearby buildings currently under construction

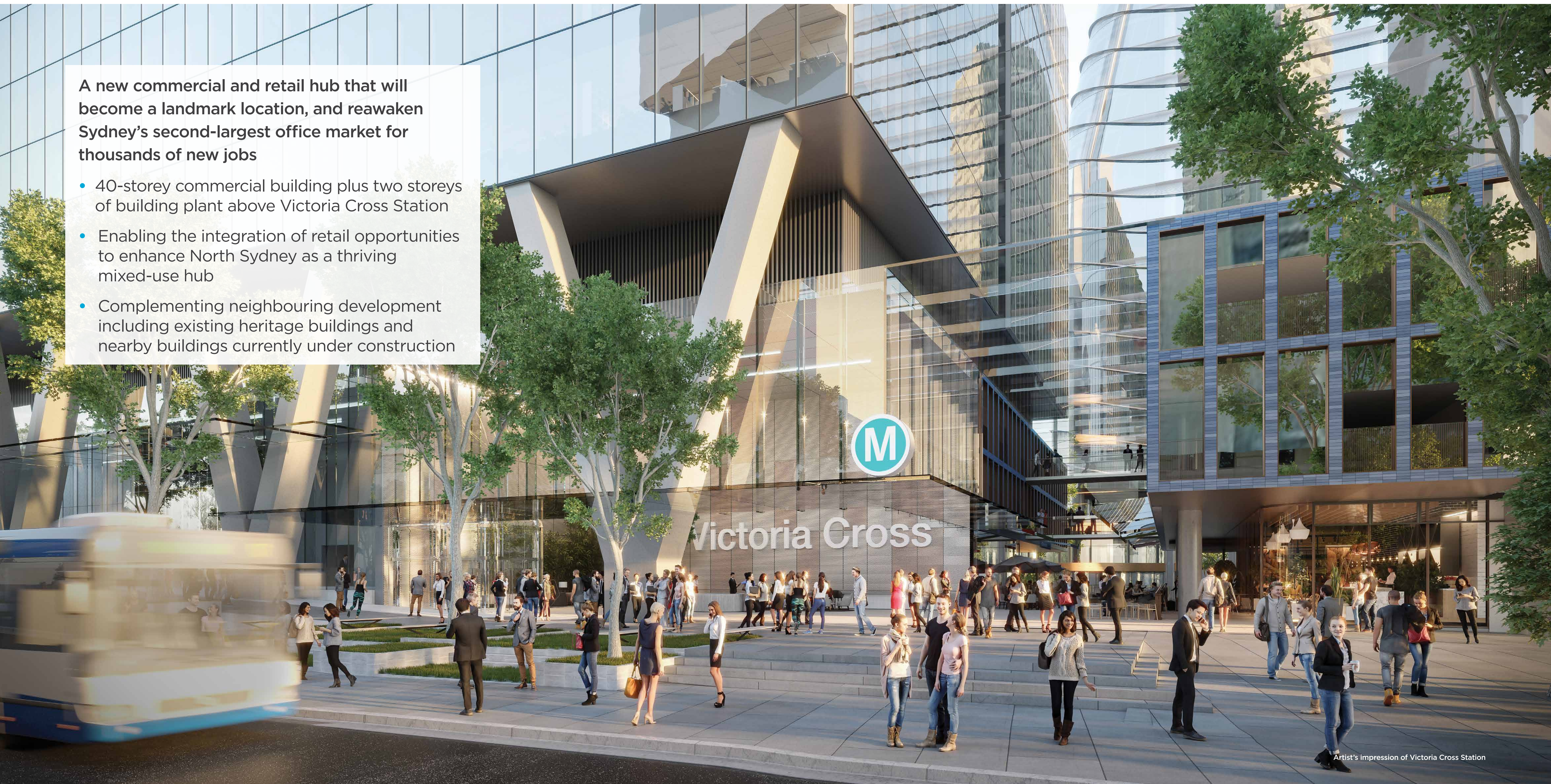

Artist's impression of Victoria Cross Station



# Victoria Cross integrated station development

## Indicative ground floor layout

**KEY**

Approximate Sydney Metro Station Development

Approximate Over Station Development (OSD)

Site boundary

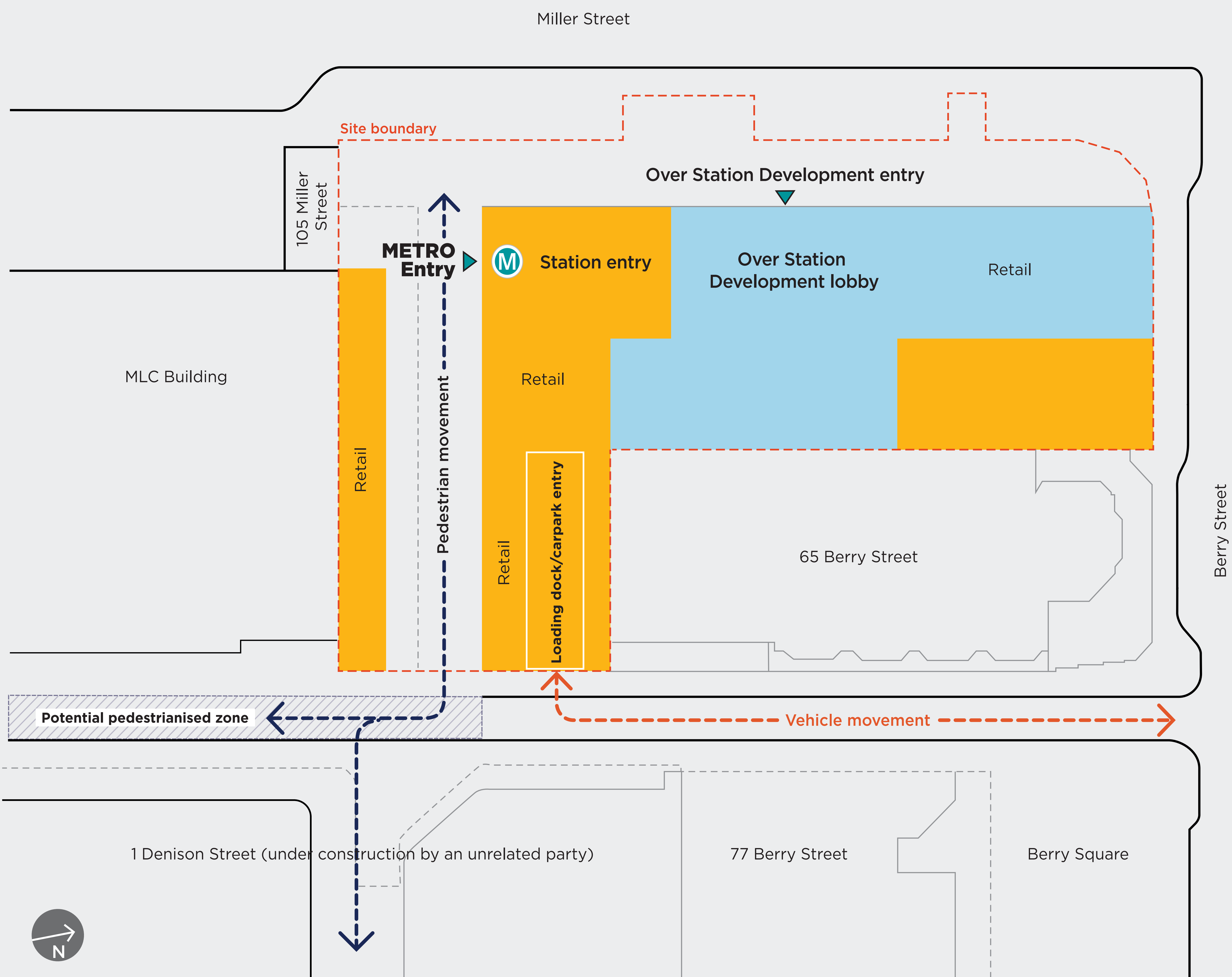



# Victoria Cross Environmental Impact Statement

The Victoria Cross over station development Environmental Impact Statement contains information about the proposed building above the new Sydney Metro station in North Sydney, as well as an assessment of possible environmental impacts.



## The building

The proposed building fits within the context of the local area now and into the future and will allow for a future building which is compatible with the scale of surrounding development.

The proposed building has been designed to minimise overshadowing of parks, public spaces and residential areas outside the North Sydney CBD. It will be set back 18 metres from the neighbouring heritage-listed MLC Building.



## Views

The proposed development at Victoria Cross Station is for a landmark building that has been designed to minimise loss of views for neighbouring buildings. The design elements of the building work to preserve partial views to Sydney Harbour that might otherwise be lost with an alternative design.

When looking at the building from Sydney Harbour it will blend with the North Sydney CBD, fitting into the skyline of existing buildings and new developments currently under construction including the new Channel Nine building on Denison Street.



## Overshadowing

Overshadowing is where a building casts a shadow onto a public or private space or dwelling. Overshadowing can vary significantly by the time of year and time of day.

The building concept has been designed to minimise overshadowing and improve access to sunlight to the public space in Miller Street during winter.

There will be minor overshadowing to the public space referred to as the Miller Street Special Area in the North Sydney Local Environmental Plan. This overshadowing will be less than that caused by the buildings that were previously on the site, prior to the start of Sydney Metro construction.



# Victoria Cross Environmental Impact Statement



## Traffic impacts

It is predicted that the Victoria Cross integrated station development would result in a net increase of 33 car and service vehicle trips per hour during the morning peak (the busiest period). The new development is planned to have 47 less parking spaces than the previous building on the site.



## Economic benefits

The proposal would boost North Sydney's economic potential by providing 60,000 square metres of commercial space for office and retail uses in Sydney's second-largest office market. The proposed commercial floor space has the potential to accommodate approximately 4,200 jobs.



## Mitigation measures

Mitigation measures have been proposed for managing the impacts for each stage of future design development and construction.

These mitigation measures include:

- adhering to the principles outlined in the design excellence strategy, including a design that demonstrates quality and best practice against international standards
- seeking ways to modify the building shape to minimise view impacts to nearby residential properties
- minimising overshadowing to nearby residential properties
- measures to ensure the building does not detract from views to heritage buildings
- measures to minimise noise and vibration once the building is in operation including reducing noise at the loading dock and any acoustic treatment required for plant and equipment.

Mitigation measures to manage construction and cumulative impacts like noise and vibration and traffic, parking and access will be addressed by developing Construction Environmental Management Plans.



# The planning process

The concept State Significant Development application is the next stage in the planning process. This stage of the approval process includes an assessment of the building envelope and potential environmental impacts including to assess the height and possible impacts to neighbouring land.

The next stage is to refine and develop the design, including the final architecture for the building. This is called a detailed State Significant Development application. Following a competitive tender process, Sydney Metro will select a contractor to build the development. This contractor will prepare and submit the detailed State Significant Development application.





# Have your say

Government agencies, project stakeholders and the community may make a submission on the proposal to the NSW Department of Planning and Environment.

At the end of the exhibition, the Department will collate submissions and publish them on its website.

If you do not want your name made available to Transport for NSW, or on the Department's website, please clearly state this in your submission.

**Your submission must reach the NSW Department of Planning and Environment by Wednesday 22 June 2018 and must include:**

1. Your name and address
2. The name of your application
3. The application number **SSD\_8874**
4. A brief statement on whether you support or object to the proposal
5. The reasons why you support or object to the proposal.

Your submission should be marked **Attention: Director, Key Sites Assessments** and can be sent via:

**Website:**

**[www.majorprojects.planning.nsw.gov.au](http://www.majorprojects.planning.nsw.gov.au)**  
and follow the 'on exhibition' links

**Post to:**

**Director, Key Sites Assessments  
Department of Planning and Environment  
GPO Box 39, SYDNEY, NSW 2001**





# Contact us

## Keeping in touch

For more information visit our website  
sydneymetro.info or contact us via



**1800 171 386** 24-hour community  
information line



**sydneymetro@transport.nsw.gov.au**



Sydney Metro, PO Box K659,  
Haymarket, NSW 1240

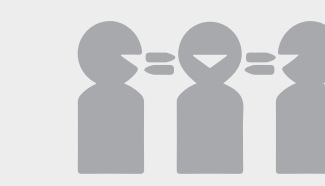

## Translating and Interpreting Service

If you require the services of an interpreter, please contact the **Translating and Interpreting Service on 131 450** and ask them to call **Sydney Metro on 1800 171 386**. The interpreter will then assist you with translation.

আপনার, একজন দোভাষীর (ইন্টারপ্রেটার) সেবা-সাহায্য আবশ্যক হলে, অনুগ্রহ করে **১৩১ ৪৫০ নং এ ট্রান্সলেটিং এন্ড ইন্টারপ্রেটিং সার্ভিস** এর সাথে যোগাযোগ করুন, এবং **১৮০০ ১৭১ ৩৮৬ নং এ সিডনী মেট্রো** কে কল করতে তাদের বলুন। তখন অনুবাদ/ ভাষান্তরে, দোভাষী আপনাকে সাহায্য করবে।

如果您需要翻译服务, 请致电131 450 翻译和口译服务, 让他们打1800 171 386 给悉尼地铁, 翻译员然后将帮助您进行翻译。

Εάν χρειάζεστε τις υπηρεσίες διερμηνείας, παρακαλείστε να επικοινωνήσετε με την **Υπηρεσία Μεταφραστών και Διερμηνέων** στο **131 450** και ζητήστε τους να καλέσουν το **Sydney Metro** στο **1800 171 386**. Ο διερμηνέας θα σας βοηθήσει στη μετάφραση.

통역서비스가 필요하시면, 번역 및 통역 서비스 (Translating and Interpreting Service) 전화 **Translating and Interpreting Service on 131 450** 에 연락하시어 **Sydney Metro 전화 1800 171 386** 에 연결해달라고 요청하십시오. 통역관이 통역을 도와 드릴 것입니다.

إذا كنتم بحاجة إلى خدمات مترجم، يرجى الاتصال بخدمة الترجمة الكتابية والشفهية على الرقم **131 450** واطلبوا منهم الاتصال بمفترو سيدني على الرقم **1800 171 386**. وبعد ذلك سيقوم المترجم بمساعدتكم في الترجمة.

Nếu quý vị cần dịch vụ thông dịch viên, xin liên lạc **Dịch vụ Thông Phiên Dịch (Translating and Interpreting)** ở số **131 450** và yêu cầu gọi Sydney Metro ở số **1800 171 386**. Sẽ có thông dịch viên giúp cho quý vị việc thông dịch.

यदि आपको दुभाषिए की सेवाओं की जरूरत है, तो कृपया अनुवाद एवं दुभाषिया सेवा (**Translating and Interpreting Service**) में **131 450** पर संपर्क करें और उन्हें सिडनी मेट्रो **1800 171 386** पर कॉल करने का निवेदन करें। फिर दुभाषिया अनुवाद में आपकी मदद करेगा।

Artist's impression of Victoria Cross Station



**sydneymetro.info**  
**1800 171 386**