

Updated architectural drawings — building envelope

APPENDIX A

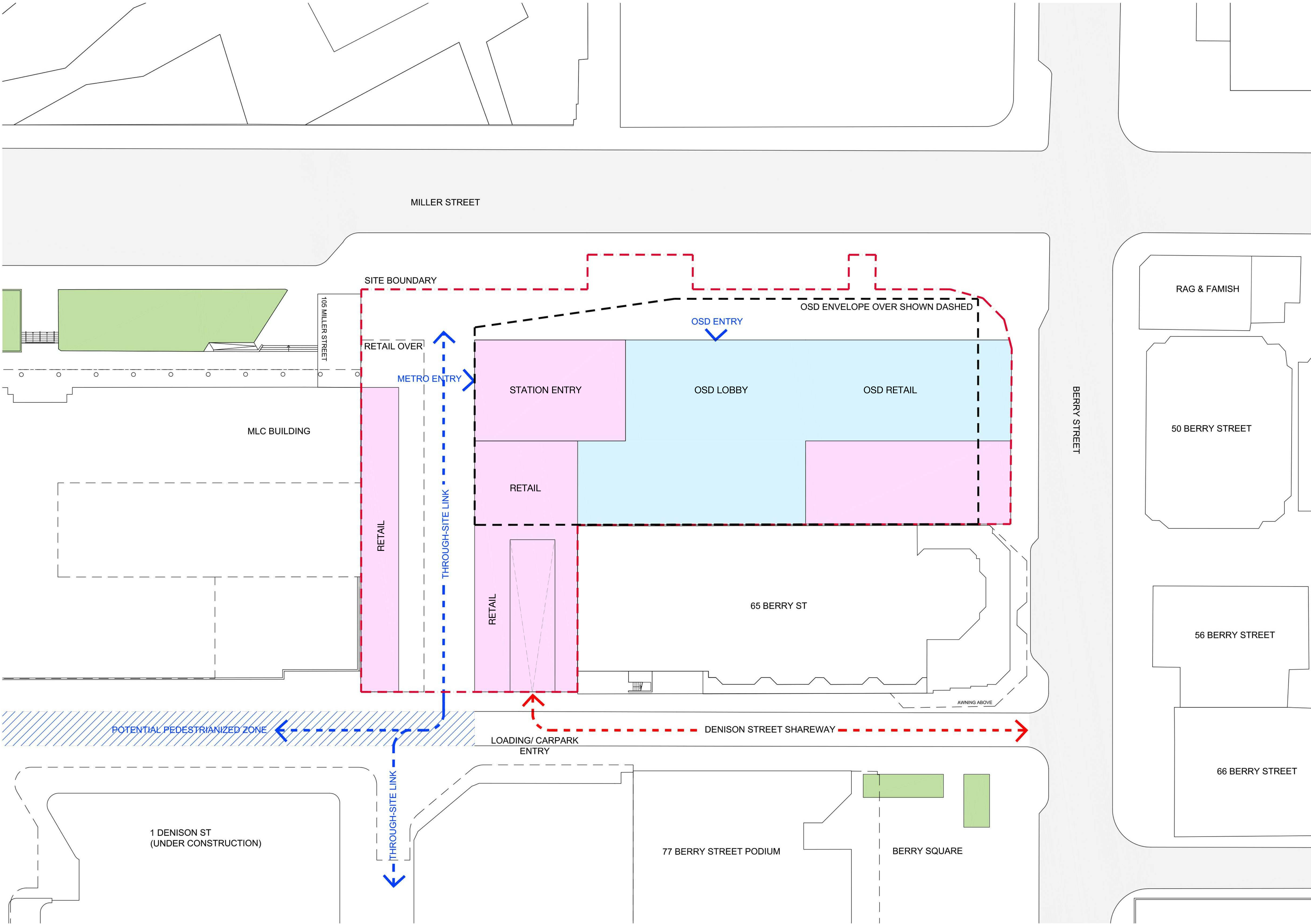

- KEY:
- VICTORIA CROSS STATION CSSI APPROVAL - INCLUDES STRUCTURE AND BUILDING INFRASTRUCTURE AND SPACE FOR LIFT CORES, ACCESS, PARKING, RETAIL AND BUILDING SERVICES FOR THE FUTURE OSD
 - OSD CONCEPT SSDA BUILDING ENVELOPE APPROXIMATE OSD LOBBY LOCATION- INCLUDES RETAIL, CORE AND PLANT
 - PEDESTRIANISED ZONE
 - APPROXIMATE LOCATION OF TOWER ENVELOPE OVER
 - PEDESTRIAN MOVEMENT
 - VEHICULAR MOVEMENT

FOR INFORMATION

Check all dimensions and site conditions prior to commencement of any work, the purchase or ordering of any materials, fittings, plant, services or equipment and the preparation of shop drawings and or the fabrication of any components.

Do not scale drawings - refer to figured dimensions only. Any discrepancies shall immediately be referred to the architect for clarification.

All drawings may not be reproduced or distributed without prior permission from the architect.

3	08.08.18	ISSUE FOR SSDA	TG	TG
2	16.04.18	ISSUE FOR SSDA	TG	FJM
1	22.02.18	ISSUE FOR SSDA	GH	GH
Revision	Date	Description	Initial	Checked

TFNSW
Victoria Cross OSD

Building Envelope
Indicative Ground Floor
Plan



Scale	Not to scale	@ A0
Drawn	Author	Checked
Project no.	S12041	
Status	Project Status	
Plot Date	11/09/2018 5:34:25 PM	
Plot File		
Drawing no.	A01.001	Revision
		3

Melbourne 1 Nicholson Street
Melbourne VIC 3000 Australia
T 03 8664 6200 F 03 8664 6300
email mel@batesmart.com.au
http://www.batesmart.com.au

Sydney 43 Brisbane Street
Surry Hills NSW 2010 Australia
T 02 8354 5100 F 02 8354 5199
email syd@batesmart.com.au
http://www.batesmart.com.au

Bates Smart Pty Ltd ABN 70 004 999 400

BATESSMART

KEY:

--- MAXIMUM BUILDING HEIGHT
NORTH SYDNEY CENTRE
PLANNING PROPOSAL (AS
AMENDED BY COUNCIL
RESOLUTION 19TH MARCH
2018)

--- MAXIMUM BUILDING
HEIGHT NORHT SYDNEY
LEP 2013

VICTORIA CROSS STATION
CSSI APPROVAL - INCLUDES
STRUCTURE AND BUILDING
INFRASTRUCTURE AND
SPACE FOR LIFT CORES,
ACCESS, PARKING, RETAIL
AND BUILDING SERVICES
FOR THE FUTURE OSD

OSD CONCEPT SSDA
BUILDING ENVELOPE
INCLUDES OSD AREAS
INSIDE THE CSSI 'SHELL'
BELOW GROUND AND IN
THE PODIUM LEVELS

ARTICULATION ZONE -
4.5M WIDE

CHAMFERED ARTICULATION ZONE -
4.5M - 0M WIDE

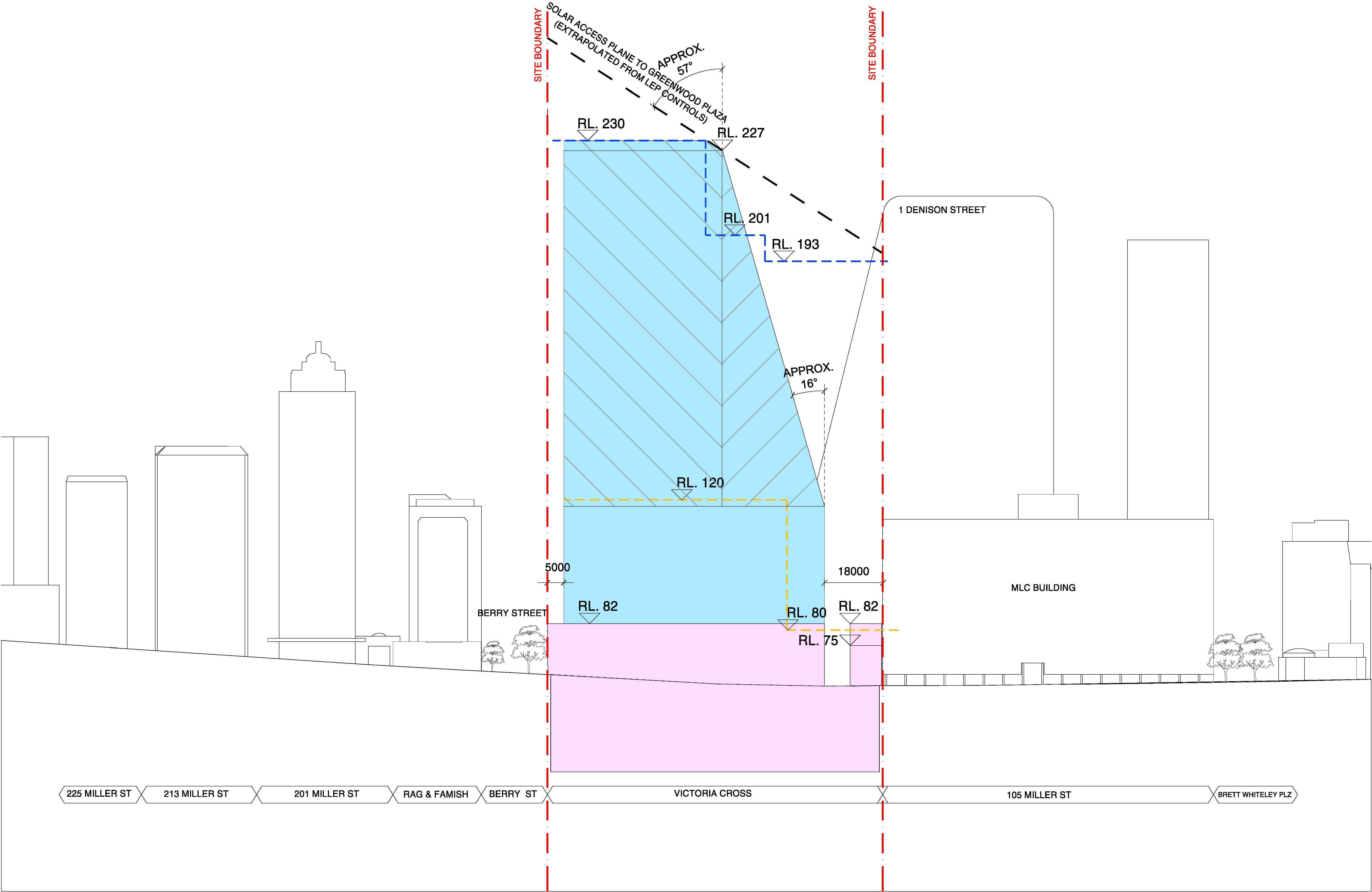

FOR INFORMATION

Check all dimensions and site conditions prior to commencement of any work, the purchase or ordering of any materials, fittings, plant, services or equipment and the preparation of shop drawings and or the fabrication of any components.

Do not scale drawings - refer to figured dimensions only. Any discrepancies shall immediately be referred to the architect for clarification.

All drawings may not be reproduced or distributed without prior permission from the architect.

3	08.08.18	ISSUE FOR SSDA	TG	TG
2	16.04.18	ISSUE FOR SSDA	TG	FJM
1	22.02.18	ISSUE FOR SSDA	GH	GH
Revision	Date	Description	Initial	Checked

TFNSW
Victoria Cross OSD

Building Envelope
Miller Street Elevation

Scale	Not to scale	@ A0
Drawn	Author	Checked
Project no.	S12041	
Status	Project Status	
Plot Date	11/09/2018 5:34:36 PM	
Plot File		

Drawing no.
A01.002

Revision
3

Melbourne 1 Nicholson Street
Melbourne VIC 3000 Australia
T 03 8664 6200 F 03 8664 6300
email mel@batesmart.com.au
http://www.batesmart.com.au

Bates Smart Pty Ltd ABN 70 004 999 400

Sydney 43 Brisbane Street
Surry Hills NSW 2010 Australia
T 02 8354 5100 F 02 8354 5199
email syd@batesmart.com.au
http://www.batesmart.com.au

BATESSMART

KEY:

--- MAXIMUM BUILDING HEIGHT
NORTH SYDNEY CENTRE
PLANNING PROPOSAL (AS
AMENDED BY COUNCIL
RESOLUTION 19TH MARCH
2018)

--- MAXIMUM BUILDING
HEIGHT NORHT SYDNEY
LEP 2013

VICTORIA CROSS STATION
CSSI APPROVAL - INCLUDES
STRUCTURE AND BUILDING
INFRASTRUCTURE AND
SPACE FOR LIFT CORES,
ACCESS, PARKING, RETAIL
AND BUILDING SERVICES
FOR THE FUTURE OSD

OSD CONCEPT SSDA
BUILDING ENVELOPE
INCLUDES OSD AREAS
INSIDE THE CSSI 'SHELL'
BELOW GROUND AND IN
THE PODIUM LEVELS

ARTICULATION ZONE -
4.5M WIDE

CHAMFERED ARTICULATION ZONE -
4.5M - 0M WIDE

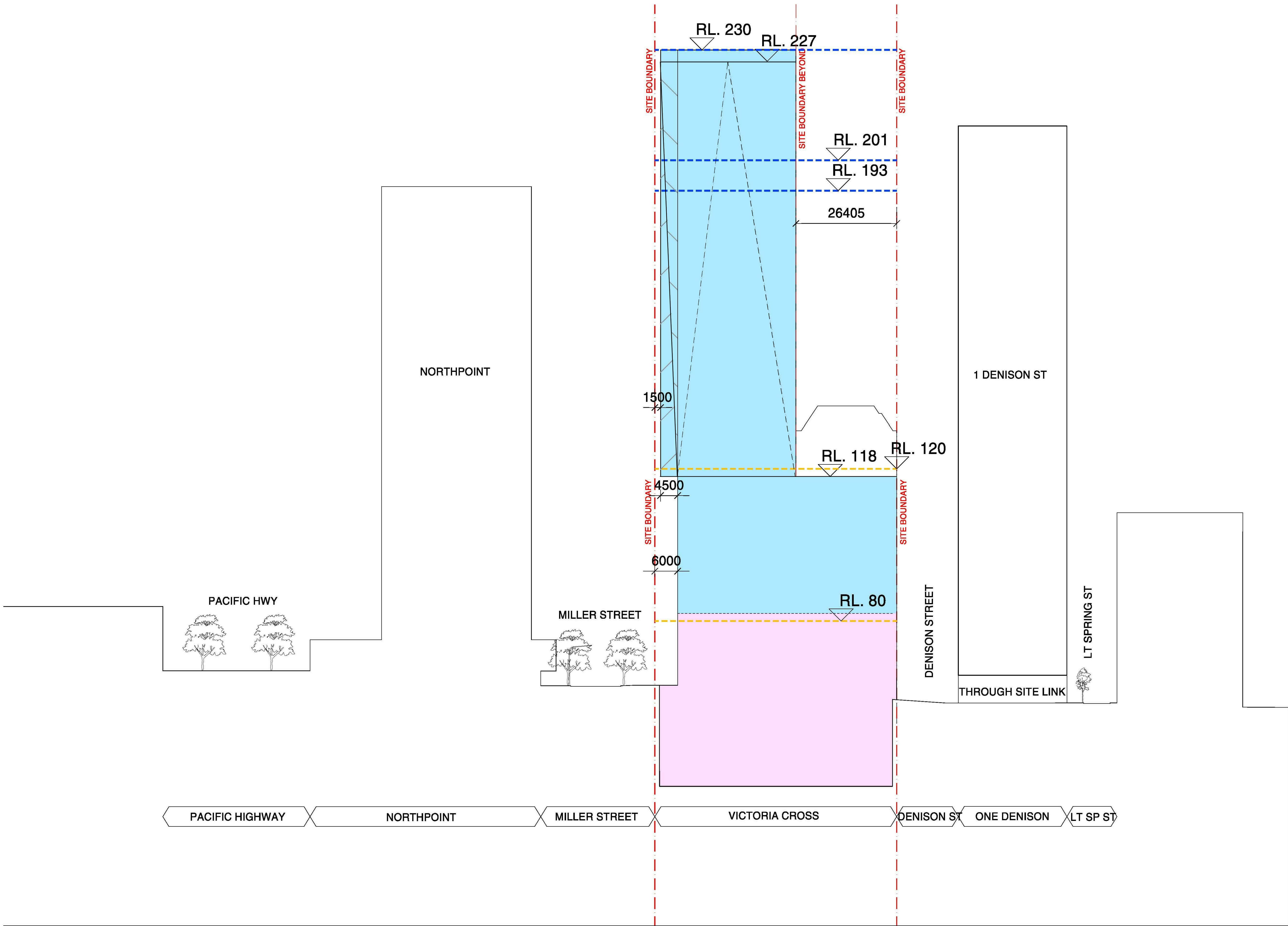

FOR INFORMATION

Check all dimensions and site conditions prior to commencement of any work, the purchase or ordering of any materials, fittings, plant, services or equipment and the preparation of shop drawings and or the fabrication of any components.

Do not scale drawings - refer to figured dimensions only. Any discrepancies shall immediately be referred to the architect for clarification.

All drawings may not be reproduced or distributed without prior permission from the architect.

3	08.08.18	ISSUE FOR SSDA	TG	TG
2	16.04.18	ISSUE FOR SSDA	TG	FJM
1	22.02.18	ISSUE FOR SSDA	GH	GH
Revision	Date	Description	Initial	Checked

TFNSW
Victoria Cross OSD

Building Envelope
East West Section

Scale	Not to scale	@ A0
Drawn	Author	Checked
Project no.	S12041	
Status	Project Status	
Plot Date	11/09/2018 5:34:43 PM	
Plot File		
Drawing no.	A01.003	Revision
		3

Melbourne 1 Nicholson Street
Melbourne VIC 3000 Australia
T 03 8664 6200 F 03 8664 6300
email mel@batesmart.com.au
http://www.batesmart.com.au

Sydney 43 Brisbane Street
Surry Hills NSW 2010 Australia
T 02 8354 5100 F 02 8354 5199
email syd@batesmart.com.au
http://www.batesmart.com.au

Bates Smart Pty Ltd ABN 70 004 999 400

BATESSMART

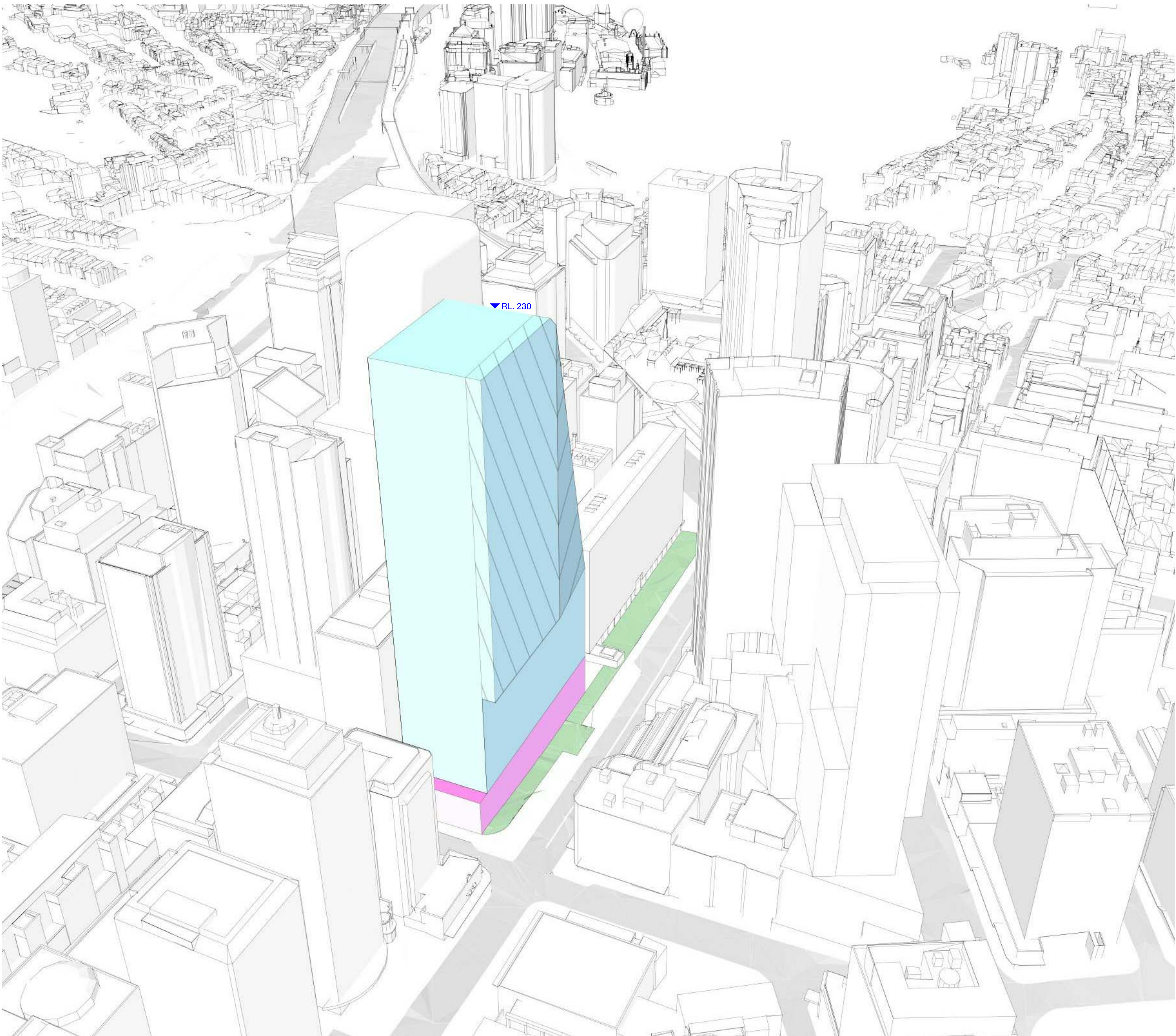

KEY:

- VICTORIA CROSS STATION
CSSI APPROVAL - INCLUDES
STRUCTURE AND BUILDING
INFRASTRUCTURE AND
SPACE FOR LIFT CORES,
ACCESS, PARKING, RETAIL
AND BUILDING SERVICES
FOR THE FUTURE OSD
- OSD CONCEPT SSDA
BUILDING ENVELOPE
INCLUDES OSD AREAS
INSIDE THE CSSI 'SHELL'
BELOW GROUND AND IN
THE PODIUM LEVELS
- ARTICULATION ZONE -
4.5M WIDE
- CHAMFERED ARTICULATION ZONE -
4.5M - 0M WIDE

FOR INFORMATION

Check all dimensions and site conditions prior to commencement of any work, the purchase or ordering of any materials, fittings, plant, services or equipment and the preparation of shop drawings and or the fabrication of any components.

Do not scale drawings - refer to figured dimensions only. Any discrepancies shall immediately be referred to the architect for clarification.

All drawings may not be reproduced or distributed without prior permission from the architect.

3	08.08.18	ISSUE FOR SSDA	TG	TG
2	16.04.18	ISSUE FOR SSDA	TG	FJM
1	22.02.18	ISSUE FOR SSDA	GH	GH
Revision Date		Description	Initial	Checked

TFNSW
Victoria Cross OSD

Building Envelope
North West Axonometric

Scale	Not to scale	@ A0
Drawn	Author	Checked
Project no.	S12041	
Status	Project Status	
Plot Date	11/09/2018 5:34:45 PM	
Plot File		
Drawing no.	Revision	
A01.004	3	

Melbourne 1 Nicholson Street
Melbourne VIC 3000 Australia
T 03 8664 6200 F 03 8664 6300
email mel@batesmart.com.au
http://www.batesmart.com.au



Sydney 43 Brisbane Street
Surry Hills NSW 2010 Australia
T 02 8354 5100 F 02 8354 5199
email syd@batesmart.com.au
http://www.batesmart.com.au

Bates Smart Pty Ltd ABN 70 004 999 400

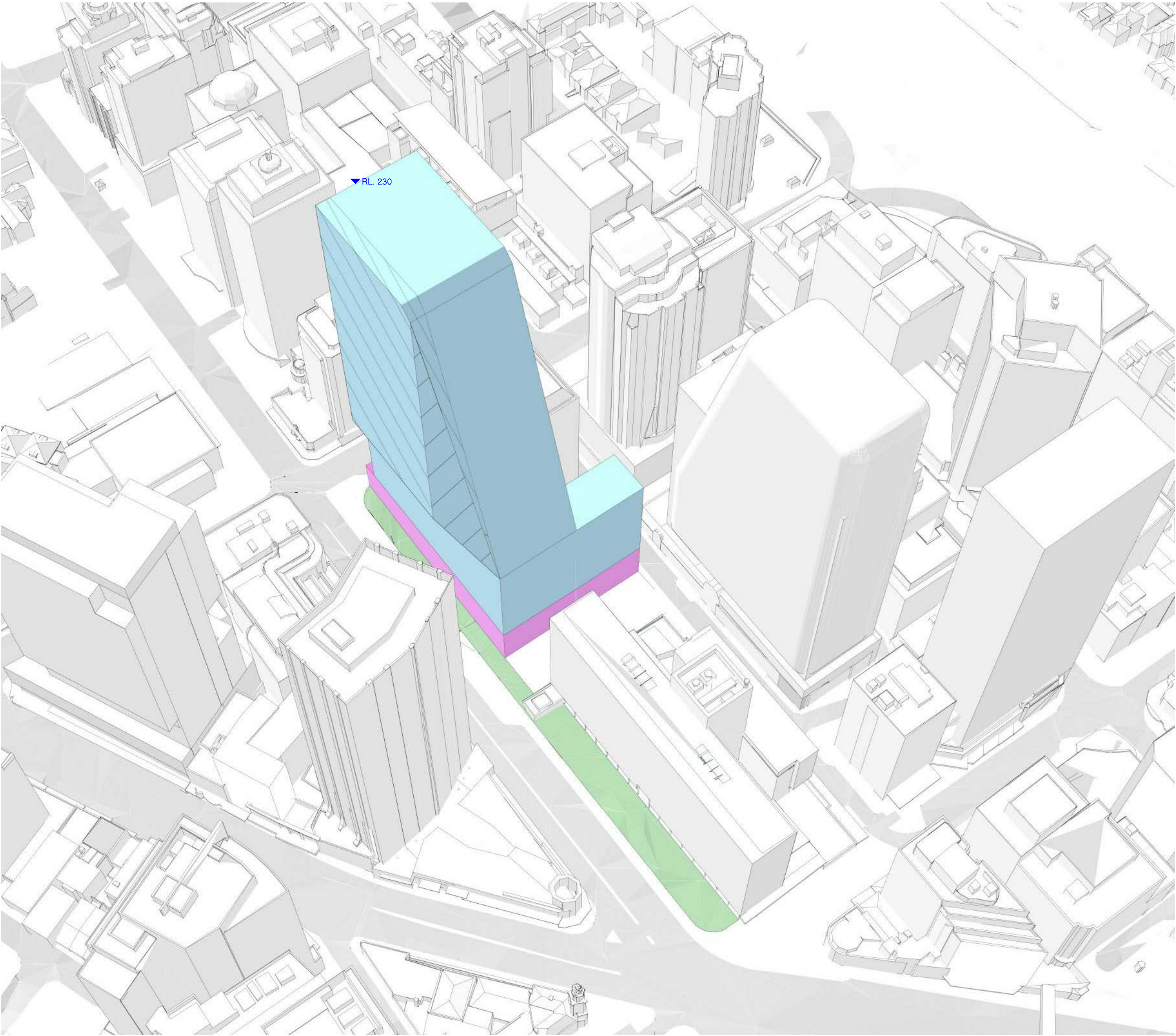
BATESSMART

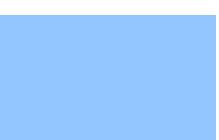

KEY:

-  VICTORIA CROSS STATION
CSSI APPROVAL - INCLUDES
STRUCTURE AND BUILDING
INFRASTRUCTURE AND
SPACE FOR LIFT CORES,
ACCESS, PARKING, RETAIL
AND BUILDING SERVICES
FOR THE FUTURE OSD
-  OSD CONCEPT SSDA
BUILDING ENVELOPE
INCLUDES OSD AREAS
INSIDE THE CSSI 'SHELL'
BELOW GROUND AND IN
THE PODIUM LEVELS
-  ARTICULATION ZONE -
4.5M WIDE
-  CHAMFERED ARTICULATION ZONE -
4.5M - 0M WIDE

FOR INFORMATION

Check all dimensions and site conditions prior to commencement of any work, the purchase or ordering of any materials, fittings, plant, services or equipment and the preparation of shop drawings and or the fabrication of any components.

Do not scale drawings - refer to figured dimensions only. Any discrepancies shall immediately be referred to the architect for clarification.

All drawings may not be reproduced or distributed without prior permission from the architect.

3	08.08.18	ISSUE FOR SSDA	TG	TG
2	16.04.18	ISSUE FOR SSDA	TG	FJM
1	22.02.18	ISSUE FOR SSDA	GH	GH
Revision	Date	Description	Initial	Checked

TFNSW
Victoria Cross OSD

Building Envelope
South West
Axonometric

Scale	Not to scale	@ A0
Drawn	Author	Checked
Project no.	S12041	
Status	Project Status	
Plot Date	11/09/2018 5:34:47 PM	
Plot File		
Drawing no.	Revision	
A01.005	3	

Melbourne 1 Nicholson Street
Melbourne VIC 3000 Australia
T 03 8664 6200 F 03 8664 6300
email mel@batesmart.com.au
http://www.batesmart.com.au

Sydney 43 Brisbane Street
Surry Hills NSW 2010 Australia
T 02 8354 5100 F 02 8354 5199
email syd@batesmart.com.au
http://www.batesmart.com.au

Bates Smart Pty Ltd ABN 70 004 999 400

BATESSMART