

Setback Study — Miller Street

APPENDIX H

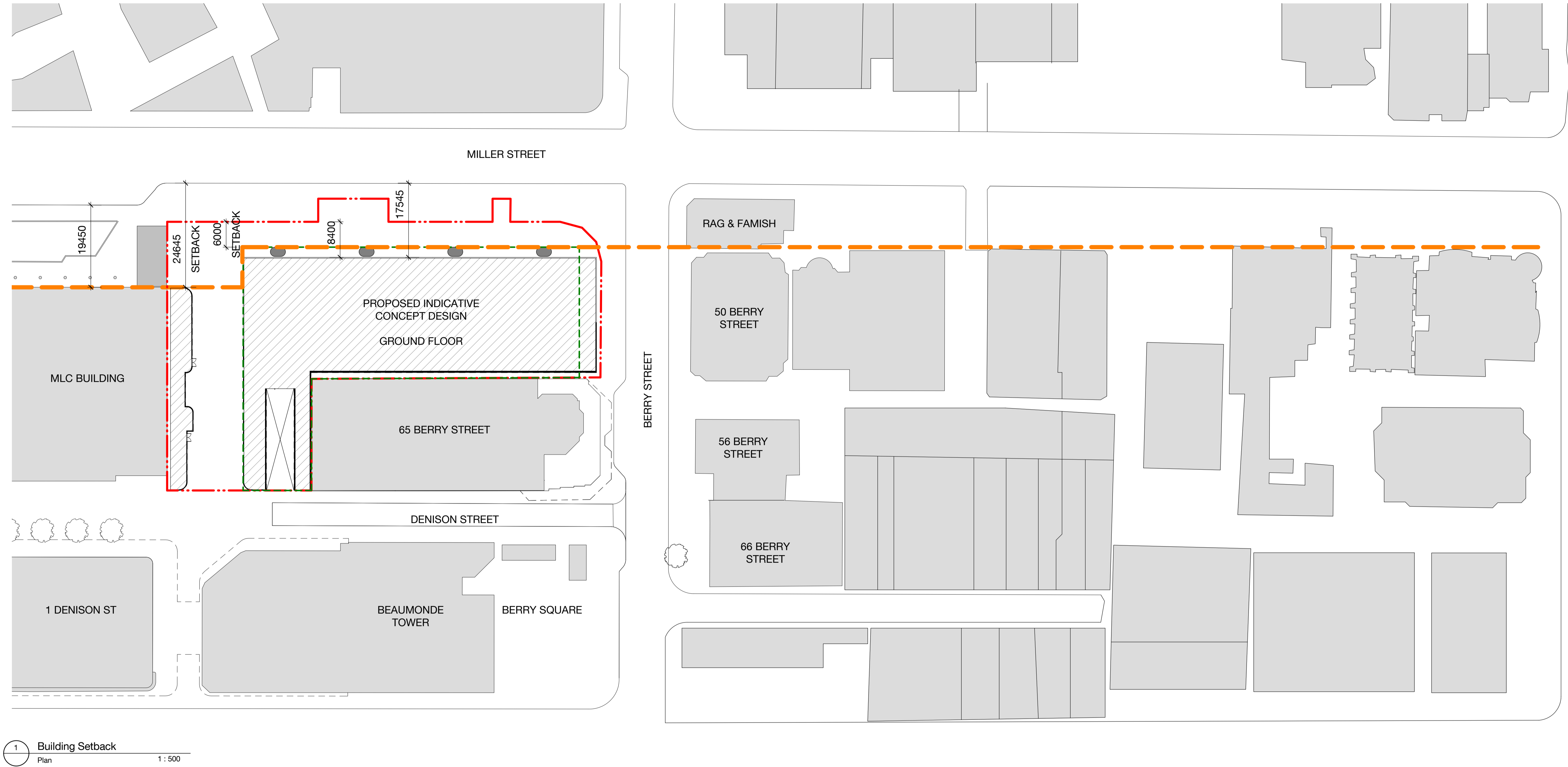

LEGEND	
<div></div>	Site Boundary
<div></div>	Building Alignment
<div></div>	OSD Tower Envelope Alignment over Low-Rise

TFNSW
Victoria Cross OSD

SKETCH
Proposed Building Alignment -
Low-Rise

Check all dimensions and site conditions prior to commencement of any work, the purchase or ordering of any materials, fittings, plant, services or equipment and the preparation of shop drawings and or the fabrication of any components.
Do not scale drawings - refer to figured dimensions only. Any discrepancies shall immediately be referred to the architect for clarification.
All drawings may not be reproduced or distributed without prior permission from the architect.



Scale	1 : 500	@ A1
Drawn	Author	Checked Checker
Project no.	S12041	
Status	Project Status	
Plot Date	7/08/2018 10:26:02 AM	
BIM		
Drawing no.	SK.202	Revision

Melbourne 1 Nicholson Street
Melbourne VIC 3000 Australia
T 03 8664 6200 F 03 8664 6300
email mel@batesmart.com.au
http://www.batesmart.com.au

Sydney 43 Brisbane Street
Surry Hills NSW 2010 Australia
T 02 8354 5100 F 02 8354 5199
email syd@batesmart.com.au
http://www.batesmart.com.au

Bates Smart Pty Ltd ABN 70 004 999 400

BATESSMART

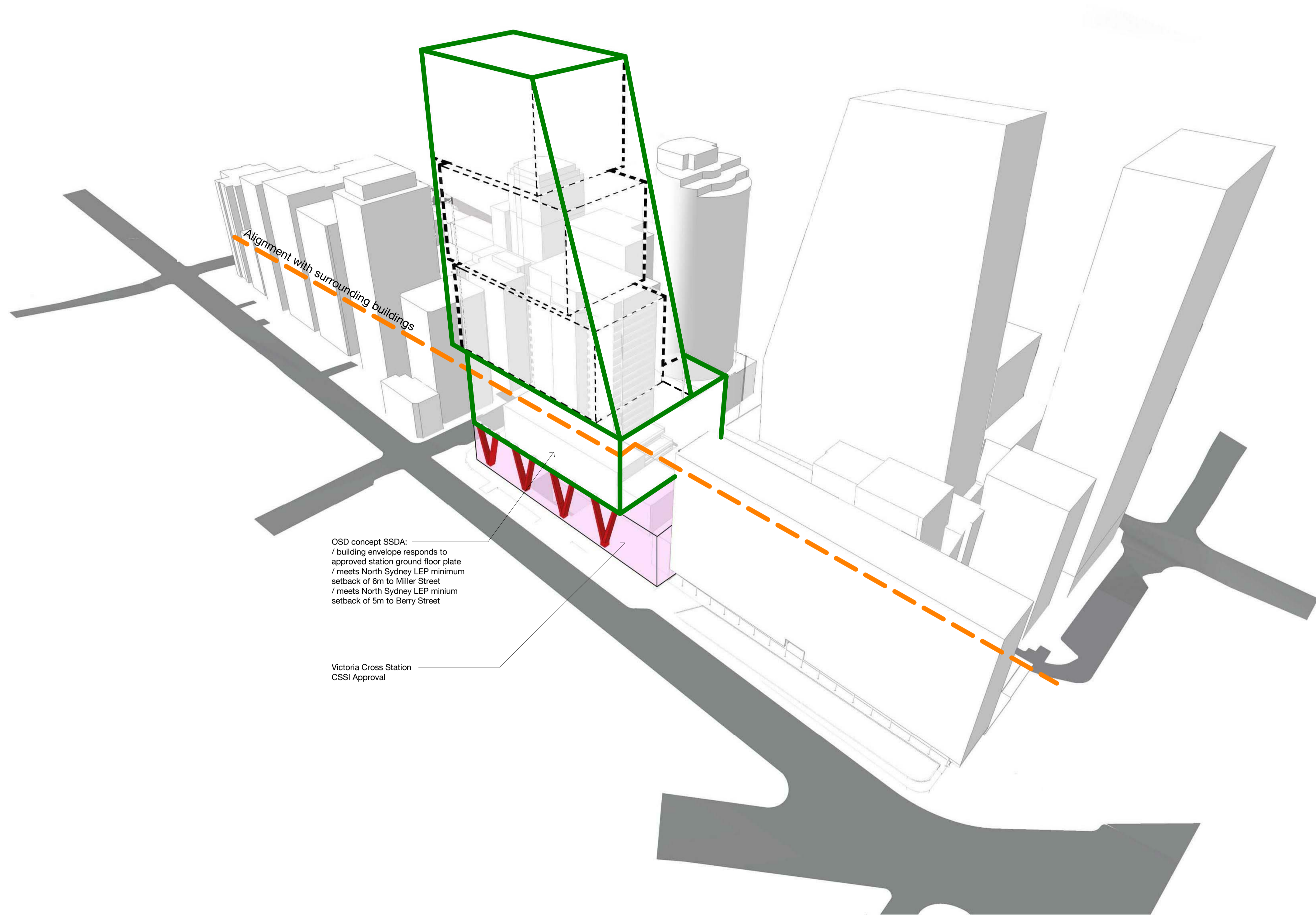

OSD concept SSDA:
/ building envelope responds to
approved station ground floor plate
/ meets North Sydney LEP minimum
setback of 6m to Miller Street
/ meets North Sydney LEP minium
setback of 5m to Berry Street

Victoria Cross Station
CSSI Approval

TFNSW Victoria Cross OSD

SKETCH
Proposed Building Alignment
Perspective

Check all dimensions and site conditions prior to commencement of any work, the purchase or ordering of any materials, fittings, plant, services or equipment and the preparation of shop drawings and or the fabrication of any components.
Do not scale drawings - refer to figured dimensions only. Any discrepancies shall immediately be referred to the architect for clarification.
All drawings may not be reproduced or distributed without prior permission from the architect.



Scale	@ A1		
Drawn	Author	Checked	Checker
Project no.	S12041		
Status	Project Status		
Plot Date	7/08/2018 10:26:04 AM		
BIM			
Drawing no.	Revision		

SK.202a

Melbourne 1 Nicholson Street
Melbourne VIC 3000 Australia
T 03 8664 6200 F 03 8664 6300
email mel@batesmart.com.au
http://www.batesmart.com.au

Sydney 43 Brisbane Street
Surry Hills NSW 2010 Australia
T 02 8354 5100 F 02 8354 5199
email syd@batesmart.com.au
http://www.batesmart.com.au

Bates Smart Pty Ltd ABN 70 004 999 400

BATESSMART