

21st JUNE 0900 EXISTING
1:1000

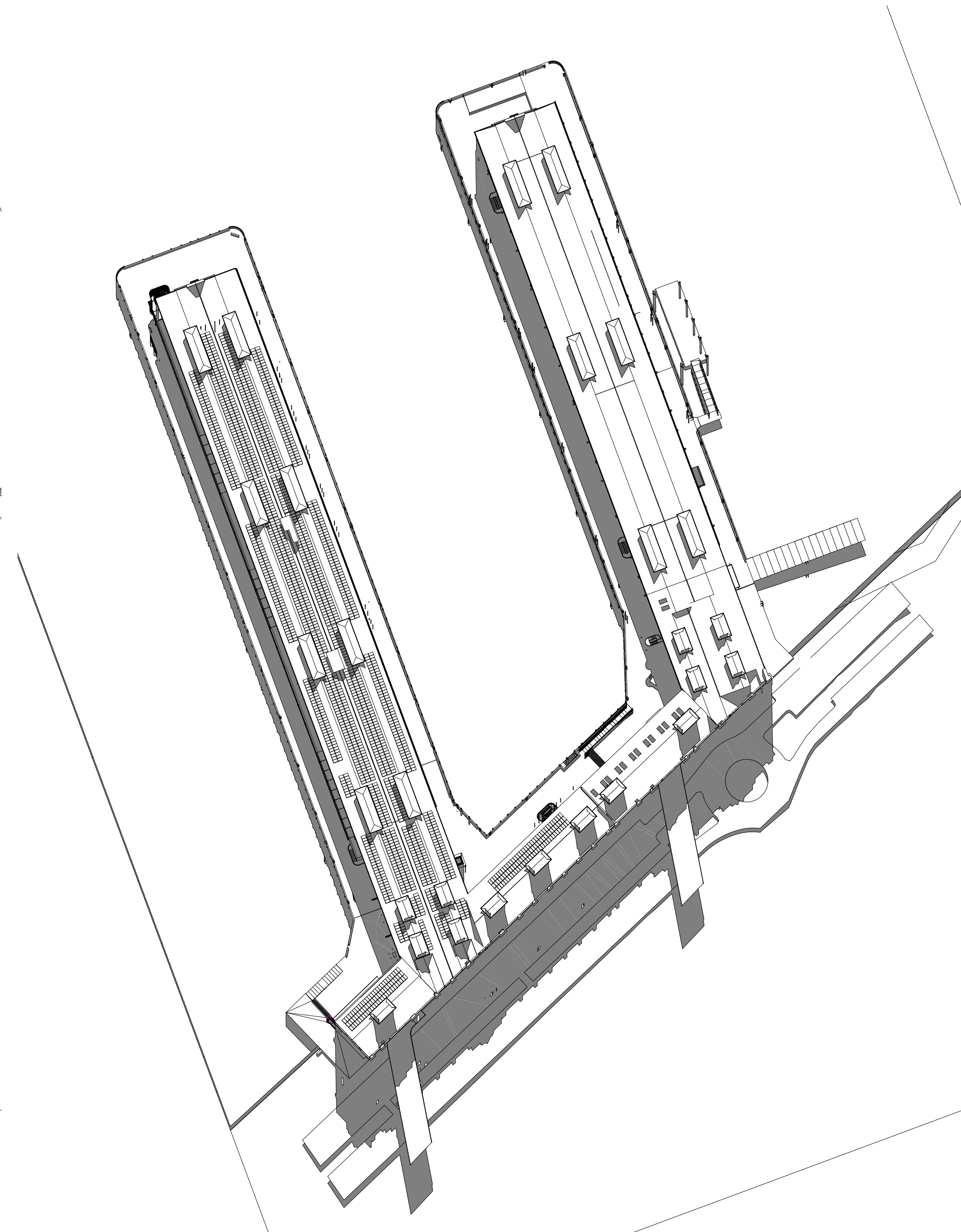

21st JUNE 1200 EXISTING
1:1000

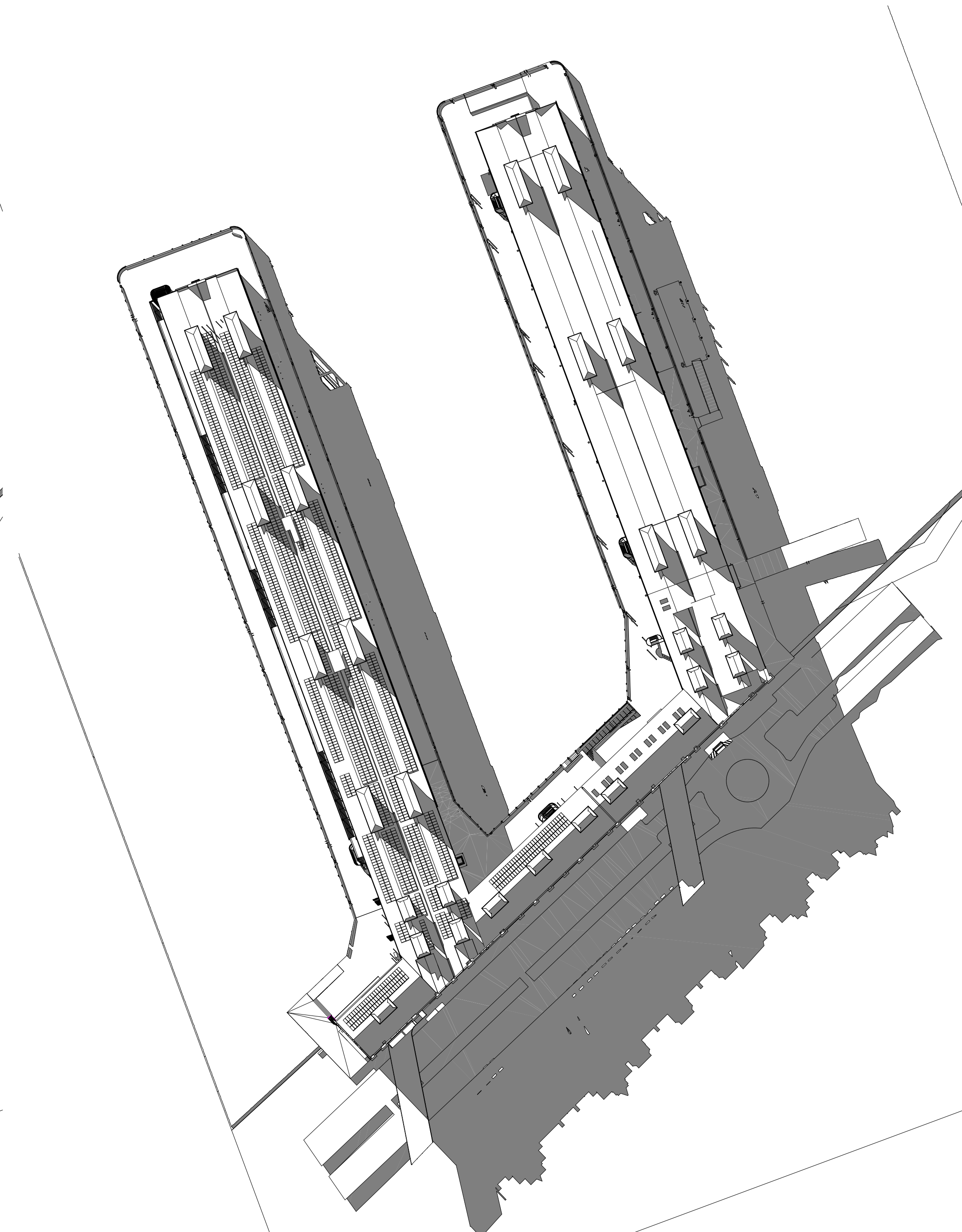

21st JUNE 1500 EXISTING
1:1000

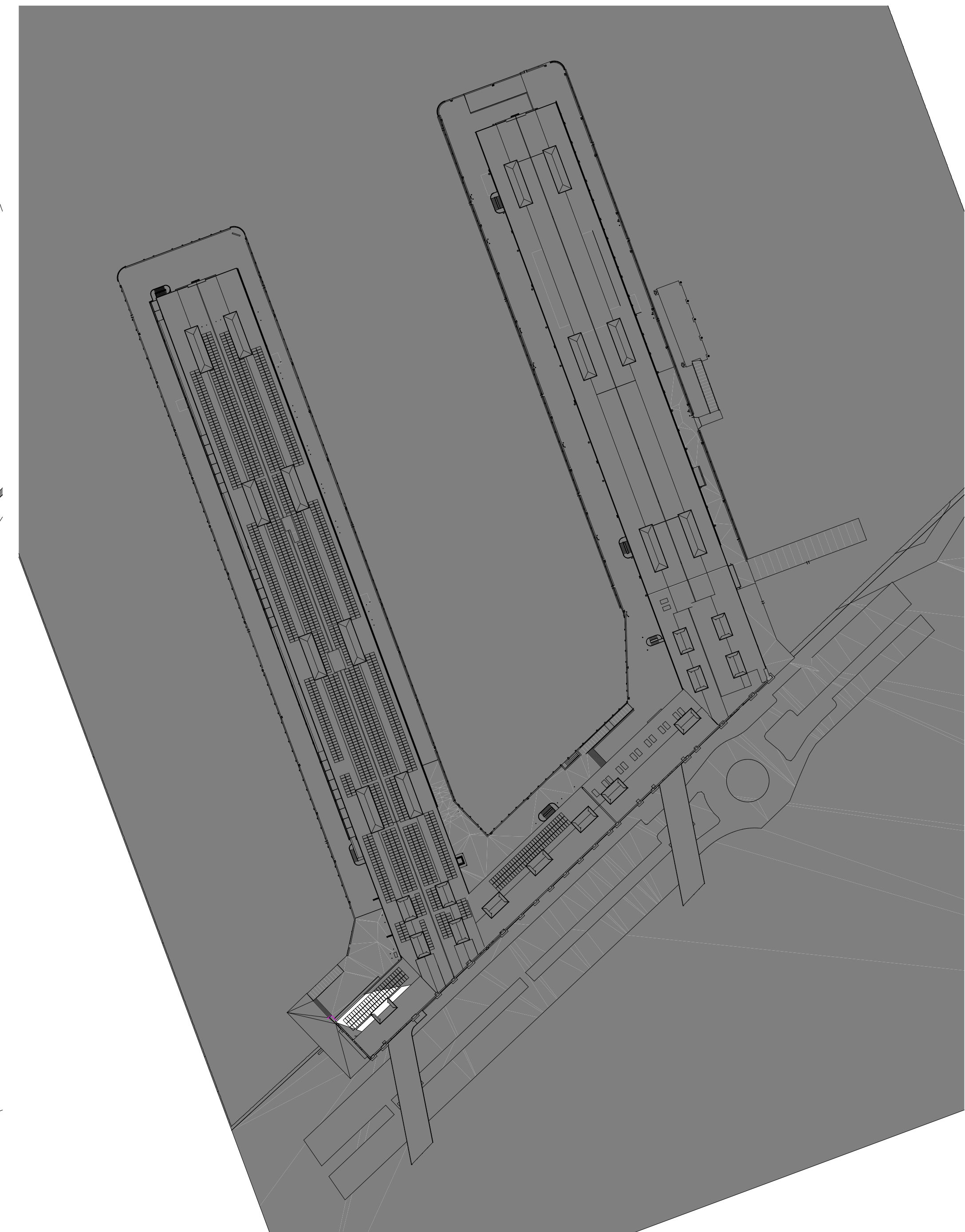

21st JUNE 1800 EXISTING
1:1000

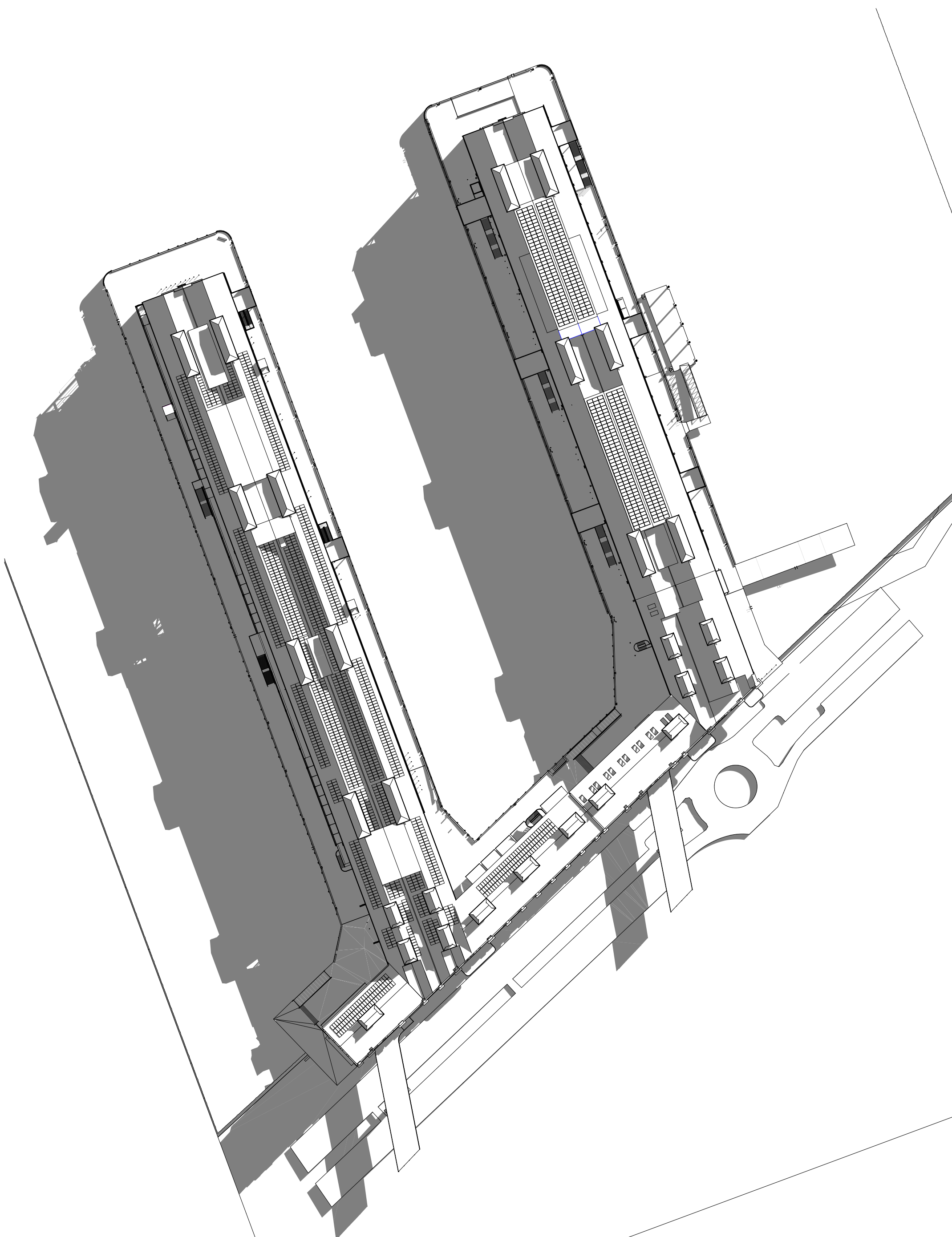

21st JUNE 0900 PROPOSED
1:1000

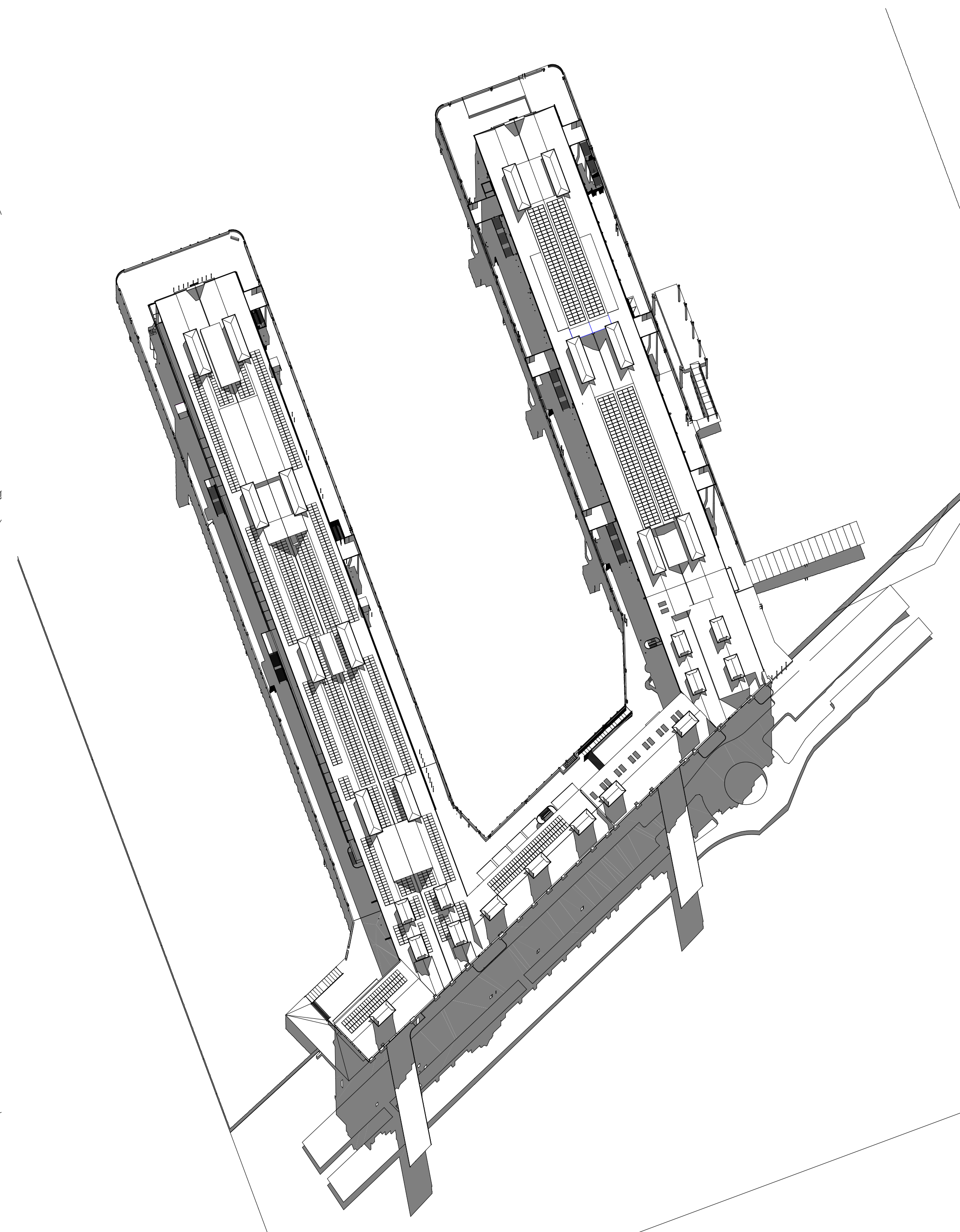

21st JUNE 1200 PROPOSED
1:1000

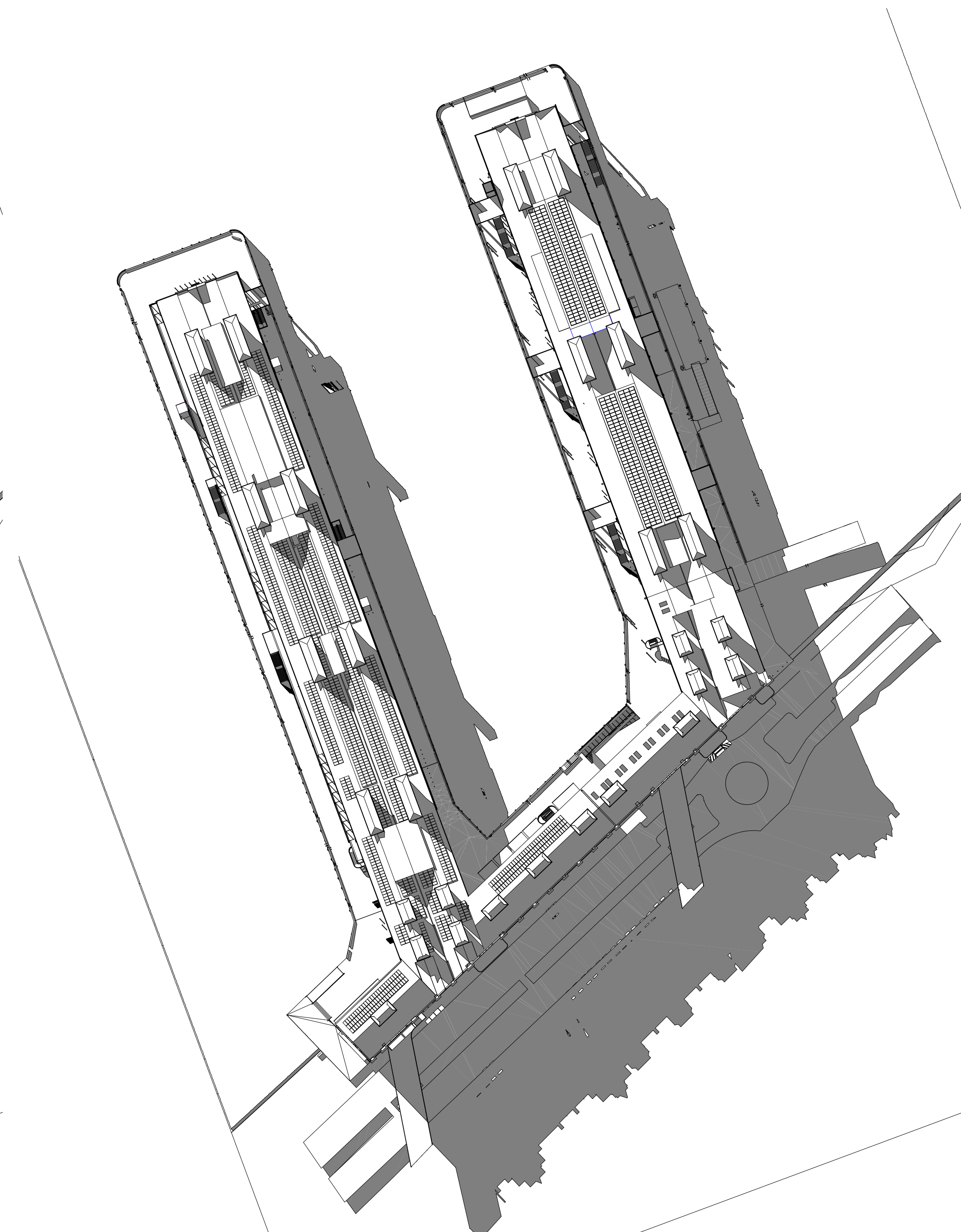

21st JUNE 1500 PROPOSED
1:1000

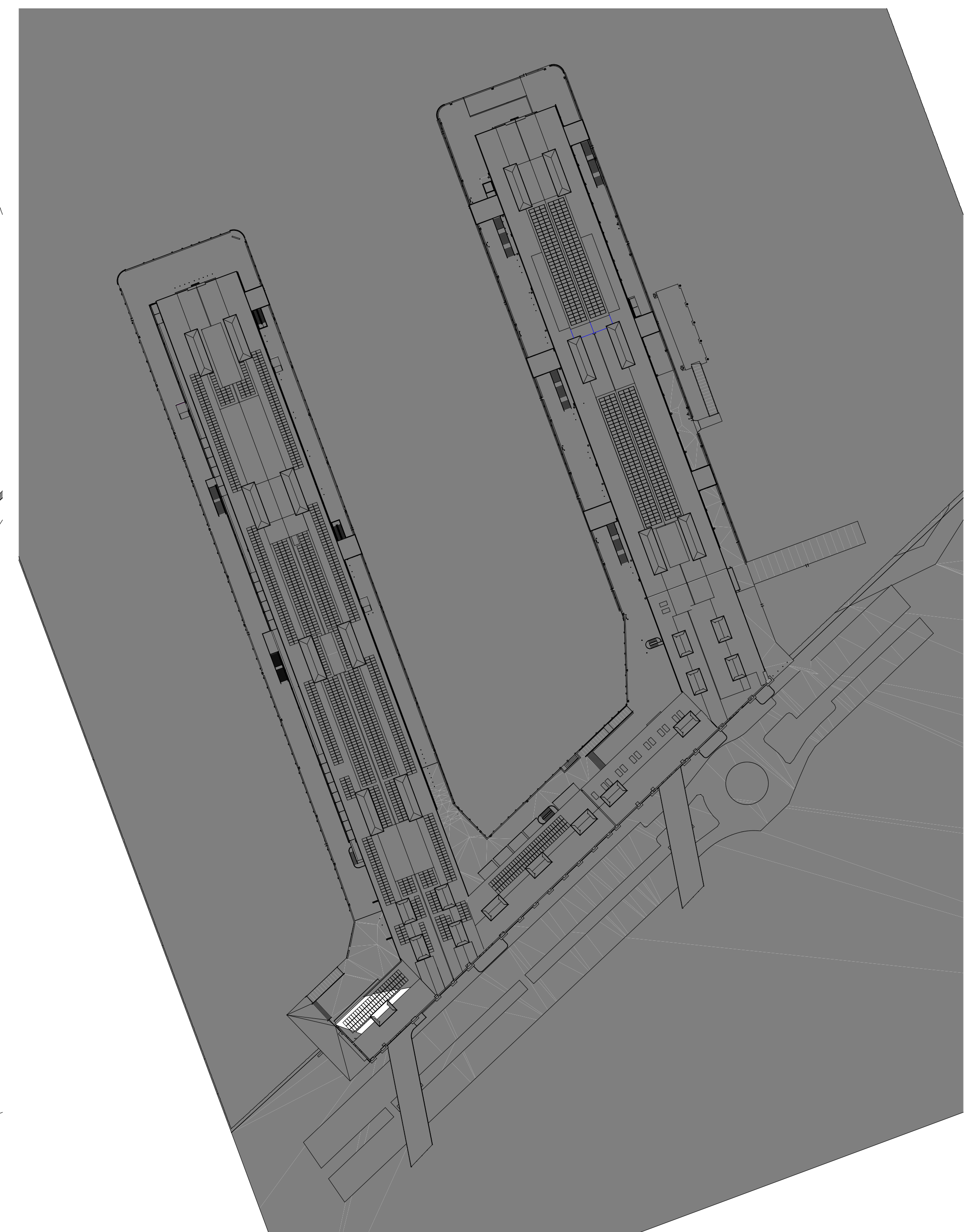

21st JUNE 1800 PROPOSED
1:1000

DATE	REV	NOTES
19/07/17	A	ISSUED FOR SEAR

NOTES:
Do not scale off drawings. Use figure dimensions only. Report any discrepancies to the architect. These designs, plans, specifications and the copyright therein are the property of Tonkin Zulaikha Greer Architects Pty Ltd. and must not be reproduced or copied wholly or in part without written permission of Tonkin Zulaikha Greer Architects Pty Ltd.

ACCESS CONSULTANT
Accessibility Solutions
Phone: 9551 1560
Email: nswa@accessibility.com.au

HERITAGE CONSULTANT
Heritage & Heritage
Phone: 9251 3290
Email: her@heritage.com.au

STATUTORY PLANNER
MGP Planning
Phone: 9179 3115
Email: nswa@mgppanning.com.au

ACOUSTIC ENGINEER
ARUP
Phone: 9200 9208
Email: nswa@arup.com

HYDRAULIC ENGINEER
ARUP
Phone: 9200 9204
Email: nswa@arup.com

THEATRE PLANNER & AV
Anup
Phone: 9200 9218
Email: tom.brock@anup.com

SCA CONSULTANT
Blackett Mirey & Associates
Phone: 9211 7777
Email: nswa@blackettmirey.com.au

LANDSCAPE ARCHITECT
McGregor Gould
Phone: 9577 3553
Email: nswa@mcgregorgould.com.au

PROGRAMME MANAGEMENT
ARUP
Phone: 9200 9208
Email: nswa@arup.com

MECHANICAL ENGINEER
ARUP
Phone: 9200 9602
Email: nswa@arup.com

KITCHEN CONSULTANT
Sangster Design Group
Phone: 9500 1548
Email: john@sangsterdesign.com.au

ELECTRICAL ENGINEER
ARUP
Phone: 9200 9208
Email: nswa@arup.com

ESD CONSULTANT
ARUP
Phone: 9200 9480
Email: nswa@arup.com

WASTE CONSULTANT
ARUP
Phone: 9200 9272
Email: nswa@arup.com

MARINE ECOLOGIST
Jacobs
Phone: 9552 1077
Email: nswa@jacobs.com.au

SPECIALIST LIGHTING ENGINEER
ARUP
Phone: 9200 9272
Email: nswa@arup.com

CONSTRUCTION PROGRAMMING
Golder
Phone: 9557 8866
Email: nswa@golder.com.au

SCENIC + WAYFINDING
Urban & Public
Phone: 9559 7182
Email: simon.king@urbanpublic.com.au

LEGEND
STC50 internal tenancy works
subject of separate SSDA
Not part of scope

SSDA
Existing
To be demolished
New work

CLIENT:
Create NSW
NSW
Create NSW
Arts, Screen & Culture

PROJECT:
WALSH BAY ARTS AND
CULTURAL PRECINCT

ARCHITECT:
TONKIN ZULAKHA GREER ARCHITECTS
117 Reservoir Street
ABN: 4602722349
P: (02) 9215 4500
F: (02) 9215 4901
EMAIL: info@tbg.com.au
WEB: www.tbg.com.au

DRAWING TITLE:
SHADOW DIAGRAM WINTER
SOLSTICE

DRAWN BY:
JMU/HGM/KUSB
HGM/ABND/TBS
CHECKED PT
DATE 25/9/17
DRAWING NO A-402
REV A