

- LEGEND - PROPOSED SEATING**
- REFER TO THEATER CONSULTANT FOR FOR SPECIFIC TYPES & DETAILED/PROPRIETARY DESCRIPTION
- EXISTING SEAT
  - PROPOSED ACCESSIBLE SEATING POSITIONS
  - RELOCATED STALLS SEATS TO NEW POSITIONS AS SHOWN
  - SEATS RELOCATED TO SUIT NEW FORESTAGE LIFT. REFER A539# DRAWING SERIES
  - RELOCATED CHOR SEATS TO NEW POSITIONS AS SHOWN
  - SEATS TO BE MODIFIED WITH NEW QUICK RELEASE MECHANISM. REFER TS: THEATRE SPECIALISTS DETAILS
  - ALLOW FOR SECOND SET OF MOUNTING HOLES FOR RELOCATED CARIER SEAT
  - PROPOSED CARIER SEAT WHEN ACCESSIBLE SEATING POSITION IN USE
  - NOMINAL LOCATION OF SEATS TO BE REBURISHED WITH MMA-01
- LEGEND - BALUSTRADES SCREENS & HANDRAILS**
- REFER TO A539# INTERNAL MATERIALS & FINISHES SCHEDULE FOR SPECIFIC TYPES & DETAILED/PROPRIETARY DESCRIPTION
- | CODE    | DESCRIPTION   |
|---------|---|
| M       | MISCELLANEOUS FIXTURES & FITTINGS (NOTE: BELOW CODES ARE AS PER CROMBIE/MS DOCUMENTATION) |
| BAR-### | BALUSTRADE  |
| GR-###  | BALUSTRADE  |
| HR-###  | HANDRAIL  |
| HD-#    | EXTRUSION PROFILE   |

- SE: 'ANYTHING PREFIXED WITH SE: REFER TO STRUCTURAL/FACADE ENGINEERS DRAWINGS
- ME: 'ANYTHING PREFIXED WITH ME: REFER TO MECHANICAL ENGINEERS DRAWINGS
- FE: 'ANYTHING PREFIXED WITH FE: REFER TO FIRE ENGINEERS DRAWINGS
- EE: 'ANYTHING PREFIXED WITH EE: REFER TO ELECTRICAL ENGINEERS DRAWINGS
- HE: 'ANYTHING PREFIXED WITH HE: REFER TO HYDRAULIC ENGINEERS DRAWINGS
- TS: 'ANYTHING PREFIXED WITH TS: REFER TO THEATER CONSULTANTS DRAWINGS

- GENERAL NOTES - DEMOLITION**
- CONTRACTOR & SUB-CONTRACTORS TO VERIFY ALL DIMENSIONS & CONFIRM ON SITE CONDITIONS RELATING TO ALL DIMENSIONS PRIOR TO COMMENCEMENT - DO NOT SCALE FROM DRAWING
  - THIS DRAWING IS TO BE READ IN CONJUNCTION WITH ALL ASSOCIATED SPECIFICATIONS, SCHEDULES & CONTRACT DOCUMENTATION
  - DEMOLITION IS INDICATIVE ONLY. CO-ORDINATE WITH STRUCTURAL DRAWINGS FOR FULLY EXTENT OF DEMOLITION
  - ALLOW TO SUITABLY PROTECT THE EXISTING HERITAGE FINISHES, WHERE THIS IS DEEMED IMPRACTICABLE ALLOW TO CARRY OUT AUDITING/RECORDING & CAREFULLY REMOVE, PROTECT, STORE (ON SITE LOCATION) FOR 7. THE CONTRACTOR IS TO ALLOW TO SAND AND RE-FINISH ALL BRICKWORK NOMINATED TO BE RE-USED IN

**2** DETAIL PLAN - LOWER CIRCLE SEATING - LEVEL 4  
A1208 1:50

**1** DETAIL PLAN - STALLS SEATING - LEVEL 2  
A1207 1:50

Issue	Description	Drawn	Approved	Date
0	0A ISSUE			06/10/2019

**ARM**  
ARCHITECTURE  
LEVEL 11/522 KUNDELS LANE MELBOURNE VICTORIA 3000 AUS  
T 03 8613 1888 F 03 8613 1889  
mail@armarchitecture.com.au  
ADV 2 475 942 350  
www.armarchitecture.com.au

- LEGEND - SCOPE**
- (THIS LEGEND APPLIES TO ALL NEW CONSTRUCTION PHASE DRAWINGS. DOES NOT APPLY TO EXISTING CONDITIONS)
- AREA SHOWN IN GREY WASH DEPICTS SCOPE OF NO NEW WORKS
  - AREA SHOWN IN WHITE WASH DEPICTS SCOPE OF NEW WORKS
  - AREA SURROUNDED BY GREEN DASHED LINES DEPICTS TENDER OPTION

- SOHT GENERAL NOTES**
- ALL DIMENSIONS AND SIZES ARE IN MILLIMETRES.
  - DO NOT SCALE DRAWINGS. USE FIGURED DIMENSIONS ONLY
  - INFORMATION INDICATED IN THIS DOCUMENT MAY BE CRUCIAL TO THE SAFE AND PROPER FUNCTIONING OF THE SYDNEY OPERA HOUSE. DO NOT ALTER ANY ASPECT WITHOUT WRITTEN PERMISSION
  - ALL NEW WORKS MUST COMPLY WITH THE SYDNEY OPERA HOUSE BUILDING SERVICES (STANDARD SPECIFICATION (BSSES)) AND RELEVANT AUSTRALIAN STANDARDS. NEW WORKS MUST ALSO COMPLY WITH THE REQUIREMENTS OF THE BUILDING CODES OF AUSTRALIA.

- SOHT COPYRIGHT**
- THIS DRAWING AND DESIGN ARE SUBJECT TO COPYRIGHT AND SHALL NOT BE COPIED IN ANY FORM WITH THE WRITTEN PERMISSION OF THE SYDNEY OPERA HOUSE TRUST

Location North

Status  
DEVELOPMENT APPLICATION  
ISSUE

Contract  
BDM-168

Date  
21/03/2019

Scale  
1:50@ B1

Project  
BUILDING RENEWAL PROJECT -  
CONCERT HALL

Title  
DETAIL AREA - STALLS SEATING - LEVEL 2  
+42

Works  
Sydney Opera House Trust  
GPO Box 4274 Sydney NSW Australia 2001  
Phone: +61 2 9250 7541  
email: info@sydneyoperahouse.com

Location Drawing No: 49-BR-ARM01  
Sheet: DA5328  
Rev: D

B1



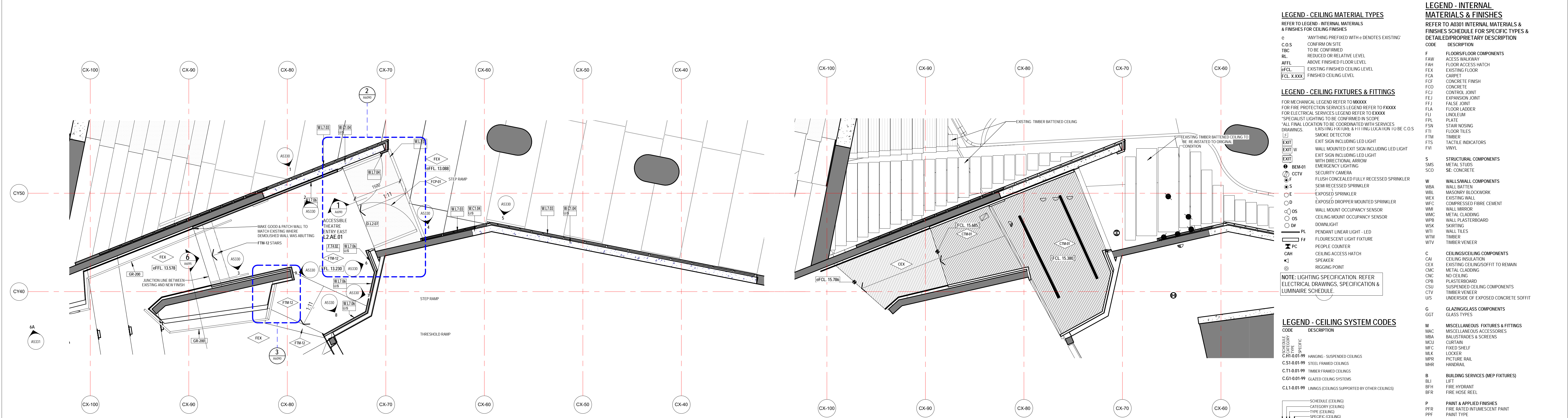

1  
A1206  
DETAIL PLAN - ACCESSIBLE THEATRE ENTRY EAST - LEVEL 2 +42  
1 : 50

3  
A1506  
DETAIL RCP - ACCESSIBLE ENTRIES EAST  
1 : 50

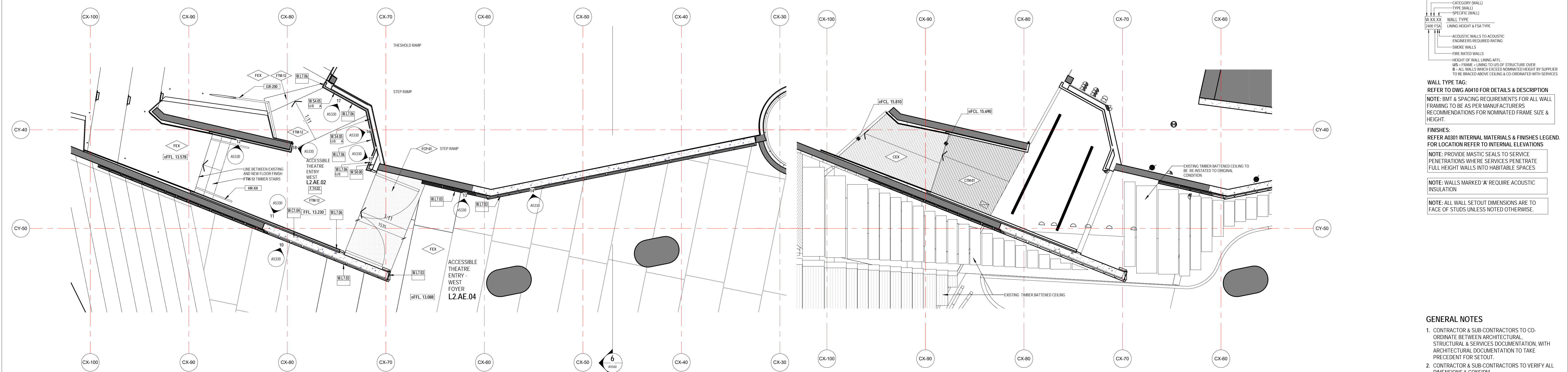

2  
A1206  
DETAIL PLAN - ACCESSIBLE THEATRE ENTRY WEST - LEVEL 2 +42  
1 : 50

4  
A1506  
DETAIL RCP - ACCESSIBLE ENTRIES WEST  
1 : 50



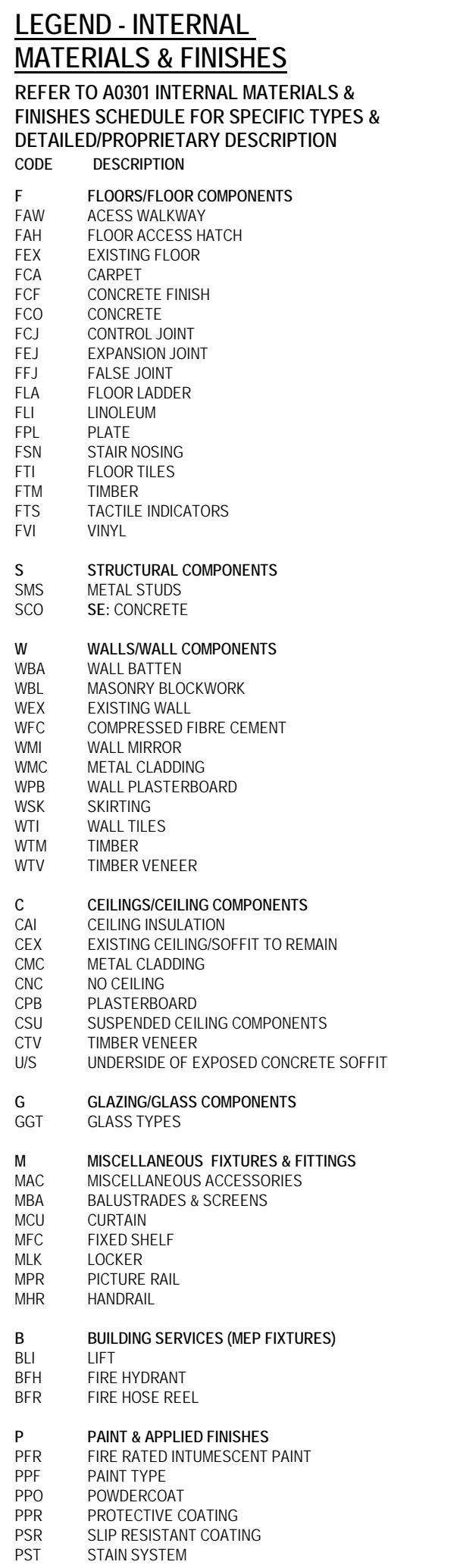

- SE: 'ANYTHING PREFIXED WITH SE: REFER TO STRUCTURAL/FACADE ENGINEERS DRAWINGS  
ME: 'ANYTHING PREFIXED WITH ME: REFER TO MECHANICAL ENGINEERS DRAWINGS  
FE: 'ANYTHING PREFIXED WITH FE: REFER TO FIRE ENGINEERS DRAWINGS  
EE: 'ANYTHING PREFIXED WITH EE: REFER TO ELECTRICAL ENGINEERS DRAWINGS  
HE: 'ANYTHING PREFIXED WITH HE: REFER TO HYDRAULIC ENGINEERS DRAWINGS  
TS: 'ANYTHING PREFIXED WITH TS: REFER TO THEATER CONSULTANTS DRAWINGS

### GENERAL NOTES



- CONTRACTOR & SUB-CONTRACTORS TO CO-ORDINATE WITH ARCHITECTURAL, STRUCTURAL & SERVICES DOCUMENTATION, WITH ARCHITECTURAL DOCUMENTATION TO TAKE PRECEDENT FOR SETOUT.
- CONTRACTOR & SUB-CONTRACTORS TO VERIFY ALL DIMENSIONS & CONFIRM ALL DIMENSIONS RELATING TO ALL DIMENSIONS PRIOR TO COMMENCEMENT - DO NOT SCALE FROM DRAWING
- SHOP DRAWINGS ARE TO BE SUPPLIED TO THE RELEVANT PARTIES & CONSULTANTS FOR REVIEW & APPROVAL PRIOR TO THE COMMENCEMENT OF ANY WORKS
- THIS DRAWING IS TO BE READ IN CONJUNCTION WITH ALL ASSOCIATED SPECIFICATIONS, SCHEDULES & CONTRACT DOCUMENTS
- MAKE GOOD ALL AFFECTED SURFACES & FINISHES INCLUDING REPAIRS REQUIRED FOR REMOVAL & REOR RELOCATION
- THE CONTRACTOR IS TO ALLOW TO SAND AND RE-FINISH ALL BRUSHBOX NOMINATED TO BE RE-USED THE WORKS. THIS BRUSHBOX IS TO BE INCORPORATED WHEREVER POSSIBLE
- WTM&S IS NOMINATED

[illegible]

**ARM**  
ARCHITECTURE  
LEVEL 11/522 FLINDERS LANE MELBOURNE VICTORIA 3000 AUS  
T/ 03 8613 1888 F/ 03 8613 1889  
mail@armarchitecture.com.au  
ABN 22 476 949 399  
www.armarchitecture.com.au

### LEGEND - SCOPE

(THIS LEGEND APPLIES TO ALL NEW CONSTRUCTION PHASE DRAWINGS. DOES NOT APPLY TO EXISTING CONDITIONS DRAWINGS)

	AREA SHOWN IN GREY WASH DEPICTS SCOPE OF NO NEW WORKS
	AREA SHOWN IN WHITE WASH DEPICTS SCOPE OF NEW WORKS
	AREA SURROUNDED BY GREEN DASHED LINES DEPICTS TENDER OPTION

- SOFT GENERAL NOTES**
1. ALL DIMENSIONS AND SIZES ARE IN MILLIMETRES.
  2. DO NOT SCALE DRAWINGS. USE FIGURED DIMENSIONS ONLY.
  3. INFORMATION INDICATED IN THIS DOCUMENT MAY BE CRUCIAL TO THE SAFE AND PROPER FUNCTIONING OF THE SYDNEY OPERA HOUSE. DO NOT ALTER ANY ASPECT WITHOUT WRITTEN PERMISSION.
  4. ALL NEW WORKS MUST COMPLY WITH THE SYDNEY OPERA HOUSE BUILDING SERVICES STANDARD SPECIFICATION (BSSS) AND RELEVANT AUSTRALIAN STANDARDS. NEW WORKS MUST ALSO COMPLY WITH THE REQUIREMENTS OF THE BUILDING CODES OF AUSTRALIA.

SOHT COPYRIGHT  
THIS DRAWING AND DESIGN ARE  
SUBJECT TO COPYRIGHT AND  
SHALL NOT BE COPIED IN ANY  
FORM WITH THE WRITTEN  
PERMISSION OF THE SYDNEY  
OPERA HOUSE TRUST

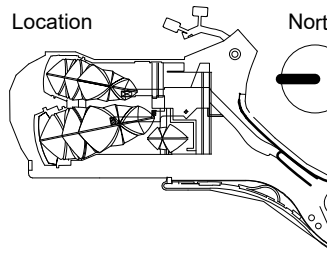

Status		DEVELOPMENT APPLICATION ISSUE	
Contract		BDM-168	
Dwn	RB	Date	21/09/2018
Ckd	Checker	Scale	1.50 @ B1

Project	BUILDING RENEWAL PROJECT - CONCERT HALL
Title	INTERIOR ELEVATIONS - ACCESSIBLE THEATRE ENTRIES - LEVEL 2 +42

Sydney Opera House Trust  
 GPO Box 4274 Sydney NSW Australia 2001  
 Phone: +61 2 9250 7541  
 email: info@sydneyoperahouse.com



© Sydney Opera House Trust

Location	Drawing No:	Sheet:	Rev:	
CHVA	49-BR-ARM01	DA5330	D	B1



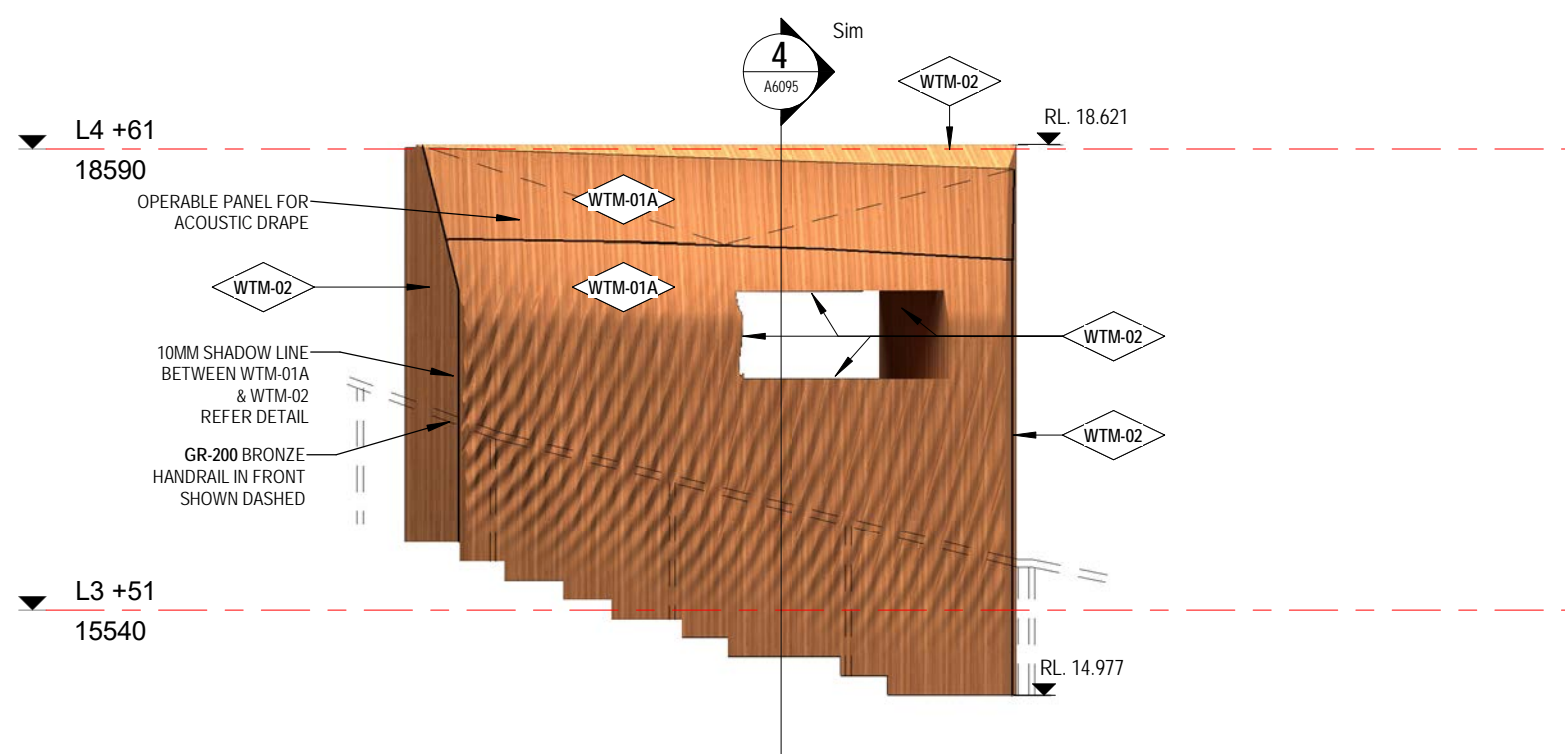

5A  
A5331  
1 : 50  
DETAIL ELEVATION - TIMBER ACOUSTIC DIFFUSION PANELS - BOX U FRONT

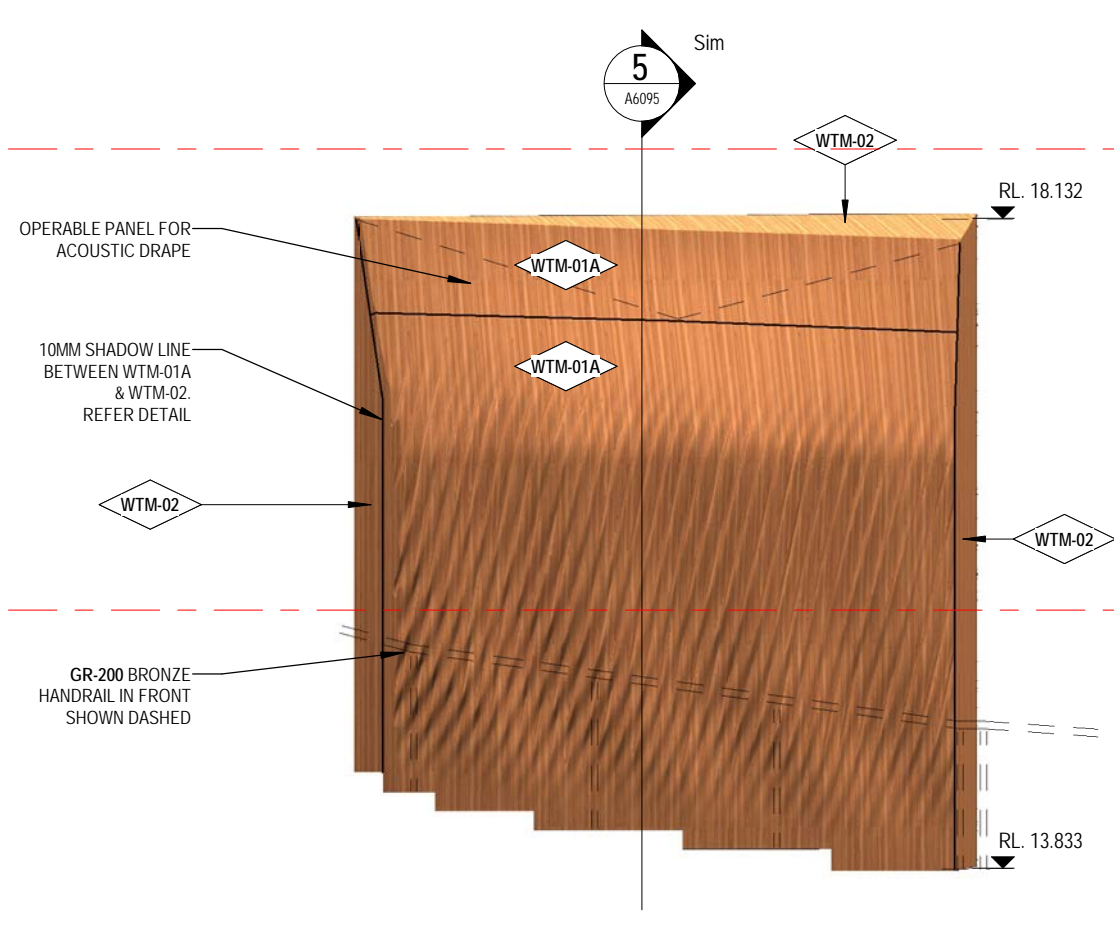

6A  
A5329  
1 : 50  
DETAIL ELEVATION - TIMBER ACOUSTIC DIFFUSION PANELS - BOX V FRONT

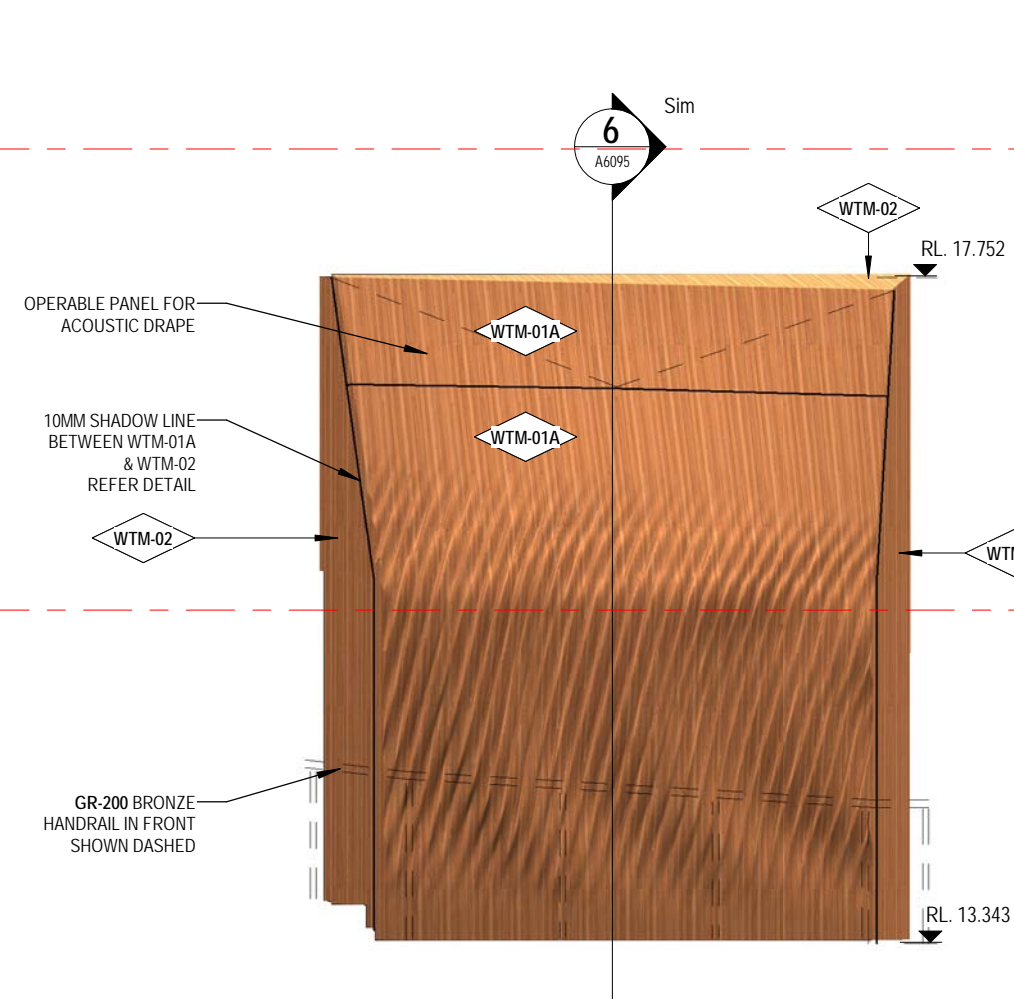

7A  
A5321  
1 : 50  
DETAIL ELEVATION - TIMBER ACOUSTIC DIFFUSION PANELS - BOX W FRONT

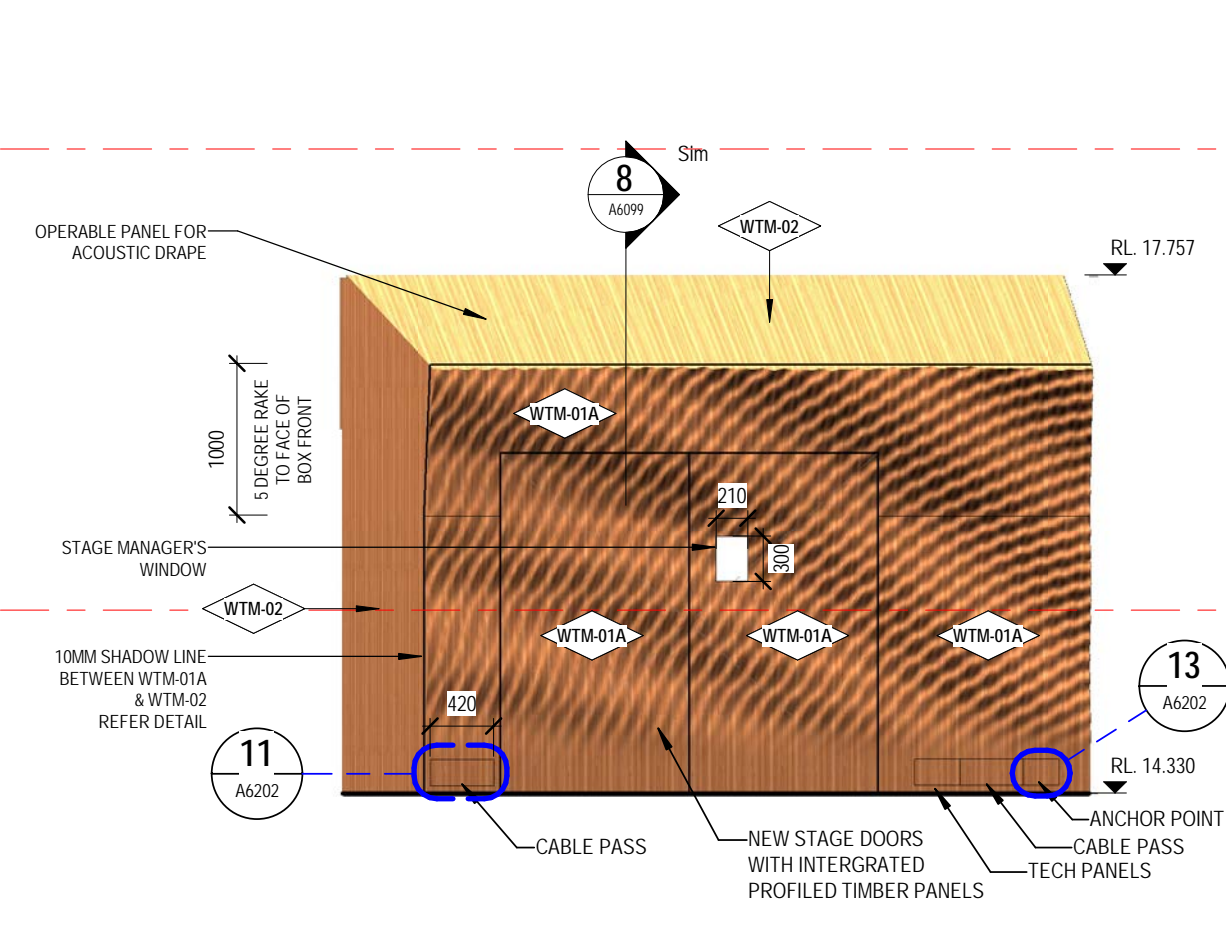

8A  
A3150  
1 : 50  
DETAIL ELEVATION - TIMBER ACOUSTIC DIFFUSION PANELS - BOX X FRONT

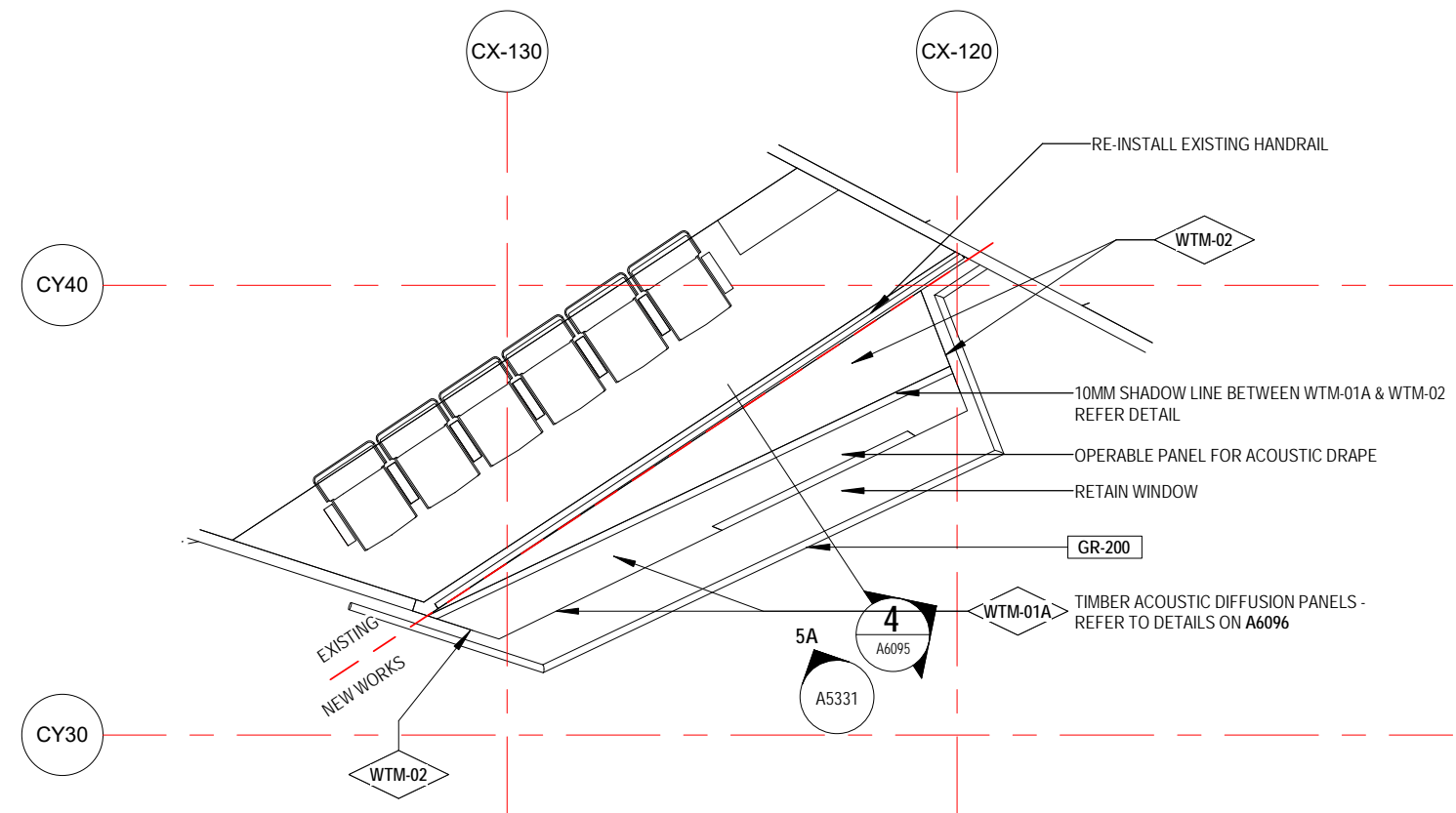

5  
A1208  
1 : 50  
DETAIL PLAN - TIMBER ACOUSTIC DIFFUSION PANELS - BOX U FRONT

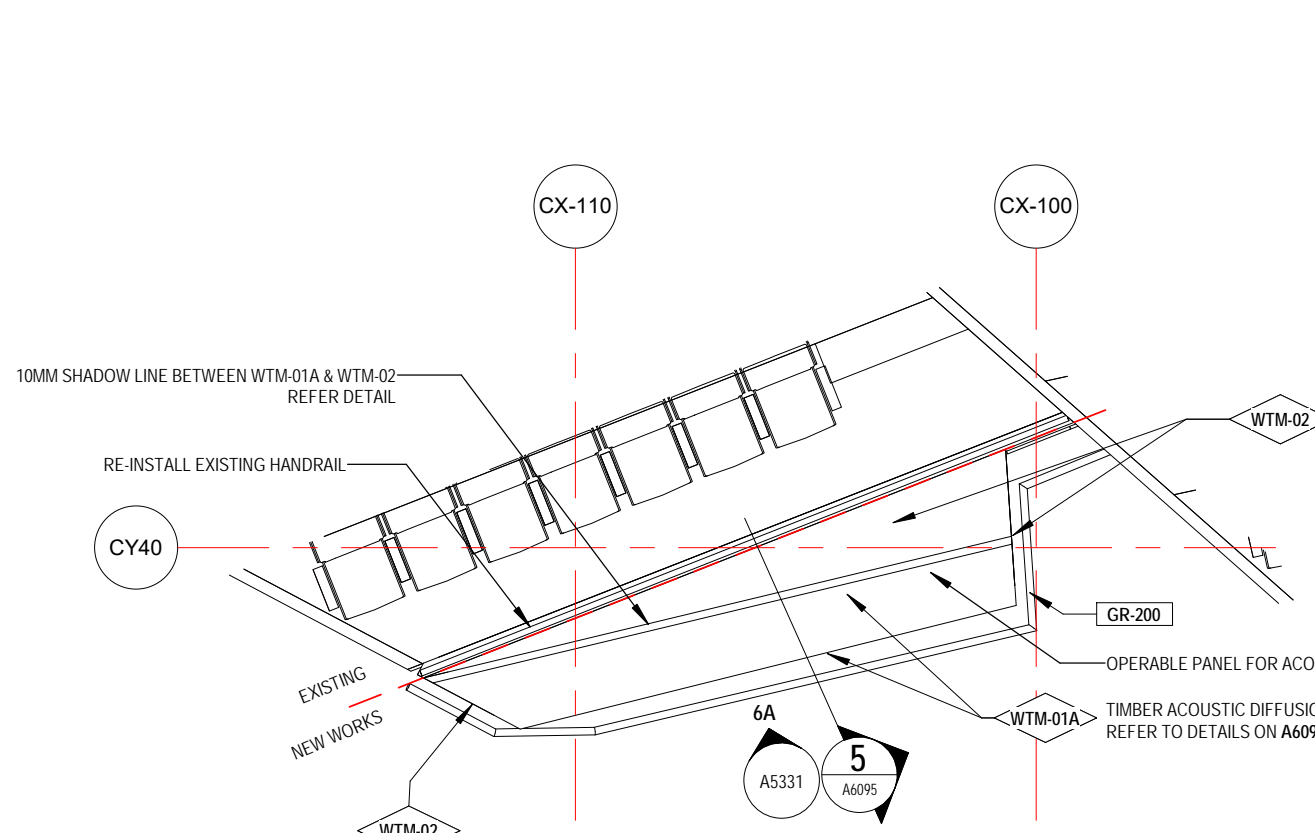

6  
A1208  
1 : 50  
DETAIL PLAN - TIMBER ACOUSTIC DIFFUSION PANELS - BOX V FRONT

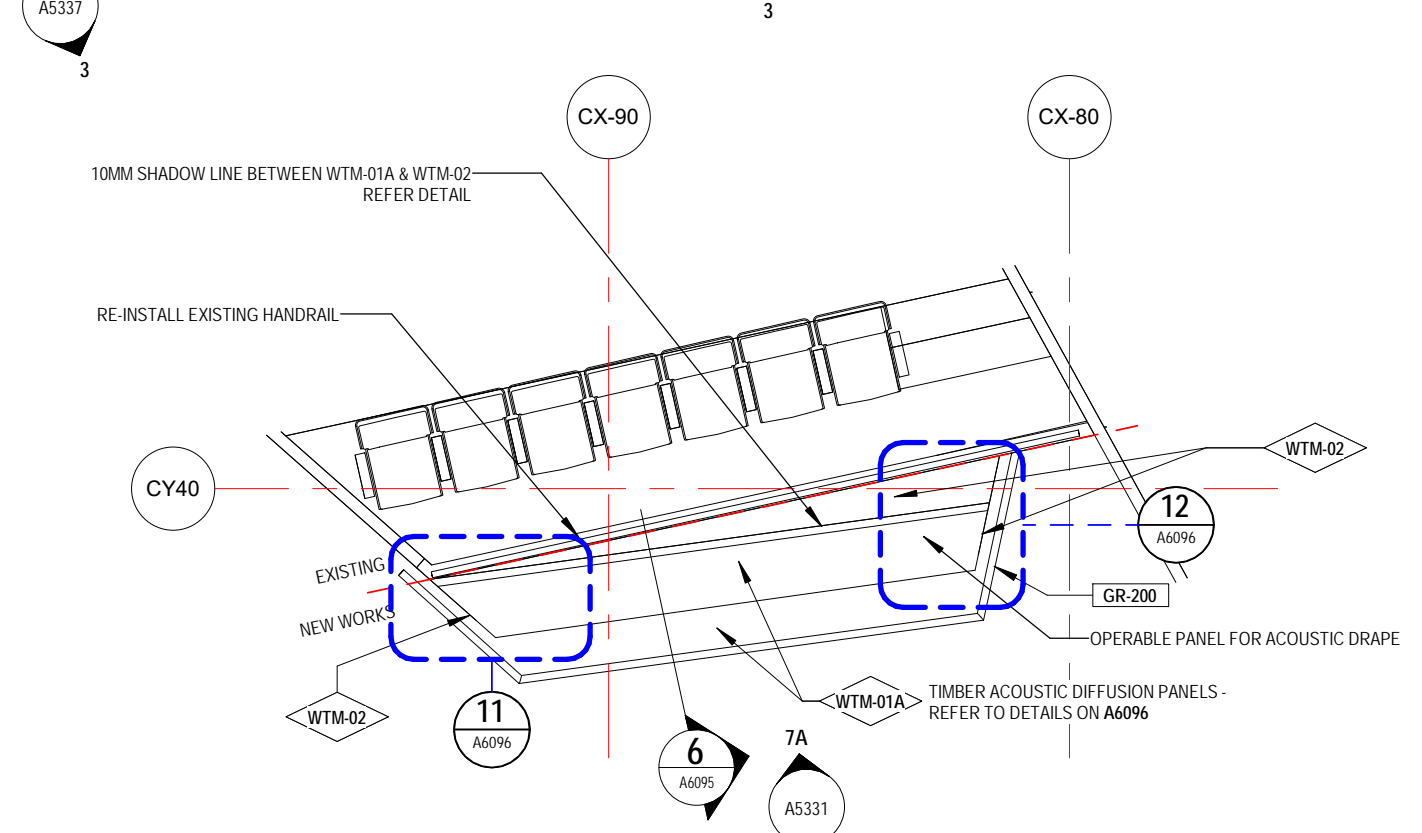

7  
A1208  
1 : 50  
DETAIL PLAN - TIMBER ACOUSTIC DIFFUSION PANELS - BOX W FRONT

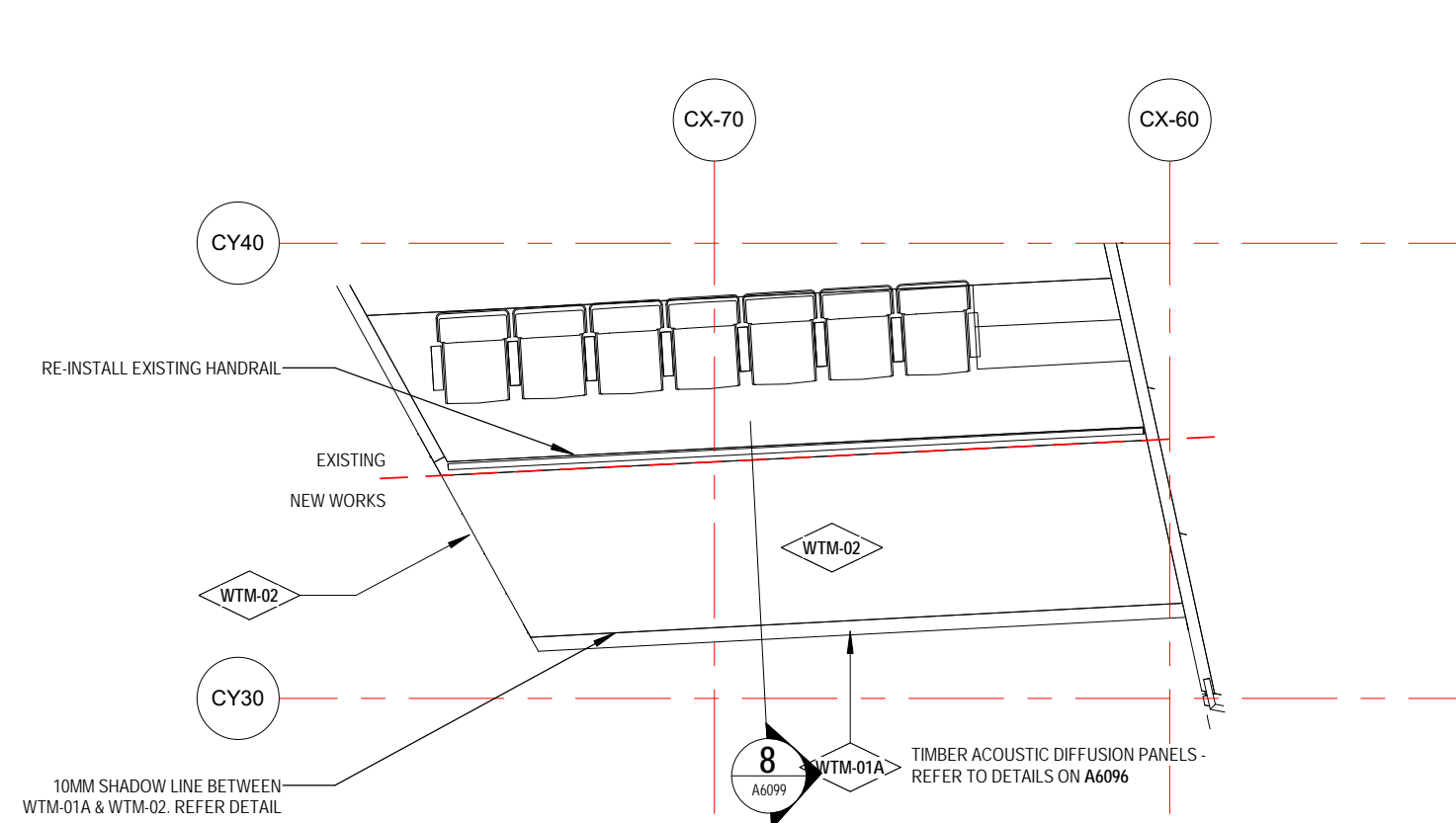

8  
A1208  
1 : 50  
DETAIL PLAN - TIMBER ACOUSTIC DIFFUSION PANELS - BOX X FRONT

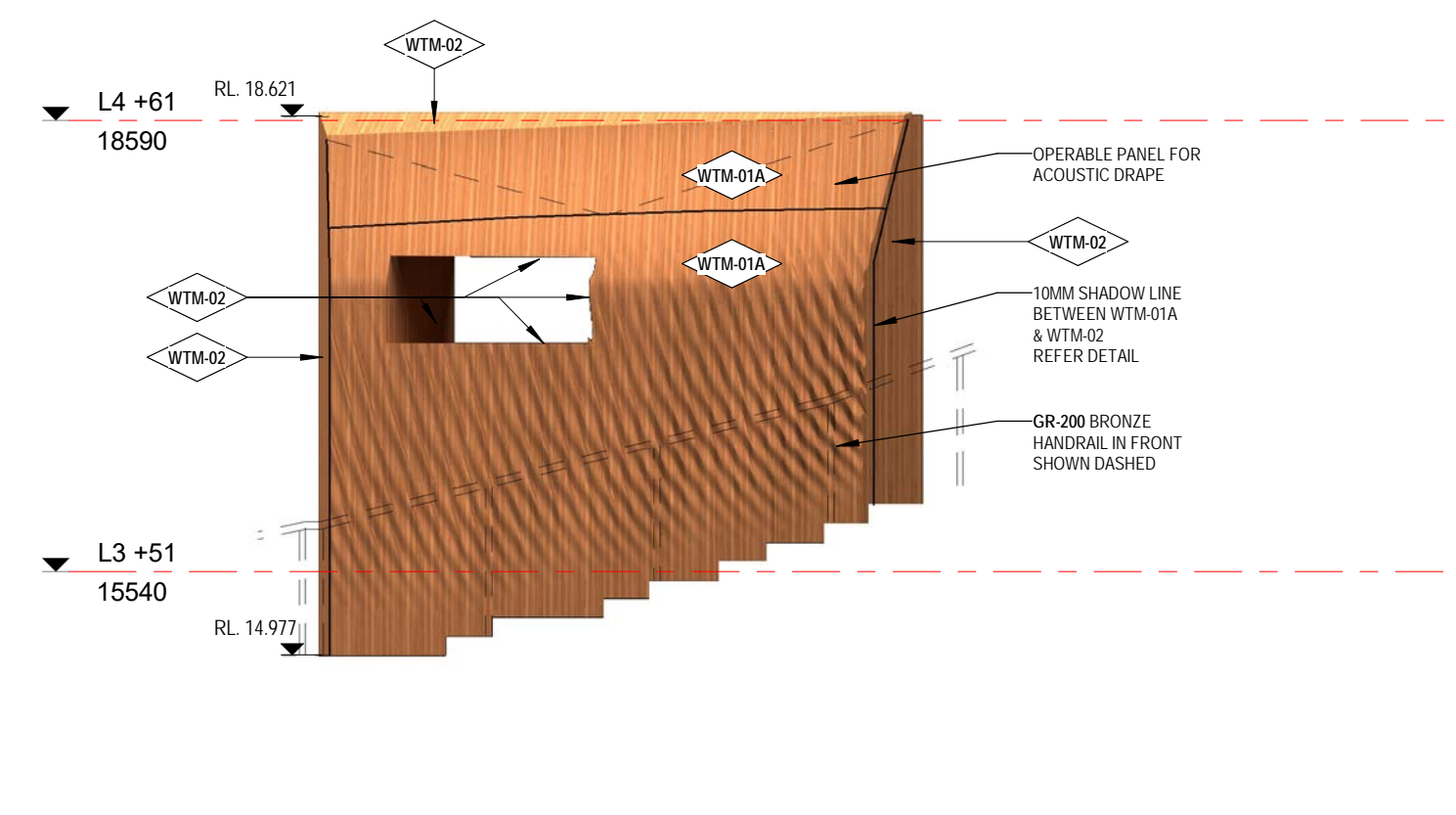

1A  
A5331  
1 : 50  
DETAIL ELEVATION - TIMBER ACOUSTIC DIFFUSION PANELS - BOX A FRONT

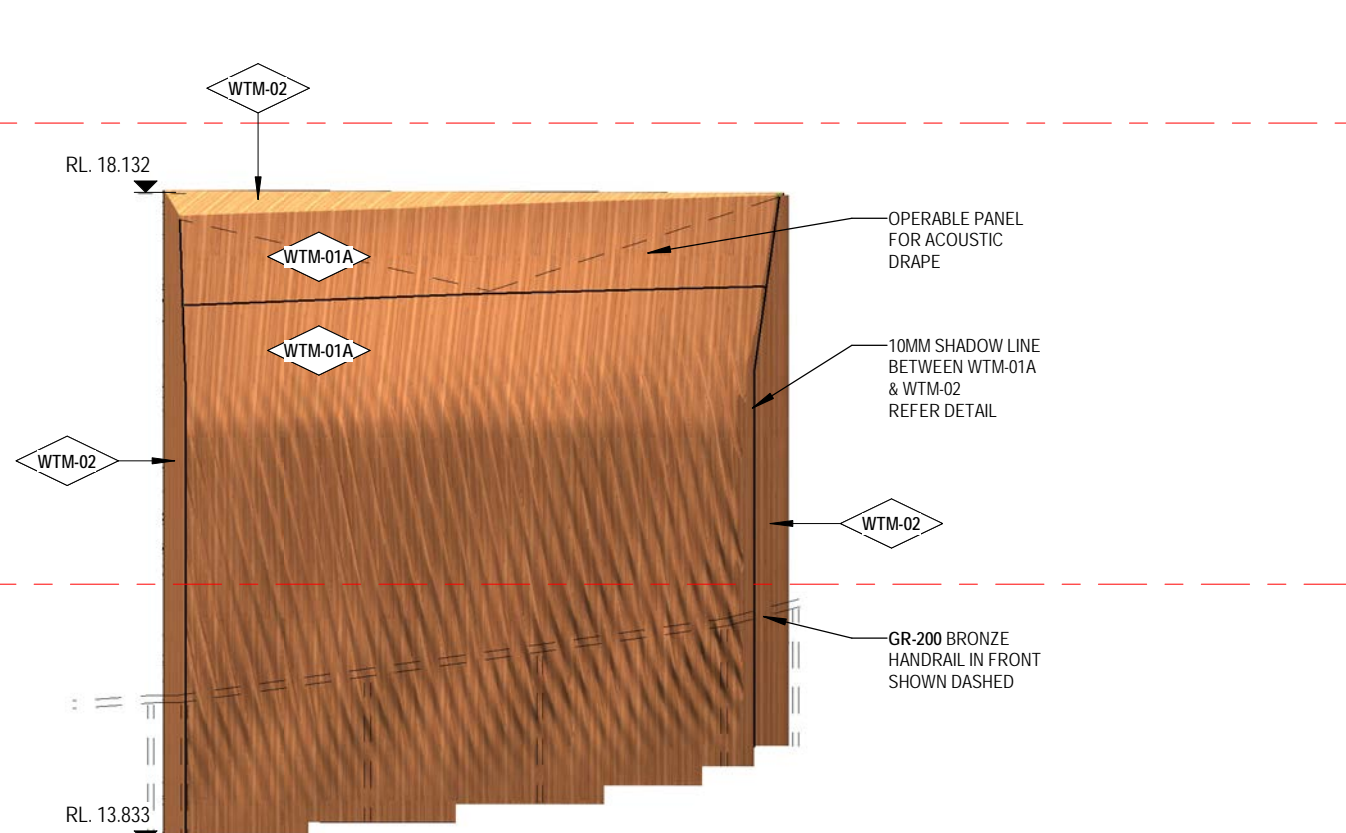

2A  
A5331  
1 : 50  
DETAIL ELEVATION - TIMBER ACOUSTIC DIFFUSION PANELS - BOX B FRONT

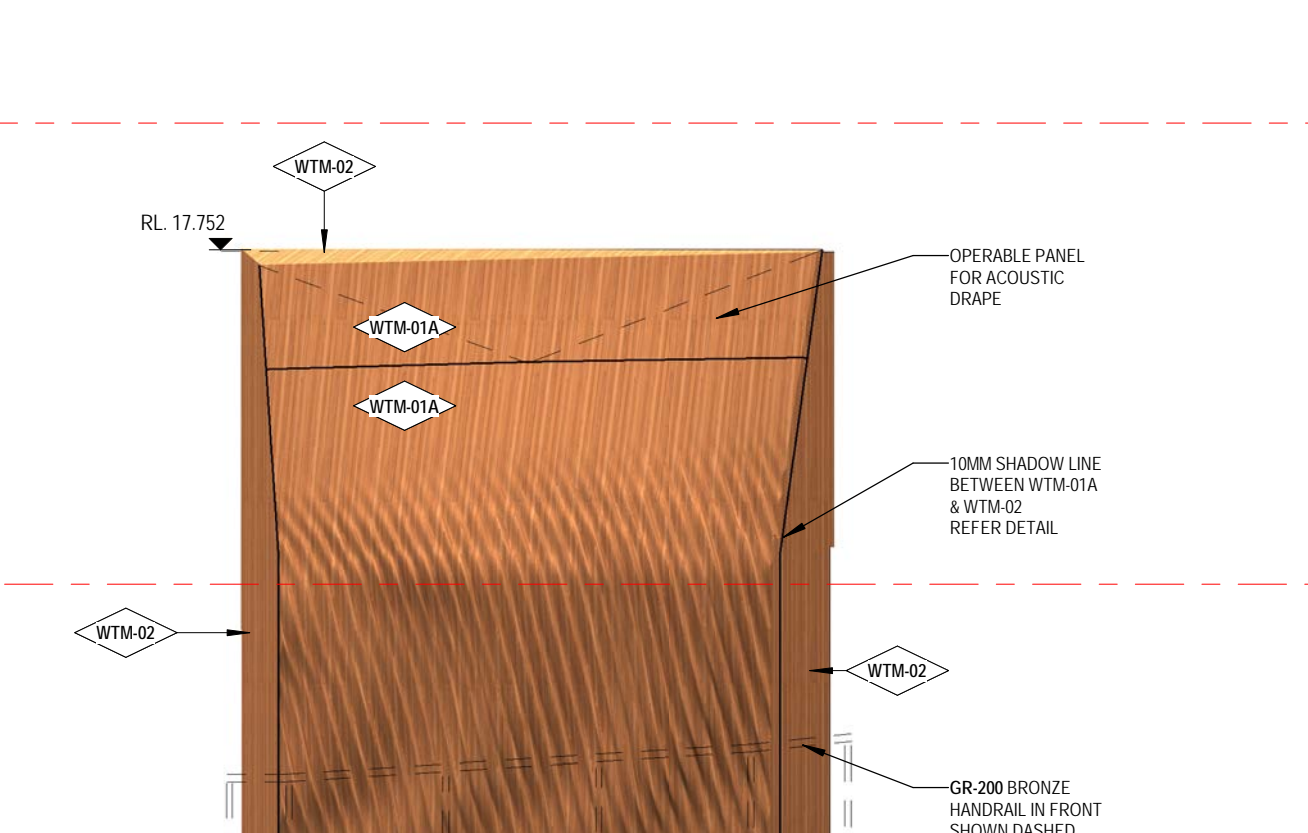

3A  
A5320  
1 : 50  
DETAIL ELEVATION - TIMBER ACOUSTIC DIFFUSION PANELS - BOX C FRONT

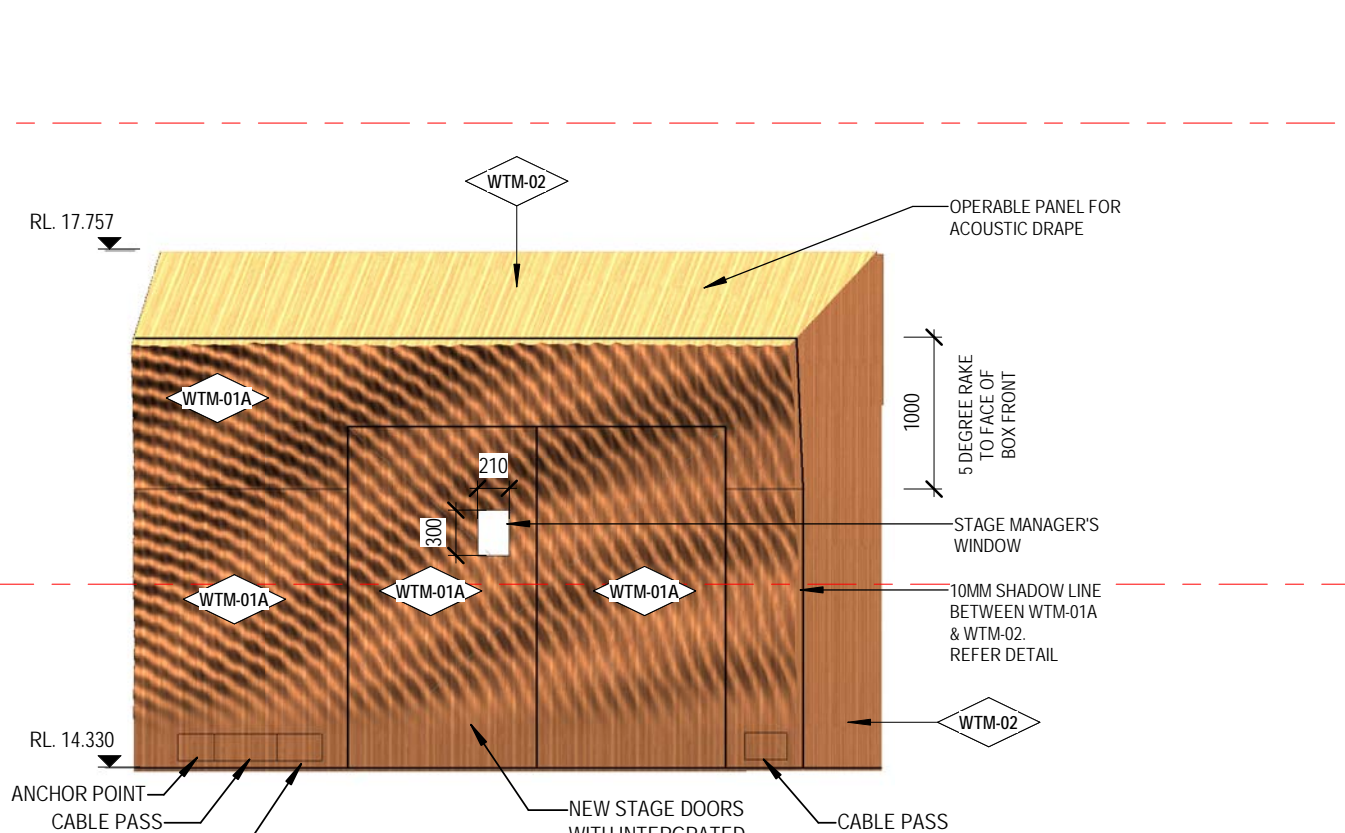

4A  
A5331  
1 : 50  
DETAIL ELEVATION - TIMBER ACOUSTIC DIFFUSION PANELS - BOX D FRONT

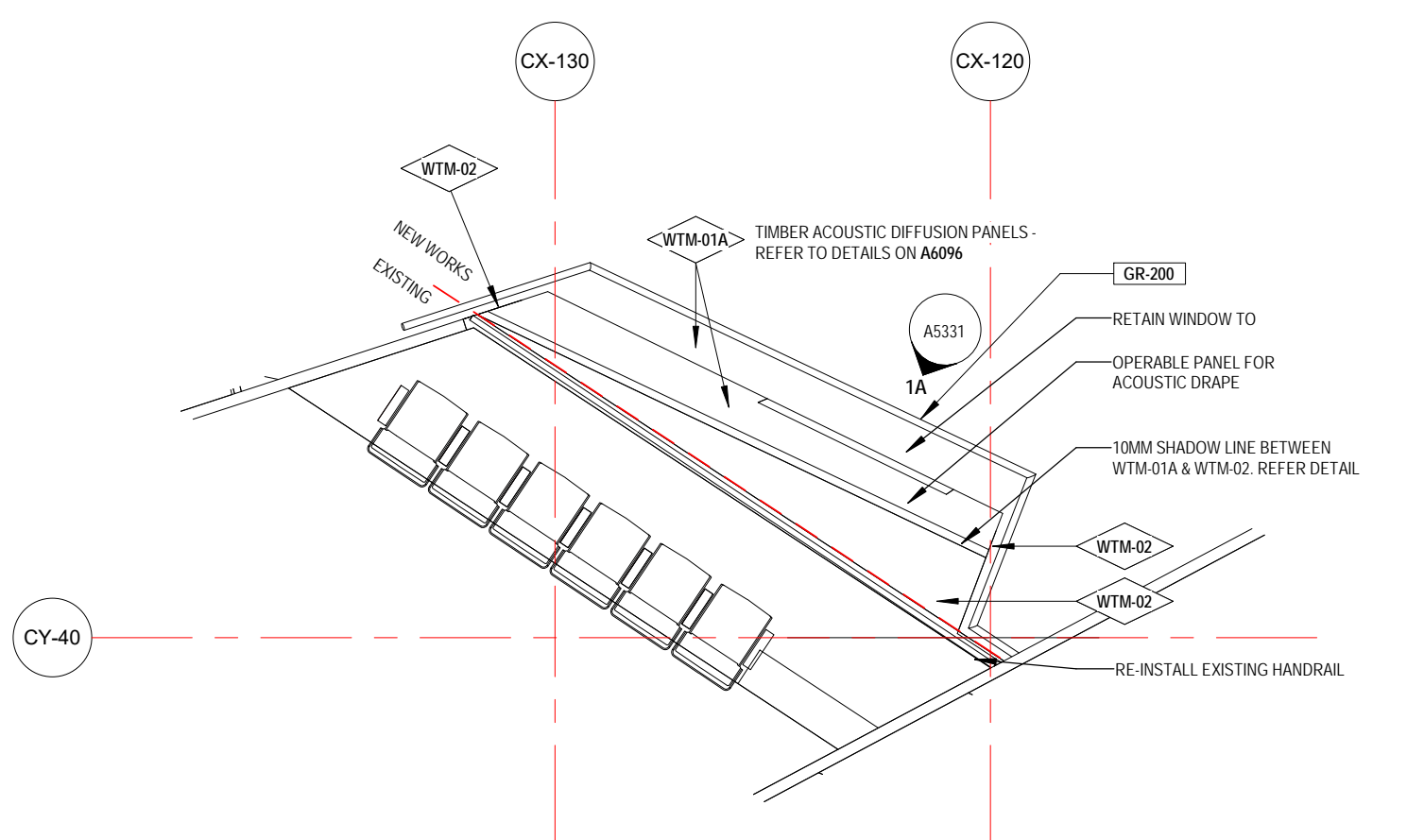

1  
A1208  
1 : 50  
DETAIL PLAN - TIMBER ACOUSTIC DIFFUSION PANELS - BOX A FRONT

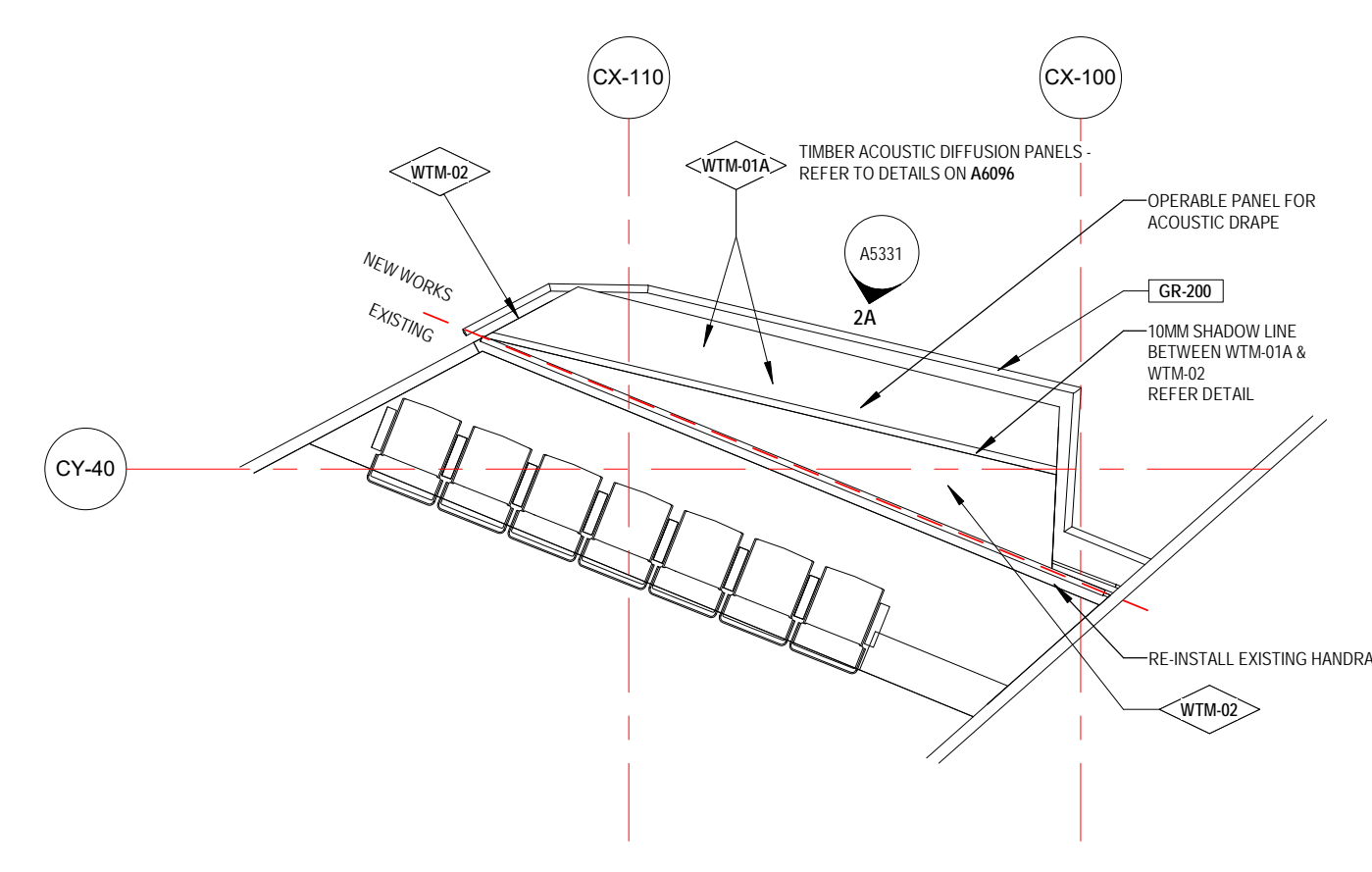

2  
A1208  
1 : 50  
DETAIL PLAN - TIMBER ACOUSTIC DIFFUSION PANELS - BOX B FRONT

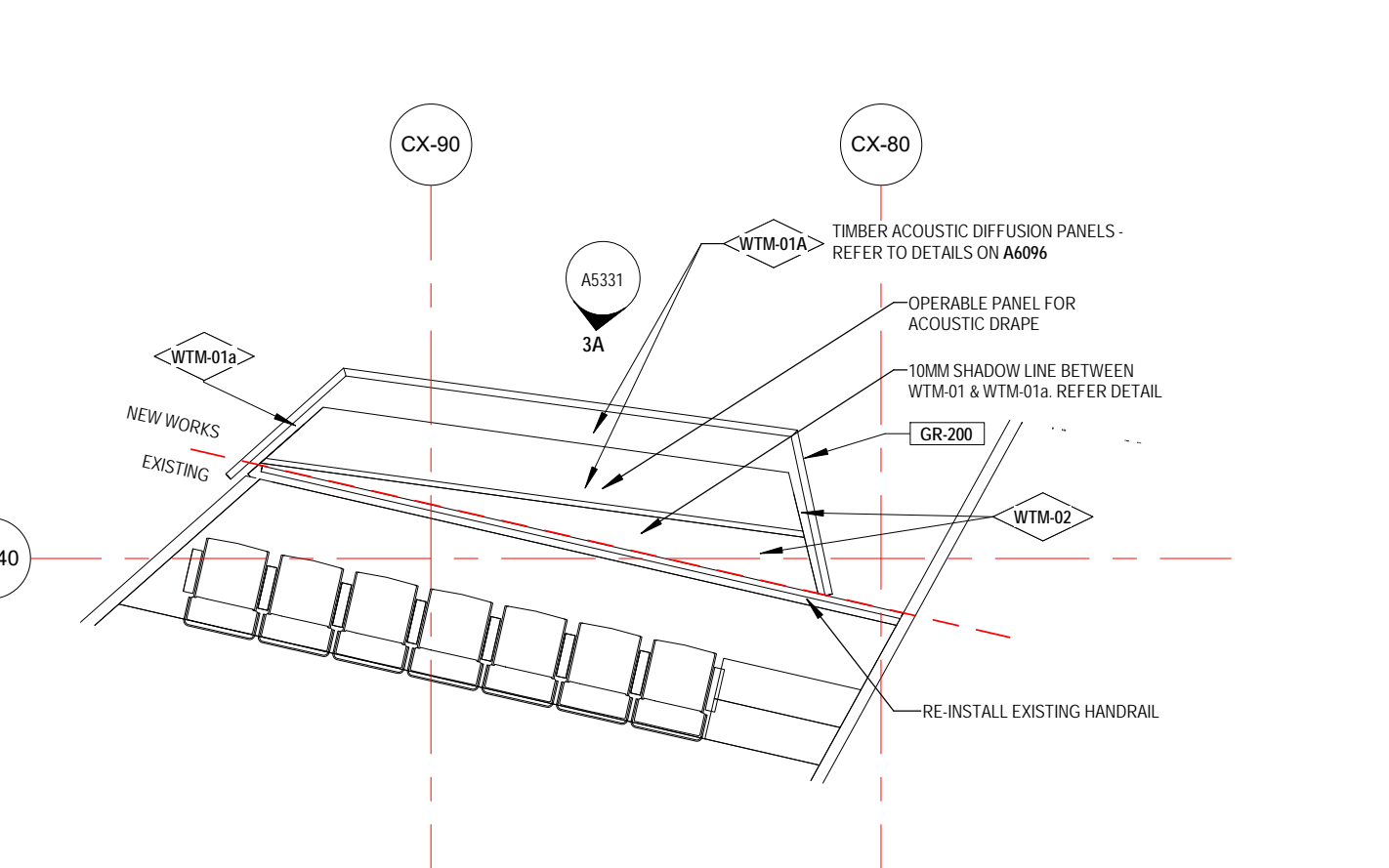

3  
A1208  
1 : 50  
DETAIL PLAN - TIMBER ACOUSTIC DIFFUSION PANELS - BOX C FRONT

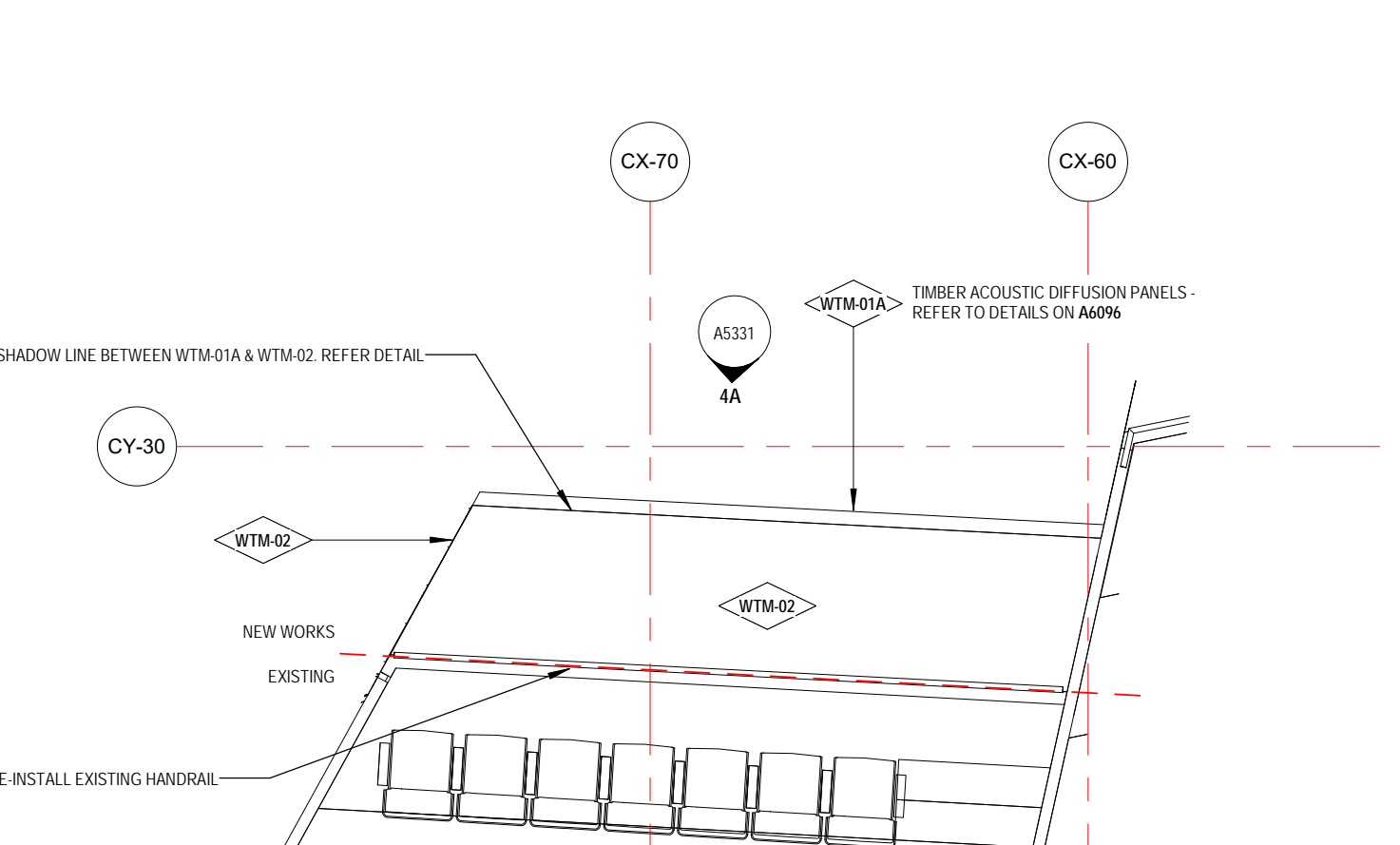

4  
A1208  
1 : 50  
DETAIL PLAN - TIMBER ACOUSTIC DIFFUSION PANELS - BOX D FRONT

## LEGEND - INTERNAL MATERIALS & FINISHES

REFER TO A0301 INTERNAL MATERIALS & FINISHES SCHEDULE FOR SPECIFIC TYPES & DETAILED PROPRIETARY DESCRIPTION

CODE	DESCRIPTION
F	FLOORS/FLOOR COMPONENTS
FAW	ACCESS WALKWAY
FAH	FLOOR ACCESS HATCH
FEA	EXISTING FLOOR
FCA	CARPET
FCF	CONCRETE FINISH
FCO	CONCRETE
FCJ	CONTROL JOINT
FEJ	EXPANSION JOINT
FFJ	FALSE JOINT
FLA	FLOOR LADDER
FLI	LINOLEUM
FPL	PLATE
FSN	STAIR NOSING
FTI	FLOOR TILES
FTM	TIMBER
FTS	TACTILE INDICATORS
FMI	VINYL

CODE	DESCRIPTION
S	STRUCTURAL COMPONENTS
SMS	METAL STUDS
SCD	SE-CONCRETE

CODE	DESCRIPTION
W	WALLS/WALL COMPONENTS
WBA	WALL BATTEN
WBL	MASONRY BLOCKWORK
WEX	EXISTING WALL
WFC	COMPRESSED FIBRE CEMENT
WMM	WALL MIRROR
WMC	METAL CLADDING
WRB	WALL PLASTERBOARD
WSK	SKIRTING
WTI	WALL TILES
WTV	TIMBER VENEER

CODE	DESCRIPTION
C	CEILING COMPONENTS
CAI	CEILING INSULATION
CEX	EXISTING CEILING/SOFFIT TO REMAIN
CAC	METAL CLADDING
CNC	NO CEILING
CPB	PLASTERBOARD
CSU	SUSPENDED CEILING COMPONENTS
CTV	TIMBER VENEER
UIS	UNDERSIDE OF EXPOSED CONCRETE SOFFIT

CODE	DESCRIPTION
G	GLAZING/GLASS COMPONENTS
GGT	GLASS TYPES

CODE	DESCRIPTION
M	MISCELLANEOUS FIXTURES & FITTINGS
MAC	MISCELLANEOUS ACCESSORIES
MCU	BALUSTRADES & SCREENS
MFC	CURTAIN
MLK	FIXED SHELF
MLR	LOCKER
MPR	PICTURE RAIL
MHR	HANDRAIL

CODE	DESCRIPTION
B	BUILDING SERVICES (MEP FIXTURES)
BLI	LIFT
BFH	FIRE HYDRANT
BFR	FIRE HOSE REEL

CODE	DESCRIPTION
P	PAINT & APPLIED FINISHES
PRF	FIRE RATED INTUMESCENT PAINT
PPT	PAINT TYPE
PPO	POWDERCOAT
PPR	PROTECTIVE COATING
PSR	SLIP RESISTANT COATING
PST	STAIN SYSTEM

## GENERAL NOTES

- CONTRACTOR & SUB-CONTRACTORS TO CO-ORDINATE BETWEEN ARCHITECTURAL, STRUCTURAL & SERVICES DOCUMENTATION, WITH ARCHITECTURAL DOCUMENTATION TO TAKE PRECEDENT FOR SETOUT.
- CONTRACTOR & SUB-CONTRACTORS TO VERIFY ALL DIMENSIONS & CONFIRM ON SITE CONDITIONS RELATING TO ALL DIMENSIONS PRIOR TO COMMENCEMENT - DO NOT SCALE FROM DRAWING
- SHOP DRAWINGS ARE TO BE SUPPLIED TO THE RELEVANT PARTIES & CONSULTANTS FOR REVIEW & APPROVAL PRIOR TO THE COMMENCEMENT OF ANY WORKS
- THIS DRAWING IS TO BE READ IN CONJUNCTION WITH ALL ASSOCIATED SPECIFICATIONS, SCHEDULES & CONTRACT DOCUMENTS
- MAKE GOOD ALL AFFECTED SURFACES & FINISHES INCLUDING ITEMS MARKED FOR REMOVAL & RELOCATION
- THE CONTRACTOR IS TO ALLOW TO SAND AND RE-FINISH ALL BRUSHBOX NOMINATED TO BE RE-USED THE WORKS. THIS BRUSHBOX IS TO BE INCORPORATED WHEREVER POSSIBLE WHERE WTM-02 IS NOMINATED

Issue	Description	Drawn	Approved	Date
0	0A ISSUE	0A	0A	06/10/2019
1	1A ISSUE	1A	1A	11/02/2020
2	2A ISSUE	2A	2A	11/02/2020
3	3A ISSUE	3A	3A	11/02/2020
4	4A ISSUE	4A	4A	11/02/2020
5	5A ISSUE	5A	5A	11/02/2020
6	6A ISSUE	6A	6A	11/02/2020
7	7A ISSUE	7A	7A	11/02/2020
8	8A ISSUE	8A	8A	11/02/2020
9	9A ISSUE	9A	9A	11/02/2020
10	10A ISSUE	10A	10A	11/02/2020
11	11A ISSUE	11A	11A	11/02/2020
12	12A ISSUE	12A	12A	11/02/2020
13	13A ISSUE	13A	13A	11/02/2020
14	14A ISSUE	14A	14A	11/02/2020
15	15A ISSUE	15A	15A	11/02/2020
16	16A ISSUE	16A	16A	11/02/2020
17	17A ISSUE	17A	17A	11/02/2020
18	18A ISSUE	18A	18A	11/02/2020
19	19A ISSUE	19A	19A	11/02/2020
20	20A ISSUE	20A	20A	11/02/2020
21	21A ISSUE	21A	21A	11/02/2020
22	22A ISSUE	22A	22A	11/02/2020
23	23A ISSUE	23A	23A	11/02/2020
24	24A ISSUE	24A	24A	11/02/2020
25	25A ISSUE	25A	25A	11/02/2020
26	26A ISSUE	26A	26A	11/02/2020
27	27A ISSUE	27A	27A	11/02/2020
28	28A ISSUE	28A	28A	11/02/2020
29	29A ISSUE	29A	29A	11/02/2020
30	30A ISSUE	30A	30A	11/02/2020
31	31A ISSUE	31A	31A	11/02/2020
32	32A ISSUE	32A	32A	11/02/2020
33	33A ISSUE	33A	33A	11/02/2020
34	34A ISSUE	34A	34A	11/02/2020
35	35A ISSUE	35A	35A	11/02/2020
36	36A ISSUE	36A	36A	11/02/2020
37	37A ISSUE	37A	37A	11/02/2020
38	38A ISSUE	38A	38A	11/02/2020
39	39A ISSUE	39A	39A	11/02/2020
40	40A ISSUE	40A	40A	11/02/2020
41	41A ISSUE	41A	41A	11/02/2020
42	42A ISSUE	42A	42A	11/02/2020
43	43A ISSUE	43A	43A	11/02/2020
44	44A ISSUE	44A	44A	11/02/2020
45	45A ISSUE	45A	45A	11/02/2020
46	46A ISSUE	46A	46A	11/02/2020
47	47A ISSUE	47A	47A	11/02/2020
48	48A ISSUE	48A	48A	11/02/2020
49	49A ISSUE	49A	49A	11/02/2020
50	50A ISSUE	50A	50A	11/02/2020
51	51A ISSUE	51A	51A	11/02/2020
52	52A ISSUE	52A	52A	11/02/2020
53	53A ISSUE	53A	53A	11/02/2020
54	54A ISSUE	54A	54A	11/02/2020
55	55A ISSUE	55A	55A	11/02/2020
56	56A ISSUE	56A	56A	11/02/2020
57	57A ISSUE	57A	57A	11/02/2020
58	58A ISSUE	58A	58A	11/02/2020
59	59A ISSUE	59A	59A	11/02/2020
60	60A ISSUE	60A	60A	11/02/2020
61	61A ISSUE	61A	61A	11/02/2020
62	62A ISSUE	62A	62A	11/02/2020
63	63A ISSUE	63A	63A	11/02/2020
64	64A ISSUE	64A	64A	11/02/2020
65	65A ISSUE	65A	65A	11/02/2020
66	66A ISSUE	66A	66A	11/02/2020
67	67A ISSUE	67A	67A	11/02/2020
68	68A ISSUE	68A	68A	11/02/2020
69	69A ISSUE	69A	69A	11/02/2020
70	70A ISSUE	70A	70A	11/02/2020
71	71A ISSUE	71A	71A	11/02/2020
72	72A ISSUE	72A	72A	11/02/2020
73	73A ISSUE	73A	73A	11/02/2020
74	74A ISSUE	74A	74A	11/02/2020
75	75A ISSUE	75A	75A	11/02/2020
76	76A ISSUE	76A	76A	11/02/2020
77	77A ISSUE	77A	77A	11/02/2020
78	78A ISSUE	78A	78A	11/02/2020
79	79A ISSUE	79A	79A	11/02/2020
80	80A ISSUE	80A	80A	11/02/2020
81	81A ISSUE	81A	81A	11/02/2020
82	82A ISSUE	82A	82A	11/02/2020
83	83A ISSUE	83A	83A	11/02/2020
84	84A ISSUE	84A	84A	11/02/2020
85	85A ISSUE	85A	85A	11/02/2020
86	86A ISSUE	86A	86A	11/02/2020
87	87A ISSUE	87A	87A	11/02/2020
88	88A ISSUE	88A	88A	11/02/2020
89	89A ISSUE	89A	89A	11/02/2020
90	90A ISSUE	90A	90A	11/02/2020
91	91A ISSUE	91A	91A	11/02/2020
92	92A ISSUE	92A	92A	11/02/2020
93	93A ISSUE	93A	93A	11/02/2020
94	94A ISSUE	94A	94A	11/02/2020
95	95A ISSUE	95A	95A	11/02/2020
96	96A ISSUE	96A	96A	11/02/2020
97	97A ISSUE	97A	97A	11/02/2020
98	98A ISSUE	98A	98A	11/02/2020
99	99A ISSUE	99A	99A	11/02/2020
100	100A ISSUE	100A	100A	11/02/2020



Legend - Scope
THIS LEGEND APPLIES TO ALL NEW CONSTRUCTION PHASE DRAWINGS. DOES NOT APPLY TO EXISTING CONDITIONS.
AREA SHOWN IN GREY WASH DEPICTS SCOPE OF NO NEW WORKS
AREA SHOWN IN WHITE WASH DEPICTS SCOPE OF NEW WORKS
AREA SURROUNDED BY GREEN DASHED LINES DEPICTS TINDER OPTION

SOHT GENERAL NOTES
1. ALL DIMENSIONS AND SIZES ARE IN MILLIMETRES.
2. DO NOT SCALE DRAWINGS. USE FIGURED DIMENSIONS ONLY.
3. INFORMATION INDICATED IN THIS DOCUMENT MAY BE CRUCIAL TO THE SAFE AND PROPER FUNCTIONING OF THE SYDNEY OPERA HOUSE. DO NOT ALTER ANY ASPECT WITHOUT WRITTEN PERMISSION OF THE SYDNEY OPERA HOUSE TRUST.
4. ALL NEW WORKS MUST COMPLY WITH THE SYDNEY OPERA HOUSE BUILDING SERVICES STANDARD SPECIFICATION (BSST) AND RELEVANT AUSTRALIAN STANDARDS. NEW WORKS MUST ALSO COMPLY WITH THE REQUIREMENTS OF THE BUILDING CODES OF AUSTRALIA.

SOHT COPYRIGHT
THIS DRAWING AND DESIGN ARE SUBJECT TO COPYRIGHT AND SHALL NOT BE COPIED IN ANY FORM WITH THE WRITTEN PERMISSION OF THE SYDNEY OPERA HOUSE TRUST

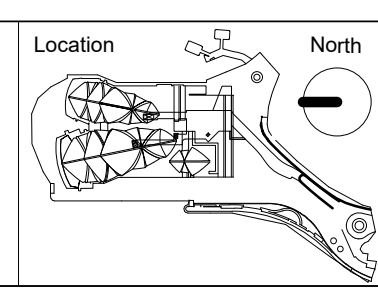

Status
DEVELOPMENT APPLICATION ISSUE
Contract BDM-168
Dwn AR Date 21/02/20
Ckd AH Scale 1:50@B1

Project
BUILDING RENEWAL PROJECT - CONCERT HALL
Title
DETAIL AREA - TIMBER ACOUSTIC DIFFUSION PANELS - BOX FRONTS

Sydney Opera House Trust GPO Box 4274 Sydney NSW Australia 2001 Phone: +61 2 9250 7541 email: info@sydneyoperahouse.com	© Sydney Opera House Trust
Location CHVA	Drawing No: 49-BR-ARM01
Sheet: DA5331	Rev: D
B1	



LEGEND - INTERNAL MATERIALS & FINISHES	
REFER TO A3031 INTERNAL MATERIALS & FINISHES SCHEDULE FOR SPECIFIC TYPES & DETAILED/PROPRIETARY DESCRIPTION	
CODE	DESCRIPTION
F	FLOORS/FLOOR COMPONENTS
FAW	ACCESS WALKWAY
FAH	FLOOR ACCESS HATCH
FEX	EXISTING FLOOR
FCA	GARRET
FCF	CONCRETE FINISH
FCO	CONCRETE
FCJ	CONTROL JOINT
FEJ	EXPANSION JOINT
FFJ	FALSE JOINT
FLA	FLOOR LADDER
FLI	LINOLEUM
FPL	PLATE
FSN	STAIR NOSING
FTI	FLOOR TILES
FTM	TIMBER
FTS	TACTILE INDICATORS
FVI	VINYL
S	STRUCTURAL COMPONENTS
SMS	METAL STUDS
SCD	SE - CONCRETE
W	WALLS/WALL COMPONENTS
WBA	WALL BATTEN
WBL	MASONRY BLOCKWORK
WEX	EXISTING WALL
WFC	COMPRESSED FIBRE CEMENT
WMR	WALL MIRROR
WMC	METAL CLADDING
WPB	WALL PLASTERBOARD
WSK	SKIRTING
WTL	WALL TILES
WTM	TIMBER
WTV	TIMBER VENEER
C	CEILINGS/CEILING COMPONENTS
CAI	CEILING INSULATION
CEX	EXISTING CEILING/SOFFIT TO REMAIN
CNC	NO CEILING
CPB	PLASTERBOARD
CSU	SUSPENDED CEILING COMPONENTS
CTV	TIMBER VENEER
US	UNDERSIDE OF EXPOSED CONCRETE SOFFIT
G	GLAZING/GLASS COMPONENTS
GGT	GLASS TYPES
M	MISCELLANEOUS FIXTURES & FITTINGS
MAC	MISCELLANEOUS ACCESSORIES
MBL	BALUSTRADES & SCREENS
MCU	CURTAIN
MFC	FIXED SHELF
MLK	LOCKER
MPR	PICTURE RAIL
MHR	HANDRAIL
B	BUILDING SERVICES (MEP FIXTURES)
BLI	LIFT
BFI	FIRE HYDRANT
BFR	FIRE HOSE REEL
P	PAINT & APPLIED FINISHES
PFR	FIRE RATED INTUMESCENT PAINT
PPF	PAINT TYPE
PRO	POWDERCOAT
PRR	PROTECTIVE COATING
PSR	SLIP RESISTANT COATING

LEGEND - PROPOSED SEATING

REFER TO THEATER CONSULTANT FOR FOR SPECIFIC TYPES & DETAILED/PROPRIETARY DESCRIPTION

	EXISTING SEAT
	PROPOSED ACCESSIBLE SEATING POSITIONS
	RELOCATED STALLS SEATS TO NEW POSITIONS AS SHOWN
	SEATS RELOCATED TO SUIT NEW FORESTAGE LIFT. REFER A334 DRAWING SERIES
	RELOCATED CHOIR SEATS TO NEW POSITIONS AS SHOWN
	SEATS TO BE MODIFIED WITH NEW QUICK RELEASE MECHANISM. REFER TS: THEATRE SPECIALISTS DETAILS
	ALLOW FOR SECOND SET OF MOUNTING HOLES FOR RELOCATED CARER SEAT
	PROPOSED CARERS SEAT WHEN ACCESSIBLE SEATING POSITION IN USE
	NOMINAL LOCATION OF SEATS TO BE REBURBISHED WITH MMA-01

GENERAL NOTES

- CONTRACTOR & SUB-CONTRACTORS TO CO-ORDINATE BETWEEN ARCHITECTURAL, STRUCTURAL & SERVICES DOCUMENTATION, WITH ARCHITECTURAL DOCUMENTATION TO TAKE PRECEDENT FOR SETOUT.
- CONTRACTOR & SUB-CONTRACTORS TO VERIFY ALL DIMENSIONS & CONFIRM ON SITE CONDITIONS RELATING TO ALL DIMENSIONS PRIOR TO COMMENCEMENT - DO NOT SCALE FROM DRAWING
- SHOP DRAWINGS ARE TO BE SUPPLIED TO THE RELEVANT PARTIES & CONSULTANTS FOR REVIEW & APPROVAL PRIOR TO THE COMMENCEMENT OF ANY WORKS
- THIS DRAWING IS TO BE READ IN CONJUNCTION WITH ALL ASSOCIATED SPECIFICATIONS, SCHEDULES & CONTRACT DOCUMENTS
- MAKE GOOD ALL AFFECTED SURFACES & FINISHES INCLUDING ITEMS MARKED FOR REMOVAL &/OR RELOCATION
- THE CONTRACTOR IS TO ALLOW TO SAND AND RE-FINISH ALL BRUSHBOX NOMINATED TO BE RE-USED THE WORKS. THIS BRUSHBOX IS TO BE INCORPORATED WHEREVER POSSIBLE WHERE WTM-02 IS NOMINATED.

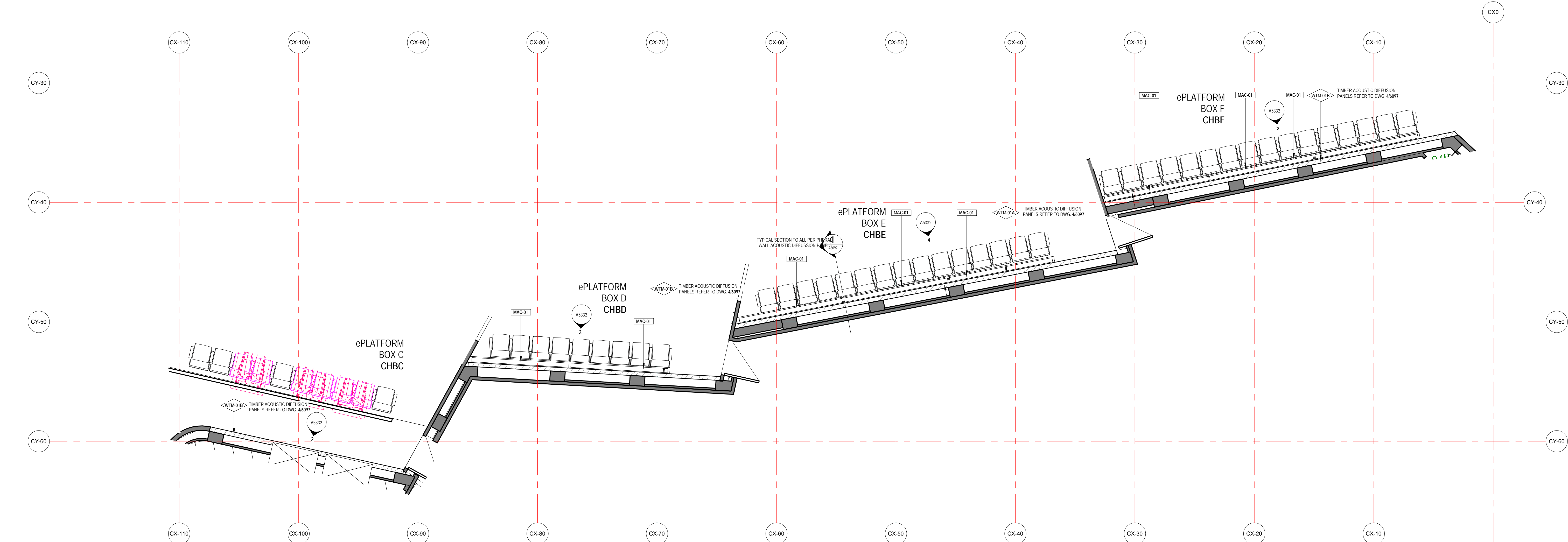
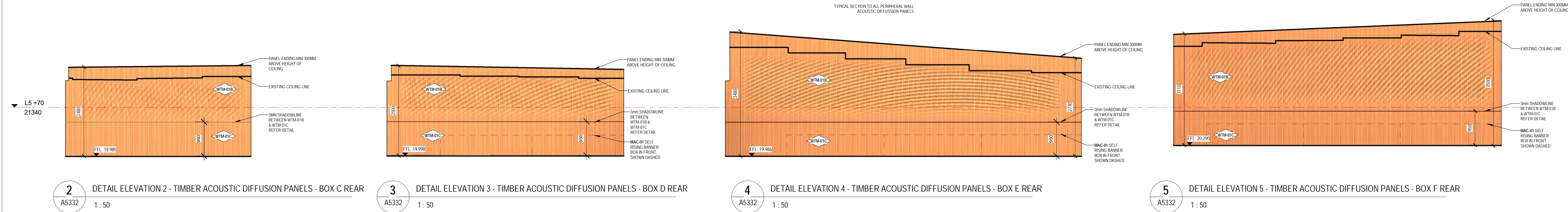

Issue	Description	Dwn	Appld	Date
1	ISSUE	10/10/2018		

**ARM**  
ARCHITECTURE  
LEVEL 11/522 KUNDELS LANE MELBOURNE VICTORIA 3000 AUS  
T 03 8613 1888 F 03 8613 1889  
mail@armarchitecture.com.au  
A001 2 475 942 350  
www.armarchitecture.com.au

LEGEND - SCOPE	
	AREA SHOWN IN GREY WASH DEPICTS SCOPE OF NO NEW WORKS
	AREA SHOWN IN WHITE WASH DEPICTS SCOPE OF NEW WORKS
	AREA SURROUNDED BY GREEN DASHED LINES DEPICTS TENDER OPTION

**SOHT GENERAL NOTES**  
1. ALL DIMENSIONS AND SIZES ARE IN MILLIMETRES.  
2. DO NOT SCALE DRAWINGS. USE FIGURED DIMENSIONS ONLY.  
3. INFORMATION INDICATED IN THIS DOCUMENT MAY BE CRUCIAL TO THE SAFE AND PROPER FUNCTIONING OF THE SYDNEY OPERA HOUSE. DO NOT ALTER ANY ASPECT WITHOUT WRITTEN PERMISSION OF THE SYDNEY OPERA HOUSE.  
4. ALL NEW WORKS MUST COMPLY WITH THE SYDNEY OPERA HOUSE BUILDING SERVICES STANDARD SPECIFICATION (BSSS) AND RELEVANT AUSTRALIAN STANDARDS. NEW WORKS MUST ALSO COMPLY WITH THE REQUIREMENTS OF THE BUILDING CODES OF AUSTRALIA.

**SOHT COPYRIGHT**  
THIS DRAWING AND DESIGN ARE SUBJECT TO COPYRIGHT AND SHALL NOT BE COPIED IN ANY FORM WITH THE WRITTEN PERMISSION OF THE SYDNEY OPERA HOUSE TRUST

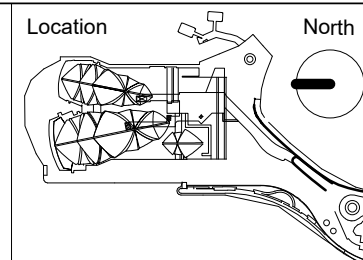

Status	
DEVELOPMENT APPLICATION ISSUE	
Contract	BDM-168
Dwn	AR
Date	21/02/2018
Ckd	AH
Scale	1:50 @ B1

Project	
BUILDING RENEWAL PROJECT - CONCERT HALL	
Title	DETAIL AREA - TIMBER ACOUSTIC DIFFUSION PANELS - WESTERN CH PERIPHERAL WALLS

Sydney Opera House Trust GPO Box 4274 Sydney NSW Australia 2001 Phone: +61 2 9250 7541 email: info@sydneyoperahouse.com		© Sydney Opera House Trust	
Location	Drawing No:	Sheet:	Rev:
CHVA	49-BR-ARM01	DA5332	D B1











## LEGEND - INTERIORS

REFER TO A0301 INTERNAL MATERIALS &  
FINISHES SCHEDULE FOR SPECIFIC TYPES &  
DETAILED/PROPRIETARY DESCRIPTION

F	CODE	DESCRIPTION
F	F	FLOOR/FLOOR COMPONENTS
FAW	FAW	ACCESS WALKWAY
FAX	FAX	FLOOR ACCESS HATCH
FE	FE	EXISTING FLOOR
FCA	FCA	FLOOR CHAIR
FCO	FCO	CONCRETE FINISH
FO	FO	CONCRETE
FJ	FJ	CONTROL JOINT
FEJ	FEJ	EXPANSION JOINT
FJL	FJL	FALSE JOINT
FCL	FCL	FLOOR LADDER
FL	FL	LINOLEUM
FLP	FLP	PLATE
FLS	FLS	START/ENDING
FLR	FLR	FLOOR TILES
FTM	FTM	TIMBER
FTS	FTS	TACHEL INDICATORS
FVI	FVI	VINYL
S	S	STRUCTURAL COMPONENTS
SMS	SMS	MEAL STUDS
SC	SC	SE: CONCRETE
W	W	WALLS/WALL COMPONENTS
WBA	WBA	WALL BATTEN
WBL	WBL	MASONRY BLOCKWORK
WEX	WEX	EXISTING WALL
WCM	WCM	COMPRESSED FIRE CEMENT
WMI	WMI	WALL MIRROR
WMC	WMC	MASONRY CEMENT
WPS	WPS	WALL PLASTERBOARD
WKB	WKB	SKIRTING
WTL	WTL	WALL TILES
WTM	WTM	TIMBER
WTV	WTV	TIMBER VENEER
C	C	CEILING/CEILING COMPONENTS
CAI	CAI	CEILING INSULATION
CAL	CAL	CEILING LAMP OFFSET TO REMAIN
CNC	CNC	MEAL CLADDING
CNL	CNL	NO CEILING
CPL	CPL	PLASTERBOARD
CSU	CSU	SUSPENDED CEILING JOISTS COMPONENTS
CU	CU	UNDERLIES OF EXPOSED CONCRETE
CU	CU	UNDERLIES OF EXPOSED CONCRETE
G	G	GLAZING/GLASS COMPONENTS
G	G	GLASS TYPES
M	M	MISCELLANEOUS FIXTURES & FITTINGS
MAC	MAC	MISCELLANEOUS ACCESSORIES
MBA	MBA	BALLUSTRADES & GORENS
MFC	MFC	FREE SHELVE
MLK	MLK	LOCKER
MNR	MNR	PICTURE RAIL
MHR	MHR	HANDRAIL
B	B	BUILDING SERVICES (MEP FIXTURES)
BJ	BJ	LIFT
BH	BH	FIRE HYDRANT
BFR	BFR	FIRE HOSE REEL
P	P	PAINT & APPLIED FINISHES
PPR	PPR	FIRE RATED INTERSECT PAINT
PPF	PPF	PAINT TYPE
PCO	PCO	POWERCOAT

### LEGEND - PROPOSED SEATING

PST STAIN SYSTEM  
REFER TO THEATER CONSULTANT FOR FOR  
SPECIFIC TYPES & DETAILED/PROPRIETARY  
DESCRIPTION

	EXISTING SEAT
	PROPOSED ACCESSIBLE SEATING POSITION
	RELOCATED STALLS SEATS TO NEW POSITIONS AS SHOWN
	SEATS RELOCATED TO SUIT NEW FLOOR LIFT. REFER <b>A33# DRAWING SERIES</b>
	RELOCATED CHAIR SEATS TO NEW POSITIONS AS SHOWN
	SEATS TO BE MODIFIED WITH NEW OIL RELEASE MECHANISM. REFER <b>THE SPECIALISTS DETAILS</b>
	ALLOW FOR SECOND SET OF MOUNTING HOLES FOR RELOCATED CARRIER SEAT
<b>CS</b>	PROPOSED CARRIERS SEAT WHEN ACCESSIBLE SEATING POSITION IN US NOMINAL LOCATION OF SEATS TO BE REBURNISHED WITH <b>MMA-01</b>
	

## GENERAL NOTES

1. CONTRACTOR & SUB-CONTRACTORS TO CO-ORDINATE BETWEEN ARCHITECTURAL, STRUCTURAL & SERVICES DOCUMENTATION, WITH ARCHITECTURAL DOCUMENTATION TO TAKE PRECEDENCE IN ANY SET-OUT
2. CONTRACTOR & SUB-CONTRACTORS TO VERIFY ALL DIMENSIONS & CONFIRM ON SITE CONDITIONS RELATING TO ALL DIMENSIONS PRIOR TO COMMENCEMENT - DO NOT SCALE FROM DRAWING
3. SHOP DRAWINGS ARE TO BE SUPPLIED TO THE RELEVANT PARTIES & CONSULTANTS FOR REVIEW & APPROVAL PRIOR TO THE COMMENCEMENT OF ANY WORKS
4. THIS DRAWING IS TO BE READ IN CONJUNCTION WITH ALL ASSOCIATED SPECIFICATIONS, SCHEDULES & CONTRACT DOCUMENTS
5. MAKE GOOD ALL AFFECTED SURFACES & FINISHES INCLUDING ITEMS MARKED FOR REMOVAL, OR RELOCATION
6. THE CONTRACTOR IS TO ALLOW TO SAND AND RE-FINISH ALL BRUSHBOX NOMINATED TO BE RE-USE THE FINISH. THIS BRUSHBOX IS TO BE DOCUMENTED WHERE POSSIBLE HOWEVER **WTM-42 IS NOMINATED**

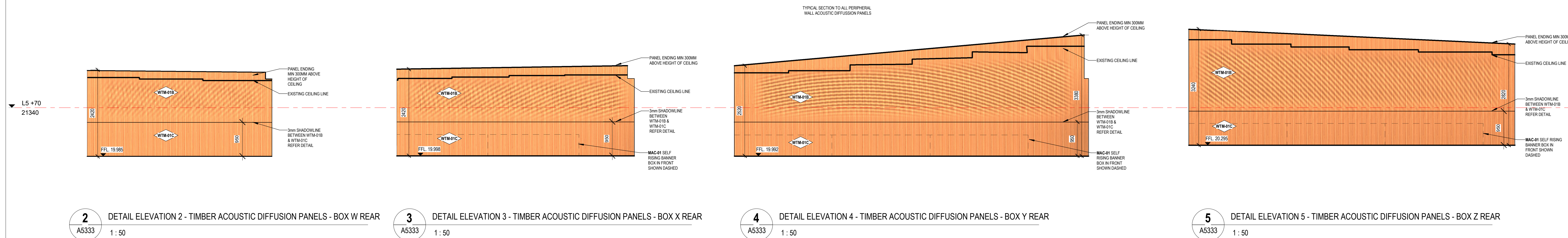

**1** DETAIL PLAN - TIMBER ACOUSTIC DIFFUSION PANELS - BOX W, X, Y & Z REAR

[illegible]

ARCHITECTURE  
LEVEL 11/522 FLINDERS LANE MELBOURNE VICTORIA 3000 AUSTRALIA  
T/ 03 8613 1888 F/ 03 8613 1889  
mail@armarchitecture.com.au  
ABN 22 476 949 399  
www.armarchitecture.com.au

LEGEND - SCOPE

(THIS LEGEND APPLIES TO ALL NEW CONSTRUCTION PHASE DRAWINGS. DOES NOT APPLY TO EXISTING CONDITIONS DRAWINGS)

AREA SHOWN IN GREY WASH DEPICTS SCOPE OF NO NEW WORKS

AREA SHOWN IN WHITE WASH  
DEPICTS SCOPE OF NEW WORKS

AREA SURROUNDED BY GREEN DASHED  
LINES DEPICTS TENDER OPTION

## SOHT GENERAL NOTES

1. ALL DIMENSIONS AND SIZES ARE IN MILLIMETRES.
2. DO NOT SCALE DRAWINGS. USE FIGURED DIMENSIONS ONLY.
3. INFORMATION INDICATED BY THE DOCUMENT TO BE CRUCIAL TO THE HOUSE DESIGN AND PROPER FUNCTIONING OF THE SYDNEY OPERA HOUSE. DO NOT ALTER ANY ASPECT WITHOUT WRITTEN PERMISSION.
4. ALL NEW WORKS MUST COMPLY WITH THE SYDNEY OPERA HOUSE BUILDING SERVICES STANDARD SPECIFICATION (BSSS) AND RELEVANT AUSTRALIAN STANDARDS. NEW WORKS MUST ALSO COMPLY WITH THE REQUIREMENTS OF THE BUILDING CODES OF AUSTRALIA.

## SOHT COPYRIGHT

THIS DRAWING AND DESIGN ARE  
SUBJECT TO COPYRIGHT AND  
SHALL NOT BE COPIED IN ANY  
FORM WITH THE WRITTEN  
PERMISSION OF THE SYDNEY  
OPERA HOUSE TRUST

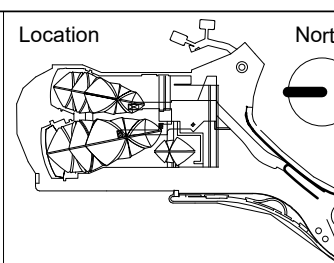

Status			
DEVELOPMENT APPLICATION ISSUE			
Contract		BDM-168	
Dwn	AR	Date	21/09/2018
Ckd	AH	Scale	1:50 @ B1

Project	BUILDING RENEWAL PROJECT - CONCERT HALL
Title	DETAIL AREA - TIMBER ACOUSTIC DIFFUSION PANELS - EASTERN CH PERIPHERAL WALLS

Sydney Opera House Trust  
GPO Box 4274 Sydney NSW Australia 2001  
Phone: +61 2 9250 7541

email: info@sydneyoperahouse.com		© Sydney Opera House Trust		
Location	Drawing No:	Sheet:	Rev:	
CHVA	49-BR-ARM01	DA5333	D	B1



[illegible]

**S** STRUCTURAL COMPONENTS  
**SMS** METAL STUDS  
**SCO** SE: CONCRETE

C	CEILINGS/CEILING COMPONENTS
CAI	CEILING INSULATION
CEX	EXISTING CEILING/SOFFIT TO REMAIN
CNC	METAL CLADDING
CNC	NO CEILING
CPB	PLASTERBOARD
CSU	SUSPENDED CEILING COMPONENTS
CTV	TIMBER VENEER
UIS	UNDERSIDE OF EXPOSED CONCRETE SOFFIT

M	MISCELLANEOUS FIXTURES & FITTINGS
MAC	MISCELLANEOUS ACCESSORIES
MBA	BALUSTRADES & SCREENS
MCU	CURTAIN
MFC	FIXED SHELF
MLK	LOCKER
MPR	PICTURE RAIL
MHR	HANDRAIL

P	PAINT & APPLIED FINISHES
PFR	FIRE RATED INTUMESCENT PAINT
PPF	PAINT TYPE
PRC	POWDER COAT

REFER TO THEATER CONSULTANT FOR FOR  
SPECIFIC TYPES & DETAILED/PROPRIETARY  
DESCRIPTION

## GENERAL NOTES

- WTM-02 IS NOMINATED**

Phone: +61 2 9250 7541  
email: [info@sydneyoperahouse.com](mailto:info@sydneyoperahouse.com)

CHVA	49-BR-ARM01	DA5334
------	-------------	--------

A1209 1-50

A1208 1:50

A1208 1 of 50

A1208 1:50

**ARM**  
ARCHITECTURE  
LEVEL 11/522 FLINDERS LANE MELBOURNE VICTORIA 3000  
T/ 03 8613 1888 F/ 03 8613 1889  
mail@armarchitecture.com.au  
ARN 22 476 949 399  
www.armarchitecture.com.au

MILLIMETRES ON ORIGINAL

### SOHT GENERAL NOTES

1. ALL DIMENSIONS AND SIZES ARE IN MILLIMETRES.
2. DO NOT SCALE DRAWINGS. USE FIGURED DIMENSIONS ONLY.
3. INFORMATION INDICATED IN THIS DOCUMENT MAY BE CRUCIAL TO THE SAFE AND PROPER FUNCTIONING OF THE SYDNEY OPERA HOUSE. DO NOT ALTER ANY ASPECT WITHOUT WRITTEN PERMISSION.
4. ALL NEW WORKS MUST COMPLY WITH THE SYDNEY OPERA HOUSE BUILDING SERVICES STANDARD SPECIFICATION (BSSS) AND RELEVANT AUSTRALIAN STANDARDS. NEW WORKS MUST ALSO COMPLY WITH THE REQUIREMENTS OF THE BUILDING CODES OF AUSTRALIA.

---

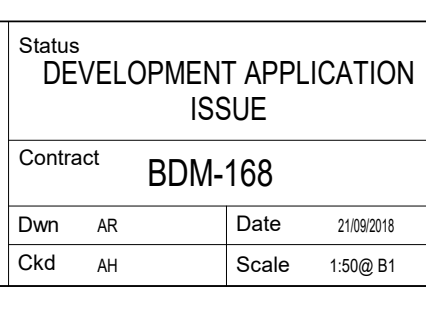

<b>WTM-02 is NOMINATED</b>			
Sydney Opera House Trust GPO Box 42/14 Sydney NSW Australia 2001 Phone: +61 2 9250 7541 email: <a href="mailto:info@sydneyoperahouse.com">info@sydneyoperahouse.com</a>			
			
		© Sydney Opera House Trust	
Location	Drawing No:	Sheet:	Rev:
CHVA	49-BR-ARM01	DA5334	D B1