

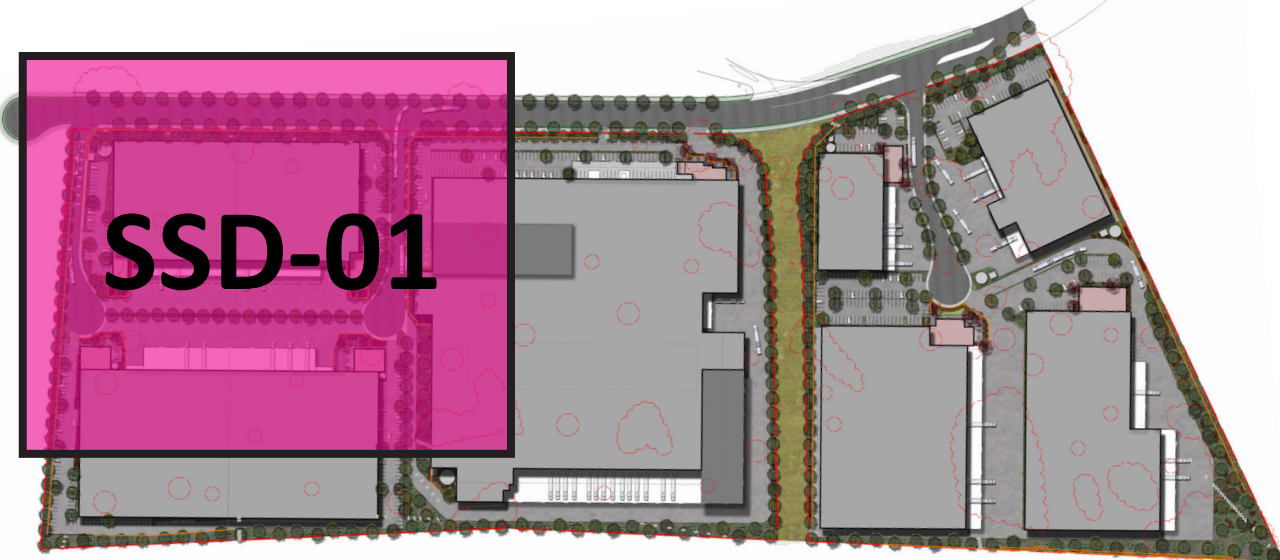

KEY PLAN



LEGEND

- SITE BOUNDARY
- EXISTING TREE TO BE REMOVED
- COPSE OF TREES TO BE REMOVED
- CANOPY TREE PLANTING WITHIN LANDSCAPE BUFFER ZONES AND TO INTERNAL ESTATE
- SCREEN AND SHRUB PLANTING
- FLOWERING DECIDUOUS TREE PLANTING AROUND OFFICE BUILDINGS
- MASS PLANTED AREAS OF GROUNDCOVERS AND LOW SHRUBS
- MAJOR DESIGN CONTOURS (TO CIVIL DETAILS)
- SECTION LOCATIONS (REFER TO SSD08 - SSD10)
- RETAINING WALL
- TURF

**NOTE:**  
DUE TO THE EXTENT OF THE DEVELOPMENT, TREE RETENTION MAY PROVE DIFFICULT. HOWEVER, EXISTING TREES SHOULD BE RETAINED WHEREVER POSSIBLE. THIS WILL BE SUBJECT TO AN ARBORIST ASSESSMENT.

Revision		FOR STATE SIGNIFICANT DEVELOPMENT			
Rev	Date	Description	Drawn	Checked	
A	28.09.2017	FOR SSD - DRAFT	CL	BG	
B	12.10.2017	FOR SSD	JT	BG	
C	14.11.2017	FOR SSD	JT	BG	





KEY PLAN

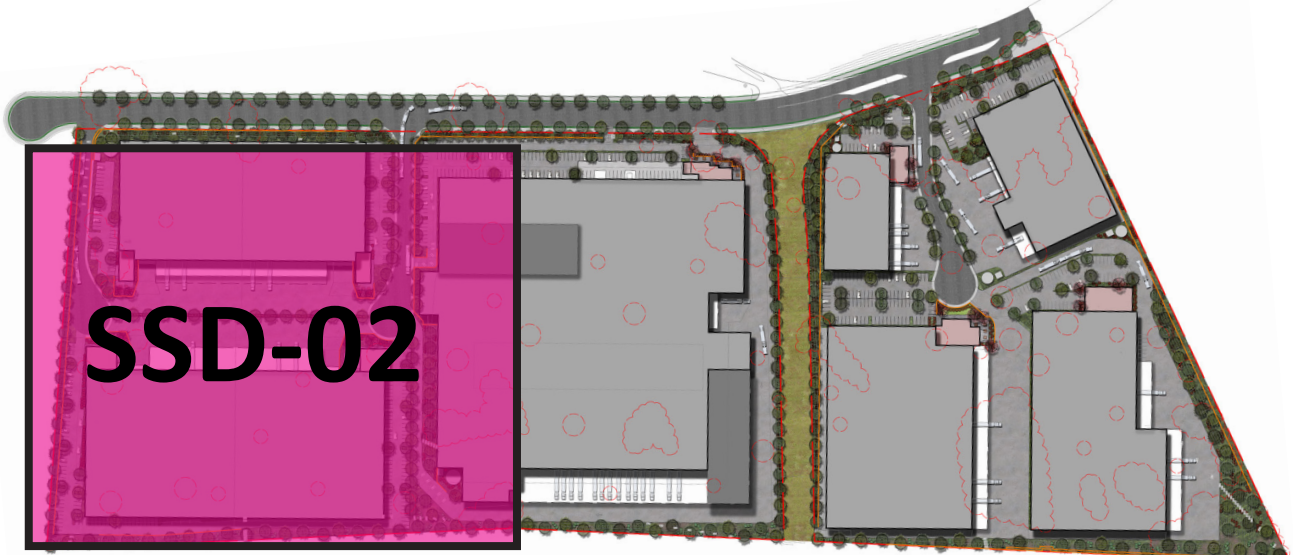

LEGEND

- SITE BOUNDARY
- EXISTING TREE TO BE REMOVED
- COPSE OF TREES TO BE REMOVED
- CANOPY TREE PLANTING WITHIN LANDSCAPE BUFFER ZONES AND TO INTERNAL ESTATE
- SCREEN AND SHRUB PLANTING
- FLOWERING DECIDUOUS TREE PLANTING AROUND OFFICE BUILDINGS
- MASS PLANTED AREAS OF GROUNDCOVERS AND LOW SHRUBS
- MAJOR DESIGN CONTOURS (TO CIVIL DETAILS)
- SECTION LOCATIONS (REFER TO SSD08 - SSD10)
- RETAINING WALL

**NOTE:**  
DUE TO THE EXTENT OF THE DEVELOPMENT, TREE RETENTION MAY PROVE DIFFICULT. HOWEVER, EXISTING TREES SHOULD BE RETAINED WHEREVER POSSIBLE. THIS WILL BE SUBJECT TO AN ARBORIST ASSESSMENT.

Revision		FOR STATE SIGNIFICANT DEVELOPMENT			
Rev	Date	Description	Drawn	Checked	
A	28.09.2017	FOR SSD - DRAFT	CL	BG	
B	12.10.2017	FOR SSD	JT	BG	
C	14.11.2017	FOR SSD	JT	BG	