

1 GROUND FLOOR - CAMPUS PLAN
1 : 500

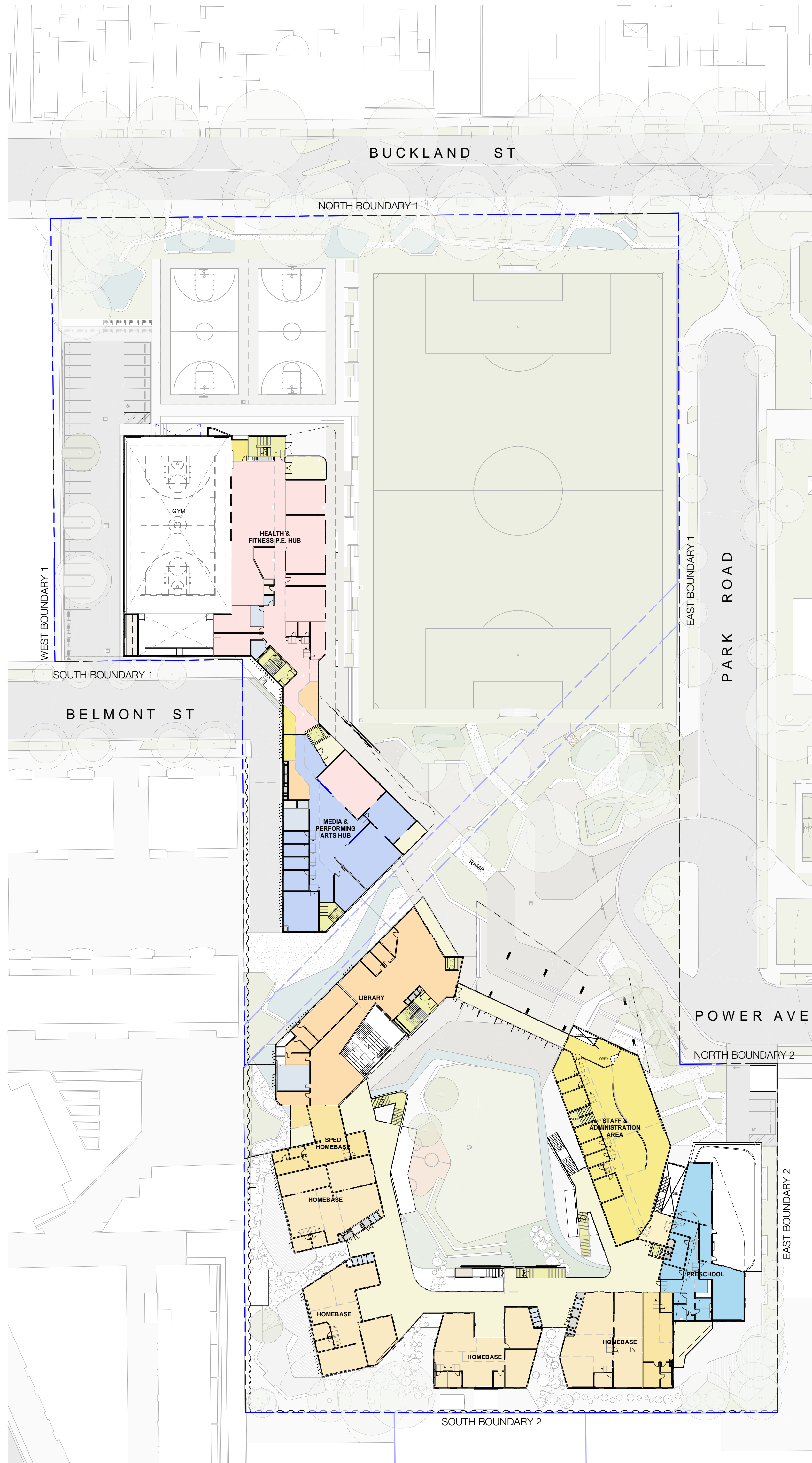

2 FIRST FLOOR - CAMPUS PLAN
1 : 500

CLIENT	DEPARTMENT OF EDUCATION
T	+ 61 2 9561 1927
F	+ 61 2 9561 8077
LANDSCAPE CONSULTANT	
CONTEXT	T + 61 2 8244 8900
STRUCTURAL & CIVIL CONSULTANT	WOOLACOTTS
GEOTECHNICAL CONSULTANT	J+K GROUP
BUILDING SERVICES CONSULTANTS	UMOW LAI
ESD CONSULTANT	UMOW LAI
NCC/BCA & ACCESS CONSULTANT	DESIGN CONFIDENCE
SITE INVESTIGATION & ENVIRONMENTAL ASSESSMENT	COFFEY
TRAFFIC CONSULTANT	ARUP
BIODIVERSITY CONSULTANT	UBM ECOLOGICAL
ARBORIST	REDGUM HORTICULTURAL
EUROPEAN AND ABORIGINAL ARCHAEOLOGY	EXTENT
ACOUSTIC CONSULTANT	WILKINSON MURRAY
WASTE MANAGEMENT CONSULTANT	FORESIGHT ENVIRONMENTAL
WIND & REFLECTIVITY CONSULTANT	WINDTECH
3D RENDERER	NARRATIVE
LAND SURVEYOR	LTS LOCKLEY
QUANTITY SURVEYOR	TURNER & TOWNSEND
TOWN PLANNER & SOCIAL IMPACT CONSULTANT	URBIS

NSW Nominated Architects: Robert Denton Reg. No. 5782, Alex Kibble Reg. No. 6015

Do not scale drawings. Verify all dimensions on site. Notify architect of all discrepancies

Rev	Date	Description	Checked	Auth
P1	08.12.17	Issue For SSDA	AH	AK

NOT FOR CONSTRUCTION

Project
ALEXANDRIA PARK COMMUNITY SCHOOL

Drawing Title
CAMPUS PLANS - GROUND AND FIRST FLOORS

Proj. Dir	Proj. Arch	Drawn
AK	AH	BO/HC
Job No.	Sheet	Scale
161044	B1	1 : 500

Drawing No. **AR.DA. 2001** P1

Tanner Kibble Denton Architects Pty Ltd
PO Box 660 Darlinghurst NSW 1300 Australia
Level 1, 19 Foster Street, Surry Hills NSW 2010 Australia
T +61 2 9281 4399
F +61 2 9281 4337
www.tkda.com.au