



Corymbia gummifera



Eucalyptus punctata



Banksia spinulosa



Callistemon 'Better John'



Grevillea juniperus 'Gold Cluster'



Hardenbergia violacea



Hibbertia scandens



Anigozanthos 'Ruby Velvet'



Anigozanthos 'Gold Velvet'



Carex appressa



Ficinia nodosa



Juncus usitatus



Lomandra 'Hystix'



Lomandra longifolia



Lomandra 'Tanika'



Pennisetum alopecuroides



Themeda australis

ID	Botanical Name	Scheduled Size
Trees		
CG	Corymbia gummifera	100L
EP	Eucalyptus punctata	100L
Shrubs		
BS	Banksia spinulosa	200mm
CBJ	Callistemon 'Better John'	200mm
GJ	Grevillea juniperus 'Gold Cluster'	200mm
Ground Covers		
HV	Hardenbergia violacea	200mm
HS	Hibbertia scandens	200mm
Grasses		
ARV	Anigozanthos 'Ruby Velvet'	200mm
AGV	Anigozanthos 'Gold Velvet'	200mm
CAA	Carex appressa	150mm
FN	Ficinia nodosa	150mm
JU	Juncus usitatus	150mm
LH	Lomandra 'Hystrix'	200mm
LOL	Lomandra longifolia	200mm
LT	Lomandra 'Tanika'	150mm
PA	Pennisetum alopecuroides	150mm
PLE	Poa labillardieri 'Eskerdale'	150mm
TA	Themeda australis	150mm
Total		

1,294m2 TURF
APPROX. 1,294 TURF ROLL
SPECIES: Zoysia 'Empire'

Issue			
No.	Date	Description	Chkd
A	14/06/2019	PRELIMINARY	JH, AW
C	12/07/2019	PRELIMINARY SS DA	JH
D	22/07/2019	SS DA	JH
E	21/04/2020	SS DA	MD
F	04/12/2020	SS DA	BR

Disclaimer
The contractor intending to use these documents shall check and verify all works on site and report any discrepancy to the Landscape Architect prior to commencement. Failure to do so shall not be the responsibility of the Client or Landscape Architect.

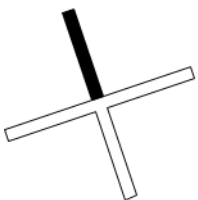

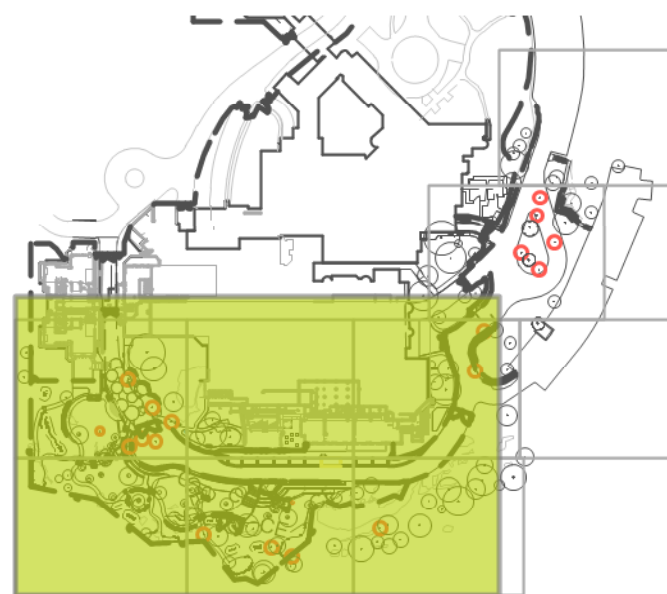

LEGEND

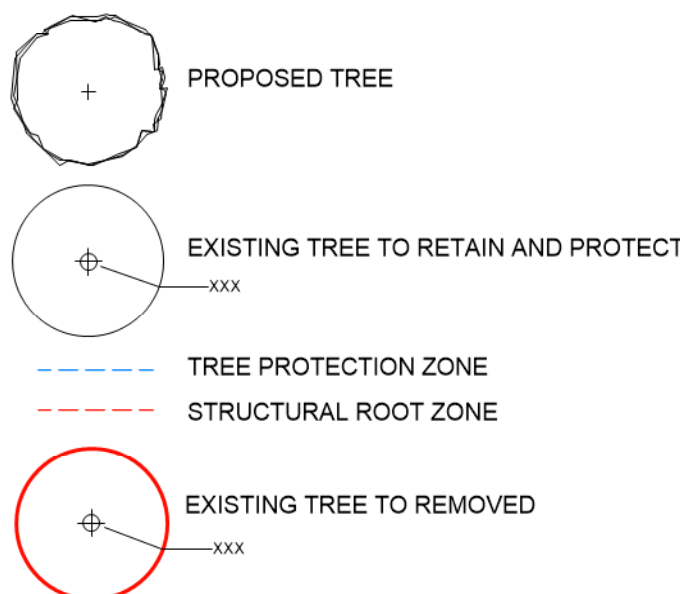

NOTE

Tree information (numbering, TPZ and SRZ) matches reports prepared by McArdle Arboricultural Consultancy.

Report 1: Arboricultural Impact and Tree Risk Assessment - 17th of April, 2020
Report 2: Addendum Arboricultural Impact Assessment - 22nd of May, 2020

Tree Codes:

T000 - refers to trees numbered in Report 1
A000 - refers to trees numbered Report 2
XXX - Unidentified specimen

Issue

No.	Date	Description	Chkd
A	26/08/2020	SS DA	DH
B	04/12/2020	SS DA	BR

Disclaimer

The contractor intending to use these documents shall check and verify all works on site and report any discrepancy to the Landscape Architect prior to commencement. Failure to do so shall not be the responsibility of the Client or Landscape Architect.

Landscape Architect

Level 3, 4 Glen Street, Milsoms Point. NSW 2061 Australia
T: 61 2 9922 2344 F: 61 2 9922 1308
E: architects@nbrsarchitecture.com W: nbrsarchitecture.com

Any form of replication of this drawing in full or in part without the written permission of NBR & PARTNERS Pty Ltd constitutes an infringement of the copyright.
ABN 16 002 247 565 © 2020

Project

Lindfield Learning Centre

at

ETON ROAD, LINDFIELD NSW

Client

SCHOOL INFRASTRUCTURE NSW

Drawing Title

TREE LOCATION PLAN 1

Date 04/12/2020

Scale 1:250

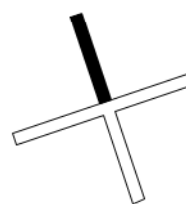

Project No. Sheet No. Revision No.

20203 LA-2-4001 B

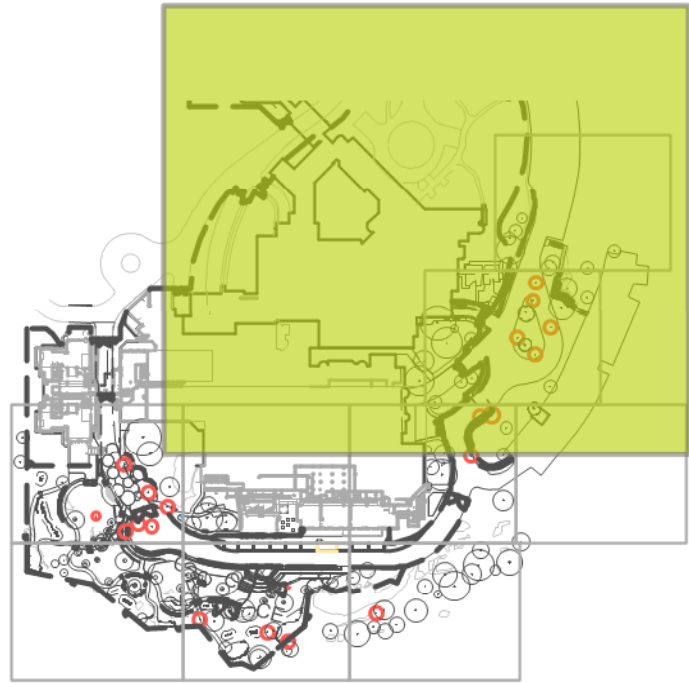
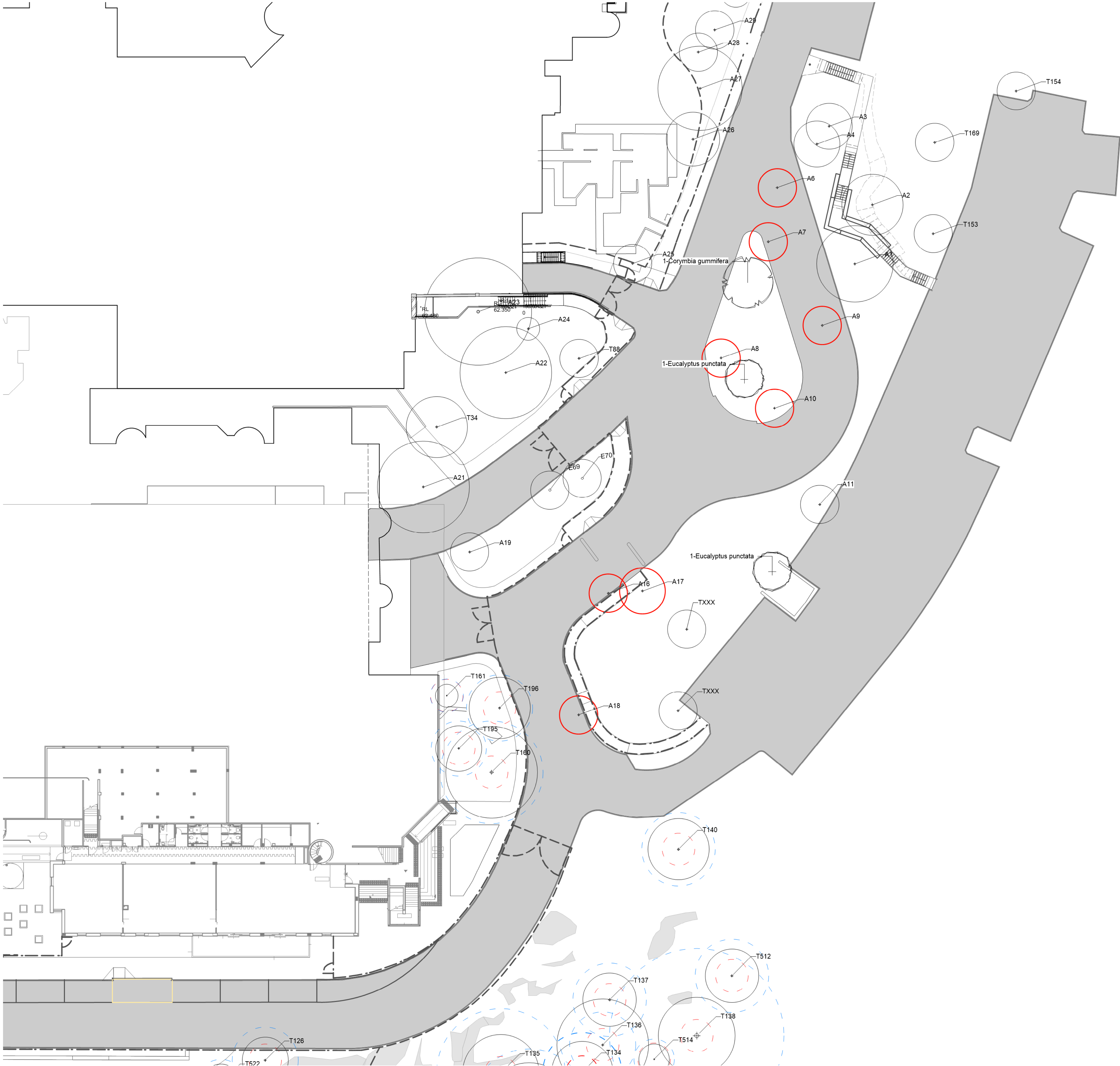

LEGEND

- PROPOSED TREE
- EXISTING TREE TO RETAIN AND PROTECT
- TREE PROTECTION ZONE
- STRUCTURAL ROOT ZONE
- EXISTING TREE TO REMOVED

NOTE

Tree information (numbering, TPZ and SRZ) matches reports prepared by McArdle Arboricultural Consultancy.

Report 1: Arboricultural Impact and Tree Risk Assessment - 17th of April, 2020
Report 2: Addendum Arboricultural Impact Assesment - 22nd of May, 2020

Tree Codes:
T000 - refers to trees numbered in Report 1
A000 - refers to trees numbered Report 2
XXX - Unidentified specimen

Issue				
No.	Date	Description	Chkd	
A	26/08/2020	SS DA	DH	
B	04/12/2020	SS DA	BR	
C	09/12/2020	SS DA	BR	

Disclaimer
The contractor intending to use these documents shall check and verify all works on site and report any discrepancy to the Landscape Architect prior to commencement. Failure to do so shall not be the responsibility of the Client or Landscape Architect.

Landscape Architect

NBR
ARCHITECTURE
LANDSCAPE

Level 3, 4 Glen Street, Milsons Point, NSW 2061 Australia
T: 61 2 9922 2344 F: 61 2 9922 1308
E: architects@nbrsarchitecture.com W: nbrsarchitecture.com

Any form of replication of this drawing in full or in part without the written permission of NBR & PARTNERS Pty Ltd constitutes an infringement of the copyright.
ABN 16 002 247 565 © 2020

Project
Lindfield Learning Centre

at
ETON ROAD, LINDFIELD NSW

Client
SCHOOL INFRASTRUCTURE NSW

Drawing Title
TREE LOCATION PLAN 2

Date 09/12/2020
Scale 1:250

Project No. Sheet No. Revision No.
20203 LA-2-4002 C