

SCHEDULE OF SIGNIFICANT ELEMENTS

LINDFIELD LEARNING VILLAGE

28 NOVEMBER 2017
RESPONSE TO SUBMISSIONS
PREPARED FOR DESIGNINC

URBIS

1. SCHEDULE OF SIGNIFICANT ELEMENTS

1.1. METHODOLOGY

The high-level mapping accompanying this schedule of significant elements separately identifies gradings of significance both for **fabric** and for **spaces** in accordance with the modified gradings of significance developed by the Heritage Council of NSW as set out in the below section.

Note that in some instances, the significance of a space may be higher than the fabric that defines the space. This means that while the fabric defining the space may be less remarkable, the contribution that it makes to the volume of the space should be retained if the fabric is replaced i.e. new walls on the same axis as those existing to retain the main 'street'.

In general, the approach to the application of significance gradings on the site is as follows.

Fabric of exceptional significance is confined to the characteristic facades on the first two stages of the building and concrete stairs within the main circulation spine. **Exceptional spaces** are confined to the main internal circulation spine and the courtyards which incorporate remnant bushland and are therefore strongly indicative of the design intent to maintain a connection with the natural landscape. The gradings applied to the landscape by landscape heritage specialist Chris Betteridge of Musecape have been utilised in this significance mapping.

Fabric of High Significance is applied to original off form concrete including walls and stairs (not within the main circulation spine). It also applies to original brick walls where they bound spaces of high significance. **Highly significant spaces** are those which are representative of the 'Italian Village Street' design concept and which aren't on the main Level 5. Further, highly significant spaces are those which strongly represent the historic use of the place as well as its character i.e. the library and the auditoriums.

Fabric of moderate significance is that which is original and which in some cases defines the central 'streets' however which does not individually constitute remarkable fabric, such as masonry walls. **Moderate spaces** are those which are directly associated with the original use of the place but which are not remarkable spaces individually including classrooms. Central corridors which aren't on the main floor (level 5) and aren't within the first two stages of development are also graded moderate.

Fabric of little significance is unremarkable fabric located within the later stages (3, 4 and 5) and minor partitions walls within secondary spaces in Stages 1 and 2. **Spaces of little significance** are spaces which were later extensions to the building (including spaces within Stage 4 and 5). Spaces which are original but ancillary to the primary teaching use of other spaces, such as small offices and storerooms, are also graded as being of little significance.

Recent internal additions/alterations to the building (i.e. glazed partitions) are identified as neutral. Neutral spaces are those which may be original but have been altered.

1.2. LEVELS AND GRADING OF SIGNIFICANCE

The Heritage Council of NSW recognises four levels of heritage significance in NSW: Local, State, National and World. The level indicates the context in which a heritage place/item is important (e.g. local heritage means it is important to the local area or region). Heritage places that are rare, exceptional or outstanding beyond the local area or region may be of State significance.

In most cases, the level of heritage significance for a place/item has a corresponding statutory listing and responsible authority for conserving them.

Different components of a place may contribute in different ways to its heritage value. The gradings of significance developed by the Heritage Council of NSW have been modified as part of this report as follows:

Table 1 – Gradings of significance.

Grading	Justification	Status
Exceptional	Rare or outstanding elements that directly contribute to the place's overall heritage significance; they retain a high degree of integrity and intactness in fabric or use; any change should be minimal and retain significant values or fabric	Fulfil criteria for local or state listing
High	Element demonstrates a key aspect of the place's overall heritage significance; they have a high degree of original fabric or they retain their original use; alterations do not detract from significance	Fulfil criteria for local or state listing
Moderate	Element contributes to the place's overall heritage significance; they may have been altered but they still have the ability to demonstrate a function or use particular to the site; change is allowed so long as it does not adversely affect the place's overall heritage significance	Fulfil criteria for local listing
Little	Element may be difficult to interpret or may have been substantially modified which detracts from its heritage significance; change is allowed so long as it does not adversely affect the place's overall heritage significance	Does not fulfil criteria for local or state listing
Neutral	Elements do not add or detract from the site's overall heritage significance; change allowed	Does not fulfil criteria for local or state listing
Intrusive	Elements are damaging to the place's overall heritage significance; can be considered for removal or alteration	Does not fulfil criteria for local or state listing

2. SCHEDULE OF ELEMENTS

2.1. OVERALL FORMS

Table 2 – General

Element	Stage	Grading
Overall form	Stage 1	Exceptional
	Stage 2	Exceptional
	Stage 3	Moderate
	Stage 4	Moderate
	Stage 5	Moderate
Link Bridge	Stage 3	High
Gatehouse	Stage 1	High
Caretaker's residence	Stage 1	High
Child-care Centre	Stage 2	Low
Shed	Stage 2	Intrusive

2.2. EXTERNAL FABRIC

Table 3 – External fabric

Element	Stage	Grading
Face brick	Stage 1	High
	Stage 3	Moderate
	Stage 5	Moderate
Pre-cast concrete sun shades.	Stage 1	High
	Stage 4 - 5	Moderate
Concrete stairwells	Stage 1	High
Windows	Stage 1 and 2	Moderate
	Stage 2 -5	Little
Paving	Stage 1	Moderate

2.3. INTERNAL SPACES

Table 4 – Internal spaces

Element	Period	Grading
Main entry	Stage 2	Exceptional
Main circulation corridor	Stage 2	Exceptional (L5 and L6) High (L4) Moderate (L2 and L3)
Greenhalgh Auditorium	Stage 2	High
Library	Stage 1 Stage 1 infill (L3)	High Moderate
Cafeteria	Stage 2	High
Classrooms (intact)	Stage 1 and 2 Stage 3 and 5	Moderate Little
Classrooms (altered)	Throughout	Neutral
Offices	Throughout	Little
Toilets	Throughout	Little

2.4. INTERNAL FABRIC

Table 5 – Internal fabric

Element	Period	Grading
Face brickwork walls (to corridors)	Stage 1 and 2 Stage 4 Stage 3 and 5	Moderate/High (where walls bound spaces of high significance) Moderate Little
Off form concrete walls	Stage 1 and 2 Stage 3 and 4	High Moderate
Concrete Columns	Stage 1 and 2 Stage 3	High Moderate
Original partition walls	Throughout	Little
Later lazed walls/partition walls	Later	Neutral
Stairs	Stage 1 and 2 (Main corridor)	Exceptional

Element	Period	Grading
	Stage 1 and 2 (elsewhere)	High
	Stage 3 - 5	Moderate
Lifts	Stage 1	Moderate
	Stage 4 – 5	Little
Timber ceiling lining	Stage 1	High
Waffle slab ceiling	Throughout	High
Panelled ceiling system	Stage 1	Moderate
Green carpet	Stage 1 and 2	High
Handrails (painted pink)	Stage 1 and 2	High
Built in furniture	Stage 1 and 2	
Benches		High
Cupboards and notice boards		Moderate

2.5. LANDSCAPE ELEMENTS

Table 6 – Landscape

Element	Period	Location	Grading
Main entry			Exceptional
Rooftop gardens	Stage 1	Roof of building 12	Exceptional
Plantings	Altered		
Central courtyard			High
Fountain/water feature	Stage 2		High
Oval	Stage 2		High
Bus Bay			High
Bushland island			High
Bus shelter	Later		Neutral
North-West Carpark	1975		Low
East carparks	Stage 1		Moderate
	Later		Little
Tennis and basketball courts	Stage 2	South of oval	Moderate
Road cutting		Between Stage 2 and Gymnasium	High



Element	Period	Location	Grading
Rock fill oval batter		South edge of oval	Exceptional
Large Rock outcrop		South of buildings 12 and 13	Exceptional
Rock infill in cuttings		Main road cutting east of Building 7	High
Road Cutting		East of Building 7	High



3. SIGNIFICANCE MAPPING

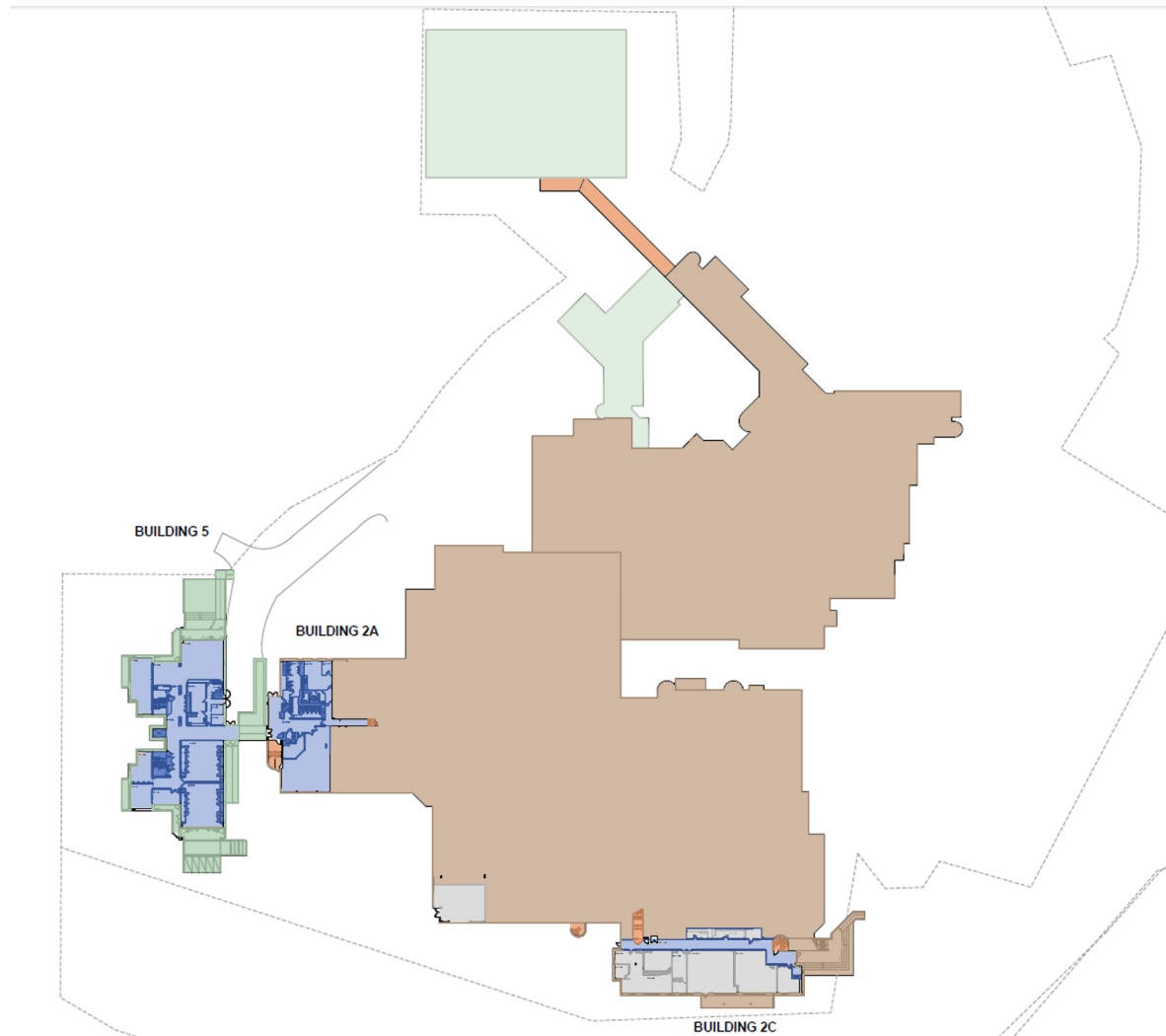

- Exceptional Significance (fabric)
- Exceptional Significance (spaces)
- High Significance (fabric)
- High Significance (spaces)
- Moderate Significance (fabric)
- Moderate Significance (spaces)
- Little Significance (fabric)
- Little Significance (spaces)
- Neutral (fabric)
- Neutral (spaces)
- Intrusive (fabric)
- Intrusive (spaces)

This plan graphically shows general gradings of significance. Refer to the Schedule of Elements for methodology and grading of significance for individual elements.

NOTE: Ancillary spaces including classrooms and store rooms are attributed little significance. However, many spaces of little significance contribute to the definition of highly significant spaces. The attributed level of significance of adjacent spaces must be considered when altering the proportions of spaces of little significance.

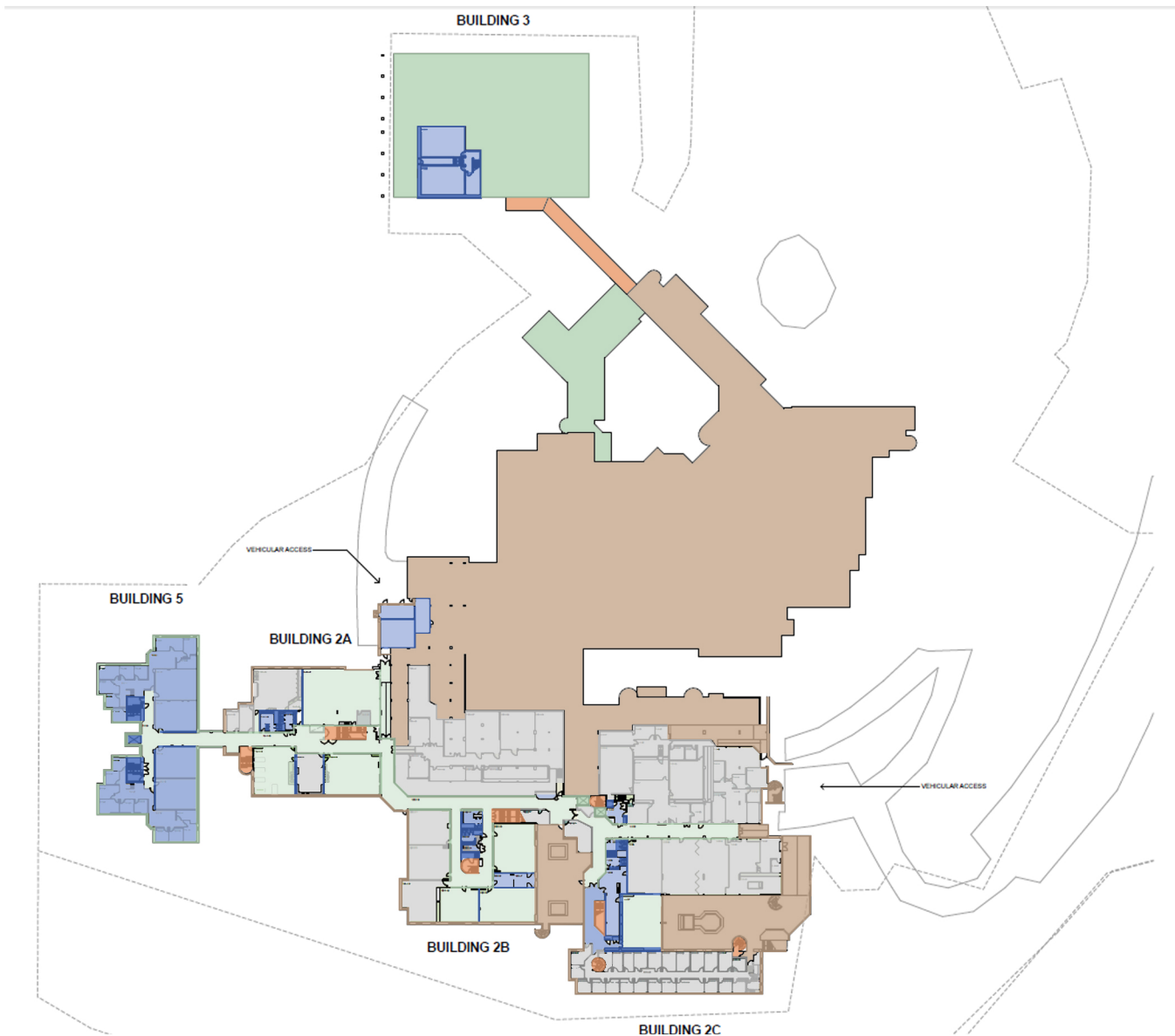

- Exceptional Significance (fabric)
- Exceptional Significance (spaces)
- High Significance (fabric)
- High Significance (spaces)
- Moderate Significance (fabric)
- Moderate Significance (spaces)
- Little Significance (fabric)
- Little Significance (spaces)
- Neutral (fabric)
- Neutral (spaces)
- Intrusive (fabric)
- Intrusive (spaces)

This plan graphically shows general gradings of significance. Refer to the Schedule of Elements for methodology and grading of significance for individual elements.

NOTE: Ancillary spaces including classrooms and store rooms are attributed little significance. However, many spaces of little significance contribute to the definition of highly significant spaces. The attributed level of significance of adjacent spaces must be considered when altering the proportions of spaces of little significance.