

CLIENT:



ARUP

ENGINEERS

ARUP

O C U L U S

LANDSCAPE

OCULUS



PLANNER

URBIS

KEY PLAN:

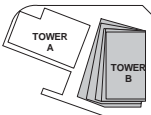

KEY SECTION:

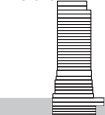

PROJECT:

Wanda Vista Sydney

1 Alfred Street Sydney NSW 2000



A	26.10.2016	ISSUED FOR STAGE 2 DEVELOPMENT APPLICATION	SH
ISSUE	DATE	REVISION	BY

DRAWING TITLE:

PERSPECTIVE - HOTEL LOBBY 02

DATE:	SCALE:	DRAWING No:	REV:
17.10.2016	1:1 @ A1	0608	A
DRAWN BY:	PROJECT NO:		
KKAA, CRONE	CA3054		

DA ISSUE

NOTES:
All dimensions and setbacks to be verified prior to commencement, omissions or discrepancies to be notified to the architect.

COPYRIGHT:
The copyright of this drawing together with any other documents prepared by crone partners architecture studios, pty ltd (cp) remains the property of cp. crone partners grants licence for the use of this document for the purpose for which they are intended. This licence is not transferable without the permission of cp.

NORTH



DO NOT SCALE



1 PERSPECTIVE - HOTEL LOBBY HERALD SQUARE
SCALE 1:1

CLIENT:



ARUP

ENGINEERS

ARUP

O C U L U S

LANDSCAPE

OCULUS



PLANNER

URBIS

KEY PLAN:

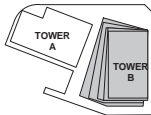

KEY SECTION:

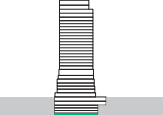

PROJECT:

Wanda Vista Sydney

1 Alfred Street Sydney NSW 2000

- PROPERTY LINE BOUNDARY
- APPROVED SIDA ENVELOPE
- PROPOSED SIDA ENVELOPE
- EARTH
- LANDSCAPE
- LANDSCAPE with service exhaust provision
- BASEMENT STORAGE
- WATER FEATURE

A	28.10.2016	ISSUED FOR STAGE 2 DEVELOPMENT APPLICATION	SH
7	20.10.2016	DRAFT FOR DA SUBMISSION	SH
6	12.10.2016	ISSUED FOR INFORMATION	SH
5	05.10.2016	ISSUED FOR INFORMATION AND COORDINATION ONLY	SH
4	30.09.2016	ISSUED FOR INFORMATION AND COORDINATION ONLY	SH
3	20.09.2016	ISSUED FOR INFORMATION AND COORDINATION ONLY	SH
2	12.09.2016	ISSUED FOR INFORMATION AND COORDINATION ONLY	SH
1	06.09.2016	ISSUED FOR INFORMATION AND COORDINATION ONLY	SH
ISSUE	DATE	REVISION	BY

DRAWING TITLE:

BASEMENT 6 - RESIDENTIAL

DATE:	SCALE:	DRAWING No:	REV:
17.10.2016	As indicated @A1		
DRAWN BY:	PROJECT NO:	1000	A
EM.DE.DP.SH	CA3054		

DA ISSUE

NOTES:

All dimensions and setbacks to be verified prior to commencement, omissions or discrepancies to be notified to the architect.

COPYRIGHT:

The copyright of this drawing together with any other documents prepared by crone partners architecture studios, pty ltd (cp) remains the property of cp. crone partners grants license for the use of this document for the purpose for which they are intended. This license is not transferable without the permission of cp.

NORTH



DO NOT SCALE

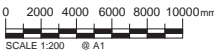

CLIENT:



ARUP

ENGINEERS

ARUP

O C U L U S

LANDSCAPE

OCULUS



PLANNER

URBIS

KEY PLAN:

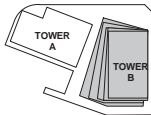

KEY SECTION:

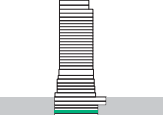

PROJECT:

Wanda Vista Sydney

1 Alfred Street Sydney NSW 2000

- PROPERTY LINE BOUNDARY
- APPROVED S1 DA ENVELOPE
- PROPOSED S1 DA ENVELOPE
- EARTH
- LANDSCAPE
- LANDSCAPE with service exhaust provision
- BASEMENT STORAGE
- WATER FEATURE

A	28.10.2016	ISSUED FOR STAGE 2 DEVELOPMENT APPLICATION	SH
7	20.10.2016	DRAFT FOR DA SUBMISSION	SH
6	12.10.2016	ISSUED FOR INFORMATION	SH
5	05.10.2016	ISSUED FOR INFORMATION AND COORDINATION ONLY	SH
4	30.09.2016	ISSUED FOR INFORMATION AND COORDINATION ONLY	SH
3	20.09.2016	ISSUED FOR INFORMATION AND COORDINATION ONLY	SH
2	12.09.2016	ISSUED FOR INFORMATION AND COORDINATION ONLY	SH
1	06.09.2016	ISSUED FOR INFORMATION AND COORDINATION ONLY	SH
ISSUE	DATE	REVISION	BY

DRAWING TITLE:

BASEMENT 5 - RESIDENTIAL

DATE:	SCALE:	DRAWING No:	REV:
17.10.2016	As indicated @A1		
DRAWN BY:	PROJECT NO:	1001	A
EM.DE.DP.SH	CA3054		

DA ISSUE

NOTES:

All dimensions and setbacks to be verified prior to commencement, omissions or discrepancies to be notified to the architect.

COPYRIGHT:

The copyright of this drawing together with any other documents prepared by crone partners architecture studios, pty ltd (cp) remains the property of cp. crone partners grants license for the use of this document for the purpose for which they are intended. This license is not transferable without the permission of cp.

NORTH



DO NOT SCALE

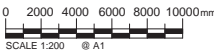

CLIENT:



ARUP

ENGINEERS

ARUP

O C U L U S

LANDSCAPE

OCULUS



PLANNER

URBIS

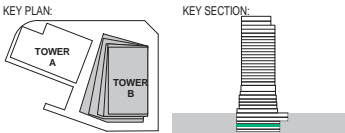

PROJECT:

Wanda Vista Sydney

1 Alfred Street Sydney NSW 2000

- PROPERTY LINE BOUNDARY
- APPROVED SIDA ENVELOPE
- PROPOSED SIDA ENVELOPE
- EARTH
- LANDSCAPE
- LANDSCAPE with service exhaust provision
- BASEMENT STORAGE
- WATER FEATURE

A	28.10.2016	ISSUED FOR STAGE 2 DEVELOPMENT APPLICATION	SH
7	20.10.2016	DRAFT FOR DA SUBMISSION	SH
6	12.10.2016	ISSUED FOR INFORMATION	SH
5	05.10.2016	ISSUED FOR INFORMATION AND COORDINATION ONLY	SH
4	30.09.2016	ISSUED FOR INFORMATION AND COORDINATION ONLY	SH
3	20.09.2016	ISSUED FOR INFORMATION AND COORDINATION ONLY	SH
2	12.09.2016	ISSUED FOR INFORMATION AND COORDINATION ONLY	SH
1	06.09.2016	ISSUED FOR INFORMATION AND COORDINATION ONLY	SH
ISSUE	DATE	REVISION	BY

DRAWING TITLE:

BASEMENT 4 - RESIDENTIAL

DATE:	SCALE:	DRAWING No:	REV:
17.10.2016	As indicated @A1		
DRAWN BY:	PROJECT NO:	1002	A
EM.DE.DP.SH	CA3054		

DA ISSUE

NOTES:
All dimensions and setbacks to be verified prior to commencement, omissions or discrepancies to be notified to the architect.
COPYRIGHT:
The copyright of this drawing together with any other documents prepared by crone partners architecture studios, pty ltd (cp) remains the property of cp. crone partners grants license for the use of this document for the purpose for which they are intended. The license is not transferable without the permission of cp.

NORTH



DO NOT SCALE

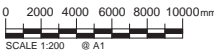

CLIENT:



ARUP

ENGINEERS

ARUP

O C U L U S

LANDSCAPE

OCULUS



PLANNER

URBIS

KEY PLAN:

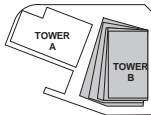

KEY SECTION:

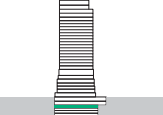

PROJECT:

Wanda Vista Sydney

1 Alfred Street Sydney NSW 2000

- PROPERTY LINE BOUNDARY
- APPROVED SIDA ENVELOPE
- PROPOSED SIDA ENVELOPE
- EARTH
- LANDSCAPE
- LANDSCAPE with service exhaust provision
- BASEMENT STORAGE
- WATER FEATURE

ISSUE	DATE	REVISION	BY
A	28.10.2016	ISSUED FOR STAGE 2 DEVELOPMENT APPLICATION	SH
7	20.10.2016	DRAFT FOR DA SUBMISSION	SH
6	12.10.2016	ISSUED FOR INFORMATION	SH
5	05.10.2016	ISSUED FOR INFORMATION AND COORDINATION ONLY	SH
4	30.09.2016	ISSUED FOR INFORMATION AND COORDINATION ONLY	SH
3	20.09.2016	ISSUED FOR INFORMATION AND COORDINATION ONLY	SH
2	12.09.2016	ISSUED FOR INFORMATION AND COORDINATION ONLY	SH
1	06.09.2016	ISSUED FOR INFORMATION AND COORDINATION ONLY	SH

DRAWING TITLE:

BASEMENT 3 - HOTEL BOH

DATE:	SCALE:	DRAWING No:	REV:
17.10.2016	As indicated @A1	1003	A
DRAWN BY:	PROJECT NO:		
EM.DE.DP.SH	CA3054		

DA ISSUE

NOTES:

All dimensions and setbacks to be verified prior to commencement, omissions or discrepancies to be notified to the architect.

COPYRIGHT:

The copyright of this drawing together with any other documents prepared by crone partners architecture studios, pty ltd (cp) remains the property of cp. crone partners grants license for the use of this document for the purpose for which they are intended. The license is not transferable without the permission of cp.

NORTH



DO NOT SCALE

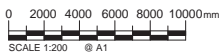

CLIENT:



ARUP

ENGINEERS

ARUP

O C U L U S

LANDSCAPE

O C U L U S



PLANNER

URBIS

KEY PLAN:

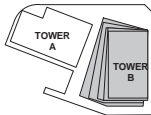

KEY SECTION:

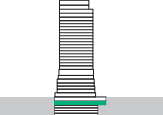

PROJECT:

Wanda Vista Sydney

1 Alfred Street Sydney NSW 2000

- PROPERTY LINE BOUNDARY
- APPROVED SIDA ENVELOPE
- PROPOSED SIDA ENVELOPE
- EARTH
- LANDSCAPE
- LANDSCAPE with service exhaust provision
- BASEMENT STORAGE
- WATER FEATURE

A	28.10.2016	ISSUED FOR STAGE 2 DEVELOPMENT APPLICATION	SH
7	20.10.2016	DRAFT FOR DA SUBMISSION	SH
6	12.10.2016	ISSUED FOR INFORMATION	SH
5	05.10.2016	ISSUED FOR INFORMATION AND COORDINATION ONLY	SH
4	30.09.2016	ISSUED FOR INFORMATION AND COORDINATION ONLY	SH
3	20.09.2016	ISSUED FOR INFORMATION AND COORDINATION ONLY	SH
2	12.09.2016	ISSUED FOR INFORMATION AND COORDINATION ONLY	SH
1	06.09.2016	ISSUED FOR INFORMATION AND COORDINATION ONLY	SH
ISSUE	DATE	REVISION	BY

DRAWING TITLE:

BASEMENT 2 - HOTEL BOH

DATE:	SCALE:	DRAWING No:	REV:
17.10.2016	As indicated @A1	1004	A
DRAWN BY:	PROJECT NO:		
EM.DE.DP.SH	CA3054		

DA ISSUE

NOTES:

All dimensions and setbacks to be verified prior to commencement, omissions or discrepancies to be notified to the architect.

COPYRIGHT:

The copyright of this drawing together with any other documents prepared by crone partners architecture studios, pty ltd (cp) remains the property of cp. crone partners grants license for the use of this document for the purpose for which they are intended. This license is not transferable without the permission of cp.

NORTH



DO NOT SCALE

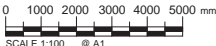

SCALE 1:100 @ A1

CLIENT:



ARUP

ENGINEERS

ARUP

O C U L U S

LANDSCAPE

O C U L U S



PLANNER

URBIS

KEY PLAN:

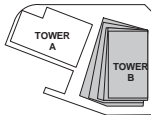

KEY SECTION:

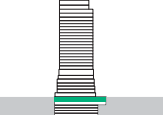

PROJECT:

Wanda Vista Sydney

1 Alfred Street Sydney NSW 2000

- PROPERTY LINE BOUNDARY
- APPROVED S1DA ENVELOPE
- PROPOSED S1DA ENVELOPE
- EARTH
- LANDSCAPE
- LANDSCAPE with service exhaust provision
- BASEMENT STORAGE
- WATER FEATURE

ISSUE	DATE	REVISION	BY
A	28.10.2016	ISSUED FOR STAGE 2 DEVELOPMENT APPLICATION	SH
7	20.10.2016	DRAFT FOR DA SUBMISSION	SH
6	12.10.2016	ISSUED FOR INFORMATION	SH
5	06.10.2016	ISSUED FOR INFORMATION AND COORDINATION ONLY	SH
4	30.09.2016	ISSUED FOR INFORMATION AND COORDINATION ONLY	SH
3	20.09.2016	ISSUED FOR INFORMATION AND COORDINATION ONLY	SH
2	12.09.2016	ISSUED FOR INFORMATION AND COORDINATION ONLY	SH
1	06.09.2016	ISSUED FOR INFORMATION AND COORDINATION ONLY	SH

DRAWING TITLE:

BASEMENT 1 - LOADING & BOH

DATE:	SCALE:	DRAWING No:	REV:
17.10.2016	As indicated @A1	1005	A
DRAWN BY:	PROJECT NO:		
EM.DE.DP.SH	CA3054		

DA ISSUE

NOTES:

All dimensions and setbacks to be verified prior to commencement, omissions or discrepancies to be notified to the architect.

COPYRIGHT:

The copyright of this drawing together with any other documents prepared by crone partners architecture studios, pty ltd (cp) remains the property of cp. crone partners grants license for the use of this document for the purpose for which they are intended. The license is not transferable without the permission of cp.

NORTH



DO NOT SCALE

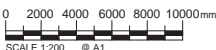

SCALE 1:200 @ A1

CLIENT:



ARUP

ENGINEERS

ARUP

O C U L U S

LANDSCAPE

OCULUS



PLANNER

URBIS

KEY PLAN:

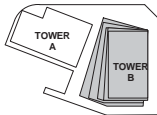

KEY SECTION:

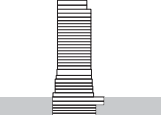

PROJECT:

Wanda Vista Sydney

1 Alfred Street Sydney NSW 2000

- PROPERTY LINE BOUNDARY
- APPROVED SIDA ENVELOPE
- PROPOSED SIDA ENVELOPE
- EARTH
- LANDSCAPE
- LANDSCAPE with service exhaust provision
- BASEMENT STORAGE
- WATER FEATURE

A	28.10.2016	ISSUED FOR STAGE 2 DEVELOPMENT APPLICATION	SH
7	20.10.2016	DRAFT FOR DA SUBMISSION	SH
6	12.10.2016	ISSUED FOR INFORMATION	SH
5	05.10.2016	ISSUED FOR INFORMATION AND COORDINATION ONLY	SH
4	30.09.2016	ISSUED FOR INFORMATION AND COORDINATION ONLY	SH
3	20.09.2016	ISSUED FOR INFORMATION AND COORDINATION ONLY	SH
2	12.09.2016	ISSUED FOR INFORMATION AND COORDINATION ONLY	SH
1	06.09.2016	ISSUED FOR INFORMATION AND COORDINATION ONLY	SH
ISSUE	DATE	REVISION	BY

DRAWING TITLE:

LOWER GROUND - TOWER A

DATE:	SCALE:	DRAWING No:	REV:
17.10.2016	As indicated @A1		
DRAWN BY:	PROJECT NO:	1006	A
EM.DE.DP.SH	CA3054		

DA ISSUE

NOTES:

All dimensions and setbacks to be verified prior to commencement, omissions or discrepancies to be notified to the architect.

COPYRIGHT:

The copyright of this drawing together with any other documents prepared by crone partners architecture studios, pty ltd (cp) remains the property of cp. crone partners grants licence for the use of this document for the purpose for which they are intended. The licence is not transferable without the permission of cp.

NORTH



DO NOT SCALE

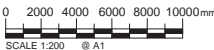

SCALE 1:200 @ A1

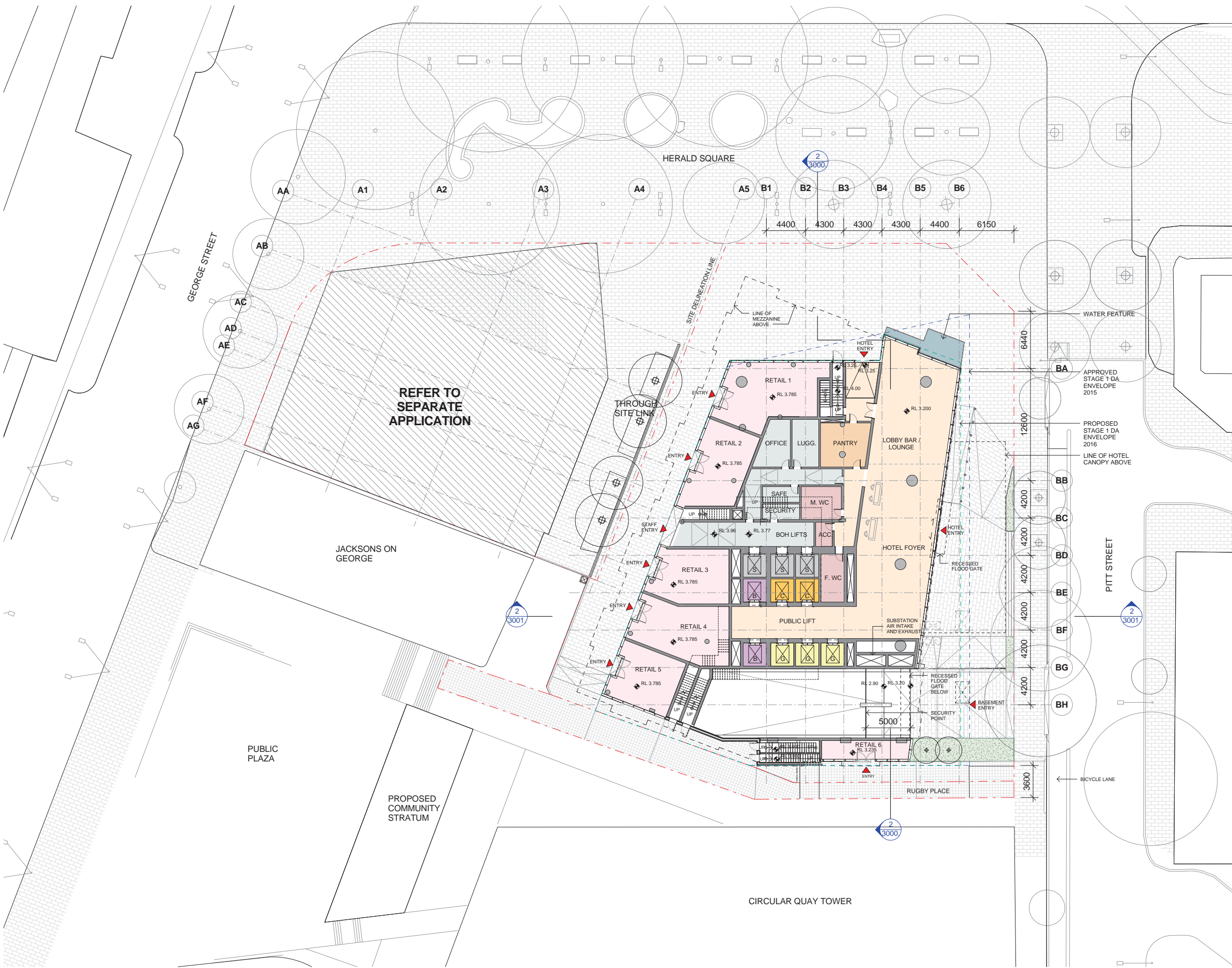

CLIENT:



ARUP

ENGINEERS

ARUP

O C U L U S

LANDSCAPE

O C U L U S



PLANNER

URBIS

KEY PLAN:

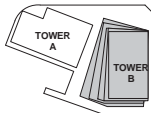

KEY SECTION:

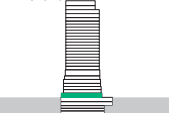

PROJECT:

Wanda Vista Sydney

1 Alfred Street Sydney NSW 2000

- PROPERTY LINE BOUNDARY
- APPROVED SIDA ENVELOPE
- PROPOSED SIDA ENVELOPE
- EARTH
- LANDSCAPE
- LANDSCAPE with service exhaust provision
- BASEMENT STORAGE
- WATER FEATURE

A	28.10.2016	ISSUED FOR STAGE 2 DEVELOPMENT APPLICATION	SH
7	20.10.2016	DRAFT FOR DA SUBMISSION	SH
6	12.10.2016	ISSUED FOR INFORMATION	SH
5	05.10.2016	ISSUED FOR INFORMATION AND COORDINATION ONLY	SH
4	30.09.2016	ISSUED FOR INFORMATION AND COORDINATION ONLY	SH
3	20.09.2016	ISSUED FOR INFORMATION AND COORDINATION ONLY	SH
2	12.09.2016	ISSUED FOR INFORMATION AND COORDINATION ONLY	SH
1	08.09.2016	ISSUED FOR INFORMATION AND COORDINATION ONLY	SH
ISSUE	DATE	REVISION	BY

DRAWING TITLE:

GROUND - LOBBY HOTEL & RETAIL

DATE:	SCALE:	DRAWING No:	REV:
17.10.2016	As indicated @A1		
DRAWN BY:	PROJECT NO:	1007	A
EM.DP.SH	CA3054		

DA ISSUE

NOTES:
All dimensions and setbacks to be verified prior to commencement, omissions or discrepancies to be notified to the architect.
COPYRIGHT:
The copyright of this drawing together with any other documents prepared by crone partners architecture studios, pty ltd (cp) remains the property of cp. crone partners grants license for the use of this document for the purpose for which they are intended. This license is not transferable without the permission of cp.

NORTH



DO NOT SCALE



CLIENT:



ARUP ENGINEERS

OCULUS LANDSCAPE

URBIS PLANNER

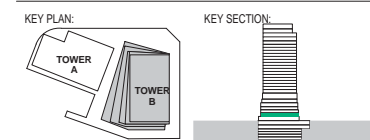

PROJECT:

Wanda Vista Sydney

1 Alfred Street Sydney NSW 2000

- PROPERTY LINE BOUNDARY
- APPROVED SIDA ENVELOPE
- PROPOSED SIDA ENVELOPE
- EARTH
- LANDSCAPE
- LANDSCAPE with service exhaust provision
- BASEMENT STORAGE
- WATER FEATURE

A	28.10.2016	ISSUED FOR STAGE 2 DEVELOPMENT APPLICATION	SH
7	20.10.2016	DRAFT FOR DA SUBMISSION	SH
6	12.10.2016	ISSUED FOR INFORMATION	SH
5	05.10.2016	ISSUED FOR INFORMATION AND COORDINATION ONLY	SH
4	30.09.2016	ISSUED FOR INFORMATION AND COORDINATION ONLY	SH
3	20.09.2016	ISSUED FOR INFORMATION AND COORDINATION ONLY	SH
2	12.09.2016	ISSUED FOR INFORMATION AND COORDINATION ONLY	SH
1	06.09.2016	ISSUED FOR INFORMATION AND COORDINATION ONLY	SH
ISSUE	DATE	REVISION	BY

DRAWING TITLE:

GROUND MEZZANINE - MEP

DATE:	SCALE:	DRAWING No:	REV:
17.10.2016	As indicated @A1		
DRAWN BY:	PROJECT NO:	1008	A
EM.DE.DP.SH	CA3054		

DA ISSUE

NOTES:
All dimensions and setbacks to be verified prior to commencement, omissions or discrepancies to be notified to the architect.
COPYRIGHT:
The copyright of this drawing together with any other documents prepared by crone partners architecture studios, phy ltd (cp) remains the property of cp. crone partners grants licence for the use of this document for the purpose for which they are intended. The licence is not transferable without the permission of cp.

NORTH



DO NOT SCALE

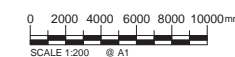

CLIENT:



ARUP ENGINEERS

OCULUS LANDSCAPE

URBIS PLANNER

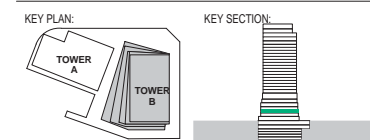

PROJECT:
Wanda Vista Sydney

1 Alfred Street Sydney NSW 2000

- PROPERTY LINE BOUNDARY
- APPROVED S10A ENVELOPE
- PROPOSED S10A ENVELOPE
- EARTH
- LANDSCAPE
- LANDSCAPE with service exhaust provision
- BASEMENT STORAGE
- WATER FEATURE

A	28.10.2016	ISSUED FOR STAGE 2 DEVELOPMENT APPLICATION	SH
7	20.10.2016	DRAFT FOR DA SUBMISSION	SH
6	12.10.2016	ISSUED FOR INFORMATION	SH
5	05.10.2016	ISSUED FOR INFORMATION AND COORDINATION ONLY	SH
4	30.09.2016	ISSUED FOR INFORMATION AND COORDINATION ONLY	SH
3	20.09.2016	ISSUED FOR INFORMATION AND COORDINATION ONLY	SH
2	12.09.2016	ISSUED FOR INFORMATION AND COORDINATION ONLY	SH
1	06.09.2016	ISSUED FOR INFORMATION AND COORDINATION ONLY	SH
ISSUE	DATE	REVISION	BY

DRAWING TITLE:
LEVEL 01 – POOL & SPA

DATE:	SCALE:	DRAWING No:	REV:
17.10.2016	As indicated @A1		
DRAWN BY:	PROJECT NO:	1009	A
EM.DE.DP.SH	CA3054		

DA ISSUE

NOTES:
All dimensions and setbacks to be verified prior to commencement, omissions or discrepancies to be notified to the architect.
COPYRIGHT:
The copyright of this drawing together with any other documents prepared by crone partners architecture studios, phy ltd (cp) remains the property of cp. crone partners grants licence for the use of this document for the purpose for which they are intended. The licence is not transferable without the permission of cp.



DO NOT SCALE
0 2000 4000 6000 8000 10000mm
SCALE 1:200 @ A1

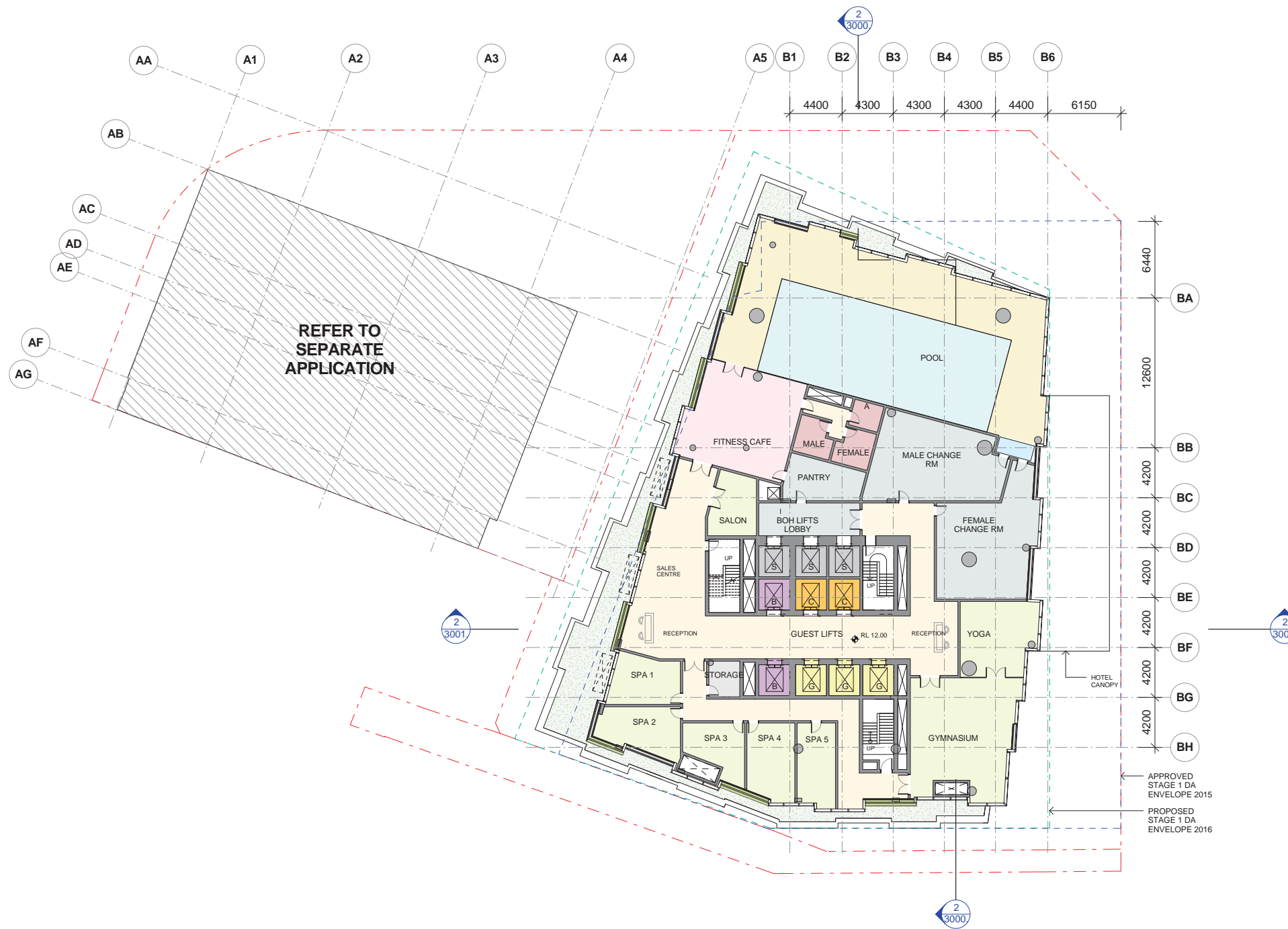

CLIENT:



ARUP ENGINEERS

OCULUS LANDSCAPE

URBIS PLANNER

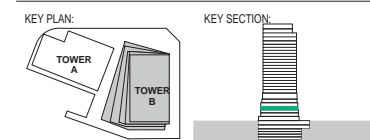

PROJECT:

Wanda Vista Sydney

1 Alfred Street Sydney NSW 2000

- PROPERTY LINE BOUNDARY
- APPROVED S1DA ENVELOPE
- PROPOSED S1DA ENVELOPE
- EARTH
- LANDSCAPE
- LANDSCAPE with service exhaust provision
- BASEMENT STORAGE
- WATER FEATURE

A	28.10.2016	ISSUED FOR STAGE 2 DEVELOPMENT APPLICATION	SH
7	20.10.2016	DRAFT FOR DA SUBMISSION	SH
6	12.10.2016	ISSUED FOR INFORMATION	SH
5	05.10.2016	ISSUED FOR INFORMATION AND COORDINATION ONLY	SH
4	30.09.2016	ISSUED FOR INFORMATION AND COORDINATION ONLY	SH
3	20.09.2016	ISSUED FOR INFORMATION AND COORDINATION ONLY	SH
2	12.09.2016	ISSUED FOR INFORMATION AND COORDINATION ONLY	SH
1	06.09.2016	ISSUED FOR INFORMATION AND COORDINATION ONLY	SH
ISSUE	DATE	REVISION	BY

DRAWING TITLE:

LEVEL 02 – EXECUTIVE OFFICE

DATE:	SCALE:	DRAWING No:	REV:
17.10.2016	As indicated @A1		
DRAWN BY:	PROJECT NO:	1010	A
EM.DE.DP.SH	CA3054		

DA ISSUE

NOTES:
All dimensions and setbacks to be verified prior to commencement, omissions or discrepancies to be notified to the architect.
COPYRIGHT:
The copyright of this drawing together with any other documents prepared by crone partners architecture studios, phy ltd (cp) remains the property of cp. crone partners grants licence for the use of this document for the purpose for which they are intended. The licence is not transferable without the permission of cp.

NORTH



DO NOT SCALE

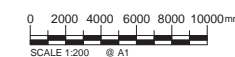

SCALE 1:200 @ A1

CLIENT:



ARUP ENGINEERS

OCULUS LANDSCAPE

URBIS PLANNER

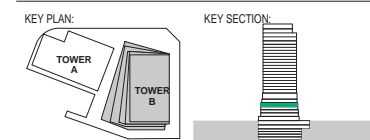

PROJECT:
Wanda Vista Sydney
1 Alfred Street Sydney NSW 2000

- PROPERTY LINE BOUNDARY
- APPROVED S1DA ENVELOPE
- PROPOSED S1DA ENVELOPE
- EARTH
- LANDSCAPE
- LANDSCAPE with service exhaust provision
- BASEMENT STORAGE
- WATER FEATURE

A	28.10.2016	ISSUED FOR STAGE 2 DEVELOPMENT APPLICATION	SH
7	20.10.2016	DRAFT FOR DA SUBMISSION	SH
6	12.10.2016	ISSUED FOR INFORMATION	SH
5	05.10.2016	ISSUED FOR INFORMATION AND COORDINATION ONLY	SH
4	30.09.2016	ISSUED FOR INFORMATION AND COORDINATION ONLY	SH
3	20.09.2016	ISSUED FOR INFORMATION AND COORDINATION ONLY	SH
2	12.09.2016	ISSUED FOR INFORMATION AND COORDINATION ONLY	SH
1	06.09.2016	ISSUED FOR INFORMATION AND COORDINATION ONLY	SH
ISSUE	DATE	REVISION	BY

DRAWING TITLE:
LEVEL 03 - GRAND BALLROOM

DATE:	SCALE:	DRAWING No:	REV:
17.10.2016	As indicated @A1		
DRAWN BY:	PROJECT NO:	1011	A
EM.DE.DP.SH	CA3054		

DA ISSUE

NOTES:
All dimensions and setbacks to be verified prior to commencement, omissions or discrepancies to be notified to the architect.
COPYRIGHT:
The copyright of this drawing together with any other documents prepared by crone partners architecture studios, phy ltd (cp) remains the property of cp. crone partners grants licence for the use of this document for the purpose for which they are intended. The licence is not transferable without the permission of cp.

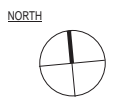

DO NOT SCALE
0 2000 4000 6000 8000 10000mm
SCALE 1:200 @ A1

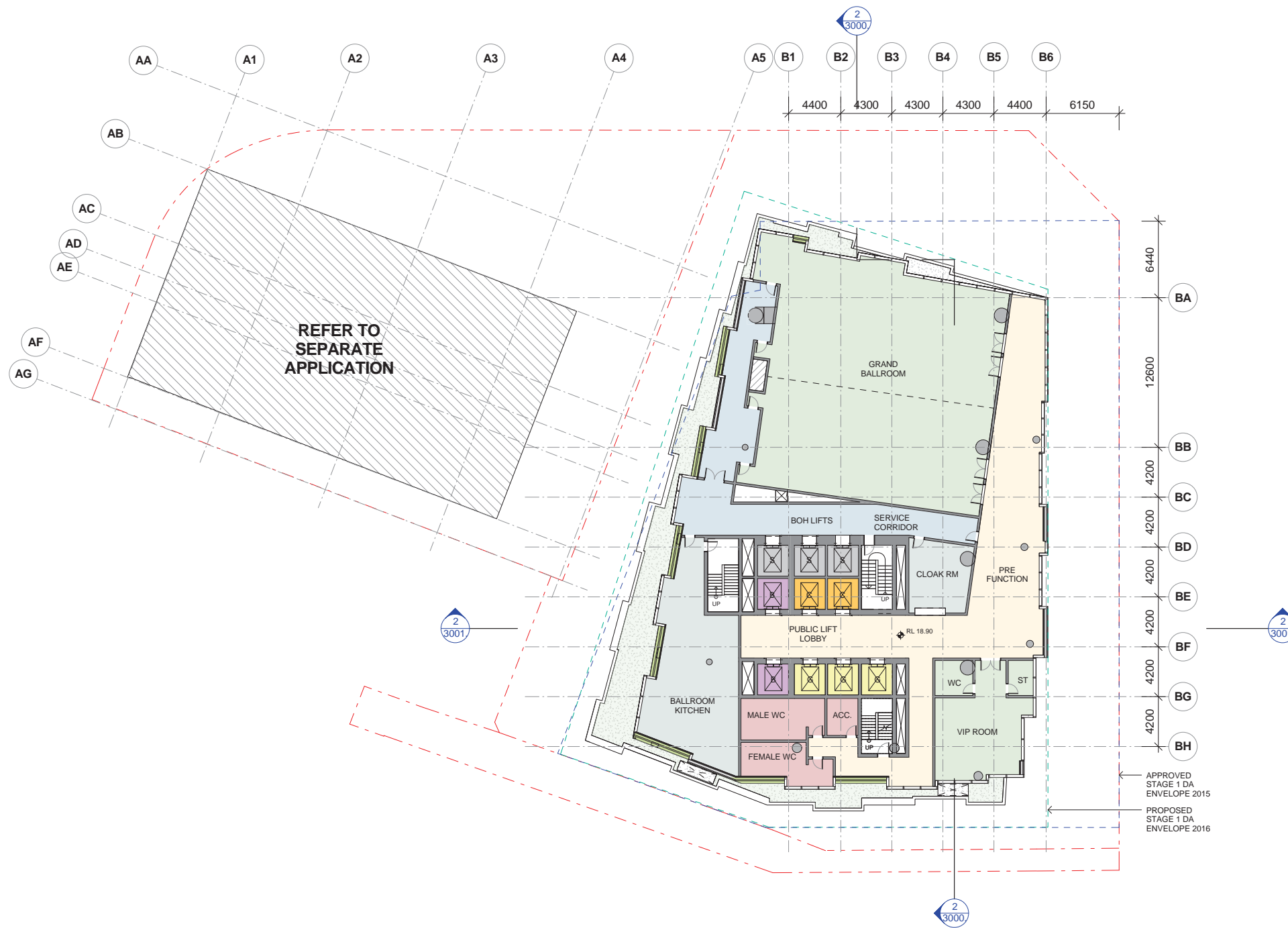

CLIENT:



ARUP ENGINEERS

OCULUS LANDSCAPE

URBIS PLANNER

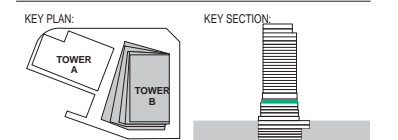

PROJECT:

Wanda Vista Sydney

1 Alfred Street Sydney NSW 2000

- PROPERTY LINE BOUNDARY
- APPROVED S1DA ENVELOPE
- PROPOSED S1DA ENVELOPE
- EARTH
- LANDSCAPE
- LANDSCAPE with service exhaust provision
- BASEMENT STORAGE
- WATER FEATURE

A	28.10.2016	ISSUED FOR STAGE 2 DEVELOPMENT APPLICATION	SH
7	20.10.2016	DRAFT FOR DA SUBMISSION	SH
6	12.10.2016	ISSUED FOR INFORMATION	SH
5	05.10.2016	ISSUED FOR INFORMATION AND COORDINATION ONLY	SH
4	30.09.2016	ISSUED FOR INFORMATION AND COORDINATION ONLY	SH
3	20.09.2016	ISSUED FOR INFORMATION AND COORDINATION ONLY	SH
2	12.09.2016	ISSUED FOR INFORMATION AND COORDINATION ONLY	SH
1	06.09.2016	ISSUED FOR INFORMATION AND COORDINATION ONLY	SH
ISSUE	DATE	REVISION	BY

DRAWING TITLE:

LEVEL 03 - MEZZ. MEETING ROOM

DATE:	SCALE:	DRAWING No:	REV:
17.10.2016	As indicated @A1		
DRAWN BY:	PROJECT NO:	1012	A
EM.DE.DP.SH	CA3054		

DA ISSUE

NOTES:
All dimensions and setbacks to be verified prior to commencement, omissions or discrepancies to be notified to the architect.
COPYRIGHT:
The copyright of this drawing together with any other documents prepared by crone partners architecture studios, phy ltd (cp) remains the property of cp. crone partners grants licence for the use of this document for the purpose for which they are intended. The licence is not transferable without the permission of cp.



DO NOT SCALE

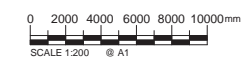

SCALE 1:200 @ A1

CLIENT:



ARUP

ENGINEERS
ARUP

O C U L U S

LANDSCAPE
OCULUS



PLANNER
URBIS

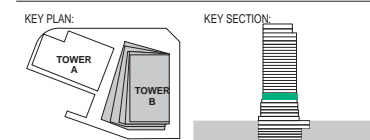

PROJECT:

Wanda Vista Sydney

1 Alfred Street Sydney NSW 2000

- PROPERTY LINE BOUNDARY
- APPROVED S1DA ENVELOPE
- PROPOSED S1DA ENVELOPE
- EARTH
- LANDSCAPE
- LANDSCAPE with service exhaust provision
- BASEMENT STORAGE
- WATER FEATURE

A	28.10.2016	ISSUED FOR STAGE 2 DEVELOPMENT APPLICATION	SH
7	20.10.2016	DRAFT FOR DA SUBMISSION	SH
6	12.10.2016	ISSUED FOR INFORMATION	SH
5	05.10.2016	ISSUED FOR INFORMATION AND COORDINATION ONLY	SH
4	30.09.2016	ISSUED FOR INFORMATION AND COORDINATION ONLY	SH
3	20.09.2016	ISSUED FOR INFORMATION AND COORDINATION ONLY	SH
2	12.09.2016	ISSUED FOR INFORMATION AND COORDINATION ONLY	SH
1	06.09.2016	ISSUED FOR INFORMATION AND COORDINATION ONLY	SH
ISSUE	DATE	REVISION	BY

DRAWING TITLE:

LEVEL 04 - ALL DAY DINING

DATE:	SCALE:	DRAWING No:	REV:
17.10.2016	As indicated @A1		
DRAWN BY:	PROJECT NO:	1013	A
EM.DE.DP.SH	CA3054		

DA ISSUE

NOTES:
All dimensions and setbacks to be verified prior to commencement, omissions or discrepancies to be notified to the architect.
COPYRIGHT:
The copyright of this drawing together with any other documents prepared by crone partners architecture studios, phy ltd (cp) remains the property of cp. crone partners grants licence for the use of this document for the purpose for which they are intended. The licence is not transferable without the permission of cp.

NORTH



DO NOT SCALE



SCALE 1:200 @ A1