

LAND AND PROPERTY INFORMATION NEW SOUTH WALES - TITLE SEARCH

FOLIO: 477/729251

SEARCH DATE	TIME	EDITION NO	DATE
19/4/2016	11:44 AM	1	30/1/1996

LAND

LOT 477 IN DEPOSITED PLAN 729251
AT TOWN OF BALLINA
LOCAL GOVERNMENT AREA BALLINA
PARISH OF BALLINA COUNTY OF ROUS
TITLE DIAGRAM DP729251

FIRST SCHEDULE

MINISTER FOR EDUCATION AND TRAINING (DD 0861814)

SECOND SCHEDULE (1 NOTIFICATION)

1 0861814 LAND EXCLUDES MINERALS SEE MEMORANDUM S700000A

NOTATIONS

NOTE: THE CERTIFICATE OF TITLE FOR THIS FOLIO OF THE REGISTER DOES NOT INCLUDE SECURITY FEATURES INCLUDED ON COMPUTERISED CERTIFICATES OF TITLE ISSUED FROM 4TH JANUARY, 2004. IT IS RECOMMENDED THAT STRINGENT PROCESSES ARE ADOPTED IN VERIFYING THE IDENTITY OF THE PERSON(S) CLAIMING A RIGHT TO DEAL WITH THE LAND COMPRISED IN THIS FOLIO.

UNREGISTERED DEALINGS: NIL

*** END OF SEARCH ***

LAND AND PROPERTY INFORMATION NEW SOUTH WALES - TITLE SEARCH

FOLIO: 478/729251

SEARCH DATE	TIME	EDITION NO	DATE
19/4/2016	11:44 AM	2	6/3/1997

LAND

LOT 478 IN DEPOSITED PLAN 729251
AT TOWN OF BALLINA
LOCAL GOVERNMENT AREA BALLINA
PARISH OF BALLINA COUNTY OF ROUS
TITLE DIAGRAM DP729251

FIRST SCHEDULE

MINISTER FOR EDUCATION AND TRAINING (DD 0861814)

SECOND SCHEDULE (2 NOTIFICATIONS)

1	0861814	LAND EXCLUDES MINERALS SEE MEMORANDUM S700000A
2	DP267380	EASEMENT FOR WATER SUPPLY 2 WIDE AFFECTING THE PART(S) SHOWN SO BURDENED IN DP267380

NOTATIONS

NOTE: THE CERTIFICATE OF TITLE FOR THIS FOLIO OF THE REGISTER DOES
NOT INCLUDE SECURITY FEATURES INCLUDED ON COMPUTERISED
CERTIFICATES OF TITLE ISSUED FROM 4TH JANUARY, 2004. IT IS
RECOMMENDED THAT STRINGENT PROCESSES ARE ADOPTED IN VERIFYING THE
IDENTITY OF THE PERSON(S) CLAIMING A RIGHT TO DEAL WITH THE LAND
COMPRISED IN THIS FOLIO.

UNREGISTERED DEALINGS: NIL

*** END OF SEARCH ***

LAND AND PROPERTY INFORMATION NEW SOUTH WALES - TITLE SEARCH

FOLIO: 1/1083219

SEARCH DATE	TIME	EDITION NO	DATE
19/4/2016	11:44 AM	-	-

CERTIFICATE OF TITLE HAS NOT ISSUED

LAND

LOT 1 IN DEPOSITED PLAN 1083219
AT BALLINA
LOCAL GOVERNMENT AREA BALLINA
PARISH OF BALLINA COUNTY OF ROUS
TITLE DIAGRAM DP1083219

FIRST SCHEDULE

MINISTER FOR EDUCATION AND TRAINING (CA175007)

SECOND SCHEDULE (1 NOTIFICATION)

- * 1 QUALIFIED TITLE. CAUTION PURSUANT TO SECTION 28J OF THE REAL PROPERTY ACT 1900. THIS TITLE WAS CREATED USING LAND AND PROPERTY INFORMATION RECORDS IN ACCORDANCE WITH SECTION 28D OF THE REAL PROPERTY ACT 1900. DELIVERY OF THE TITLE AND/OR REGISTRATION OF ANY DEALING WILL REQUIRE LODGMENT OF A STATEMENT OF TITLE PARTICULARS SUPPLYING COMPLETE OWNERSHIP DETAILS.

NOTATIONS

UNREGISTERED DEALINGS: NIL

*** END OF SEARCH ***

LAND AND PROPERTY INFORMATION NEW SOUTH WALES - TITLE SEARCH

FOLIO: 392/755684

SEARCH DATE	TIME	EDITION NO	DATE
19/4/2016	11:44 AM	1	30/1/1996

LAND

LOT 392 IN DEPOSITED PLAN 755684
AT BALLINA
LOCAL GOVERNMENT AREA BALLINA
PARISH OF BALLINA COUNTY OF ROUS
(FORMERLY KNOWN AS PORTION 392)
TITLE DIAGRAM CROWN PLAN 27.1612

FIRST SCHEDULE

MINISTER FOR EDUCATION AND TRAINING (DD 0861814)

SECOND SCHEDULE (1 NOTIFICATION)

1 0861814 LAND EXCLUDES MINERALS SEE MEMORANDUM S700000A

NOTATIONS

NOTE: THE CERTIFICATE OF TITLE FOR THIS FOLIO OF THE REGISTER DOES
NOT INCLUDE SECURITY FEATURES INCLUDED ON COMPUTERISED
CERTIFICATES OF TITLE ISSUED FROM 4TH JANUARY, 2004. IT IS
RECOMMENDED THAT STRINGENT PROCESSES ARE ADOPTED IN VERIFYING THE
IDENTITY OF THE PERSON(S) CLAIMING A RIGHT TO DEAL WITH THE LAND
COMPRISED IN THIS FOLIO.

UNREGISTERED DEALINGS: NIL

*** END OF SEARCH ***

PLAN FORM 1 (APPROVED FORM 1)

SIGNATURES, SEALS AND STATEMENTS
of intention to dedicate public roads, to
create public reserves, drainage
reserves, easements, restrictions on the
use of land or positive covenants.

IT IS INTENDED TO ACQUIRE LOT 1
FOR SCHOOL PURPOSES

Department of Lands Approval

I, [Authorised Officer] in approving this plan certify
that all necessary approvals in regard to the allocation of the land
shown hereon have been given

Signature
Date
File Number
Office

Subdivision Certificate

I certify that the provisions of s 109(1) of the Environmental Planning
and Assessment Act 1979 have been satisfied in relation to the
proposed

* (insert 'subdivision' or 'new road') set out herein

* Authorised Person/General Manager/Accredited Certifier

Consent Authority
Date of Endorsement
Accreditation no
Subdivision Certificate no

* Delete whichever is inapplicable

REVIEWER'S REFERENCE S.B.55612 2005M7100 (240) Comp

WARNING CREASING OR FOLDING WILL LEAD TO REJECTION

Plan Drawing only to appear in this space

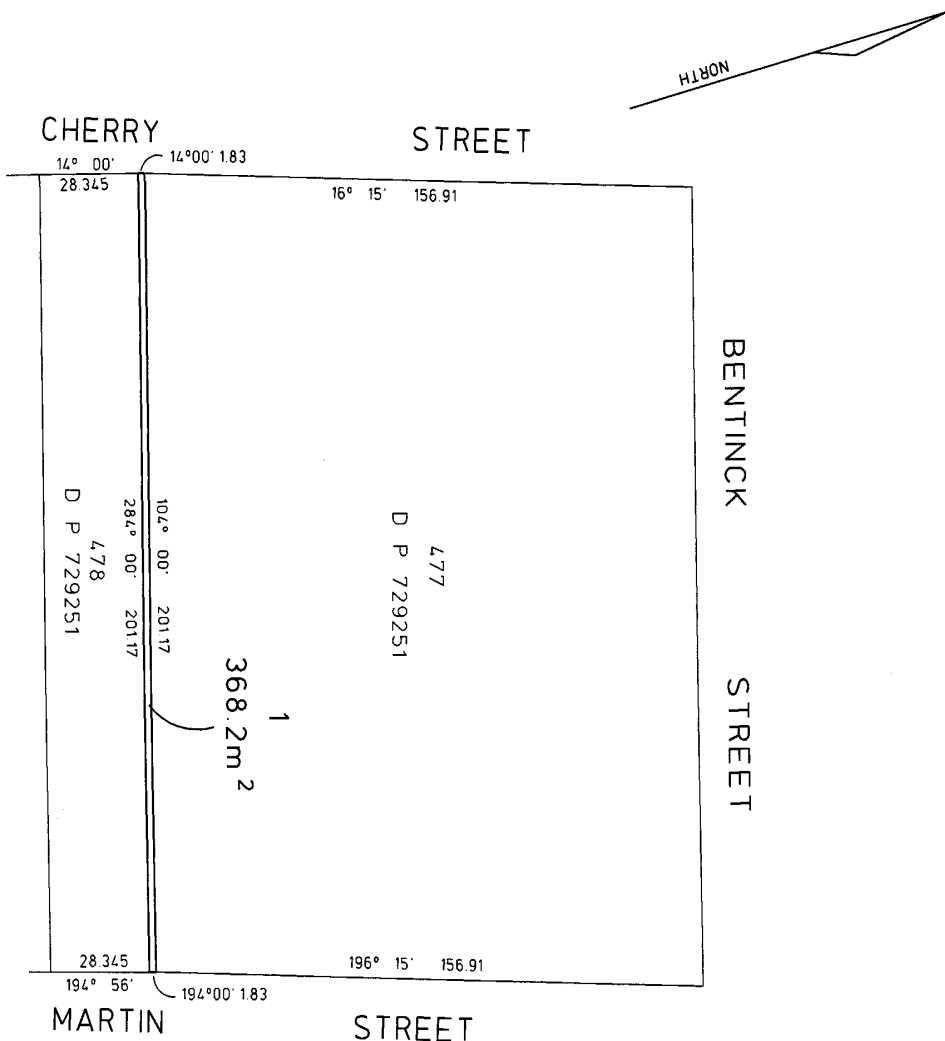

DP1083219

Registered: 03/06/2005

Title System: CROWN

Purpose: ACQUISITION

Ref. Map: X 5400-13

Lost Plan: _____

PLAN OF

PROPOSED ACQUISITION OF ROAD
183 WIDE BEING CROWN LAND

Lengths are in metres. Reduction Ratio 1:1250

LGA : BALLINA

Locality: BALLINA

Parish: BALLINA

County: ROUS

Plans used in preparation of Survey/Compilation

DP729251

Surveying Regulation, 2001

GRAHAM PAUL BENTHOLD
NSW, DEPARTMENT OF COMMERCE

I, the surveyor registered under the Surveying Act 2003, hereby certify
that the survey represented on this plan is accurate, has been made in
accordance with the Surveying Regulation, 2001 and was completed
on 21/03/2005

I hereby specify the land actually surveyed or specified only land shown in
the plan that is not the subject of the survey

(Signature) S.B.55612

Position: Surveyor

Type: Urban/Rural

PLAN FORM 1												
STANDARD TERMS, SEALS AND STATEMENTS OF INTENTION TO DEDICATE PUBLIC ROADS OR TO CREATE PUBLIC RESERVES, DRAINAGE RESERVOIRS, RESERVATIONS OR RESTRICTIONS AS TO LAND.												
LOTS 477 & 478 ADDED BY GAZ. 28-11-1975 TO DEDICATION FOR PUBLIC SCHOOL PURPOSES GAZ. 16-12-1927												
Crown Lands Office Approval PLAN APPROVED: 25/2/88 21/4/89 Land District: LISMORE Paper No.: NP 1241 Date of Issue: 1988												
Council Clerk's Certificate I hereby certify that — (a) the requirements of the Local Government Act, 1929 (other than those relating to the registration of plans, and the provisions of the Drainage and Drainage Act, 1924, as amended) have been complied with by the applicant in relation to the proposed "new road", "subdivision" or "consolidated lot" set out herein. (b) the requirements of the Local Government Act, 1929 (other than those relating to the registration of plans, and the provisions of the Drainage and Drainage Act, 1924, as amended) have been complied with by the applicant in relation to the proposed "new road", "subdivision" or "consolidated lot" set out herein. Date: 25/2/88 (Signature) Council Clerk Council File No. 25/2/88 *This seal of intention to be placed where the application is only for a consolidation of the opening of a new road or where the land to be dedicated is not to be used for public purposes and the Local Government Board and the Hunter District Water Board are not required to be consulted.												
SURVEYOR'S REFERENCE:												
Plan Drawing only to appear in this space												
WARNING: CREASING OR FOLDING WILL LEAD TO REJECTION												
AMENDMENTS AND/OR ADDITIONS MADE ON PLAN IN THE LAND TITLES OFFICE												
This negative is a photograph made as a permanent record of a document in the custody of the Registrar General this day, 19th FEBRUARY, 1990												
PLAN OF CROWN LAND DEDICATED FOR PUBLIC SCHOOL PURPOSES												
Lengths are in metres. Reduction Ratio: 1:2000												
Town/Shire: BALLINA												
Locality: TOWN OF BALLINA												
Parish: BALLINA												
County: ROUS												
Plans used in preparation of survey compilation: B1-2503 6-2339 & GAZ. B-3-1974 FOL 798												
Registered: DP 729251												
C.A. 1/1/1990												
Title System: CROWN LAND												
Purpose: CROWN FOLIO CREATION												
Ref. Map: X5400-13												
Last Plan: 6-2339												
PLAN AMENDED IN L.T.O. AT SURVEYOR'S REQUEST 9.2.1990												

15132

Town of

West Ballina

"Lismore"

PLAN OF

PORTION 60 392

County

Rous

Parish of Ballina

Applied for under the 5th clause of the Crown Lands Alienation Act of 1861 by
Measured as a Site for Public Markets

Within Res N^o 606 Public Recreation, not^d 31st May 80

Approved 8th Sep. 81 Vide Mis. 811532

Note: That part of Reserve N^o 606 within Suburban Portion N^o 60
Cancelled 25th Nov^r 85.

Vide Misc 86:8334 land set apart as a Site for Public Markets

vested in the Municipal Council of Ballina

Dedicated as Site for Public Markets 26th Mar. 1886 Revoked 16.12.27.

Do. for Public School Purposes 16th Dec^r 1927

Reserve N^o 606

Notified 31st May 1880

Burnet Street

Dedicated
60 392

Level land very thickly timbered
5a 1r 8p
26th March 86

Swift Street

M. Russell M. Russell M. Russell M. Russell
0. 2. 6 0. 2. 6 0. 2. 6 0. 2. 6
18² 6 16¹ 2 26⁰ 0. 2. 6

Por. N^o 392 adopted 21.11.21 E.H.

Scale of
Chain
and
Link

Azimuth taken from SEG 18

Acc. N^o 84. 43
12th Sep. on amp Street
J.H.

Examined & Charted
on town map 14 881
J.H. 29 Aug 1881

Value of Improvements Nil

Situated in the

Scale 20 Chains to an Inch.

I hereby certify that I in person made and on the 20th May 1884
completed the survey represented on this plan, on which are written
the bearings and lengths of the lines measured by me, and I declare
that the survey has been executed in accordance with the regulations
published for the guidance of Licensed Surveyors, and the practice
of the Surveyor General's Department.

J. Herdman Minter LS

Licensed Surveyor.

Transmitted to the Surveyor General with my letter of the 15th July N^o 84/4

Stanley, St. Boniface, Holborn, London, W.C.

B27. 1612

27-1612