

STAGE 1 SSDA AMENDED CONCEPT PROPOSAL

LEGEND:

- TOWER
- TOWER BASE
- PODIUM
- DECK
- UPGRADES TO EXISTING PROMENADE
- EXTENSION TO BOARDWALK

NOTES:

REFER TO SECTION 7.2 OF THE
DESIGN REPORT FOR KEY DESIGN
CRITERIA

BALUSTRADES, PARAPETS, ROOF
FEATURES, SERVICES POLES AND
ANTENNA / ARIALS, AWNINGS,
ARTWORKS, GARDEN PAVILIONS,
KIOSKS, VEGETATION, SIGNAGE
AND STRUCTURES CAN EXTEND
BEYOND THE ENVELOPE

New South Wales Government
Independent Planning Commission
Issued under the Environmental Planning and Assessment Act 1979

Approved Application No. SSO 7684

granted on the 13 May 2019

Signed ff

Sheet No. 1 of 15

0 10 20 50m
1:1000 @ A3
28/08/2018

**STAGE 1 SSDA AMENDED
CONCEPT PROPOSAL**

LEGEND:

- TOWER
- TOWER BASE
- PODIUM
- DECK
- DRUITT STREET BRIDGE

NOTES:

REFER TO SECTION 7.2 OF THE
DESIGN REPORT FOR KEY DESIGN
CRITERIA

BALUSTRADES, PARAPETS, ROOF
FEATURES, SERVICES POLES AND
ANTENNA / ARIALS, AWNINGS,
ARTWORKS, GARDEN PAVILIONS,
KIOSKS, VEGETATION, SIGNAGE
AND STRUCTURES CAN EXTEND
BEYOND THE ENVELOPE



New South Wales Government
Independent Planning Commission

Issued under the Environmental Planning and Assessment Act 1979

Approved Application No. **SSO 7684**

granted on the **13 May 2019**

Signed **JH**

Sheet No. **2** of **15**



Envelope Plan - Level 1

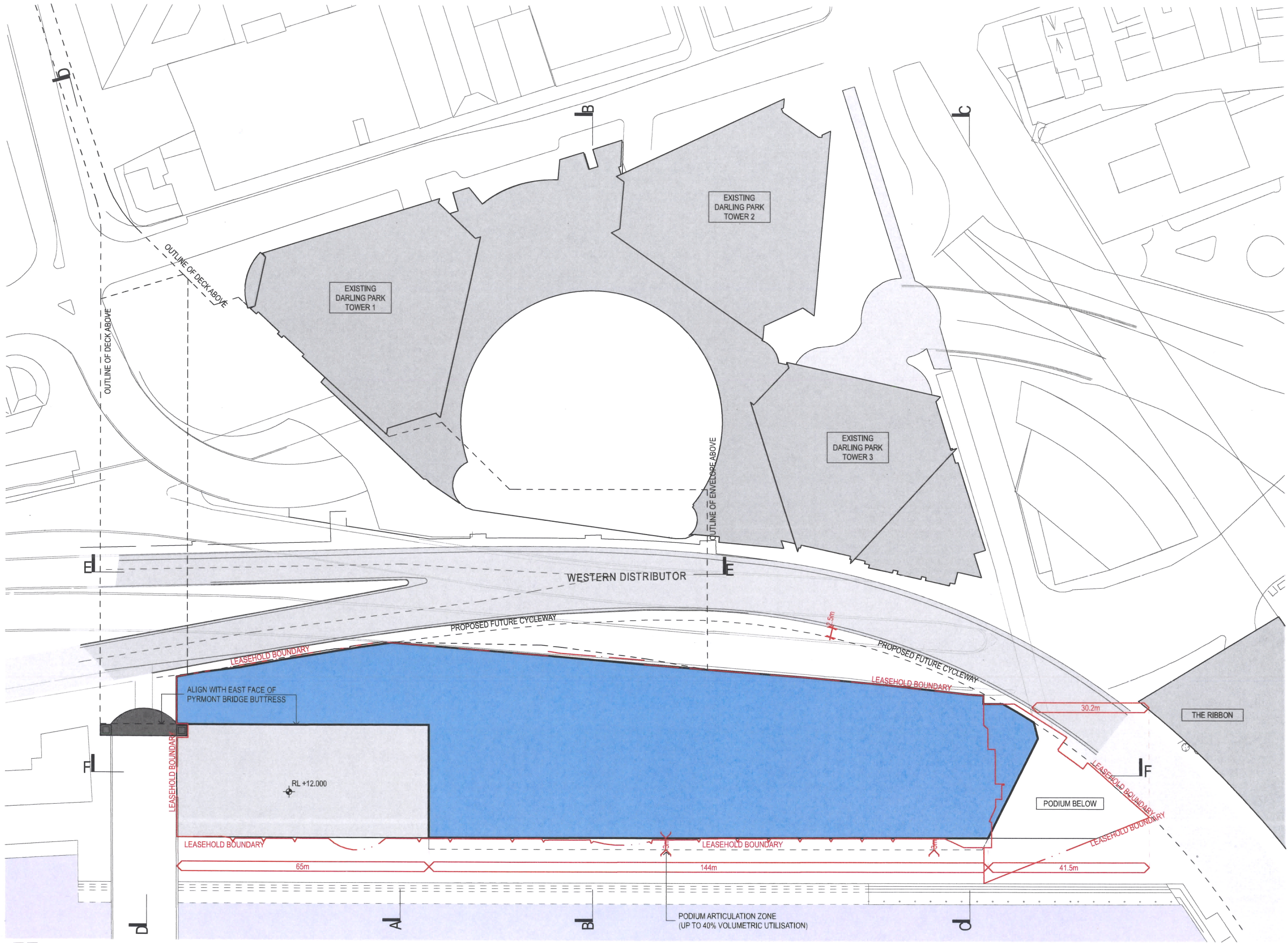

**STAGE 1 SSDA AMENDED
CONCEPT PROPOSAL**

LEGEND:

- TOWER
- TOWER BASE
- PODIUM
- DECK

NOTES:

REFER TO SECTION 7.2 OF THE
DESIGN REPORT FOR KEY DESIGN
CRITERIA

BALUSTRADES, PARAPETS, ROOF
FEATURES, SERVICES POLES AND
ANTENNA / ARIALS, AWNINGS,
ARTWORKS, GARDEN PAVILIONS,
KIOSKS, VEGETATION, SIGNAGE
AND STRUCTURES CAN EXTEND
BEYOND THE ENVELOPE

New South Wales Government
Independent Planning Commission
Issued under the Environmental Planning and Assessment Act 1979
Approved Application No. *SSD 7684*
granted on the *13 May 2019*
Signed *th*
Sheet No. *3* of *15*



Envelope Plan - Level 2

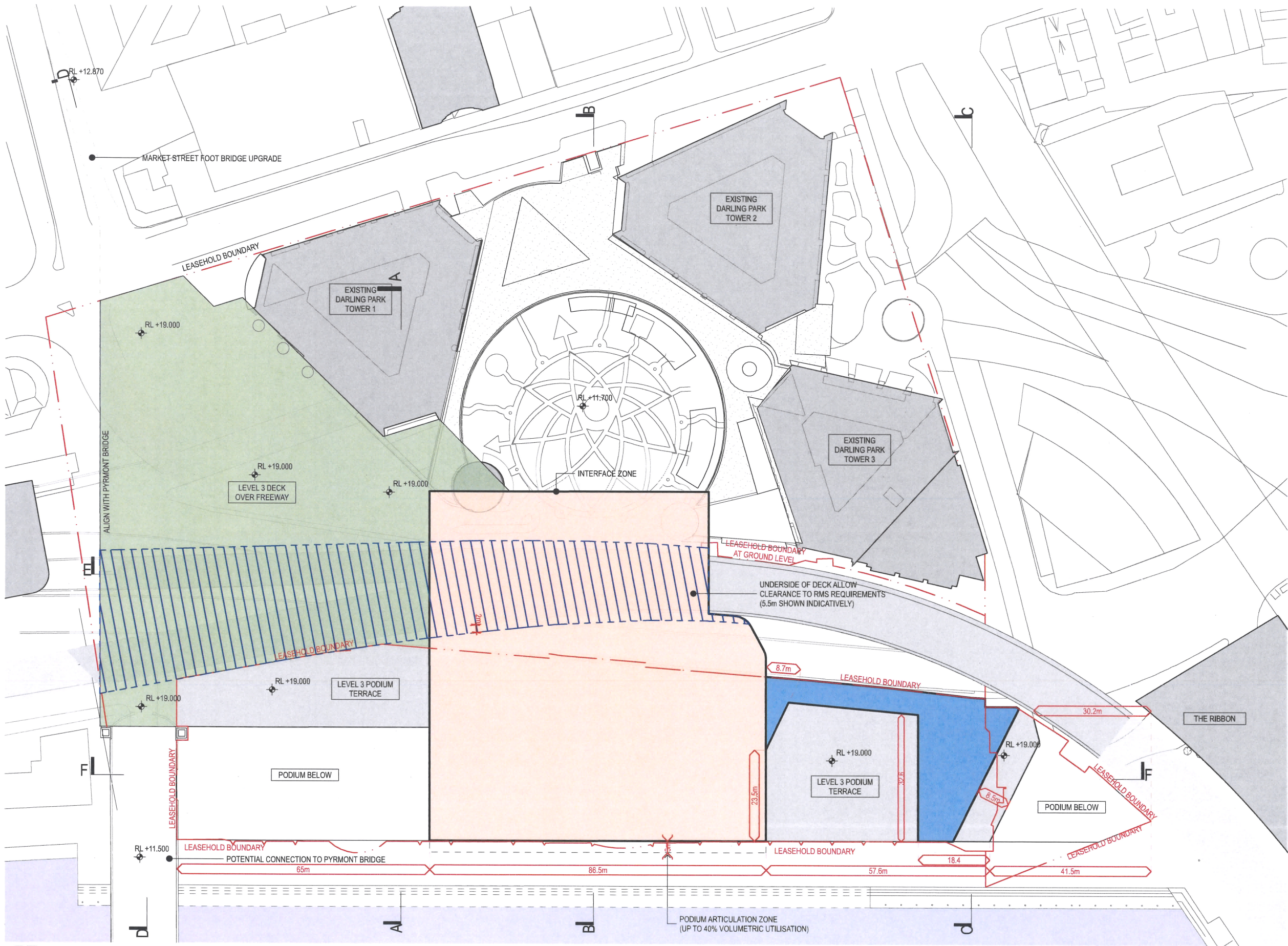

**STAGE 1 SSDA AMENDED
CONCEPT PROPOSAL**

LEGEND:

- TOWER
- TOWER BASE
- PODIUM
- DECK
- CLEARANCE TO RMS REQUIREMENTS

NOTES:

REFER TO SECTION 7.2 OF THE
DESIGN REPORT FOR KEY DESIGN
CRITERIA

BALUSTRADES, PARAPETS, ROOF
FEATURES, SERVICES POLES AND
ANTENNA / ARIALS, AWNINGS,
ARTWORKS, GARDEN PAVILIONS,
KIOSKS, VEGETATION, SIGNAGE
AND STRUCTURES CAN EXTEND
BEYOND THE ENVELOPE

New South Wales Government
Independent Planning Commission
Issued under the Environmental Planning and Assessment Act 1979

Approved Application No. **SSD 7684**
granted on the **13 May 2019**
Signed **[Signature]**
Sheet No. **4** of **15**



Envelope Plan - Level 3

STAGE 1 SSDA AMENDED CONCEPT PROPOSAL

LEGEND:

- TOWER
- TOWER BASE
- PODIUM
- DECK

NOTES:

REFER TO SECTION 7.2 OF THE
DESIGN REPORT FOR KEY DESIGN
CRITERIA

BALUSTRADES, PARAPETS, ROOF
FEATURES, SERVICES POLES AND
ANTENNA / ARIALS, AWNINGS,
ARTWORKS, GARDEN PAVILIONS,
KIOSKS, VEGETATION, SIGNAGE
AND STRUCTURES CAN EXTEND
BEYOND THE ENVELOPE

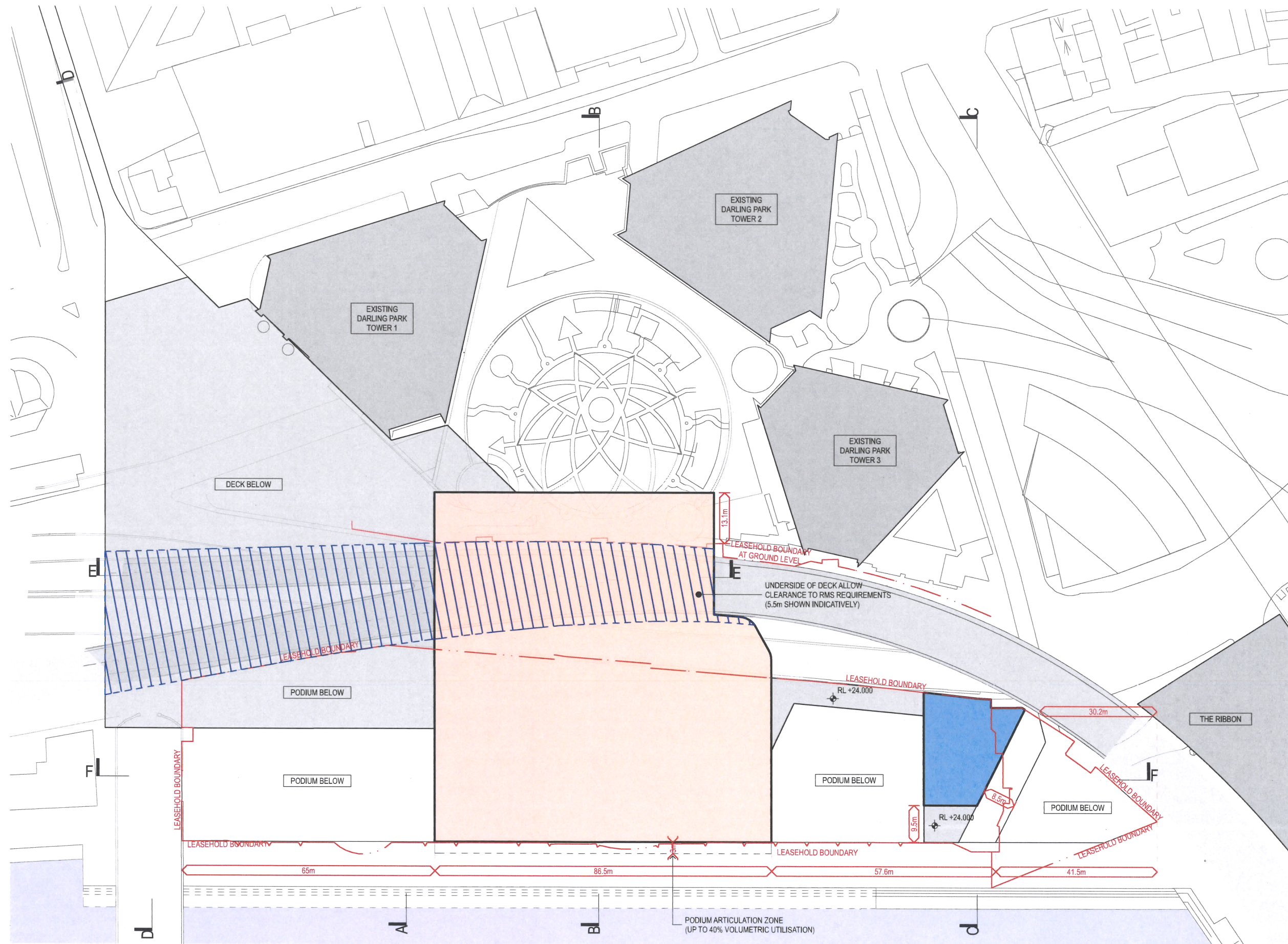

New South Wales Government
Independent Planning Commission

Issued under the Environmental Planning and Assessment Act 1979

Approved Application No. **SSD 7684**

granted on the **13 May 2019**

Signed **JH**

Sheet No. **5** of **15**



Envelope Plan - Level 4

STAGE 1 SSDA AMENDED
CONCEPT PROPOSAL

LEGEND:

- TOWER
- TOWER BASE
- PODIUM
- DECK

NOTES:

MAXIMUM TOWER ENVELOPE
VOLUMETRIC UTILISATION 65%

REFER TO SECTION 7.2 OF THE
DESIGN REPORT FOR KEY DESIGN
CRITERIA

BALUSTRADES, PARAPETS, ROOF
FEATURES, SERVICES POLES AND
ANTENNA / ARIALS, AWNINGS,
ARTWORKS, GARDEN PAVILIONS,
KIOSKS, VEGETATION, SIGNAGE
AND STRUCTURES CAN EXTEND
BEYOND THE ENVELOPE



New South Wales Government
Independent Planning Commission

Issued under the Environmental Planning and Assessment Act 1979

Approved Application No SSD 7684

granted on the 13 May 2019

Signed *[Signature]*

Sheet No. 6 of 15



Envelope Plan - Typical Tower Level

STAGE 1 SSDA AMENDED
CONCEPT PROPOSAL

LEGEND:

- TOWER
- TOWER BASE
- PODIUM
- DECK

NOTES:

MAXIMUM TOWER ENVELOPE
VOLUMETRIC UTILISATION 65%

REFER TO SECTION 7.2 OF THE
DESIGN REPORT FOR KEY DESIGN
CRITERIA

BALUSTRADES, PARAPETS, ROOF
FEATURES, SERVICES POLES AND
ANTENNA / ARIALS, AWNINGS,
ARTWORKS, GARDEN PAVILIONS,
KIOSKS, VEGETATION, SIGNAGE
AND STRUCTURES CAN EXTEND
BEYOND THE ENVELOPE



New South Wales Government
Independent Planning Commission

Issued under the Environmental Planning and Assessment Act 1979

Approved Application No. **SSD 7684**

granted on the **13 May 2019**

Signed **[Signature]**

Sheet No. **7** of **15**

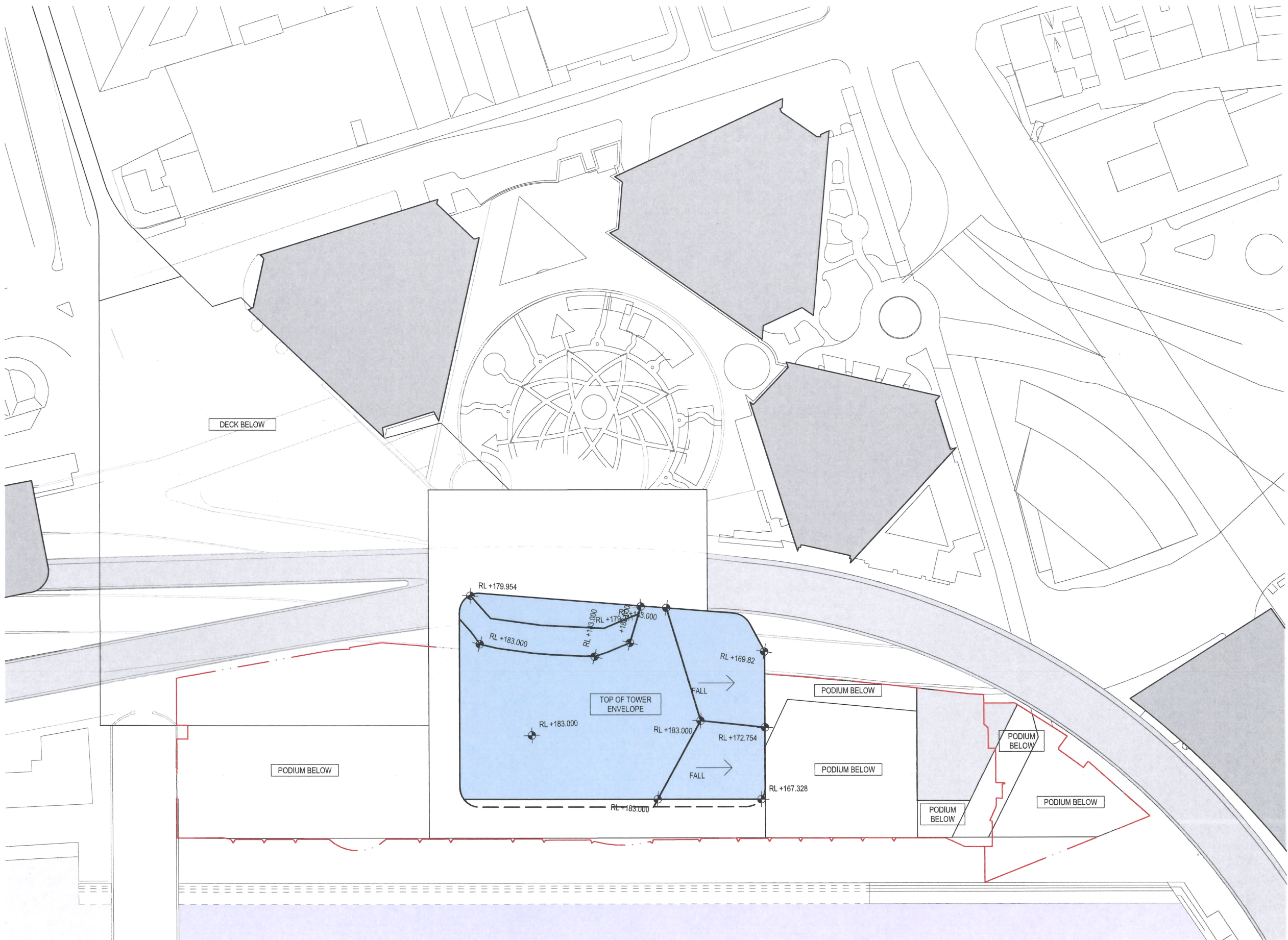
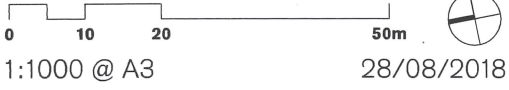

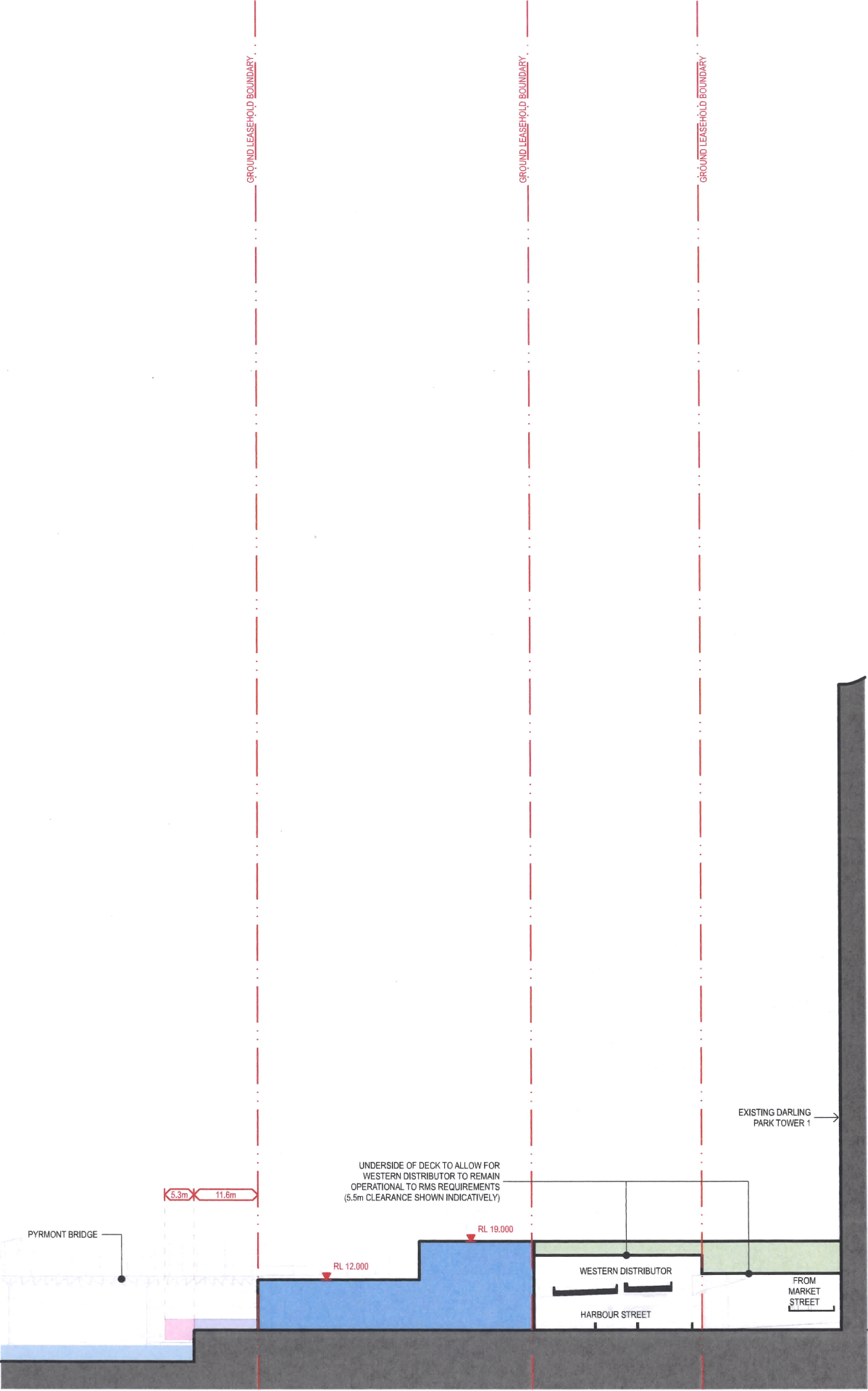

**STAGE 1 SSDA AMENDED
CONCEPT PROPOSAL**

LEGEND:

- TOWER
- TOWER BASE
- PODIUM
- DECK
- UPGRADES TO EXISTING PROMENADE
- EXTENSION TO BOARDWALK

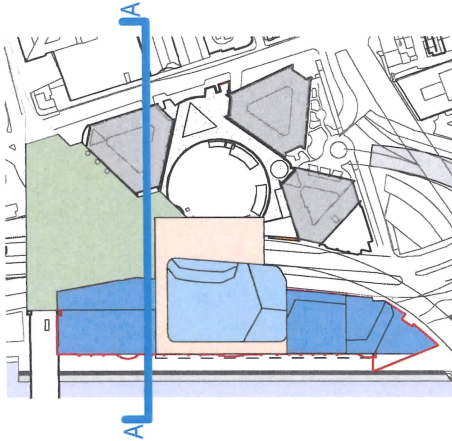

NOTES:

REFER TO SECTION 7.2 OF THE
DESIGN REPORT FOR KEY DESIGN
CRITERIA

BALUSTRADES, PARAPETS, ROOF
FEATURES, SERVICES POLES AND
ANTENNA / ARIALS, AWNINGS,
ARTWORKS, GARDEN PAVILIONS,
KIOSKS, VEGETATION, SIGNAGE
AND STRUCTURES CAN EXTEND
BEYOND THE ENVELOPE

New South Wales Government
Independent Planning Commission
Issued under the Environmental Planning and Assessment Act 1979
Approved Application No. SSD 7684
granted on the 13 May 2019
Signed [Signature]
Sheet No. 8 of 15

STAGE 1 SSDA AMENDED
CONCEPT PROPOSAL

LEGEND:

- TOWER
- TOWER BASE
- PODIUM
- DECK
- UPGRADES TO EXISTING PROMENADE
- EXTENSION TO BOARDWALK

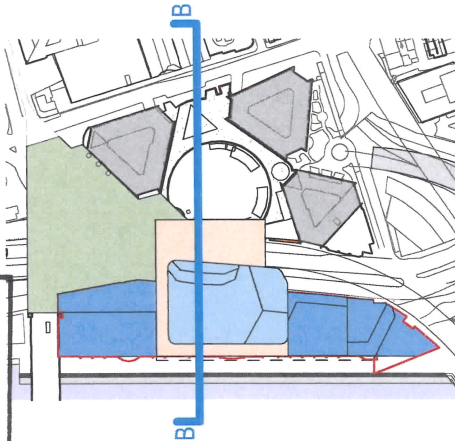

NOTES:

- MAXIMUM TOWER ENVELOPE
VOLUMETRIC UTILISATION 65%
- REFER TO SECTION 7.2 OF THE
DESIGN REPORT FOR KEY DESIGN
CRITERIA
- BALUSTRADES, PARAPETS, ROOF
FEATURES, SERVICES POLES AND
ANTENNA / ARIALS, AWNINGS,
ARTWORKS, GARDEN PAVILIONS,
KIOSKS, VEGETATION, SIGNAGE
AND STRUCTURES CAN EXTEND
BEYOND THE ENVELOPE

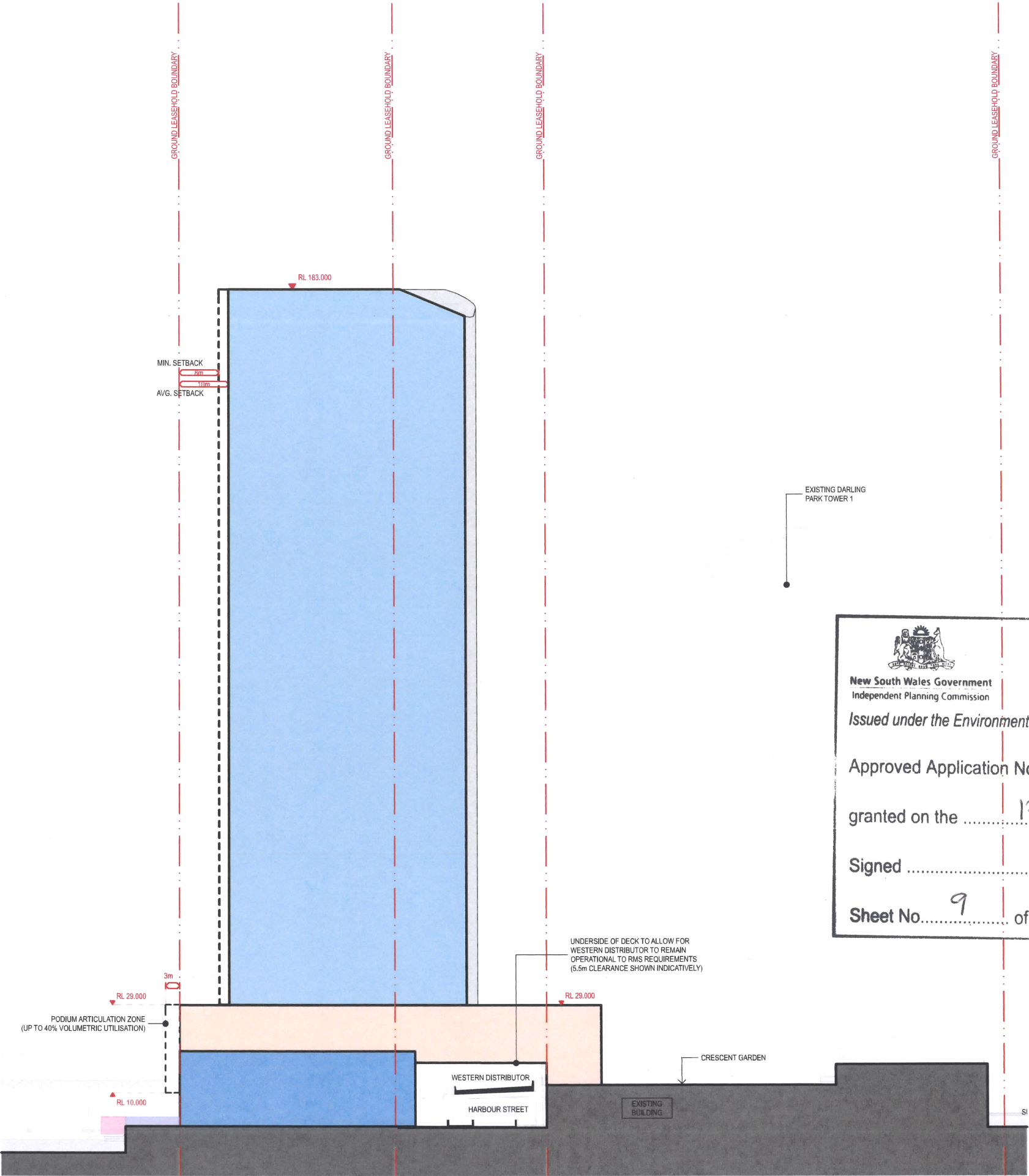

New South Wales Government
Independent Planning Commission

Issued under the Environmental Planning and Assessment Act 1979

Approved Application No. SSD 7684

granted on the 13 May 2019

Signed H

Sheet No. 9 of 15

Section B - Through Tower



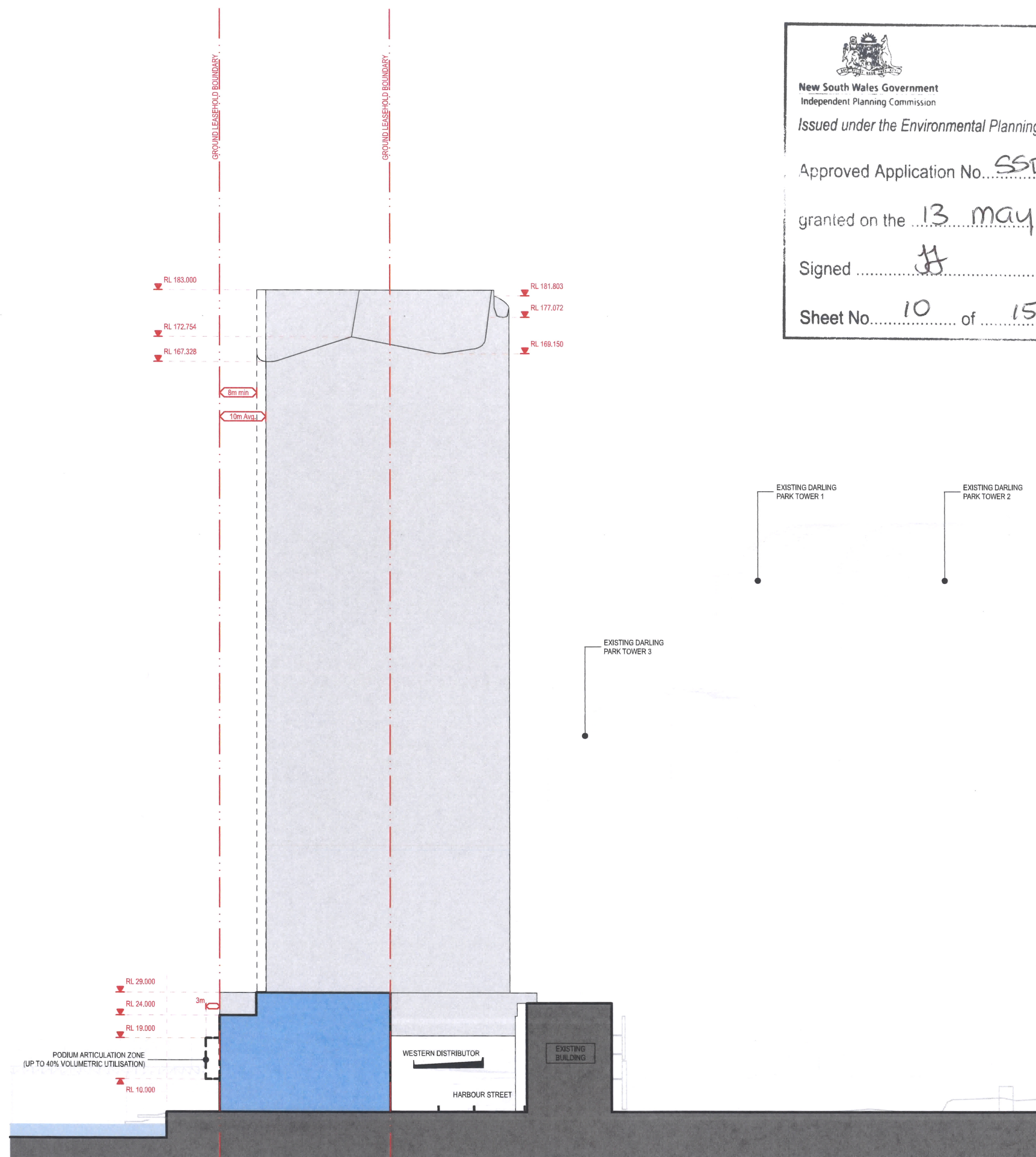

New South Wales Government
 Independent Planning Commission
Issued under the Environmental Planning and Assessment Act 1979

Approved Application No. SSD 7684

granted on the 13 May 2019

Signed [Signature]

Sheet No. 10 of 15

STAGE 1 SSDA AMENDED CONCEPT PROPOSAL

LEGEND:

- TOWER
- TOWER BASE
- PODIUM
- DECK

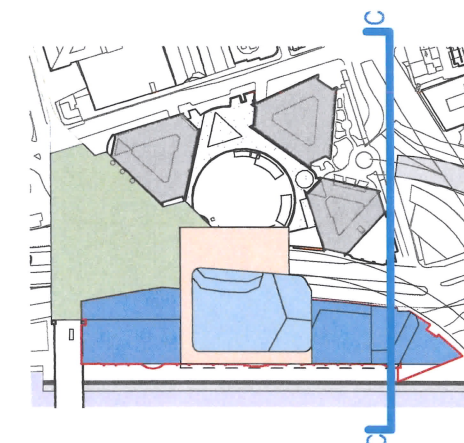

NOTES:

MAXIMUM TOWER ENVELOPE
VOLUMETRIC UTILISATION 65%

REFER TO SECTION 7.2 OF THE
DESIGN REPORT FOR KEY DESIGN
CRITERIA

BALUSTRADES, PARAPETS, ROOF
FEATURES, SERVICES POLES AND
ANTENNA / ARIALS, AWNINGS,
ARTWORKS, GARDEN PAVILIONS,
KIOSKS, VEGETATION, SIGNAGE
AND STRUCTURES CAN EXTEND
BEYOND THE ENVELOPE



New South Wales Government
 Independent Planning Commission
Issued under the Environmental Planning and Assessment Act 1979

Approved Application No. SSD 7684
 granted on the 13 May 2019
 Signed [Signature]
 Sheet No. 11 of 15

STAGE 1 SSDA AMENDED CONCEPT PROPOSAL

LEGEND:

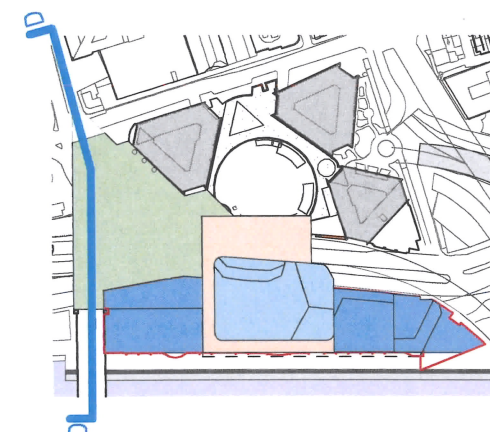
- TOWER
- TOWER BASE
- PODIUM
- DECK
- UPGRADES TO EXISTING PROMENADE
- EXTENSION TO BOARDWALK



NOTES:

REFER TO SECTION 7.2 OF THE
DESIGN REPORT FOR KEY DESIGN
CRITERIA

BALUSTRADES, PARAPETS, ROOF
FEATURES, SERVICES POLES AND
ANTENNA / ARIALS, AWNINGS,
ARTWORKS, GARDEN PAVILIONS,
KIOSKS, VEGETATION, SIGNAGE
AND STRUCTURES CAN EXTEND
BEYOND THE ENVELOPE

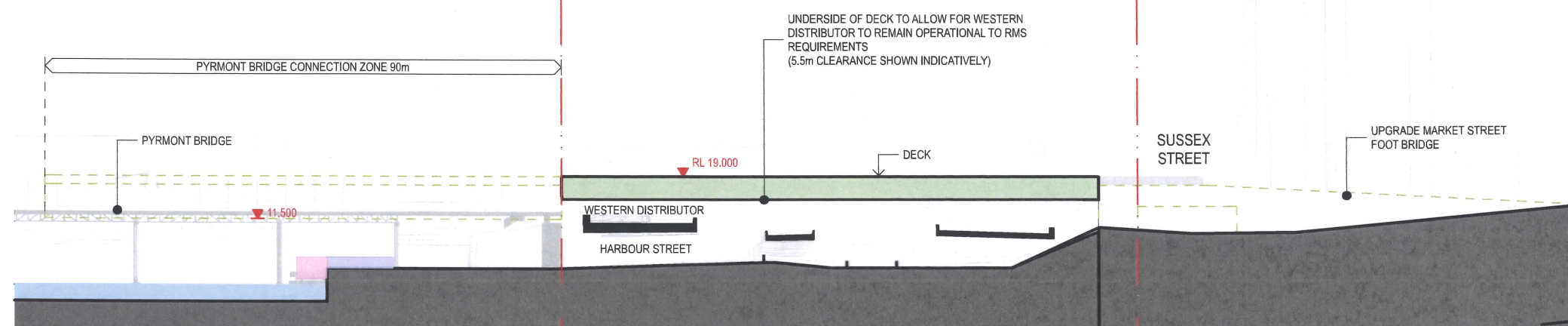

Section D - Through Land Bridge





New South Wales Government
Independent Planning Commission

Issued under the Environmental Planning and Assessment Act 1979

Approved Application No. SSD 7684

granted on the 13 May 2019

Signed [Signature]

Sheet No. 12 of 15

STAGE 1 SSDA AMENDED
CONCEPT PROPOSAL

LEGEND:

- TOWER
- TOWER BASE
- PODIUM
- DECK

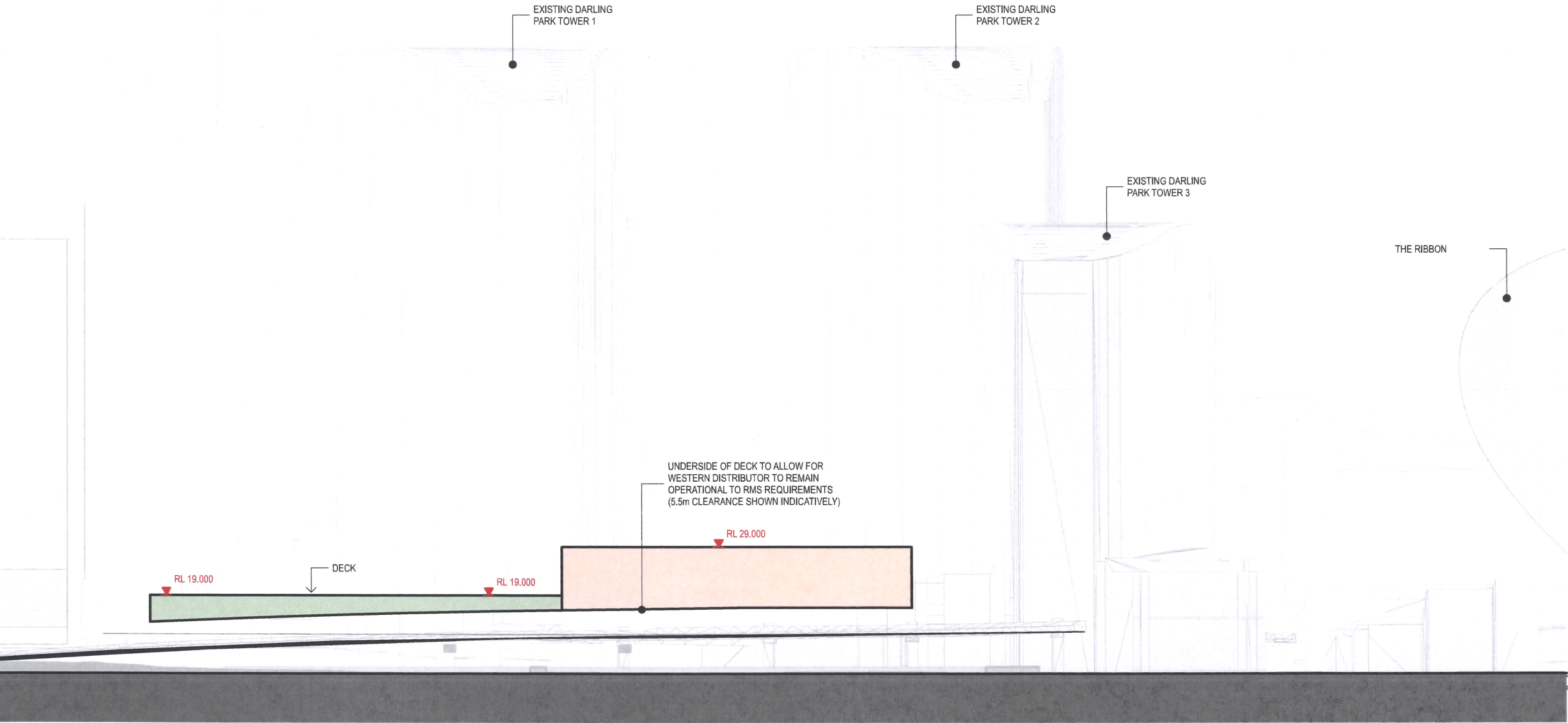
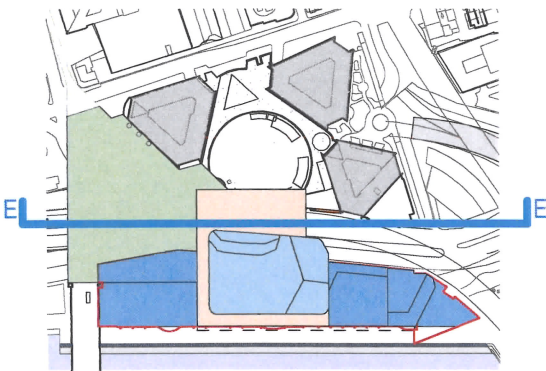

NOTES:

REFER TO SECTION 7.2 OF THE
DESIGN REPORT FOR KEY DESIGN
CRITERIA

BALUSTRADES, PARAPETS, ROOF
FEATURES, SERVICES POLES AND
ANTENNA / ARIALS, AWNINGS,
ARTWORKS, GARDEN PAVILIONS,
KIOSKS, VEGETATION, SIGNAGE
AND STRUCTURES CAN EXTEND
BEYOND THE ENVELOPE

STAGE 1 SSDA AMENDED
CONCEPT PROPOSAL

LEGEND:

- TOWER
- TOWER BASE
- PODIUM
- DECK

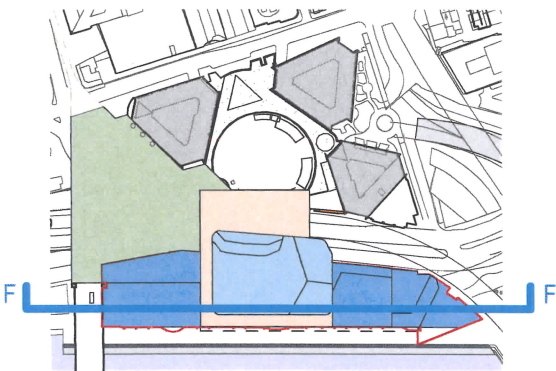

NOTES:

- MAXIMUM TOWER ENVELOPE
VOLUMETRIC UTILISATION 65%
- REFER TO SECTION 7.2 OF THE
DESIGN REPORT FOR KEY DESIGN
CRITERIA
- BALUSTRADES, PARAPETS, ROOF
FEATURES, SERVICES POLES AND
ANTENNA / ARIALS, AWNINGS,
ARTWORKS, GARDEN PAVILIONS,
KIOSKS, VEGETATION, SIGNAGE
AND STRUCTURES CAN EXTEND
BEYOND THE ENVELOPE

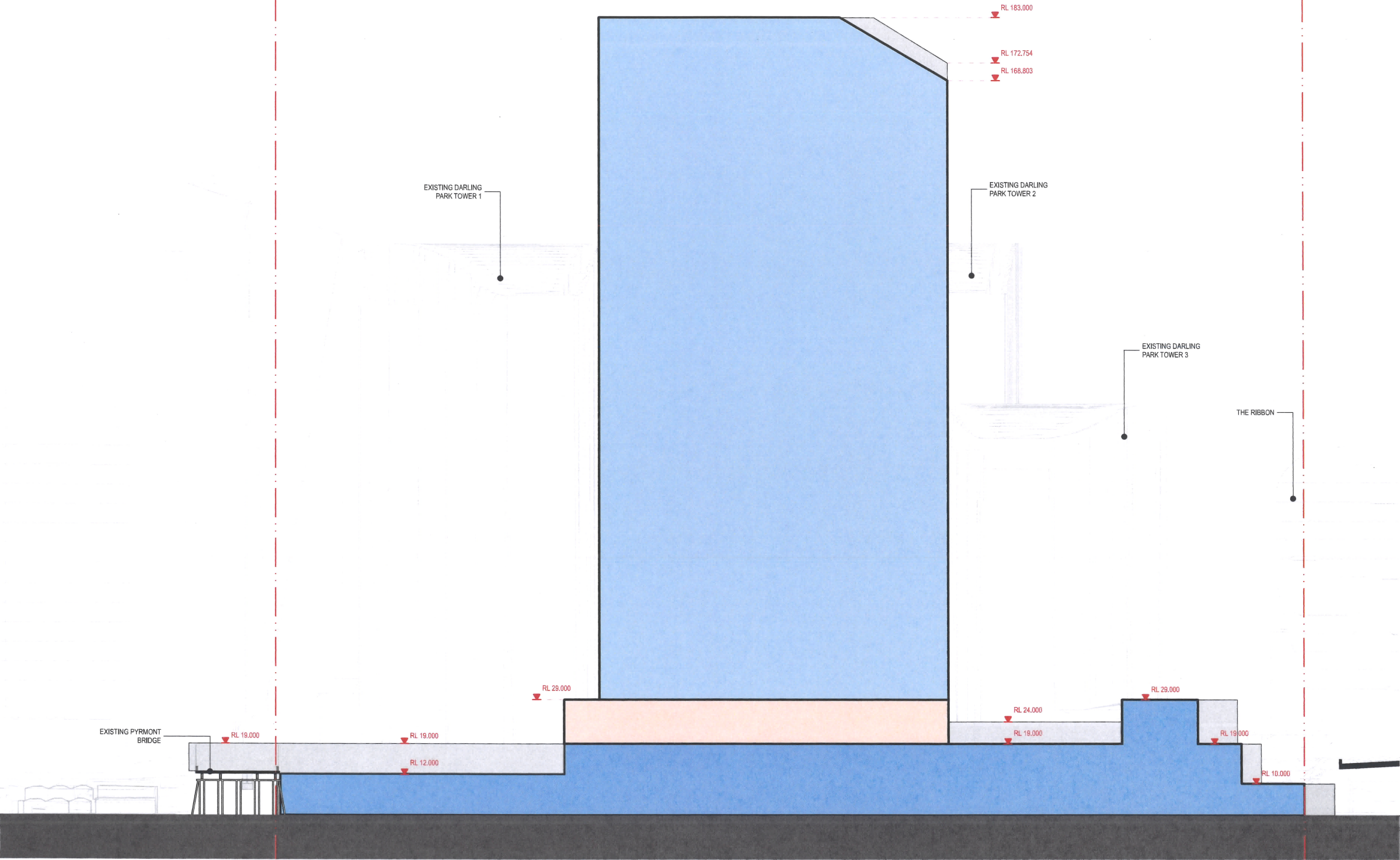

Section F - North to South



New South Wales Government
Independent Planning Commission

Issued under the Environmental Planning and Assessment Act 1979

Approved Application No. SSD 7684

granted on the 13 May 2019

Signed [Signature]

Sheet No. 14 of 15

STAGE 1 SSDA AMENDED CONCEPT PROPOSAL

LEGEND:

- TOWER
- TOWER BASE
- PODIUM
- DECK

NOTES:

MAXIMUM TOWER ENVELOPE
VOLUMETRIC UTILISATION 65%

REFER TO SECTION 7.2 OF THE
DESIGN REPORT FOR KEY DESIGN
CRITERIA

BALUSTRADES, PARAPETS, ROOF
FEATURES, SERVICES POLES AND
ANTENNA / ARIALS, AWNINGS,
ARTWORKS, GARDEN PAVILIONS,
KIOSKS, VEGETATION, SIGNAGE
AND STRUCTURES CAN EXTEND
BEYOND THE ENVELOPE

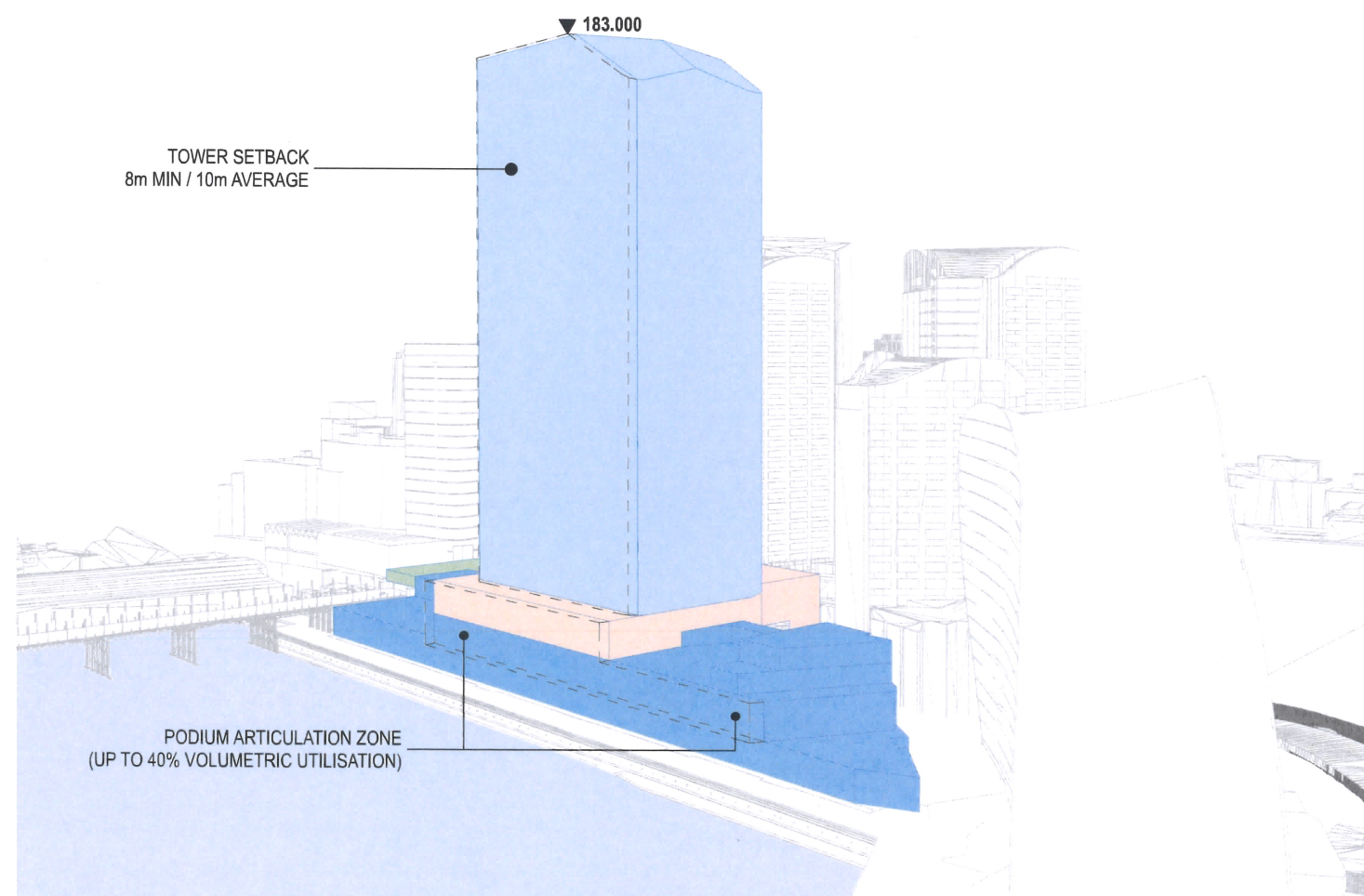

Building Envelope- 3D View

New South Wales Government
 Independent Planning Commission

Issued under the Environmental Planning and Assessment Act 1979

Approved Application No. SSD 7684

granted on the 13 May 2019

Signed [Signature]

Sheet No. 15 of 15

STAGE 1 SSDA AMENDED CONCEPT PROPOSAL

LEGEND:

- TOWER
- TOWER BASE
- PODIUM
- DECK

NOTES:

MAXIMUM TOWER ENVELOPE
VOLUMETRIC UTILISATION 65%

REFER TO SECTION 7.2 OF THE
DESIGN REPORT FOR KEY DESIGN
CRITERIA

BALUSTRADES, PARAPETS, ROOF
FEATURES, SERVICES POLES AND
ANTENNA / ARIALS, AWNINGS,
ARTWORKS, GARDEN PAVILIONS,
KIOSKS, VEGETATION, SIGNAGE
AND STRUCTURES CAN EXTEND
BEYOND THE ENVELOPE

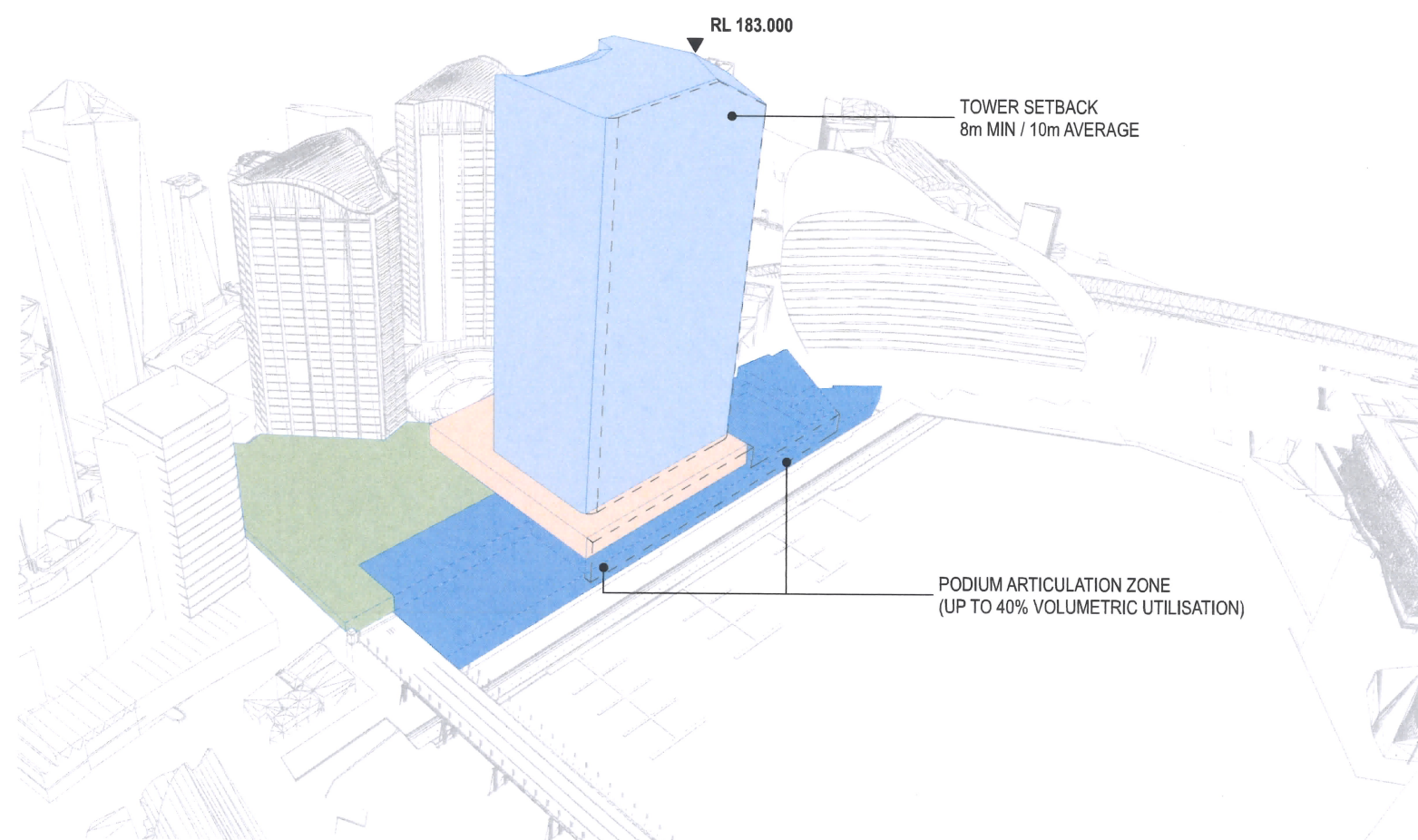

Building Envelope-3D View 2