

Key Views - 188 Chalmers Street



Key Plan



Street view



Elevation Chalmers St
1:500

EXISTING

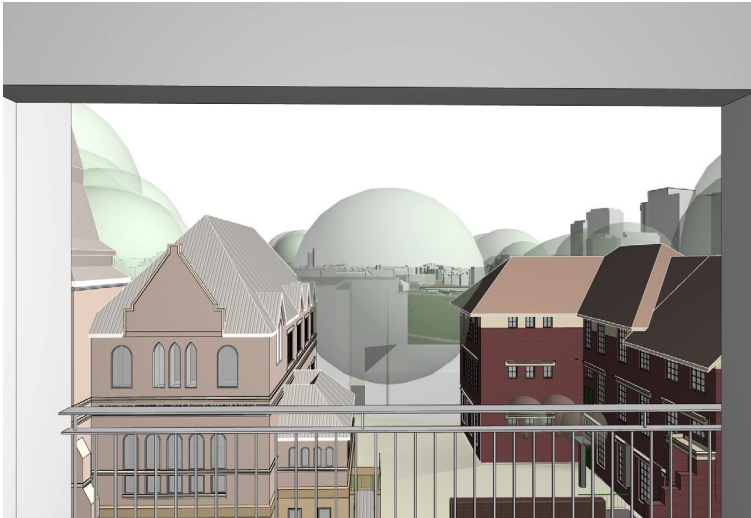

L4D9

PROPOSED



L4D9

Key Views - 204 Chalmers Street



Street view



Key Plan



Elevation Chalmers St
1:500

EXISTING

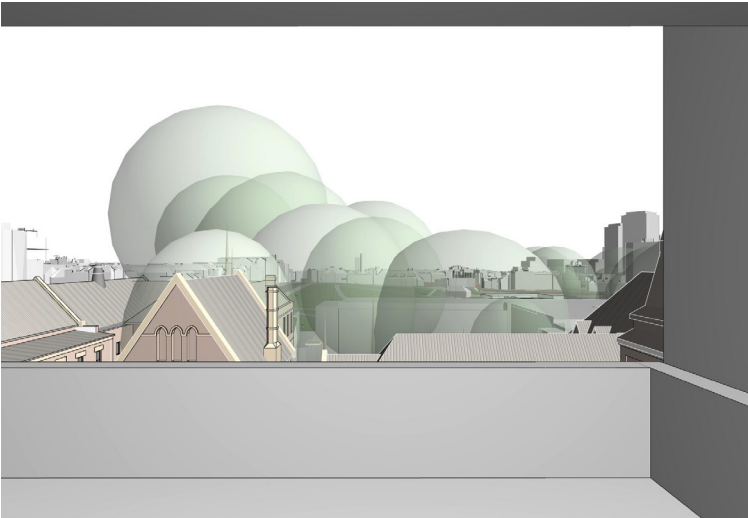

L5 D5

PROPOSED



L5 D5

8.0 Public Domain, Public Open Space and Community Uses

Recreational and Games Areas

- information identifying alternative locations where students would participate in active sports, in the event the park is not able to accommodate all of the school's needs

As identified in Section 8.2, Organisational Strategies: Outdoor Learning and Recreational Areas, the proposal provides for a variety of external recreational, learning and games areas. One of the important characteristics of a campus is the differentiation of experiences.

At the site is constrained, in order to accommodate high quality outdoor areas, four large undercroft areas have been created as well as the “*Verandah*” which provides Outdoor Learning. The undercroft areas located on Ground and Level 1, provide large protected areas with a close connection to Prince Alfred Park. More intimate courtyards are provided within the lower levels of the “*Village Campus*”.

A large external Games Court is provided on Level 5, with an adjacent undercroft Games Area. This court can accommodate a full sized basketball court. It will be enclosed with netting, using a similar language to the Prince Alfred Park Pool and will also have a protective lightweight net over to prevent objects from entering the park.

Additional elevated undercroft areas are provided on Level 9 and the roof.

Community Facilities

- opportunities for the provision of community facilities within the new school that can be utilised by the general public

It is envisaged that there will be a number of opportunities for the provision of community facilities within the new school that can be utilised by the general public.

As outlined in Section 9.0 Educational Planning Strategies, “the design of learning environments should acknowledge that the greatest impact on learners is the well being of the whole family and the social capital of the community. Therefore the learning environment should be designed with the needs of the community in mind and should remove as many barriers to inclusion as possible by incorporating settings and graded degrees of access appropriate to the community's context.”

The project team is currently in discussion with stakeholders, including the City of Sydney Council, to understand the potential for shared community facilities. The backbone of a clear circulation and wayfinding strategy has been developed which allows for a secure response to community access after hours and during the weekend. This strategy will be further developed once engagement is made with the new school management.

As outlined in Section 9.0 Educational Planning Strategies, “there is a need to secure the site while at the same time offering a sense of openness for students and families. The site and its facilities have been configured using a public, privileged and private zoning strategy with the appropriate amount of space allocated to invite community participation while at the same time protecting users and assets.”

It is envisaged that the community access will occur mainly on Basement, Lower Ground and Ground Level with potential access to the Welcome Hub (Cafeteria and open areas) on Level 1. Here the community will potentially have access

to sporting and performance facilities. Whilst entry must be controlled, there is a potential for direct entry from Prince Alfred Park to the Gymnasium and the Lower Ground Level Performance areas.

As outlined in Section 9.0 Educational Planning Strategies, “the configuration of spaces creates a vibrant and active street level accessible to the public and linked to gathering spaces, meeting spaces, performance spaces and sports facilities above and below to the main community hub. This can be used by students for study and might possibly serve as a more convenient study location for local students from other learning institutions. The learning and meeting areas within this space might also attract business and community groups seeking new spaces to collaborate and network.”



View from Student and Community Hub towards Prince Alfred Park.