

3.0 Landscape Character Zones

1 THE HOLLOW

A quieter recreational space sunken in between the heritage buildings. Deciduous screening landscaping will provide privacy from Chalmers Street whilst allow sun access into the court. The edges will be used for quieter more contemplative spaces with opportunities for activities such as table tennis in the open areas.

2 THE AMPHITHEATRE

A special gathering space at the heart of the school directly connected to the Student and Community Hub. The Quadrangle can be used for performances, presentations or recreation.

3 NORTHERN PARK INTERFACE

Access from the northern gate will allow students to spill out into the park, accessing shaded seating and concrete paved zones that will be constructed to prevent trampling to the root zones of the existing trees, and provide pathways over the low lying wet areas, connecting to the existing park pathway network.

Planting themes, furniture detailing and pathway materials all take their cue from the existing park palette.

4 WESTERN PARK INTERFACE

The existing footpath to the immediate west of the school boundary has been relocated further east, to allow a planting zone to encompass the building and soften the interface.

A new seatwall provides flood mitigation along the park side for the 1 in 100 year flood event and activates the western interface. A DDA compliant pathway provides direct access to the north /south pathway .

The relocation of the pathway improves sight lines along the length of the path generally.

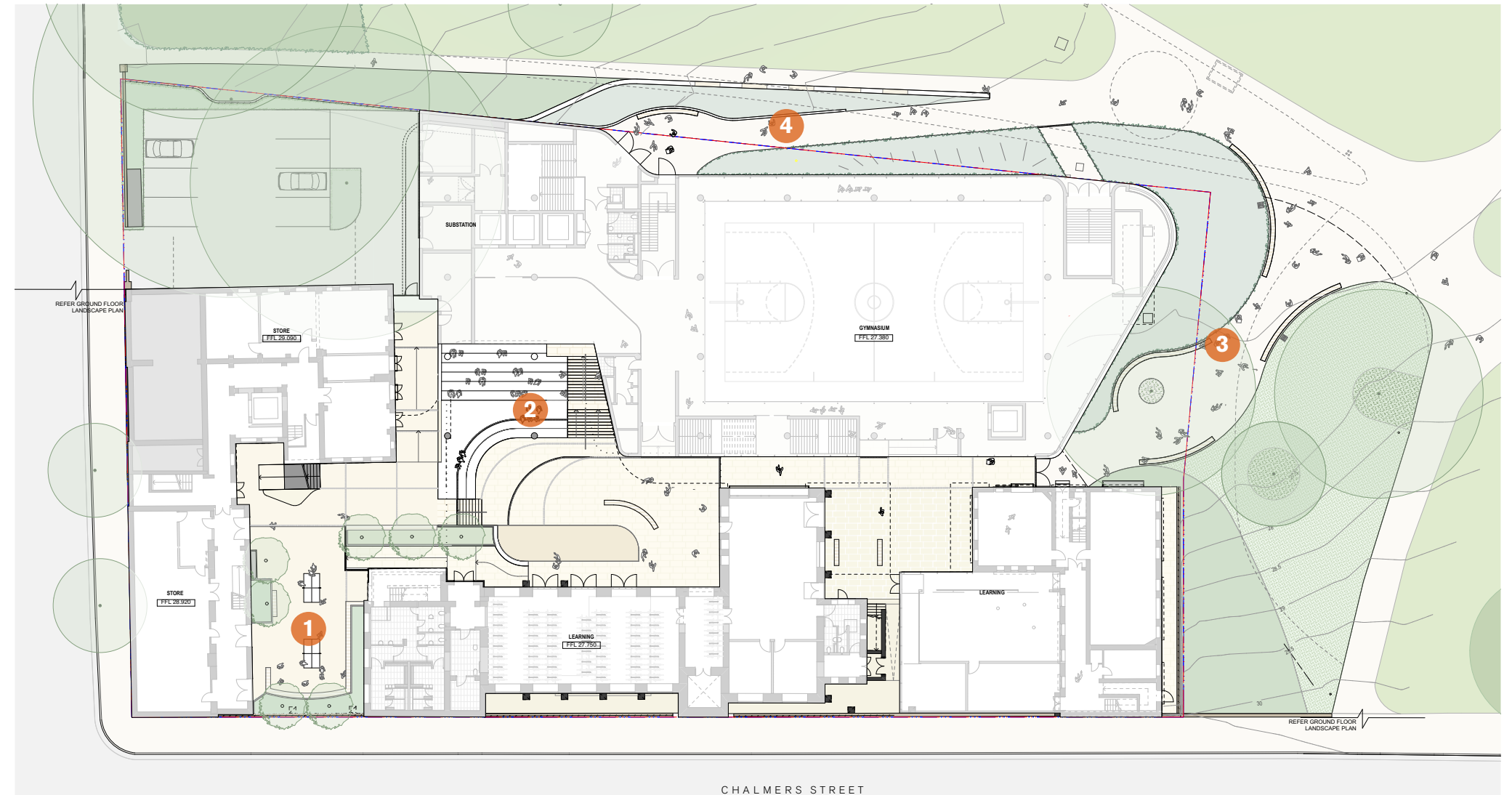

EXISTING PARK CHARACTER



Timber seating



Plant species palette



Existing park trees

PARK INTERFACE

