

Plan

1:20

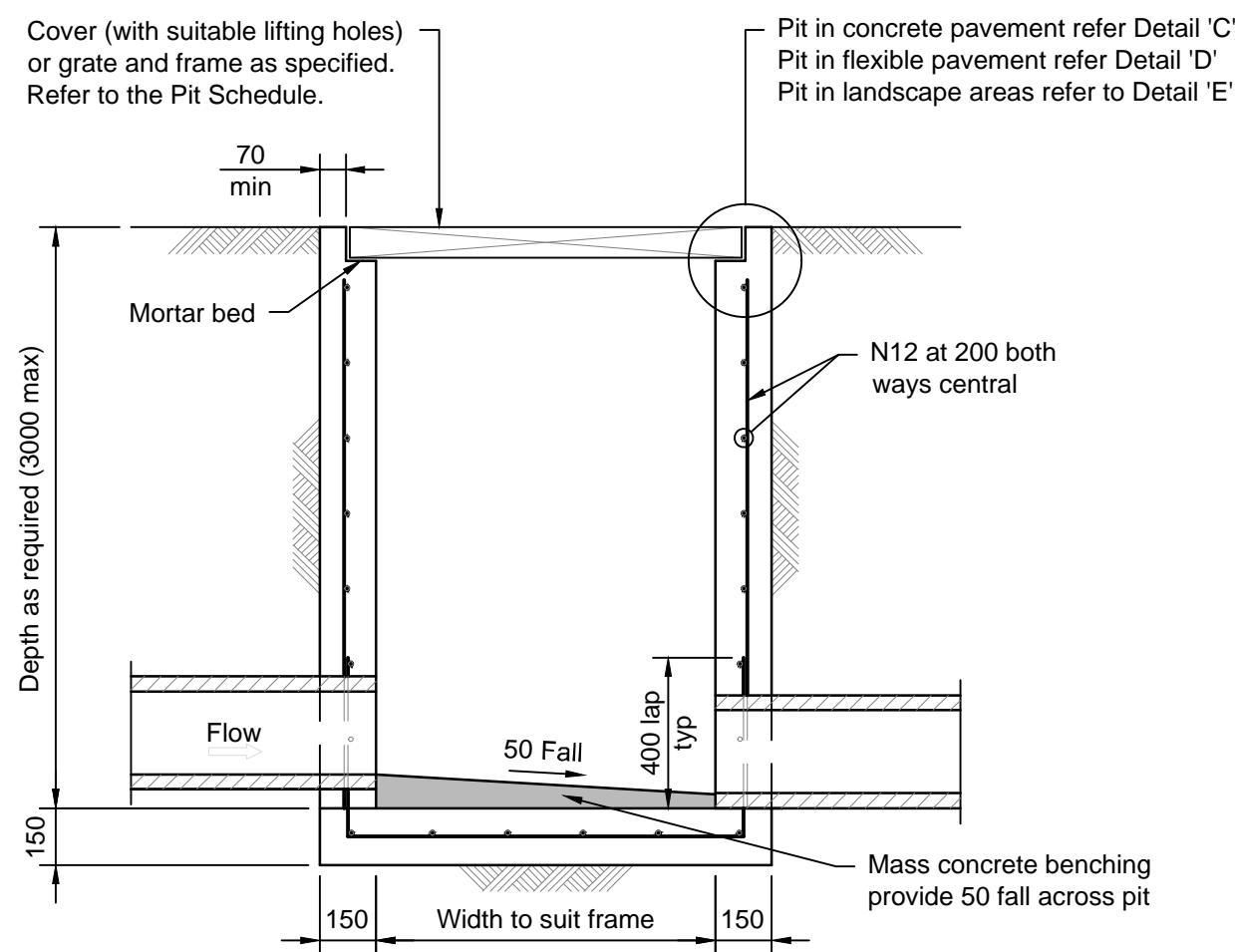

Section

1:20

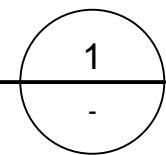

Provide step irons if pit deeper than 1000 (refer detail)

Surface Inlet / Junction Pit

(pipe sizes ≤ Ø450)

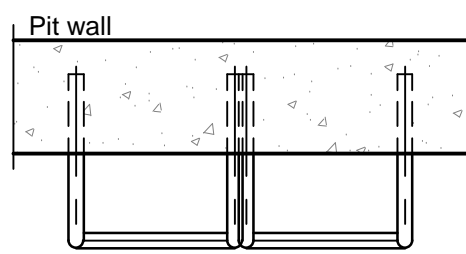

Plan

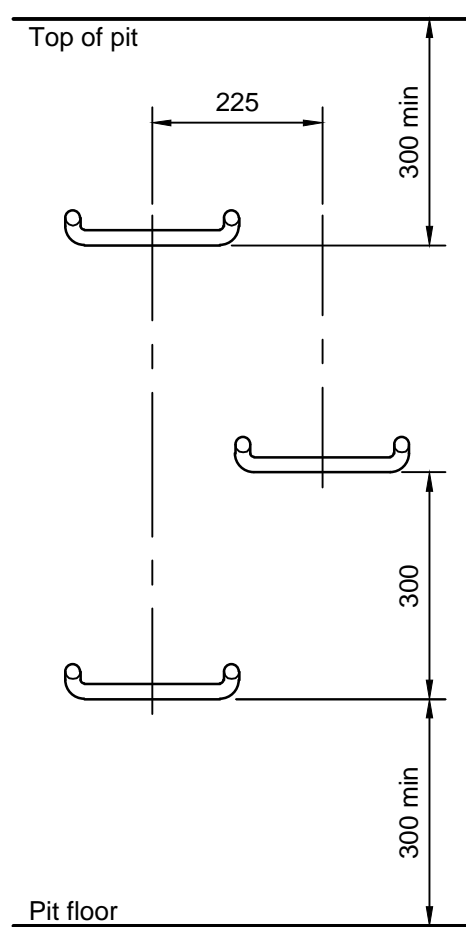

Elevation

Step Iron Placement to Pit Wall

NTS

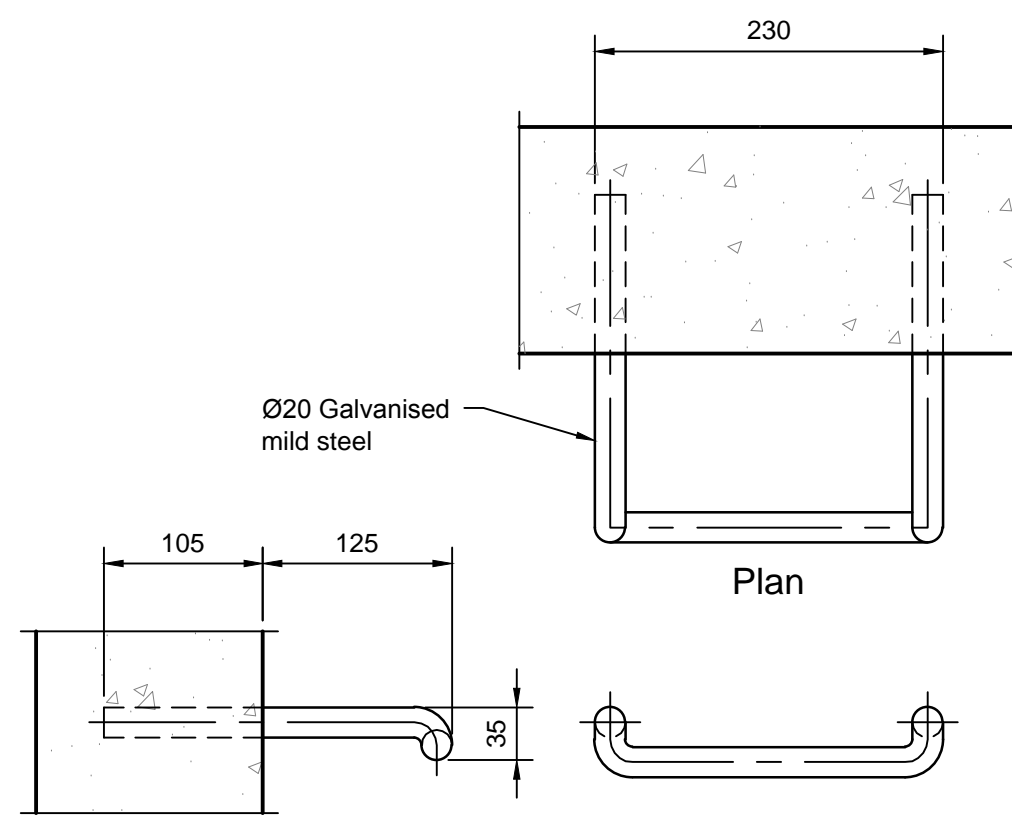

Side Elevation

Front Elevation

Step Iron Detail

1:5

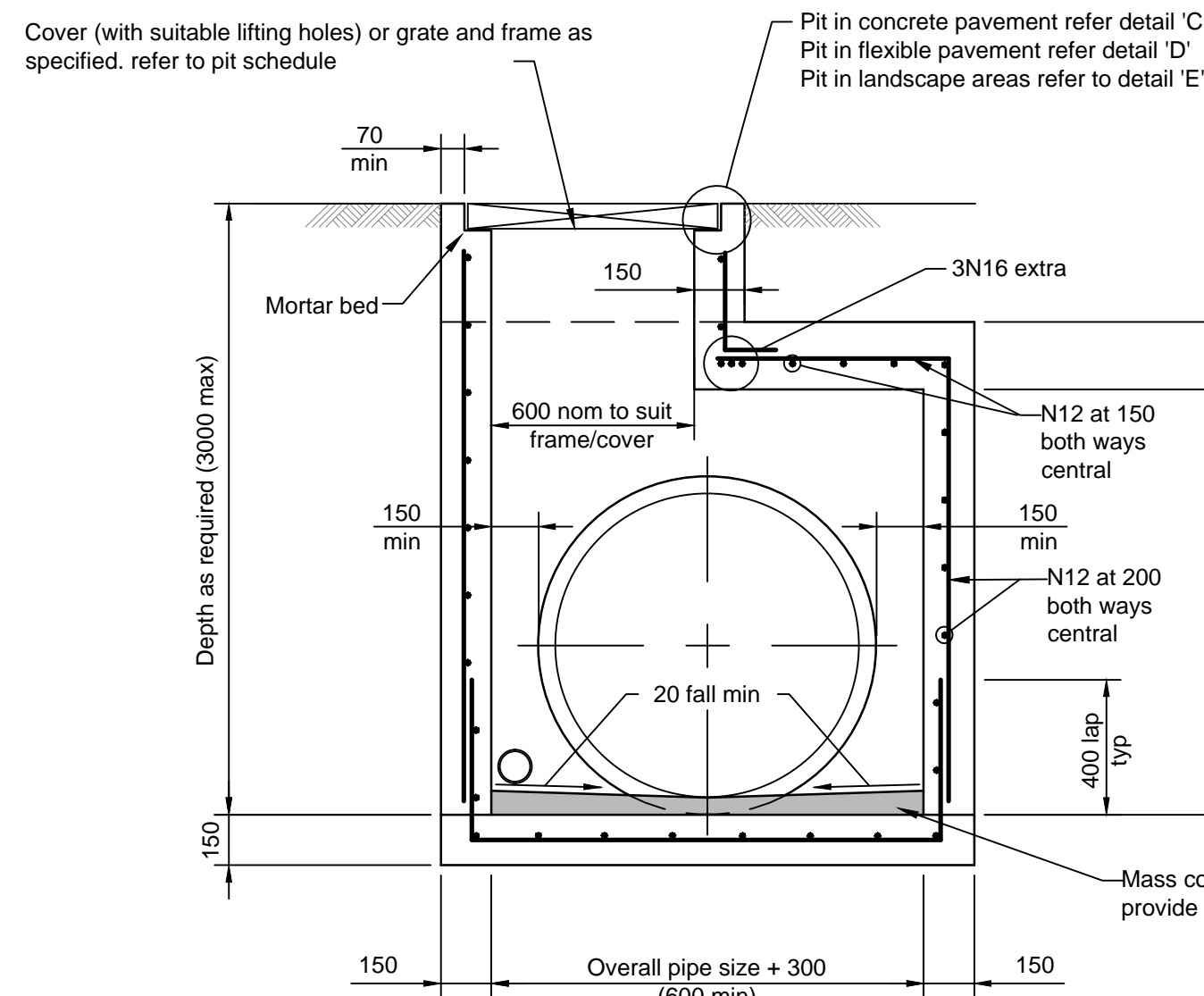

Section

1:20

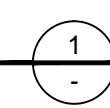

Surface inlet / junction pit

( pipe sizes > Ø450 )

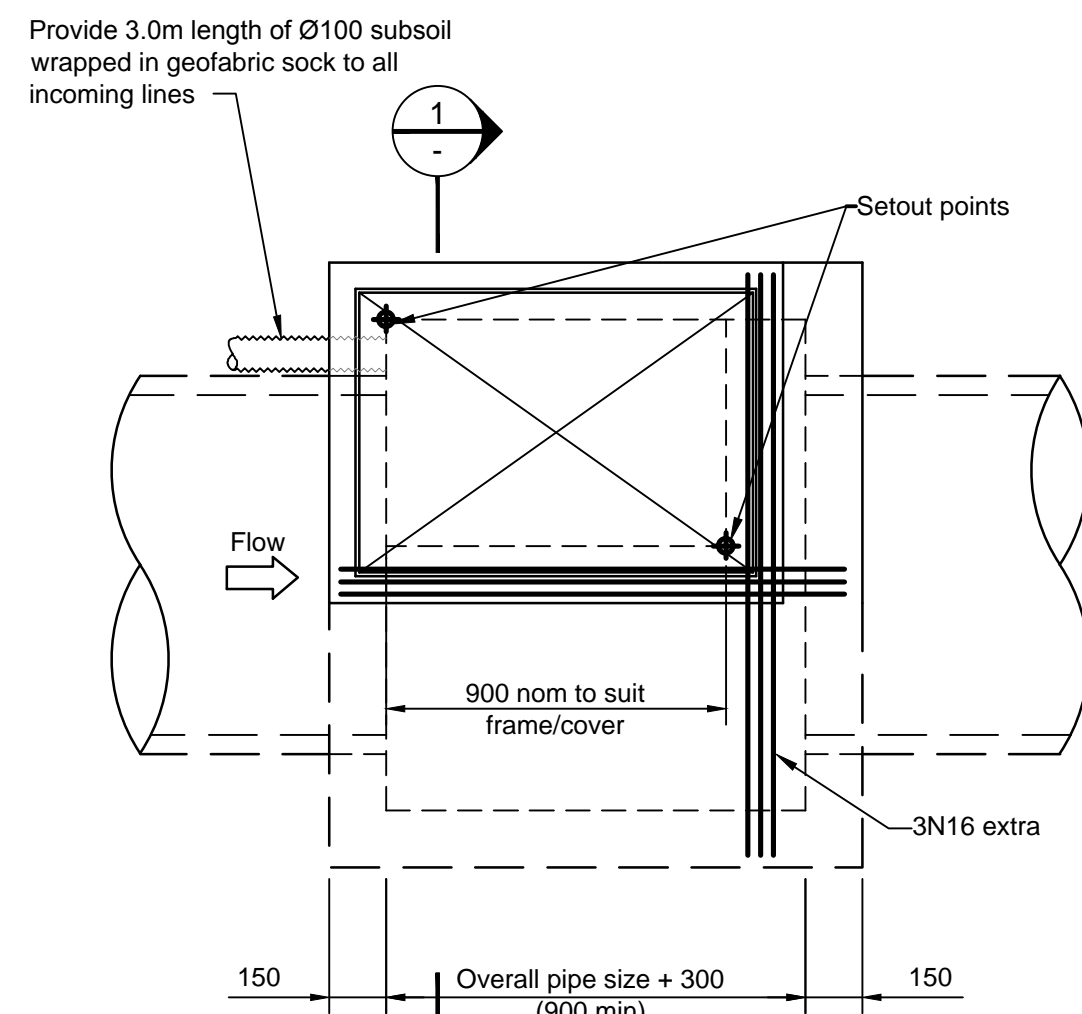

Plan

1:20

Provide step irons if pit deeper than 1000 (refer detail)

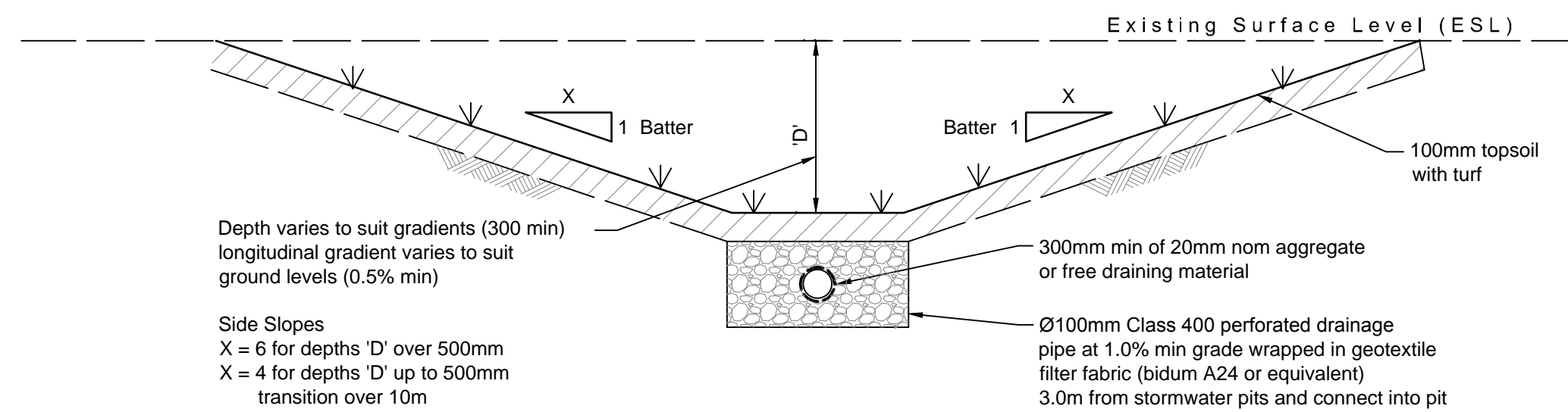

Grass Lined Swale

1:20

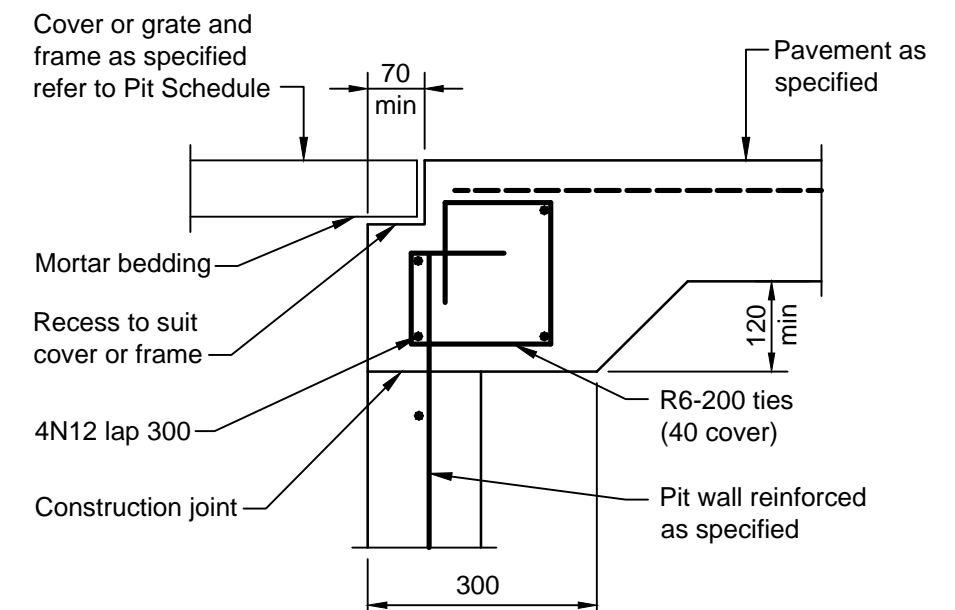

Detail 'C'

1:10

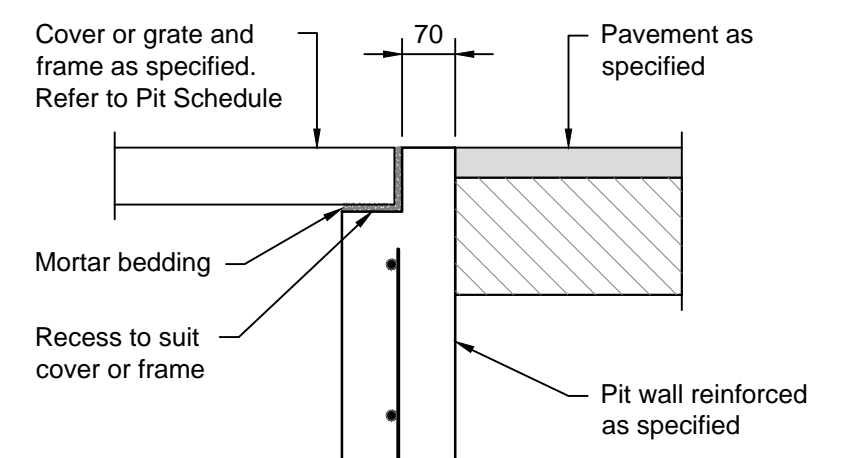

Detail 'D'

1:10

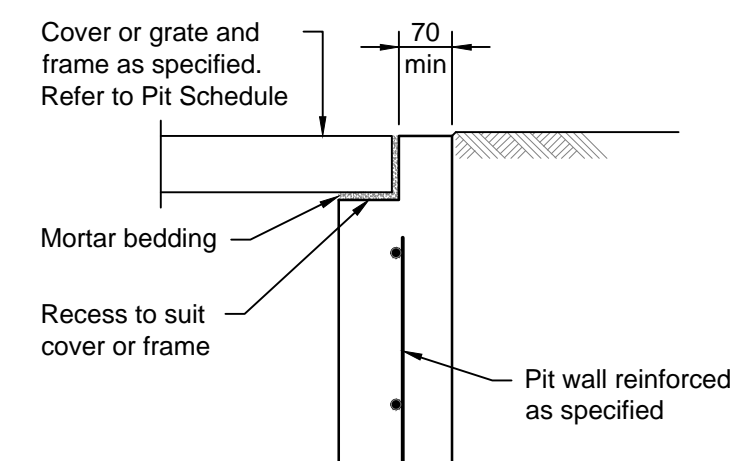

Detail 'E'

1:10

Preliminary - Not for Construction

© Mott MacDonald  
This document should not be relied on or used in circumstances other than those for which it was originally prepared and for which Mott MacDonald was commissioned. Mott MacDonald accepts no responsibility for this document to any other party other than the person by whom it was commissioned.

Rev	Date	Drawn	Description	Ch'k'd	App'd
P4	13.05.16	AMP	Issued for Approval - Minor Amendments	SR	CJA
P3	11.05.16	AMP	Issued for Approval - Minor Amendments	SR	CJA
P2	06.05.16	AMP	Issued for Approval	SR	CJA
P1	22.04.16	AMP	Issued Client Review	SR	X

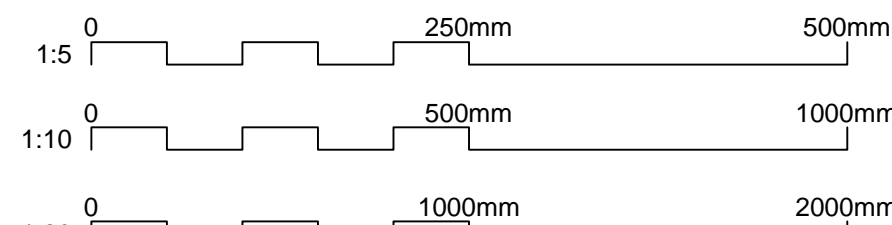

Level 10, 383 Kent Street  
Sydney, NSW 2000  
Australia  
PO Box Q1678  
QVB Sydney NSW 1230  
T +61 (0)2 9098 6800  
W www.mottmac.com.au

Client  
Gregory Hills  
Development Company  
Pty Ltd

Title  
Gregory Hills Corporate Park  
Camden Medical Campus  
Civil Works  
Stormwater Drainage Details  
Sheet 1

Designed	C Keenan	06.05.16	Eng check	S Reilly	06.05.16
Drawn	A Paciben	06.05.16	Coordination	S Reilly	06.05.16
Dwg check	G Collins	06.05.16	Approved	C. Avis	06.05.16
Scale at A1	Status	Rev	P4	Sec	STD
As Shown	PRE				
Drawing Number	MMD-368851-C-DR-CA-DA-0140				



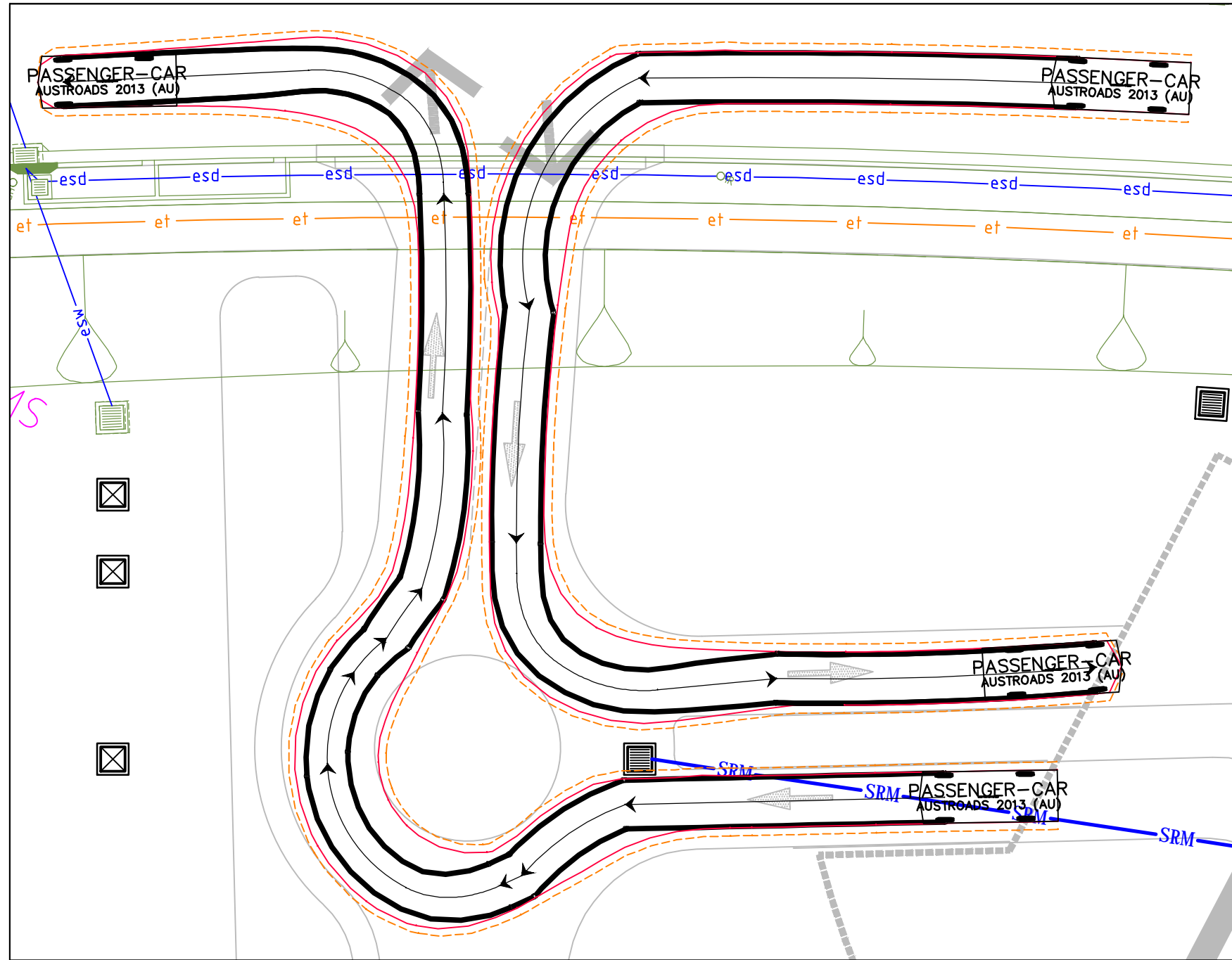

Inset A  
1:200

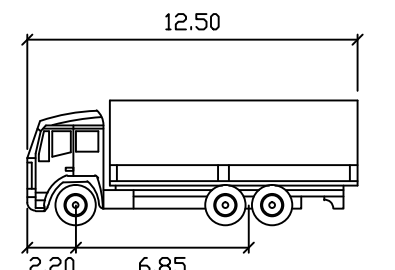

SU Truck meters  
Width : 2.50  
Track : 2.50  
Lock to Lock Time : 6.0  
Steering Angle : 35.6

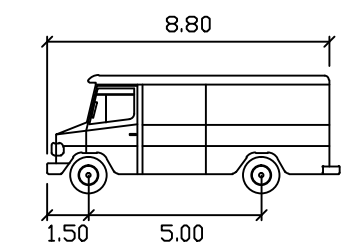

Service Vehicle meters  
Width : 2.50  
Track : 2.50  
Lock to Lock Time : 6.0  
Steering Angle : 38.7

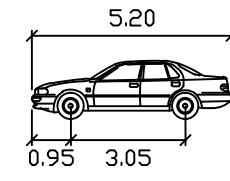

Passenger-car meters  
Width : 1.94  
Track : 1.84  
Lock to Lock Time : 6.0  
Steering Angle : 33.6

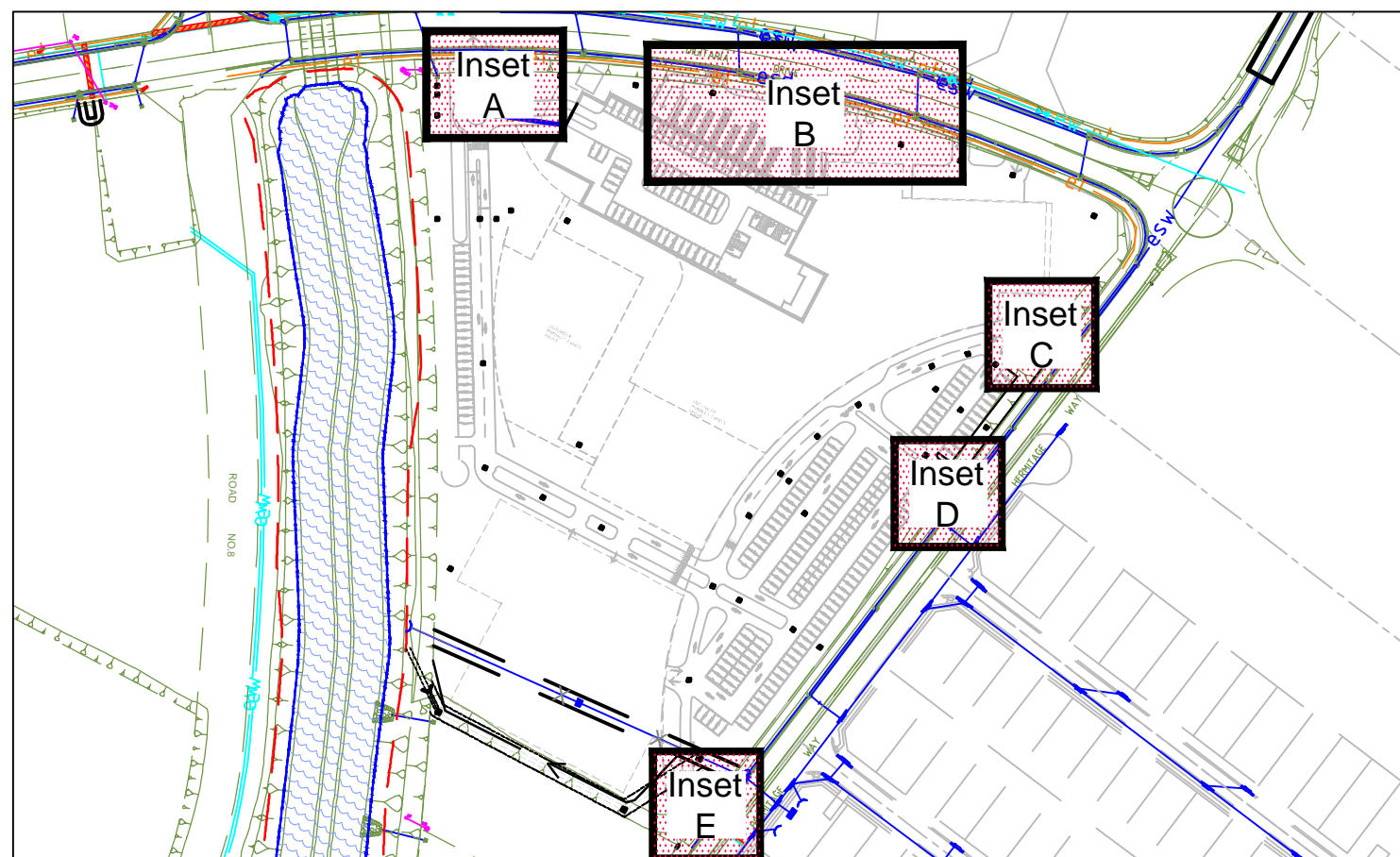
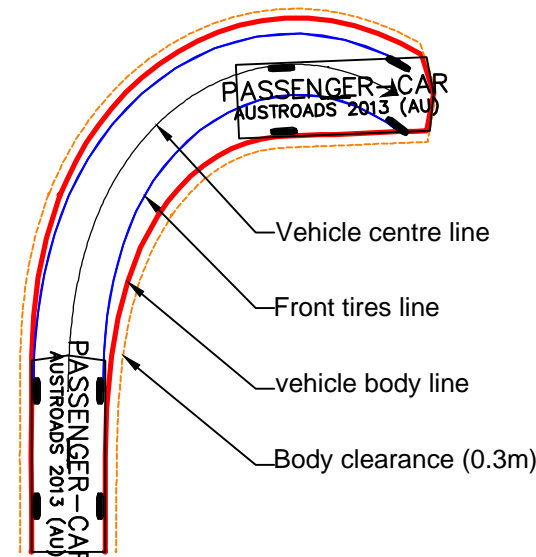

Key Plan  
NTS

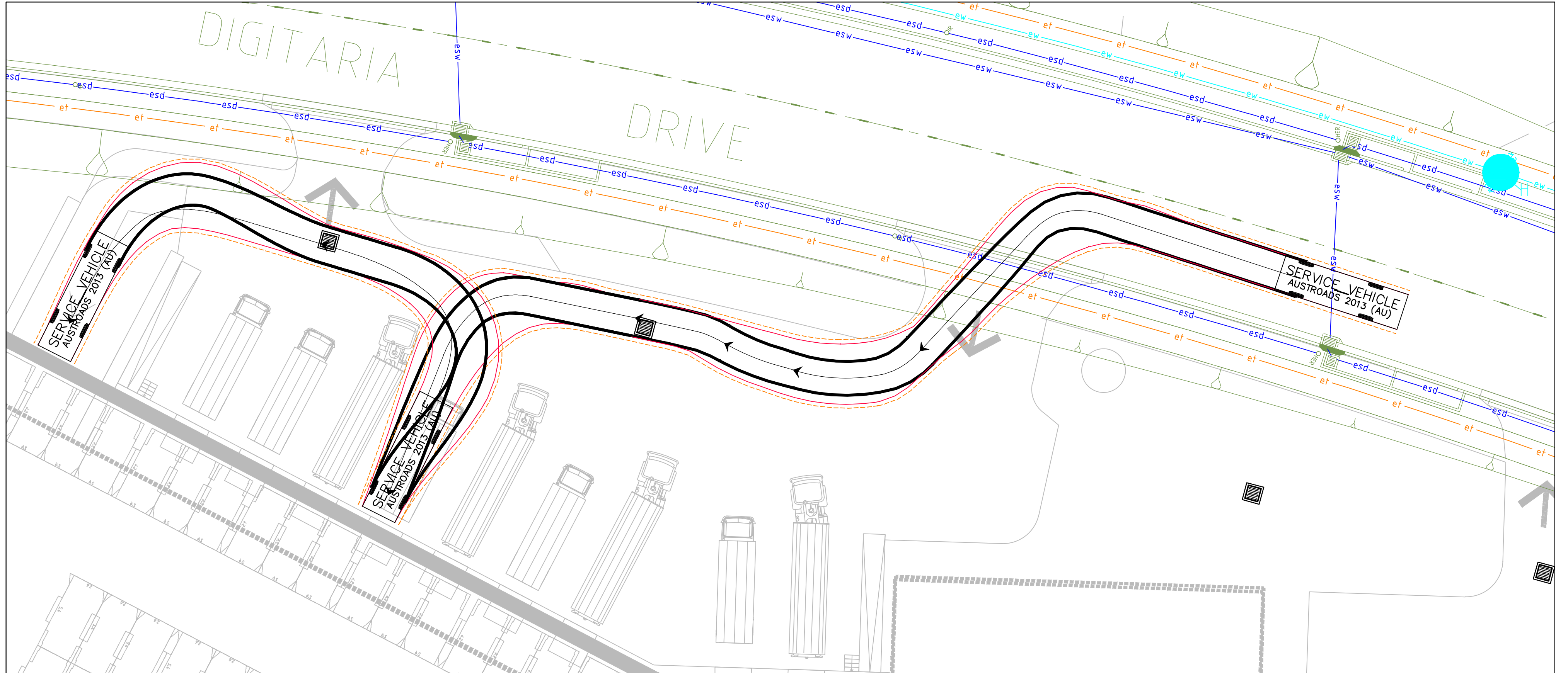

Inset B  
1:200

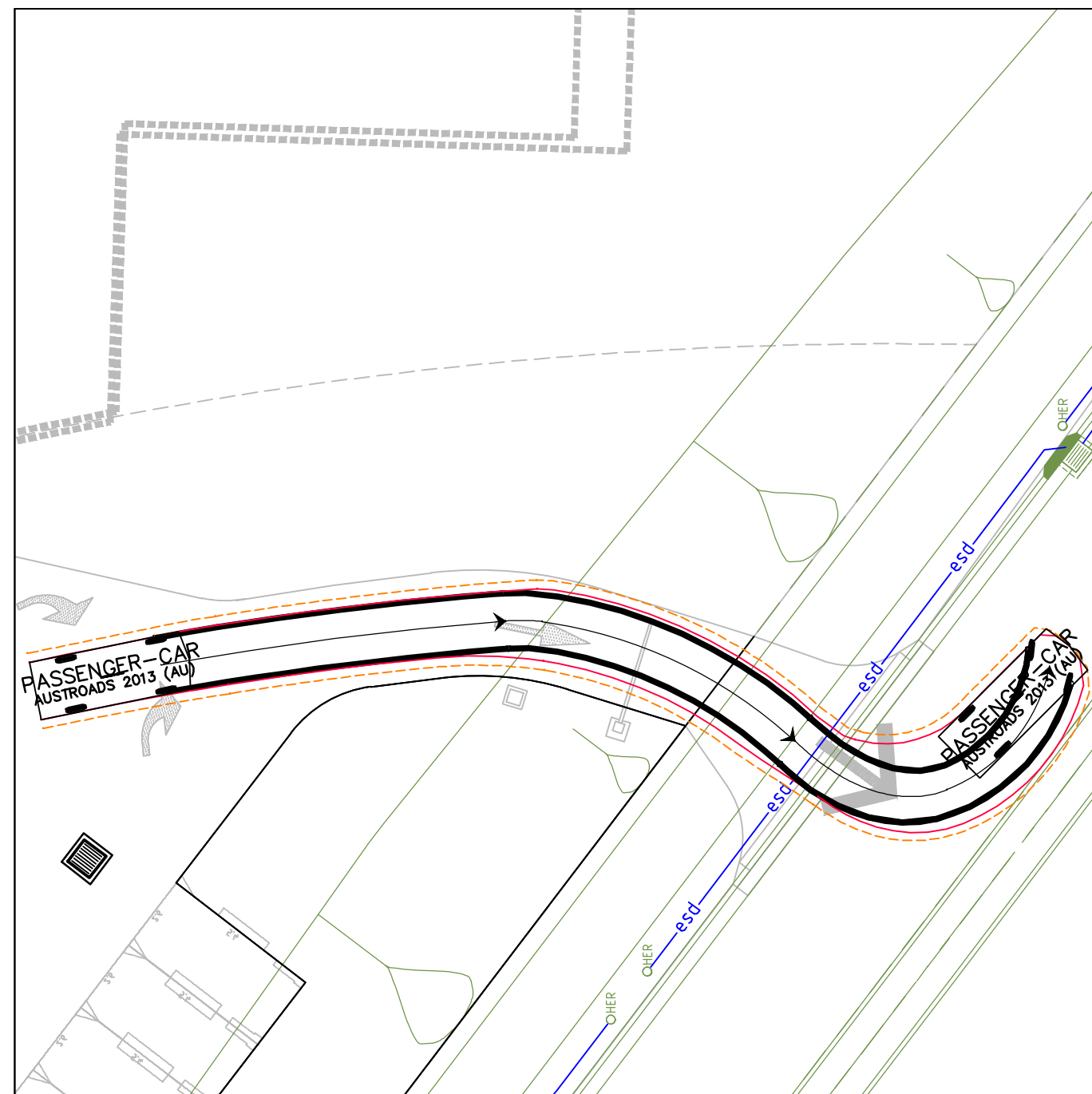

Inset C  
1:200

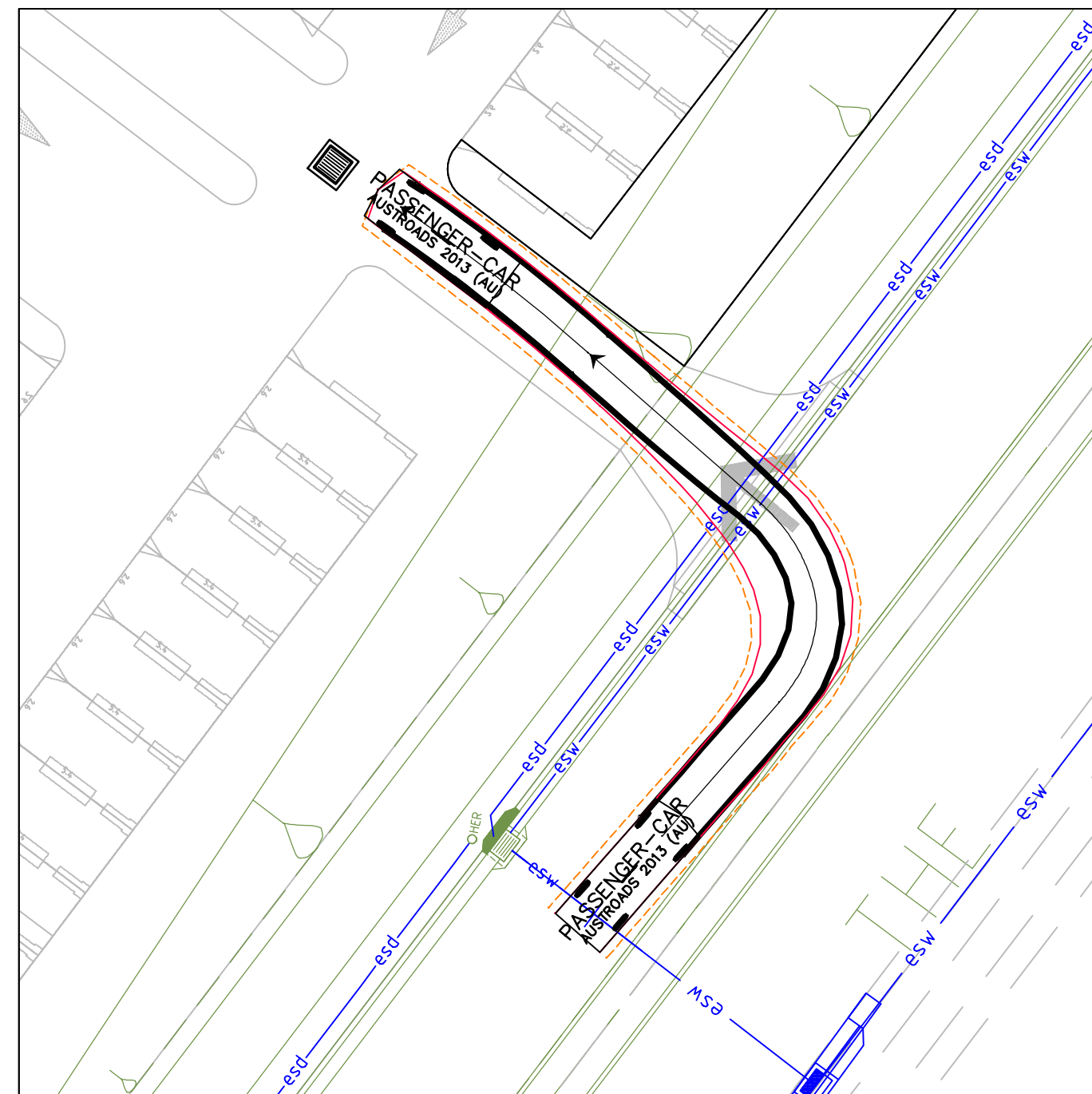

Inset D  
1:200

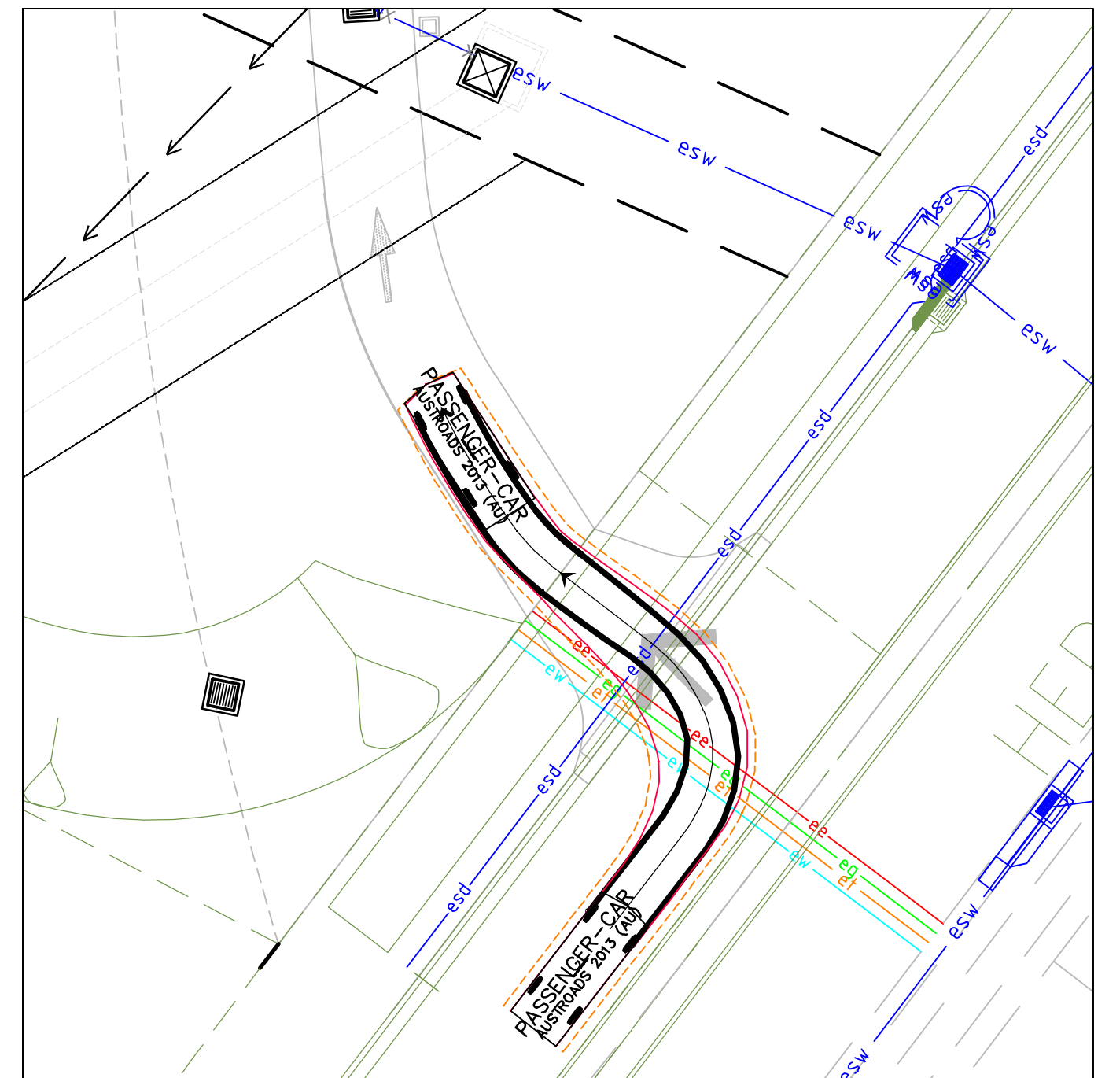

Inset E  
1:200

Preliminary - Not for Construction

© Mott MacDonald  
This document should not be relied on or used in circumstances other than those for which it was originally prepared and for which Mott MacDonald was commissioned. Mott MacDonald accepts no responsibility for this document to any other party other than the person by whom it was commissioned.

Rev	Date	Drawn	Description	Ch'k'd	App'd
P4	13.05.16	AMP	Issued for Approval - Minor Amendments	SR	CJA
P3	11.05.16	AMP	Issued for Approval - Minor Amendments	SR	CJA
P2	06.05.16	AMP	Issued for Approval	SR	CJA
P1	22.04.16	AMP	Issued Client Review	SR	X

1:200 0 10m 20m



Level 10, 383 Kent Street  
Sydney, NSW 2000  
Australia  
PO Box Q1678  
QVB Sydney NSW 1230  
T +61 (0)2 9098 6800  
W www.mottmac.com.au

Client  
Gregory Hills  
Development Company  
Pty Ltd

Title  
Gregory Hills Corporate Park  
Camden Medical Campus  
Civil Works  
Simulated Vehicle Manoeuvres  
Sheet 1

Designed	C Keenan	06.05.16	Eng check	S Reilly	06.05.16
Drawn	A Paciben	06.05.16	Coordination	S Reilly	06.05.16
Dwg check	G Collins	06.05.16	Approved	C. Avis	06.05.16
Scale at A1	1:200	Status	PRE	Rev	P4
Drawing Number	MMD-368851-C-DR-CA-DA-0180	Sec	STD		



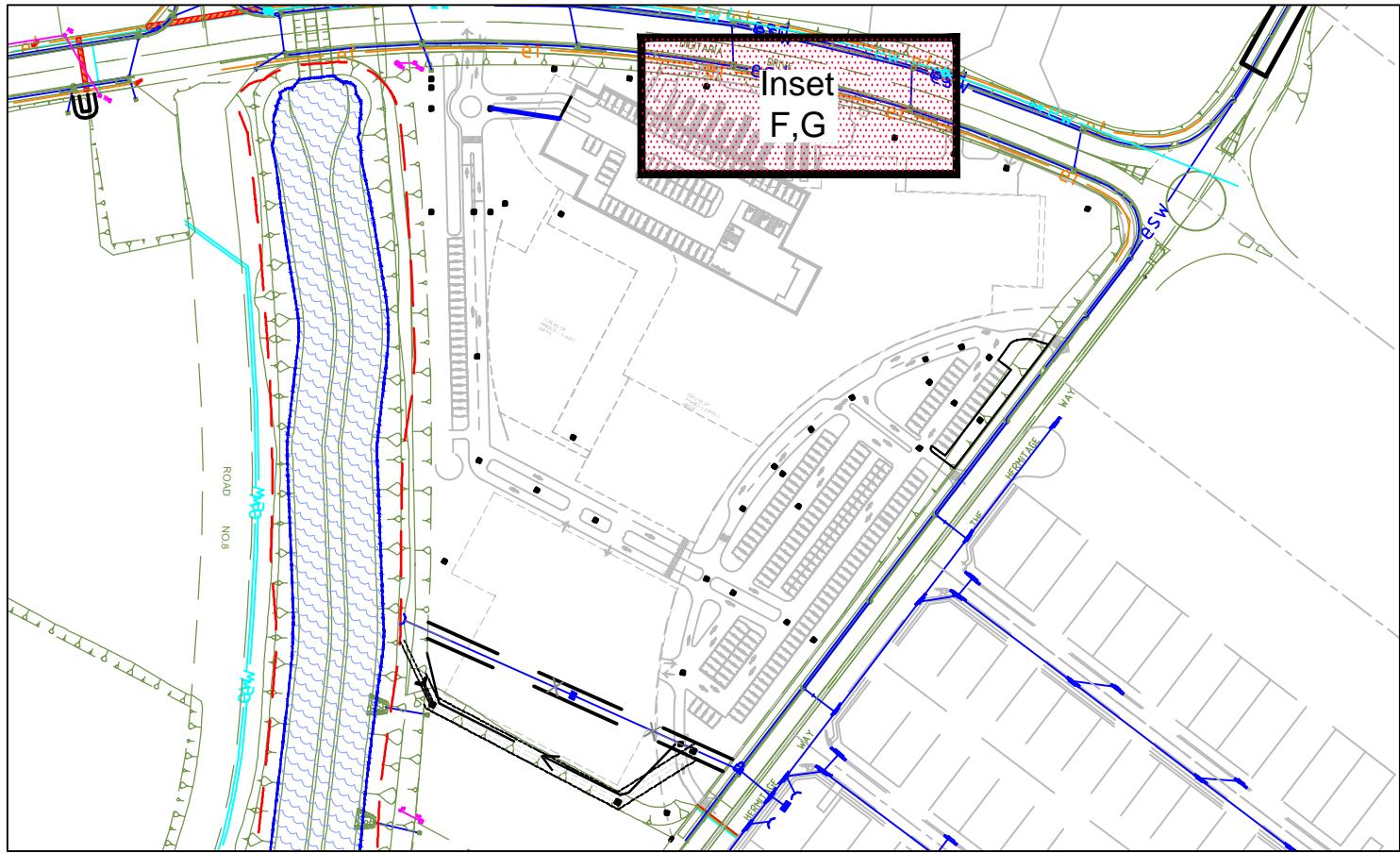

Key Plan  
NTS

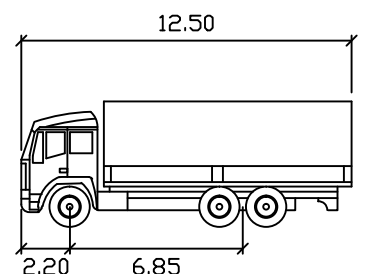

SU Truck meters  
Width : 2.50  
Track : 2.50  
Lock to Lock Time : 6.0  
Steering Angle : 36.6

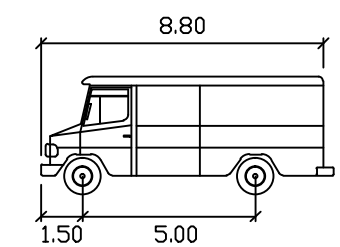

Service Vehicle meters  
Width : 2.50  
Track : 2.50  
Lock to Lock Time : 6.0  
Steering Angle : 38.7

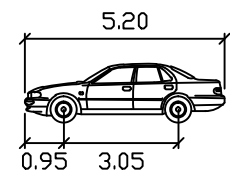

Passenger-car meters  
Width : 1.94  
Track : 1.84  
Lock to Lock Time : 6.0  
Steering Angle : 33.6

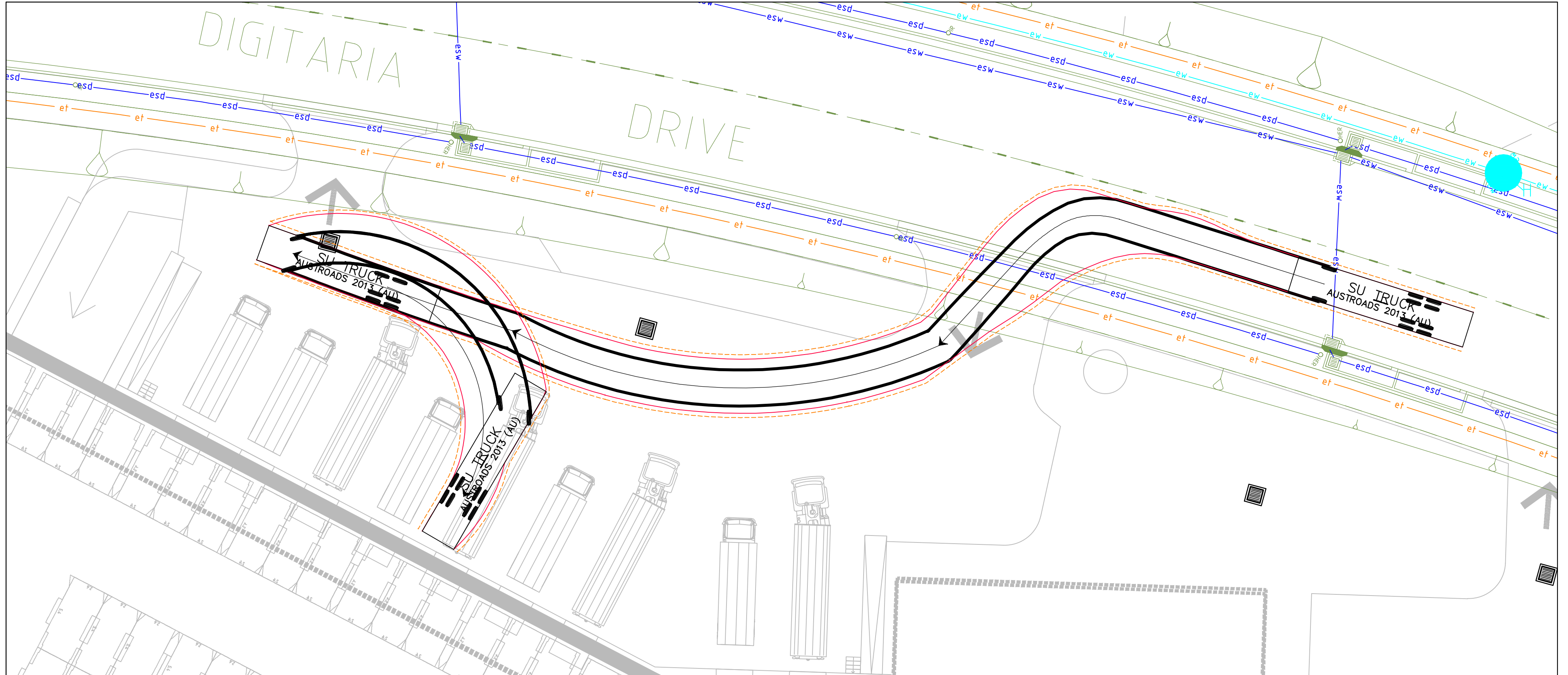
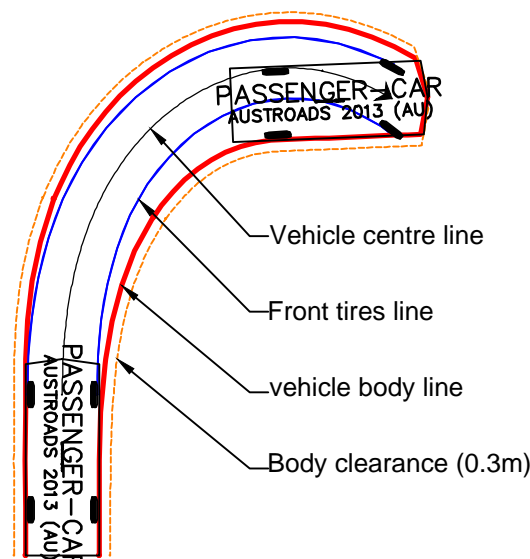

Inset F

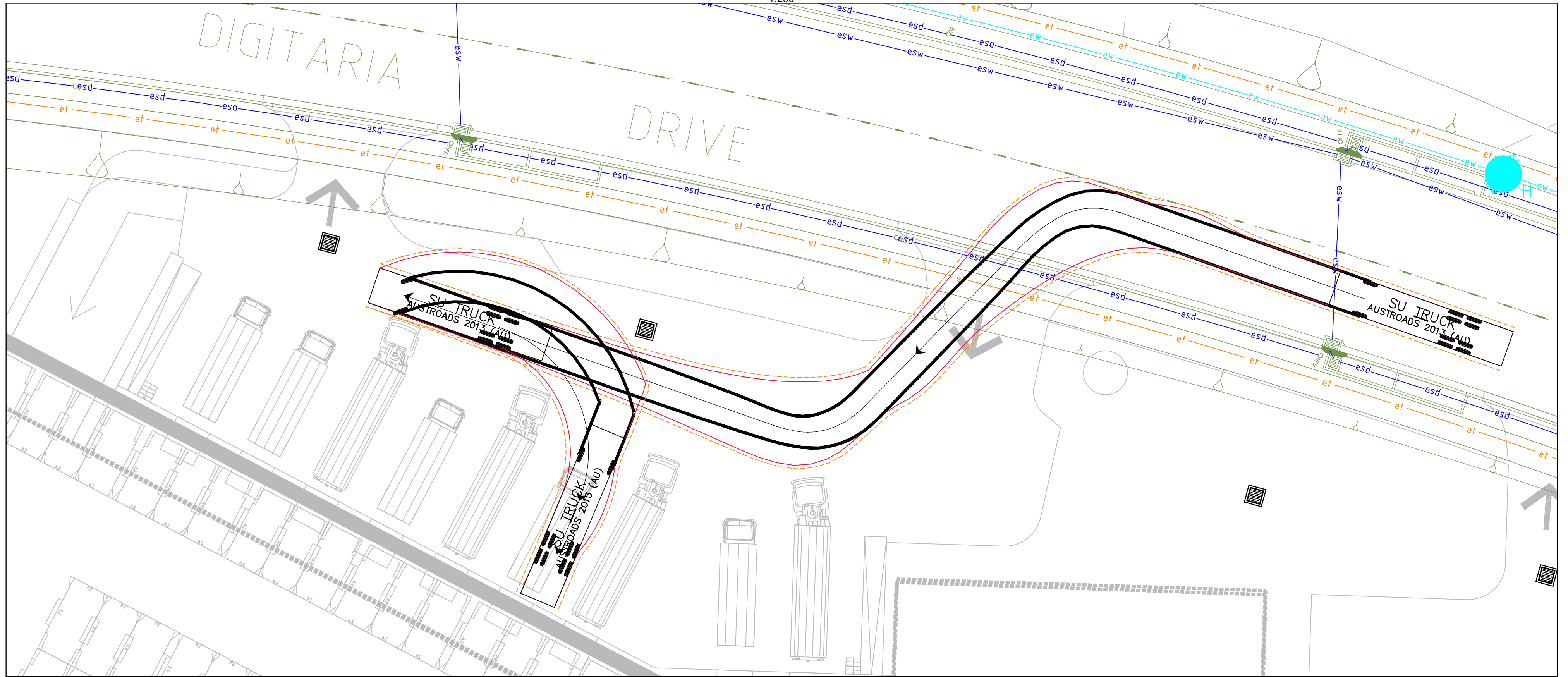

Inset G

Preliminary - Not for Construction

© Mott MacDonald  
This document should not be relied on or used in circumstances other than those for which it was originally prepared and for which Mott MacDonald was commissioned. Mott MacDonald accepts no responsibility for this document to any other party other than the person by whom it was commissioned.

Rev	Date	Drawn	Description	Ch'k'd	App'd
P4	13.05.16	AMP	Issued for Approval - Minor Amendments	SR	CJA
P3	11.05.16	AMP	Issued for Approval - Minor Amendments	SR	CJA
P2	06.05.16	AMP	Issued for Approval	SR	CJA
P1	22.04.16	AMP	Issued Client Review	SR	X

1:200 0 10m 20m



Level 10, 383 Kent Street  
Sydney, NSW 2000  
Australia  
PO Box Q1678  
QVB Sydney NSW 1230  
T +61 (0)2 9098 6800  
W www.mottmac.com.au

Client  
Gregory Hills  
Development Company  
Pty Ltd

Title  
Gregory Hills Corporate Park  
Camden Medical Campus  
Civil Works  
Simulated Vehicle Manoeuvres  
Sheet 2

Designed	C Keenan	06.05.16	Eng check	S Reilly	06.05.16
Drawn	A Paciben	06.05.16	Coordination	S Reilly	06.05.16
Dwg check	G Collins	06.05.16	Approved	C. Avis	06.05.16
Scale at A1	1:200	Status	PRE	P4	STD
Drawing Number	MMD-368851-C-DR-CA-DA-0181				



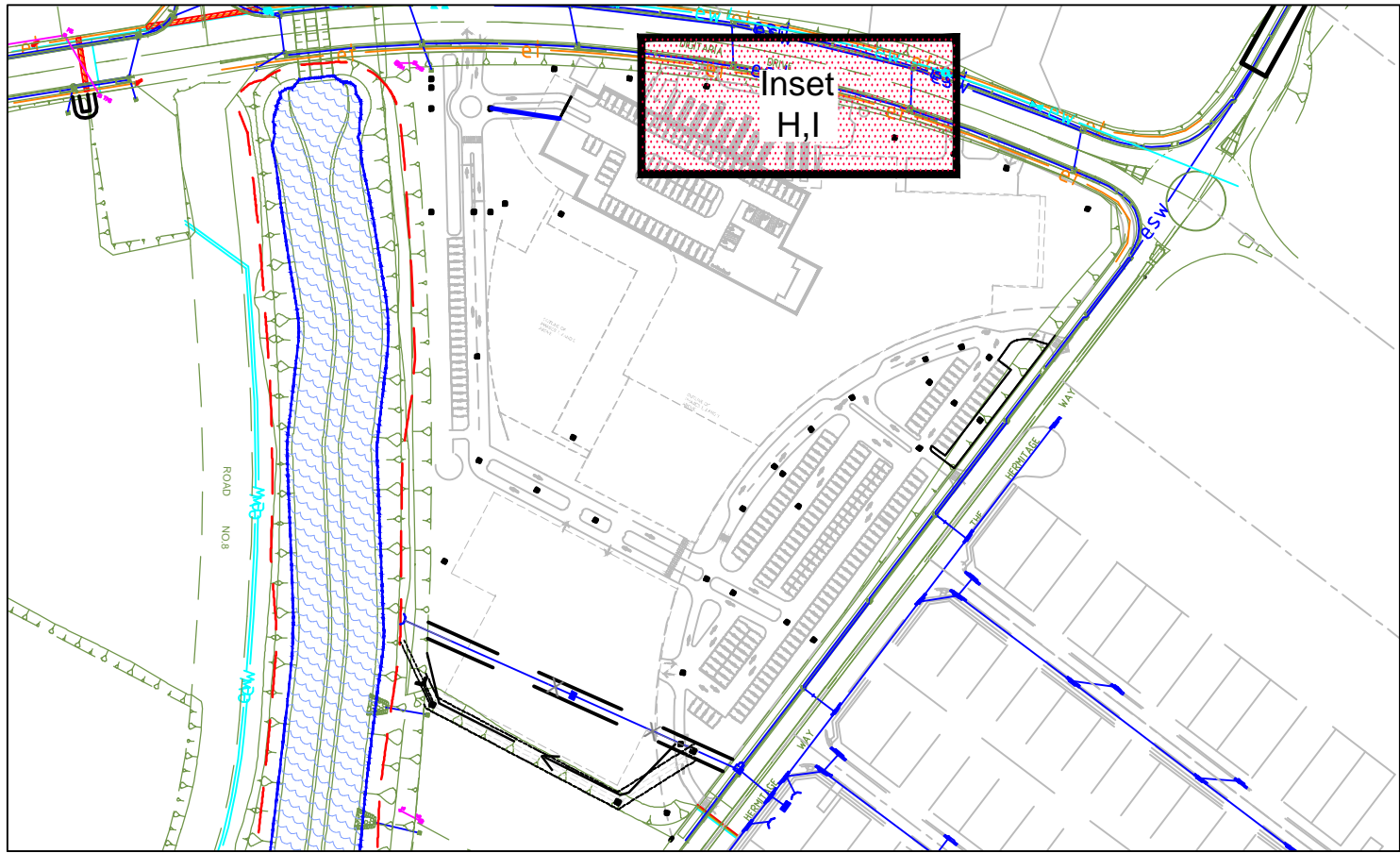

Key Plan  
NTS

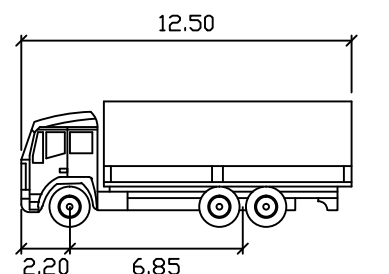

SU Truck meters  
Width : 2.50  
Track : 2.50  
Lock to Lock Time : 6.0  
Steering Angle : 36.6

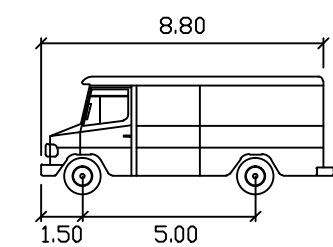

Service Vehicle meters  
Width : 2.50  
Track : 2.50  
Lock to Lock Time : 6.0  
Steering Angle : 38.7

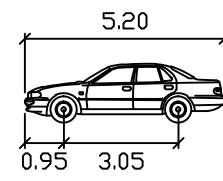

Passenger-car meters  
Width : 1.94  
Track : 1.84  
Lock to Lock Time : 6.0  
Steering Angle : 33.6

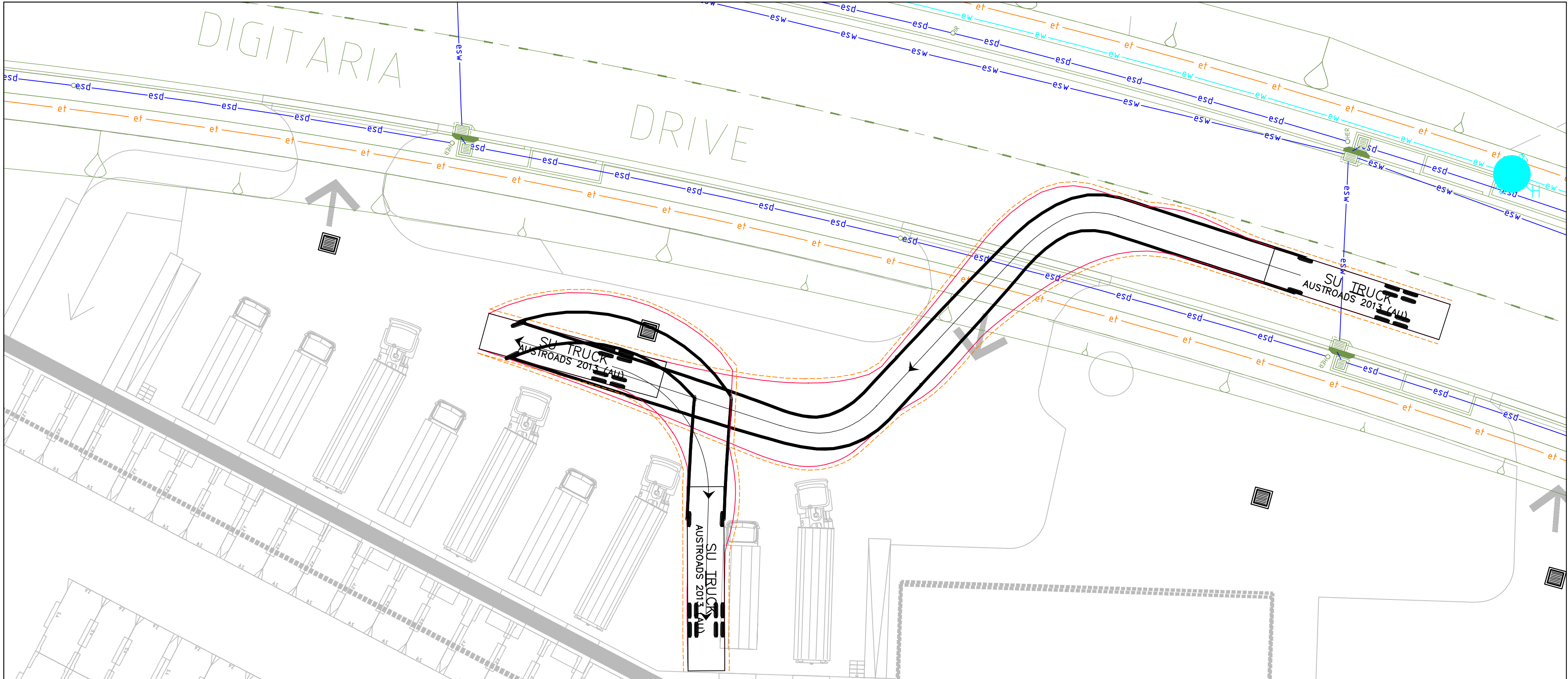
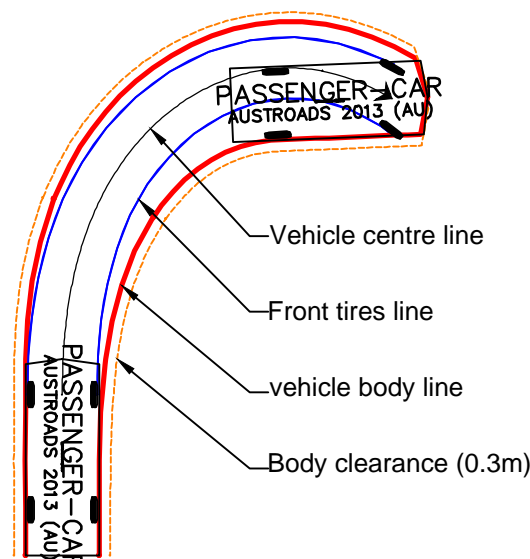

Inset H

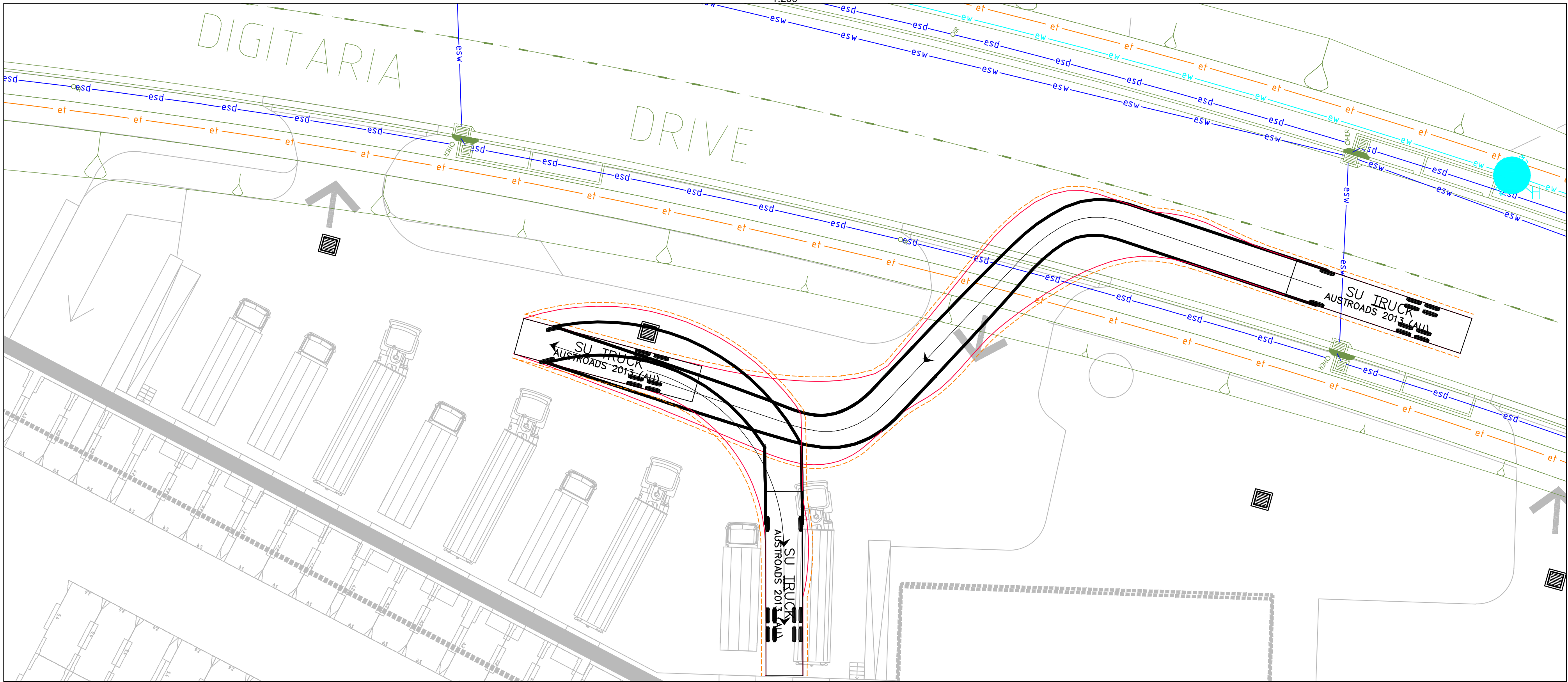

Inset I

Preliminary - Not for Construction

© Mott MacDonald  
This document should not be relied on or used in circumstances other than those for which it was originally prepared and for which Mott MacDonald was commissioned. Mott MacDonald accepts no responsibility for this document to any other party other than the person by whom it was commissioned.

Rev	Date	Drawn	Description	Ch'k'd	App'd
P4	13.05.16	AMP	Issued for Approval - Minor Amendments	SR	CJA
P3	11.05.16	AMP	Issued for Approval - Minor Amendments	SR	CJA
P2	06.05.16	AMP	Issued for Approval	SR	CJA
P1	22.04.16	AMP	Issued Client Review	SR	X

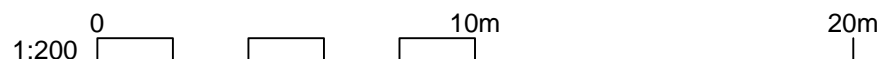

Level 10, 383 Kent Street  
Sydney, NSW 2000  
Australia  
PO Box Q1678  
QVB Sydney NSW 1230  
T +61 (0)2 9098 6800  
W www.mottmac.com.au

Client  
Gregory Hills  
Development Company  
Pty Ltd

Title  
Gregory Hills Corporate Park  
Camden Medical Campus  
Civil Works  
Simulated Vehicle Manoeuvres  
Sheet 3

Designed	C Keenan	06.05.16	Eng check	S Reilly	06.05.16
Drawn	A Paciben	06.05.16	Coordination	S Reilly	06.05.16
Dwg check	G Collins	06.05.16	Approved	C. Avis	06.05.16
Scale at A1	1:200	Status	PRE	P4	STD
Drawing Number	MMD-368851-C-DR-CA-DA-0182				



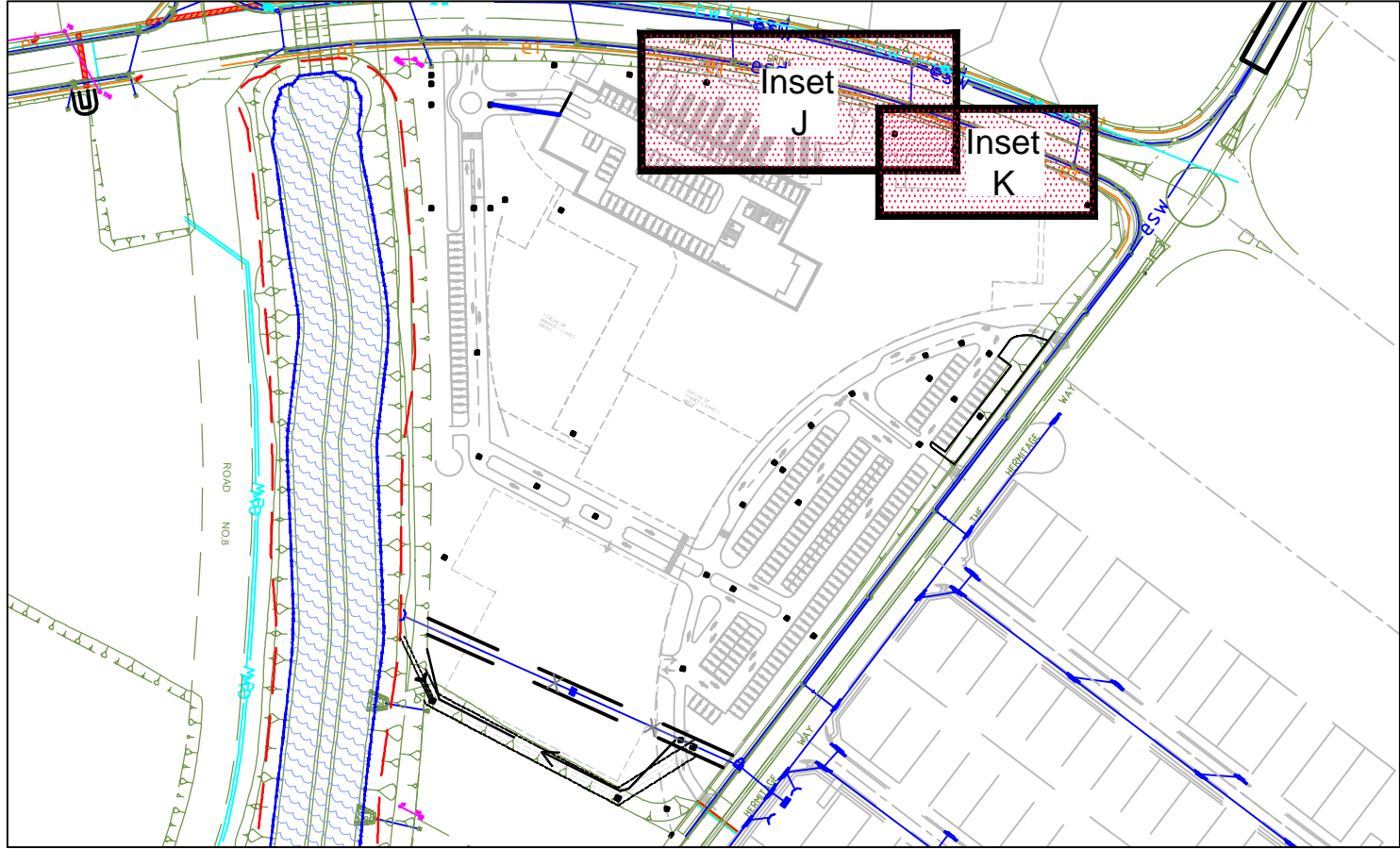

Key Plan  
NTS

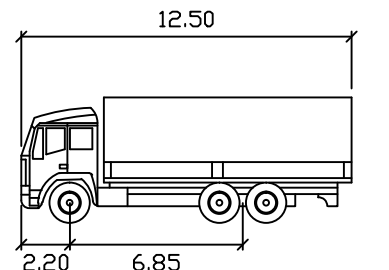

SU Truck meters  
Width : 2.50  
Track : 2.50  
Lock to Lock Time : 6.0  
Steering Angle : 36.6

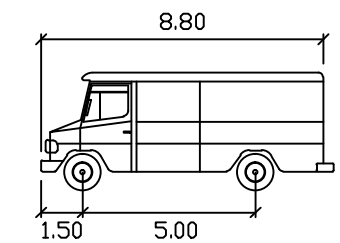

Service Vehicle meters  
Width : 2.50  
Track : 2.50  
Lock to Lock Time : 6.0  
Steering Angle : 38.7

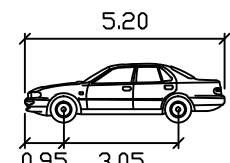

Passenger-car meters  
Width : 1.94  
Track : 1.84  
Lock to Lock Time : 6.0  
Steering Angle : 33.6

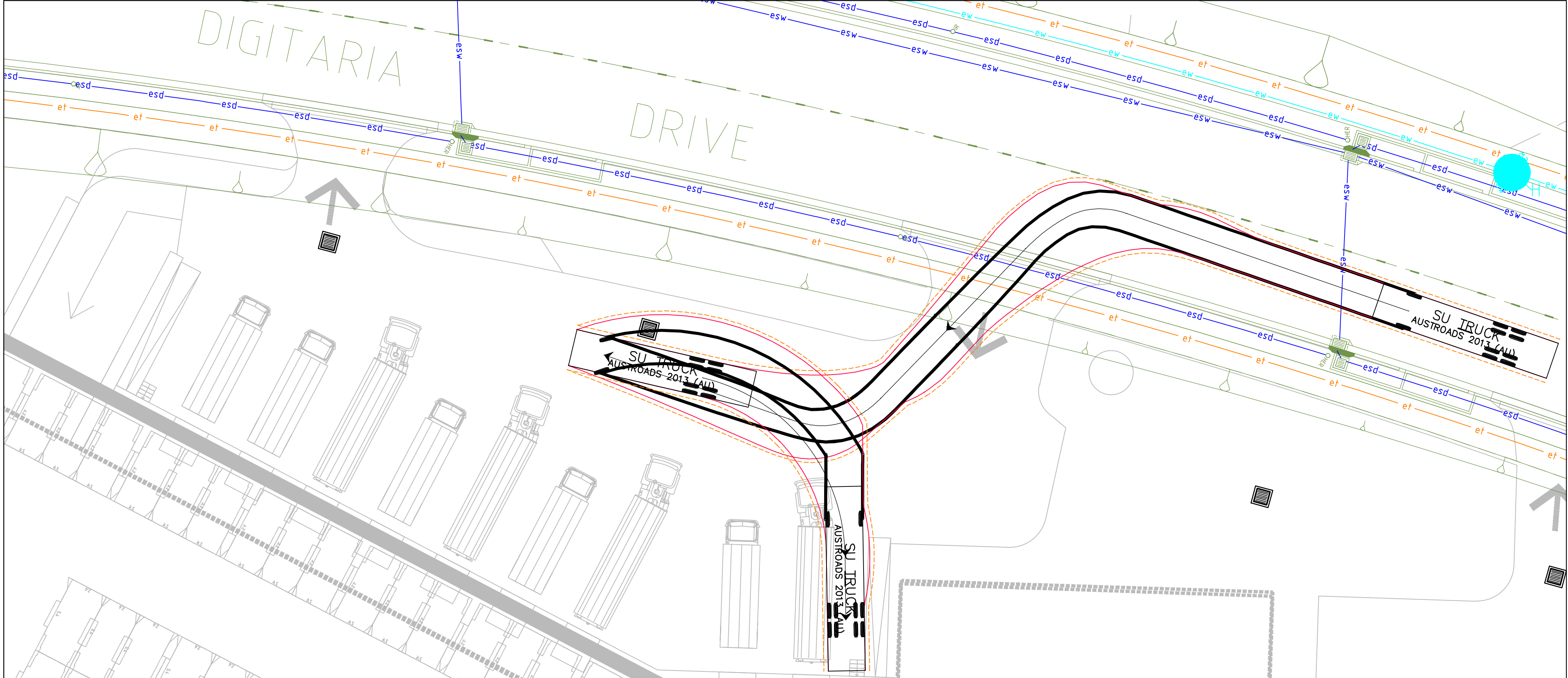
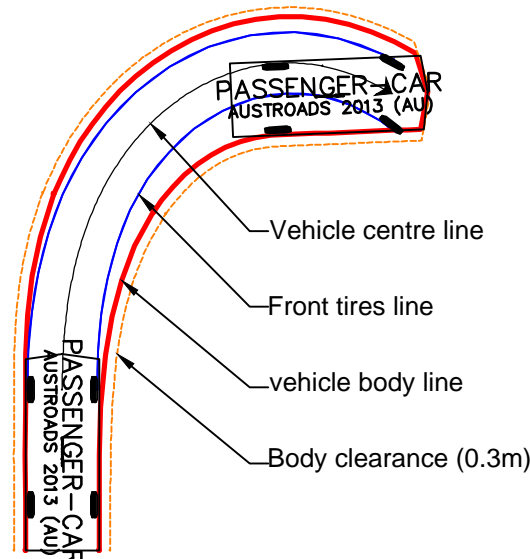

Inset J  
1:200

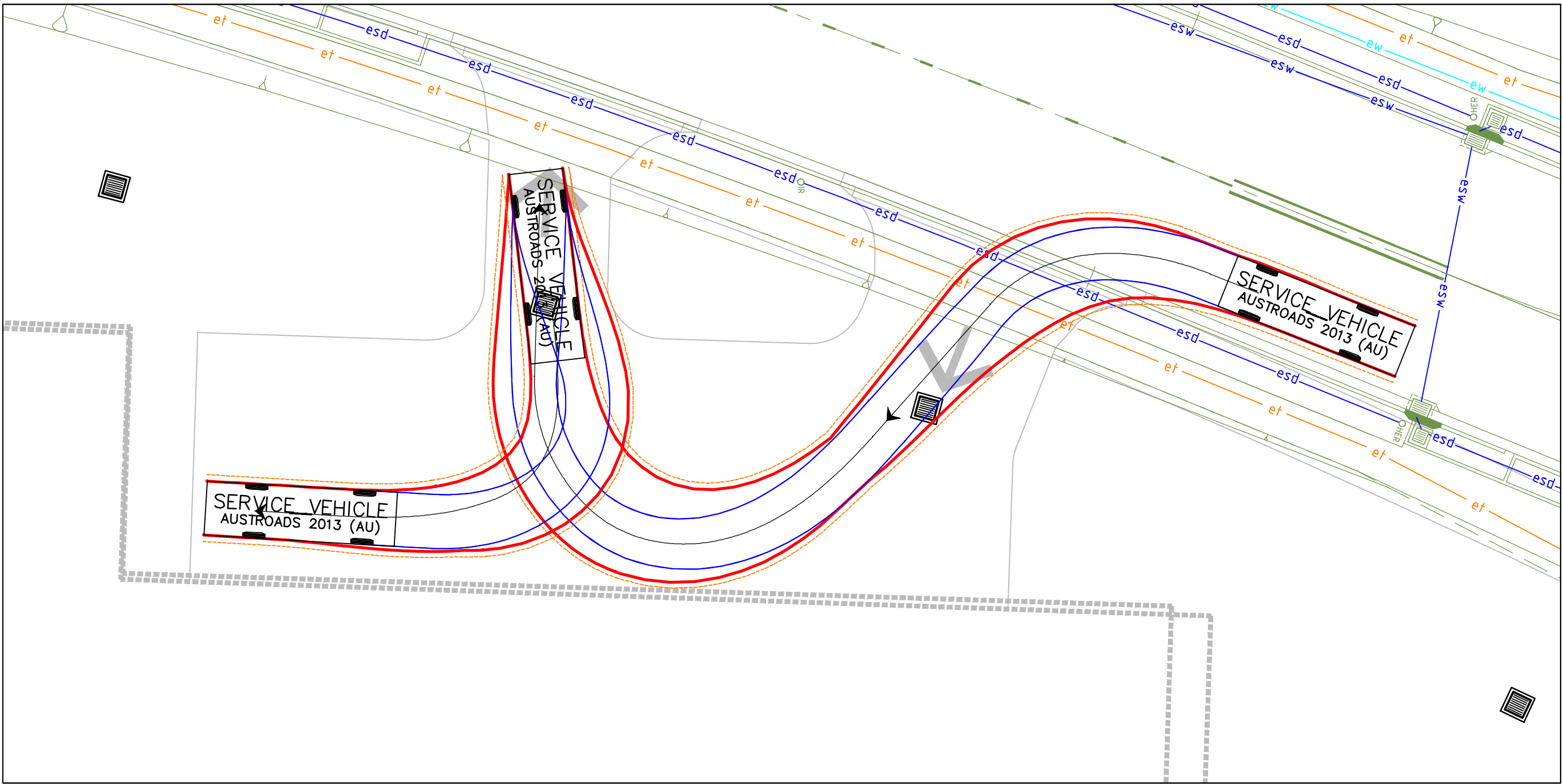

Inset K  
1:200

© Mott MacDonald  
This document should not be relied on or used in circumstances other than those for which it was originally prepared and for which Mott MacDonald was commissioned. Mott MacDonald accepts no responsibility for this document to any other party other than the person by whom it was commissioned.

Rev	Date	Drawn	Description	Ch'k'd	App'd
P4	13.05.16	AMP	Issued for Approval - Minor Amendments	SR	CJA
P3	11.05.16	AMP	Issued for Approval - Minor Amendments	SR	CJA
P2	06.05.16	AMP	Issued for Approval	SR	CJA
P1	22.04.16	AMP	Issued Client Review	SR	X

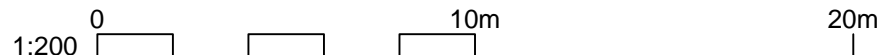

Level 10, 383 Kent Street  
Sydney, NSW 2000  
Australia  
PO Box Q1678  
QVB Sydney NSW 1230  
T +61 (0)2 9098 6800  
W www.mottmac.com.au

Client  
Gregory Hills  
Development Company  
Pty Ltd

Title  
Gregory Hills Corporate Park  
Camden Medical Campus  
Civil Works  
Simulated Vehicle Manoeuvres  
Sheet 4

Dsgn'd	C Keenan	06.05.16	Eng check	S Reilly	06.05.16
Drawn	A Paciben	06.05.16	Coordination	S Reilly	06.05.16
Dwg check	G Collins	06.05.16	Approved	C. Avis	06.05.16
Scale at A1	1:200	Status	PRE	P4	STD
Rev					
Sec					
Drawing Number	MMD-368851-C-DR-CA-DA-0183				

Preliminary - Not for Construction



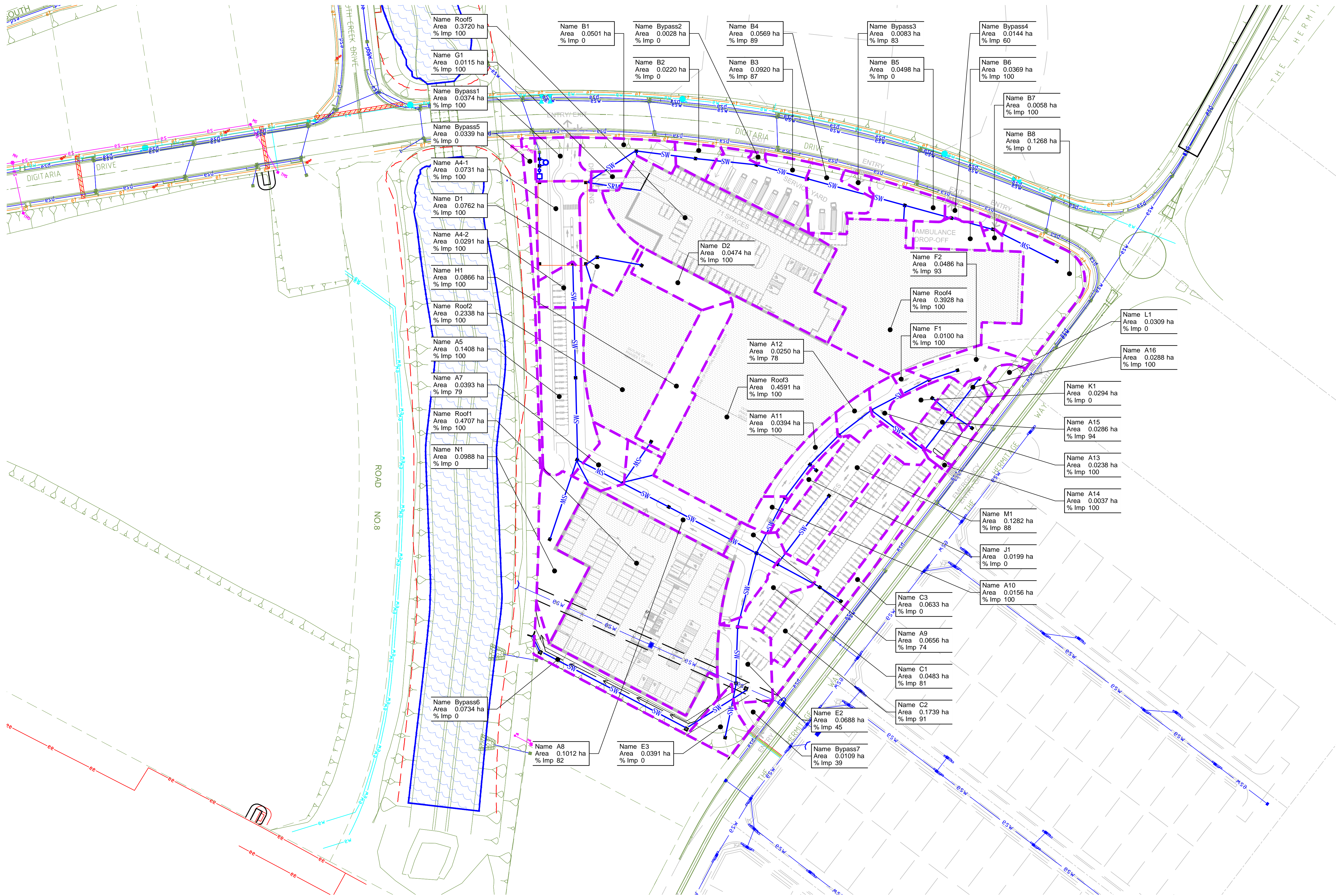

© Mott MacDonald  
This document should not be relied on or used in circumstances other than those for which it was originally prepared and for which Mott MacDonald was commissioned. Mott MacDonald accepts no responsibility for this document to any other party other than the person by whom it was commissioned.

Preliminary - Not for Construction

Rev	Date	Drawn	Description	Ch'k'd	App'd
P4	13.05.16	AMP	Issued for Approval - Minor Amendments	SR	CJA
P3	11.05.16	AMP	Issued for Approval - Minor Amendments	SR	CJA
P2	06.05.16	AMP	Issued for Approval	SR	CJA
P1	22.04.16	AMP	Issued Client Review	SR	X

This plan may be prepared using COLOUR and may be incomplete if copied to black and white.

1:800 0 40m 80m



Level 10, 383 Kent Street  
Sydney, NSW 2000  
Australia  
PO Box Q1678  
QVB Sydney NSW 1230  
T +61 (0)2 9098 6800  
W www.mottmac.com.au

Client  
Gregory Hills  
Development Company  
Pty Ltd

Title  
Gregory Hills Corporate Park  
Camden Medical Campus  
Civil Works  
DRAINS Catchment Plan

Designed	C Keenan	06.05.16	Eng check	S Reilly	06.05.16
Drawn	A Paciben	06.05.16	Coordination	S Reilly	06.05.16
Dwg check	G Collins	06.05.16	Approved	C. Avis	06.05.16
Scale at A1	1:800	Status	PRE	P4	STD
Rev					
Sec					
Drawing Number MMD-368851-C-DR-CA-DA-0210					



Legend

'MUSIC' Catchment Boundary

Roof to Treatment = 1.928ha

Sealed Road and Footpath to Treatment = 1.354ha

Landscape to Treatment = 0.681ha

Landscape Bypass = 0.121ha

Sealed Road and Footpath Bypass = 0.06ha

© Mott MacDonald  
This document should not be relied on or used in circumstances other than those for which it was originally prepared and for which Mott MacDonald was commissioned. Mott MacDonald accepts no responsibility for this document to any other party other than the person by whom it was commissioned.

Preliminary - Not for Construction

Rev	Date	Drawn	Description	Ch'k'd	App'd
P4	13.05.16	AMP	Issued for Approval - Minor Amendments	SR	CJA
P3	11.05.16	AMP	Issued for Approval - Minor Amendments	SR	CJA
P2	06.05.16	AMP	Issued for Approval	SR	CJA
P1	22.04.16	AMP	Issued Client Review	SR	X

Level 10, 383 Kent Street  
Sydney, NSW 2000  
Australia  
PO Box Q1678  
QVB Sydney NSW 1230  
T +61 (0)2 9098 6800  
W www.mottmac.com.au

Client  
Gregory Hills  
Development Company  
Pty Ltd

Title  
Gregory Hills Corporate Park  
Camden Medical Campus  
Civil Works  
MUSIC Catchment Plan

Drafted	C Keenan	06.05.16	Eng check	S Reilly	06.05.16
Drawn	A Paciben	06.05.16	Coordination	S Reilly	06.05.16
Dwg check	G Collins	06.05.16	Approved	C. Avis	06.05.16
Scale at A1	Status	PRE	Rev	P4	Sec
1:800					STD
Drawing Number MMD-368851-C-DR-CA-DA-0220					

This plan may be prepared using COLOUR and may be incomplete if copied to black and white.

P:\Sydney\Projects\36xxxx\368851\04 Working\01 CAD\Civil\Drawings\MMD-369626-C-DR-CA-DA-0220.dwg May 13, 2016 - 4:59PM pac55913