

4.0 Broadway Activation

Further details regarding the program for the General Teaching Spaces and the Learning Commons and how they would provide activation of the façade must also be provided, particularly whether any entry to the CLT space/s is proposed on the façade side. Without a designated circulation path around this side of the CLT, it is unlikely that this space used given the width of this space and therefore is unlikely to achieve the aim of activating the façade.

Locating the Collaborative Learning Theatre (GTS) more centrally and away from the façade on Broadway and Jones Street provides a place on these floors, adjacent to the façades, for Learning Commons previously not provided for in the DA. This generates the opportunity for greater student use and activation which would be clearly visible from Broadway and Jones Street. This opens up the Jones Street and Broadway corner to allow students to make the most of the this space as a view corner.

The intended and designed uses for these spaces encourage non-conventional, open collaborative and active teaching and learning in a large open and flexible space which would also be visible from Broadway.

APPENDIX A
PART 3 OF 3

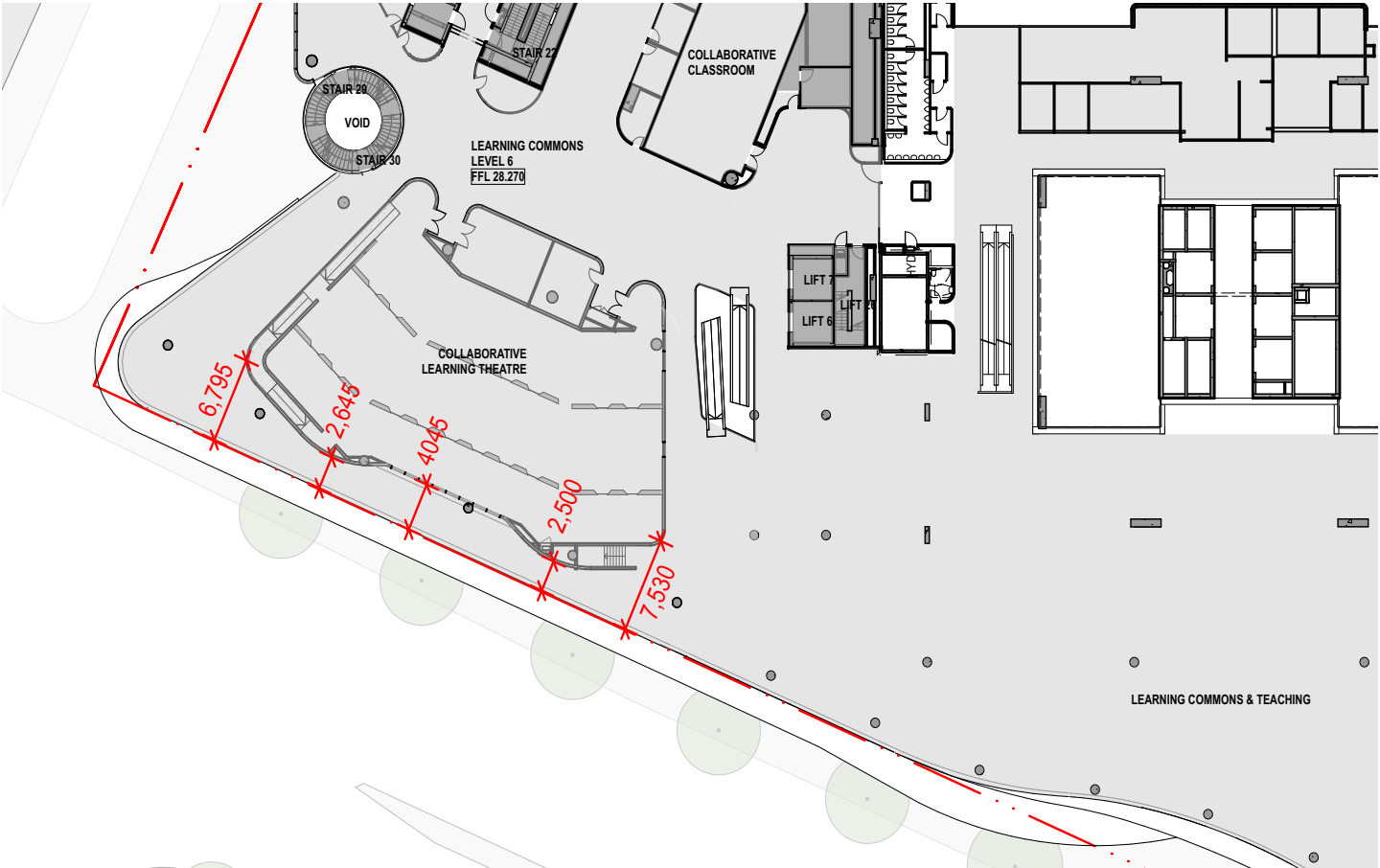

Level 6 - GTS demonstrating distance from facade

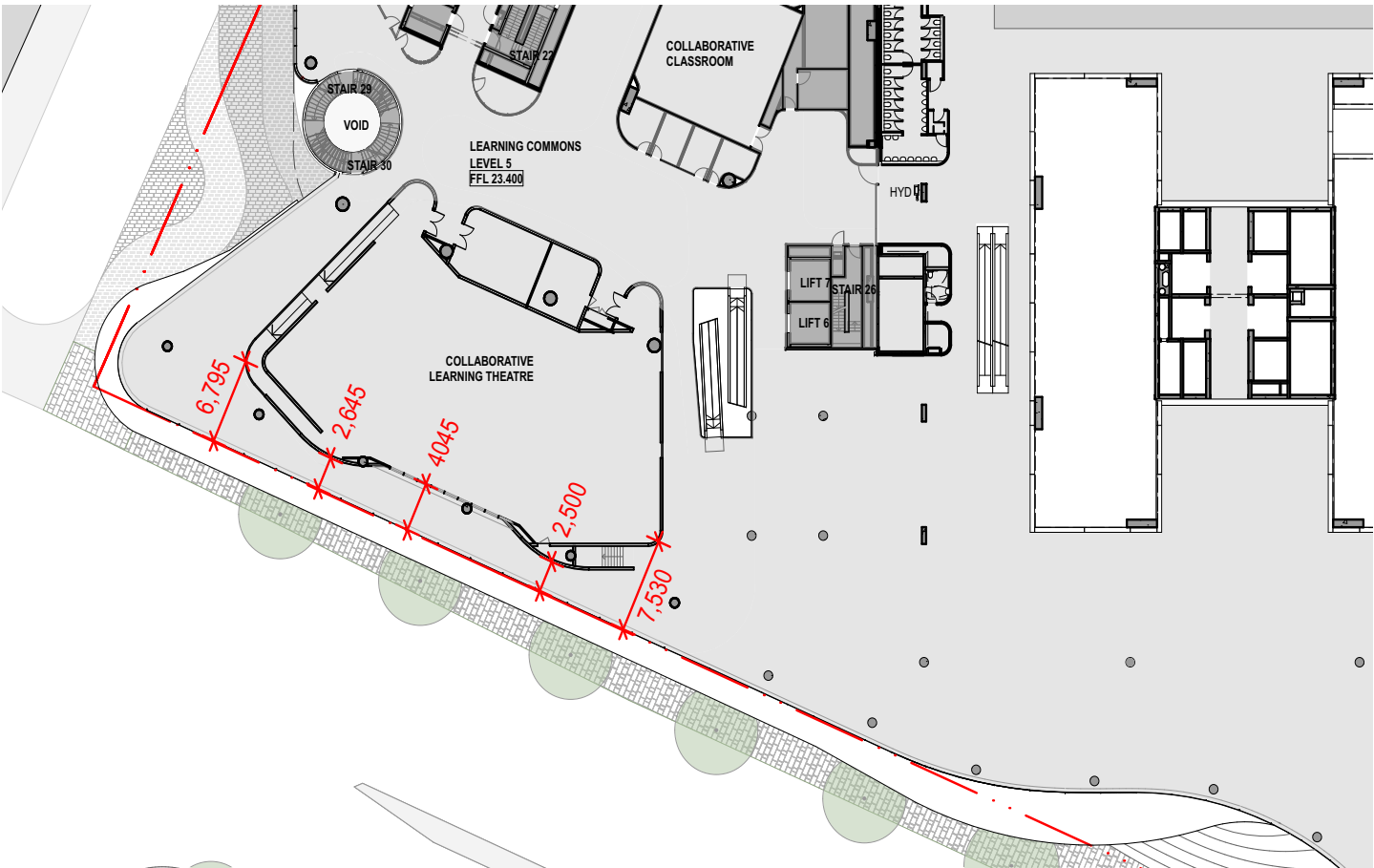

Level 5 - GTS demonstrating distance from facade



Level 7 - GTS demonstrating distance from facade

Provision has been made for greater access to the GTS on the north side and on the south side (Broadway façade side) to more evenly distribute access to and from the GTS and therefore further activating the façade along Broadway and Jones Street.

These spaces address the Broadway façade allowing informal learning and activated areas to occupy the space adjacent to the Broadway façade which would be very visible from Broadway.

The Collaborative Teaching Spaces will be glazed along the back wall allowing further visual connectivity to Broadway and providing natural daylight into these spaces.

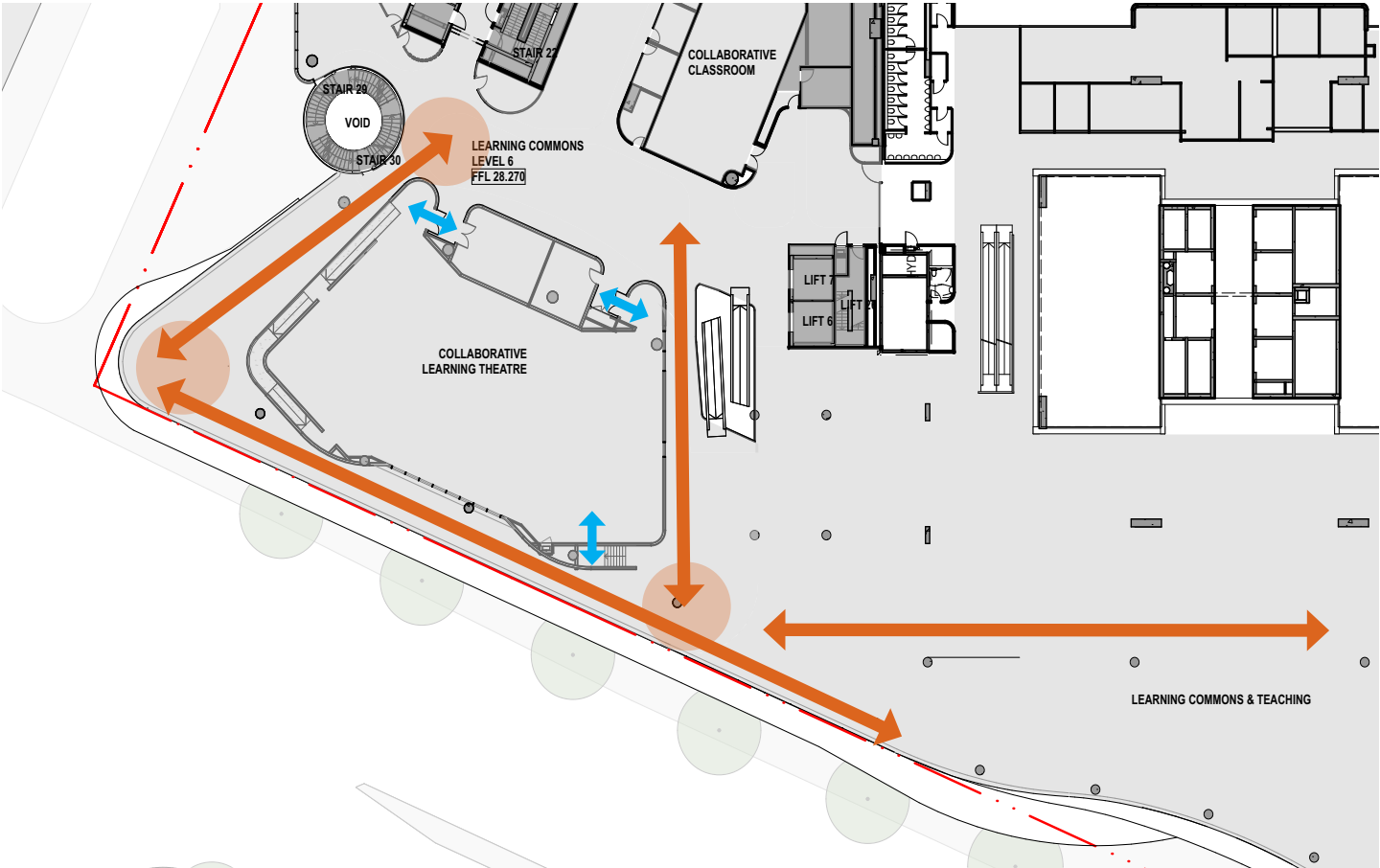

Level 6 - Circulation & Connections

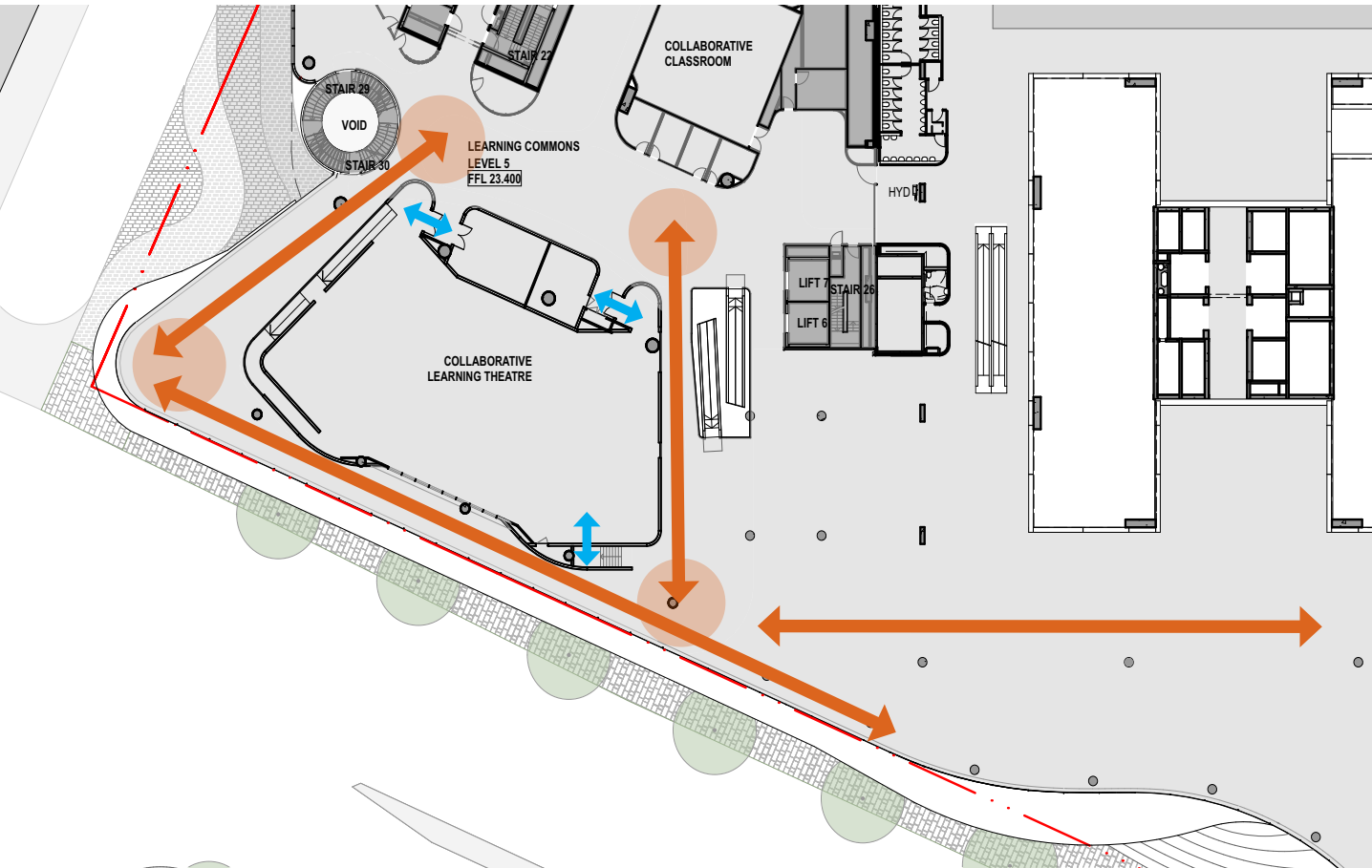

Level 5 - Circulation & Connections

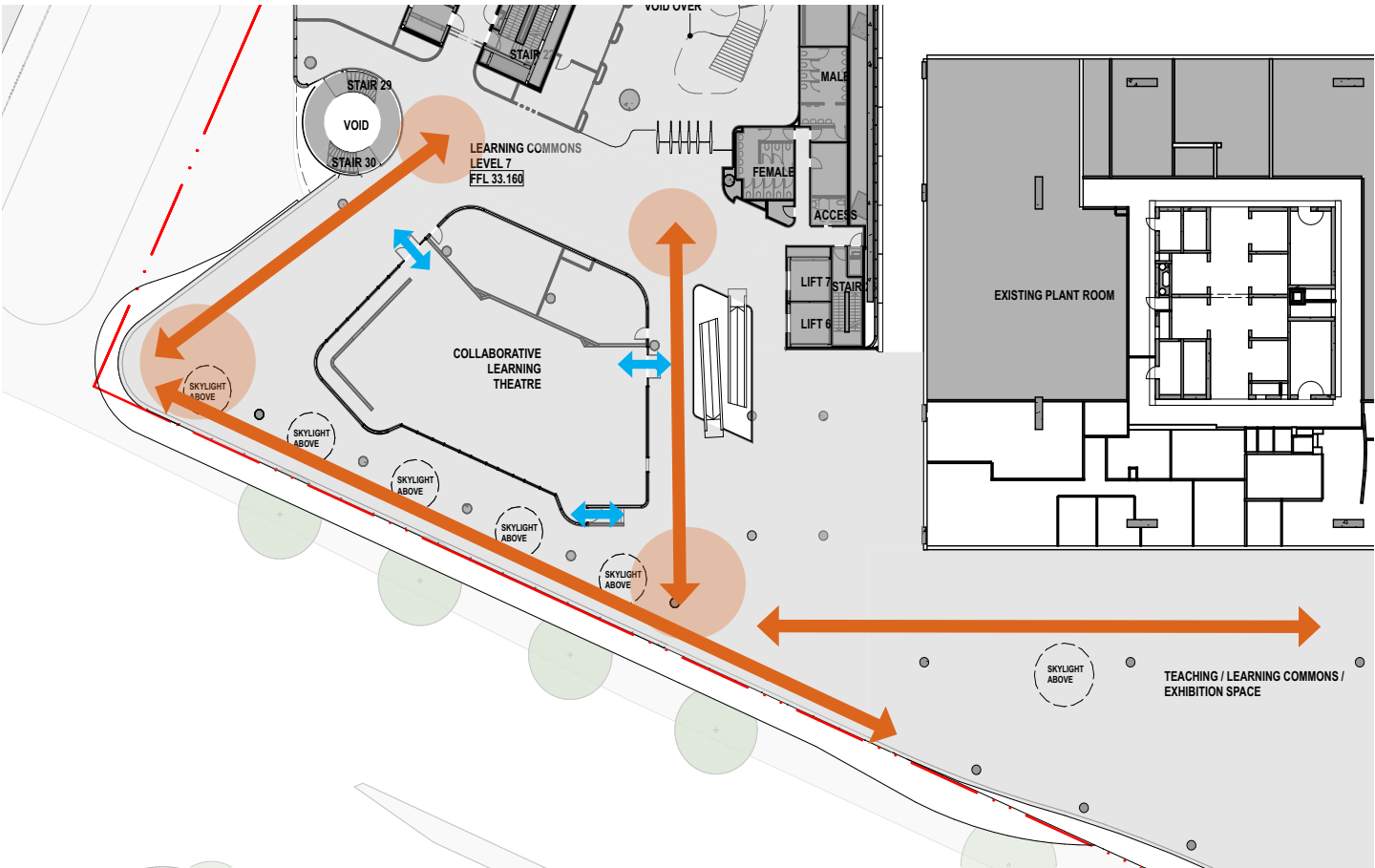

Level 7 - Circulation & Connections

The activation of the Broadway facade will come from the creation of informal learning commons around the GTS on levels 5, 6 and 7. Analysis of how students use these spaces has shown that “destination spaces” such as this are greatly desired by students, who actively seek them out.

As the placement of the GTS is moved off the facade, it creates a variety of different sized spaces which allow a range of group types to occupy the spaces as well as being able to accomodate individuals who want to study in a group setting. These changes in the scale of spaces appeal to students as it gives them a range of options to use the space.

The area at the corner of Jones Street and Broadway will be a key meeting space for group study, especially due to its location next to the GTS and prominent position within the building. The numbers of students using the GTS spaces will lead to a large voulme of students who circulate around this area and along the facade. These students will also use the surrounding Learning Commons before and after their classes.



Level 5 - Activation



Level 6 - Activation

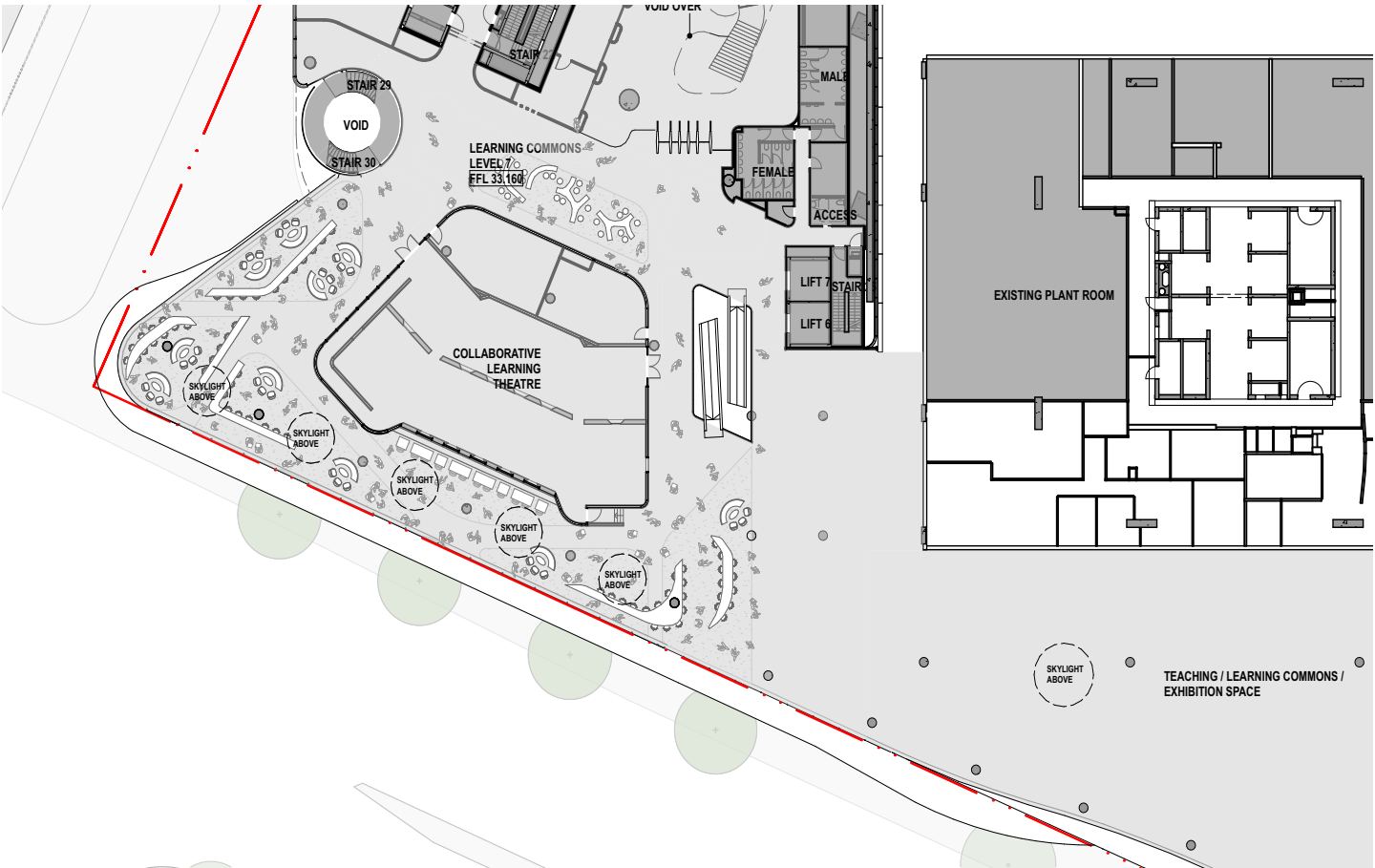

Level 7 - Activation

