

- LEGEND:
- SITE:
- ELECTRICAL SUBSTATION
 - FIRE BOOSTER
 - HANDBALL COURT LINE MARKINGS REFER TO LANDSCAPE ARCHITECT'S DRAWINGS
 - EXISTING TABLE TENNIS TABLES
 - LARGE ELECTRICAL PIT HATCH
 - SMALL ELECTRICAL PIT HATCH
 - TREE GRATE
 - DRAINAGE PIT GRATE
 - CIRCULAR DRAINAGE PIT GRATE
- REFER TO:
- REFER TO ARCHITECTURAL SPECIFICATION FOR ALL SPECIFICATION CODES
 - REFER TO FIXTURES, FITTINGS & EQUIPMENT SCHEDULE AR-XX-A21-001 FOR SITE FIXTURES AND FITTINGS
 - REFER TO CIVIL ENGINEERS DETAILS AND SPECIFICATION
 - REFER TO STRUCTURAL ENGINEER'S DETAILS AND SPECIFICATION
 - REFER TO LANDSCAPE ARCHITECT'S DRAWINGS, DETAILS AND SPECIFICATION
 - REFER TO SERVICES DETAILS AR-SI-A06-002 TO 004
 - REFER TO SITE, BUILDING AND HERITAGE SURVEYS
 - REFER TO HERITAGE IMPACT STATEMENT BY GML HE-XX-RPT-1011
 - REFER TO ARCHAEOLOGICAL RESEARCH DESIGN REPORT BY GML HE-XX-RPT-001
 - REFER TO SCHEDULE OF CONSERVATION WORKS BY GML HE-XX-RPT-002
 - REFER TO REMEDIATION ACTION PLAN (RAP) BY DOUGLAS PARTNERS GT-XX-RPT-004
- NOTES:
- ALL DRAWINGS TO BE READ IN CONJUNCTION WITH APHS, PPS, GYM AND HERITAGE DRAWING PACKAGES
 - HATCHED BUILDING AREAS ARE COVERED IN O ARCHITECTURAL DRAWING PACKAGES. REFER TO APHS, PPS, GYM AND HERITAGE DRAWING PACKAGES
 - FURNITURE YET TO BE SCOPED, SETOUT AND DETAILED
 - ANY FURNITURE SHOWN IN ARCHITECTURAL PLANS INCLUDING SEATING, TABLES AND BENCHES IS INDICATIVE ONLY, UNLESS OTHERWISE SET OUT, DETAILED AND SCHEDULED
 - ANY FURNITURE SHOWN IN LANDSCAPE ARCHITECT'S PLANS INCLUDING SEATING, TABLES AND BENCHES IS INDICATIVE ONLY, UNLESS OTHERWISE SET OUT, DETAILED AND SCHEDULED
 - FURNITURE IS TO BE SELECTED BY THE DEPARTMENT OF EDUCATION AT A LATER DATE
 - SUPER-GRAPHICS AND SIGNAGE YET TO BE SCOPED, SETOUT AND DETAILED
 - SUPER-GRAPHICS AND SIGNAGE TO BE SELECTED AND DESIGNED AT A LATER DATE
 - ALL PLANTING, TREES AND SOFT WORKS TO LANDSCAPE ARCHITECT'S DRAWINGS AND SCHEDULE
 - PLAY EQUIPMENT AND SPORTS COURTS TO LANDSCAPE ARCHITECT'S DETAILS AND SPECIFICATION
 - SPORTS COURT LINE MARKINGS TO LANDSCAPE ARCHITECT'S DESIGN AND SETOUT

Hoists indicated in yellow boxes

GRIMSHAW

GRIMSHAW Architects
Telephone +61 (02) 9253 0200
Address Level 2,
333 George Street,
Sydney NSW 2000
Australia
www.grimshaw-architects.com



BVN Architecture
Telephone +61 (02) 8297 7200
Address Level 11,
265 Pitt Street,
Sydney NSW 2000
Australia
www.bvn.com.au

INTELLECTUAL PROPERTY			
© Copyright Grimshaw and BVN. All rights reserved. No part of this document may be reproduced, stored in a retrieval system, or transmitted, in any form or by any means, electronic, mechanical, photocopying, recording, or by any information storage or retrieval system, without prior written permission from Grimshaw and BVN.			
ISSUE	DATE	FOR	
6	18.08.16	For Information	
7	23.08.16	For Information	
8	26.08.16	DD COST ISSUE	
9	04.11.16	DD Planning	
10	24.11.16	For Information	
11	14.02.17	80% Coordination Issue	
12	24.02.17	FOR TENDER	
13	24.03.17	FOR TENDER ADDENDUM	
A	02.06.17	ISSUED FOR CONSTRUCTION	
B	26.04.18	ISSUED FOR CONSTRUCTION (CC)	
C	01.06.18	ISSUED FOR CONSTRUCTION (CC)	
D	02.06.18	ISSUED FOR INFORMATION (CC)	
E	07.06.18	ISSUED FOR INFORMATION (CC)	

NOTES FOR CURRENT REVISION:

CLIENT
Department of Education

DRAWING KEY

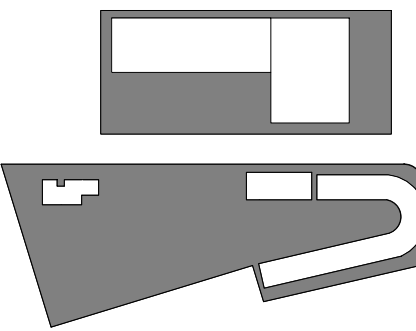

PROJECT
Arthur Phillip High School and
Paramatta Public School
ADDRESS
171 - 177 Macquarie
Street
(PPS)
(APHS)
102 - 116 Macquarie
Street
Paramatta, NSW 2150
Australia

GRIMSHAW PROJECT NO.
15091

NORTH

SCALE @ A0
As indicated

STATUS
FOR CONSTRUCTION

DRAWING
PROPOSED SITE PLAN

DRAWING NUMBER
AR-SI-A01-200

DRAWN
AK

CHECKED
WH

REVISION
E

AUTHORISED
AC