

ALL DRAWINGS TO BE READ IN CONJUNCTION WITH EFSG DEPARTURE SCHEDULE, FUNCTIONAL DESIGN BRIEF AND EDUCATIONAL FOUNDATIONS REPORTS

**GRIMSHAW**

GRIMSHAW Architects  
Telephone +61 (0)2 9253 0200  
Address Level 3, 24 Hickson Rd  
Walsh Bay  
Sydney NSW 2000  
Australia

www.grimshaw-architects.com

**BVN**

BVN Architecture  
Telephone +61 (0)2 8297 7200  
Address Level 11  
255 Pitt Street  
Sydney NSW 2000  
Australia

www.bvn.com.au

INTELLECTUAL PROPERTY

© COPYRIGHT GRIMSHAW ARCHITECTS.  
UNLESS OTHERWISE AGREED IN WRITING, ALL RIGHTS TO  
USE THIS DOCUMENT ARE SUBJECT TO PAYMENT IN FULL  
OF ALL GRIMSHAW CHARGES. THIS DOCUMENT MAY ONLY  
BE USED FOR THE EXPRESS PURPOSE AND PROJECT FOR  
WHICH IT HAS BEEN CREATED AND DELIVERED. AS  
NOTIFIED IN WRITING BY GRIMSHAW, AND THIS  
DOCUMENT MAY NOT BE OTHERWISE USED, OR COPIED,  
ANY UNAUTHORISED USE OF THIS DOCUMENT IS AT THE  
USER'S SOLE RISK AND WITHOUT LIMITING GRIMSHAW'S  
RIGHTS THE USER RELEASES AND INDEMNIFIES GRIMSHAW  
FROM AND AGAINST ALL LOSS SO ARISING

REV.	DATE	FOR
0	04.03.16	DoE
1	11.03.16	DoE
2	21.03.16	DoE
3	12.04.16	DoE Approval
4	15.04.16	PLANNING DRAFT
5	02.05.16	PLANNING ISSUE

CLIENT  
**Department of Education**

GRIMSHAW PROJECT NO.  
**15091**

DRAWING KEY

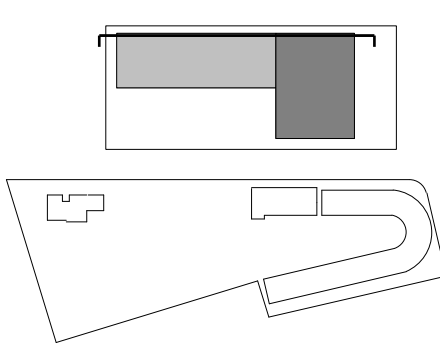

PROJECT  
**Arthur Phillip High School  
and Parramatta Public School**

ADDRESS  
**(PPS)  
171 - 177 Macquarie Street**

**(APHS)  
102-116 Macquarie Street  
Parramatta NSW 2150  
Australia**

NORTH



SCALE AT A1  
**1 : 250**

STATUS  
**SSD SUBMISSION ISSUE**

DRAWING  
**ELEVATIONS NORTH  
ELEVATION - INNER FACADE**

DRAWN CHECKED AUTHORISED  
**GAS EE / LJ LB**

DRAWING NUMBER REVISION  
**AR-A06-1224 5**