

ABBREVIATIONS - ROOF	
BG	box gutter
EG	eaves gutter
RC	ridge capping - notched to suit roof sheet profile
REJ	roof expansion joint
TRS	translucent roof sheeting

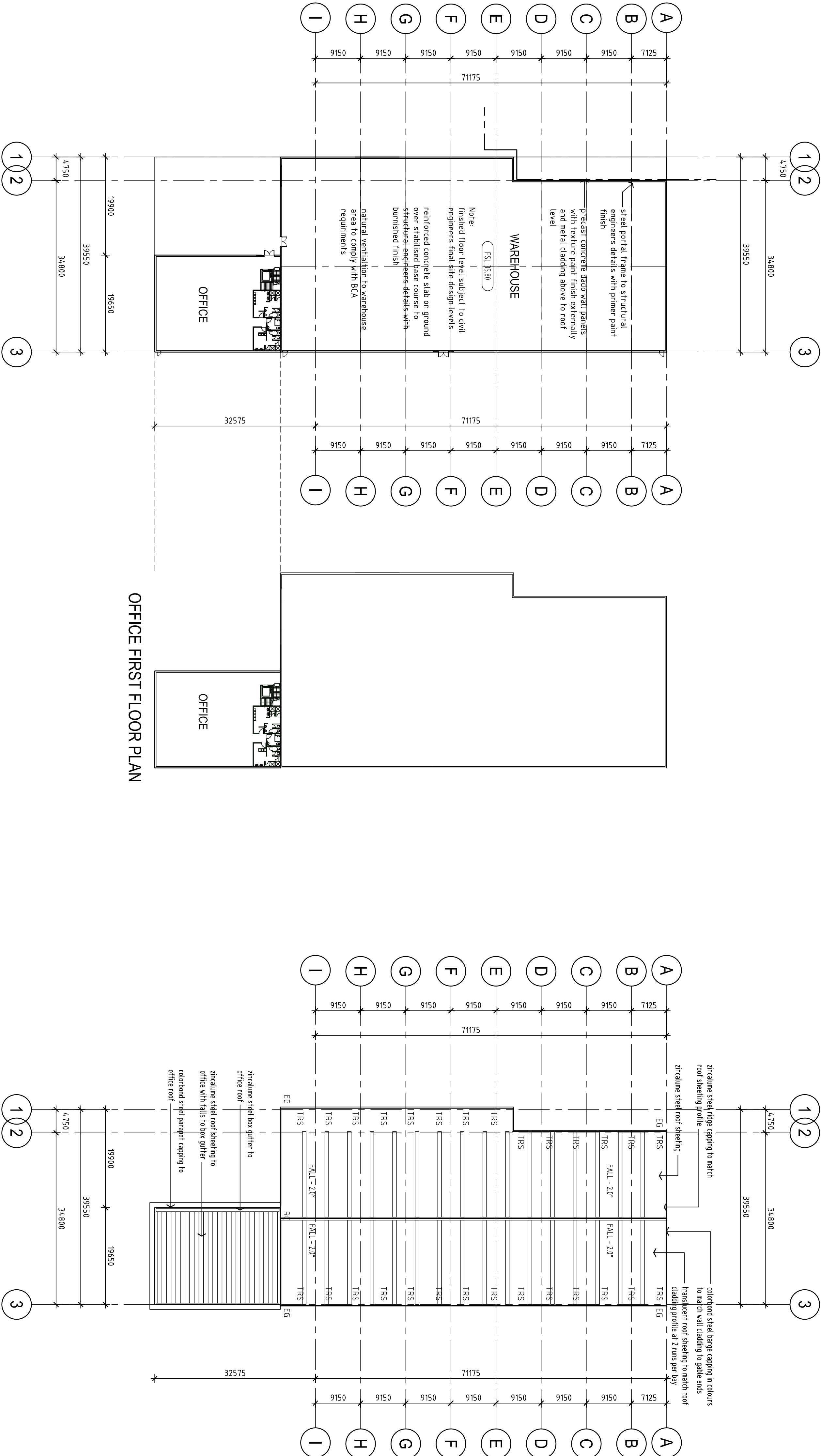

(A) WAREHOUSE 4 TENANCY MODIFIED

SECTION 96 / No.2 APPLICATION TO MODIFY
EXISTING DEVELOPMENT APPLICATION

GROUND FLOOR PLAN WAREHOUSE 4

ROOF PLAN WAREHOUSE 4

Scale - Measurement
A 28/11/15 ISSUED FOR DEVELOPMENT APPLICATION
B 26/04/16 RESUBMISSION FOR PLANNING APPROVAL
C 15/06/17 ISSUED FOR SECTION 96 - No. 2 APPLICATION
D 30/10/17 BUILDING 4 NOTED AS WAREHOUSE AND OFFICE

1: 500 scale @ A1 / 1: 1000 scale @ A3

Developer: **LOGOS**
LOGOS Property Group
Suite 1202 / 167 Macquarie Street
Sydney NSW 2000
T: + 61 2 919 8066 F: + 61 2 231 0948

Project Manager: **DBL PROPERTY**
Project / Development Managers
Level 6 / 432 Kent Street
Sydney NSW 2000
T: + 61 2 9261 7267 F: + 61 2 9261 7265

Project: **PRESTONS INDUSTRIAL ESTATE**
PROPOSED WAREHOUSE DEVELOPMENT
Cnr YARRUNGA STREET & BERNERA ROAD, PRESTONS NSW

AXIS ARCHITECTURAL
4 / 112 Cronulla Street, Cronulla NSW 2230
P + 02 9523 7858 / M + 0414 954 405
E - david@axisarchitects.com.au
AXIS ARCHITECTURAL Pty Ltd ABN 88 868 631 316
Nominated Architect - David McDonald A20 No. 7997

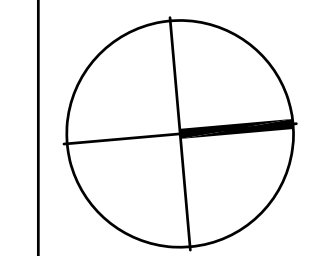

Drawn: **AA**
Date: November 2015
Scale: 1: 500 @ A1
1: 1000 @ A3

Project No: **140604**
Drawing No: **S96 - A 241**
Issue: **D**