

NOTES
1. FOR GENERAL NOTES AND EXISTING SERVICES NOTES REFER PD-CI-1005.
2. REFER TO DIAL BEFORE YOU DIG SURVEY

EXISTING SERVICES LEGEND	
s1	150-300 SEWER MAIN
s2	375-450 SEWER MAIN
s3	525-1000 SEWER MAIN
s4	812X1219, 1016X1219, 1016X1778, 1300X1750 SEWER MAIN
sr1	375 SEWER RISING MAIN
sr2	600 SEWER RISING MAIN
s	DISUSED SEWER MAIN
w	POTABLE WATER MAIN (UNKNOWN)
w1	100, 150 POTABLE WATER MAIN
w2	200, 225 POTABLE WATER MAIN
w3	250, 300 POTABLE WATER MAIN
w4	375, 500 POTABLE WATER MAIN
w5	600 POTABLE WATER MAIN
g	GAS (UNKNOWN)
g1	SECONDARY MAIN 1050 KPA
g2	210 KPA
g3	7 KPA
g4	PROPOSED MAIN 2KPA
c	COMMUNICATIONS (UNKNOWN)
a1	AAPT DUCT
a2	NON-AAPT DUCT (LIKELY FALSE)
n1	NEXTGEN CABLE
n2	NEXTGEN THIRD PARTY
o1	OPTUS
o2	OPTUS IN OTHER UTILITY'S DUCT
t1	TELSTRA 1-4 CONDUITS
t2	TELSTRA MAJOR SERVICE
t3	TELSTRA AERIAL CABLE
v1	VERIZON DUCT
v2	TELSTRA DUCT (LIKELY FALSE)
pn	PIPE NETWORKS DUCT
e1	ELECTRICAL 1-5 CONDUITS
e2	ELECTRICAL 6-12 CONDUITS
e3	ELECTRICAL 13-20 CONDUITS
e4	ELECTRICAL RAILWAY CABLES
e5	ELECTRICAL TRANSMISSION CABLES
e6	ELECTRICAL 21+ CONDUITS
sw	EXISTING STORMWATER CULVERT/PIPE
sp	EXISTING SYDNEY WATER CULVERT/PIPE
st	EXISTING STORMWATER PIT

DARLING HARBOUR LIVE

REFERENCE MAP

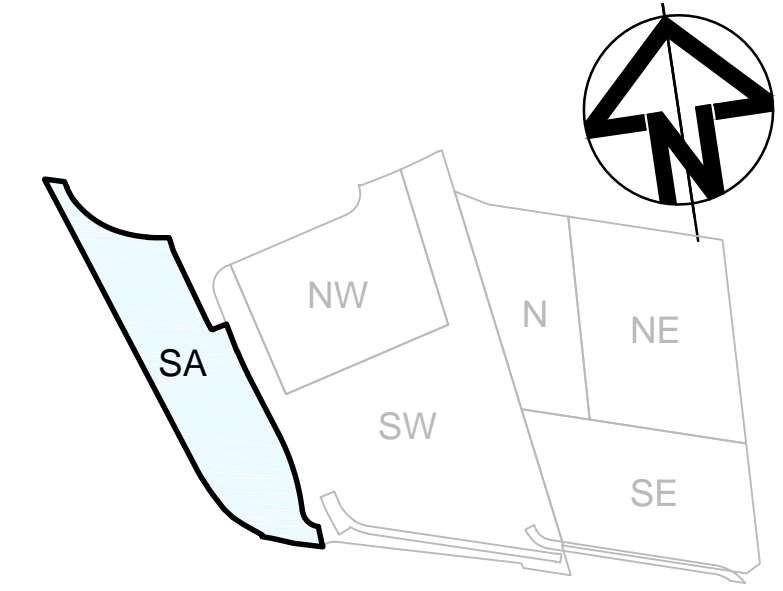

NOTES:

1. DO NOT SCALE FROM DRAWINGS. USE WRITTEN DIMENSIONS ONLY.
2. ALL DIMENSIONS IN MILLIMETRES UNLESS NOTED OTHERWISE.
3. ALL COORDINATES TO MGA. ALL LEVELS TO AHD.
4. ALL DIMENSIONS, COORDINATES AND LEVELS TO BE VERIFIED ON SITE BEFORE PROCEEDING WITH WORK. HYDER SHALL BE NOTIFIED IN WRITING OF ANY DISCREPANCIES.
5. THIS DRAWING MUST BE READ IN CONJUNCTION WITH ALL RELEVANT CONTRACTS, SPECIFICATIONS AND DRAWINGS.
6. THIS DRAWING CONTAINS COLOUR AND MUST ONLY BE PRINTED OR COPIED IN COLOUR.

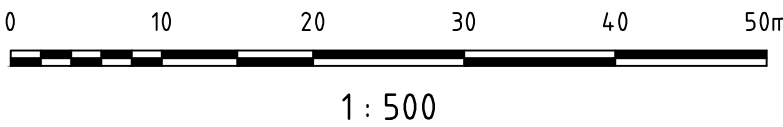

REV	DESCRIPTION	DATE
04	ISSUE FOR DEVELOPMENT APPLICATION	11/09/15
03	ISSUE FOR DEVELOPMENT APPLICATION	04/09/15
02	ISSUE FOR DEVELOPMENT APPLICATION	01/09/15
01	DRAFT ISSUE	19/08/15

CLIENT

urbanest
student accommodation
SUITE 102, LEVEL 1, AUSTRALIA SQUARE,
PLAZA BUILDING, 95 PITT ST
SYDNEY, NSW 2000

CONSULTANTS

ASPECT Studios
ASPECT STUDIOS
STUDIO 61, LEVEL 6, 61 MARLBOROUGH ST,
SURRY HILLS, NSW 2010

AJ+C
ARCHITECT
79 MYRTLE STREET,
CHIPPENDALE NSW 2008

CIVIL / TRAFFIC / FACADES

HYDER CONSULTING PTY LTD
ABN 76 104 485 289
LEVEL 5, 141 WALKER ST,
NORTH SYDNEY NSW 2060
AUSTRALIA

Tel: +61 (0)2 8907 9000
Fax: +61 (0)2 8907 9001
www.hyderconsulting.com
© Copyright reserved

PROJECT

**SICEEP - DARLING HARBOUR LIVE
DARLING SQUARE
WESTERN PLOT BUILDING W1**

DRAWING TITLE

**SURVEY AND EXISTING
SERVICES PLAN
(ROBERT BIRD GROUP)**

STATUS

DA APPROVAL

SCALE @ A1	DRAWN	DESIGNED	REVIEWED	APPROVED
1 : 500	JW	JW	MAK	-
PROJECT NUMBER	DRAWING NUMBER	REV		
AA004399	PD-CI-1022	04		

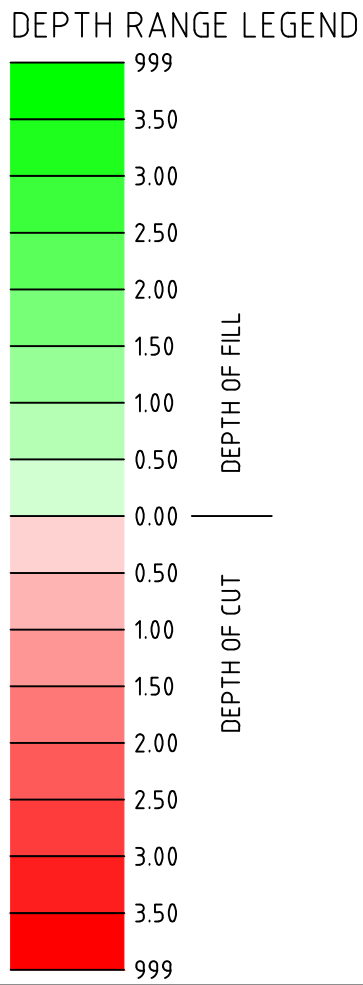
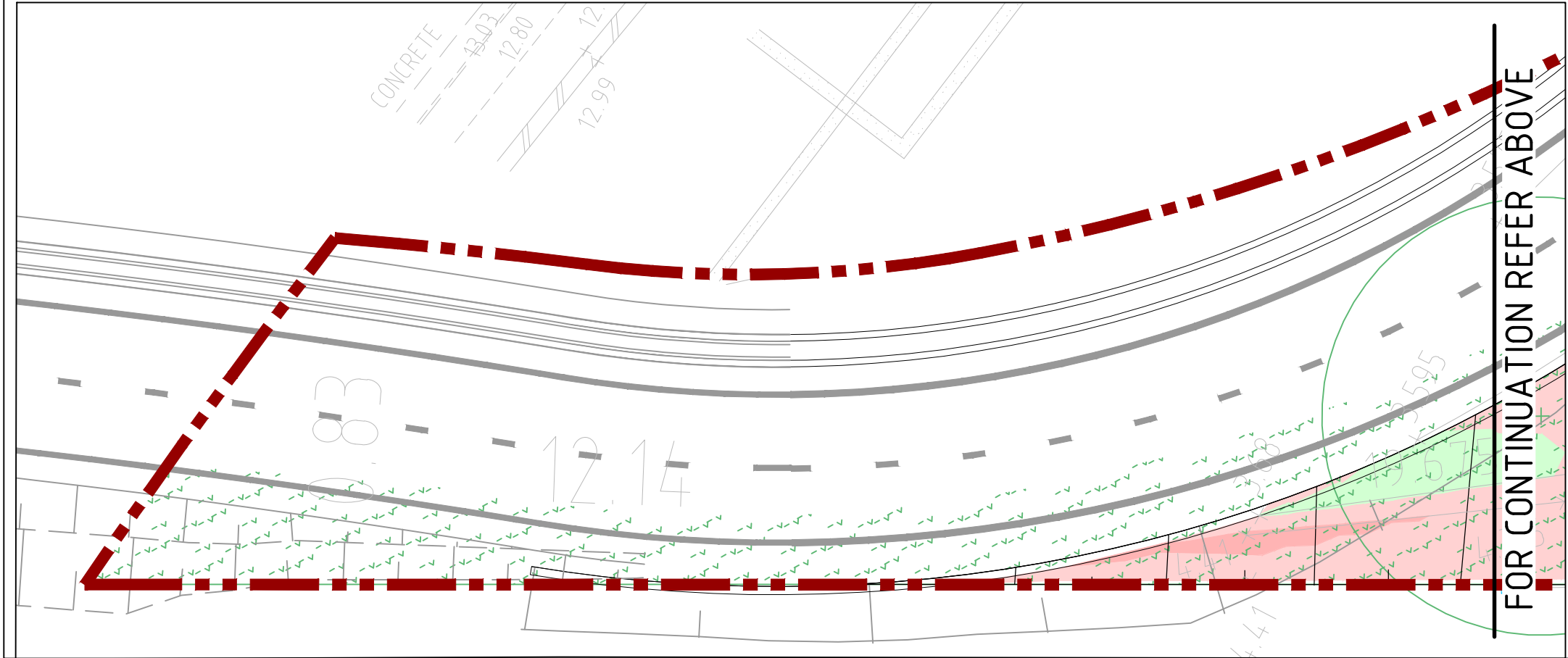
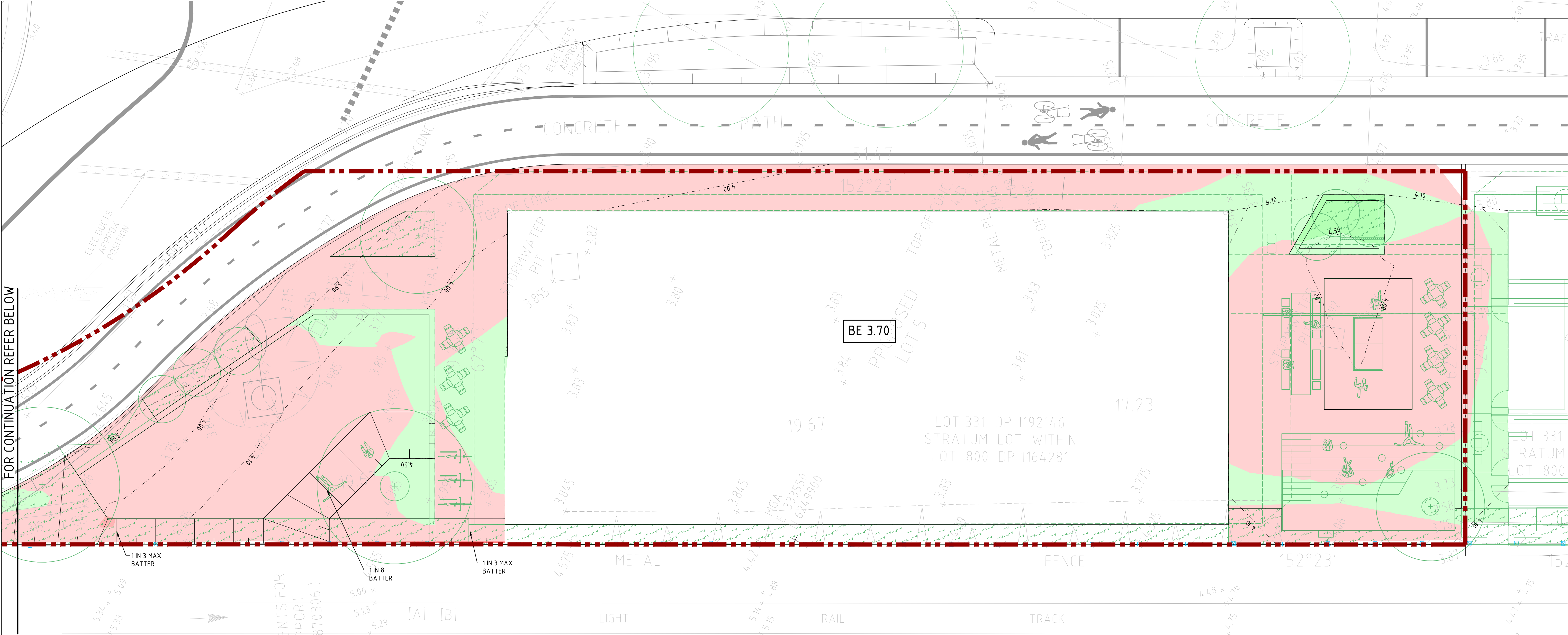

CUT/FILL VOLUMES:

TOTAL CUT	82m ³
TOTAL FILL	16m ³
TOTAL BALANCE	66m ³
IE EXCESS OF CUT OVER FILL	66m ³

FIGURES ABOVE ARE APPROXIMATE ONLY.

- EARTHWORKS NOTES/ASSUMPTIONS:
1. THE CUT/FILL VOLUMES DO NOT INCLUDE THE ACTUAL PAVEMENT MATERIALS (NOMINAL PAVEMENT THICKNESS ASSUMED 300mm) REQUIRED. THE VOLUMES ALLOW FOR THE EXCAVATION AND FORMATION OF THE SUBGRADE WITH RELATION TO THE EXISTING SURFACE (NO STRIPPING).
 2. NO ALLOWANCE FOR BULKING FACTORS.
 3. NO ALLOWANCE FOR TRENCH EXCAVATION.
 4. CONTOURS SHOWN ON THIS PLAN ARE FINISHED SURFACE CONTOURS.

NOTES:

1. FOR GENERAL NOTES AND BULK EARTHWORKS, REFER DRAWING PD-CI-1005.

DARLING HARBOUR LIVE

REFERENCE MAP

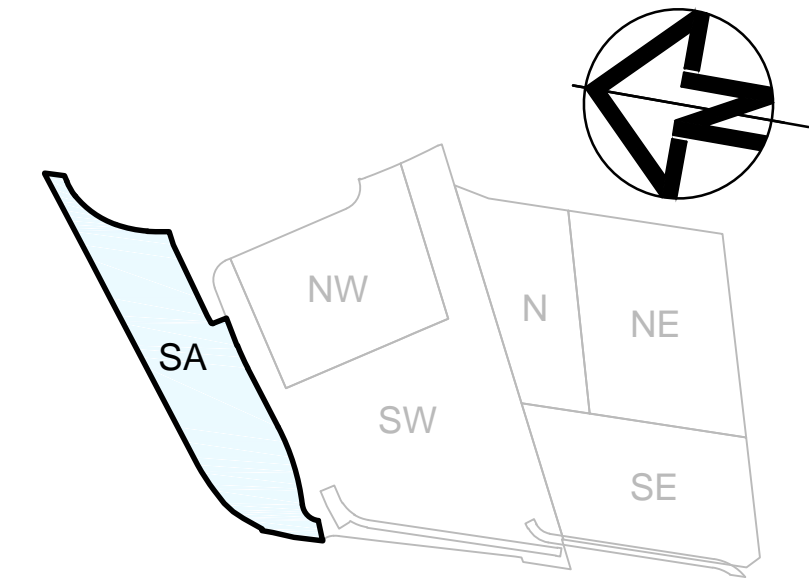

- NOTES:
1. DO NOT SCALE FROM DRAWINGS. USE WRITTEN DIMENSIONS ONLY.
 2. ALL DIMENSIONS IN MILLIMETRES UNLESS NOTED OTHERWISE.
 3. ALL COORDINATES TO MGA. ALL LEVELS TO AHD.
 4. ALL DIMENSIONS, COORDINATES AND LEVELS TO BE VERIFIED ON SITE BEFORE PROCEEDING WITH WORK. HYDER SHALL BE NOTIFIED IN WRITING OF ANY DISCREPANCIES.
 5. THIS DRAWING MUST BE READ IN CONJUNCTION WITH ALL RELEVANT CONTRACTS, SPECIFICATIONS AND DRAWINGS.
 6. THIS DRAWING CONTAINS COLOUR AND MUST ONLY BE PRINTED OR COPIED IN COLOUR.

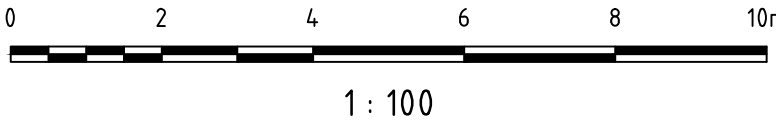

REV	DESCRIPTION	DATE
03	ISSUE FOR DEVELOPMENT APPLICATION	11/09/15
02	ISSUE FOR DEVELOPMENT APPLICATION	04/09/15
01	ISSUE FOR DEVELOPMENT APPLICATION	01/09/15

CLIENT

urbanest
student accommodation

URBANEST STUDENT ACCOMMODATION
SUITE 102, LEVEL 1, AUSTRALIA SQUARE,
PLAZA BUILDING, 95 PITT ST
SYDNEY, NSW 2000

CONSULTANTS

ASPECT Studios™
ASPECT STUDIOS
STUDIO 61, LEVEL 6, 61 MARLBOROUGH ST,
SURRY HILLS, NSW 2010

AJ+C
ARCHITECT
79 MYRTLE STREET,
CHIPPENDALE NSW 2008

CIVIL / TRAFFIC / FACADES

HYDER CONSULTING PTY LTD
ABN 76 104 485 289
LEVEL 5, 141 WALKER ST,
NORTH SYDNEY NSW 2060
AUSTRALIA

Tel: +61 (0)2 8907 9000
Fax: +61 (0)2 8907 9001
www.hyderconsulting.com
© Copyright reserved



PROJECT

SICEP - DARLING HARBOUR LIVE
DARLING SQUARE
WESTERN PLOT BUILDING W1

DRAWING TITLE				
BULK EARTHWORKS PLAN				
STATUS				
DA APPROVAL				
SCALE @ A1	DRAWN	DESIGNED	REVIEWED	APPROVED
1:100	JW	JW	MAK	-
PROJECT NUMBER	DRAWING NUMBER		REV	
AA004399	PD-CI-1151		03	

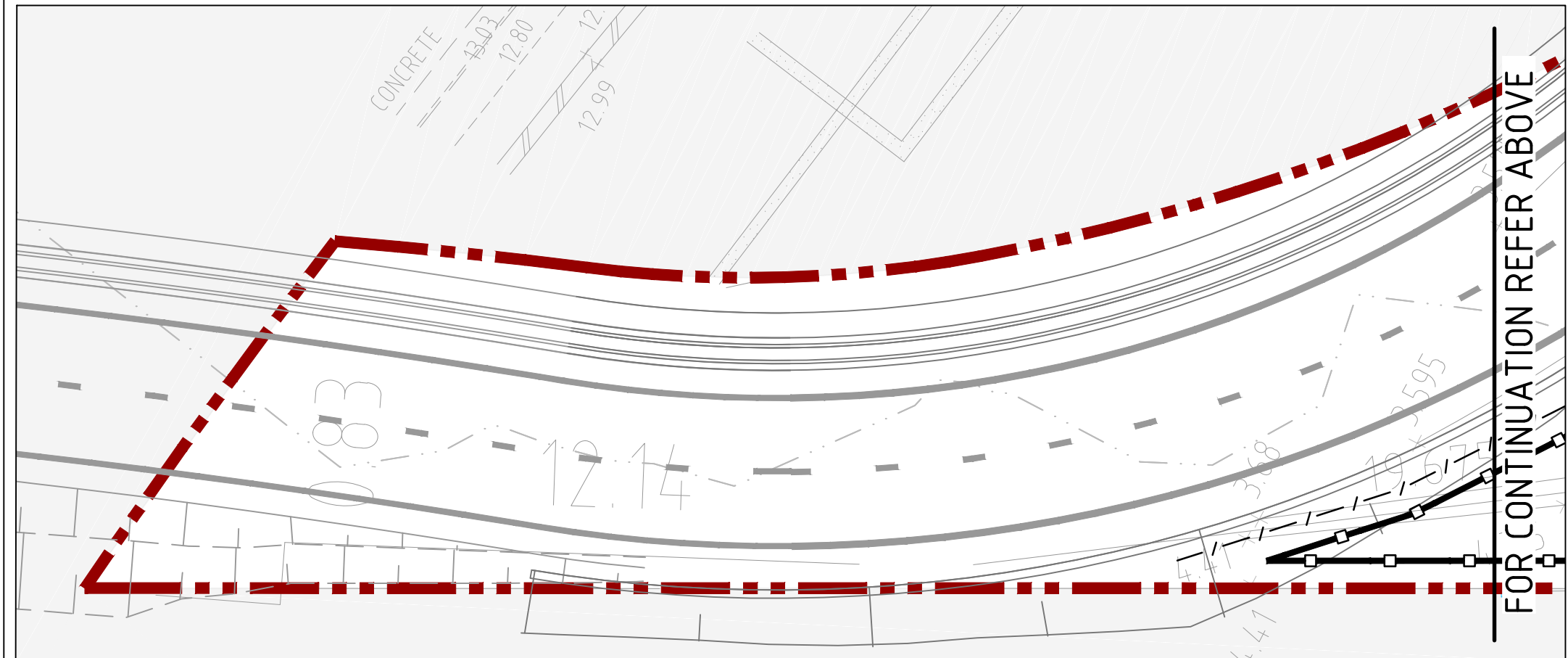
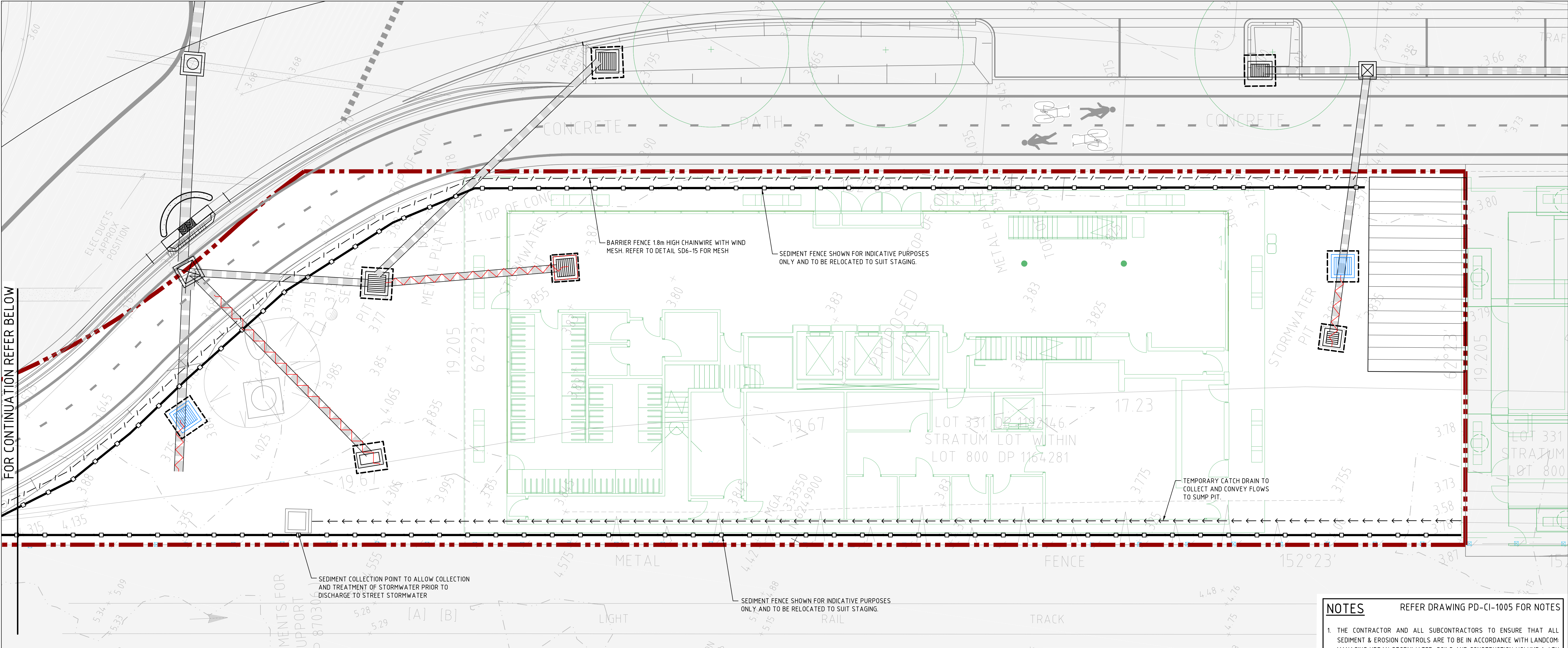

NOTES REFER DRAWING PD-CI-1005 FOR NOTES

1. THE CONTRACTOR AND ALL SUBCONTRACTORS TO ENSURE THAT ALL SEDIMENT & EROSION CONTROLS ARE TO BE IN ACCORDANCE WITH LANDCOM: MANAGING URBAN STORMWATER: SOILS AND CONSTRUCTION VOLUME 1: 4TH EDITION MARCH 2004, ALSO KNOWN AS "THE BLUE BOOK".
2. SEDIMENT CONTROL FENCES AND BARRIERS TO BE INSTALLED AROUND CONSTRUCTION STAGING PERIMETERS IN ACCORDANCE WITH COUNCIL REQUIREMENTS.
3. ALL SUBCONTRACTORS TO BE INFORMED OF THEIR RESPONSIBILITIES IN MINIMISING THE POTENTIAL FOR SOIL EROSION AND POLLUTION TO DOWNSLOPE AREAS.
4. WHERE PRACTICABLE, THE SOIL EROSION HAZARD ON THE SITE WILL BE KEPT AS LOW AS POSSIBLE AND AS RECOMMENDED BY THE CONTRACTOR.
5. EROSION AND SEDIMENT CONTROLS TO BE INSTALLED ON INLET PITS, IN ACCORDANCE WITH COUNCIL REQUIREMENTS E.G. MESH & GRAVEL FILTERS, GEOTEXTILE INLET FILTERS ETC.
6. CONSTRUCT LOW FLOW EARTH BANKS WHERE REQUIRED, IN ACCORDANCE WITH COUNCIL REQUIREMENTS.
7. CONSTRUCT STABILISED SITE ACCESSES WHERE NECESSARY, IN ACCORDANCE WITH COUNCIL REQUIREMENTS.
8. ALL STOCKPILES TO BE LOCATED CLEAR OF ALL POSSIBLE AREAS OF CONCENTRATED WATER FLOW, AND TO BE CONTAINED WITHIN A SEDIMENT FENCE.
9. STOCKPILES TO BE COVERED WHERE NECESSARY.
10. ALL WHEEL AND EQUIPMENT WASHING FACILITIES TO BE CONTAINED TO SPECIFIC BUNDED WASH AREAS.
11. ALL FUEL AND CHEMICALS TO BE SAFELY STORED TO PREVENT CONTAMINATION FROM SPILLAGES.

LEGEND

- 46.0 --- PROPOSED CONTOUR
- 48.0 --- EXISTING CONTOUR
- PROPOSED STORMWATER INLET PIT
- PROPOSED STORMWATER JUNCTION PIT
- MESH AND GRAVEL INLET FILTER
- GEOTEXTILE FILTER PIT SURROUND
- STABILISED SITE ACCESS AND TRUCK WASH DOWN AREA. LOCATION TO BE DETERMINED ON SITE
- SEDIMENT FENCE
- TEMPORARY CATCH DRAIN
- PROJECT BOUNDARY

NOTE: REFER DRAWING PD-CI-1221 FOR DETAILS

DARLING HARBOUR LIVE

REFERENCE MAP

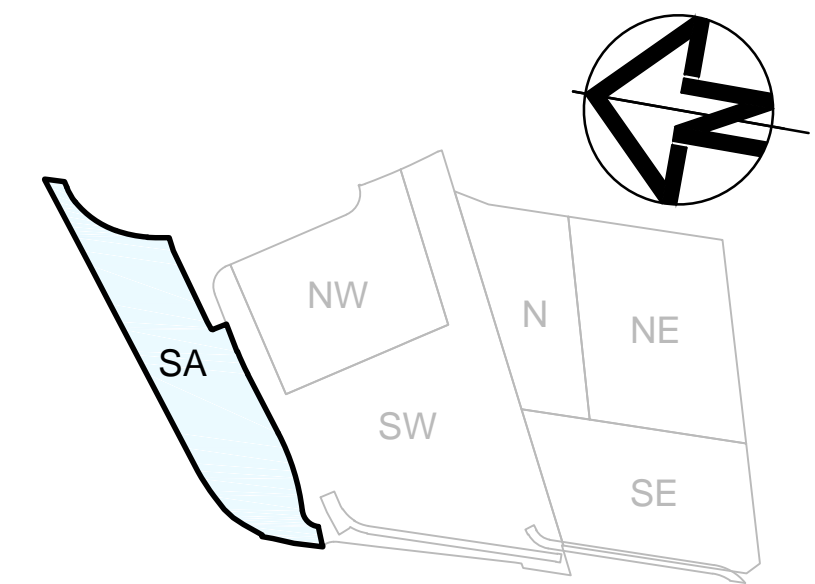

- NOTES:**
1. DO NOT SCALE FROM DRAWINGS. USE WRITTEN DIMENSIONS ONLY.
 2. ALL DIMENSIONS IN MILLIMETRES UNLESS NOTED OTHERWISE.
 3. ALL COORDINATES TO MGA. ALL LEVELS TO AHD.
 4. ALL DIMENSIONS, COORDINATES AND LEVELS TO BE VERIFIED ON SITE BEFORE PROCEEDING WITH WORK. HYDER SHALL BE NOTIFIED IN WRITING OF ANY DISCREPANCIES.
 5. THIS DRAWING MUST BE READ IN CONJUNCTION WITH ALL RELEVANT CONTRACTS, SPECIFICATIONS AND DRAWINGS.
 6. THIS DRAWING CONTAINS COLOUR AND MUST ONLY BE PRINTED OR COPIED IN COLOUR.

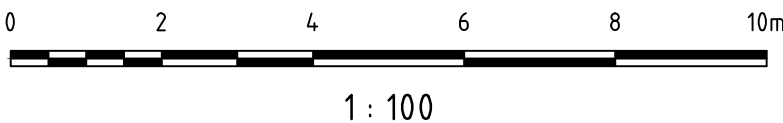

REV	DESCRIPTION	DATE
05	ISSUE FOR DEVELOPMENT APPLICATION	11/09/15
04	ISSUE FOR DEVELOPMENT APPLICATION	07/09/15
03	ISSUE FOR DEVELOPMENT APPLICATION	04/09/15
02	ISSUE FOR DEVELOPMENT APPLICATION	01/09/15
01	DRAFT ISSUE	19/08/15

CLIENT
urbanest student accommodation
SUITE 102, LEVEL 1, AUSTRALIA SQUARE,
PLAZA BUILDING, 95 PITT ST
SYDNEY, NSW 2000

CONSULTANTS
ASPECT Studios™
ASPECT STUDIOS
STUDIO 61, LEVEL 6, 61 MARLBOROUGH ST,
SURRY HILLS, NSW 2010

AJ+C ARCHITECT
79 MYRTLE STREET,
CHIPPENDALE NSW 2008

CIVIL / TRAFFIC / FACADES
HYDER CONSULTING PTY LTD
ABN 76 104 485 289
LEVEL 5, 141 WALKER ST,
NORTH SYDNEY NSW 2060
AUSTRALIA

Tel: +61 (0)2 8907 9000
Fax: +61 (0)2 8907 9001
www.hyderconsulting.com
© Copyright reserved

PROJECT
SICEEP - DARLING HARBOUR LIVE
DARLING SQUARE
WESTERN PLOT BUILDING W1

DRAWING TITLE
**SEDIMENT AND EROSION
CONTROL PLAN**

STATUS

DA APPROVAL

SCALE @ A1 1:100	DRAWN JW	DESIGNED JW	REVIEWED MAK	APPROVED -
PROJECT NUMBER AA004399	DRAWING NUMBER PD-CI-1201	REV 05		

EARTH BUND (SD5-5)
NTS

HAY BALE AND GEOTEXTILE SEDIMENT FILTER (SD6-7)

SEDIMENT FENCE (SD6-8)
NTS

MESH AND GRAVEL INLET FILTER (SD 6-11)
NTS

STABILISED SITE ACCESS AND TRUCK WASH DOWN AREA (SD6-14)
NTS

GEOTEXTILE FILTER PIT SURROUND (SD6-12)
NTS

INDICATIVE SEDIMENT COLLECTION POINT
1 : 20

TRUCK WASH - PLAN

ALTERNATE CONCRETE TRUCK WASH DOWN DETAIL

TEMPORARY CATCH DRAIN
(MIN FALL 1%)
SCALE N.T.S.

NOTE:
(SDXX) INDICATES STANDARD DRAWINGS,
REFER MANAGING URBAN STORMWATER, SOIL
AND CONSTRUCTION 4th EDITION MARCH 2004.

REFERENCE MAP

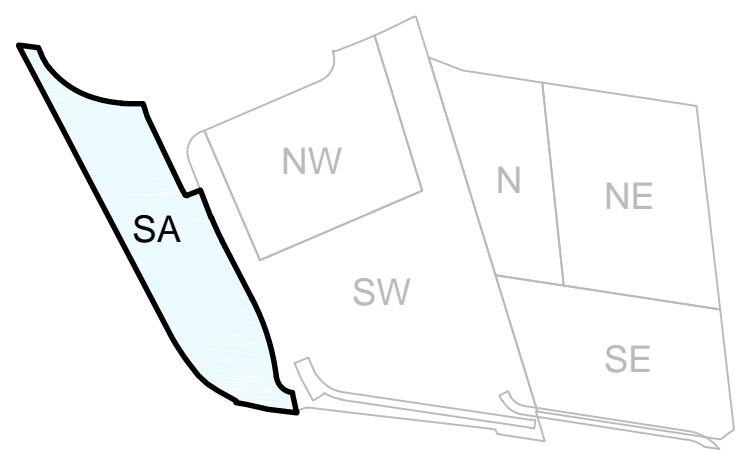

NOTES:

1. DO NOT SCALE FROM DRAWINGS. USE WRITTEN DIMENSIONS ONLY.
2. ALL DIMENSIONS IN MILLIMETRES UNLESS NOTED OTHERWISE.
3. ALL COORDINATES TO MGA. ALL LEVELS TO AHD.
4. ALL DIMENSIONS, COORDINATES AND LEVELS TO BE VERIFIED ON SITE BEFORE PROCEEDING WITH WORK. HYDER SHALL BE NOTIFIED IN WRITING OF ANY DISCREPANCIES.
5. THIS DRAWING MUST BE READ IN CONJUNCTION WITH ALL RELEVANT CONTRACTS, SPECIFICATIONS AND DRAWINGS.
6. THIS DRAWING CONTAINS COLOUR AND MUST ONLY BE PRINTED OR COPIED IN COLOUR.

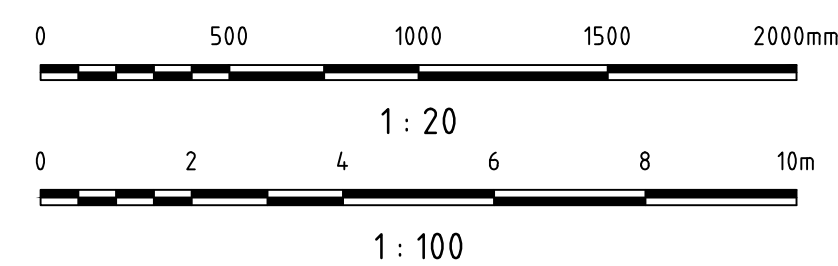

04	ISSUE FOR DEVELOPMENT APPLICATION	11/09/15
03	ISSUE FOR DEVELOPMENT APPLICATION	04/09/15
02	ISSUE FOR DEVELOPMENT APPLICATION	01/09/15
01	DRAFT ISSUE	19/08/15
REV	DESCRIPTION	DATE

CLIENT

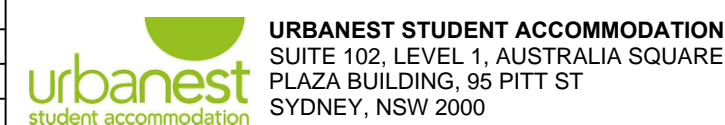

CONSULTANTS:



ASPECT STUDIOS
STUDIO 61, LEVEL 6, 61 MA
SURRY HILLS, NSW 2010



ARCHITECT
79 MYRTLE STREET,
CHIPPENDALE NSW 2008

CIVIL / TRAFFIC / FACADES

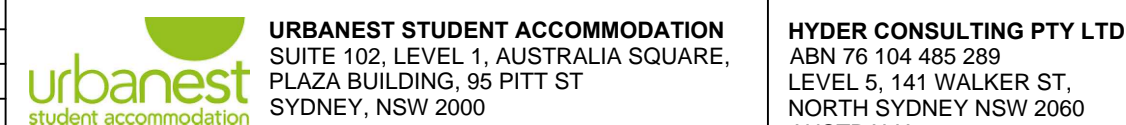

Tel: +61 (0)2 8907 9000
Fax: +61 (0)2 8907 9001
www.hyderconsulting.com
© Copyright reserved

PROJECT

SICEEP - DARLING HARBOUR LIVE
DARLING SQUARE
WESTERN PLOT BUILDING W1



DRAWING TITLE

SEDIMENT AND EROSION CONTROL DETAILS

STATUS

DA APPROVAL

SCALE @ A1	DRAWN	DESIGNED	REVIEWED	APPROVED
AS SHOWN	JW	JW	MAK	-
PROJECT NUMBER	DRAWING NUMBER			REV
AA004399	PD-CI-1221			04

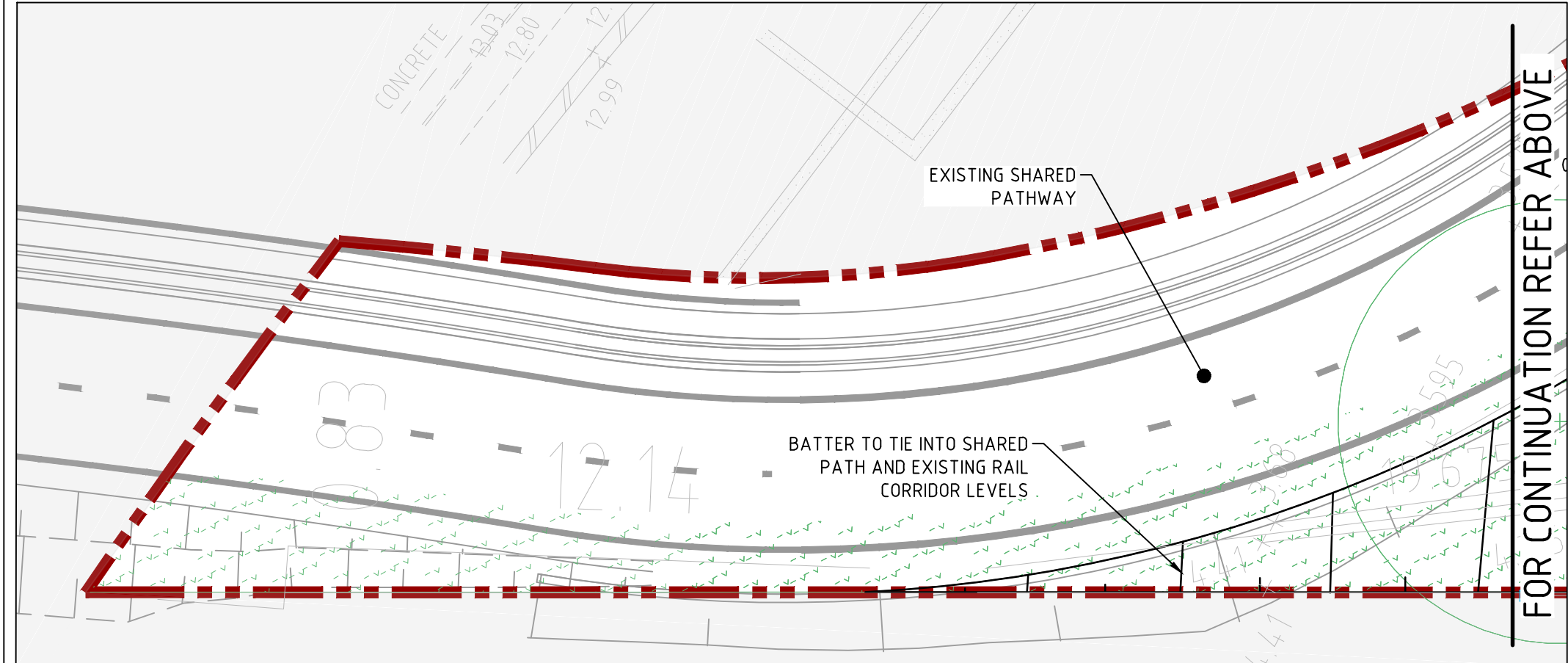
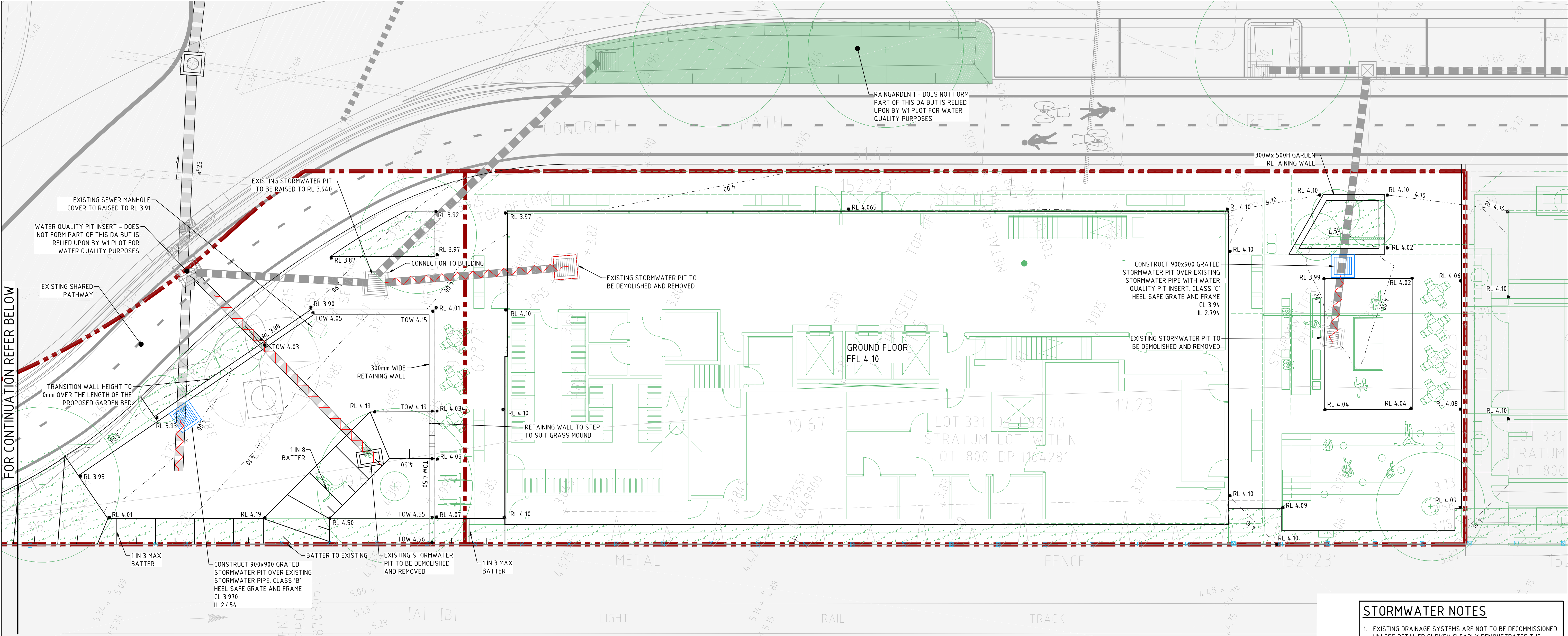

STORMWATER NOTES

1. EXISTING DRAINAGE SYSTEMS ARE NOT TO BE DECOMMISSIONED UNLESS DETAILED SURVEY CLEARLY DEMONSTRATES THE SYSTEMS DO NOT SERVE UPSTREAM CATCHMENT

NOTES

1. REFER DRAWING PD-CI-1005 FOR GENERAL NOTES.

LEGEND

46.0	PROPOSED CONTOUR
48.0	EXISTING CONTOUR
K&G	PROPOSED KERB & GUTTER
CK&G	PROPOSED CASTELLATED KERB & GUTTER
DC	PROPOSED DISH CROSSING
MK	PROPOSED MOUNTABLE KERB
K&T	PROPOSED KERB & TOE
KO	PROPOSED KERB ONLY
CKO	PROPOSED CASTELLATED KERB ONLY
TE	PROPOSED THICKENED EDGE

LEGEND (CONTINUED)

	EXISTING STORMWATER PIPE / CULVERT TO BE RETAINED AND PROTECTED
	EXISTING STORMWATER PIPE / CULVERT TO BE DEMOLISHED AND BACKFILLED
	EXISTING STORMWATER PIT TO BE RETAINED (OUTLINE SHOWN INDICATIVE ONLY)
	EXISTING STORMWATER PIT TO BE DEMOLISHED (OUTLINE SHOWN INDICATIVE ONLY)
	PROPOSED STORMWATER PIPE / CULVERT
	PRELIMINARY PROPOSED STORMWATER PIPE / CULVERT AS PART OF OTHER PLOTS. REFER RELEVANT PLOT DRAWINGS FOR DETAILS
	STORMWATER PIT NUMBER
	PROPOSED SURFACE INLET PIT
	PROPOSED JUNCTION PIT
	PROJECT BOUNDARY

DARLING HARBOUR LIVE

REFERENCE MAP

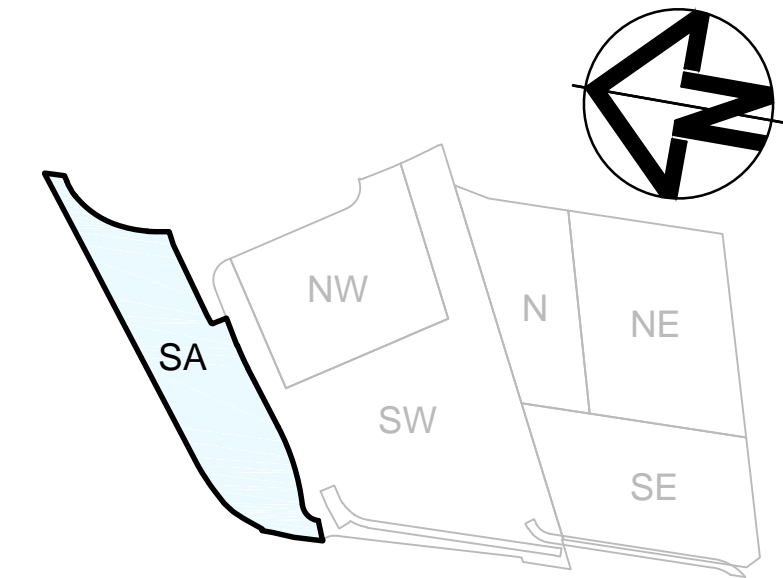

NOTES:

- DO NOT SCALE FROM DRAWINGS. USE WRITTEN DIMENSIONS ONLY.
- ALL DIMENSIONS IN MILLIMETRES UNLESS NOTED OTHERWISE.
- ALL COORDINATES TO MGA. ALL LEVELS TO AHD.
- ALL DIMENSIONS, COORDINATES AND LEVELS TO BE VERIFIED ON SITE BEFORE PROCEEDING WITH WORK. HYDER SHALL BE NOTIFIED IN WRITING OF ANY DISCREPANCIES.
- THIS DRAWING MUST BE READ IN CONJUNCTION WITH ALL RELEVANT CONTRACTS, SPECIFICATIONS AND DRAWINGS.
- THIS DRAWING CONTAINS COLOUR AND MUST ONLY BE PRINTED OR COPIED IN COLOUR.

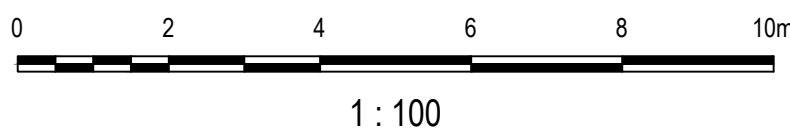

REV	DESCRIPTION	DATE
04	ISSUE FOR DEVELOPMENT APPLICATION	11/09/15
03	ISSUE FOR DEVELOPMENT APPLICATION	04/09/15
02	ISSUE FOR DEVELOPMENT APPLICATION	01/09/15
01	DRAFT ISSUE	19/08/15

CLIENT
urbanest student accommodation
SUITE 102, LEVEL 1, AUSTRALIA SQUARE,
PLAZA BUILDING, 95 PITT ST
SYDNEY, NSW 2000

CONSULTANTS
ASPECT Studios
ASPECT STUDIOS
STUDIO 61, LEVEL 6, 61 MARLBOROUGH ST,
SURREY HILLS, NSW 2010

ARCHITECT
AJ+C
79 MYRTLE STREET,
CHIPPENDALE NSW 2008

CIVIL / TRAFFIC / FACADES
HYDER CONSULTING PTY LTD
ABN 76 104 485 289
LEVEL 5, 141 WALKER ST,
NORTH SYDNEY NSW 2060
AUSTRALIA

Tel: +61 (0)2 8907 9000
Fax: +61 (0)2 8907 9001
www.hyderconsulting.com
© Copyright reserved

PROJECT
SICEEP - DARLING HARBOUR LIVE
DARLING SQUARE
WESTERN PLOT BUILDING W1

DRAWING TITLE
CIVIL WORKS AND STORMWATER PLAN

STATUS
DA APPROVAL

SCALE @ A1
1:100

DRAWN
JW

DESIGNED
JW

REVIEWED
MAK

APPROVED
-

PROJECT NUMBER
AA004399

DRAWING NUMBER
PD-CI-1301

REV
04

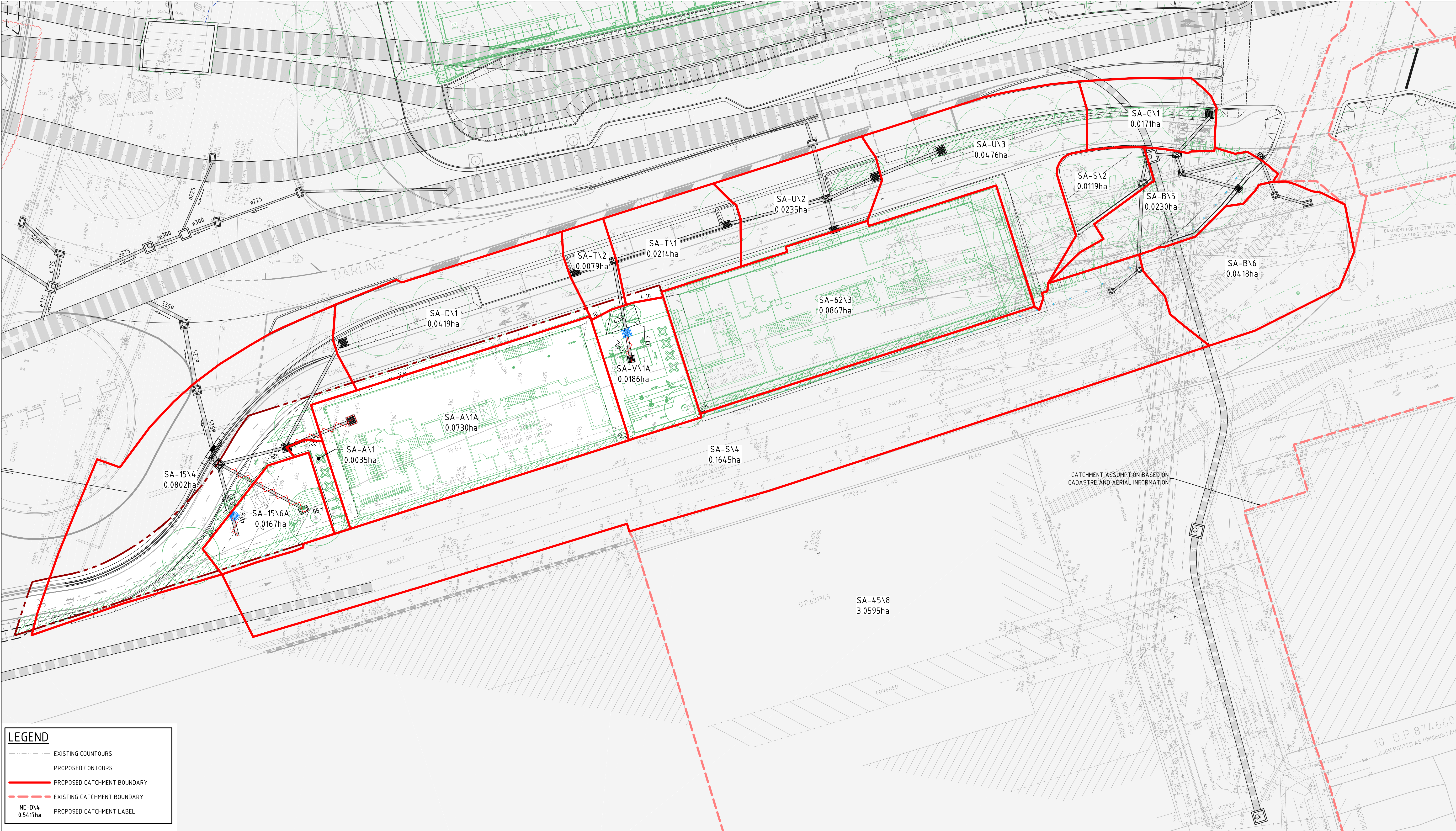

LEGEND

EXISTING COUNTOURS

PROPOSED COUNTOURS

PROPOSED CATCHMENT BOUNDARY

EXISTING CATCHMENT BOUNDARY

NE-DV4
0.5417ha

PROPOSED CATCHMENT LABEL

DARLING HARBOUR LIVE

REFERENCE MAP

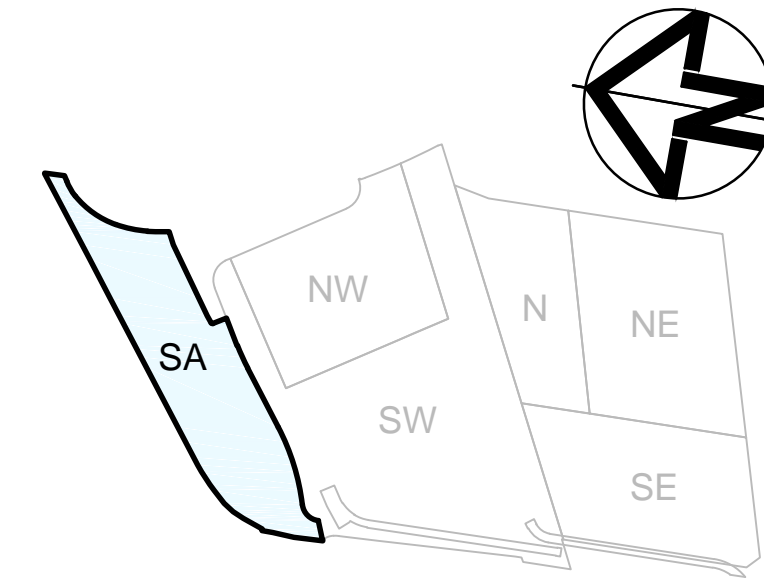

- NOTES:
- DO NOT SCALE FROM DRAWINGS. USE WRITTEN DIMENSIONS ONLY.
 - ALL DIMENSIONS IN MILLIMETRES UNLESS NOTED OTHERWISE.
 - ALL COORDINATES TO MGA. ALL LEVELS TO AHD.
 - ALL DIMENSIONS, COORDINATES AND LEVELS TO BE VERIFIED ON SITE BEFORE PROCEEDING WITH WORK. HYDER SHALL BE NOTIFIED IN WRITING OF ANY DISCREPANCIES.
 - THIS DRAWING MUST BE READ IN CONJUNCTION WITH ALL RELEVANT CONTRACTS, SPECIFICATIONS AND DRAWINGS.
 - THIS DRAWING CONTAINS COLOUR AND MUST ONLY BE PRINTED OR COPIED IN COLOUR.

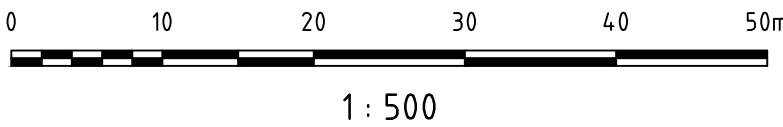

REV	DESCRIPTION	DATE
05	ISSUE FOR DEVELOPMENT APPLICATION	11/09/15
04	ISSUE FOR DEVELOPMENT APPLICATION	07/09/15
03	ISSUE FOR DEVELOPMENT APPLICATION	04/09/15
02	ISSUE FOR DEVELOPMENT APPLICATION	01/09/15
01	DRAFT ISSUE	19/08/15

CLIENT

urbanest

student accommodation

SUITE 102, LEVEL 1, AUSTRALIA SQUARE,
PLAZA BUILDING, 95 PITT ST
SYDNEY, NSW 2000

CONSULTANTS

ASPECT Studios™

ASPECT STUDIOS
STUDIO 61, LEVEL 6, 61 MARLBOROUGH ST,
SURRY HILLS, NSW 2010

AJ+C

ARCHITECT

79 MYRTLE STREET,
CHIPPENDALE NSW 2008

CIVIL / TRAFFIC / FACADES

HYDER CONSULTING PTY LTD

ABN 76 104 485 289
LEVEL 5, 141 WALKER ST,
NORTH SYDNEY NSW 2060
AUSTRALIA

Tel: +61 (0)2 8907 9000
Fax: +61 (0)2 8907 9001
www.hyderconsulting.com
© Copyright reserved



PROJECT

SICEP - DARLING HARBOUR LIVE
DARLING SQUARE
WESTERN PLOT BUILDING W1

DRAWING TITLE

STORMWATER DRAINAGE
CATCHMENT PLAN

STATUS

DA APPROVAL

SCALE @ A1	DRAWN	DESIGNED	REVIEWED	APPROVED
1 : 500	JW	VN	MAK	-
PROJECT NUMBER	DRAWING NUMBER	REV		
AA004399	PD-CI-1541	05		

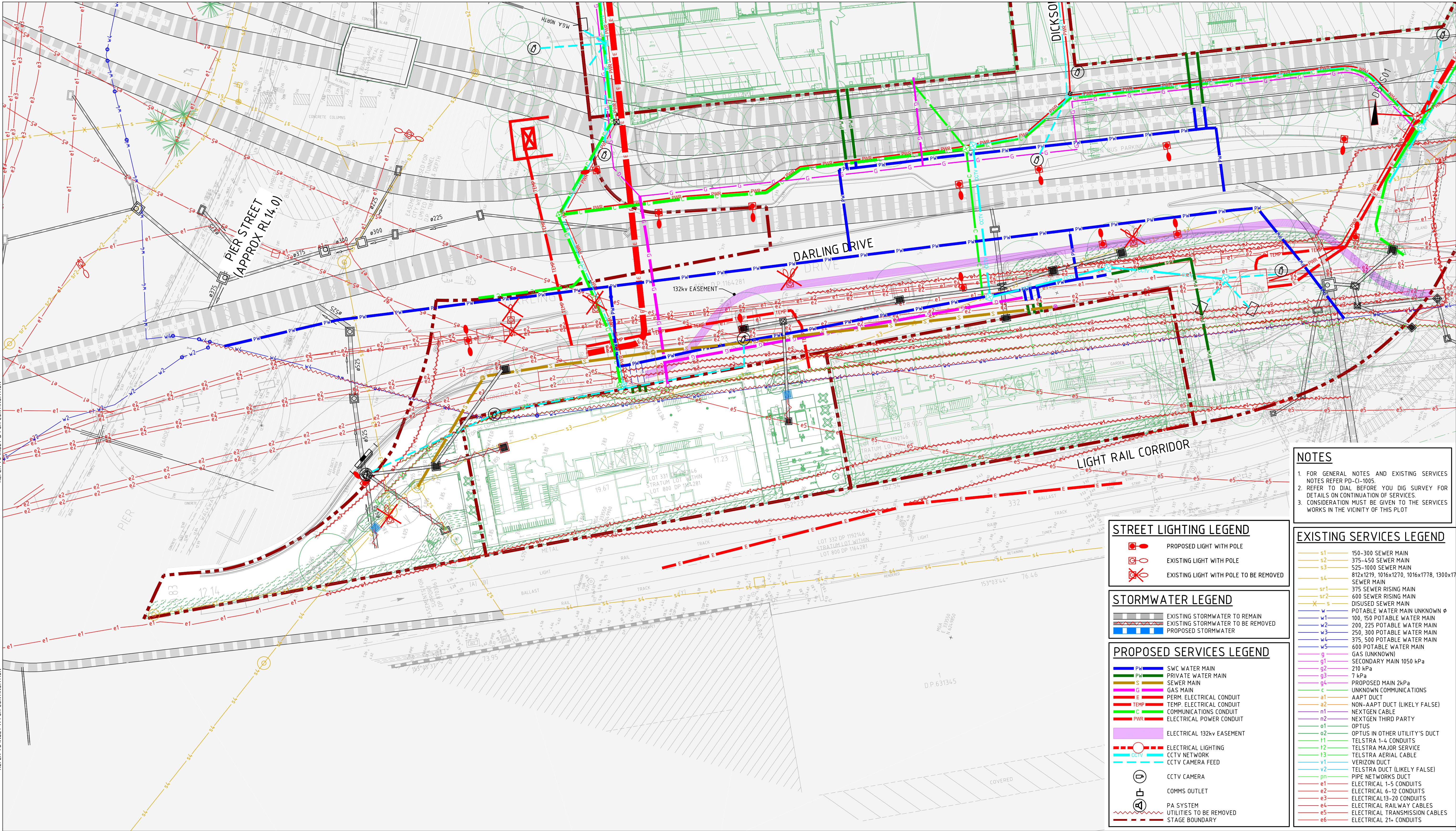

NOTES

- FOR GENERAL NOTES AND EXISTING SERVICES NOTES REFER PD-CI-1005.
- REFER TO DIAL BEFORE YOU DIG SURVEY FOR DETAILS ON CONTINUATION OF SERVICES.
- CONSIDERATION MUST BE GIVEN TO THE SERVICES WORKS IN THE VICINITY OF THIS PLOT

- EXISTING SERVICES LEGEND**
- s1 150-300 SEWER MAIN
 - s2 375-450 SEWER MAIN
 - s3 525-1000 SEWER MAIN
 - s4 812x1219, 1016x1270, 1016x1778, 1300x1778 SEWER MAIN
 - sr1 375 SEWER RISING MAIN
 - sr2 600 SEWER RISING MAIN
 - s 600 DISUSED SEWER MAIN
 - w 100, 150 POTABLE WATER MAIN
 - w1 200, 225 POTABLE WATER MAIN
 - w3 250, 300 POTABLE WATER MAIN
 - w4 375, 500 POTABLE WATER MAIN
 - w5 600 POTABLE WATER MAIN
 - g GAS (UNKNOWN)
 - g1 SECONDARY MAIN 1050 kPa
 - g2 210 kPa
 - g3 7 kPa
 - g4 PROPOSED MAIN 24kPa
 - c UNKNOWN COMMUNICATIONS
 - a1 AAPT DUCT
 - a2 NON-AAPT DUCT (LIKELY FALSE)
 - n1 NEXTGEN CABLE
 - n2 NEXTGEN THIRD PARTY
 - o1 OPTUS
 - o2 OPTUS IN OTHER UTILITY'S DUCT
 - f1 TELSTRA 1-4 CONDUITS
 - f2 TELSTRA MAJOR SERVICE
 - f3 TELSTRA AERIAL CABLE
 - v1 VERIZON DUCT
 - v2 TELSTRA DUCT (LIKELY FALSE)
 - pn PIPE NETWORKS DUCT
 - e1 ELECTRICAL 1-5 CONDUITS
 - e2 ELECTRICAL 6-12 CONDUITS
 - e3 ELECTRICAL 13-20 CONDUITS
 - e4 ELECTRICAL RAILWAY CABLES
 - e5 ELECTRICAL TRANSMISSION CABLES
 - e6 ELECTRICAL 21+ CONDUITS

- STREET LIGHTING LEGEND**
- PROPOSED LIGHT WITH POLE
 - EXISTING LIGHT WITH POLE
 - EXISTING LIGHT WITH POLE TO BE REMOVED

- STORMWATER LEGEND**
- EXISTING STORMWATER TO REMAIN
 - EXISTING STORMWATER TO BE REMOVED
 - PROPOSED STORMWATER

- PROPOSED SERVICES LEGEND**
- PW SWC WATER MAIN
 - PW PRIVATE WATER MAIN
 - S SEWER MAIN
 - G GAS MAIN
 - E PERM. ELECTRICAL CONDUIT
 - TEMP TEMP. ELECTRICAL CONDUIT
 - C COMMUNICATIONS CONDUIT
 - PWR ELECTRICAL POWER CONDUIT
 - ELECTRICAL 132kV EASEMENT
 - ELECTRICAL LIGHTING
 - CCTV NETWORK
 - CCTV CAMERA FEED
 - CCTV CAMERA
 - COMMS OUTLET
 - PA SYSTEM
 - UTILITIES TO BE REMOVED
 - STAGE BOUNDARY

DARLING HARBOUR LIVE

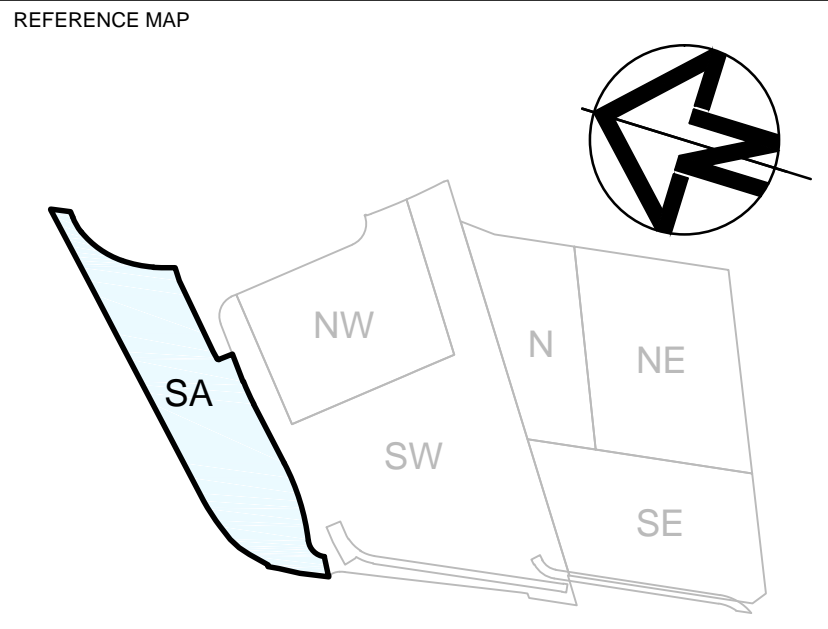

NOTES:

- DO NOT SCALE FROM DRAWINGS. USE WRITTEN DIMENSIONS ONLY.
- ALL DIMENSIONS IN MILLIMETRES UNLESS NOTED OTHERWISE.
- ALL COORDINATES TO MGA. ALL LEVELS TO AHD.
- ALL DIMENSIONS, COORDINATES AND LEVELS TO BE VERIFIED ON SITE BEFORE PROCEEDING WITH WORK. HYDER SHALL BE NOTIFIED IN WRITING OF ANY DISCREPANCIES.
- THIS DRAWING MUST BE READ IN CONJUNCTION WITH ALL RELEVANT CONTRACTS, SPECIFICATIONS AND DRAWINGS.
- THIS DRAWING CONTAINS COLOUR AND MUST ONLY BE PRINTED OR COPIED IN COLOUR.

0 5 10 15 20 25m

1 : 250

REV	DESCRIPTION	DATE
04	ISSUE FOR DEVELOPMENT APPLICATION	11/09/15
03	ISSUE FOR DEVELOPMENT APPLICATION	04/09/15
02	ISSUE FOR DEVELOPMENT APPLICATION	01/09/15
01	DRAFT ISSUE	19/08/15

CLIENT

urbanest URBANEST STUDENT ACCOMMODATION
SUITE 102, LEVEL 1, AUSTRALIA SQUARE,
PLAZA BUILDING, 95 PITT ST
SYDNEY, NSW 2000

CONSULTANTS

ASPECT Studios™
ASPECT STUDIOS
STUDIO 61, LEVEL 6, 61 MARLBOROUGH ST,
SURREY HILLS, NSW 2010

AJ+C ARCHITECT
79 MYRTLE STREET,
CHIPPENDALE NSW 2008

CIVIL / TRAFFIC / FACADES

HYDER CONSULTING PTY LTD
ABN 76 104 485 289
LEVEL 5, 141 WALKER ST,
NORTH SYDNEY NSW 2060
AUSTRALIA

Tel: +61 (0)2 8907 9000
Fax: +61 (0)2 8907 9001
www.hyderconsulting.com
© Copyright reserved

PROJECT

SICEP - DARLING HARBOUR LIVE
DARLING SQUARE
WESTERN PLOT BUILDING W1

DRAWING TITLE				
COMBINED SERVICES PLAN (ROBERT BIRD GROUP)				
STATUS				
DA APPROVAL				
SCALE @ A1	DRAWN	DESIGNED	REVIEWED	APPROVED
1 : 250	JW	JW	MAK	-
PROJECT NUMBER	DRAWING NUMBER		REV	
AA004399	PD-CI-1902		04	