

**Notice by Council to Sydney Airport**

**Pursuant to Airports (Protection of Airspace) Regulations 1996 – [Reg 8]**

**TO: Sydney Airport Corporation Ltd**

c/- Airport Design Services  
Locked Bag 5000  
Sydney International Airport  
NSW 2020  
Email: CADDServices@syd.com.au

**APPLICANT FOR DEVELOPMENT APPROVAL:** Wanda One Sydney Pty Ltd c/- Urbis Pty Ltd

Of: Wanda One Sydney Pty Ltd c/- Urbis Pty Ltd  
Contact: Ashleigh Ryan  
Phone: (02) 8235 9990  
Email: aryan@urbis.com.au

**NOTICE PURSUANT TO AIRPORT (PROTECTION OF AIRSPACE) REGULATIONS REG 8**

**1. Proposed controlled activity:**

Constructing a building that intrudes into the  
prescribed air space.

Name of Project: Sydney One

**2. Location:**

I. [No.] Alfred Street [Street/Road]  
Sydney, NSW [Suburb]

**3. If the proposed controlled activity consists of the erection of a building or structure:**

- (i) proposed max height (above Australian Height Datum) (AHD) in metres of the proposed building, structure or thing:  
Maximum building structure - RL200 (AHD)
- (ii) proposed max height (above AHD) of any temporary structure or equipment to be used in the erection of the proposed building or structure:  
Maximum crane height - RL275 (AHD)
- (iii) diagram defining footprint of development – TO BE ATTACHED
- (iv) MGA 94 co-ordinates defining outline of development:

Refer to attached plan

- (v) elevations of development in metres AHD. West elevation is RL 129.58  
North, south and east elevations is max 194m or 200 RL

4. **Purpose of the controlled activity:**

Construction of a 61 storey mixed use building

5. **Proposed safety case if the controlled activity breaches the OLS or PANS-OPS:**

Hazard beacon on crane  
Hazard beacon on upmost point of building, if required

6. **Development Application:**

Date: 20/04/2016

Reference: DA # D/2015/882/A and D/2015/1049/A

DA be attached as relevant:

**IMPORTANT NOTES**

***[Pursuant to Airports Act 1996 and Airports (Protection of Airspace) Regulations 1996]***

1. Section 182: defines "controlled activities".
2. Section 187: if a controlled activity is carried out without approval, or is carried out otherwise than in accordance with an approval, the Federal Court may order a person to carry out remedial work on a building, structure or thing; to mark it or light it or both; to reduce its height.
3. Section 183: a person who carries out a controlled activity without the approval of the Secretary (or Airport as applicable) commits an offence against section 183 of the Act.  
  
Penalty: 250 penalty units for each such offence.
4. Regulation 8: a building authority that receives a proposal for a building activity that, if undertaken, would constitute a controlled activity in relation to an airport must give notice of the proposal to the airport.  
  
Penalty: 50 penalty units for each such offence.
5. If the activity is a short term activity (less than 3 months), the Airport will determine the application pursuant to delegated authority from the Secretary.
6. If the activity is a long term activity (greater than 3 months), the Secretary will determine the application.
7. If the activity is a long term intrusion into PANS-OPS, the application will not be approved. [Reg 9].
8. The Airport will give notice of the application to, and invite submissions from, CASA and Airservices and the Building Authority concerned. [Reg 10].
9. Upon receipt of submissions from CASA and Airservices, the Airport will refer the application and any submissions from CASA and Airservices, as well as the Airport, to the Secretary or determine the application itself if it is a short term activity.  
  
The Secretary or the Airport will notify you in writing of their decision.
10. Neither the Secretary or the Airport will approve any activity if CASA advises that carrying out the activity would have an unacceptable effect on the safety of existing or future air transport operations into or out of the Airport. [Reg14(6)].



CAHILL EXPRESSWAY

ALFRED STREET

PITT STREET

REIBY PLACE

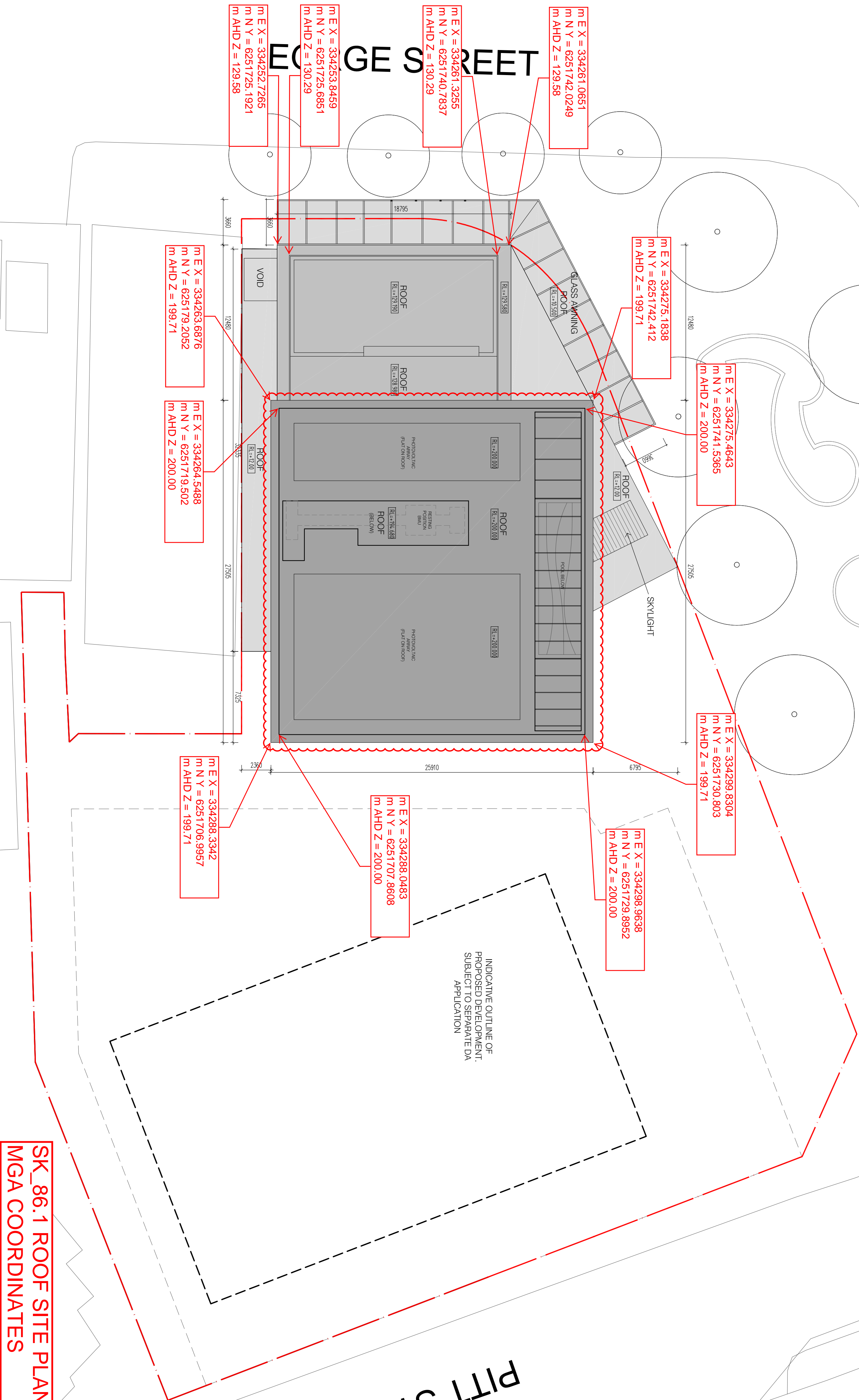

D		17/06/2015	ISSUED FOR REVISED OUTLAMENT APPLICATION	CLIENT		ARCHITECT	PROJECT	SCALE	DRAWING TITLE
C		21/03/2015	ISSUED FOR COMPLIANCE OF DA CONDITIONS	WANDA ONE SYDNEY PTY LTD		Kerry Hill Architects			
B		08/11/2011	ISSUED FOR REVISED APPLICATION	LEVEL 19, 1 ALFRED ST		30 Mount Street, Fremantle, WESTERN AUSTRALIA 6160	SYDNEY 1 PROJECT	1:200 @ A1	ROOF SITE PLAN
A		22/11/2010	ISSUED FOR APPLICATION	SYDNEY NSW 2000		TEL +61 8 9336 4545 FAX +61 8 9336 4546 admin_park@kerryhillarchitects.com			
REV.		DATE	AMENDMENT	PROJECT		ARCHITECT	SYDNEY 1 PROJECT	(1:400 @ A3)	DRAWING NUMBER
REV.		DATE	AMENDMENT	PROJECT		ARCHITECT			
D		17/06/2015	ISSUED FOR REVISED OUTLAMENT APPLICATION	WANDA ONE SYDNEY PTY LTD		Kerry Hill Architects	SYDNEY 1 PROJECT	1:200 @ A1	ROOF SITE PLAN
C		21/03/2015	ISSUED FOR COMPLIANCE OF DA CONDITIONS	LEVEL 19, 1 ALFRED ST		30 Mount Street, Fremantle, WESTERN AUSTRALIA 6160			
B		08/11/2011	ISSUED FOR REVISED APPLICATION	SYDNEY NSW 2000		TEL +61 8 9336 4545 FAX +61 8 9336 4546 admin_park@kerryhillarchitects.com	SYDNEY 1 PROJECT	(1:400 @ A3)	DRAWING NUMBER
A		22/11/2010	ISSUED FOR APPLICATION	SYDNEY NSW 2000		TEL +61 8 9336 4545 FAX +61 8 9336 4546 admin_park@kerryhillarchitects.com			
REV.		DATE	AMENDMENT	PROJECT		ARCHITECT	SYDNEY 1 PROJECT	(1:400 @ A3)	DRAWING NUMBER
REV.		DATE	AMENDMENT	PROJECT		ARCHITECT			

