

Job Number: 152182

16 September 2016

Level 11, 345 George Street, Sydney NSW 2000

T (02) 9241 4188 F (02) 9241 4324

E sydney@northrop.com.au    ABN 81 094 433 100

**Mr Simon Karkkainen**

Richard Crookes Constructions Pty Ltd

PO Box 1024

CROWS NEST NSW 1585

Dear Simon,

**RE: SSD\_7054: LEES 1 Building, Condition 9 – Stormwater Management Strategy**  
**LEES1 Building, Sydney University**

In response to Condition 9, the flood levels have been provided as per the civil stormwater report dated on: 16 March 2016.

The finished floor levels are required to be 500mm above the levels as specified i.e. FFL 35.70 at entrances' to the western side, FFL31.80 on the eastern (Barff Rd) side, thus complies with the City of Sydney's Interim Floodplain Management Policy.

With respect to the water quantity, since the issue of the report, the stormwater strategy has changed in that we are now discharging to the Council/ Sydney Water system in City Road rather than the University of Sydney's downstream network. We are required to comply with parameters that Sydney Water has sent is in terms of OSD volume (37m3) and PSD (47L/s).

The proposed building development is located upon a highly constrained site, bound by an existing University building to the north, Barff Road to the east and existing landscaped areas and City Road to the south. Due to the relatively small increase in impervious area in the developed case when compared to the existing scenario, it is proposed that the water quality treatment requirements of the site be assessed of a merits based approach.

On this basis, water quality treatment systems will be provided to reduce the pollutant runoff from the site in best efforts to achieve targets as stated in City of Sydney's DCP 2012. MUSIC modelling showing details of such water quality devices and pollutant removal results can be provided upon request.

I trust the above information is satisfactory in clarifying the condition as stated above.

Feel free to contact me if any further information is required.

Yours faithfully

Mert

Matthew Lester

Civil Engineer

**Northrop Consulting Engineers**

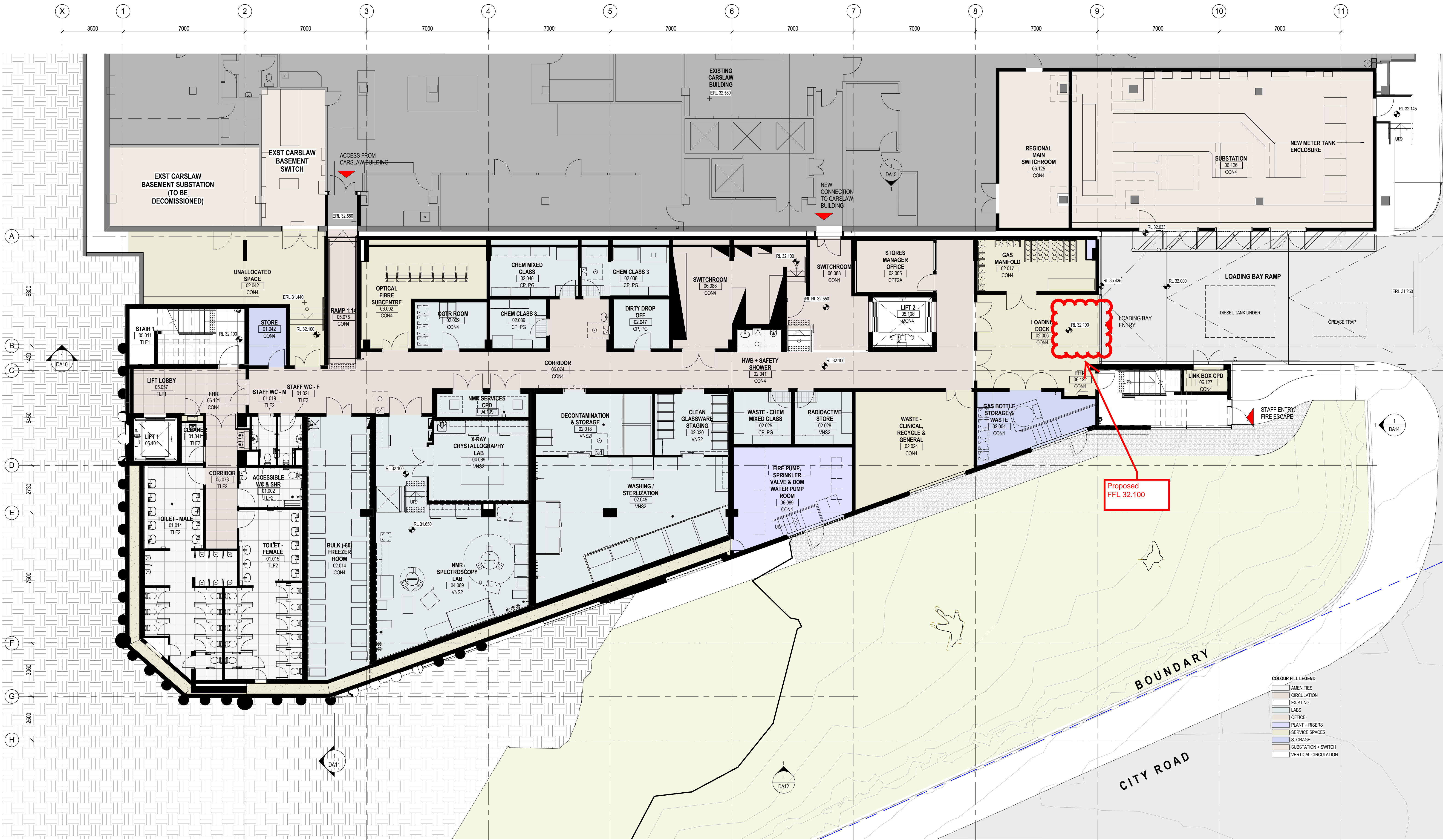

9/16/2016 11:38:11 AM	FOR INFORMATION	MS	13.09.2016	1m
REV	DESCRIPTION OF CHANGE	CHKD	DATE	10m A1

CONSULTANT	ESD Consultant	Mechanical Engineer
Access Consultant	JHA Consulting Engineers	JHA Consulting Engineers
Code Compliance	8 M + G Pty Ltd	Plumbing Engineer
Comm/Security Engineer	JHA Consulting Engineers	Surface Design Consult. Pty Ltd
Electrical Engineer	JHA Consulting Engineers	Fire Engineer
		Defire Pty Limited
		Structural Engineer
		Northrop Engineers Pty Ltd
		Landscape Architects
		OCCULUS Pty Ltd

CLIENT	RICHARD CROOKES CONSTRUCTIONS	THE UNIVERSITY OF SYDNEY
--------	-------------------------------	--------------------------

ARCHITECTS	HDR	RICE DAUBNEY
Level 1, 110 Walker Street, North Sydney NSW 2060, Australia		
+61 2 9956 2666   hdr@ricedaubney.com   hdnrc.com		

PROJECT	LEES1 BUILDING (F07) THE UNIVERSITY OF SYDNEY CITY ROAD, CAMPERDOWN
PROJECT NUMBER	271821_19H

DRAWING TITLE	PLAN LEVEL 01	SCALE	1 : 100 @ A1	CHECKED	MS	DATE	13.09.2016
CONTRACT NUMBER	TBC	DRAWING NUMBER	HDR-AR-DWG-DA01	ISSUE	G		
THIS DOCUMENT IS THE PROPERTY OF THE RICE DAUBNEY GROUP (NSW) PTY LTD. ALL INFORMATION ILLUSTRATED ON THIS DOCUMENT IS TO BE CHECKED AND VERIFIED ON SITE. IN THE EVENT OF DISCREPANCIES REFER TO ARCHITECT PRIOR TO COMMENCEMENT OF THE WORK. DO NOT SCALE DRAWINGS MANUALLY OR ELECTRONICALLY.							



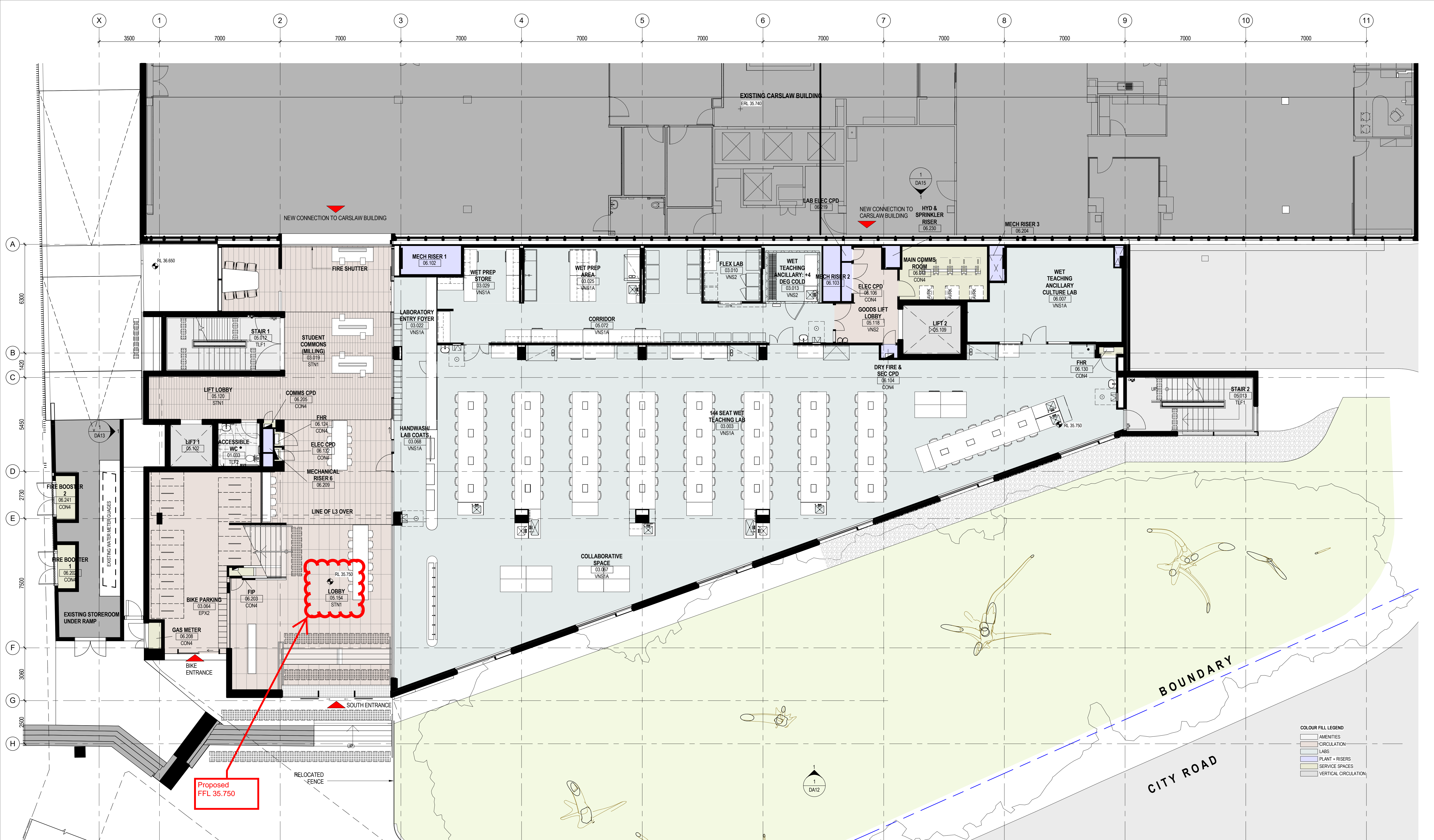

9/10/2016 4:25:22 PM		FOR INFORMATION		MS	13.09.2016			<div>CONSULTANT</div> <div>Access Consultant Cheung Access Code Compliance B.M + G Pty Ltd Comma/Security Engineer JHA Consulting Engineers JHA Consulting Engineers</div> <div>ESD Consultant JHA Consulting Engineers Plumbing Engineer Surface Design Consult. Pty Ltd Fire Engineer Defire Pty Limited Landscape Architects OCCULUS Pty Ltd</div> <div>Mechanical Engineer JHA Consulting Engineers Facade Engineer JHA Consulting Engineers Structural Engineer Northrop Engineers Pty Ltd</div>		<div>CLIENT</div> <div>RICHARD CROOKES CONSTRUCTIONS</div> <div></div> <div>THE UNIVERSITY OF SYDNEY</div> <div>Level 1, 110 Walker Street, North Sydney NSW 2060, Australia +61 2 9956 2666   <a href="http://hdriceadubney.com">hdriceadubney.com</a>   <a href="http://hdrinc.com">hdrinc.com</a></div>		<div>ARCHITECTS</div> <div></div> <div>RICE DAUBNEY</div> <div>Level 1, 110 Walker Street, North Sydney NSW 2060, Australia +61 2 9956 2666   <a href="http://hdriceadubney.com">hdriceadubney.com</a>   <a href="http://hdrinc.com">hdrinc.com</a></div>		<div>PROJECT</div> <div>LEES1 BUILDING (F07) THE UNIVERSITY OF SYDNEY CITY ROAD, CAMPERDOWN</div> <div>PROJECT NUMBER 271821_15H</div>		<div>DRAWING TITLE</div> <div>PLAN LEVEL 02</div>		<div>SCALE</div> <div>1 : 100 @ A1</div> <div>CHECKED</div> <div>MS</div> <div>DATE</div> <div>13.09.2016</div>		<div>CONTRACT NUMBER</div> <div>TBC</div> <div>DRAWING NUMBER</div> <div>HDR-AR-DWG-DA02</div> <div>ISSUE</div> <div>G</div>		<div>THIS DOCUMENT IS THE COPYRIGHT OF THE RICE DAUBNEY GROUP (NSW) PTY. LTD. ALL INFORMATION ILLUSTRATED ON THIS DOCUMENT IS TO BE CHECKED AND VERIFIED ON SITE. IN THE EVENT OF DISCREPANCIES REFER TO ARCHITECT PRIOR TO COMMENCEMENT OF THE WORK. DO NOT SCALE. DRAWINGS MANUALLY OR ELECTRONICALLY.</div>	
----------------------	--	-----------------	--	----	------------	--	--	---	--	--	--	---	--	--	--	---	--	---	--	--	--	--	--