

SITE PHOTOS



SITE 53 FROM FIGTREE DRIVE
Looking East onto Site 53, 2 Figtree Drive, with Australia Towers in the back-ground



EXISTING FIG TREES ON SITE
The two existing fig trees on the North-East corner of the site.



1 FIGTREE DRIVE
The neighbouring building to the north of the site



LOOKING NORTH UP AUSTRALIA AVENUE
Site 53 on the left obscured by trees, with the rail and pedestrian overpass crossing Australia Avenue.



LOOKING WEST INTO LINEAR PARK
Existing landscaping and footpath of the linear park along the southern boundary of the site.



4 FIGTREE DRIVE
The existing Fujitsu Australia building neighbouring to the west of the site



SITE ANALYSIS

SITE ANALYSIS PLAN

ISSUE B

SITE ANALYSIS

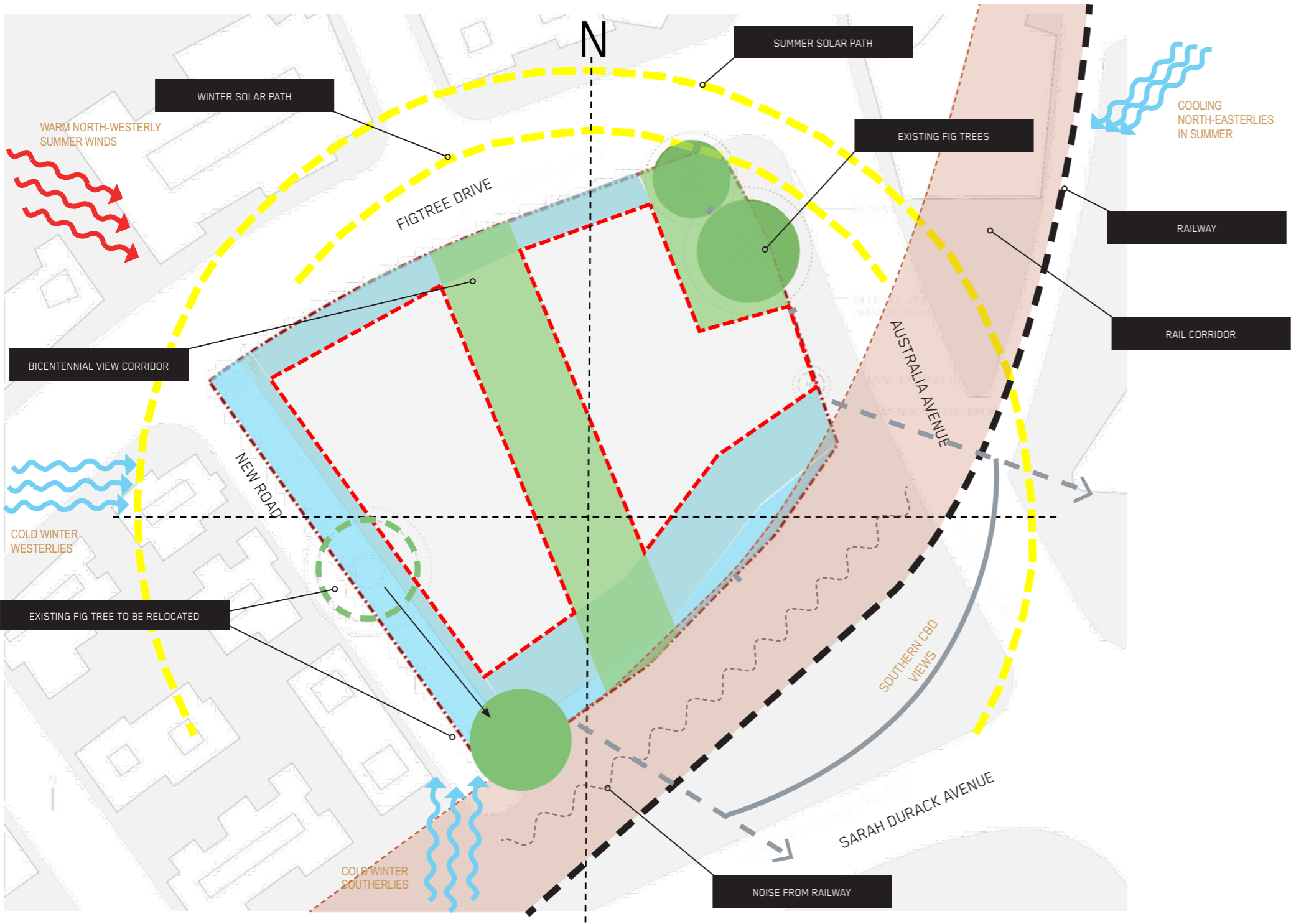

SITE ANALYSIS
Plan demonstrating solar paths, view corridor and surrounding infrastructure

MASSING STUDIES

Below are massing study options based on SEPP 65 and SOPA masterplan 2030 controls showing the variations of built form considered during the design process. The design studies try to balance a built form that complies with the relevant controls while responding to the future streetscape character of the area and creating a sense of place for the residents.

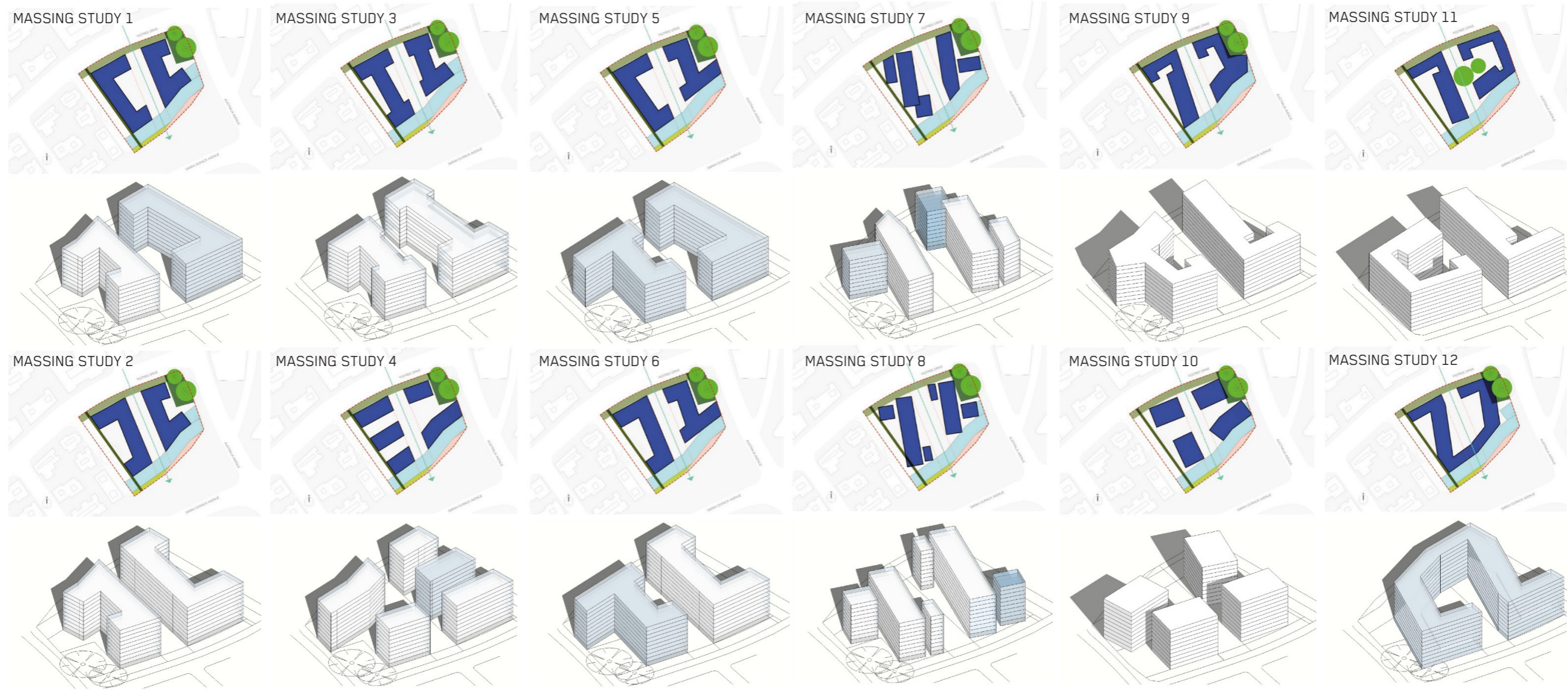



COMPETITION SCHEME