

KEY

North Plot + The Square DA Boundary

Darling Square (DS) Boundary

Minimum 2.5m wide pedestrian walkway

Minimum 2m wide pedestrian walkway

Accessible stair

Step ramp

Walkway 1:21 grade

Flexible circulation

Proposed levels

Building Lobby Locations

NOTE: LEVELS ARE INDICATIVE & SUBJECT TO DESIGN DEVELOPEMENT

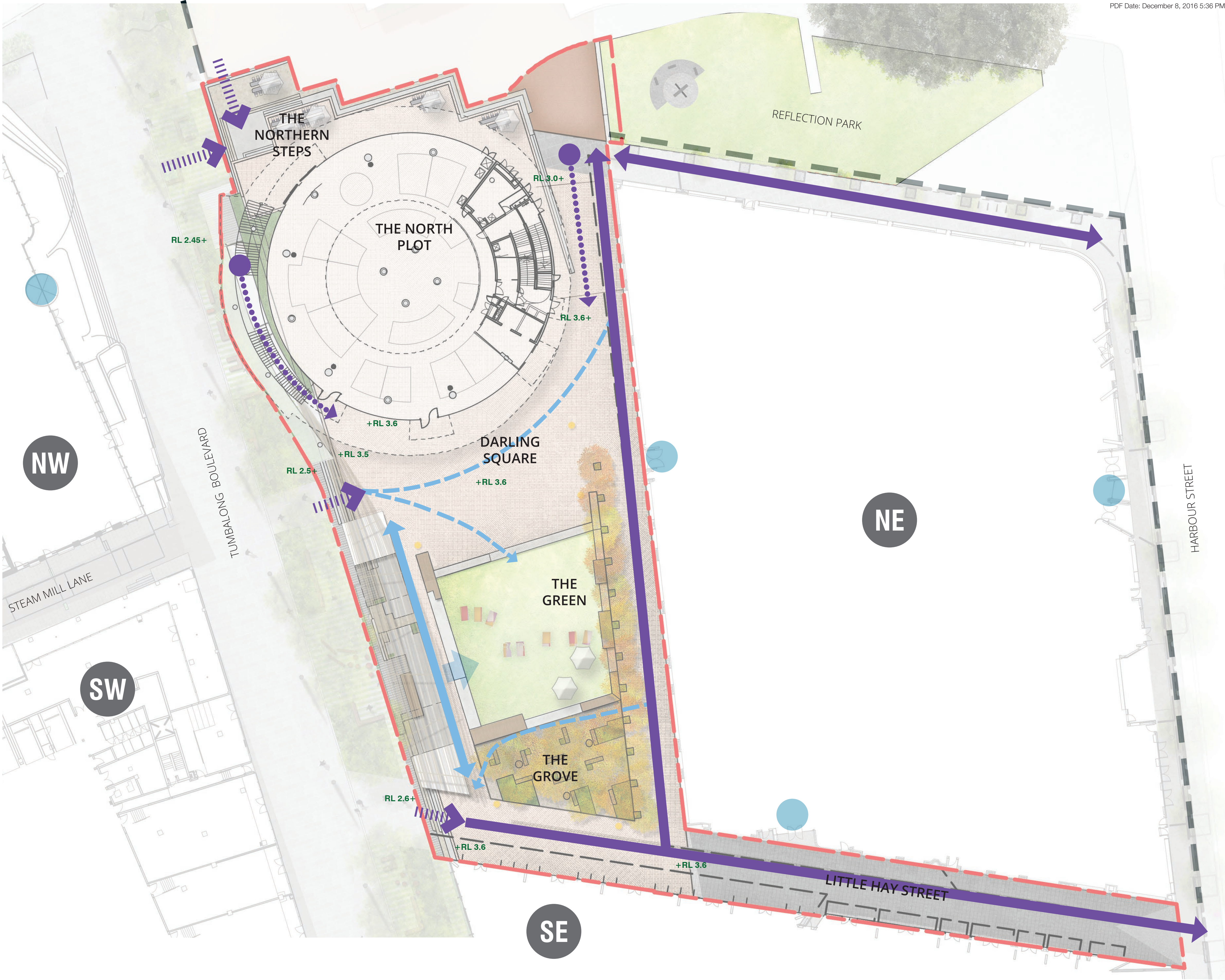

KEY

North Plot + The Square DA Boundary

Darling Square (DS) Boundary

NOTE: SPECIES SELECTION SUBJECT TO AVAILABILITY

Botanic Name	Common Name	Estimated pot size	Native/ Exotic
New planting trellising up the Canopy structure			
<i>Bougainvillea glabra</i>	Bougainvillea	200mm	exotic
<i>Pandorea jasminoides</i>	Bower of Beauty	200mm	Native
<i>Pandorea pandorana</i>	Wonga Wonga Vine	200mm	Native



Botanic Name	Common Name	Area (m²)	Native/ Exotic
New Turf			
<i>Pennisetum clandestinum</i>	Kikuyu village green	446	exotic

Botanic Name	Common Name	Quantity	Estimated Pot Size	Native/ Exotic
New Trees				
<i>Zelkova serrata</i>	Japanese Elm	21	800L	exotic
Low shrubs and groundcovers				
<i>Alternanthera dentata</i>	Ruby Leaf Alternanthera		300mm	exotic
<i>Convolvulus cneorum</i>	Silverbush		200mm	exotic
<i>Dichondra 'Silver Falls'</i>	Silver Falls		200mm	exotic
<i>Ozothamnus diosmifolius</i>	Rice Flower		200mm	native
<i>Lomandra 'Tanika'</i>	Spiny Headed Mat Rush		300mm	native
<i>Loropetalum chinense</i>	Chinese Fringe Flower		300mm	exotic
<i>Poa labillardierei</i>	Tussock Grass		200mm	native



Botanic Name	Common Name	Estimated Pot Size	Native/ Exotic
Low Shrubs and Groundcovers			
<i>Acanthus mollis</i>	Bears Breeches	200mm	exotic
<i>Alpinia caerulea</i>	Native Ginger	300mm	native
<i>Viola hederacea</i>	Native Violet	200mm	native
<i>Cissus antarctica</i>	Kangaroo vine	200mm	native
<i>Calathea zebrina</i>	Zebra Plant	300mm	exotic
<i>Arthropodium cirratum</i>	New Zealand Rock Lily	300mm	exotic
<i>Pachysandra terminalis</i>	Japanese pachysandra	200mm	exotic
<i>Sansevieria trifasciata</i>	Mothers in Laws Tongue	200mm	exotic
<i>Helichrysum petiolare</i>	Silver Bush	200mm	exotic

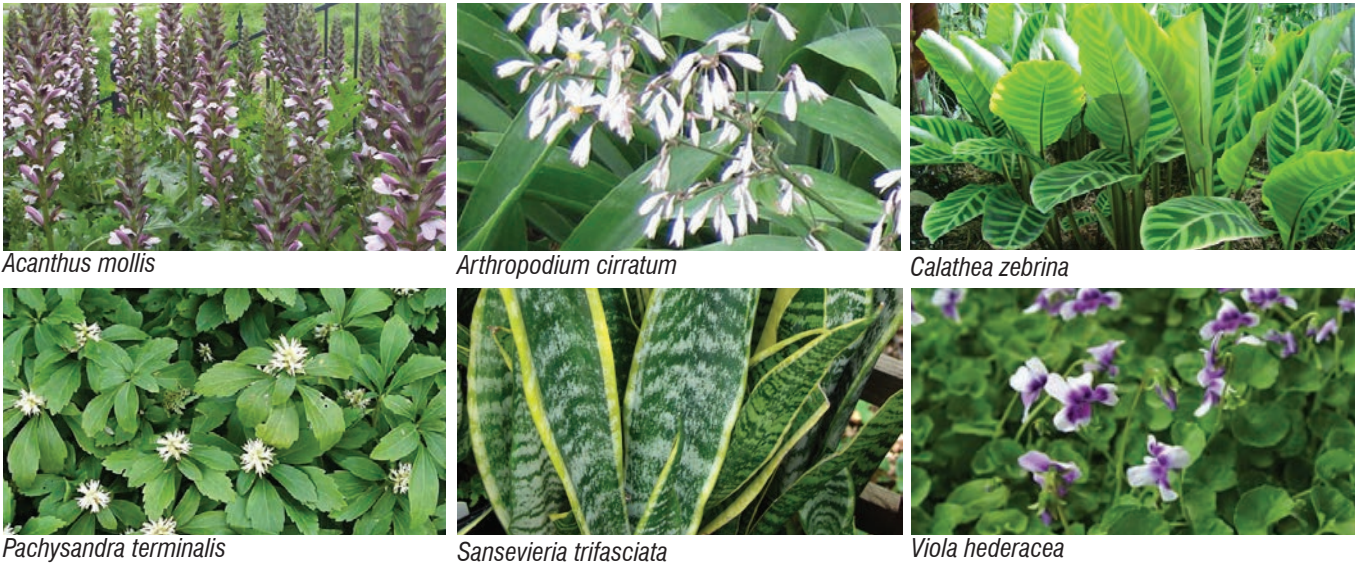

Darling Square, SSDA10 (RTS)

ASPECT Studios™

PLANTING PRINCIPLES

THE CANOPY

- Climbing species that complement architectural form without obscuring viewlines
- Provide seasonal colour and interest
- Species that prefer full sun and will provide additional shade to the surrounding seating and retail pod areas

THE GREEN

- Hard-wearing turf species to provide passive recreation opportunities

THE GROVE

- Vase to broad-domed deciduous trees provide summer shade and allow winter sun + also create seasonal interest
- Clear trunk to allow passive surveillance and retain views to retail tenancies across space
- Low under-planting to define intimate seating spaces whilst facilitating passive surveillance across space
- Species palette tolerant of variable seasonable solar access, including hot summer sun
- Opportunity for annual plantings of food plants or colour interest flowers

NORTH WEST PLOT STAIRS + ACCESS RAMP

- Layered, shade tolerant planting to soften plinth edge under stairs and provide lush, green backdrop to access ramp
- Opportunity for heritage interpretation through native bush tucker planting
- Colour interest through variable foliage and flowers

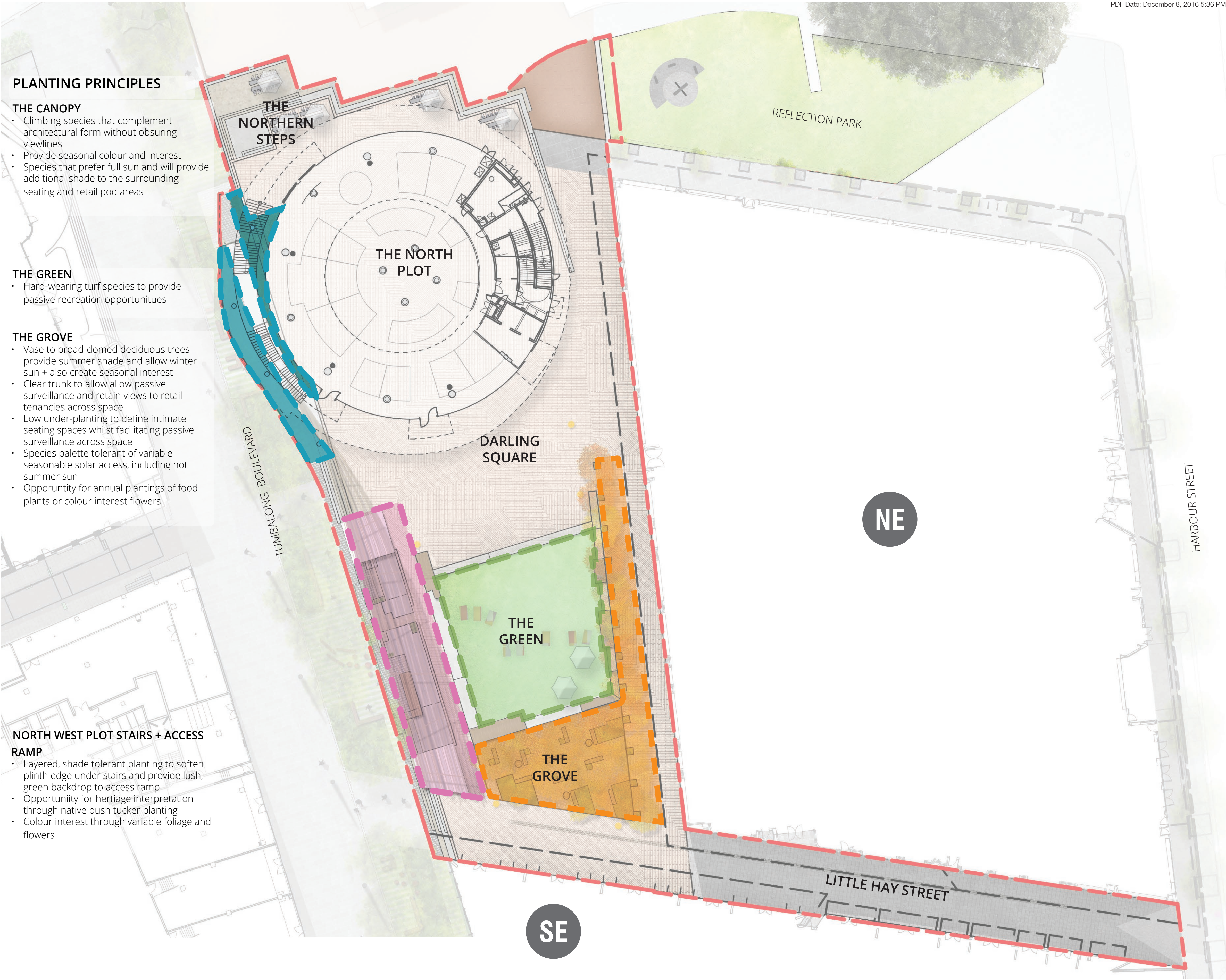

NORTH PLOT AND DARLING SQUARE PLANTING STRATEGY

Client: Lendlease

Lendlease

Drawn: LB/RD
Checked: LN/SC/LP

Scale: 1:250 @ A1
Date: 1:500 @ A3
November 2016



Dwg no.: 14076-SSDA10(RTS)-11
Rev: A

KEY

North Plot + The Square DA Boundary

Darling Square (DS) Boundary



LINEAR SEATING EDGE

- Timber with steel and concrete base.
- Generous in width, double sided, with backrests and armrests at key locations.



SEATING EDGE

- Refined warm stone bleacher edge with 'floating' timber seating decks.



THE GROVE SEATING

- Playful detailing and form.
- Timber and steel.
- Suited to pairs, individuals and small groups.



NORTHERN STEPS

- Generous terraces for flexible seating.
- Solid, large furniture planes, of warm materiality



FIXED PUBLIC SEATING + UMBRELLAS

- Generous terraces for flexible seating.
- Solid, large furniture planes
- Fixed umbrellas



BIKE PARKING

- Steel hoops.



RETAIL SEATING AREAS

- Moveable furniture including tables and seating, that can be packed up and put away at close of business.



RETAIL SEATING AREAS

(subject to separate future approval)

- Moveable furniture including tables and seating, that can be packed up and put away at close of business.

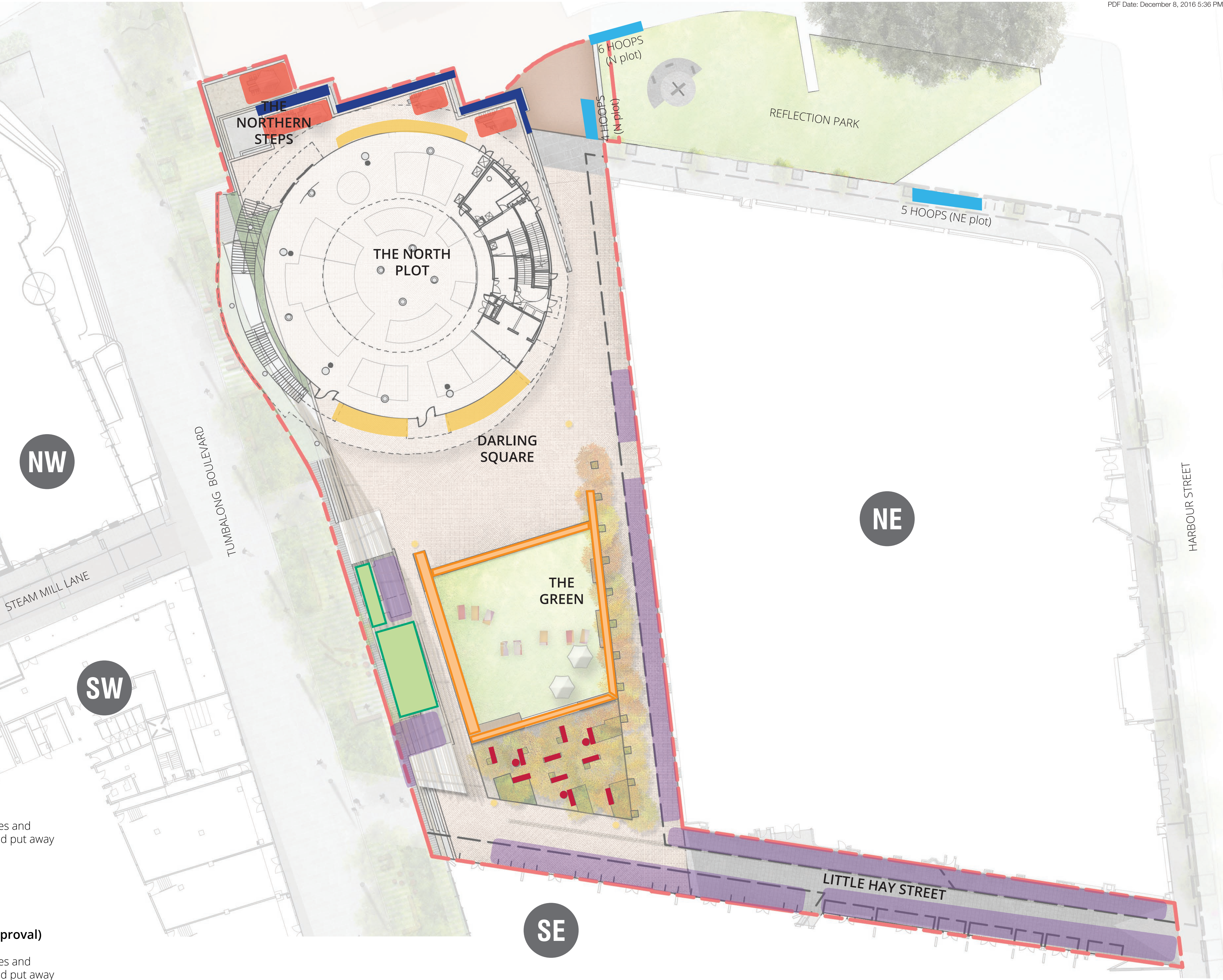

KEY

- North Plot + The Square DA Boundary
- Darling Square (DS) Boundary
- Circulation
- 21 x 3x3m Market Stalls
- Information stall (3x3m)
- Service vehicles bump in bump out
- Public Toilets (under Pier St)
- GPO (3 phase)

NOTE: LOCATIONS OF GPOS + BINS SUBJECT TO DESIGN DEVELOPEMENT

WEEKEND MARKET

DESCRIPTION	Varying size arrangement of market stalls (eg. for locally farmed produce, designers market, hobby trade fare etc.)
CAPACITY	1050 (1.4msq p/p) - 1650 (0.9sqm p/p)
SIZE (SQM)	1500
FREQUENCY	Daily to Weekly
HOURS OF OPERATION	8am - 2pm public. Bump in 6am-8am, Bump out 2-4pm.
SERVICING	Truck access via Tumbalong Boulevard
UTILITY SERVICES	GPO (SINGLE + 3 PHASE) GAS HYDRAULIC

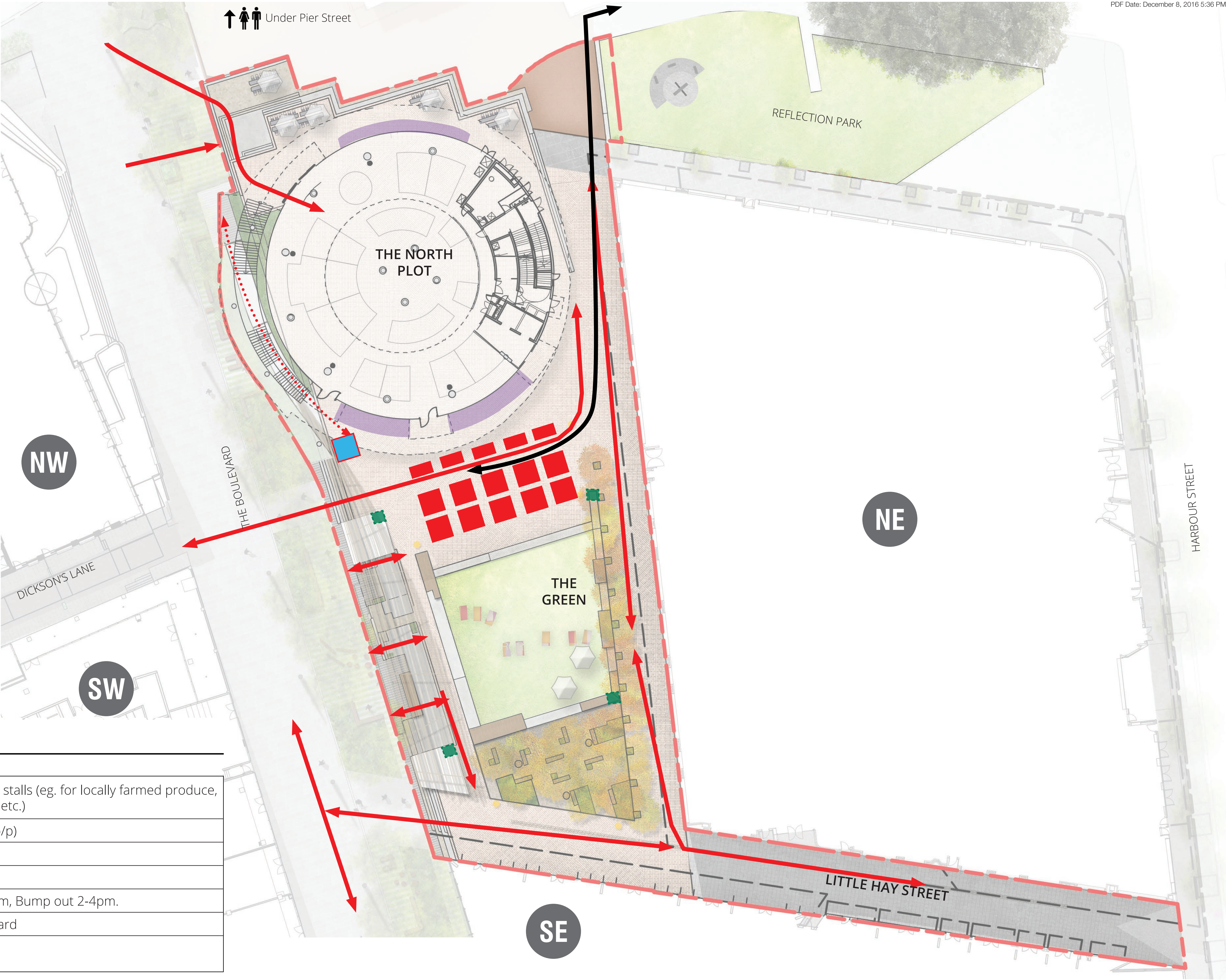

KEY

- North Plot + The Square DA Boundary
- Darling Square (DS) Boundary
- Circulation
- Audience area
- Service vehicles bump in bump out
- Public Toilets (under Pier St)
- GPO (3 phase)

NOTE: LOCATIONS OF GPOS + BINS SUBJECT TO DESIGN DEVELOPEMENT

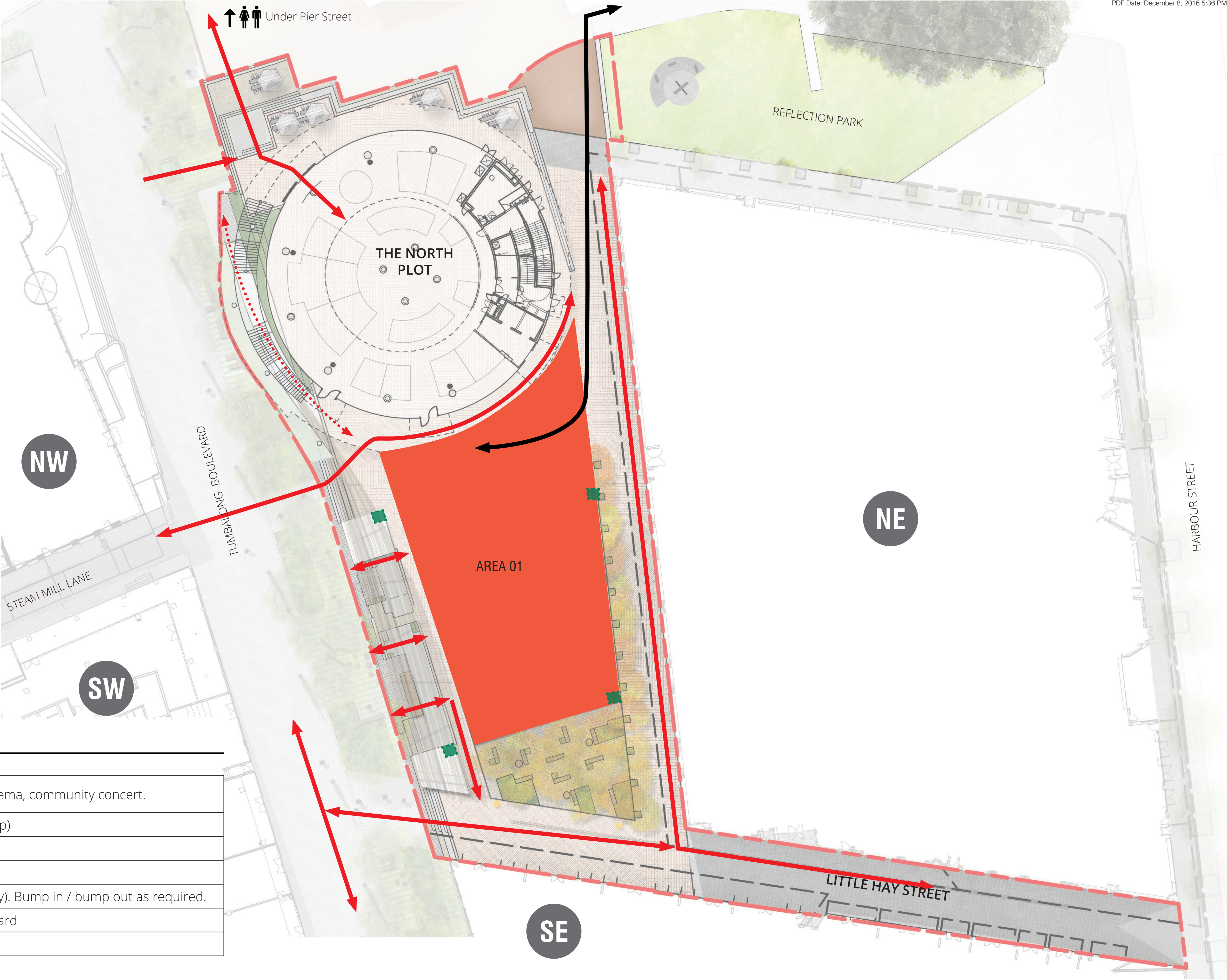

LARGE EVENT

DESCRIPTION	Large event such as community cinema, community concert.
CAPACITY	Area 01: 1040-670 (0.9 - 1.4sqm p/p)
SIZE (SQM)	Area 01: 935
FREQUENCY	2-3 times a year.
HOURS OF OPERATION	6pm-11pm (evening). 9am-4pm (day). Bump in / bump out as required.
SERVICING	Truck access via Tumbalong Boulevard
UTILITY SERVICES	3 PHASE GPO

KEY

North Plot + The Square DA Boundary

Darling Square (DS) Boundary

Circulation

Audience area

Service vehicles bump in bump out

GPO (3 phase)

Public Toilets (under Pier St)

NOTE: LOCATIONS OF GPOS + BINS SUBJECT TO DESIGN DEVELOPEMENT

MEDIUM-SCALE EVENT

DESCRIPTION	Medium event such as acoustic music, community concert.
CAPACITY	Area 01: 470-305 (0.9 -1.4sqm p/p)
SIZE (SQM)	Area 01: 475
FREQUENCY	5-6 times a year.
HOURS OF OPERATION	6pm-10pm (evening). 9am-12pm, 12pm-3pm (day). Bump in / bump out as required.
SERVICING	Truck access via Tumbalong Boulevard
UTILITY SERVICES	3 PHASE GPO

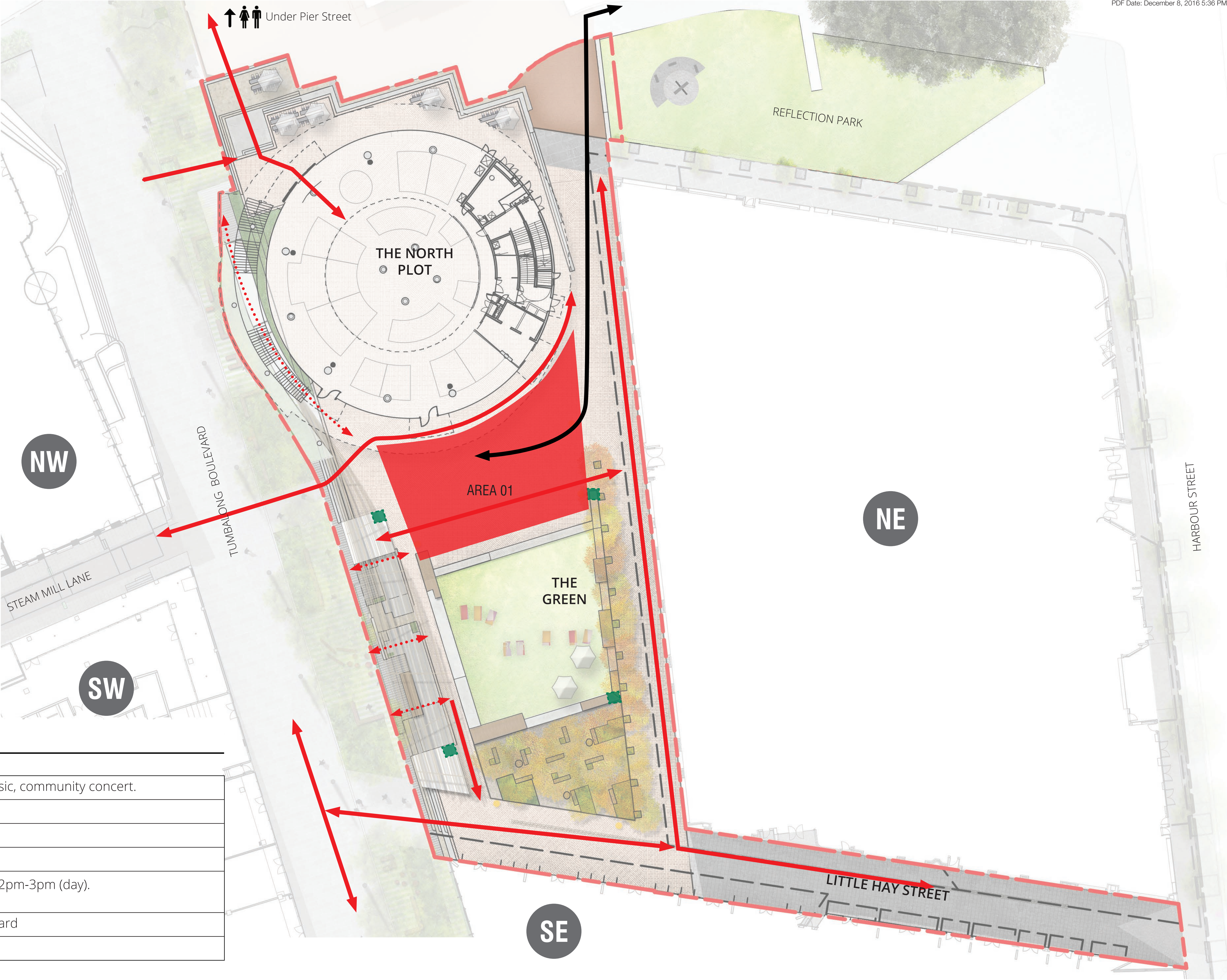

KEY

- North Plot + The Square DA Boundary
- Darling Square (DS) Boundary
- GPO (single phase)
- GPO (3 phase)
- Bins
- Drinking Fountain

NOTE: LOCATIONS OF GPOS + BINS SUBJECT TO DESIGN DEVELOPEMENT

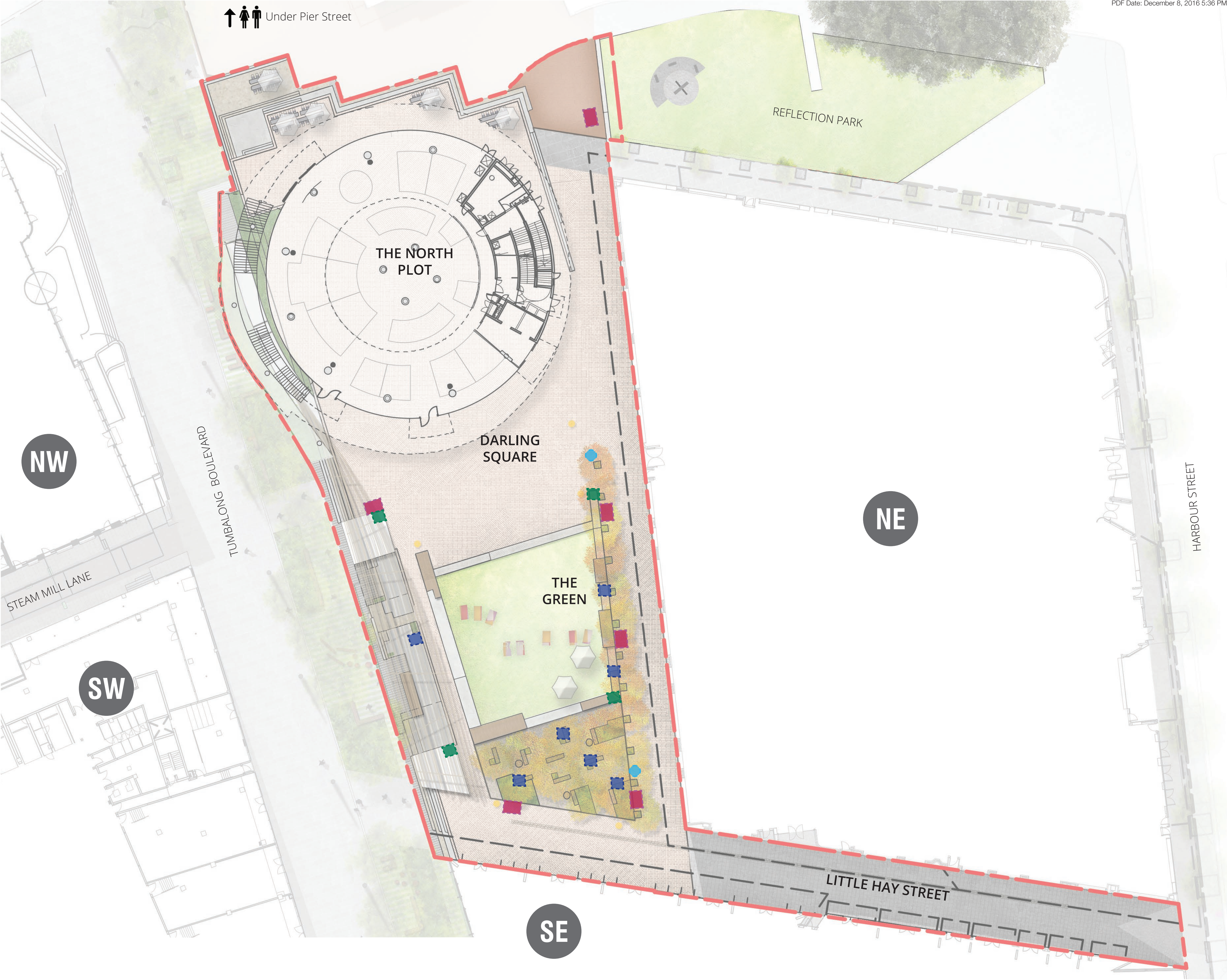

KEY

North Plot + The Square DA Boundary

Darling Square (DS) Boundary

1. GATHERING COCKLES



- An Indigenous camp near cockle bay, 1812 Passeig de Saint Joan, Barcelona. Interpretive Boulevard planting.
- Local plant species celebrate the natural realm of Darling Harbour prior to European settlement.
 - Paving inlays will enhance the aforementioned themes.

2. STEAMING AHEAD

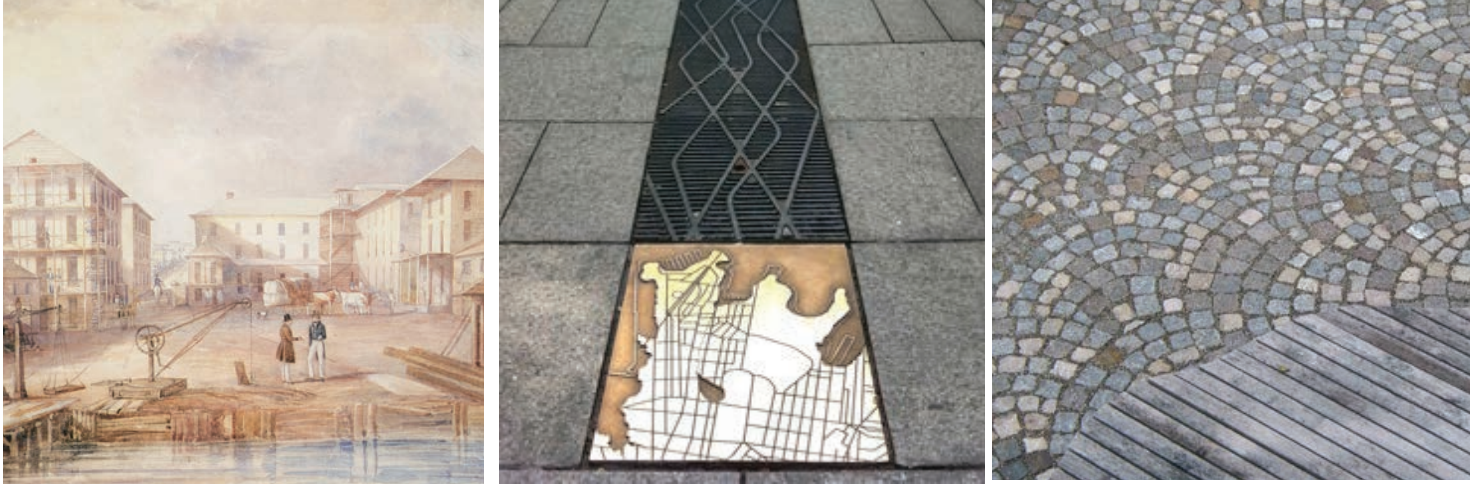

- Albion Mills, 1841, Frederick Garling. Pitt St Mall inlay detail. Paving interpretation
- Paving inlays will allude to the former location of Dickson's millpond dam wall.

3. SKILL, SWEAT AND TOIL



- Cold room at Mort & Co., 1876 Delivery of Chubb Safe, 1820 Memory Lines, 2004, Ingrid Skirka.
- The existing memorial to workers killed at work (Memory Lines, 2004 by Ingrid Skirka), and its accompanying interpretative plaques will remain.

4. THE MARKETPLACE



- Sydney markets, 1900 Haymarket, 1930 Indicative market stall demarcation.
- The proposed Darling Exchange, which is devoted to community use, includes a market on its ground floor remembering the Producer's Market of the 1930s.
 - The Market Square weekend markets will recall the area's historical narratives of trade and exchange.

5. MIGRATION



- Migrants arriving, 1853, Thomas Picker. Chinese migrants, 1938 Neon Lane, Melbourne.
- The ethnic and cultural diversity in Sydney will be interpreted in Little Hay Street.

Darling Square, SSDA10 (RTS)

ASPECT Studios™



NORTH PLOT AND DARLING SQUARE OPPORTUNITIES FOR HERITAGE INTERPRETATION

Client: Lendlease

lendlease

Drawn: LB/RD
Checked: LN/SC/LP

Scale: 1:500 @ A1
Date: 1:1000 @ A3
November 2016

0 10 20 30 40m



Dwg no.: 14076-SSDA10(RTS)-17
Rev: A

KEY

North Plot + The Square DA Boundary

Darling Square (DS) Boundary

- 1 The Exchange Building
- 2 Steam Mill Lane outdoor gallery
- 3 Little Hay Street
- 4 Interpretive Ground Treatment

PRECEDENTS



The Exchange
KKAA | artist's impression

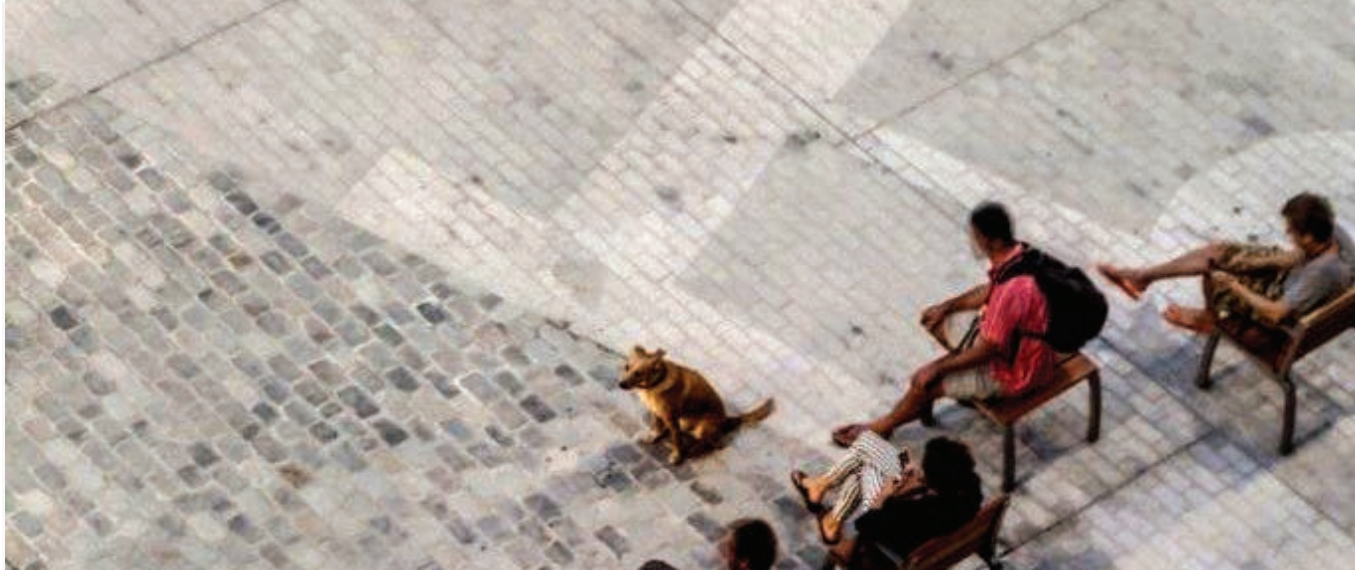

Interpretive ground treatment: poetic, historical, wayfinding
Mercado del Born Square



Little Hay Street: eclectic, intriguing, delightful
Light Rain | Peter Kennedy

NOTE: Subject to separate approval



Darling Square, SSDA10 (RTS)

ASPECT Studios™

NORTH PLOT AND DARLING SQUARE PUBLIC ART STRATEGY

Client: Lendlease



Drawn: LB/RD
Checked: LN/SC/LP

Scale: 1:500 @ A1
1:1000 @ A3
Date: November 2016



Dwg no.: 14076-SSDA10(RTS)-18
Rev: A

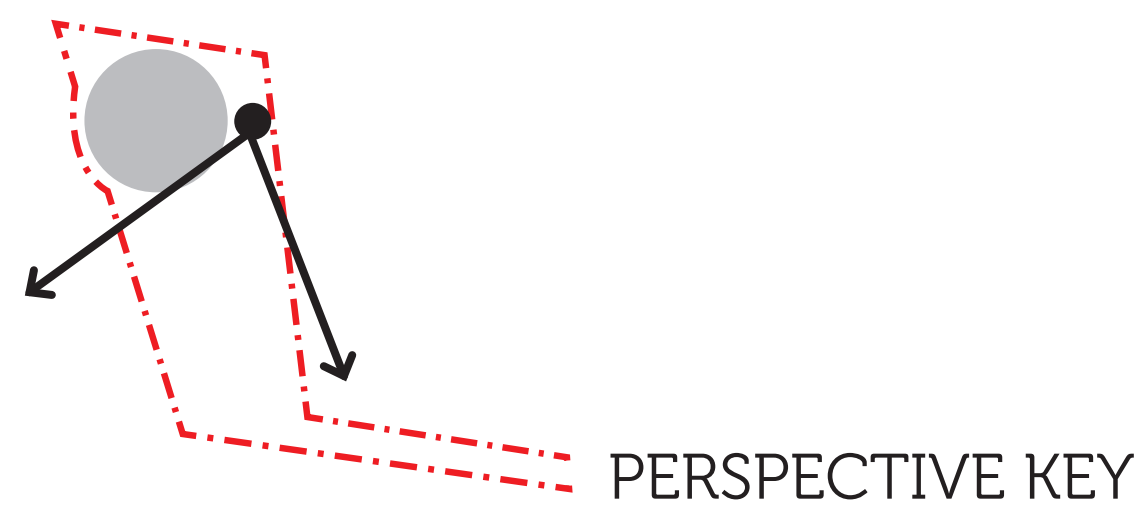

Darling Square, SSDA10 (RTS)

ASPECT Studios™

Client: **Lendlease**



Drawn: **LB/RD**
Checked: **LN/SC/LP**

Scale: **NTS**
Date: **November 2016**

Dwg no.: **14076-SSDA10(RTS)-19**
Rev: **A**

NORTH PLOT AND DARLING SQUARE
PERSPECTIVE 1 - LOOKING SOUTH TO THE SOUTH EAST AND SOUTH WEST PLOT

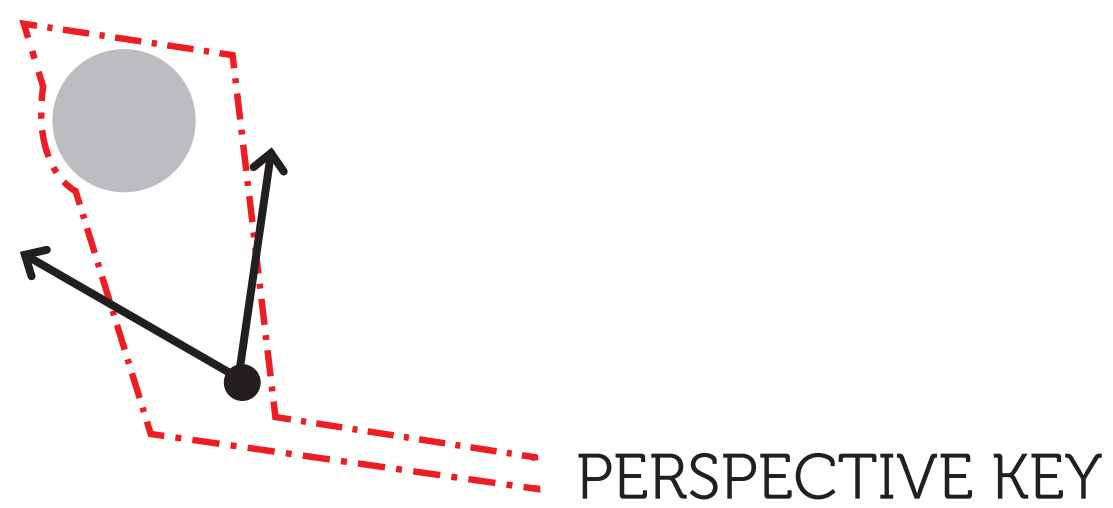

Darling Square, SSSDA10 (RTS)
ASPECT Studios™

NORTH PLOT AND DARLING SQUARE
PERSPECTIVE 2 - LOOKING NORTH TO THE NORTH PLOT

Client: Lendlease



Drawn: LB/RD
Checked: LN/SC/LP

Scale: NTS
Date: November 2016

Dwg no.: 14076-SSDA10(RTS)-20
Rev: A