

SECTION KEY

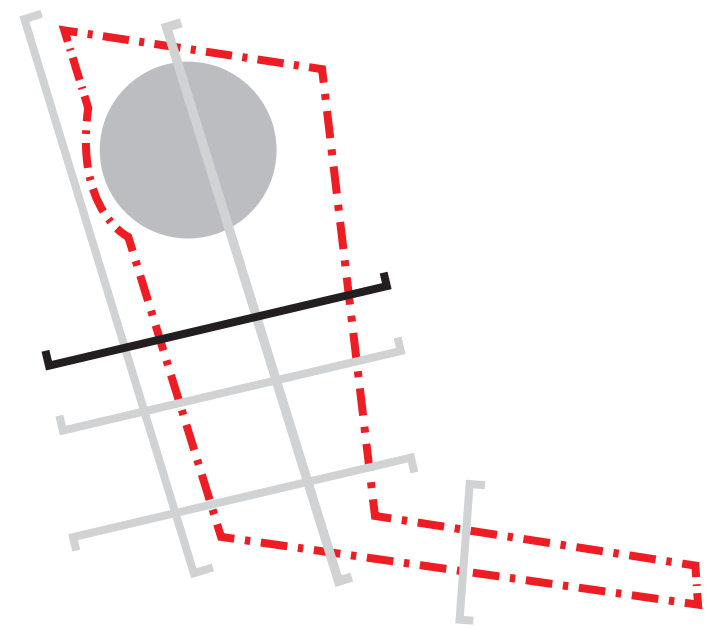

NOTE: LEVELS ARE INDICATIVE & SUBJECT TO DESIGN DEVELOPMENT

SW

N

NE

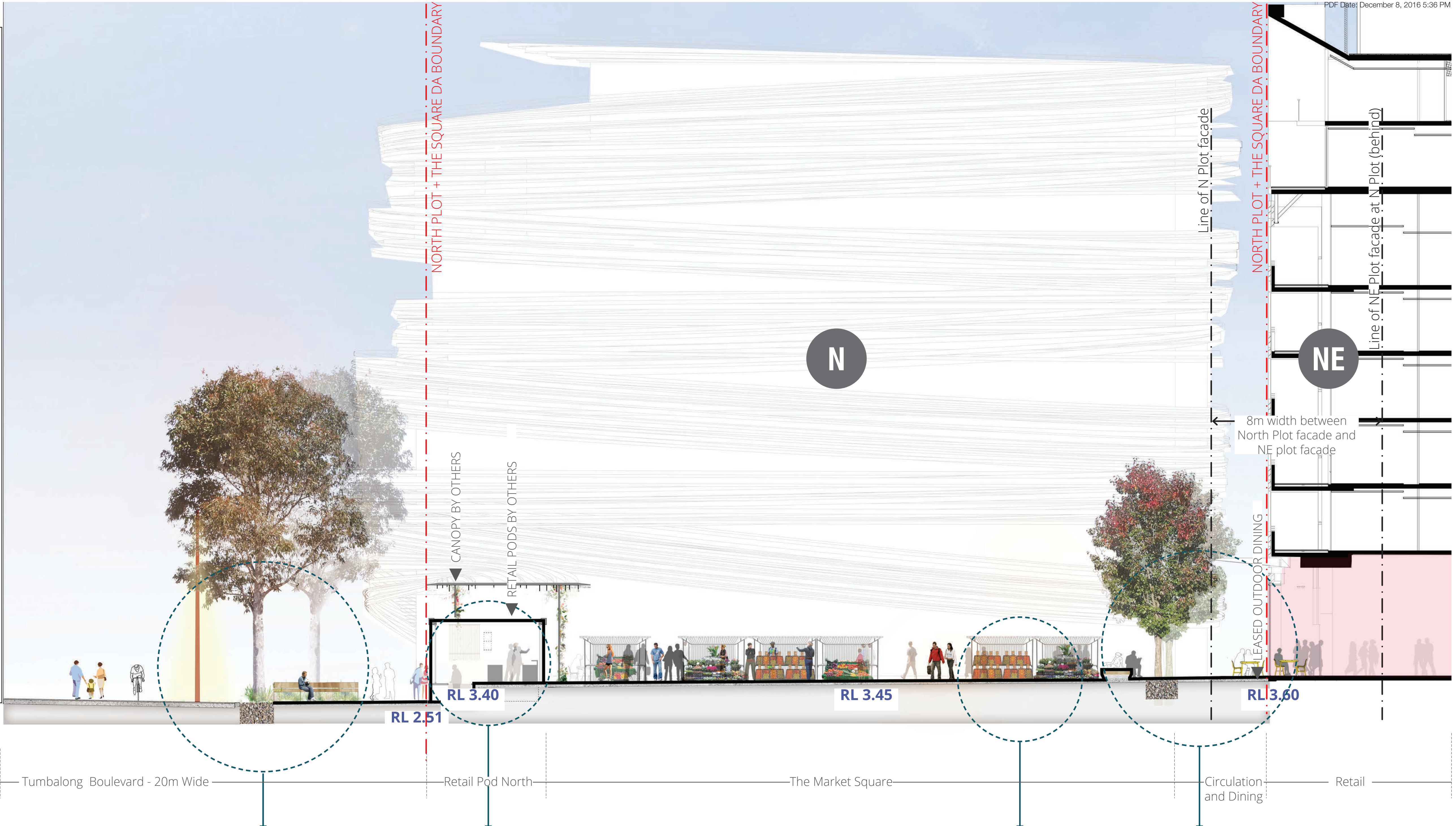

Space to pause amongst planting and trees on Tumbalong Boulevard.  
The High Line, New York | James Corner Field Operations



Outdoor dining areas with possible moveable furniture under canopy.  
Reg Bartley Kiosk, Rushcutters Bay | Lacoste + Stevenson



Open, flexible paved space suited to weekend markets and local events.  
Torvehallerne, Copenhagen | Arkitekturvaerkstedet and Jorn Palle Schmidt



Clear pedestrian circulation to retail under row of trees.  
Stationstraat, Sint Niklaas, Belgium | Grontmij

# Darling Square, SSDA10 (RTS)

ASPECT Studios™

Client: Lendlease



Drawn: LB/RD  
Checked: LN/SC/LP

Scale: 1:100 @ A1  
1:200 @ A3  
Date: November 2016



Dwg no.: 14076-SSDA10(RTS)-05  
Rev: A

## NORTH PLOT AND DARLING SQUARE SECTION 3 - THE MARKET SQUARE



## SECTION KEY

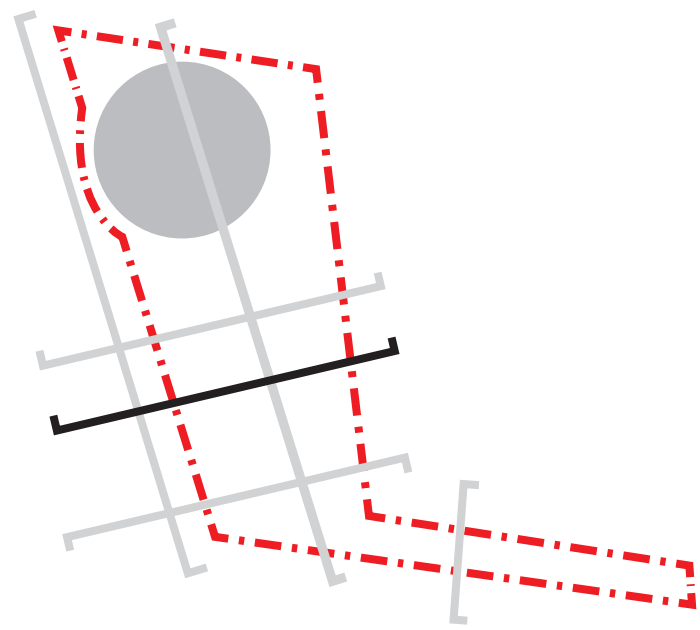

NOTE: LEVELS ARE INDICATIVE & SUBJECT TO DESIGN DEVELOPEMENT

SW

N

NE

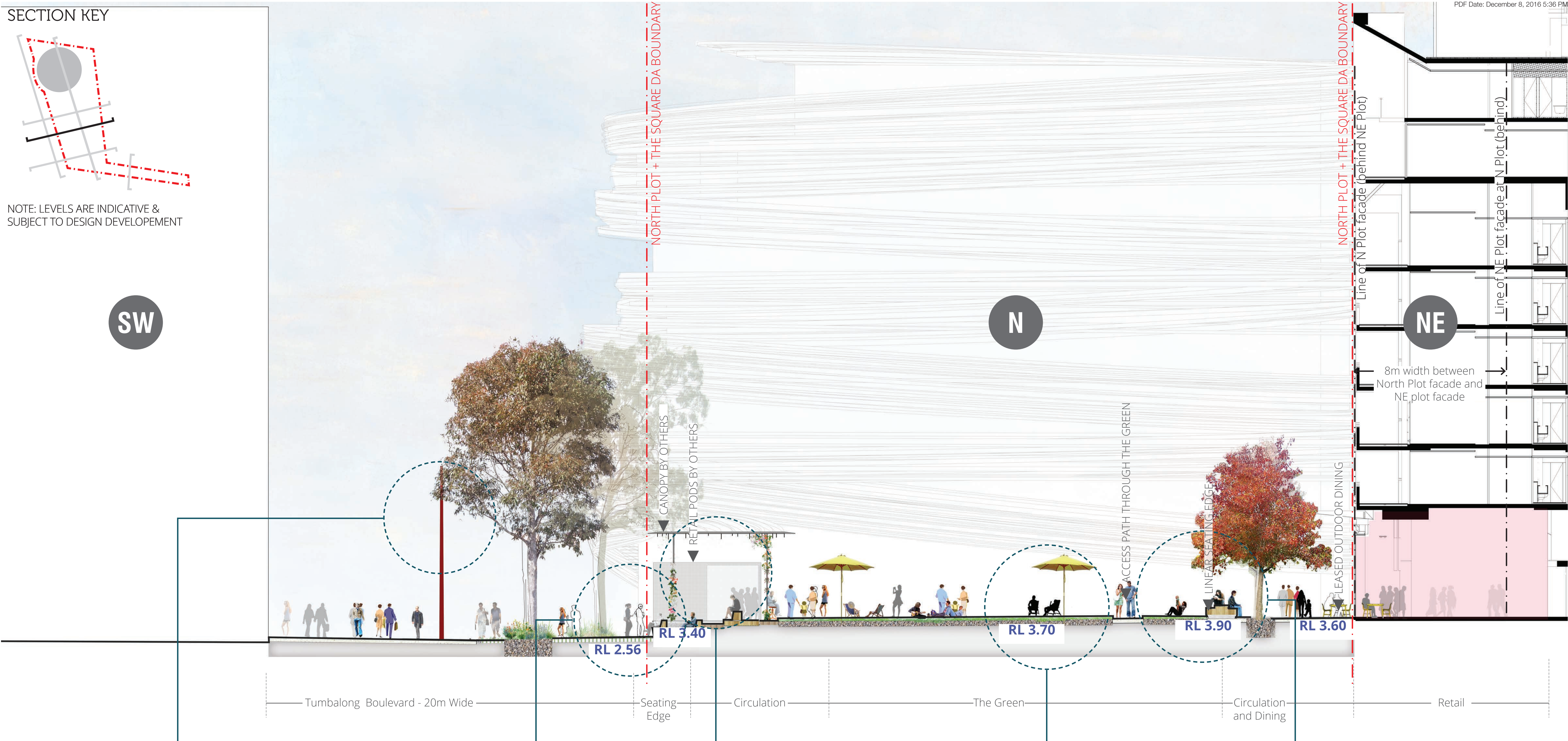

Tall, simple public domain lighting to length of Tumbalong Boulevard.  
Riverwalk Plaza, Alberta, Canada | Hess Lighting, Stantec Consulting



Integrated planting and steps / terraces  
Kengo Kuma and Associates



Pocket sized Retail pod with public amenity.  
The Kiosk Flower Stall, London | Buchanan Partnership



Open grass area with possible moveable furniture.  
Darling Quarter, Sydney | ASPECT Studios



Generous, seating edge to edge of The Green  
Tietgenkollegiet, Copenhagen | Lundgaard and Tranberg

# Darling Square, SSDA10 (RTS)

## ASPECT Studios™

Client: **Lendlease**



Drawn: **LB/RD**  
Checked: **LN/SC/LP**

Scale: **1:100 @ A1**  
**1:200 @ A3**  
Date: **November 2016**



Dwg no.: **14076-SSDA10(RTS)-06**  
Rev: **A**

## NORTH PLOT AND DARLING SQUARE

### SECTION 4 - THE GREEN



## SECTION KEY

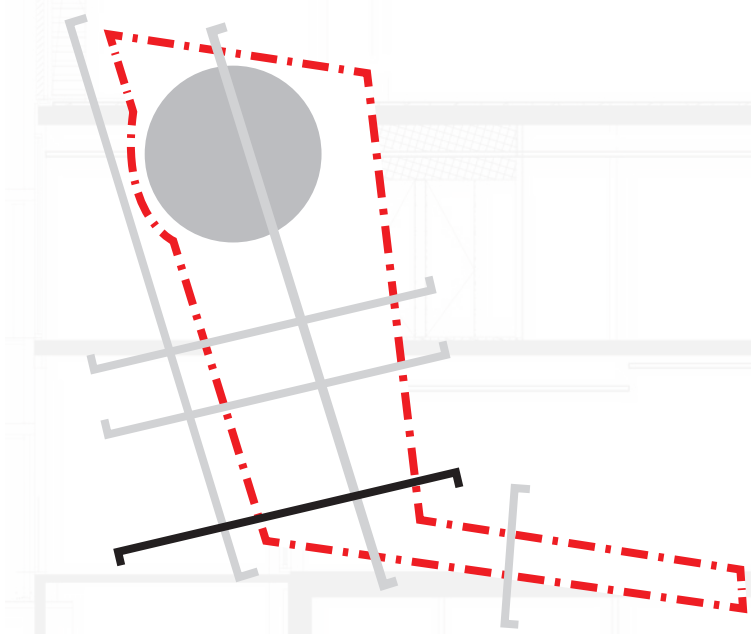

NOTE: LEVELS ARE INDICATIVE & SUBJECT TO DESIGN DEVELOPMENT

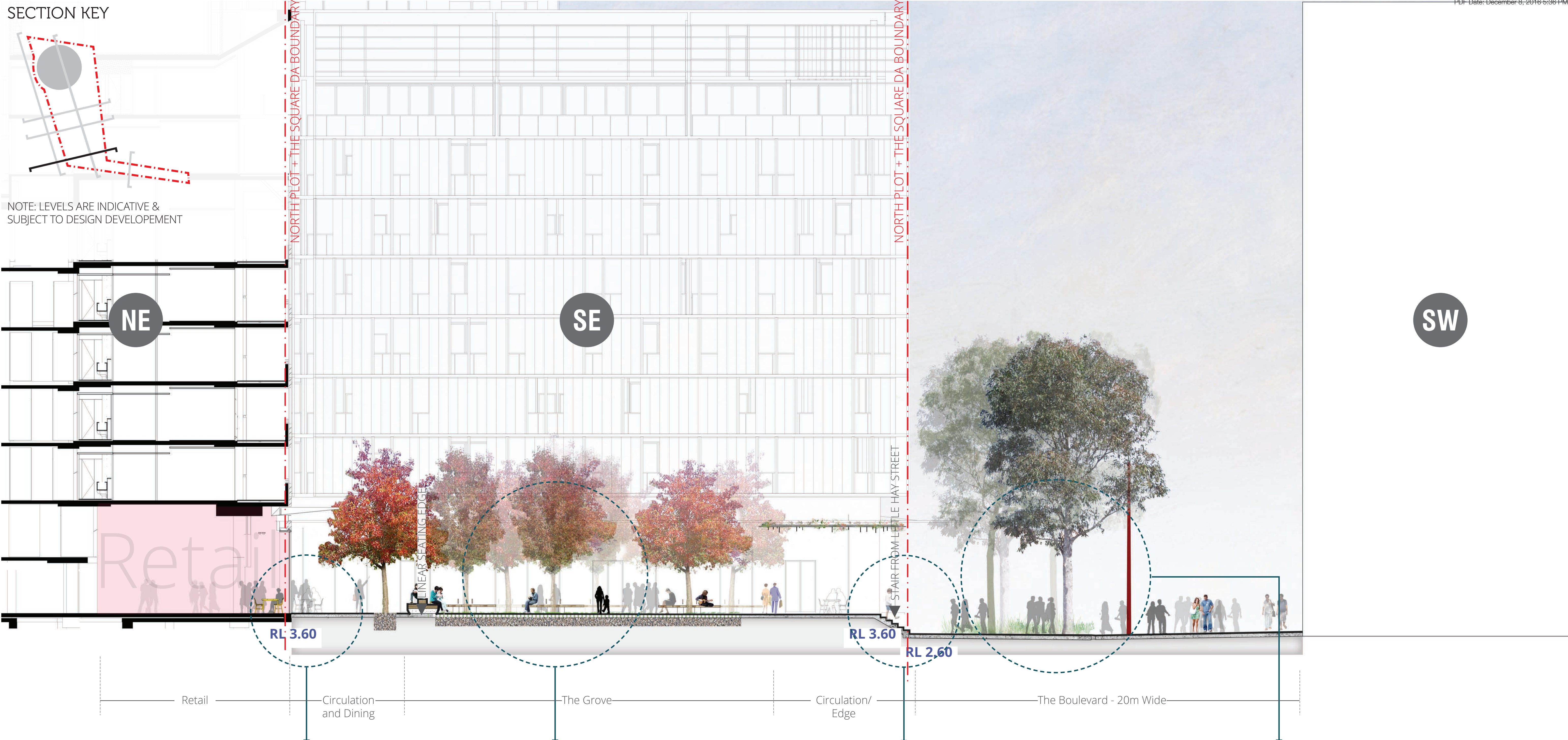

Generous circulation area adjacent retail.  
The Avenue, Washington DC | Sasaki Associates



Planting + Paving  
Passeig De St Joan Boulevard, Barcelona, Spain | Lola Domenech



Generous, elegant stone stairs that appear to float.  
Olivetti Showroom, Venice, Italy | Carlo Scarpa

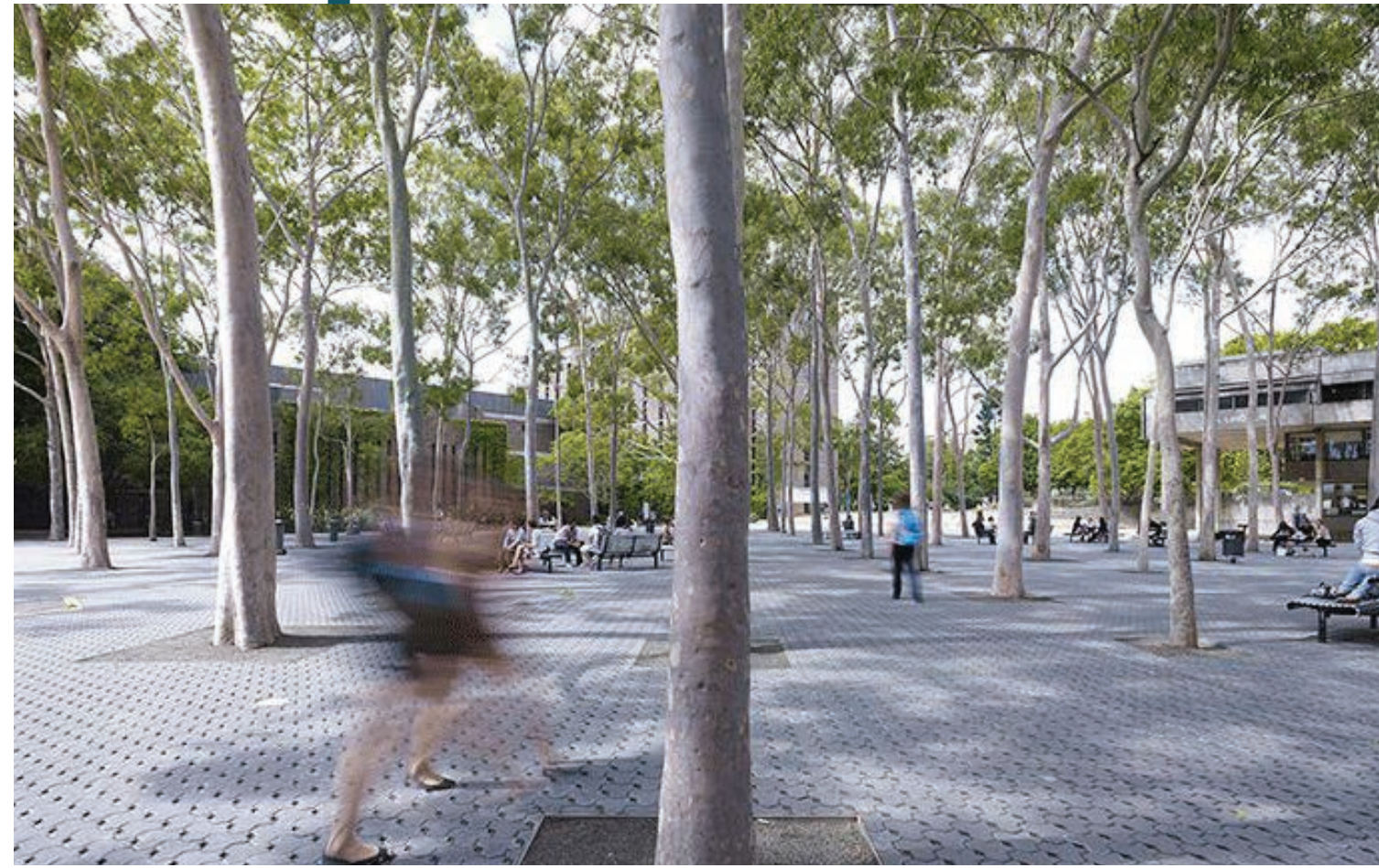

Eucalyptus species to provide dappled shade to circulation areas of Tumbalong Boulevard.  
Central Courtyard, Macquarie University | Hassell

# Darling Square, SSDA10 (RTS)

ASPECT Studios™

Client: **Lendlease**



Drawn: **LB/RD**  
Checked: **LN/SC/LP**

Scale: **1:100 @ A1**  
**1:200 @ A3**  
Date: **November 2016**



Dwg no. : **14076-SSDA10(RTS)-07**  
Rev: **A**

## NORTH PLOT AND DARLING SQUARE SECTION 5 - THE GROVE



SECTION KEY

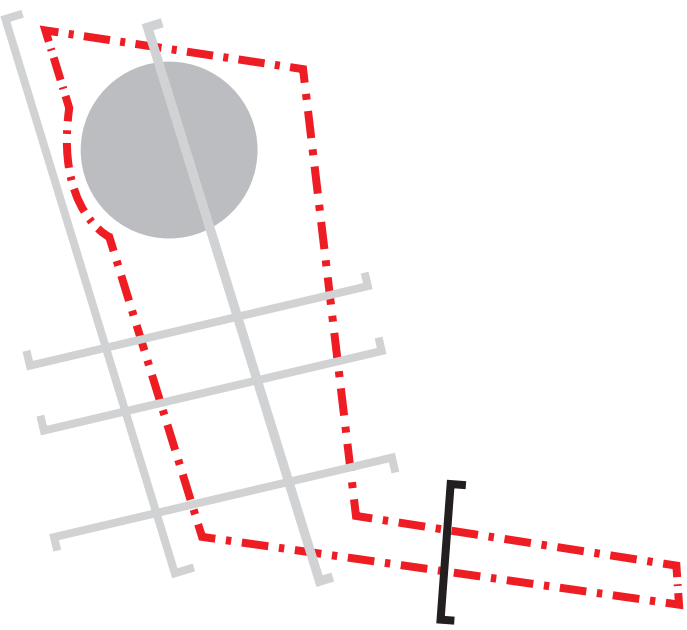

NOTE: TO SEPARATE APPROVAL

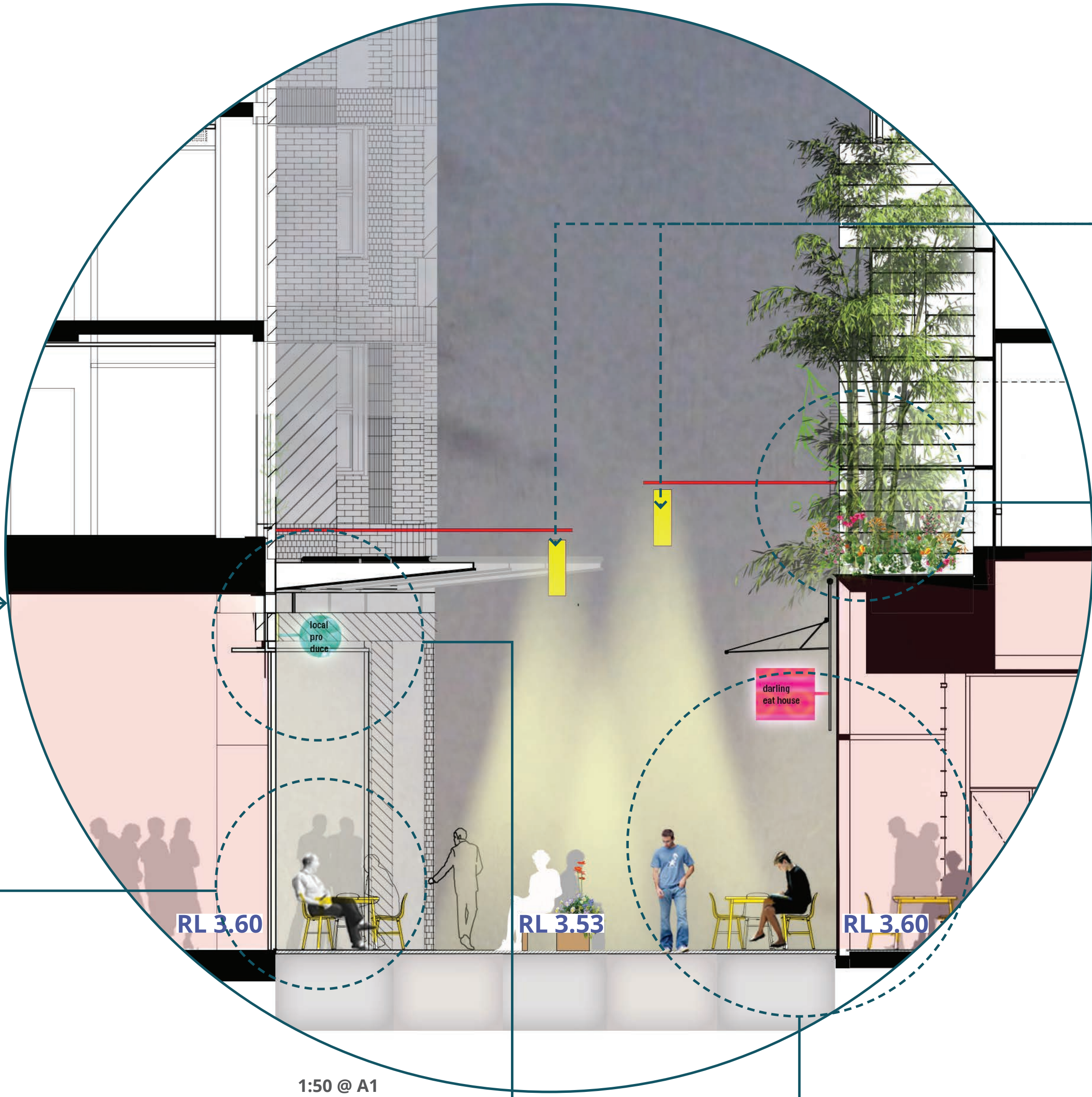
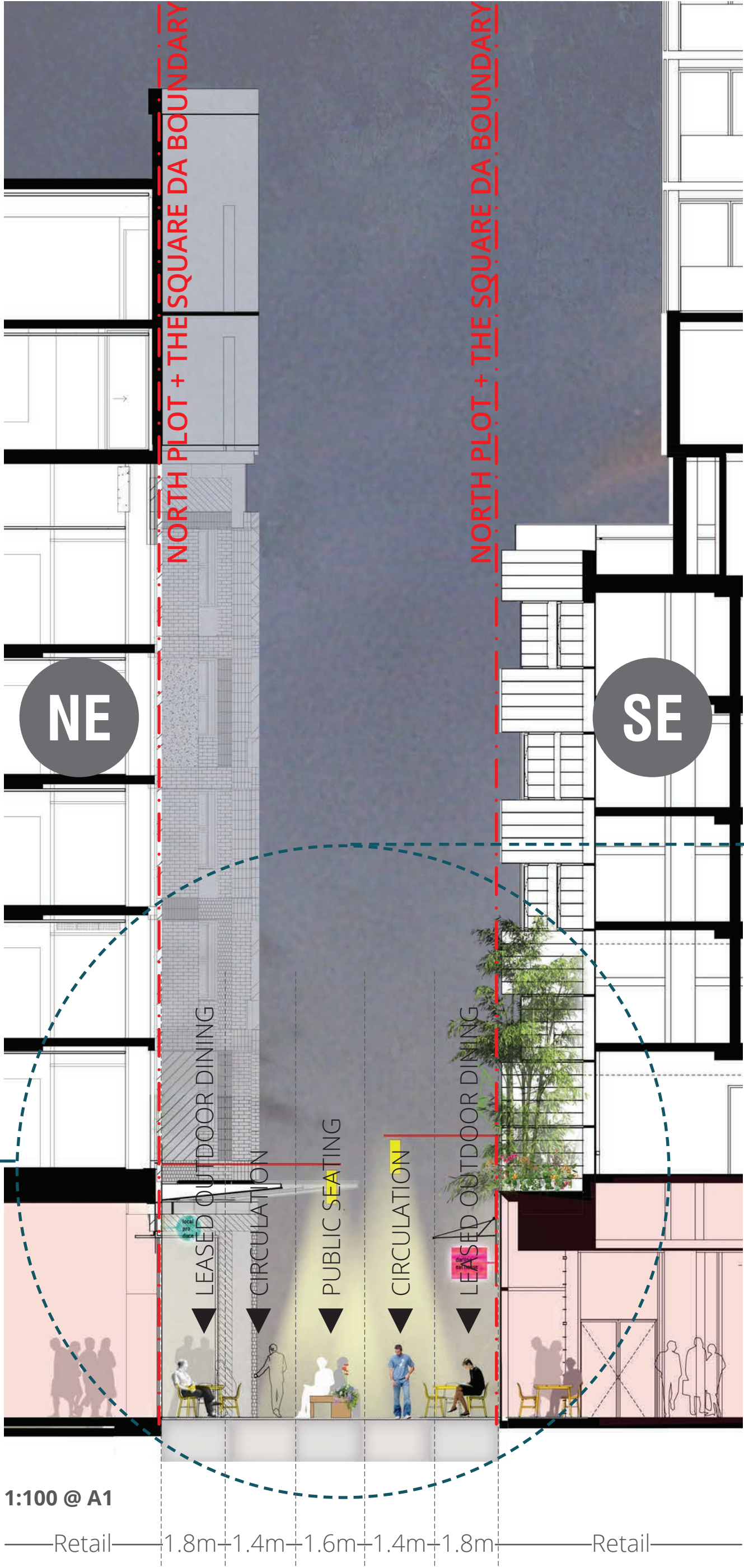

REFER TO LIGHTING  
CONCEPT DRAWINGS



Rich texture of signage and lighting.  
Centre Place, Melbourne



Diverse shopfronts  
Cafe Trama, Paris



Opportunity for graphic signage and lighting overlay.  
Neon Lane, LaTrobe Lane, Melbourne | Craig & Karl



Generous outdoor dining to south side of laneway.  
Degraives Lane, Melbourne



Screening to car park to provide greenery and outlook.  
The Ivy, Sydney | 360 Landscape Architecture

# Darling Square, SSDA10 (RTS)

ASPECT Studios™

## NORTH PLOT AND DARLING SQUARE SECTION 6 - LITTLE HAY STREET

Client: Lendlease



Drawn: LB/RD  
Checked: LN/SC/LP

Scale: 1:50 @ A1  
Date: 1:100 @ A3  
November 2016



Dwg no.: 14076-SSDA10(RTS)-08  
Rev: A



KEY

North Plot + The Square DA Boundary

Darling Square (DS) Boundary

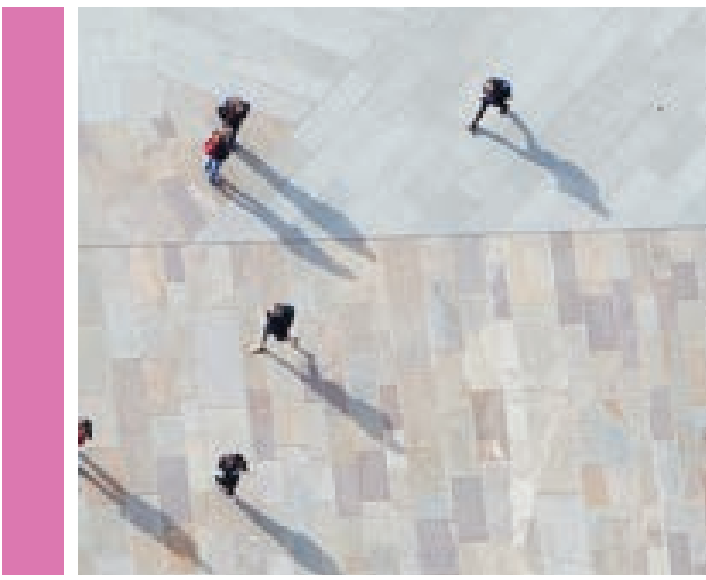

DARLING SQUARE

- High quality, warm toned stone paving in a range of colours and finishes.
- Stone such as Porphyry.
- Variety of sizes.



THE GROVE

- Warm stone to compliment The Square with planting in between.
- Mix of hard & soft surfacing.

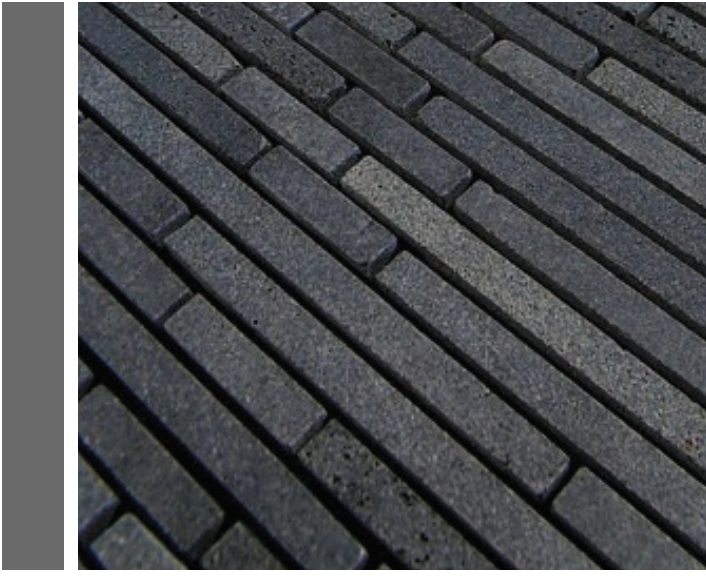

LANEWAYS

- Dark stone (such as granite or bluestone) in a range of finishes (bush hammered, exfoliated, honed).
- Complimentary with City of Sydney material colour palette.

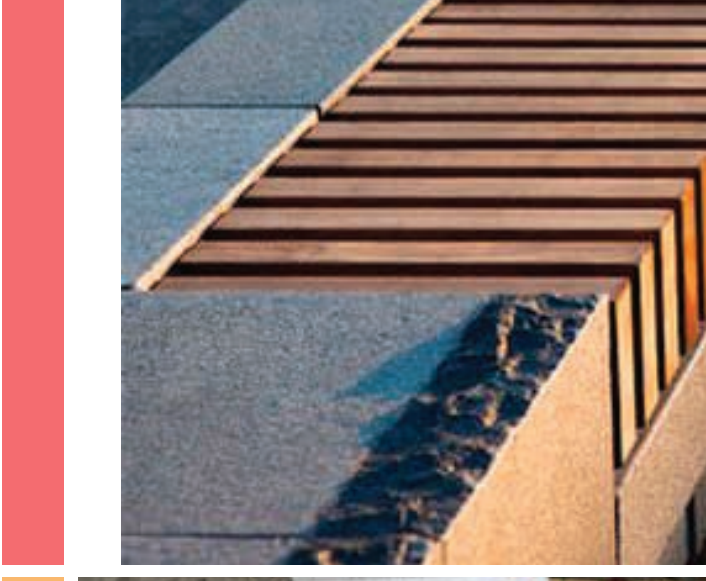

SEATING EDGES

- Warm seating platforms.
- Timber in a range of dimensions and profiles.

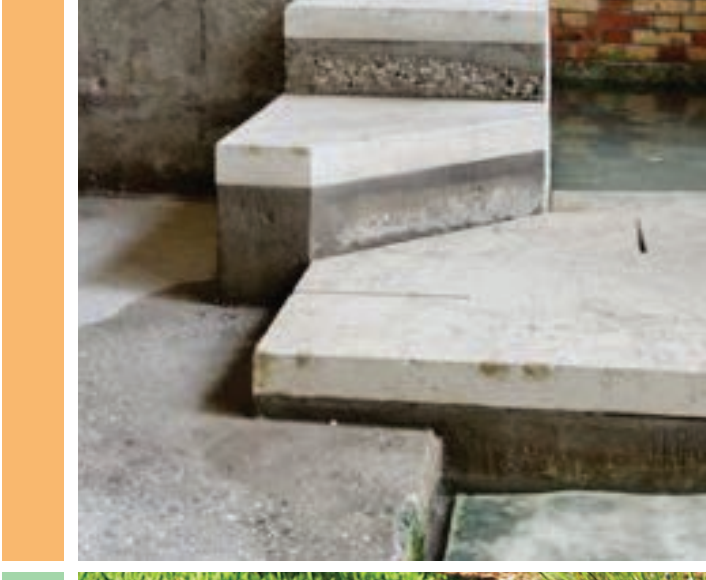

NORTHERN STEPS + STAIRS

- Materiality to match the Square.
- Warm, textured stone and precast concrete.



THE GREEN

- Shade tolerant, high traffic suited species of turf with engineered sub grade to ensure longevity and success.

