

**1 Level 32 FFL**  
1 : 100

- TERRACES
- PLANT
- CORES
- RISER
- CIRCULATION
- BOH

Rev	Date	Description	By	Chkd
1	30.10.2014	Planning Submission	WE	WE
	29.11.2017	Section 9e Amendment	WE	WE

Do not Scale. Use figured dimensions only. All dimensions to be checked on site.  
All drawings to be read in conjunction with the Engineers' drawings.  
Any discrepancies between consultants drawings to be reported to the Architect before any work commences.  
The Contractor's attention is drawn to the Health & Safety matters identified in the Health & Safety plan as being potentially hazardous.  
These items should not be considered as a complete and final list.  
The Work Package Contractor's normal Health & Safety obligations still apply when undertaking constructional operations both on and off site.

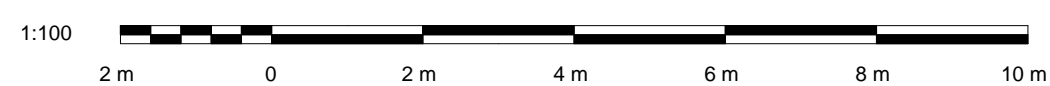

Issue Status

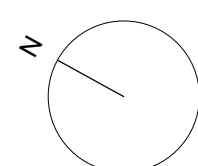

Client

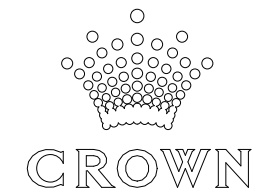

**WilkinsonEyre**

Wilkinson Eyre Architects  
33 Bowling Green Lane, London  
EC1R 0BJ, United Kingdom

+44 (0) 20 7608 7900 T  
+44 (0) 20 7608 7901 F  
www.wilkinsonseyre.com

Project:  
**915.11 Crown Hotel Sydney**  
Title:  
**Level 32 Plan**

Scale @ A1:  
**1 : 100**

Drawing and CAD File Number:  
**00915 - P - 1320 - TP**

Rev  
**1**



ABSAClass 2 Building Project Certification

Certification Number

Certification Date

Assessor Name

Assessor Number

Assessor Signature

1007018219

07/11/2014

Qian Wang

20557

Averaged Simulated Energy: HEATING: 16.0 MJ/m2 pa

Averaged Simulated Energy: COOLING: 16.1 MJ/m2 pa

Rated with Downlights: No

Averaged NABERS Rating 32.0 MJ/m2 pa

6.9/10

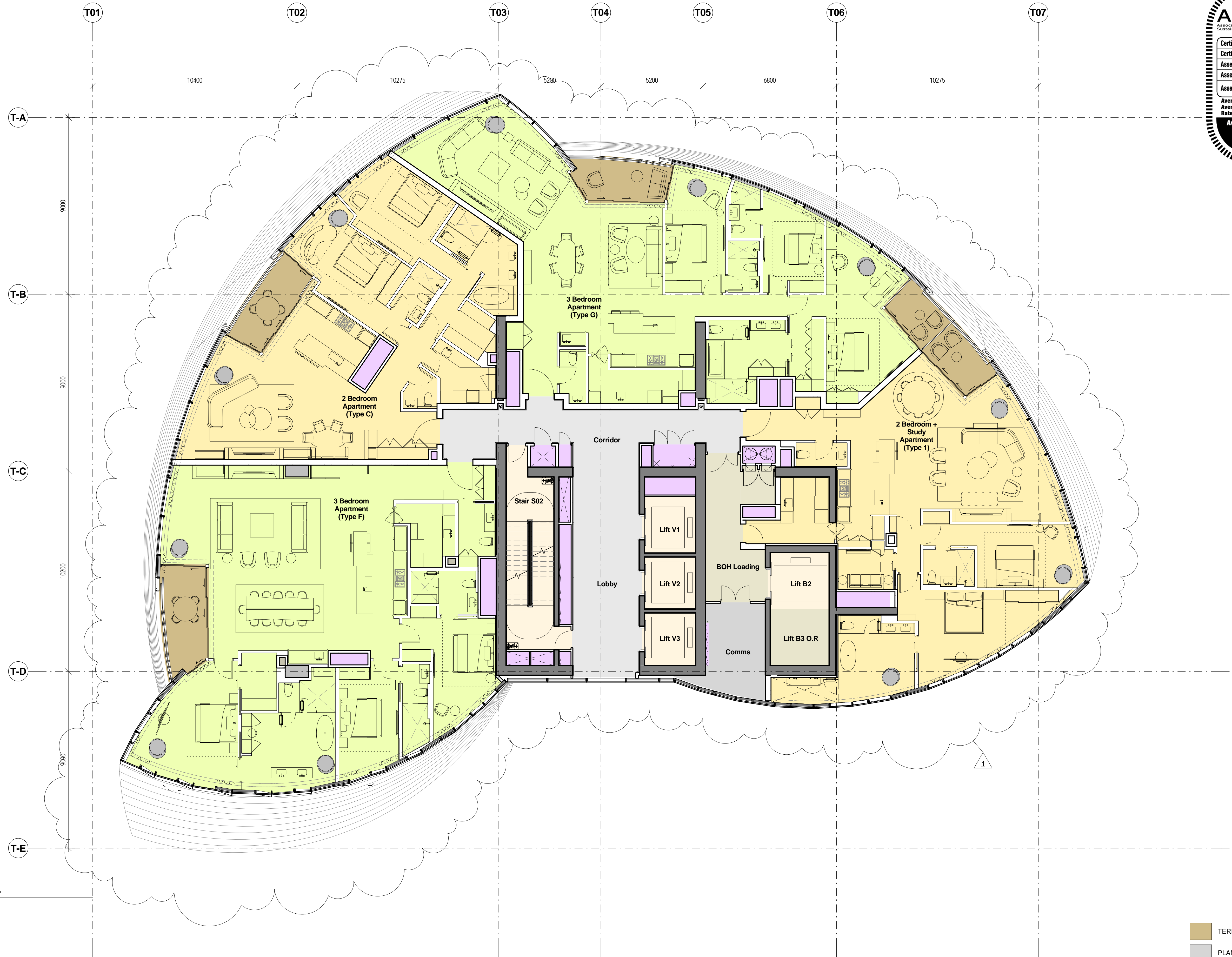

**1 Level 33 FFL**  
1 : 100

- TERRACES

PLANT

CORES
- RISER

CIRCULATION

BOH

Rev	Date	Description	By	Chkd
1	30.10.2014	Planning Submission	WE	WE
	29.11.2017	Section 96 Amendment	WE	WE

Do not Scale. Use figured dimensions only. All dimensions to be checked on site.

All drawings to be read in conjunction with the Engineers' drawings.

Any discrepancies between consultants drawings to be reported to the Architect before any work commences.

The Contractor's attention is drawn to the Health & Safety matters identified in the Health & Safety plan as being potentially hazardous.

These items should not be considered as a complete and final list.

The Work Package Contractor's normal Health & Safety obligations still apply when undertaking constructional operations both on and off site.



Issue Status

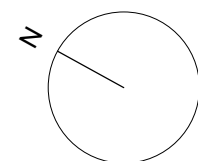

Client

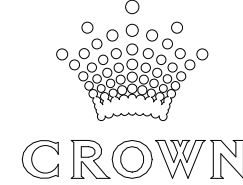

**WilkinsonEyre**

Wilkinson Eyre Architects  
33 Bowling Green Lane, London  
EC1R 0BJ, United Kingdom

+44 (0) 20 7608 7900 T  
+44 (0) 20 7608 7901 F  
www.wilkinsoneyre.com

Project:  
**915.11 Crown Hotel Sydney**

Title:  
**Level 33 Plan**

Scale @ A1:  
**1 : 100**

Drawing and CAD File Number:  
**00915 - P - 1330 - TP**

Rev  
**1**



ABSAAssociation of Building Sustainability Assessors

Class 2 Building Project Certification

Certification Number

1007018219

Certification Date

07/11/2014

Assessor Name

Qian Wang

Assessor Number

20557

Assessor Signature

Averaged Simulated Energy: HEATING: 16.0 MJ/m2 pa

Averaged Simulated Energy: COOLING: 16.1 MJ/m2 pa

Averaged Simulated Energy: RATED WITH DOWNLIGHTS: No

Averaged NatHERS Rating: 32.0 MJ/m2 pa

6.9/10

**1 Level 34 FFL**  
1 : 100

TERRACES

PLANT

CORES

RISER

CIRCULATION

BOH

Rev	Date	Description	By	Chkd
1	30.10.2014	Planning Submission	WE	WE
	29.11.2017	Section 9e Amendment	WE	WE

Do not Scale. Use figured dimensions only. All dimensions to be checked on site.

All drawings to be read in conjunction with the Engineers' drawings.

Any discrepancies between consultants drawings to be reported to the Architect before any work commences.

The Contractor's attention is drawn to the Health & Safety matters identified in the Health & Safety plan as being potentially hazardous.

These items should not be considered as a complete and final list.

The Work Package Contractor's normal Health & Safety obligations still apply when undertaking constructional operations both on and off site.

Issue Status

Client

**WilkinsonEyre**

Wilkinson Eyre Architects  
33 Bowling Green Lane, London  
EC1R 0BJ, United Kingdom

+44 (0) 20 7608 7900 T  
+44 (0) 20 7608 7901 F  
www.wilkinsonseyre.com

Project:  
**915.11 Crown Hotel Sydney**

Title:  
**Level 34 Plan**

Scale @ A1:  
**1 : 100**

Drawing and CAD File Number:  
**00915 - P - 1340 - TP**

Rev  
**1**

©WilkinsonEyre Architects Ltd



ABSA

Association of Building Sustainability Assessors

Class 2 Building Project Certification

Certification Number

1007018219

Certification Date

07/11/2014

Assessor Name

Qian Wang

Assessor Number

20557

Assessor Signature

Averaged Simulated Energy: HEATING

16.0 MJ/m2 pa

Averaged Simulated Energy: COOLING

16.1 MJ/m2 pa

Rated with Downlights:

No

Averaged MATHERS Rating

32.0 MJ/m2 pa

6.9/10

**1 Level 35 FFL**  
1 : 100

TERRACES

PLANT

CORES

RISER

CIRCULATION

BOH

Rev	Date	Description	By	Chkd
1	30.10.2014	Planning Submission	WE	WE
	29.11.2017	Section 9e Amendment	WE	WE

Do not Scale. Use figured dimensions only. All dimensions to be checked on site.

All drawings to be read in conjunction with the Engineers' drawings.

Any discrepancies between consultants drawings to be reported to the Architect before any work commences.

The Contractor's attention is drawn to the Health & Safety matters identified in the Health & Safety plan as being potentially hazardous.

These items should not be considered as a complete and final list.

The Work Package Contractor's normal Health & Safety obligations still apply when undertaking constructional operations both on and off site.

Issue Status

Client

**WilkinsonEyre**

Wilkinson Eyre Architects  
33 Bowling Green Lane, London  
EC1R 0BJ, United Kingdom

+44 (0) 20 7608 7900 T  
+44 (0) 20 7608 7901 F  
www.wilkinsonseyre.com

Project:  
**915.11 Crown Hotel Sydney**

Title:  
**Level 35 Plan**

Scale @ A1:  
**1 : 100**

Drawing and CAD File Number:  
**00915 - P - 1350 - TP**

Rev  
**1**

©WilkinsonEyre Architects Ltd



ABSAAssociation of Building Sustainability Assessors

Class 2 Building Project Certification

Certification Number	1007018219
Certification Date	07/11/2014
Assessor Name	Qian Wang
Assessor Number	20557
Assessor Signature	<i>Qian Wang</i>

Averaged Simulated Energy: HEATING: 16.0 MJ/m2 pa  
Averaged Simulated Energy: COOLING: 16.1 MJ/m2 pa  
Rated with Downlights: No

Averaged NatHERS Rating: 32.0 MJ/m2 pa

6.9/10

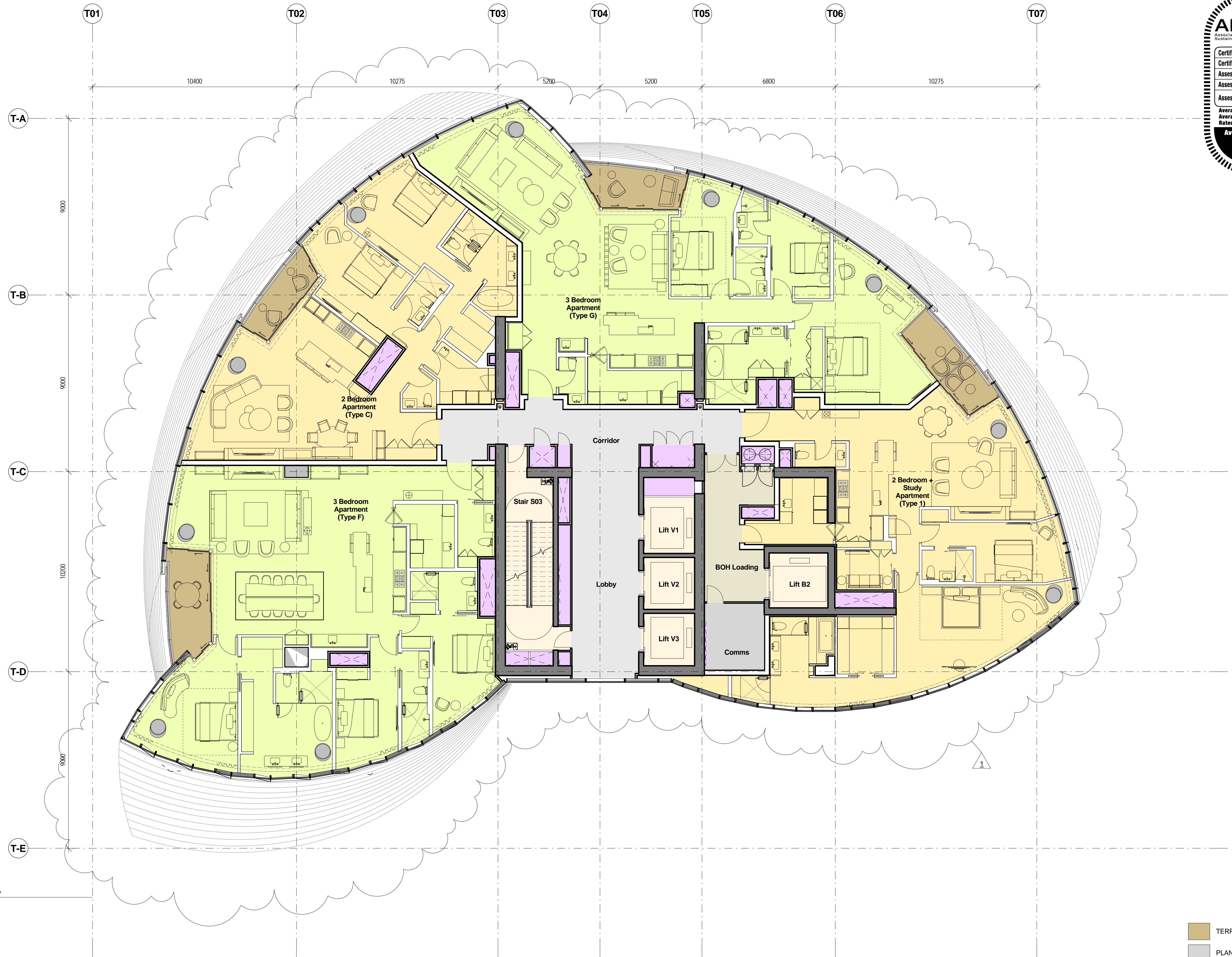

**1 Level 36 FFL**  
1 : 100

- TERRACES

PLANT

CORES
- RISER

CIRCULATION

BOH

Rev	Date	Description	By	Chkd
1	30.10.2014	Planning Submission	WE	WE
	29.11.2017	Section 96 Amendment	WE	WE

Do not Scale. Use figured dimensions only. All dimensions to be checked on site.

All drawings to be read in conjunction with the Engineers' drawings.

Any discrepancies between consultants drawings to be reported to the Architect before any work commences.

The Contractor's attention is drawn to the Health & Safety matters identified in the Health & Safety plan as being potentially hazardous.

These items should not be considered as a complete and final list.

The Work Package Contractor's normal Health & Safety obligations still apply when undertaking constructional operations both on and off site.



Issue Status

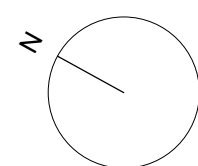

Client

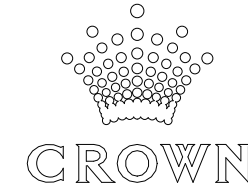

**WilkinsonEyre**

Wilkinson Eyre Architects  
33 Bowling Green Lane, London  
EC1R 0BJ, United Kingdom

+44 (0) 20 7608 7900 T  
+44 (0) 20 7608 7901 F  
www.wilkinsonseyre.com

Project:  
**915.11 Crown Hotel Sydney**

Title:  
**Level 36 Plan**

Scale @ A1:  
**1 : 100**

Drawing and CAD File Number:  
**00915 - P - 1360 - TP**



ABSA

Association of Building Sustainability Assessors

Class 2 Building Project Certification

Certification Number

1007018219

Certification Date

07/11/2014

Assessor Name

Qian Wang

Assessor Number

20557

Assessor Signature

Averaged Simulated Energy: HEATING

18.0 MJ/m2 pa

Averaged Simulated Energy: COOLING

16.1 MJ/m2 pa

Rated with Downlights:

No

Averaged NatHERS Rating

32.0 MJ/m2 pa

6.9/10

**1 Level 37 FFL**  
1 : 100

TERRACES

PLANT

CORES

RISER



CIRCULATION



BOH

<table><tr><th>Rev</th><th>Date</th><th>Description</th><th>By</th><th>Chkd</th></tr><tr><td>1</td><td>30.10.2014</td><td>Planning Submission</td><td>WE</td><td>WE</td></tr><tr><td></td><td>29.11.2017</td><td>Section 96 Amendment</td><td>WE</td><td>WE</td></tr><tr><td> </td><td> </td><td> </td><td> </td><td> </td></tr><tr><td> </td><td> </td><td> </td><td> </td><td> </td></tr><tr><td> </td><td> </td><td> </td><td> </td><td> </td></tr><tr><td> </td><td> </td><td> </td><td> </td><td> </td></tr><tr><td> </td><td> </td><td> </td><td> </td><td> </td></tr><tr><td> </td><td> </td><td> </td><td> </td><td> </td></tr></table>	Rev	Date	Description	By	Chkd	1	30.10.2014	Planning Submission	WE	WE		29.11.2017	Section 96 Amendment	WE	WE																															<p>Do not Scale. Use figured dimensions only. All dimensions to be checked on site.</p> <p>All drawings to be read in conjunction with the Engineers' drawings.</p> <p>Any discrepancies between consultants drawings to be reported to the Architect before any work commences.</p> <p>The Contractor's attention is drawn to the Health &amp; Safety matters identified in the Health &amp; Safety plan as being potentially hazardous.</p> <p>These items should not be considered as a complete and final list.</p> <p>The Work Package Contractor's normal Health &amp; Safety obligations still apply when undertaking constructional operations both on and off site.</p>	<div>1:100</div> <div></div>	<div>Issue Status</div> <div></div>	<div>Client</div> <div></div>	<div>WilkinsonEyre</div> <div>Wilkinson Eyre Architects 33 Bowling Green Lane, London EC1R 0BJ, United Kingdom</div> <div>+44 (0) 20 7608 7900 T +44 (0) 20 7608 7901 F www.wilkinsonseyre.com</div>	<div>Project</div> <div>915.11 Crown Hotel Sydney</div> <div>Title</div> <div>Level 37 Plan</div>	<div>Scale @ A1:</div> <div>1 : 100</div> <div>Drawing and CAD File Number</div> <div>00915 - P - 1370 - TP</div> <div>Rev</div> <div>1</div>
Rev	Date	Description	By	Chkd																																																
1	30.10.2014	Planning Submission	WE	WE																																																
	29.11.2017	Section 96 Amendment	WE	WE																																																

©WilkinsonEyre Architects Ltd



 TERRACES  
 PLANT  
 CORES

 RISER  
 CIRCULATION  
 BOH

Do not Scale. Use figured dimensions only. All dimensions to be checked on site.

All drawings to be read in conjunction with the Engineers' drawings.

Any discrepancies between consultants drawings to be reported to the Architect before any work commences.

The Contractor's attention is drawn to the Health & Safety matters identified in the Health & Safety plan as being potentially hazardous.

These items should not be considered as a complete and final list.

The Work Package Contractor's normal Health & Safety obligations still apply when undertaking constructional operations both on and off site.

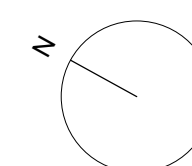

CROWN

Wilkinson Eyre Architects +44 (0) 20 7608 7900 T  
33 Bowling Green Lane, London +44 (0) 20 7608 7901 F  
EC1R 0BJ, United Kingdom [www.wilkinsoneyre.com](http://www.wilkinsoneyre.com)

1



ABSA

Association of Building Sustainability Assessors

Class 2 Building Project Certification

Certification Number

1007018219

Certification Date

07/11/2014

Assessor Name

Qian Wang

Assessor Number

20557

Assessor Signature

Averaged Simulated Energy: HEATING

16.0 MJ/m2 pa

Averaged Simulated Energy: COOLING

16.1 MJ/m2 pa

Rated with Downlights:

No

Averaged MATHERS Rating

32.0 MJ/m2 pa

6.9/10

**1 Level 39 FFL**  
1 : 100

TERRACES

PLANT

CORES

RISER

CIRCULATION

BOH

Rev	Date	Description	By	Chkd
1	30.10.2014	Planning Submission	WE	WE
	29.11.2017	Section 9e Amendment	WE	WE

Do not Scale. Use figured dimensions only. All dimensions to be checked on site.

All drawings to be read in conjunction with the Engineers' drawings.

Any discrepancies between consultants drawings to be reported to the Architect before any work commences.

The Contractor's attention is drawn to the Health & Safety matters identified in the Health & Safety plan as being potentially hazardous.

These items should not be considered as a complete and final list.

The Work Package Contractor's normal Health & Safety obligations still apply when undertaking constructional operations both on and off site.

Issue Status

Client

**WilkinsonEyre**

Wilkinson Eyre Architects  
33 Bowling Green Lane, London  
EC1R 0BJ, United Kingdom

+44 (0) 20 7608 7900 T  
+44 (0) 20 7608 7901 F  
www.wilkinsoneyre.com

Project:  
**915.11 Crown Hotel Sydney**

Title:  
**Level 39 Plan**

Scale @ A1:  
**1 : 100**

Drawing and CAD File Number:  
**00915 - P - 1390 - TP**

Rev  
**1**

©WilkinsonEyre Architects Ltd



ABSAAssociation of Building Sustainability Assessors

Class 2 Building Project Certification

Certification Number1007018219

Certification Date07/11/2014

Assessor NameQian Wang

Assessor Number20557

Assessor Signature

Averaged Simulated Energy: HEATING: 16.0 MJ/m2 pa

Averaged Simulated Energy: COOLING: 16.1 MJ/m2 pa

Rated with Downlights: No

Averaged NatHERS Rating 32.0 MJ/m2 pa

6.9/10

**1 Level 40 FFL**  
1 : 100

TERRACES

PLANT

CORES

RISER

CIRCULATION

BOH

Rev	Date	Description	By	Chkd
1	30.10.2014	Planning Submission	WE	WE
	29.11.2017	Section 96 Amendment	WE	WE

Do not Scale. Use figured dimensions only. All dimensions to be checked on site.

All drawings to be read in conjunction with the Engineers' drawings.

Any discrepancies between consultants drawings to be reported to the Architect before any work commences.

The Contractor's attention is drawn to the Health & Safety matters identified in the Health & Safety plan as being potentially hazardous.

These items should not be considered as a complete and final list.

The Work Package Contractor's normal Health & Safety obligations still apply when undertaking constructional operations both on and off site.

Issue Status

Client

**WilkinsonEyre**

Wilkinson Eyre Architects  
33 Bowling Green Lane, London  
EC1R 0BJ, United Kingdom

+44 (0) 20 7608 7900 T  
+44 (0) 20 7608 7901 F  
www.wilkinsonseyre.com

Project:  
**915.11 Crown Hotel Sydney**

Title:  
**Level 40 Plan**

Scale @ A1:  
**1 : 100**

Drawing and CAD File Number:  
**00915 - P - 1400 - TP**

Rev  
**1**

©WilkinsonEyre Architects Ltd



ABSA

Association of Building Sustainability Assessors

Class 2 Building Project Certification

Certification Number	1007018219
Certification Date	07/11/2014
Assessor Name	Qian Wang
Assessor Number	20557
Assessor Signature	

Averaged Simulated Energy: HEATING: 16.0 MJ/m2 pa  
Averaged Simulated Energy: COOLING: 16.1 MJ/m2 pa  
Rated with Downlights: No

Averaged NABERS Rating 32.0 MJ/m2 pa

6.9/10

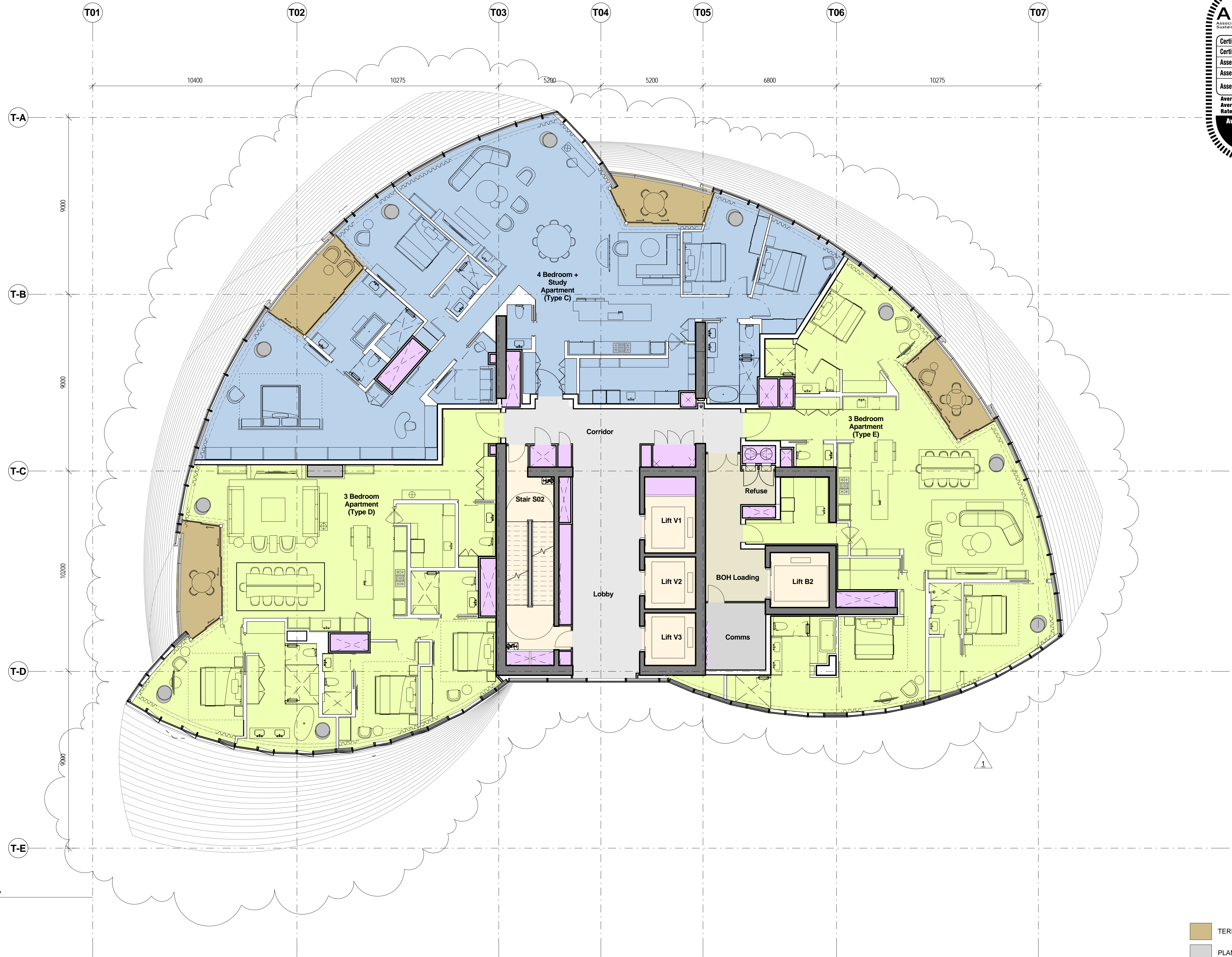

**1** Level 41 FFL  
1 : 100

- TERRACES

PLANT

CORES
- RISER

CIRCULATION

BOH

Rev	Date	Description	By	Chkd
1	30.10.2014	Planning Submission	WE	WE
	29.11.2017	Section 96 Amendment	WE	WE

Do not Scale. Use figured dimensions only. All dimensions to be checked on site.

All drawings to be read in conjunction with the Engineers' drawings.

Any discrepancies between consultants drawings to be reported to the Architect before any work commences.

The Contractor's attention is drawn to the Health & Safety matters identified in the Health & Safety plan as being potentially hazardous.

These items should not be considered as a complete and final list.

The Work Package Contractor's normal Health & Safety obligations still apply when undertaking constructional operations both on and off site.



Issue Status

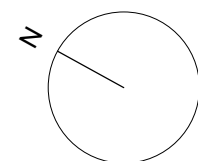

Client

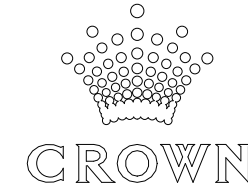

**WilkinsonEyre**

Wilkinson Eyre Architects  
33 Bowling Green Lane, London  
EC1R 0BJ, United Kingdom

+44 (0) 20 7608 7900 T  
+44 (0) 20 7608 7901 F  
www.wilkinsonseyre.com

Project:  
**915.11 Crown Hotel Sydney**

Title:  
**Level 41 Plan**

Scale @ A1:  
**1 : 100**

Drawing and CAD File Number:  
**00915 - P - 1410 - TP**

Rev  
**1**



ABSA

Association of Building Sustainability Assessors

Class 2 Building

Project Certification

Certification Number

1007018219

Certification Date

07/11/2014

Assessor Name

Qian Wang

Assessor Number

20557

Assessor Signature

Averaged Simulated Energy: HEATING:

16.0 MJ/m2 pa

Averaged Simulated Energy: COOLING:

16.1 MJ/m2 pa

Rated with Downlights:

No

Averaged NatHERS Rating

32.0 MJ/m2 pa

6.9/10

**1 Level 42 FFL**  
1 : 100

TERRACES

PLANT

CORES

RISER

CIRCULATION

BOH

Rev	Date	Description	By	Chkd
1	30.10.2014	Planning Submission	WE	WE
	29.11.2017	Section 96 Amendment	WE	WE

Do not Scale. Use figured dimensions only. All dimensions to be checked on site.

All drawings to be read in conjunction with the Engineers' drawings.

Any discrepancies between consultants drawings to be reported to the Architect before any work commences.

The Contractor's attention is drawn to the Health & Safety matters identified in the Health & Safety plan as being potentially hazardous.

These items should not be considered as a complete and final list.

The Work Package Contractor's normal Health & Safety obligations still apply when undertaking constructional operations both on and off site.

Issue Status

Client

**WilkinsonEyre**

Wilkinson Eyre Architects  
33 Bowling Green Lane, London  
EC1R 0BJ, United Kingdom

+44 (0) 20 7608 7900 T  
+44 (0) 20 7608 7901 F  
www.wilkinsoneyre.com

Project:  
**915.11 Crown Hotel Sydney**

Title:  
**Level 42 Plan**

Scale @ A1:  
**1 : 100**

Drawing and CAD File Number:  
**00915 - P - 1420 - TP**

Rev  
**1**

©WilkinsonEyre Architects Ltd