

8 May 2019

WM Project Number: 13385
Our Ref: KY 080519 Mod BC.docx

Kristjan Young
Crown Resorts
Level 19, 201 Kent Street
SYDNEY NSW 2000 AUSTRALIA

Dear Kristjan

Re: Operational Noise statement for S4.55(2) Application - Crown Sydney

Approval for SDD SSD6957 in relation to the Crown Development at Barangaroo requires the following:

Acoustic Compliance

F21. Prior to the issue of a relevant Occupation Certificate, evidence shall be submitted to the PCA demonstrating compliance with all recommendations of the Construction and Operational Noise Report (Version D), prepared by Wilkinson Murray dated 07 July 2015 and the development achieves compliance with the requirements of State Environmental Planning Policy (Infrastructure) 2007 and other guidelines applicable to the development.

The above reference report, prepared by Wilkinson Murray, was based on a number of outdoor areas operating including the level 3 All Day Dining restaurant terrace and the Spa terrace at the Level 4. It is now proposed that the following modification be made to these areas:

1. Moving of the façade line at the level 3 All Day Dining restaurant terrace to partially enclose the area.
2. Partial enclosure of the Spa terrace at level 4.

These areas are shown in the following figures:

Figure 1 Level 3 All Day Dining Approved DA Plan

Level 3 Approved DA plan

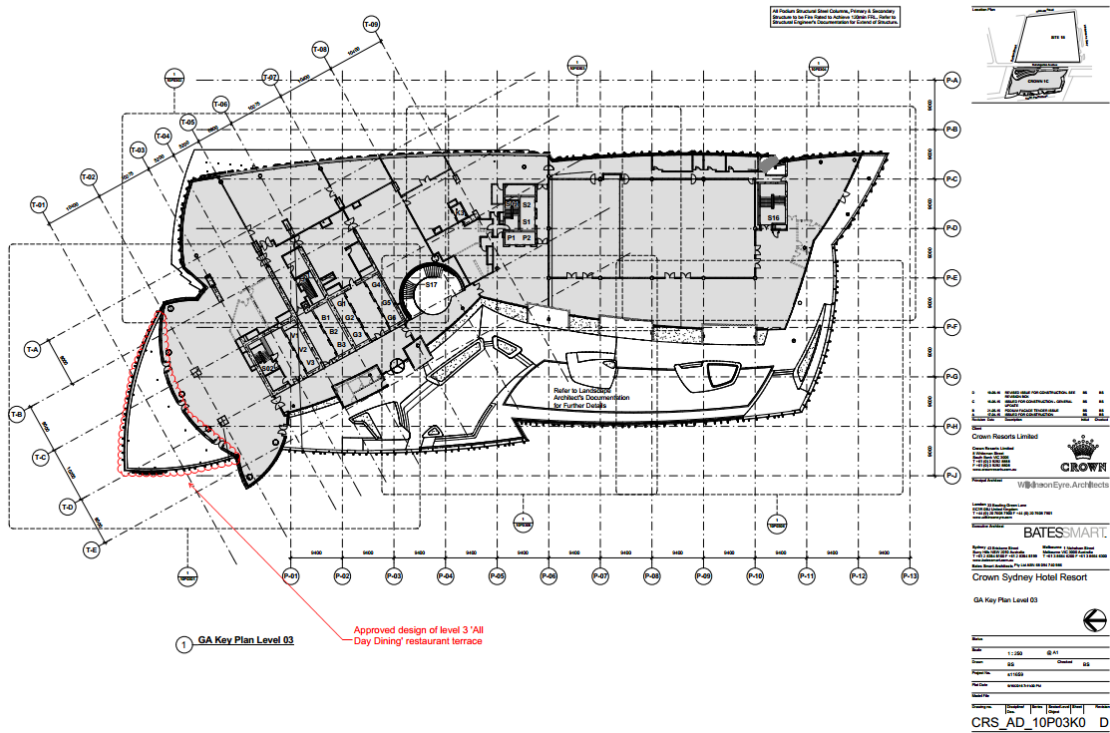

Figure 2 Level 3 All Day Dining Proposed Modification Plan

Level 3 PROPOSED - Modification under a S4.55(2) application

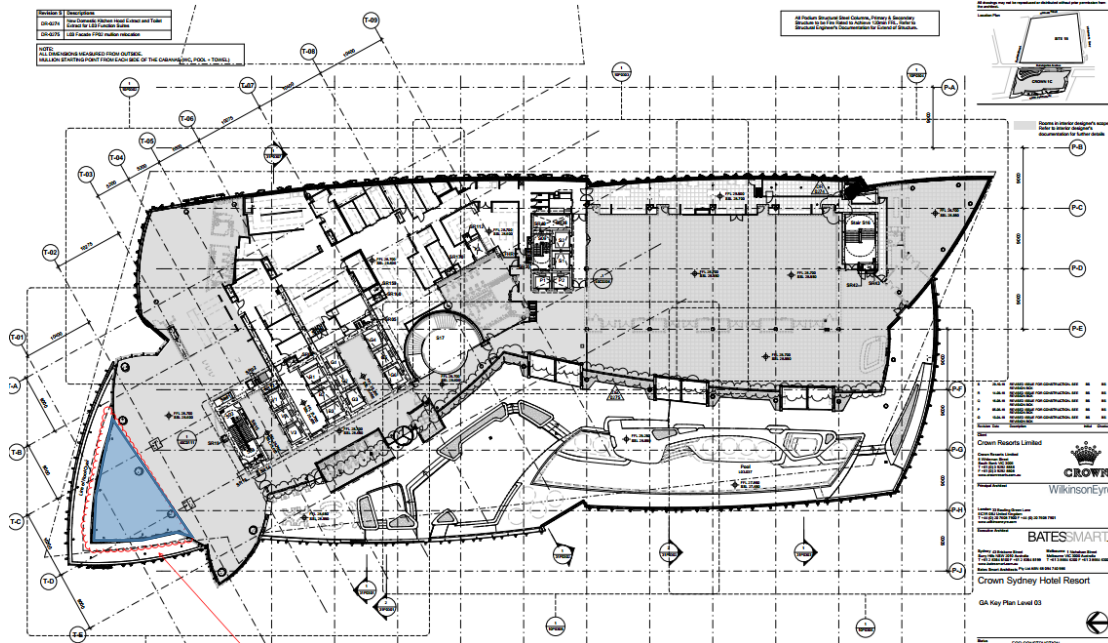
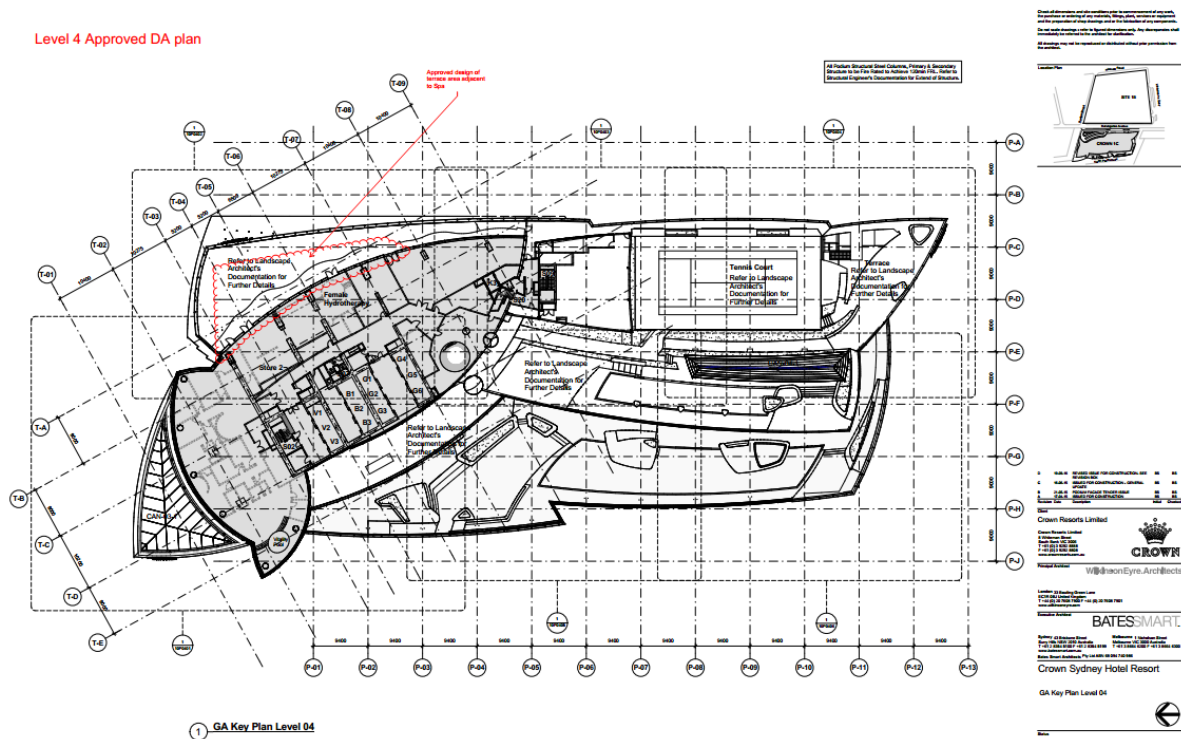
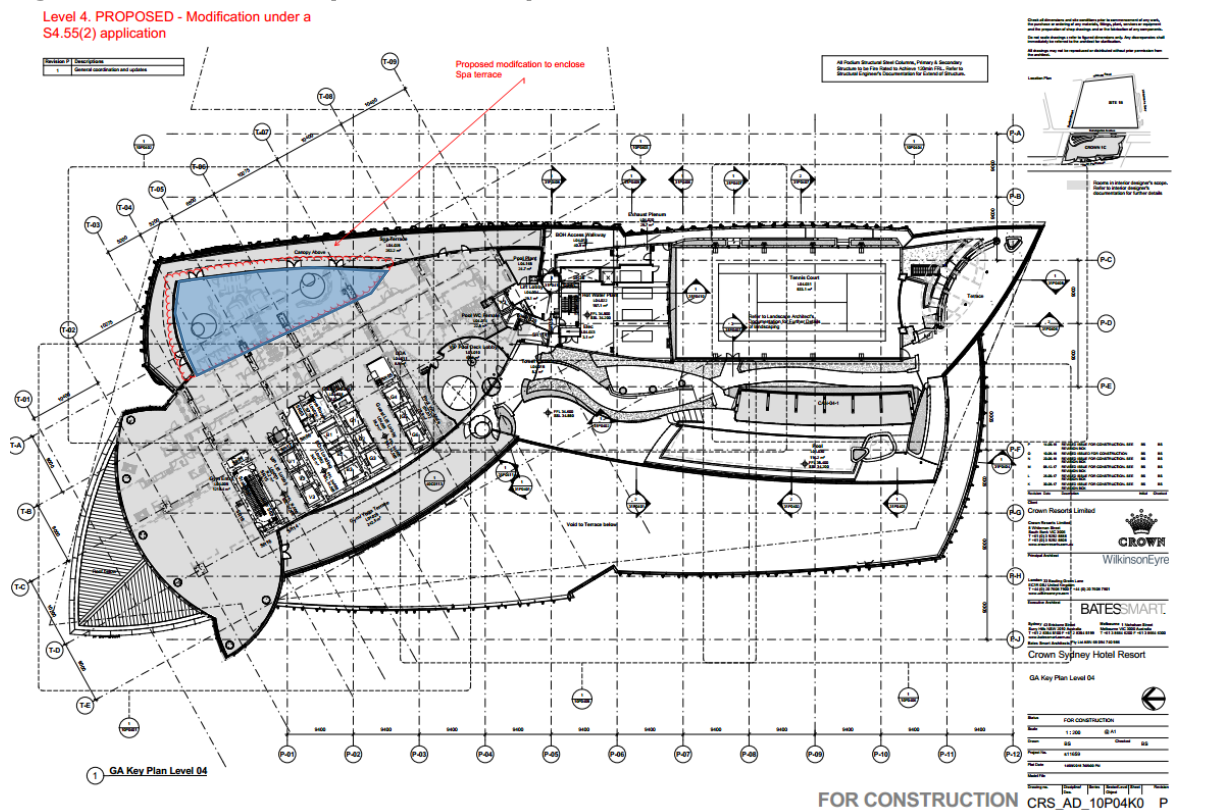

Figure 3 Level 4 Spa Terrace DA Plan**Figure 4 Level 4 Spa Terrace Proposed Modification Plan**

A review of the two areas indicates that the outdoors areas will be now enclosed. As such noise generated by patrons and activities in these areas will now be contained within the building envelope. As such the noise contribution from these areas to surrounding noise sensitive receivers, as detailed in our assessment, will be significantly reduced.

Therefore the proposed changes will not adversely impact on the acoustic amenity of surrounding noise sensitive receivers. That is, from a noise perspective, the proposed modification are acceptable.

Further it is noted that as these areas are now enclosed any restrictions on hours of operation as identified in the DA Acoustic report in Table 6-4 (See attached) are no longer necessary.

I trust this information is sufficient. Please contact us if you have any further queries.

Yours faithfully

WILKINSON MURRAY

A handwritten signature in black ink, appearing to read "Brian Clarke". The signature is fluid and cursive, with the first name "Brian" and the last name "Clarke" clearly distinguishable.

Brian Clarke

Senior Associate

**Extract from DA Acoustic Report Construction and Operational Noise Report (Version D),
prepared by Wilkinson Murray dated 07 July 2015**

Table 6-4 Indicative Typical Weekend Patron Numbers on Outdoor Areas

Outdoor Area	Number of Patrons up	Number of Patrons	Number of Patrons
	to 10 pm	up to Midnight	after Midnight
Ground Level Restaurant Terrace North	98	98	0
Ground Level Restaurant Terrace South	98	98	30
Ground Level Bar Terrace North	174	174	0
Ground Level Bar Terraces South	174	174	0
Level 1 VIP Terrace	116	116	30
Level 1 Restaurant Terrace	16	16	0
Level 2 Restaurant Terrace	16	16	0
Level 2 VIP Terrace	85	85	25
Level 3 All day Dining Level 3 Restaurant Terrace	42	42	0
Level 3 Function Terrace	65	65	0
Level 3 Pool Terrace	166	0	0
Level 4 VIP Pool and Tennis	115	0	0
Level 24 VIP Terrace	84	0	0
Total External Patrons	1247	882	85