

Landscape Concept Master Plan

The landscape concept masterplan demonstrates the vision for the Oakdale South Estate (OSE). Various proposed landscape upgrades, rehabilitation and enhancements are proposed.



Bioretention basin



Creek & Riparian Zone



Biodiveristy Zone

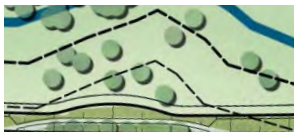

Landscape Node

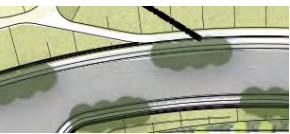

Estate Streetscape



On site presentational landscaping

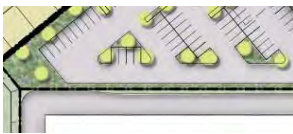

On site buffer planting

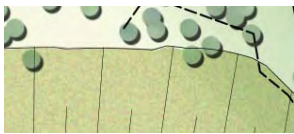

Vegetated embankments



Southern Boundary Landscape Section



5m Noise wall

Proposed retaining wall

Proposed surface level

LANDSCAPE SETBACK 30m

Section AA (Southern Boundary)
1:200 (Adapted from Civil section)

SCALE 1:200



Oakdale South - MOD 4 | Landscape



Client
Site Image Job Number

Goodman
SS15-3057

Drawing Number
Issue
Date

LR-005
O
12.02.2018

Eastern Boundary Landscape Section



SCALE 1:200























Oakdale South - MOD 4 | Landscape



Client	Goodman	Drawing Number	LR-006
Site Image Job Number	SS15-3057	Issue	O
		Date	12.02.2018

Vegetation Typologies



 Typology 1 Streetscape	 Typology 2 Landscape Nodes	 Typology 3 Basins	 Typology 4 Biodiversity Zone	 Typology 5 Riparian Zone	 Typology 6 Defendable Zone	 Typology 7 On Lot Landscaping	 Typology 8 Existing Managed Grasses	 Typology 9 Embankment Turf	 Typology 10 Boundary Planting
Refer to Street Tree Masterplan. Copse detail, ballast stone base.	Formalised planting to create legibility and amenity.	Bioretention species in accordance with Penrith City Council WSUD Guidelines.	Various rehabilitated plant communities, refer to Biodiversity Offset Strategy by Cumberland Ecology	Rehabilitation of creekline included in biodiversity offsets.	Managed clear turf zone as stipulated by fire consultant	Presentation landscaping, softening of built form and amenity creation	Powerline easement, retain existing pastoral grassses and reinstate as required by civil works	Turf to civil embankment	Screen planting to boundary
									

Street Tree Master Plan

This section has been produced to graphically demonstrate the interfaces and relationship of intended landscape treatments across the subject site.

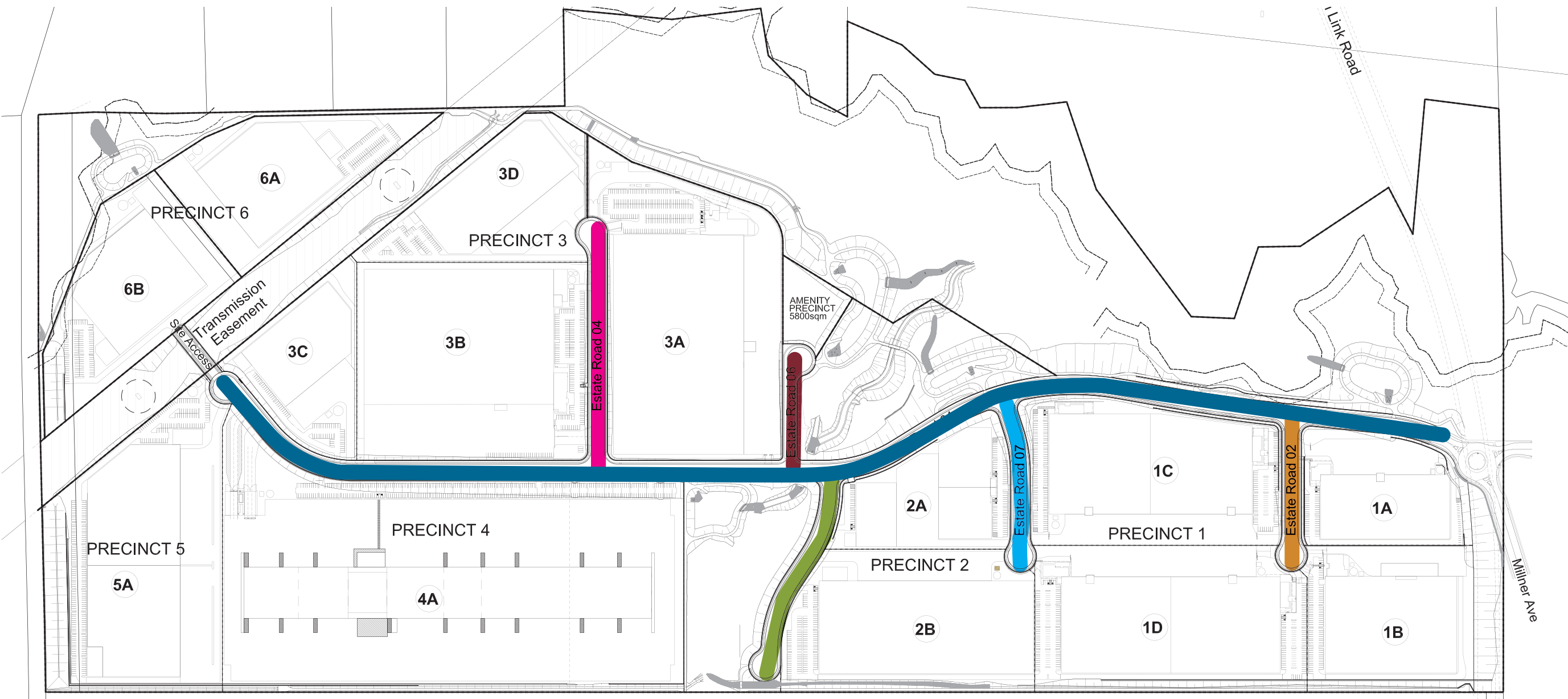

Estate Road (Road 1)		Road 2		Road 3		Road 4		Road 6		Road 7	
<i>Corymbia maculata</i>		<i>Eucalyptus crebra</i>		<i>Angophora subvelutina</i>		<i>Eucalyptus moluccana</i>		<i>Eucalyptus crebra</i>		<i>Eucalyptus crebra</i>	
Spotted Gum		Narrow-leaved Ironbark		Broad-leaved Apple		Grey Box		Narrow-leaved Ironbark		Narrow-leaved Ironbark	
30m (h) x 8m (w)		15m (h) x 6m (w)		18m (h) x 8m (w)		25m (h) x 6m (w)		15m (h) x 6m (w)		15m (h) x 6m (w)	

Landscape Node 2 - Plan / Section



Nodes shall be strategically placed close to office administration areas, entries etc to 'cluster' activity, and provide convenience and accessibility for workers of nearby facilities.

Landscapes nodes shall also be used by pedestrians and cyclists, create a sense of place and legibility across the site.

The use of feature planting and pergola structures will further enhance these areas, and create a focal points for the greater estate



SCALE 1:100

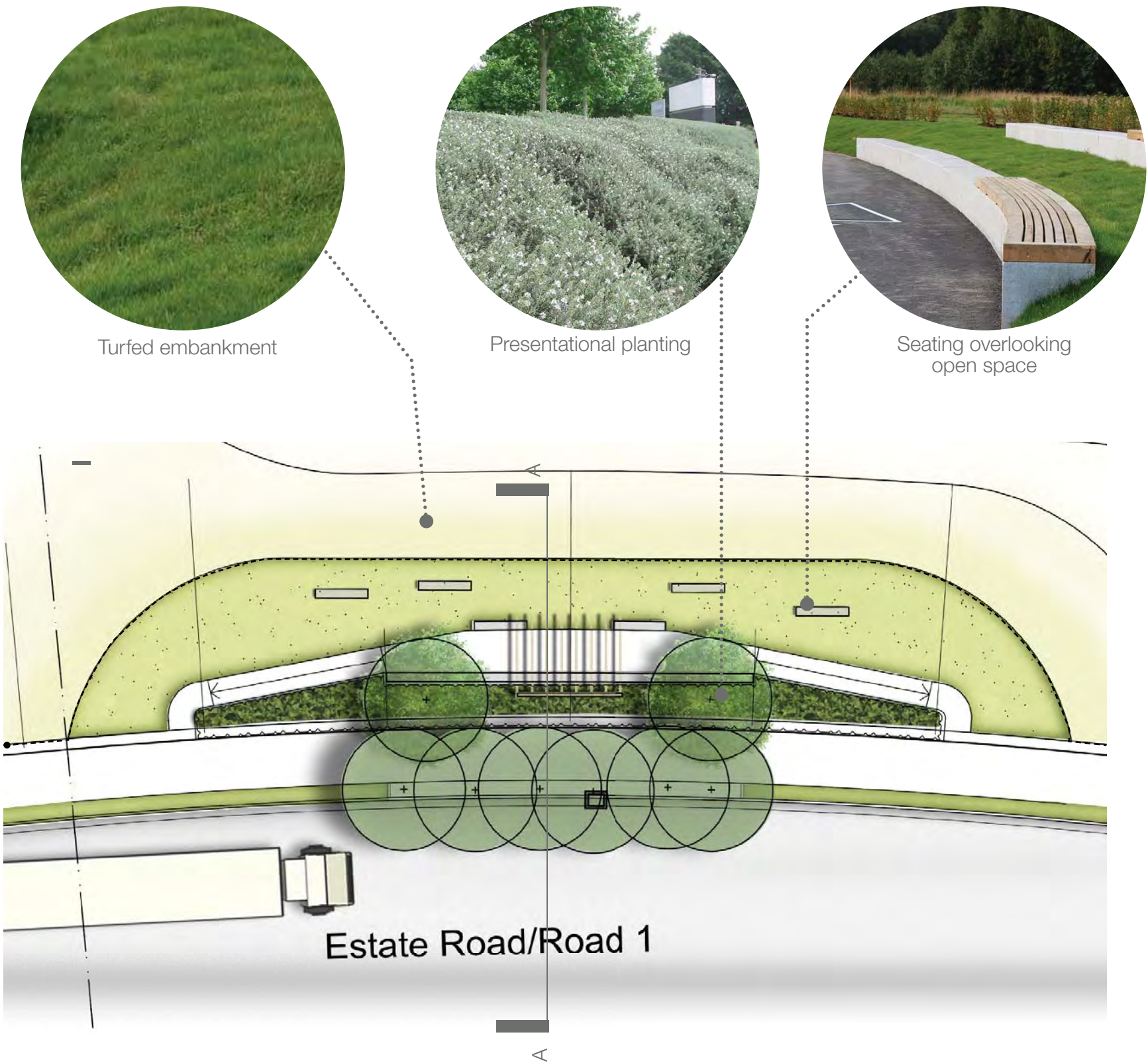

SCALE 1:250

Stage 1 Development

Landscape Scope of Works

The landscape works described specifically in this report, and subsequent design development, shall consist of

- Estate Works: Streetscape works: street trees, verges, Landscape nodes, detention basins (and other civil related landscape requirements – i.e batters). These works shall be staged as per civil works.
- Precinct Works (on lot works): Each lot and precinct (combining of several lots) shall be landscaped as building forms are developed.

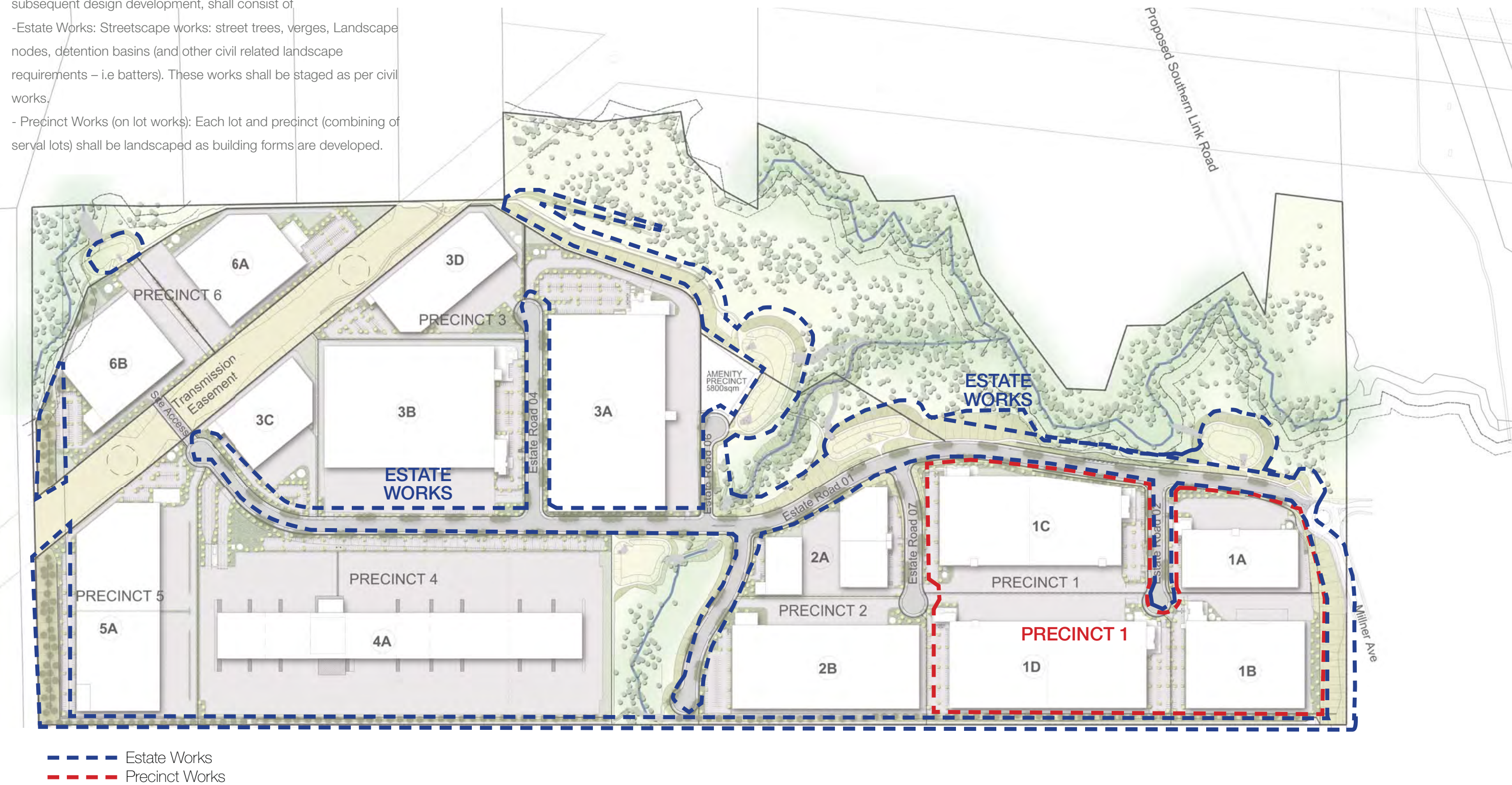

Stage 1 Development Works
Landscape Plan

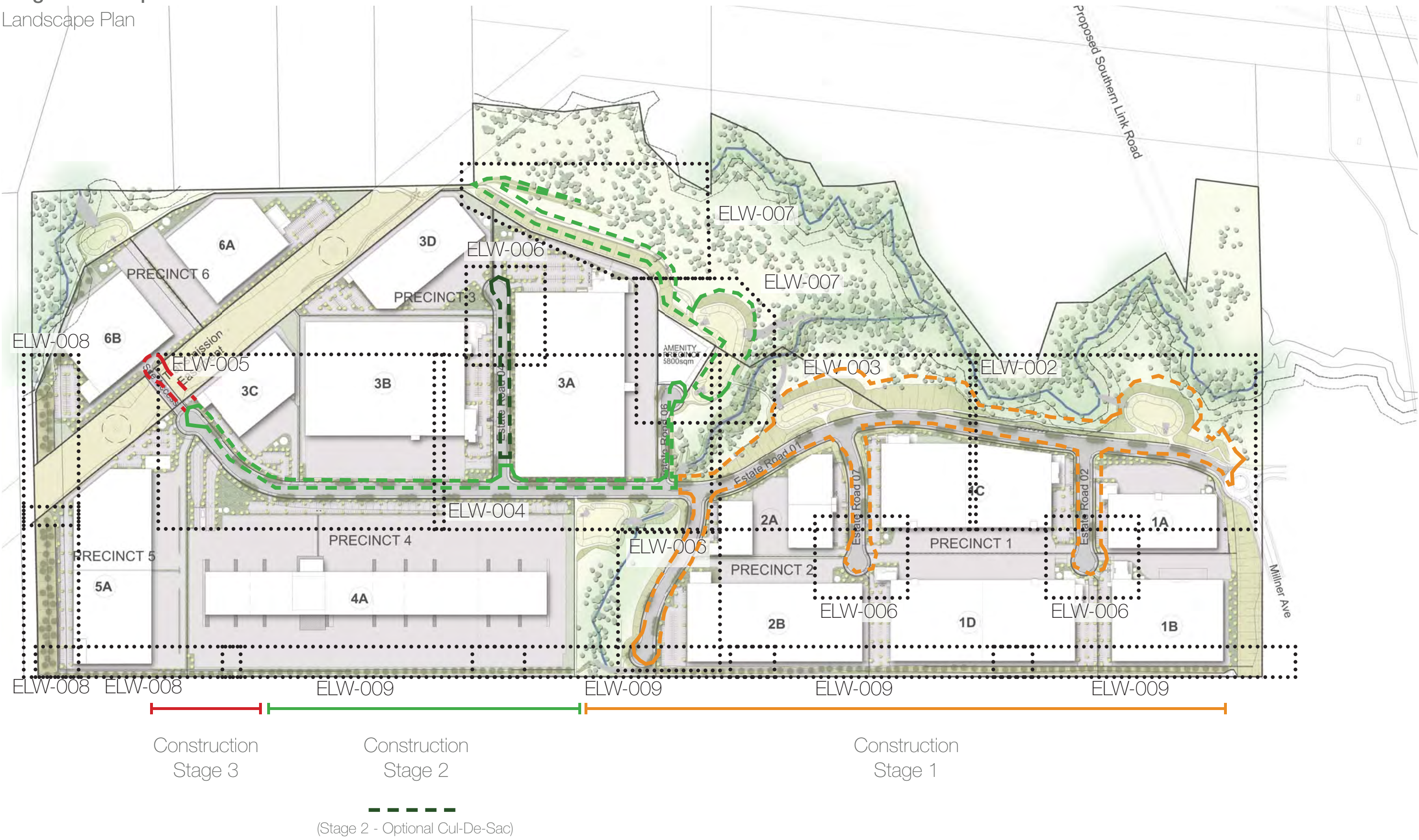

Estate Landscape Works
Landscape Plan

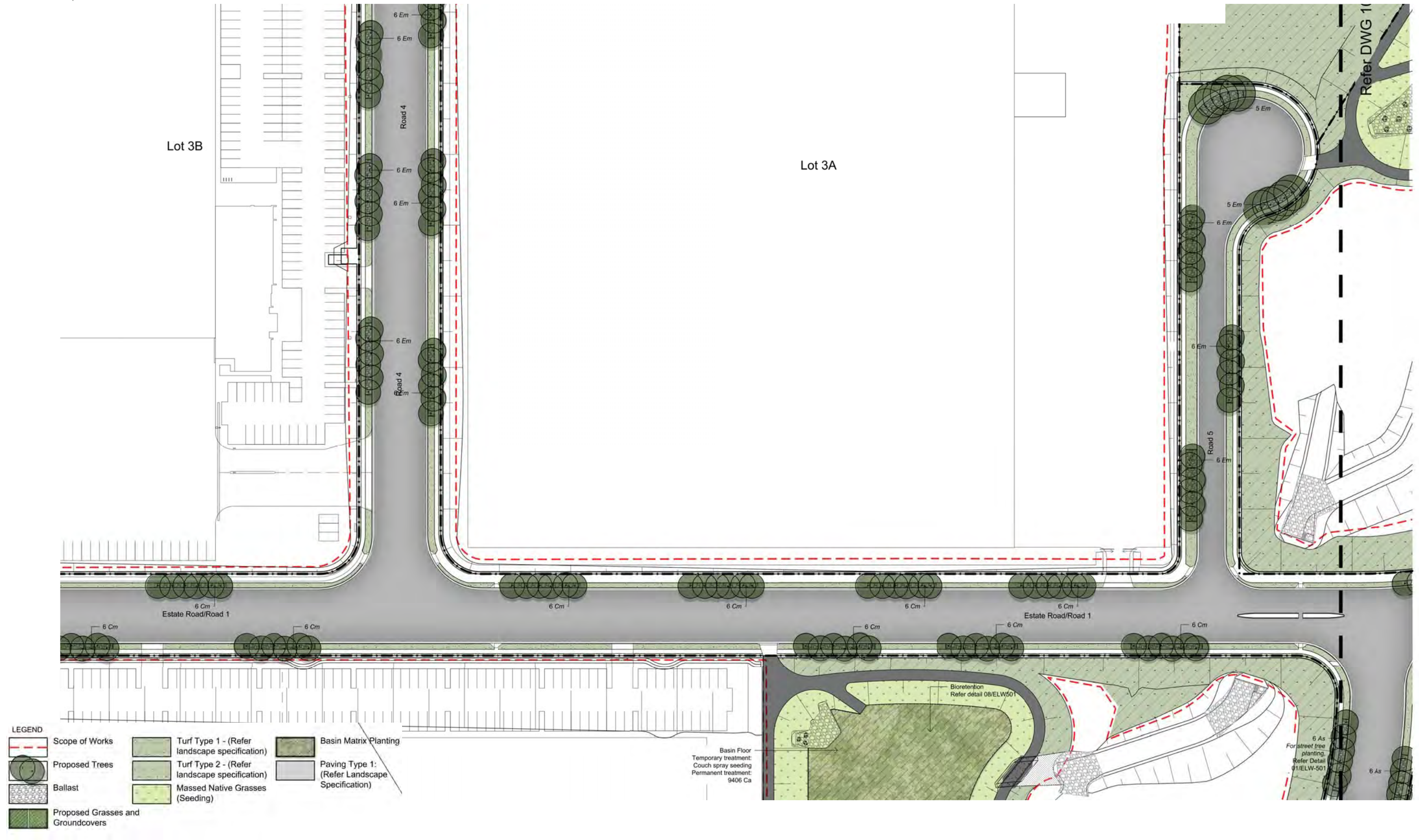

Estate Landscape Works
Landscape Plan

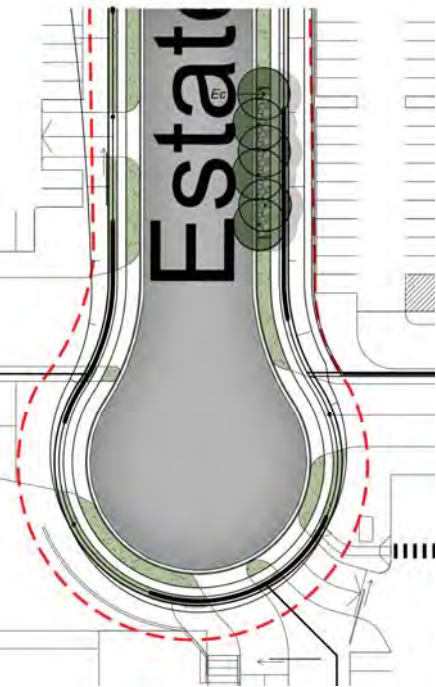
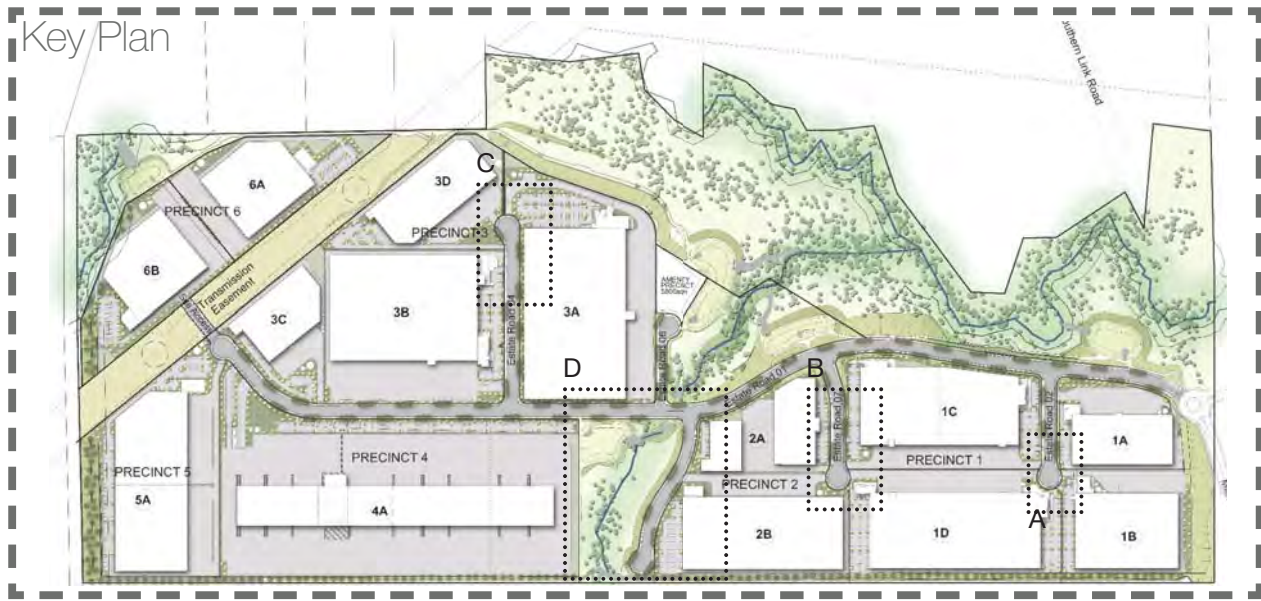

Plan A

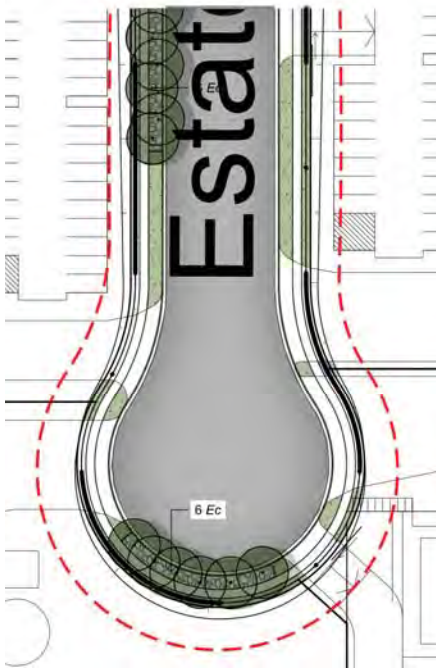

Plan B

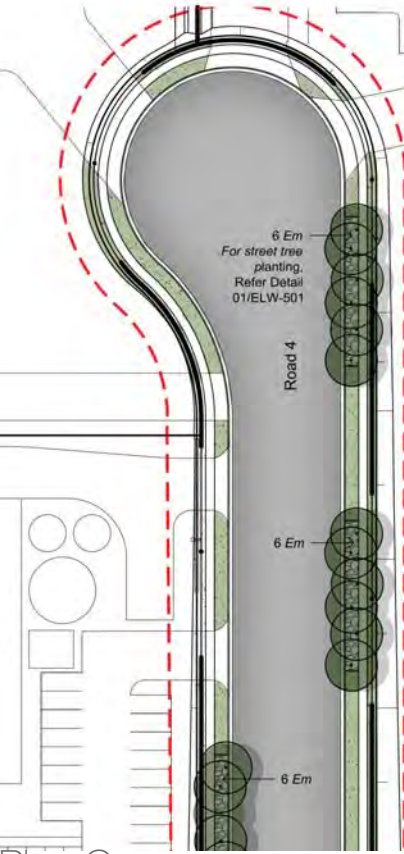

Plan C

- LEGEND
- | | | |
|-----------------------------------|---|--|
| Scope of Works | Turf Type 1 - (Refer landscape specification) | Basin Matrix Planting |
| Proposed Trees | Turf Type 2 - (Refer landscape specification) | Paving Type 1: (Refer Landscape Specification) |
| Ballast | Massed Native Grasses (Seeding) | |
| Proposed Grasses and Groundcovers | | |



Plan D



Estate Landscape Works
Landscape Plan



Plan A



Plan B

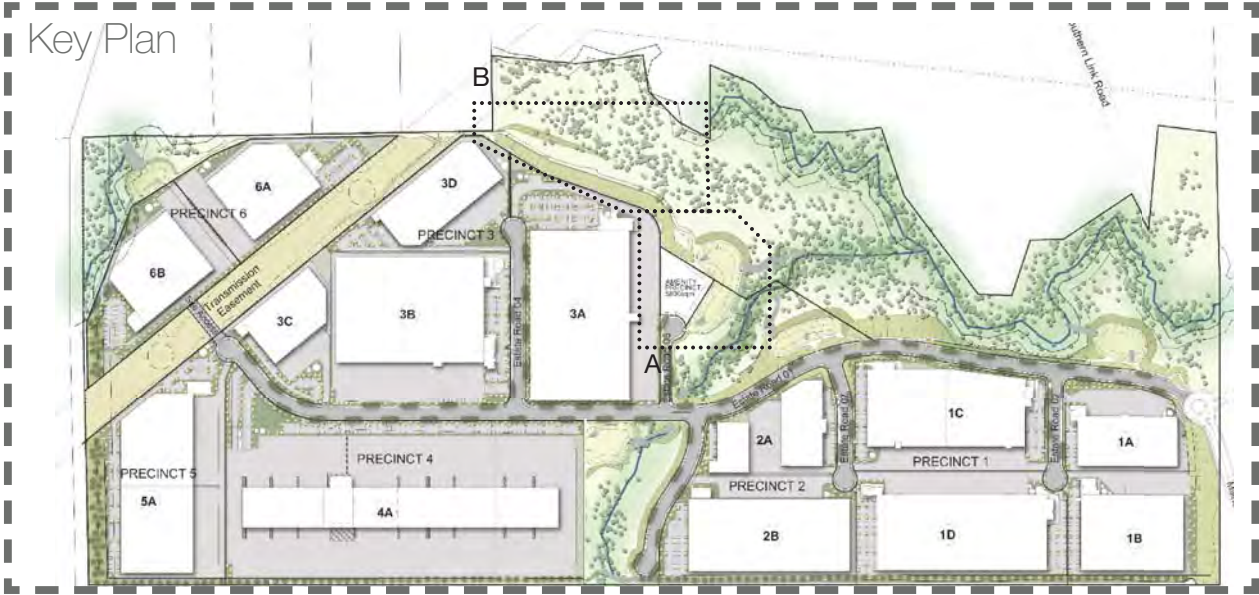

Key Plan

LEGEND

	Scope of Works		Turf Type 1 - (Refer landscape specification)		Basin Matrix Planting
	Proposed Trees		Turf Type 2 - (Refer landscape specification)		Paving Type 1: (Refer Landscape Specification)
	Ballast		Massed Native Grasses (Seeding)		
	Proposed Grasses and Groundcovers				

Landscape Plan

Plan B

Plan C

Key Plan

ELW - 008
O
2.02.2018

Estate Landscape Works
Landscape Plan



Plan A

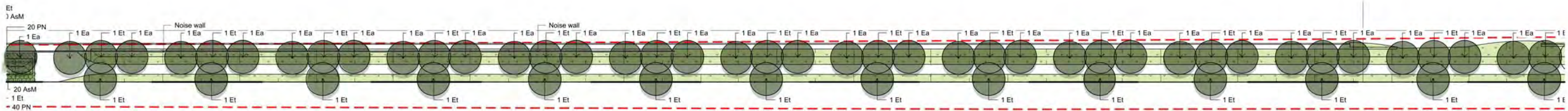

Plan B

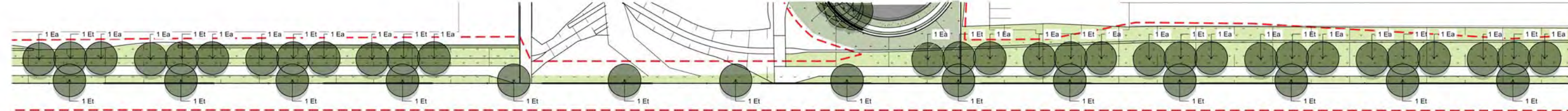

Plan C

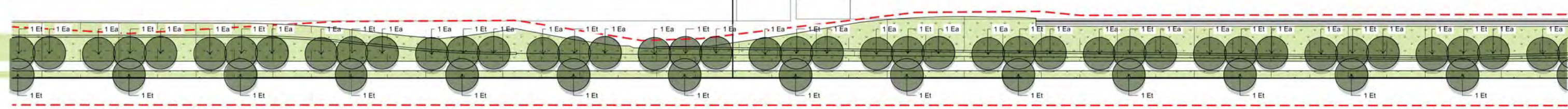

Plan D

