



SHEET	TITLE	SCALE
LANDSCAPE DRAWINGS		
L.DA.000	Key Plan	NA
L.DA.001	Summary of changes overview	
L.DA.002	Overview Plan	1:400 @A1
L.DA.101	Finishes Plan 1 of 4	1:200 @A1
L.DA.102	Finishes Plan 2 of 4	1:200 @A1
L.DA.103	Finishes Plan 3 of 4	1:200 @A1
L.DA.104	Finishes Plan 4 of 4	1:200 @A1
L.DA.201	Detail Area 1 of 3	1:100 @A1
L.DA.202	Detail Area 2 of 3	1:100 @A1
L.DA.203	Detail Area 3 of 3	1:100 @A1
L.DA.204	Planting Schedule	N/A

DRAFT

[illegible]

This drawing provides an overview of the landscape and public domain changes from the initial Development Application (16.06.2015) and the proposed Section 96 Submission

SHOWGROUND ROAD

Removed from initial Development Application

- 1) Planting & road blisters on Showground Road
- 2) Future Development Area

*Newly incorporated for Section 96
Development Application*

- ### 3) Planter troughs along the eastern edge

LEVEL 6 PLAZA

Removed from initial Development Application

- 4) Rooftop Garden Area
- 5) Retail Garden Zone - turf, trees and raised beds
- 6) Viewing Platforms with historic platforms
- 7) Turf insitu concrete

8) Trees between building A & B

*Newly incorporated for Section 96
Development Application*

- 11) Corten Steel raised beds & seating

HOLDEN STREET LINK

Removed from initial Development Application

- 12) Steps on Holden Street
- 13) Street furniture & lighting

- 14) Boundary reconfiguration - west of Holden Street
e.g. planting, trees, raised beds, ramps, street furniture

- 15) Bus stop

- 16) Entry point street trees north & south

*Newly incorporated for Section 96
Development Application*

- 17) Increased provision of green space
- 18) Retaining wall

- ### LEVEL 7 TERRACE

Removed from initial Development Application

- 19) 1.8 Metre wind awning
- 20) Turf insitu concrete
- 21) Raised Planters, trees and vegetation
- 22) Step into Building A
- 23) Ramp into Building B

*Newly incorporated for Section 96
Development Application*

- 24) Shaded canopy

* Please refer to L.DA.204 for changes to species list

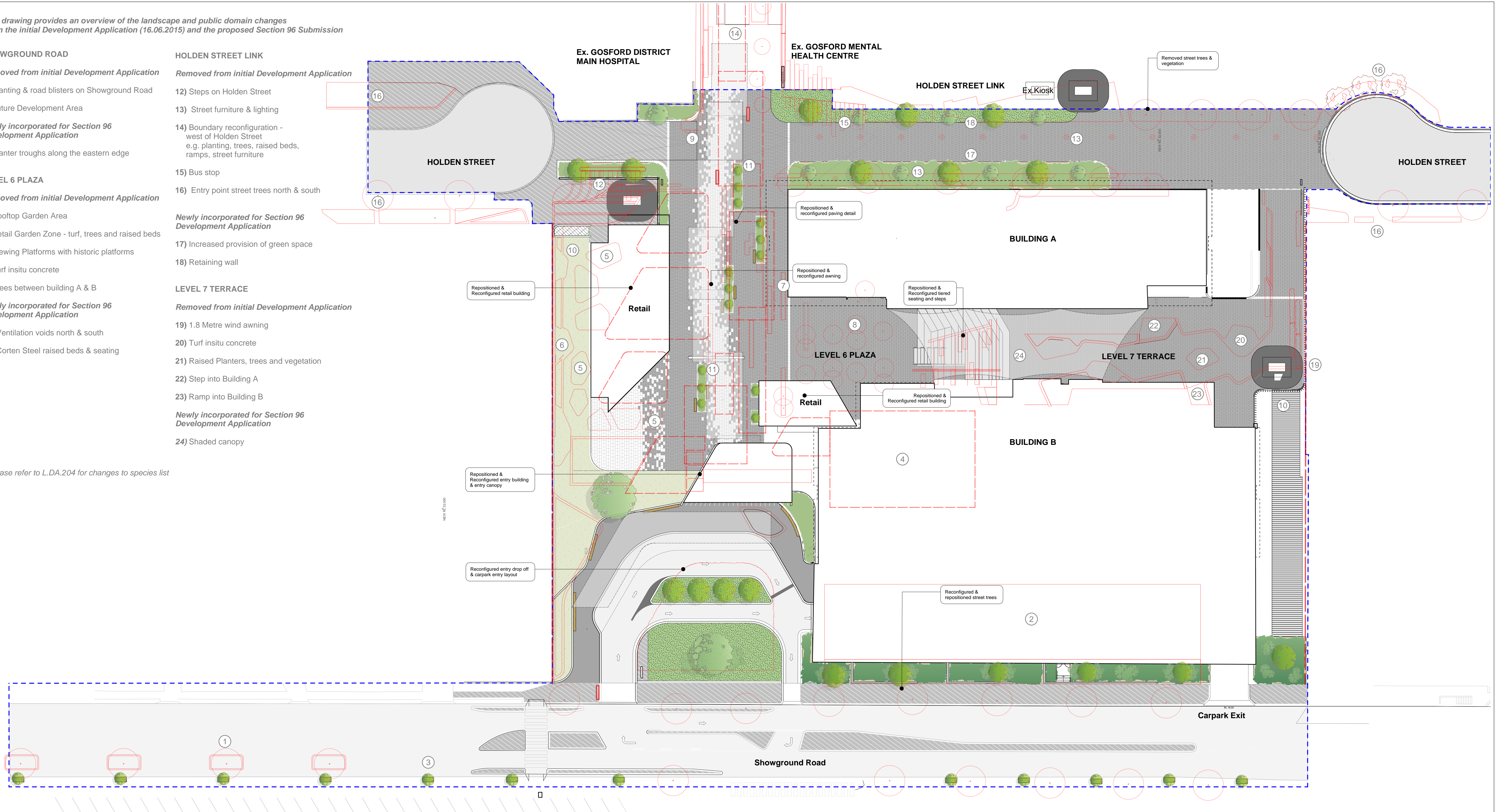

KEY

General

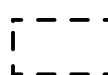

HWP Extent of Works



Proposed building footprint



Proposed canopy (Refer Archi Dwg)

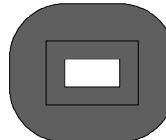

Proposed kiosks



Outline of initial from
DA Submission
(16.06.2015)



Proposed concrete

Resheet concrete
(Refer Civil Dwg)



Existing trees



Proposed trees

[illegible]

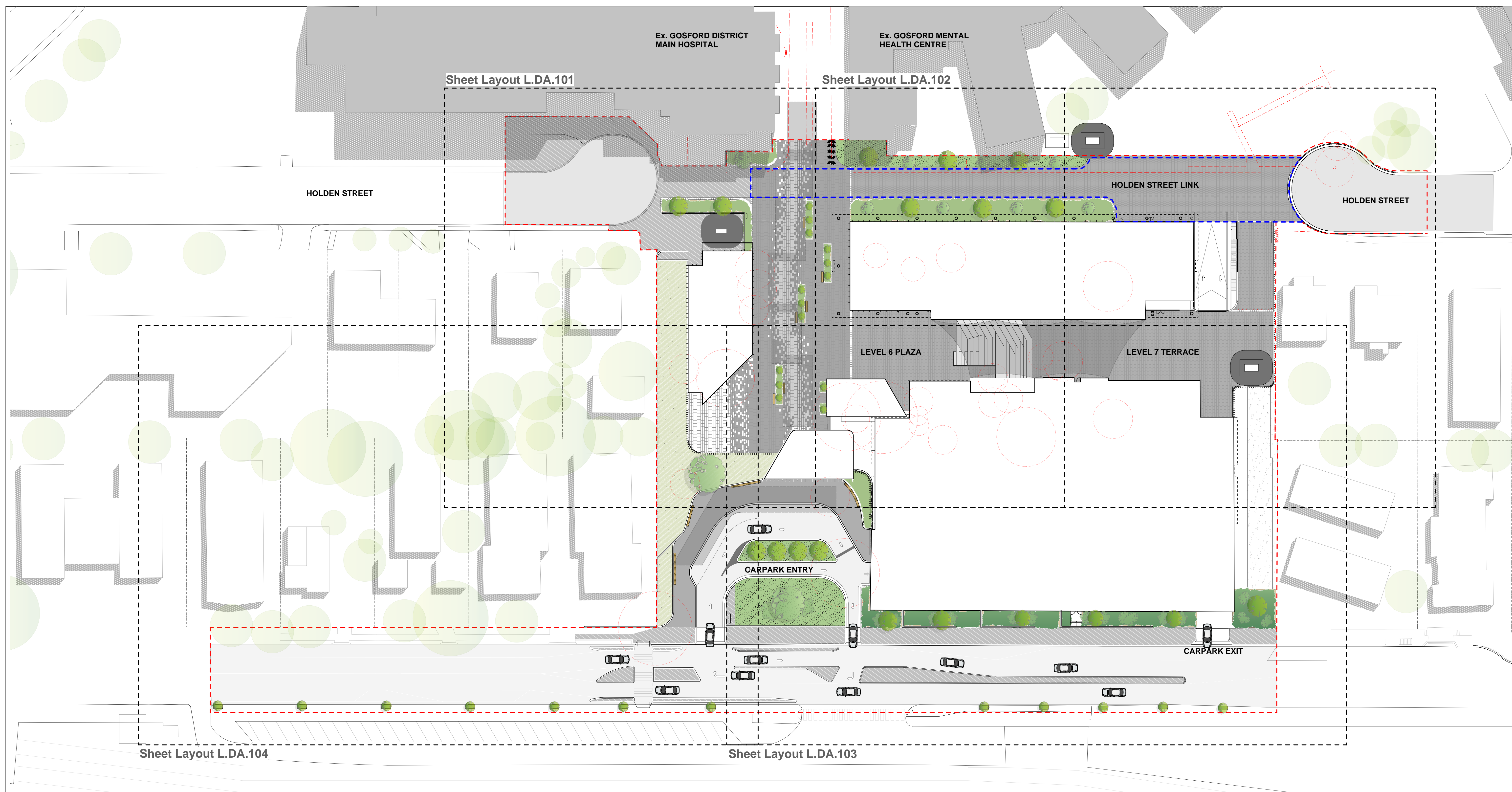

KEY

General



HWP Extent of Works

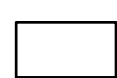

Proposed building footprint



Proposed canopy (Refer Archi Dwg)



Removed existing items



Trafficable zone



Proposed kiosks



Existing Gosford Hospital



Proposed concrete



Existing trees



Removed trees



Proposed street furniture

Existing Buildings

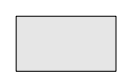

Resheet concrete
(Refer Civil Dwg)



Proposed trees

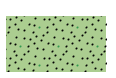

Planted beds



Infrastructure easement
(Refer Civil Dwgs)

[illegible]

LANDSCAPE ARCHITECTS
Spackman Mossop Michaels
Level 1 - 3 Oxford Street,
Paddington, NSW 2021

STRUCTURAL ENGINEERS
Enstruct
4/2 Glen St, Milsons Point,
NSW 2061

ARCHITECTS
fitzpatrick+ partners
Level 6 - Clarence Street, NSW 2000.

CLIENT
Lend Lease
30 Hickson Road
Millers Point, NSW 2000

Do not scale from this Drawing, use figured dimensions only. Check all dimensions on site before commencing work. Report any discrepancies to Landscape Architect before proceeding. This Drawing and Designs thereon are copyright of Spackman Mossop Michaels. ©

Refer Civil Drawings for Levels and Drainage

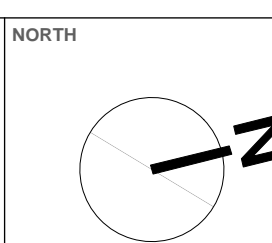

FOR
NSW HEALTH INFRASTRUCTURE
77 PACIFIC HWY
NORTH SYDNEY NSW 2060

 **NSW**
GOVERNMENT

Health
Infrastructure

PROJECT TITLE
GOSFORD HOSPITAL - HEALTH AND WELLBEING
PRECINCT

**SPACKMAN
MOSSOP ^{AND}
MICHAELS**

DRAWING STATUS	50% PRELIMINARY DD +VE ISSUE DRAFT
----------------	------------------------------------

TITLE	
	SHEET LAYOUT

DRAWN FM	PLOT DATE 28/07/2016	SCALE @A1 1:200	
CHECKED MS	PROJECT NO. 14070	DRAWING NO. L.DA.002	REV. NO. 1