

QUARRY - WEST

QUARRY - EAST

### PROPOSED LANDSCAPE MASTERPLAN

The Quarry West development proposes to build on the character of the neighbouring development of Quarry East, but with it's own identity and framework of landscape to integrate with the signage & fencing.

Fencing & Signage will be carried out as per the approved strategies.

A strong streetscape structure with tree planting and native grasses & groundcover planting is proposed (Refer to drawing LA03 for details).

It is proposed to retain as much existing vegetation to precinct F as practical.

## PROPOSED LANDSCAPE MASTERPLAN



**SITE IMAGE**  
Landscape Architects

DEXUS QUARRY WEST  
RECONCILIATION ROAD, PEMULWUY



Client Dexus Wholesale Management  
Trustee for DEXUS West Subtrust  
Site Image Job Number SS14-2875  
Scale NTS

Drawing Number  
Issue  
Date

LA02  
M  
04 October 2017



Primary Streetscape

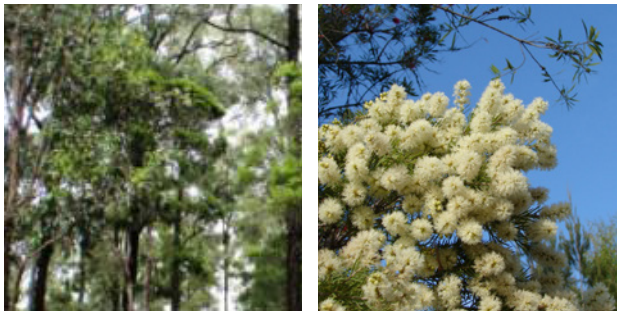

Melaleuca decora

Secondary Streetscape



Elaeocarpus reticulatus

Reconciliation Road



Backhousia myrtifolia

Internal Landscape



Elaeocarpus reticulatus

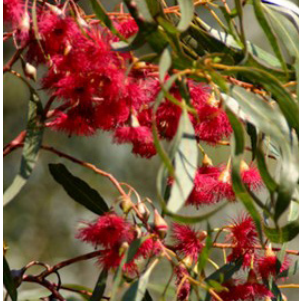

Eucalyptus leucoxylon 'Rosea'

Perimeter Landscape



Melaleuca stephelioides

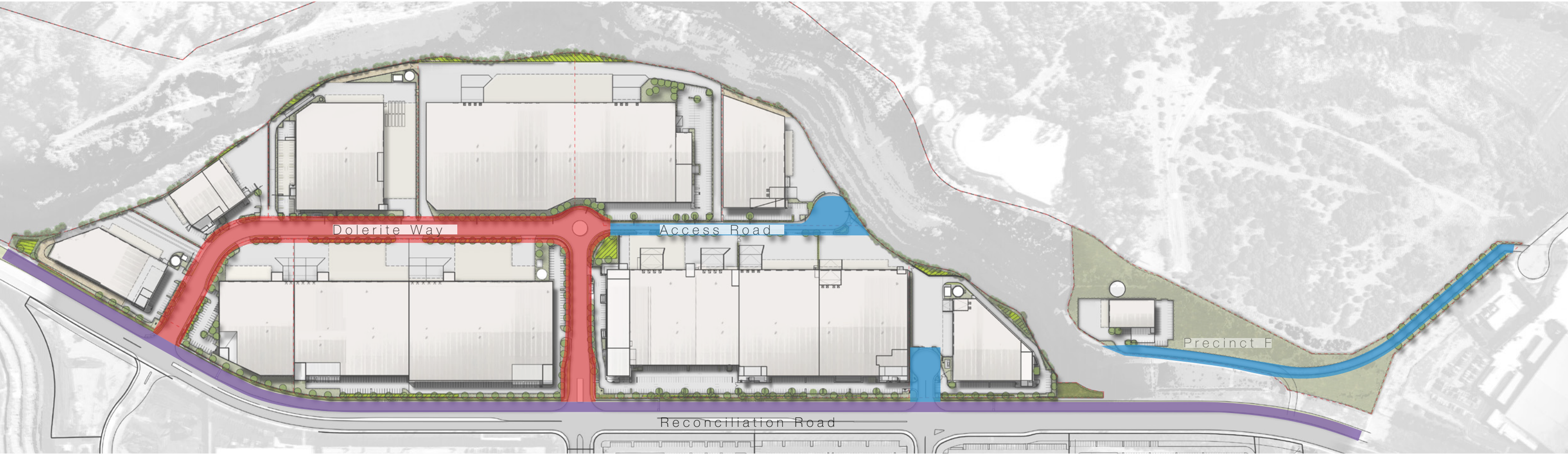

KEY

-  Reconciliation Road Dedication Zone (Restricted Planting)
-  Primary Streetscape Treatment
-  Secondary Streetscape Treatment

Primary Streetscape

Tree planting is proposed to create a streetscape character to the Primary roads of Dolerite Close and Basalt Road.. Tree planting is proposed within the precinct boundary, but outside the fence line:

- *Melaleuca decora*: 10-12 x 3m

Secondary Streetscape

Small scale tree planting is proposed to create shade, screening and visual interest:

- *Elaeocarpus reticulatus*: 8-10 x 5m

Precinct F

The steepness of the site and access road limits the proposed structure tree planting here to small native tree planting with a visual interest:

- *Melaleuca stephelioides*: 6-10 x 3m

Reconciliation Road

Tree planting within the precinct boundary, is proposed to use small form tree planting as a green corridor to Reconciliation Road:

- *Backhousia myrtifolia* 6 x 5m

Internal Landscape

Tree planting within the precinct boundary, proposed to be small scale native tree planting with strong visual interest:

- *Backhousia myrtifolia* 6 x 5m
- *Elaeocarpus reticulatus*: 12 x 5m
- *Eucalyptus leucoxylon 'Rosea'*: 5-10m h
- *Tristaniopsis laurina*: 10m h

Perimeter Landscape

Tree planting within the precinct boundary, to form a buffer area to the edge of the development using small scale planting stock of a mix of species including;

- *Acacia parramattensis*: 10 x 6m
- *Melaleuca decora*: 6-10m x 3m
- *Melaleuca stephelioides*: 6-10 x 3m

STREETSCAPE CHARACTER ZONES





- LEGEND
- Boundary Tree Planting
  - Tree Planting
  - Mown Lawn
  - Shrub/Native Grasses
  - BS Bus Stop
  - Planting to Bio retention Basin
  - Fire Trail Surfacing

NOTES

1. Refer to LA09 for fencing masterplan
2. Refer to LA11 for signage masterplan



## PROPOSED LANDSCAPE MASTERPLAN AREA 1



**SITE IMAGE**  
Landscape Architects

DEXUS QUARRY WEST  
RECONCILIATION ROAD, PEMULWUY



Client Dexus Wholesale Management  
Trustee for DEXUS West Subtrust  
Site Image Job Number SS14-2875  
Scale 1:1500 @ A3

Drawing Number  
Issue  
Date

LA05  
M  
04 October 2017





# PROPOSED LANDSCAPE MASTERPLAN AREA 2





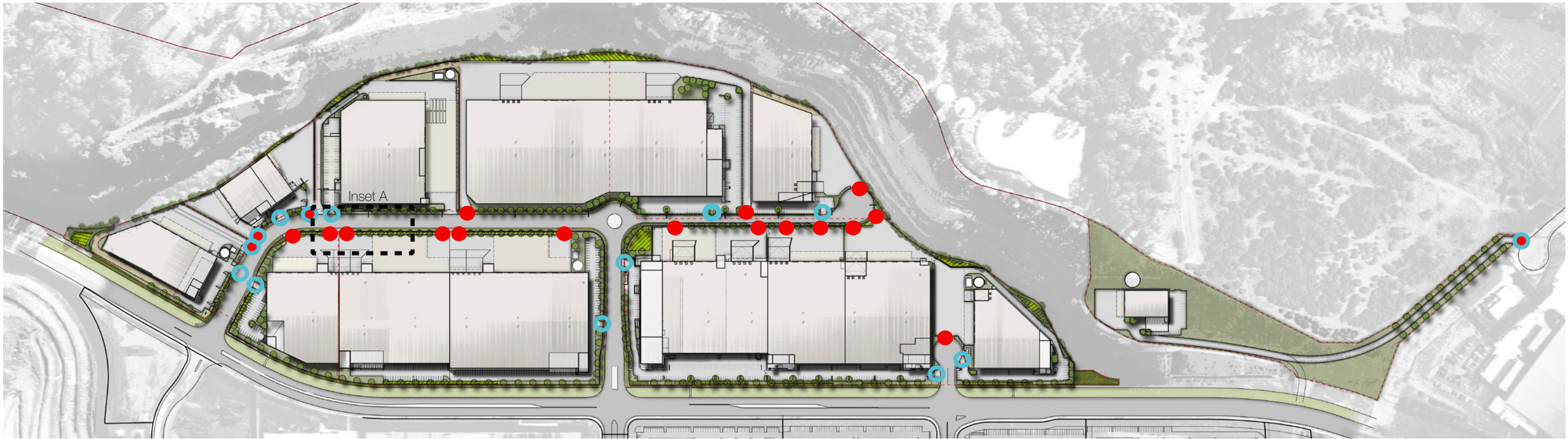

- KEY**
- Truck Entry and Exit
  - Vehicular Access

# TRUCK AND VEHICULAR ACCESS ANALYSIS

Truck and vehicle access points will determine street tree setout to some extent. Refer inset A for typical guidelines.

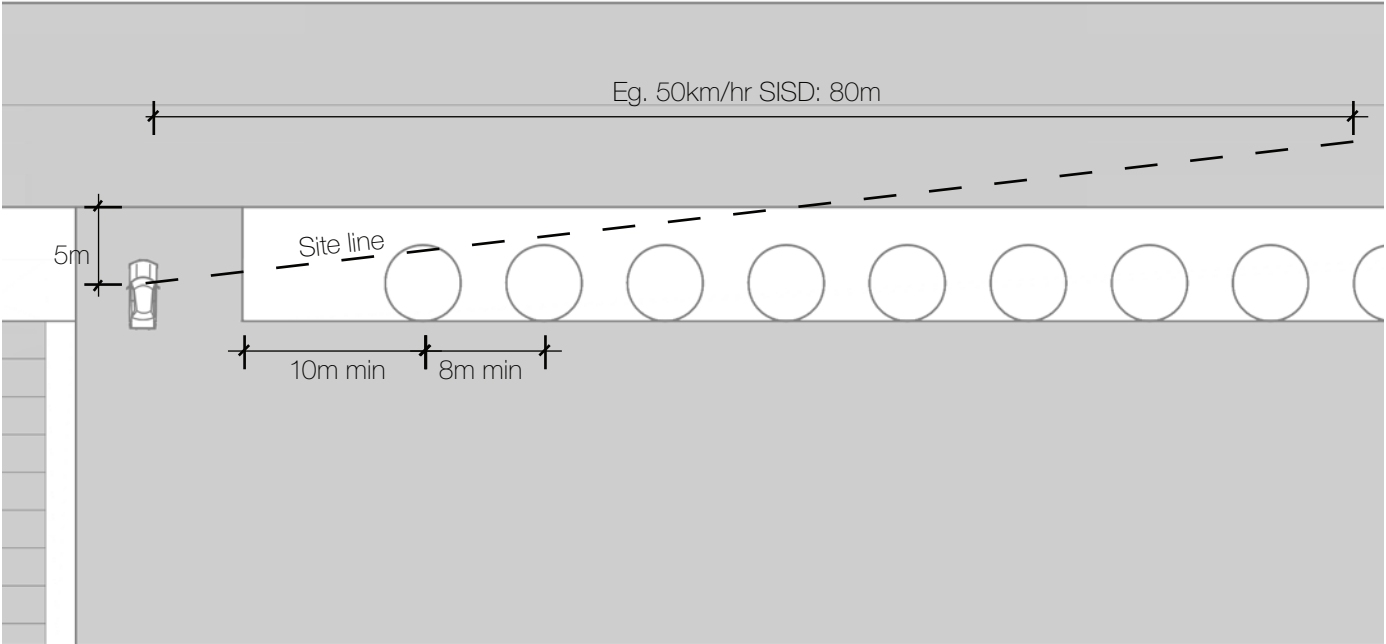

Inset A: Street tree setout in relation to truck access







## JAW CRUSHER LANDSCAPE INTEGRATION

Integrating the heritage protected Jawcrusher back into the landscape gives the development a chance to celebrate the site's former use as a quarry. There are examples around the world where industrial relics are not shunned to the corner, rather celebrated as prominent figures within their setting.

Possible design methods may include reusing site rocks with bands of ground covers blanketing its surrounds as seen in the above simulation with the Jaw crusher nested within a bed of native flowering Yellow Buttons (*Chrysocephalum apiculatum*).

It is proposed to locate the jaw crusher into a landscape area in front of one of the Warehouse developments along Reconciliation Road, adjusting the fenceline so that the Jaw Crusher is a visible statement to the Quarry West development



Proposed use of native species: *Chrysocephalum apiculatum* (Yellow Buttons)

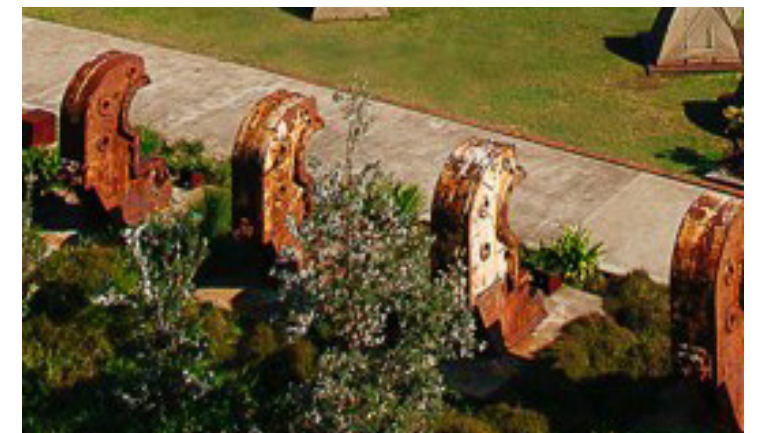

Industrial relics planted out within a bed of native grasses (Cockatoo Island, Sydney)

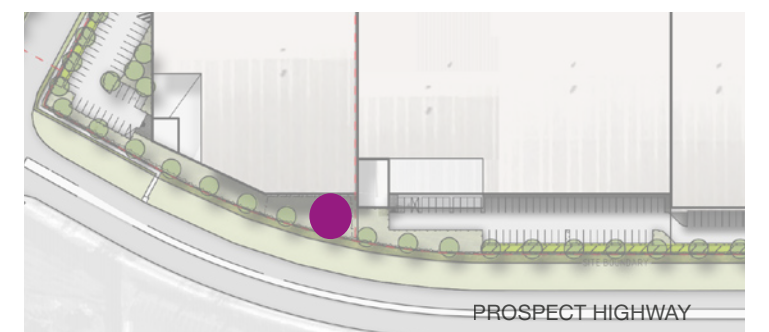

Jaw crusher to be placed along frontage to site for high visibility



**SITE IMAGE**  
Landscape Architects

**DEXUS QUARRY WEST**  
RECONCILIATION ROAD, PEMULWUY

Client Dexus Wholesale Management  
Trustee for DEXUS West Subtrust  
Site Image Job Number SS14-2875

Drawing Number  
Issue  
Date

LA013  
M  
04 October 2017



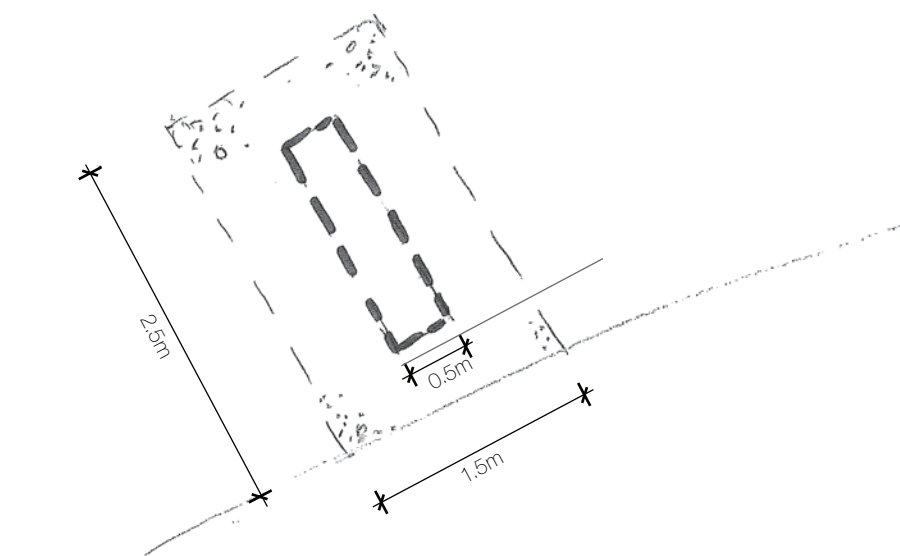

A. VERTICAL ELEMENT

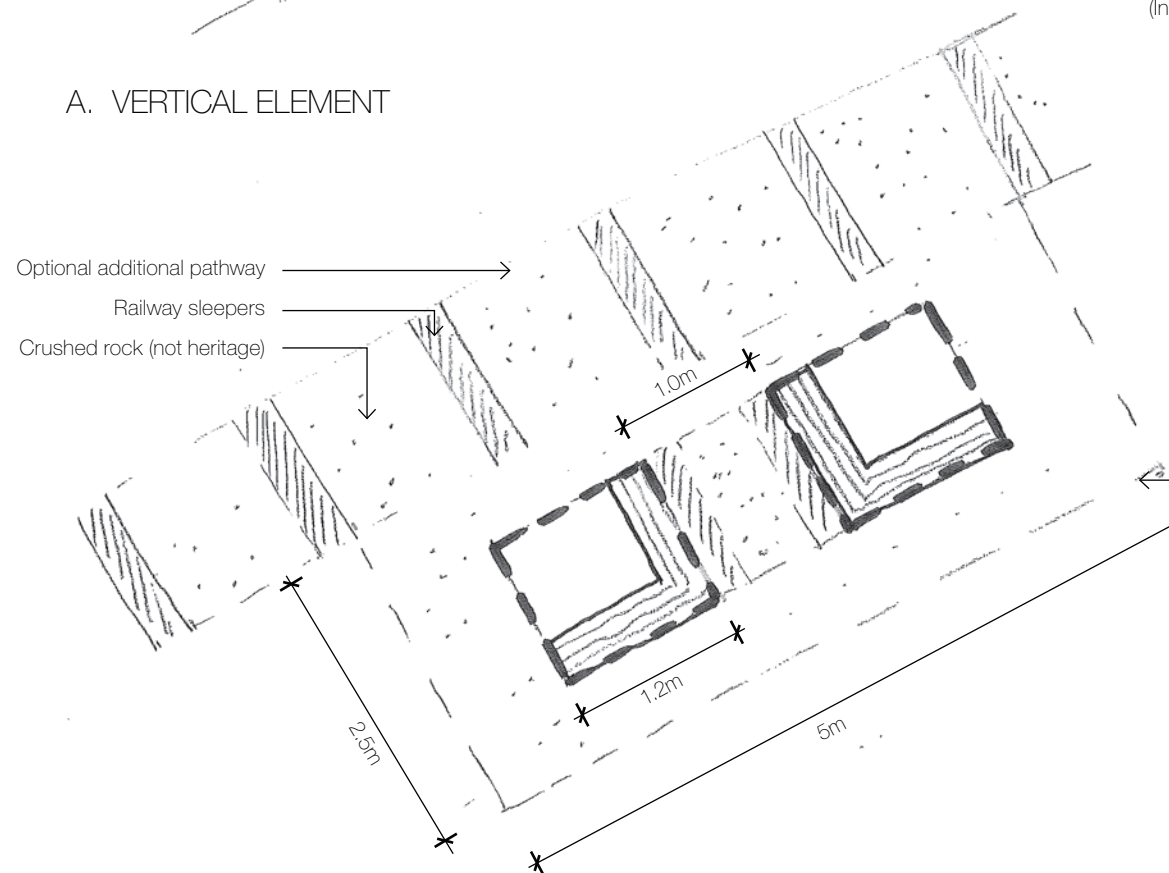

B. HORIZONTAL / FUNCTIONAL ELEMENT

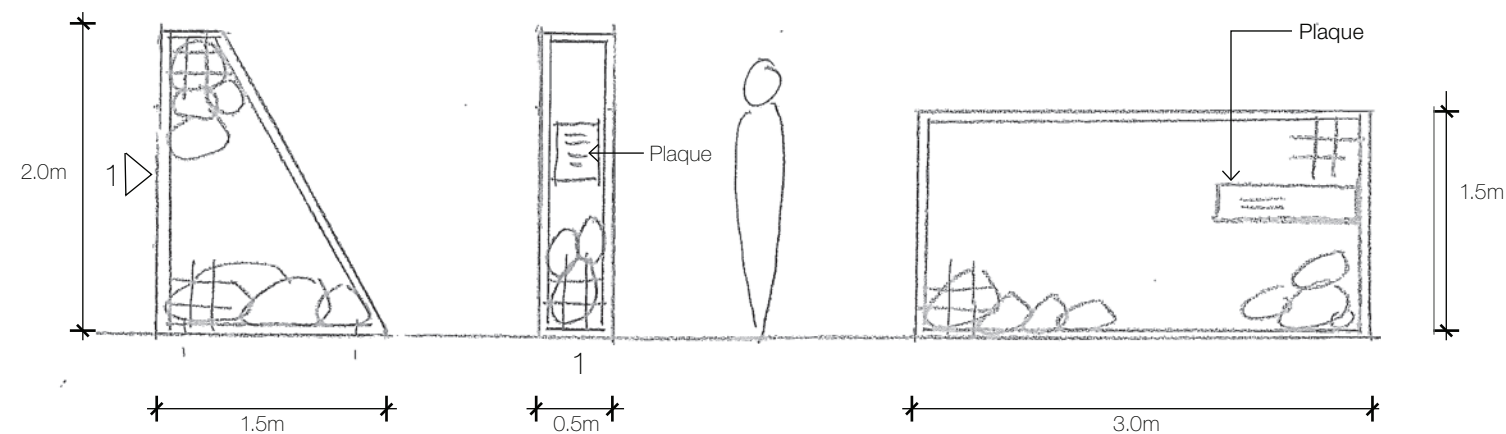

- Opportunity to uplight the vertical element
- Heritage rocks inside the gabion cage

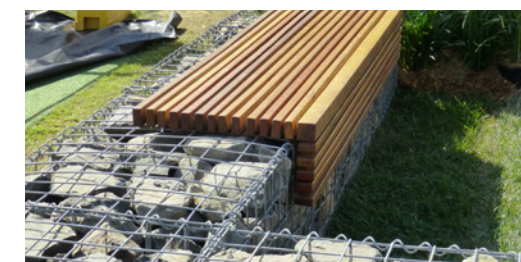
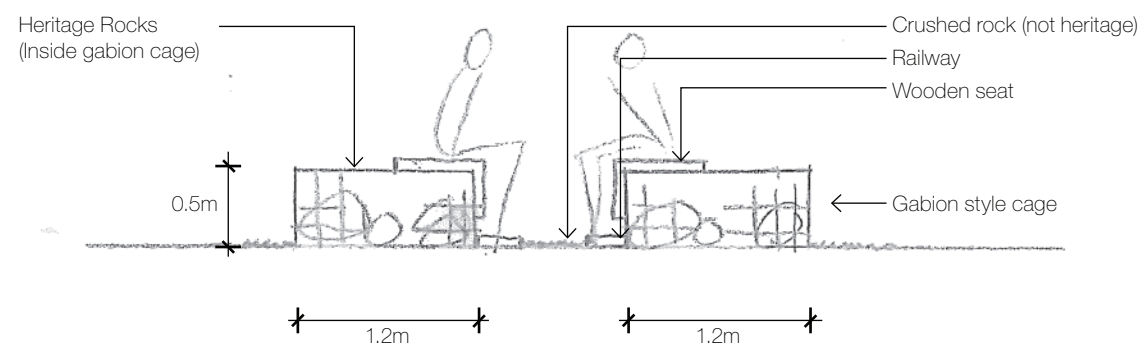

Gabion seat combination example



Heritage site rocks



Heritage rock feature to be located alongside the Jaw Crusher artifact, potentially in a 'breakout' space area.

## CONCEPT

The Heritage Rocks (found on site and now protected) are proposed to be utilised to form either a vertical element or incorporated into a seating element. It is proposed that the heritage rocks are also located in a landscape area adjacent to one of the Warehouse developments fronting Reconciliation Road in conjunction with the jaw crusher. The Rocks may be incorporated into a 'breakout' area space associated with the Warehouse.

If the seating area is adopted, a supplementary access footpath made of railway sleepers and crushed rock could be incorporated (as per the sketch) to reference the original railway from where the Heritage Rocks were found.

Crushed rock (not heritage) may be utilised from stockpiles from the Quarry West, at the base of either feature.

# HERITAGE ROCK FEATURE IDEAS



**SITE IMAGE**  
Landscape Architects

**DEXUS QUARRY WEST**  
RECONCILIATION ROAD, PEMULWUY

Client: Dexus Wholesale Management  
Trustee for DEXUS West Subtrust  
Site Image Job Number: SS14-2875

Drawing Number  
Issue  
Date

LA014  
M  
04 October 2017