

7 November 2017

**Andrew Needham**

Dexus - Industrial Development  
Australia Square,  
Level 25, 264-278 George Street  
Sydney NSW 2000  
Per Email:

[andrew.needham@dexus.com](mailto:andrew.needham@dexus.com)

Dear Andrew,

**RE: RELOCATION OF HERITAGE INTERPRETIVE ELEMENTS - DEXUS QUARRY WEST  
PROJECT (SSD 6801)**

Further to the request of Dexus I have reviewed the proposed Landscape Masterplan dated 4 October 2017 and prepared by Site Image Landscape Architects. I confirm that the proposed new location for the Jaw Crusher, the industrial relics and the historic rocks is acceptable and consistent with the aim of the original Heritage Interpretation Statement submitted in response to the Secretary's Environmental Assessment Requirements (SEARs) issued as part of the State Significant Development (SSD 6801). The subject Statement of Compliance dated 16 December 2014 was prepared with the following heritage requirement:

*heritage - demonstrate that the development is consistent with the Heritage Site Interpretation Strategy approved under the Greystanes Southern Employment Lands Concept Plan (MP06\_0181).*

The proposed concept and location as detailed on landscape drawings LA013 and LA014 reflect the intention of the original interpretive concept for these heritage elements and their integration into the landscape. Relevant pages from the Landscape Masterplan have been attached to this letter for the interested consent authority's information and for clarification of the drawings referred to in this statement.

If there is anything in the above statement or the following attachments that requires further clarification or detail please do not hesitate to call and discuss.

Yours Sincerely,



**Kerime Danis**

Director - Heritage



ATTACHMENT:

RELEVANT PAGES FROM THE LANDSCAPE MASTERPLAN BY SITE IMAGE



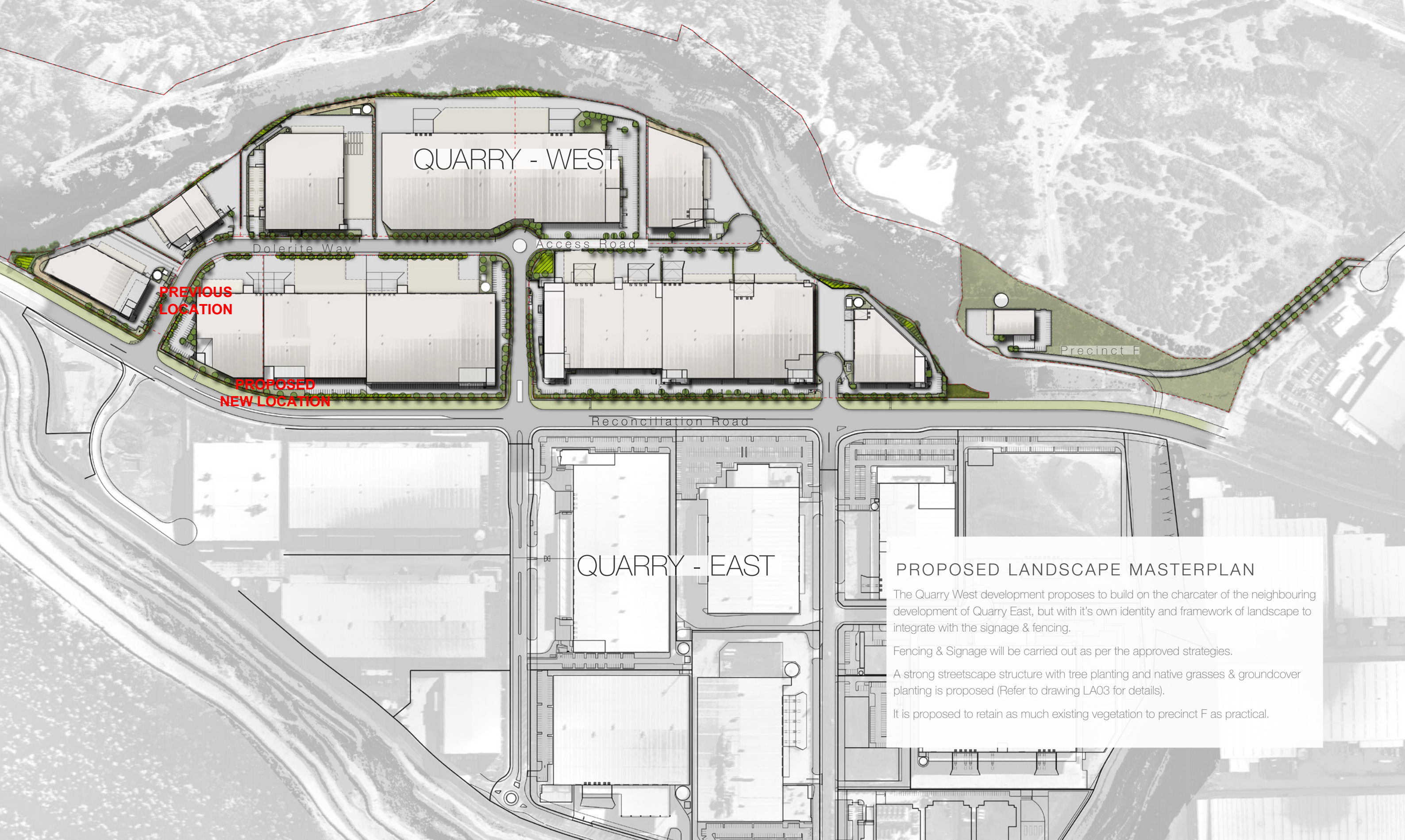

### PROPOSED LANDSCAPE MASTERPLAN

The Quarry West development proposes to build on the character of the neighbouring development of Quarry East, but with it's own identity and framework of landscape to integrate with the signage & fencing.

Fencing & Signage will be carried out as per the approved strategies.

A strong streetscape structure with tree planting and native grasses & groundcover planting is proposed (Refer to drawing LA03 for details).

It is proposed to retain as much existing vegetation to precinct F as practical.

## PROPOSED LANDSCAPE MASTERPLAN



**SITE IMAGE**  
Landscape Architects

DEXUS QUARRY WEST  
RECONCILIATION ROAD, PEMULWUY

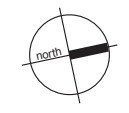

Client Dexus Wholesale Management  
Trustee for DEXUS West Subtrust  
Site Image Job Number SS14-2875  
Scale NTS

Drawing Number  
Issue  
Date

LA02  
M  
04 October 2017





# JAW CRUSHER LANDSCAPE INTEGRATION

Integrating the heritage protected Jawcrusher back into the landscape gives the development a chance to celebrate the site's former use as a quarry. There are examples around the world where industrial relics are not shunned to the corner, rather celebrated as prominent figures within their setting.

Possible design methods may include reusing site rocks with bands of ground covers blanketing its surrounds as seen in the above simulation with the Jaw crusher nested within a bed of native flowering Yellow Buttons (*Chrysocephalum apiculatum*).

It is proposed to locate the jaw crusher into a landscape area in front of one of the Warehouse developments along Reconciliation Road,adjusting the fenceline so that the Jaw Crusher is a visible statement to the Quarry West development



Proposed use of native species: *Chrysocephalum apiculatum* (Yellow Buttons)



Industrial relics planted out within a bed of native grasses (Cockatoo Island, Sydney)



Jaw crusher to be placed along frontage to site for high visibility



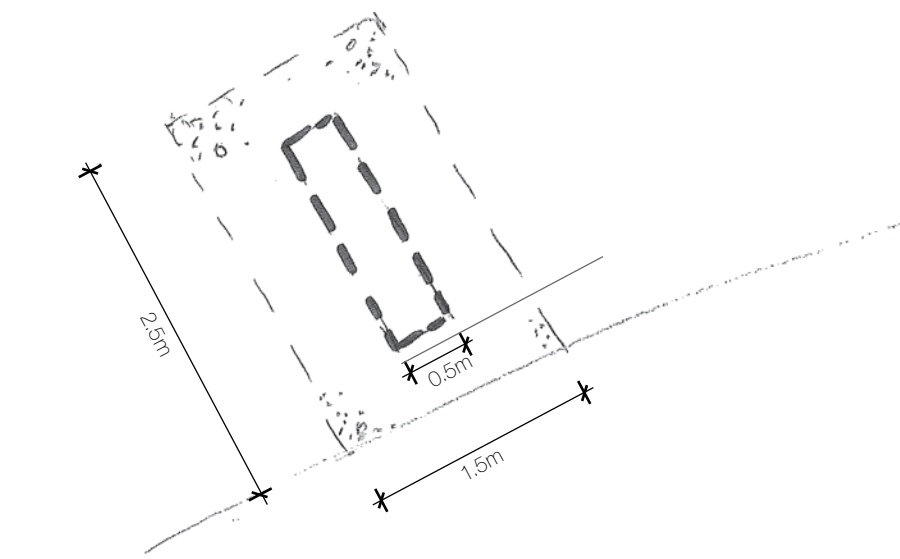

A. VERTICAL ELEMENT

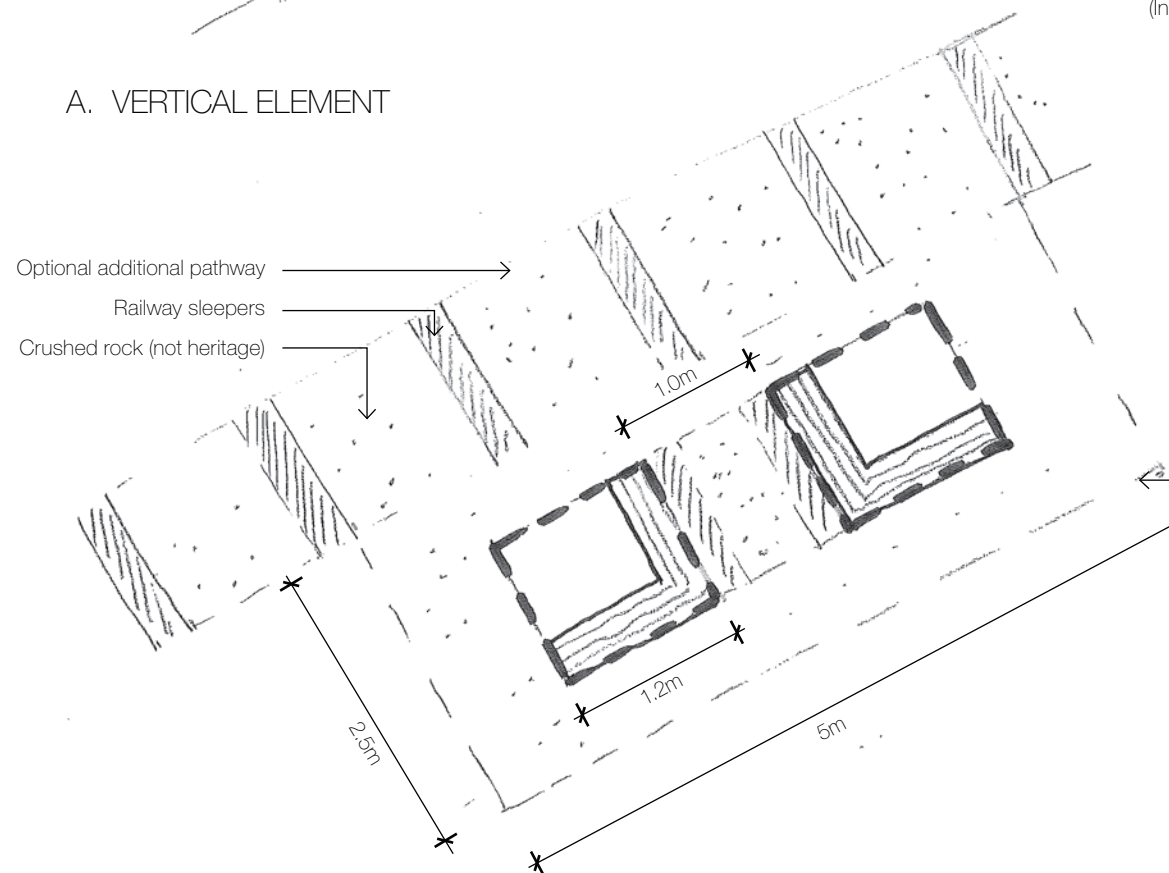

B. HORIZONTAL / FUNCTIONAL ELEMENT

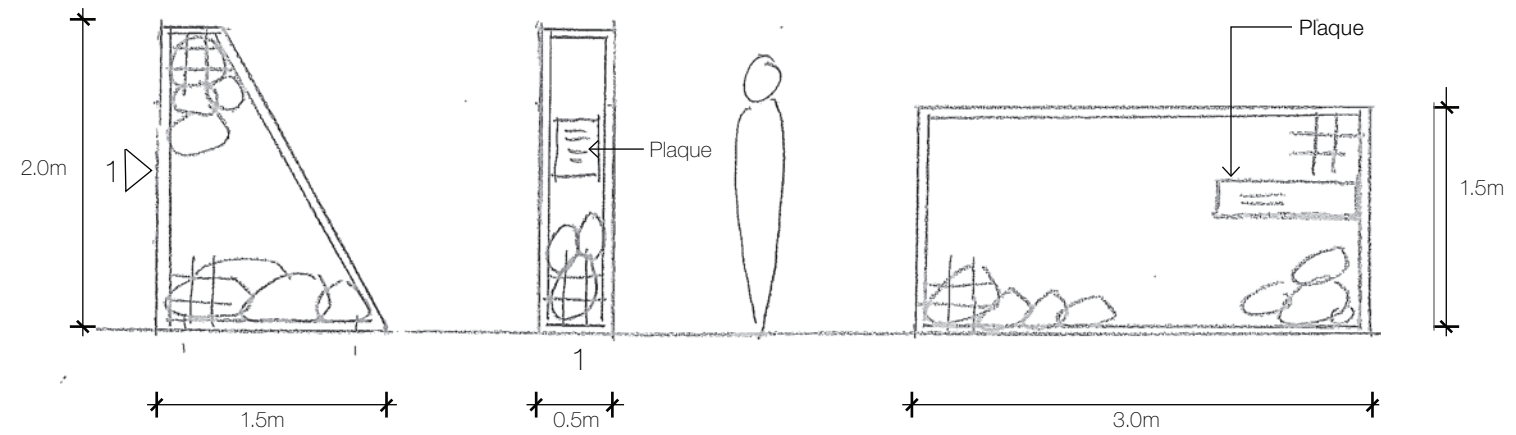

- Opportunity to uplight the vertical element
- Heritage rocks inside the gabion cage

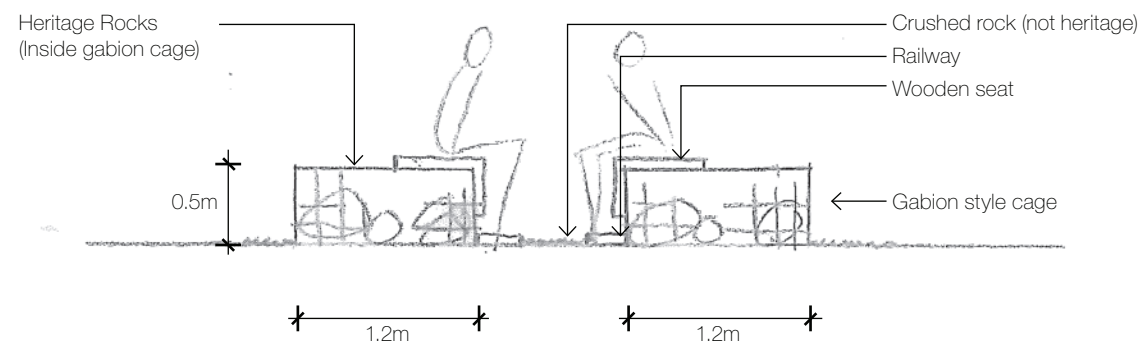

Proposed seating area using base material of crushed rock (not heritage) or decomposed granite.

## CONCEPT

The Heritage Rocks (found on site and now protected) are proposed to be utilised to form either a vertical element or incorporated into a seating element. It is proposed that the heritage rocks are also located in a landscape area adjacent to one of the Warehouse developments fronting Reconciliation Road in conjunction with the jaw crusher. The Rocks may be incorporated into a 'breakout' area space associated with the Warehouse.

If the seating area is adopted, a supplementary access footpath made of railway sleepers and crushed rock could be incorporated (as per the sketch) to reference the original railway from where the Heritage Rocks were found.

Crushed rock (not heritage) may be utilised from stockpiles from the Quarry West, at the base of either feature.



Gabion seat combination example



Heritage site rocks



Heritage rock feature to be located alongside the Jaw Crusher artifact, potentially in a 'breakout' space area.

# HERITAGE ROCK FEATURE IDEAS



**SITE IMAGE**  
Landscape Architects

**DEXUS QUARRY WEST**  
RECONCILIATION ROAD, PEMULWUY

Client: Dexu Wholesale Management  
Trustee for DEXUS West Subtrust  
Site Image Job Number: SS14-2875

Drawing Number  
Issue  
Date

LA014  
M  
04 October 2017