

Residential Void
Base of Residential Void
Hotel Level 13, Residential Level 11

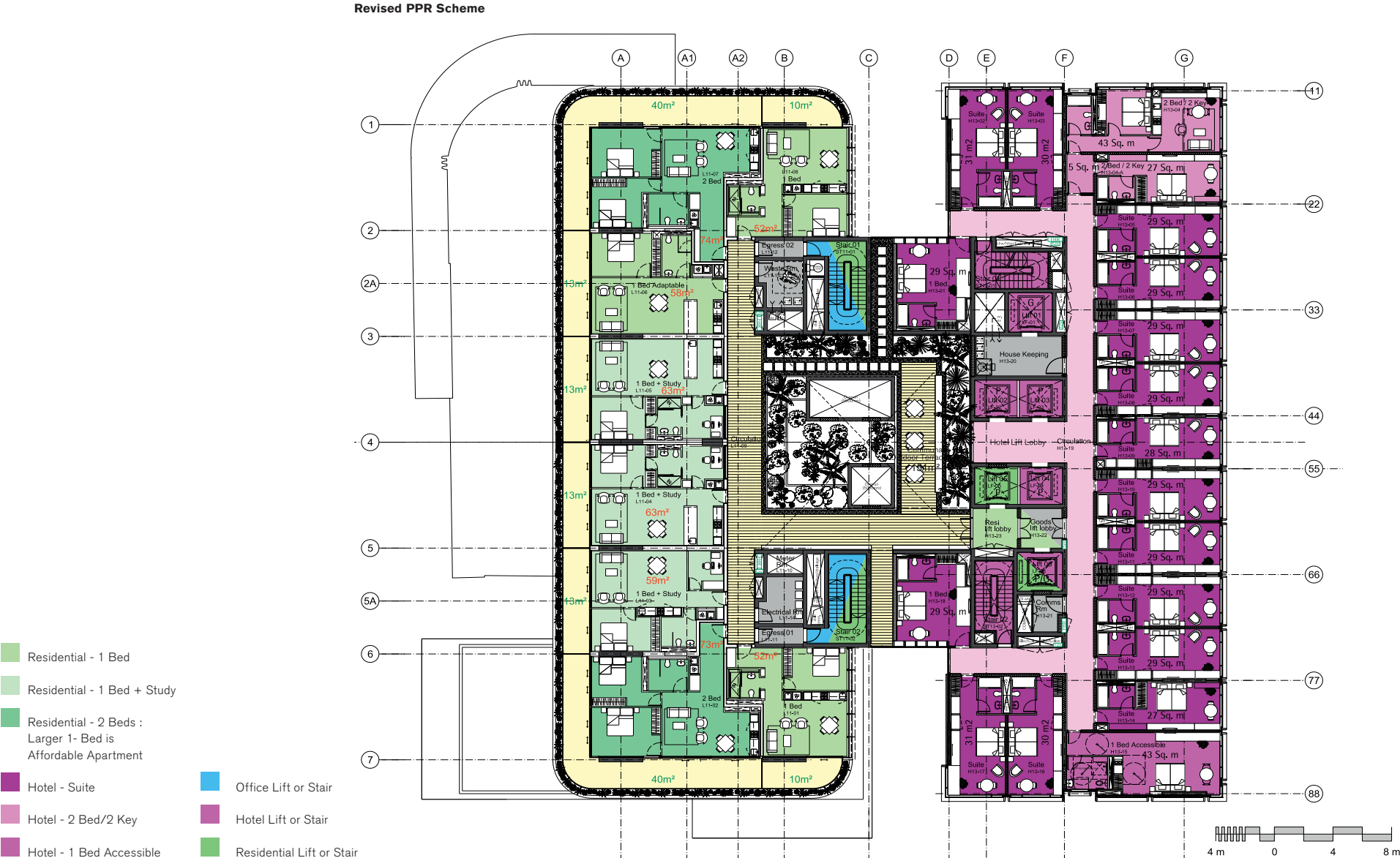

Residential Void

External Terrace Bridges
Hotel Level 14-18, Residential Level 11-16

The key revision in the design of the residential void has been to reconfigure the main link bridges connecting the residential lift lobbies with the general circulation walkways of the apartments. This was primarily driven from the structural design but also had the added benefit of improving the general light levels with the Residential Void. As stated, the main revision has been the "straightening" of the link bridges from the angular configuration of the SSDA proposal. This effectively means the link bridges now run along the south side of the void. Analysis conducted by WSP demonstrated that there would be improved daylight levels as a result.

SSDA Scheme

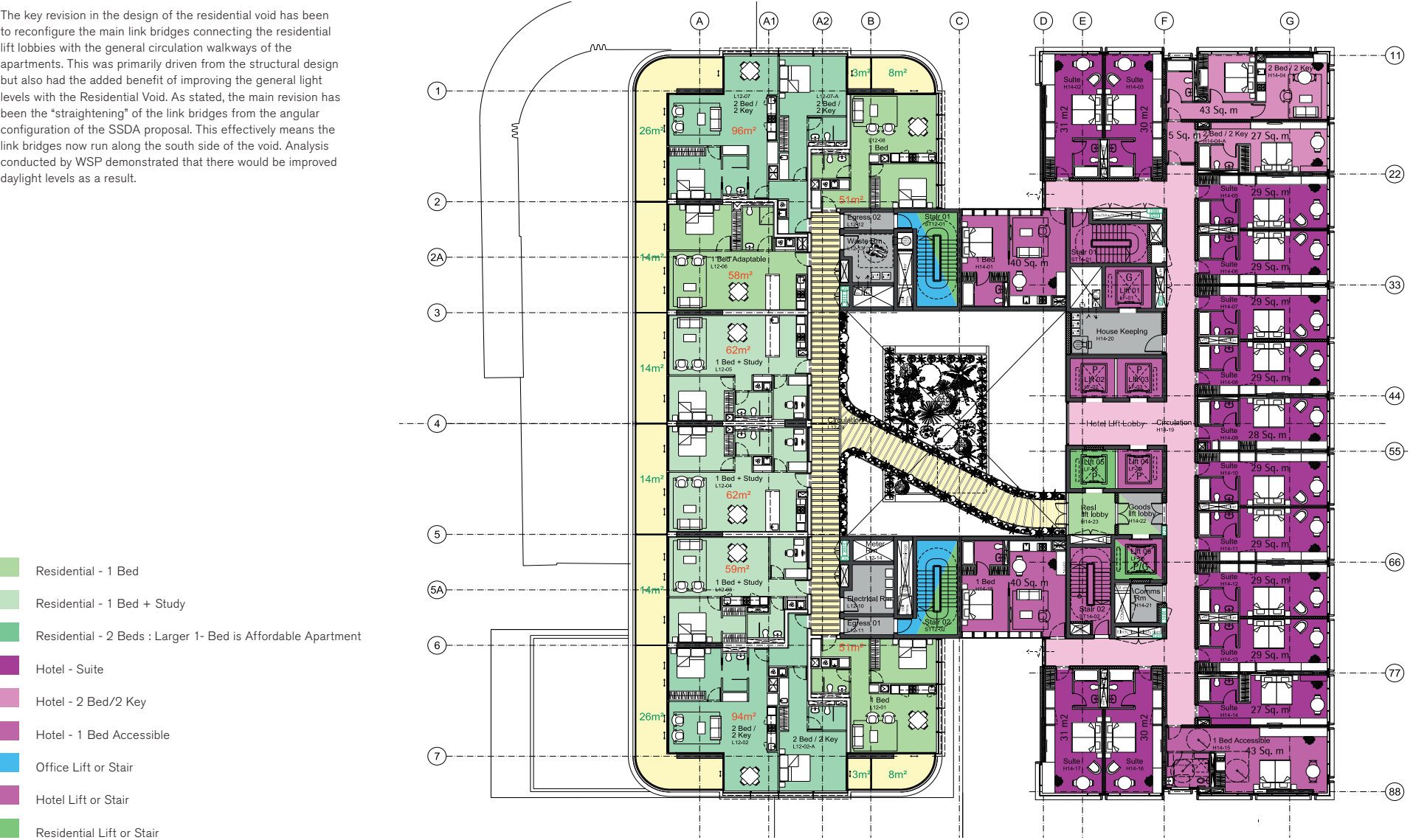

Residential Void

External Terrace Bridges

Hotel Level 14-18, Residential Level 11-16

Revised PPR Scheme

