

KEY

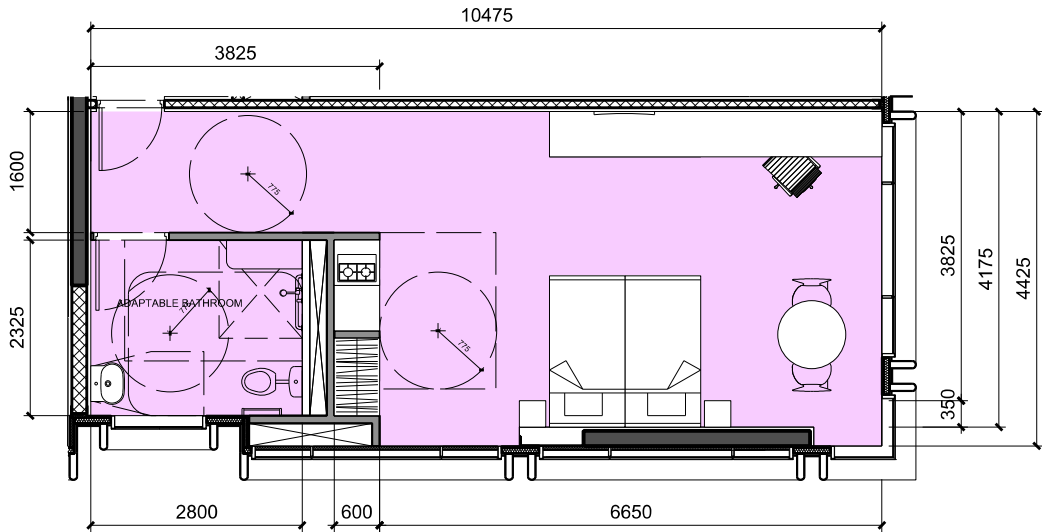

GFA 45 sqm

01 Typical Hotel 1-Bed - Type 3 - Accessible
1:100

- General Notes
1. Do not scale drawings. Dimensions govern.
 2. All dimensions are in millimetres unless noted otherwise.
 3. All dimensions shall be verified on site before proceeding with the work.
 4. Foster + Partners shall be notified in writing of any discrepancies.
 5. Any areas indicated on this sheet are approximate and indicative only.

Rev.	Date	Reason For Issue	Chk
00	15/10/14	SSD Application	RP

For information

Key Plan

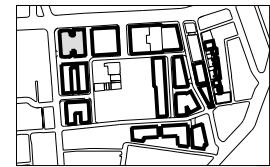

FRASERS PROPERTY

Project Frasers Broadway
20 - 102 Broadway Sydney NSW 2000

Client Frasers Broadway
L11, 488 Kent Street Sydney NSW 2000
T: 02 8623 8800 F: 02 8623 8801

Architect

Foster + Partners

Riverside, 22 Hester Road
London SW11 4AN
T +44 (0)20 7738 0455
F +44 (0)20 7738 1107

Local Collaborating Architect

PTW Architects

Level 17, 9 Castlereagh St
Sydney NSW 2000 Australia
T +61 (0)2 92250777
F +61 (0)2 9221 4139
www.ptw.com.au

Title

Block 4N
Hotel Typology
Typical 1-Bed - Type 3
Accessible

Project No:	Scale @ A3	Date	Drawn By
2094	1:100	02/10/14	GM

Number	Revision
PA-A4-1807	00