

01 21 June  
08:00 AM

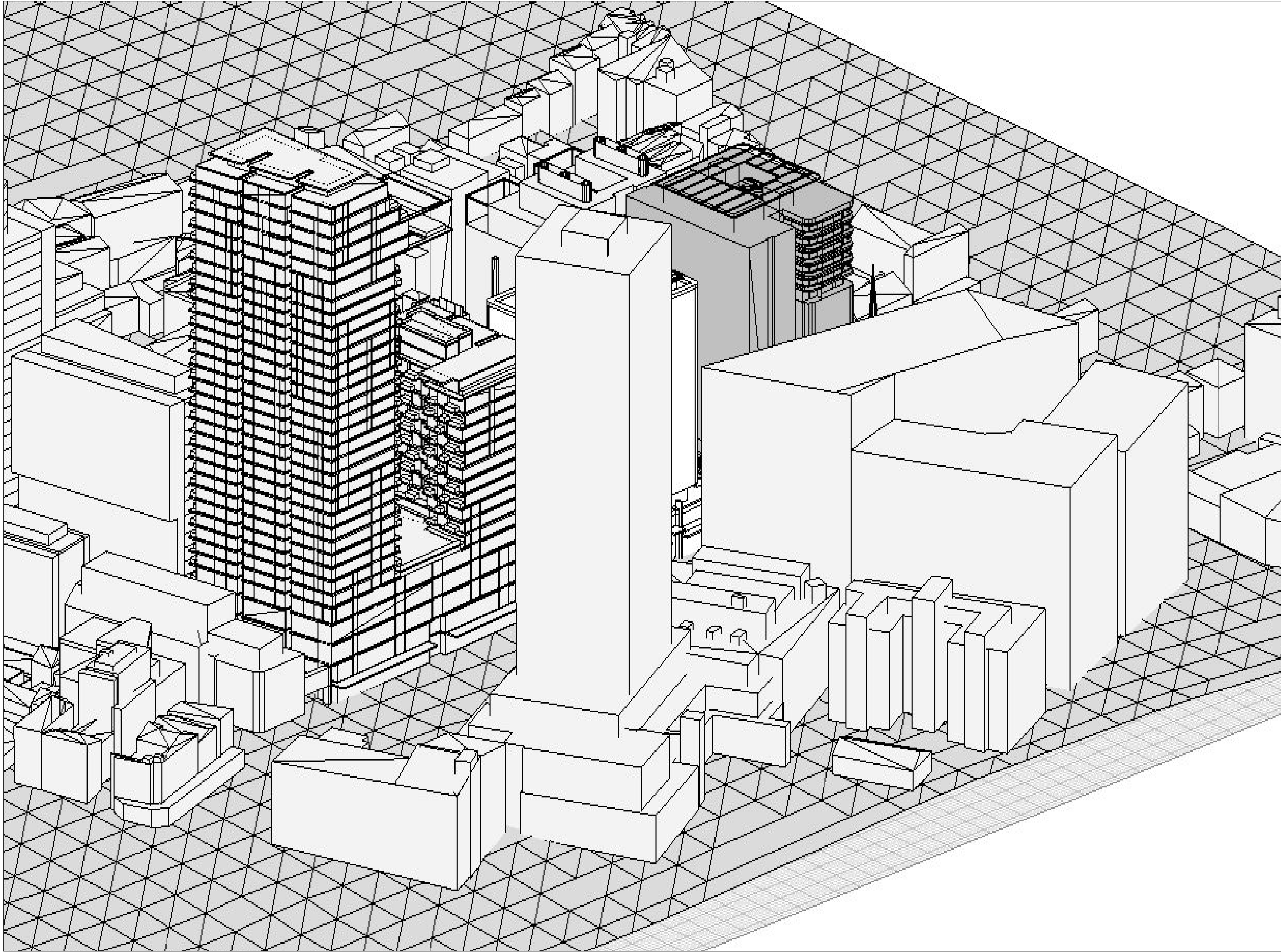

02 22 June  
9:00 AM

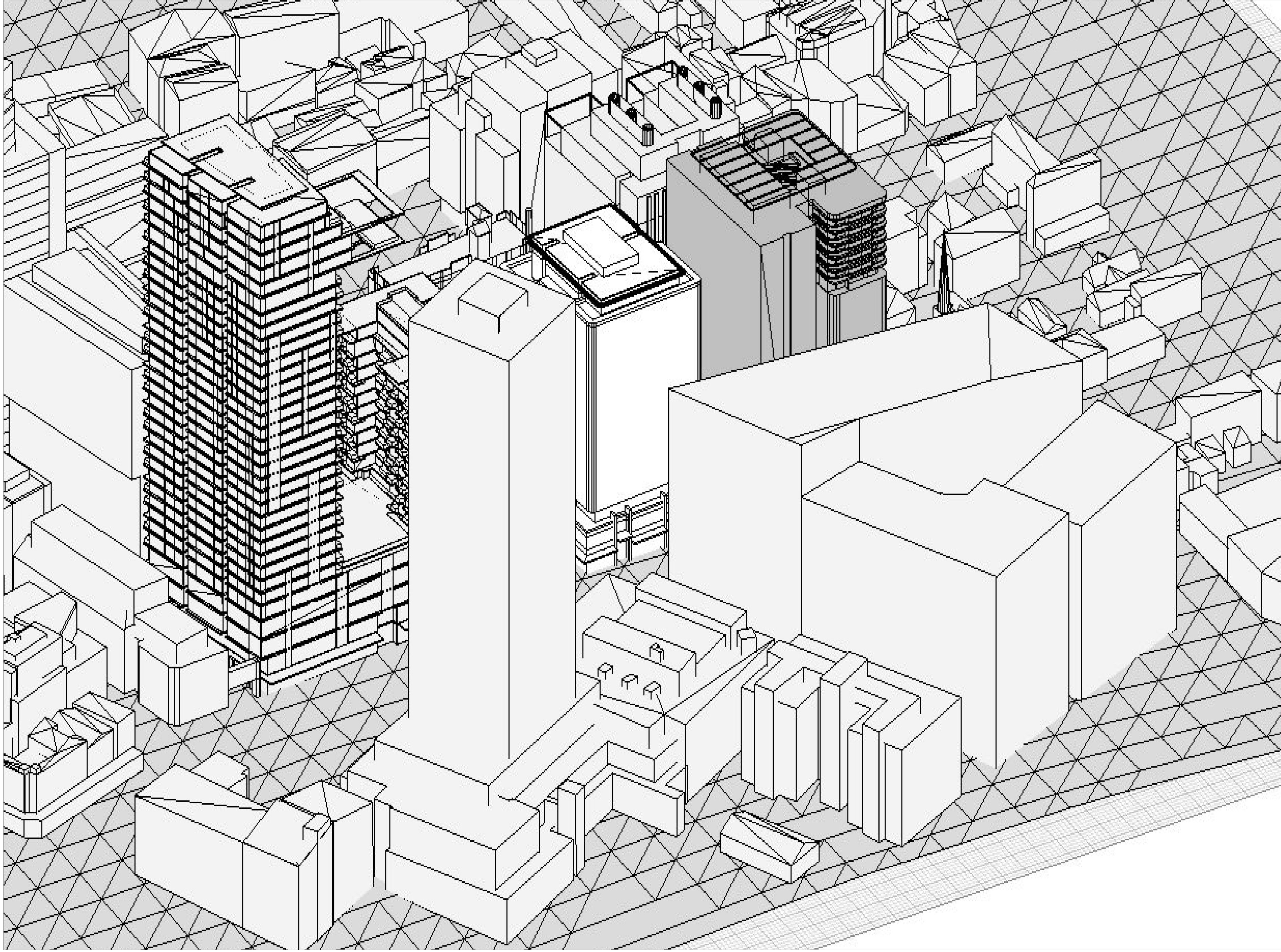

03 22 June  
11:00 AM

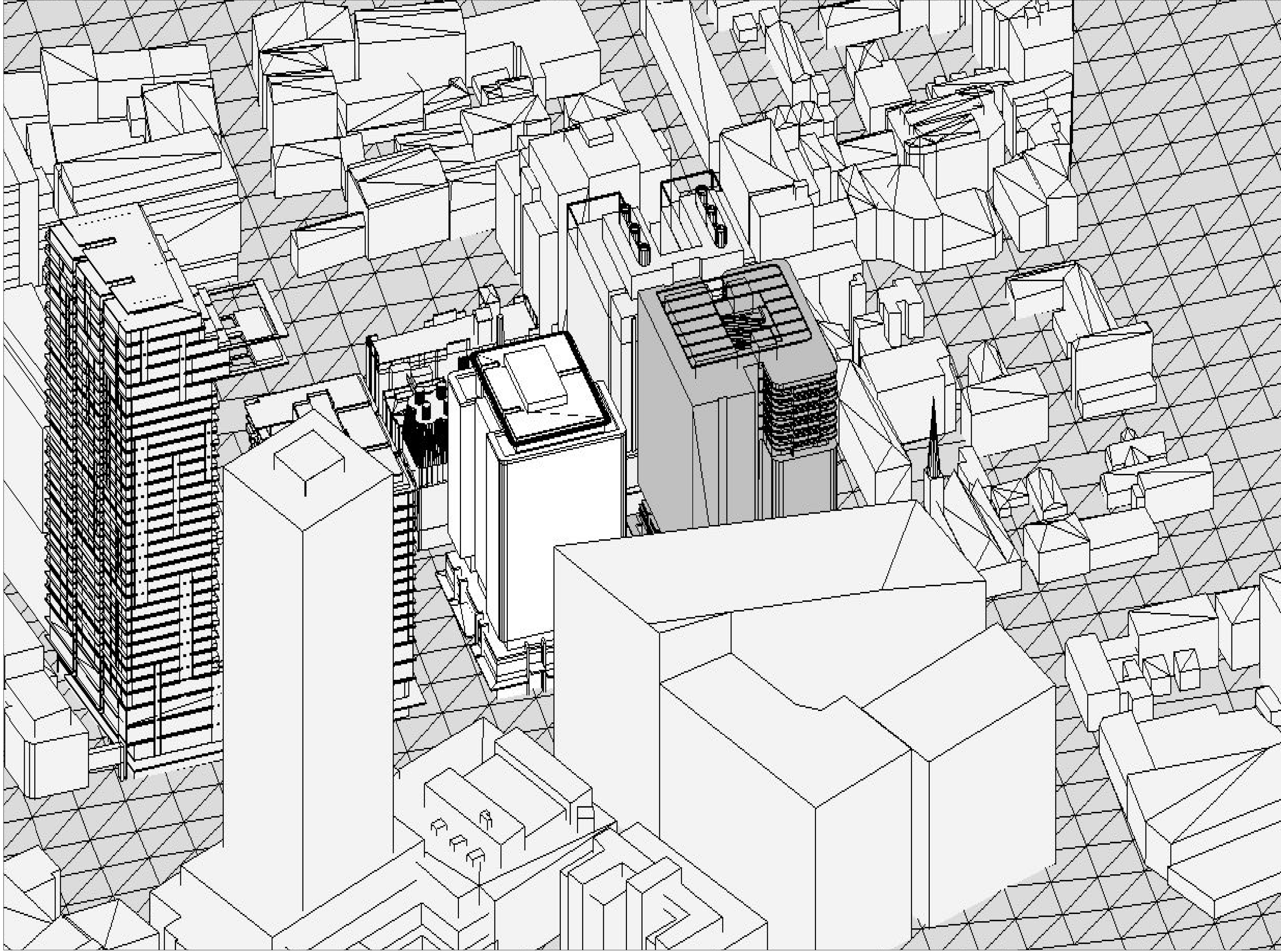

04 22 June  
11:00 AM

General Notes

1. Do not scale drawings. Dimensions govern.

2. All dimensions are in millimetres unless noted otherwise.

3. All dimensions shall be verified on site before proceeding with the work.

4. Foster + Partners shall be notified in writing of any discrepancies.

5. Any areas indicated on this sheet are approximate and indicative only.

6. Australian Eastern Time Zone: UTC/GMT +10 hours

NOTE: shadow study and comparison indicative only. All areas are to be confirmed by a specialist consultant

00	15/10/14	SSD Application	RP
Rev.	Date	Reason For Issue	CHK

For information

Key Plan

SERS PROPERTY

Project

Frasers Broadway  
20 - 102 Broadway Sydney NSW 2000

Client

Frasers Broadway  
L11, 456 Kent Street Sydney NSW 2000  
T: 02 8823 8800 F: 02 8823 8801

Architect

**Foster + Partners**  
Riverside, 22 Hester Road  
London SW11 4AN  
T +44 (0)20 7738 0455  
F +44 (0)20 7738 1107

Local Collaborating Architect

**PTW Architects**  
Level 17, 9 Castlereagh St  
Sydney NSW 2000 Australia  
T +61 (0)2 92325977  
F +61 (0)2 9221 4139  
www.ptw.com.au

Block 4N

Sun Studies

Project No.	Scale @ A0	Date	Drawn By
2094	NTS	08/10/14	DS
Number	Revision		
PA-A4-1283			00

© Foster + Partners 2008

15-OCT-2014 19:02