

- LEGEND**
- EXISTING STORMWATER PIT
 - EXISTING STORMWATER PIPE
 - EXISTING STORMWATER PIPE
 - PROPOSED STORMWATER PIPE/CULVERT
 - PROPOSED STORMWATER PIT
 - PROPOSED STORMWATER PIT TO TANK
 - PROPOSED GRATED DRAIN SURFACE WATER COLLECTION
 - CATCHMENT - TOWER TO OSD TANK (DRAINAGE DETAILS BY BLDG SERVICES ENGINEER)
 - CATCHMENT - SITE 68 'PLAZA' AREA FLOWING TO BIORETENTION/OSD TANK
 - CATCHMENT - SITE 68 'PLAZA' AREA FLOWING DIRECTLY TO DRAINAGE LINE
 - CATCHMENT - SITE 3 POCKET PARK (DRAINAGE DETAILS UNDER SEPERATE DA)

PLAN SK05
CONCEPT DRAINAGE PLAN
SCALE 1:400 @ A1

NOT FOR CONSTRUCTION

| REV | DESCRIPTION | DATE | INTL |
|-----|-----------------|---------|------|
| D | REISSUED FOR DA | 27/5/15 | AM |
| C | REISSUED FOR DA | 6/11/14 | AM |
| B | ISSUED FOR DA | 17/9/14 | AM |
| A | PRELIMINARY | 12/9/14 | AM |

| DESIGNED: | NAME | DATE |
|---------------|-------|-----------|
| DRAWN: | AM | |
| CHECKED: | AM | |
| APPROVED: | DK | |
| SCALE (at A1) | | |
| A | 1:400 | 0 20 40 m |
| B | | |
| C | | |
| D | | |

alluvium
www.alluvium.com.au
T +61 2 8094 9703

Client:

ECOVE
SOP SITE 68
STORMWATER CONCEPT PLAN

Drawing No. SK05
Sheet No. 1 OF 1
© Alluvium Consulting Australia Pty Ltd

Revision No. D
File Name: Site68_v10.dwg
ABN 45 653 522 596

A1

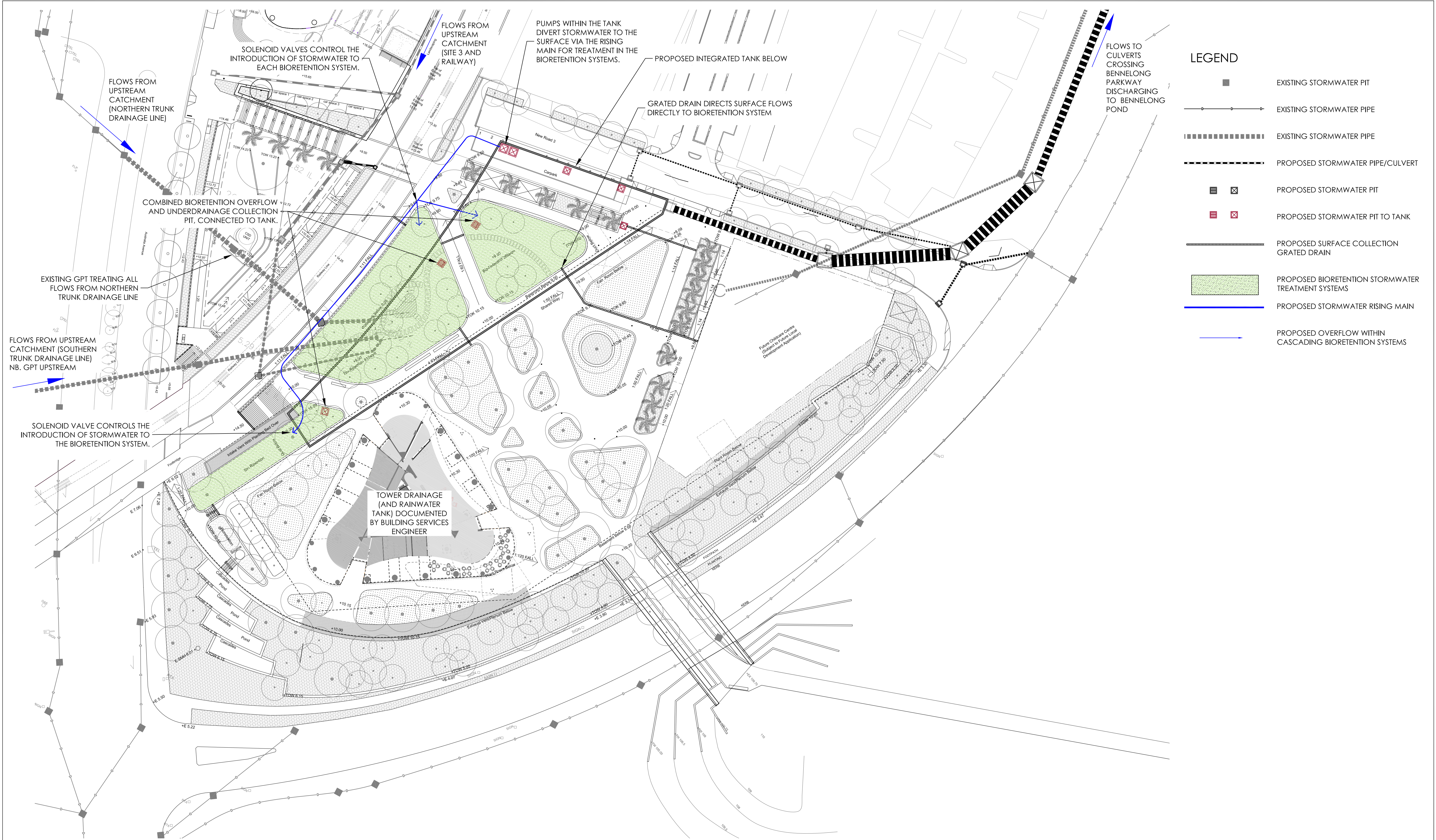

PLAN SK06
CONCEPT STORMWATER TREATMENT PLAN
SCALE 1:400 @ A1

NOT FOR CONSTRUCTION

| REV | DESCRIPTION | DATE | INTL |
|-----|-----------------|---------|------|
| D | REISSUED FOR DA | 27/5/15 | AM |
| C | REISSUED FOR DA | 6/11/14 | AM |
| B | ISSUED FOR DA | 17/9/14 | AM |
| A | PRELIMINARY | 12/9/14 | AM |

| DESIGNED: | NAME | DATE |
|---------------|-------|-----------|
| DRAWN: | AM | |
| CHECKED: | AM | |
| APPROVED: | DK | |
| SCALE (at A1) | | |
| A | 1:400 | 0 20 40 m |
| B | | |
| C | | |
| D | | |

alluvium
www.alluvium.com.au
T +61 2 8094 9703

Client:

ECOVE
SOP SITE 68
STORMWATER TREATMENT PLAN

Drawing No. SK06
Sheet No. 1 OF 1
© Alluvium Consulting Australia Pty Ltd

Revision No. D
File Name: Site68_v10.dwg
ABN 45 653 522 596

A1

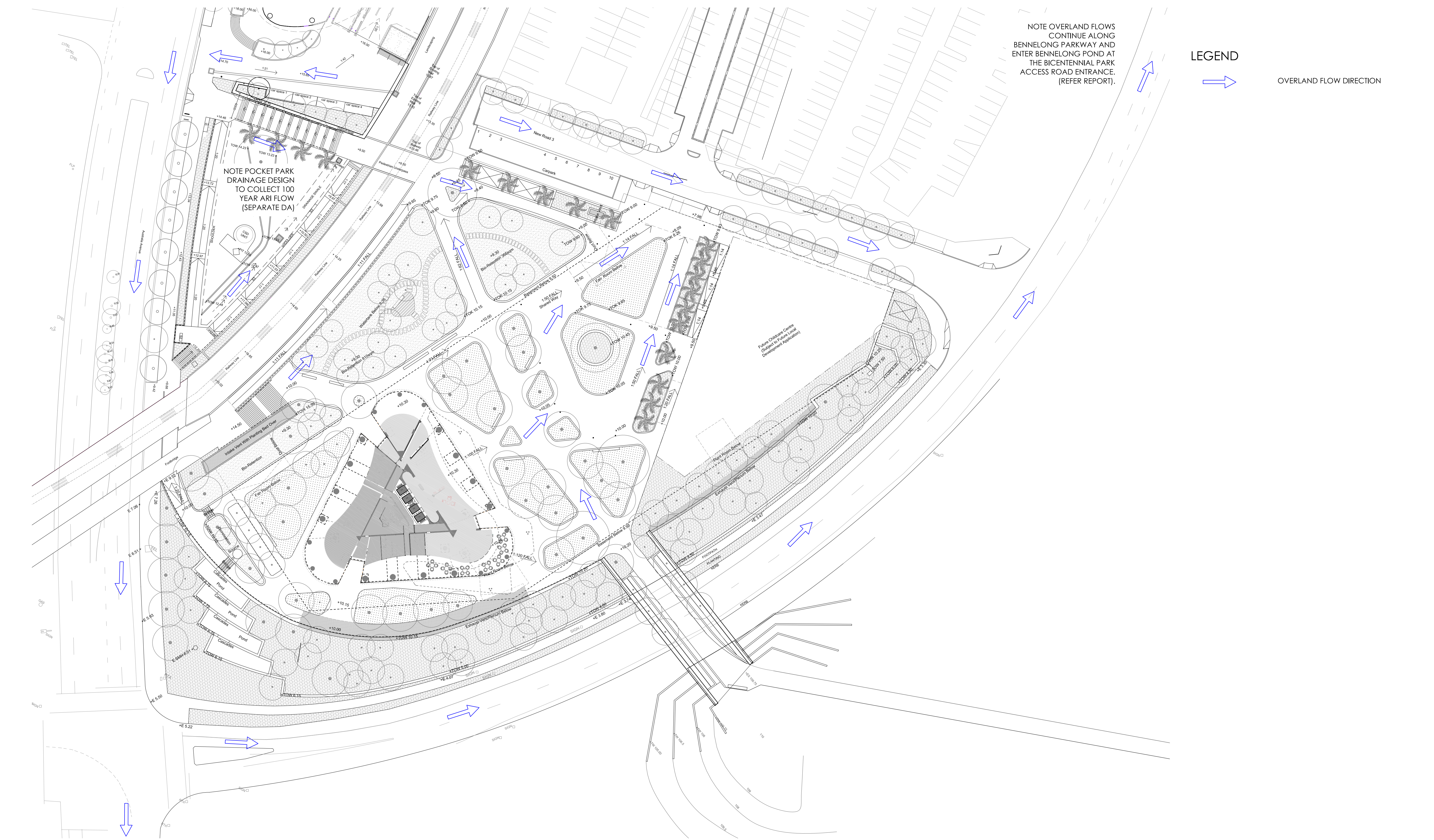

PLAN SK07
OVERLAND FLOW PLAN
SCALE 1:400 @ A1

NOT FOR CONSTRUCTION

| REV | DESCRIPTION | DATE | INTL |
|-----|-----------------|---------|------|
| D | REISSUED FOR DA | 27/5/15 | AM |
| C | REISSUED FOR DA | 6/11/14 | AM |
| B | ISSUED FOR DA | 17/9/14 | AM |
| A | PRELIMINARY | 12/9/14 | AM |

| DESIGNED: | NAME | DATE |
|---------------|-----------|------|
| DRAWN: | AM | |
| CHECKED: | AM | |
| APPROVED: | DK | |
| SCALE (at A1) | 0 20 40 m | |
| A | 1:400 | |
| B | | |
| C | | |
| D | | |



www.alluvium.com.au
T +61 2 8094 9703



ecove

ECOVE
SOP SITE 68
OVERLAND FLOW PLAN

Drawing No. SK07
Sheet No. 1 OF 1
© Alluvium Consulting Australia Pty Ltd

Revision No. D
File Name: Site68_v10.dwg
ABN 45 653 522 596